



Government Gazette

OF THE STATE OF
NEW SOUTH WALES

Number 19
Friday, 30 January 2004

Published under authority by the Government Printing Service

LEGISLATION

Regulations

CONTAMINATED LAND MANAGEMENT AMENDMENT REGULATION 2004

ERRATUM

THE Contaminated Land Management Amendment Regulation 2004 which was published in the *Government Gazette* on 23rd January 2004, No. 16, folios 265 to 268 was published containing an error. The Regulation is now republished in full.



Contaminated Land Management Amendment Regulation 2004

under the

Contaminated Land Management Act 1997

Her Excellency the Governor, with the advice of the Executive Council, has made the following Regulation under the *Contaminated Land Management Act 1997*.

BOB DEBUS, M.P.,
Minister for the Environment

Explanatory note

The object of this Regulation is to amend the *Contaminated Land Management Regulation 1998* to take into account amendments to the *Contaminated Land Management Act 1997* made by the *Contaminated Land Management Amendment Act 2003*. This Regulation updates certain cross references and removes redundant clauses and a redundant form.

This Regulation is made under the *Contaminated Land Management Act 1997*, including Schedule 2 and sections 50 (2) (c), 51 (5), 52 (1) (c), 52 (9), 53D (3) and 112 (the general regulation-making power).

Clause 1 Contaminated Land Management Amendment Regulation 2004

Contaminated Land Management Amendment Regulation 2004

under the

Contaminated Land Management Act 1997

1 Name of Regulation

This Regulation is the *Contaminated Land Management Amendment Regulation 2004*.

2 Commencement

This Regulation commences on 1 February 2004.

3 Amendment of Contaminated Land Management Regulation 1998

The *Contaminated Land Management Regulation 1998* is amended as set out in Schedule 1.

Contaminated Land Management Amendment Regulation 2004

Amendments

Schedule 1

Schedule 1 Amendments

(Clause 3)

[1] Clause 9 Accreditation fees

Omit “section 49 (1) (c)” from clause 9 (1).

Insert instead “section 50 (2) (c)”.

[2] Clause 9 (2)

Omit the subclause. Insert instead:

(2) For the purposes of sections 51 (5) and 52 (9) of the Act the prescribed accreditation fee is as follows:

- (a) if the accreditation period is 1 year or less—\$3,500,
- (b) if the accreditation period is 2 years or less but more than 1 year—\$7,000,
- (c) if the accreditation period is greater than 2 years—\$10,500.

[3] Clause 10 Time for making renewal applications

Omit “section 50 (3)”. Insert instead “section 52 (1) (c)”.

[4] Clause 11 Particulars to be included in annual returns

Omit “section 53 (2)”. Insert instead “section 53D (3)”.

[5] Clauses 12 and 13

Omit the clauses.

[6] Part 4

Omit the Part. Insert instead:

Part 4 Transitional

12 Fees

Clause 9 (2), as substituted by the *Contaminated Land Management Amendment Regulation 2004*, applies only in respect of accreditation granted or renewed on or after 1 February 2004.

Contaminated Land Management Amendment Regulation 2004

Schedule 1 Amendments

[7] Schedule 1 Forms

Omit Form 2.

**GAMING MACHINE AMENDMENT (SIA EXEMPTION)
REGULATION 2004**

Erratum

IN the notification appearing in the *Government Gazette* of 23 January 2004, Folio 269, under the heading Gaming Machines Amendment (SIA Exemption) Regulation 2004, “GRANT McBRIDE MP, Minister for Gaming and Racing” should read “KERRY HICKEY MP, Acting Minister for Gaming and Racing”.

Orders



New South Wales

Fisheries Management Amendment (Threatened Species Conservation) Order (No 2) 2004

under the

Fisheries Management Act 1994

I, the Minister for Agriculture and Fisheries, in pursuance of section 220D of the *Fisheries Management Act 1994*, make the following Order.

Dated, this 12th day of January 2004.

IAN MICHAEL MACDONALD, M.L.C.,
Minister for Agriculture and Fisheries

Explanatory note

Part 7A of the *Fisheries Management Act 1994* (*the Act*) deals with the conservation of threatened species, populations and ecological communities of fish and marine vegetation. For the purposes of identification and classification, provision is made for the listing:

- (a) in Schedule 4 to the Act, of endangered species, endangered populations, and endangered ecological communities and species that are presumed to be extinct, and
- (b) in Schedule 5, of vulnerable species, and
- (c) in Schedule 6, of key threatening processes.

Under the Act, listings and amendments to listings are to be made by the Minister by order on the recommendation of the Fisheries Scientific Committee (*the Committee*).

The object of this Order is to list hook and line fishing in areas important for the survival of threatened fish species in Schedule 6 to the Act (Key threatening processes), as recommended by the Committee.

Fisheries Management Amendment (Threatened Species Conservation) Order (No 2) 2004

Explanatory note

The Committee has recommended this listing because it considers that the process adversely affects 2 or more threatened species, populations or ecological communities, or could cause species, populations or ecological communities that are not threatened to become threatened.

This Order is made under section 220D of the *Fisheries Management Act 1994*.

Fisheries Management Amendment (Threatened Species Conservation)
Order (No 2) 2004

Clause 1

Fisheries Management Amendment (Threatened Species Conservation) Order (No 2) 2004

under the

Fisheries Management Act 1994

1 Name of Order

This Order is the *Fisheries Management Amendment (Threatened Species Conservation) Order (No 2) 2004*.

2 Commencement

This Order takes effect on the date that it is published in the Gazette.

3 Amendment of Fisheries Management Act 1994

The *Fisheries Management Act 1994* is amended by inserting in alphabetical order in Schedule 6:

Hook and line fishing in areas important for the survival of threatened fish species



New South Wales

Fisheries Management Amendment (Threatened Species Conservation) Order (No 1) 2004

under the

Fisheries Management Act 1994

I, the Minister for Agriculture and Fisheries, in pursuance of section 220D of the *Fisheries Management Act 1994*, make the following Order.

Dated, this 2nd day of January 2004.

IAN MICHAEL MACDONALD, M.L.C.,
Minister for Agriculture and Fisheries

Explanatory note

Part 7A of the *Fisheries Management Act 1994* (*the Act*) deals with the conservation of threatened species, populations and ecological communities of fish and marine vegetation. For the purposes of identification and classification, provision is made for the listing:

- (a) in Schedule 4 to the Act, of endangered species, endangered populations, and endangered ecological communities and species that are presumed to be extinct, and
- (b) in Schedule 5, of vulnerable species, and
- (c) in Schedule 6, of key threatening processes.

Under the Act, listings and amendments to listings are to be made by the Minister by order on the recommendation of the Fisheries Scientific Committee (*the Committee*).

The object of this Order is to list the current shark meshing program in New South Wales waters in Schedule 6 to the Act (Key threatening processes), as recommended by the Committee.

The Committee has recommended this listing because it considers that the process adversely affects 2 or more threatened species, populations or ecological communities, or could cause species, populations or ecological communities that are not threatened to become threatened.

Fisheries Management Amendment (Threatened Species Conservation) Order (No 1) 2004

Explanatory note

This Order is made under section 220D of the *Fisheries Management Act 1994*.

Fisheries Management Amendment (Threatened Species Conservation)
Order (No 1) 2004

Clause 1

Fisheries Management Amendment (Threatened Species Conservation) Order (No 1) 2004

under the

Fisheries Management Act 1994

1 Name of Order

This Order is the *Fisheries Management Amendment (Threatened Species Conservation) Order (No 1) 2004*.

2 Commencement

This Order takes effect on the date that it is published in the Gazette.

3 Amendment of Fisheries Management Act 1994

The *Fisheries Management Act 1994* is amended by inserting in alphabetical order in Schedule 6:

The current shark meshing program in New South Wales waters

OFFICIAL NOTICES

Appointments

CONSTITUTION ACT 1902

Ministerial Arrangements During the Absence from the State of the Treasurer, and Minister for State Development

PURSUANT to section 36 of the Constitution Act, 1902, Her Excellency the Governor, with the advice of the Executive Council, has authorised the Honourable J. J. DELLA BOSCA, M.L.C., Special Minister of State, Minister for Commerce, Minister for Industrial Relations, Assistant Treasurer, and Minister for the Central Coast, be authorised to perform the duties of the office of the Treasurer from 28 January 2004 with a view to him performing the duties of the Honourable M. R. EGAN, M.L.C., during his absence from the State.

ANDREW REFSHAUGE, M.P.,
Acting Premier

The Cabinet Office, Sydney
23 January 2004

MINES INSPECTION ACT 1901

Appointment of Acting Inspector

MARIE BASHIR, Governor I, Professor MARIE BASHIR, AC, Governor of the State of New South Wales, with the advice of the Executive Council and pursuant to the provisions of section 32(1) of the Mines Inspection Act 1901, have appointed ROBERT ALAN JAY as an Acting Inspector of Mines for a period commencing on 21 January 2004 up to and including 30 April 2004.

Signed and sealed at Sydney, this 21st day of January 2004.

By Her Excellency's Command,

KERRY HICKEY, M.P.,
Minister for Mineral Resources

CONSTITUTION ACT 1902

Ministerial Arrangements During the Absence from the State of the Treasurer, and Minister for State Development

PURSUANT to section 36 of the Constitution Act, 1902, Her Excellency the Governor, with the advice of the Executive Council, has authorised the Honourable D. A. CAMPBELL, M.P., Minister for Regional Development, Minister for the Illawarra, and Minister for Small Business, be authorised to perform the duties of the office of the Minister for State Development from 28 January 2004 with a view to him performing the duties of the Honourable M. R. EGAN, M.L.C., during his absence from the State.

ANDREW REFSHAUGE, M.P.,
Acting Premier

The Cabinet Office, Sydney
23 January 2004

SUSTAINABLE ENERGY DEVELOPMENT ACT 1995

Appointment Under Section 14

HER Excellency the Governor with the advice of the Executive Council, pursuant to the provisions of the Sustainable Energy Development Act 1995, has appointed the officer listed below to the senior executive service position as specified:

Sustainable Energy Development Authority

Mark Thomas FOGARTY, Executive Director [31 January 2004].

The Hon. BOB CARR, M.P.,
Premier

NSW Agriculture

PLANT DISEASES ACT 1924

PROCLAMATION P145

Proclamation to regulate the bringing into specified parts of New South Wales of certain fruit originating from or which has moved through other specified parts of New South Wales on account of an outbreak of Queensland fruit fly at Yenda.

Her Excellency Professor MARIE BASHIR AC,
Governor

I, Professor MARIE BASHIR, AC, Governor of the State of New South Wales, being of the opinion that the movement of fruit within a portion of the State is likely to introduce the pest Queensland fruit fly (*Bactrocera tryoni*), with the advice of the Executive Council and pursuant to Section 4(1) of the Plant Diseases Act 1924 do by this proclamation regulate the movement of fruit within the State in the manner set out in this proclamation.

1. In this Proclamation –

host fruit means the fruit specified in the Schedule.

outbreak area means the area within a 1.5 kilometre radius of coordinates decimal degrees 34.25 South and 146.20 East.

Note: The suspension area, including the outbreak area, is illustrated on the map titled Yenda Outbreak & Suspension Areas

FFEZ means the area known as the New South Wales Fruit Fly Exclusion Zone, as declared in Proclamation P36 published in Government Gazette No 13 of 31 January 1997 at page 321.

Plant Health Assurance Certificate means a certificate:

- issued by a person authorised by the Department of Agriculture to issue Plant Health Assurance Certificates, and
- which certifies that the host fruit has been treated in a manner approved by the Chief, Division of Plant Industries of the Department of Agriculture, and
- which specifies any conditions subject to which the host fruit must be transported or stored.

Plant Health Certificate means a certificate –

- issued by an inspector or a person authorised pursuant to Section 11(3), and
- which certifies that the host fruit has been treated in a manner approved by the Chief, Division of Plant Industries of the Department of Agriculture, and
- which specifies any conditions subject to which the host fruit must be transported or stored.

suspension area means the area within a 15 kilometre radius of coordinates decimal degrees 34.25 south and 146.20 east.

2. Host fruit must not be brought into –

- the suspension area from the outbreak area, or
- the FFEZ from the suspension area

unless

- a Plant Health Certificate or a Plant Health Assurance Certificate has been issued in respect of the host fruit, and
- the host fruit is transported and stored in accordance with any conditions relating to such matters which are stated in the Plant Health Certificate or the Plant Health Assurance Certificate, and
- the Plant Health Certificate or the Plant Health Assurance Certificate is in the possession of the driver of the vehicle transporting the host fruit or the person otherwise having custody or control of the host fruit while it is in the suspension area or the FFEZ as the case may be, and
- the Plant Health Certificate or the Plant Health Assurance Certificate is produced on demand to an inspector or a person authorised pursuant to Section 11(3).

3. Paragraph 2 applies whether or not the host fruit was grown in the outbreak area or the suspension area as the case may be.

Note: Any movement of host fruit is subject to the requirements of this proclamation even if the host fruit is merely transported through the outbreak area or the suspension area.

SCHEDULE

Host fruit

All citrus fruit, pome fruit, stone fruit and tropical fruit (excepting pineapple).

The following berry fruit:

blackberry	cape gooseberry	raspberry
blueberry	loganberry	strawberry
boysenberry	mulberry	youngberry

The following other fruit:

abiu	kiwifruit or Chinese gooseberries
babaco	loquat
Brasilian cherry	medlars
capsicum	pepino
cashew apple	persimmon
cherimoya	pomegranate
chilli (chillies) (cherry peppers) (tabasco)	prickly pear
dates (fresh)	rollinia
feijoa	santol
fig	tamarillo
granadilla	tomato
grumichama (Brazilian) (Costa Rican)	walnuts (green)
jujubes	wax jambu

Note: The New South Wales Department of Agriculture's reference for this proclamation is P145.

For further information contact the New South Wales Department of Agriculture on 02 6391 3593.

Signed and sealed at Sydney this 28th day of January 2004.

By Her Excellency's Command,

IAN MACDONALD, M.L.C.,

NSW Minister for Agriculture and Fisheries

GOD SAVE THE QUEEN!

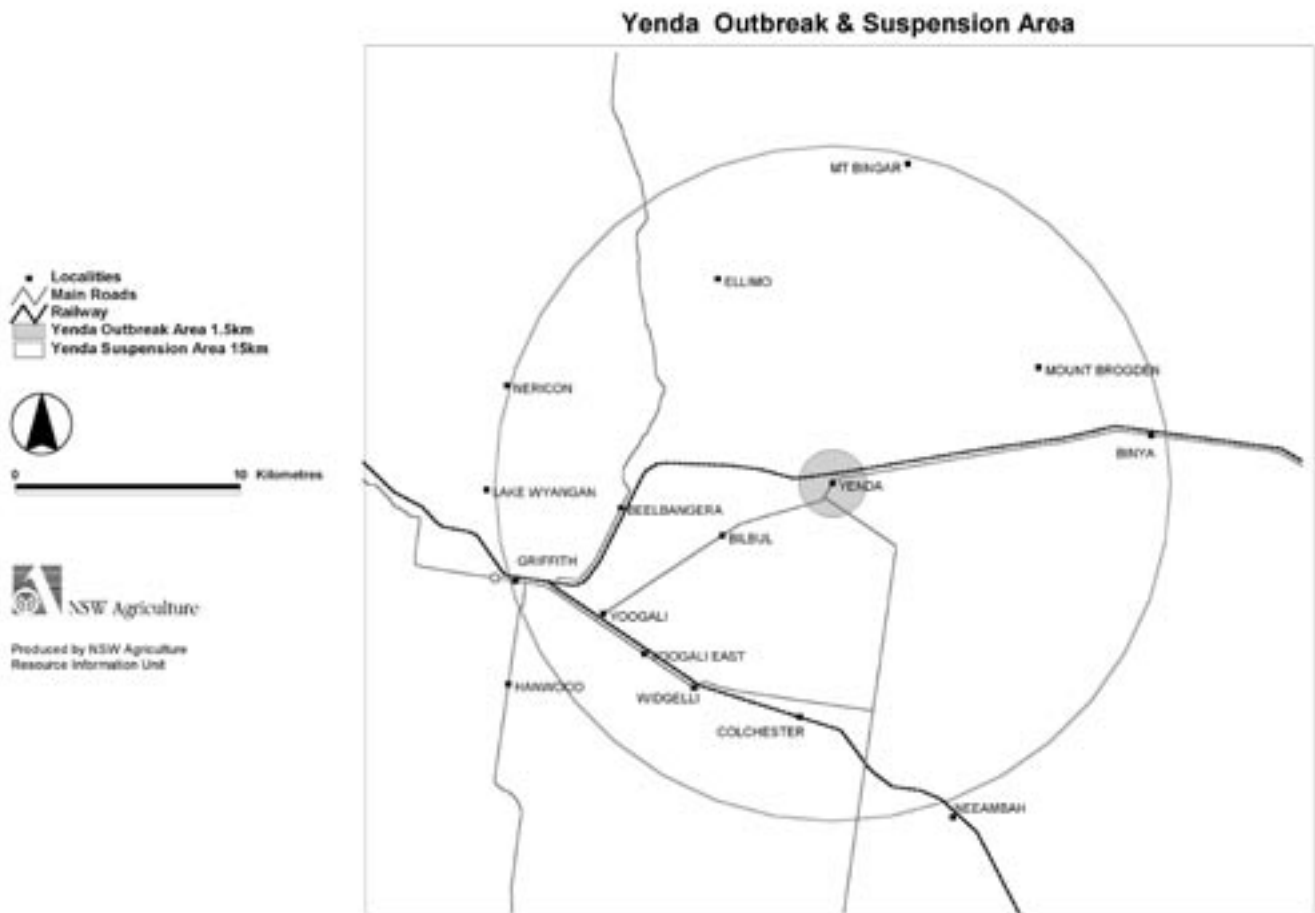

NSW Fisheries

F98/358

FISHERIES MANAGEMENT ACT 1994

Section 8 Notification – Fishing Closure

Bega River, its Creeks, Tributaries, Inlets and Lagoons.

I, STEVE DUNN, prohibit the taking of fish by the methods of fishing specified in Column 1 of Schedule of this notification, from waters shown opposite in Column 2.

This prohibition is effective for a period of up to five years from the date of publication, unless sooner varied or revoked by notification of Director-General of NSW Fisheries.

STEVE DUNN,
Director-General,
NSW Fisheries.

SCHEDULE

Bega River – Netting Closure

<i>Column 1</i> Methods	<i>Column 2</i> Waters
By means of nets of every description, except the landing net, as prescribed by the Fisheries Management (General) Regulation 2002.	The whole of the waters of that part of the Bega River, its creeks and tributaries, inlets and lagoons, extending upward to its source from a line drawn easterly across that river from the southern most point of the entrance of Jellat-Jellat Creek into that river, and the whole of the waters of Jellat-Jellat Creek and the Brogo River, together with all their creeks, tributaries, inlets and lagoons.

F92/50

FISHERIES MANAGEMENT ACT 1994

Section 8 Notification – Fishing Closure

Congo Creek

I, STEVE DUNN, prohibit the taking of fish by the methods of fishing specified in Column 1 of Schedule of this notification, from waters shown opposite in Column 2.

This prohibition is effective for a period of up to five years from the date of publication, unless sooner varied or revoked by notification of Director-General of NSW Fisheries.

Notes: Fishing will be further subject to the ‘condition’ as set out in the Schedule of this notification.

The word ‘Regulation’, where appearing in this notification, refers to the Fisheries Management (General) Regulation 2002.

STEVE DUNN,
Director-General,
NSW Fisheries.

SCHEDULE

Congo Creek

<i>Column 1</i> Methods	<i>Column 2</i> Waters
By means of nets of every description, except the following recreational nets; the hand hauled prawn net, the push or scissors net (prawns), the dip or scoop net (prawns), the hoop or lift net and the landing net, as prescribed by Regulation.	The whole of the waters of Congo Creek, from its source, downstream to the South Pacific Ocean.
Conditions: This closure will only be effective from 1 November to 30 April (inclusive) in each year.	

FISHERIES MANAGEMENT ACT 1994

Section 8 Notification – Fishing Closure

Clyde River

I, STEVE DUNN, prohibit the taking of fish by the methods of fishing specified in Column 1 of Schedules 1 and 2 of this notification, from waters shown opposite in Column 2 of those Schedules.

This prohibition is effective for a period of up to five years from the date of publication, unless sooner varied or revoked by notification of the Director-General of NSW Fisheries.

Notes: Fishing will be further subject to the ‘condition’ as set out in the Schedules of this notification.

The word ‘Regulation’, where appearing in this notification, refers to the Fisheries Management (General) Regulation 2002.

STEVE DUNN,
Director-General,
NSW Fisheries.

SCHEDULE 1

Clyde River set meshing nets (Bass)

<i>Column 1</i> Methods	<i>Column 2</i> Waters
By means of meshing nets, except when used by the method known as ‘splashing’ (that is, shooting the net, splashing the water in the vicinity and retrieving the net as a continuous operation), as prescribed by Regulation.	The whole of the waters of Clyde River, its creeks and tributaries, from the Nelligen road bridge, upstream to the causeway at Shallow Crossing.
Conditions: This closure will only be effective during the period 15 May to 31 August (inclusive) each year.	

SCHEDULE 2

Upper Clyde River (Bass)

<i>Column 1</i> Methods	<i>Column 2</i> Waters
All methods other than up to two (2) rods and line or handlines (only 2 lines allowed per person) each with not more than two hooks attached or three treble hooks attached to a lure, and the landing net, as prescribed by Regulation.	The whole of the waters of Clyde River, its creeks and tributaries, from the causeway at Shallow Crossing, upstream to its source.

FISHERIES MANAGEMENT ACT 1994

Section 8 Notification – Fishing Closure

Durras Lake

I, STEVE DUNN, prohibit the taking of fish by the methods of fishing specified in Column 1 of Schedule of this notification, from waters shown opposite in Column 2.

This prohibition is effective for a period of up to five years from the date of publication, unless sooner varied or revoked by notification of the Director-General of NSW Fisheries.

Notes: Fishing will be further subject to the ‘condition’ as set out in the Schedule of this notification.

The word ‘Regulation’, where appearing in this notification, refers to the Fisheries Management (General) Regulation 2002.

STEVE DUNN,
Director-General,
NSW Fisheries.

SCHEDULE

Durras Lake

<i>Column 1</i> Methods	<i>Column 2</i> Waters
By means of nets of every description, except the following nets when used by recreational fishers; the hand hauled prawn net, the push or scissors net (prawns), the dip or scoop net (prawns), the hoop or lift net and the landing net, as prescribed by Regulation.	The whole of the waters of Durras Lake, its creeks, inlets and bays, from a line drawn from the eastern shore at the entrance to Waterhole Bay, northerly to the nearest point on the opposite shore downstream to the South Pacific Ocean.
By means of nets of every description, except the following nets when used by recreational fishers; the hand hauled prawn net, the push or scissors net (prawns), the dip or scoop net (prawns) and the landing net, as prescribed by Regulation. The garfish net (bullringing), the prawn net (hauling), the prawn running net, the meshing net and the hoop or lift net (max. 5 per person), may also be used as prescribed by Regulation.	The whole of the waters of Durras Lake, its creeks, inlets and bays, upstream to its source, from a line drawn from the eastern shore at the entrance to Waterhole Bay, northerly to the nearest point on the opposite shore.
Condition: The garfish net (bullringing) as prescribed by Regulation may only be used during the months of 1 February to 30 November (inclusive) in each year.	

FISHERIES MANAGEMENT ACT 1994

Section 8 Notification – Fishing Closure

Tomaga River and Candlagan Creek

I, STEVE DUNN, prohibit the taking of fish by the methods of fishing specified in Column 1 of Schedules 1 and 2 of this notification, from waters shown opposite in Column 2 of those Schedules.

This prohibition is effective for a period of up to five years from the date of publication, unless sooner varied or revoked by notification of the Director-General of NSW Fisheries.

Note: The word 'Regulation', where appearing in this notification, refers to the Fisheries Management (General) Regulation 2002.

STEVE DUNN,
Director-General,
NSW Fisheries.

 SCHEDULE 1

Tomaga River

<i>Column 1</i> Methods	<i>Column 2</i> Waters
By means of nets of every description, except the dip or scoop net (when used for the taking of prawns only) and the landing net, as prescribed by Regulation.	The waters of that part of Tomaga River, its creeks and tributaries, from its confluence with the South Pacific Ocean, upstream to the Tomaga River road bridge.

 SCHEDULE 2

Candlagan Creek

<i>Column 1</i> Methods	<i>Column 2</i> Waters
By means of nets of every description, except the dip or scoop net (when used for the taking of prawns only), and the landing net, as prescribed by Regulation.	The whole of the waters of Candlagan Creek, its creeks and tributaries, from its confluence with the South Pacific Ocean, upstream to its source.

FISHERIES MANAGEMENT ACT 1994

Section 8 Notification – Fishing Closure

Moruya (or Deua) River and Tributaries, and Willija (or ‘Y’) Swamp at Moruya Heads

I, STEVE DUNN, prohibit the taking of fish by the methods of fishing specified in Column 1 of Schedules 1 to 6 of this notification, from waters shown opposite in Column 2 of those Schedules.

This prohibition is effective for a period of up to five years from the date of publication, unless sooner varied or revoked by notification of Director-General of NSW Fisheries.

Notes: Fishing will be further subject to the ‘time periods’ as set out in the Schedules of this notification.

The word ‘Regulation’, where appearing in this notification, refers to the Fisheries Management (General) Regulation 2002.

STEVE DUNN,
Director-General,
NSW Fisheries.

SCHEDULE 1

Nets – Weekends and Public Holidays

<i>Column 1</i> Methods	<i>Column 2</i> Waters
By means of nets of every description, except the dip or scoop net, the push or scissors net, the hand hauled prawn net, the hoop or lift net and the landing net, as prescribed by Regulation.	All waters of the Moruya River and tributaries, from a line drawn between the eastern extremities of the northern and southern breakwalls at the entrance to the river, upstream to its source.
Time periods: During the months of November to February (inclusive), this closure only applies from 6am Saturday to 8pm Sunday, or to 6pm Monday if Monday is a Public Holiday, in each week. During the months of March to October (inclusive), this closure only applies from 6am Saturday to 6pm Sunday, or to 6pm Monday if Monday is a Public Holiday, in each week. On any weekday Public Holiday (except Monday) throughout the year, the closure will apply from 6am to 6pm on that day.	

SCHEDULE 2

Nets – Moruya River Entrance Waters

<i>Column 1</i> Methods	<i>Column 2</i> Waters
By means of nets of every description, except the following recreational nets (when used for the capture of prawns only): the dip or scoop net, the push or scissors net and the hand hauled prawn net, the hoop or lift net and the landing net, are also permitted, as prescribed by Regulation.	All waters of the Moruya River and its bays and tributaries, from a line drawn between the eastern extremities of the northern and southern breakwalls at the entrance to the river, upstream to a line drawn generally northerly from the western extremity of the southern training wall (adjacent to the boat launching ramp), to the left bank of Burches Creek at Garlandtown.

SCHEDULE 3
Nets – Malabar Creek

<i>Column 1</i> Methods	<i>Column 2</i> Waters
By means of nets of every description, except the dip or scoop net and the landing net, as prescribed by Regulation.	The whole of the waters of Malabar Creek upwards to its source from its confluence with the Moruya River.

SCHEDULE 4
Nets – Upper Moruya River

<i>Column 1</i> Methods	<i>Column 2</i> Waters
By means of nets of every description, except the landing net, as prescribed by Regulation.	All waters of the Moruya (or Deua) River and tributaries, including Wamban Creek, upstream from the Kiora Bridge to its source.

SCHEDULE 5
Set Mesh Nets

<i>Column 1</i> Methods	<i>Column 2</i> Waters
By means of meshing nets, except when such nets are used by the method of 'splashing' (that is, shooting the net, splashing the water in the vicinity and retrieving the net as a continuous operation), as prescribed by Regulation.	All waters of Moruya River and tributaries, from the high voltage power lines crossing the river approximately 250 metres upstream of the junction with Mogendura Creek, upstream to the Kiora Bridge.
Time periods: This closure will only apply from 15 May to 31 August (inclusive) in each year.	

SCHEDULE 6
Nets and Traps – Willija (or 'Y') Swamp

<i>Column 1</i> Methods	<i>Column 2</i> Waters
By means of nets and traps of every description.	All waters of Willija, or 'Y' Swamp at Moruya Heads.

Department of Infrastructure, Planning and Natural Resources

Infrastructure and Planning



New South Wales

City of Wollongong Local Environmental Plan 1990 (Amendment No 218)

under the

Environmental Planning and Assessment Act 1979

I, the Minister Assisting the Minister for Infrastructure and Planning (Planning Administration), make the following local environmental plan under the *Environmental Planning and Assessment Act 1979*. (W03/00027/S69)

DIANE BEAMER, M.P.,
Minister Assisting the Minister for Infrastructure
and Planning (Planning Administration)

Clause 1 City of Wollongong Local Environmental Plan 1990 (Amendment No 218)

City of Wollongong Local Environmental Plan 1990 (Amendment No 218)

under the

Environmental Planning and Assessment Act 1979

1 Name of plan

This plan is *City of Wollongong Local Environmental Plan 1990 (Amendment No 218)*.

2 Aims of plan

This plan aims to reclassify the land to which this plan applies from community land to operational land within the meaning of the *Local Government Act 1993*.

3 Land to which plan applies

This plan applies to land situated in the City of Wollongong, being Lot 82, DP 13047, Rowland Avenue, Wollongong, as shown edged heavy black on the map marked “City of Wollongong Local Environmental Plan 1990 (Amendment No 218)” deposited in the office of Wollongong City Council.

4 Amendment of City of Wollongong Local Environmental Plan 1990

The *City of Wollongong Local Environmental Plan 1990* is amended by inserting at the end of Schedule 4A the following words:

Lot 82, DP 13047, Rowland Avenue, Wollongong, as shown edged heavy black on the map marked “City of Wollongong Local Environmental Plan 1990 (Amendment No 218)”

Natural Resources

WATER ACT 1912

Notice Under Section 22B

THE subject notice cancels and replaces the notice published on 23rd January 2004.

The Department of Infrastructure, Planning and Natural Resources pursuant to section 22B of the Water Act, 1912, being satisfied that the quantity of water available in the Boomi River, Unregulated Barwon River and Unregulated Darling River (Barwon/Darling River System) all upstream of Lake Wetherall is insufficient to meet requirements with respect to the taking of water therefrom for water entitlements denoted as "B" and "C" class detailed hereunder, gives notice to all holders of permits, authorities and licences issued under Part 2 of the Water Act, 1912 that all those water entitlements as mentioned above and held under the said part are restricted as of midday 17th January 2004 ("B" class) and midday 28th January 2004 ("C" class).

Details of restrictions:

- "B" class – a total of 13 days within the flow conditions attaching to their entitlement as of midday 17th January 2004.
- "C" class – a total of 2 days within the flow conditions attaching to their entitlement provided that where the same pump is used for both "B" and "C" class entitlements, the total allowable extraction is 13 days comprising 11 days of "B" class and no more than 2 days of "C" class entitlement. Separate "C" class works can extract water for a maximum of 2 days. All "C" class extraction commences as of midday 28th January 2004.

The subject restrictions apply until further notice.

GEOFF WISE,
Regional Director
Far West Region

WATER ACT 1912

APPLICATIONS for a licence under section 10 of the Water Act 1912, as amended, has been received from:

Sheila Margaret FAULKNER for a pump on Apsley River, Lot 182, DP 240261, Parish Walcha, County Vernon, for water supply for stock and domestic purposes (new licence) (Reference: GRA6322190) (GA2:476067).

Nicole Linda McGUIRE and Wayne James McGUIRE for a pump on Little Plain Creek, Lot 244, DP 752830, Parish Leigh, County Fitzroy, for irrigation of 5 hectares (8 megalitres) (replacement application – relocation of pump site – no increase in authorised area or allocation) (Reference: GRA6322264-1) (GA2:476069).

Richard Alan GRACE and Beverley Dawn GRACE for a pump on Little Plain Creek, Lots 27, 28 and 29, DP 752830, Parish Leigh, County Fitzroy, for water supply for

farming purposes (dairy washdown and mixing of sprays) (replacement application – additional pump site – no increase in allocation) (Reference: GRA6322172).

Barrie Leon ISAAC and Malcolm James ISAAC for two pumps on Camden Haven River Easement within Lot 1, DP 597019, Parish Johns River, County Macquarie, for water supply for stock, domestic, farming (dairy washdown) purposes and irrigation of 15 hectares (102 megalitres) (split of existing licence – no increase in authorised area or allocation) (Reference: GRA6322245-1) (GA2:476068).

Any enquiries regarding the above should be directed to the undersigned (telephone: [02] 6640 2000).

Written objections specifying the grounds thereof must be lodged within twenty-eight (28) days of the date of this publication as prescribed by the Act.

G. LOLLBACK,
Resource Access Manager,
North Coast Region, Grafton.

WATER ACT 1912

AN application under Part 2 within a proclaimed (declared) local area under section 5(4) of the Water Act 1912.

An application for a licence under section 10 for works within a proclaimed (declared) local area as generally described hereunder have been received from:

Murrumbidgee Valley

BELLA PASTORAL CO PTY LTD for two pumps on the Murrumbidgee River, Lot 1, DP 105818 and Road Reserve South of Lot 3, DP 750841, both Parish of Ganmain, County of Bourke, for a water supply for stock purposes and irrigation of 45 hectares (pulses and cereals) (replacement licence – amalgamation of existing licences) (Reference: 40SL70934).

Any inquiries regarding the above should be directed to the undersigned (telephone: [02] 6953 0700).

Formal objections to the application specifying the grounds thereof may be made by any statutory authority or a local occupier within the proclaimed area and must be lodged with the Department's Regional Director at Leeton within the twenty-eight (28) days as fixed by the Act.

S. F. WEBB,
Resource Access Manager,
Murrumbidgee Region.

Department Infrastructure, Planning and Natural Resources, PO Box 156, Leeton, NSW 2705.

WATER ACT 1912

AN APPLICATION under Part 2, being within a proclaimed (declared) local area under section 10 of the Water Act 1912, as amended.

An application for a licence within a proclaimed local area as generally described hereunder has been received as follows:

Gwydir River Valley

Peter James HARRIS and Jane Maree HARRIS for works on Moomin Creek as follows: four (4) pumps on Lot 47, DP 45269, one (1) pump, a diversion channel, four (4) pipes and gates on Lot 29, DP 750484 and Road, Parish of Moomin, one (1) pump on Lot 33, DP 45249, Parish of Mungi, all County of Benarba for water supply for stock and domestic purposes and existing irrigation of 3,240 hectares.

Application is due to relocation of three (3) diversion pipes and gates within the same Lot/DP. L.O. Papers 90SL100729. GA2:472125.

Written objections to the application specifying the grounds thereof may be made by any statutory authority or local occupier within the proclaimed (declared) area, whose interest may be affected and must be lodged with the Department's Manager, Resource Access, Tamworth within 28 days as specified in the Act.

GEOFF CAMERON,
Manager Resource Access

Department of Infrastructure, Planning and Natural Resources
P O Box 550, Tamworth NSW 2340

WATER ACT 1912

AN APPLICATION under Part 8, being within a Proclaimed (declared) Local Area under section 5(4) of the Water Act.

An application for Approval of Controlled Works under section 167 within the Proclaimed (declared) Local Area described hereunder has been received as follows:

Gwydir River Valley

John MADDEN and OTHERS trading as ALMA PASTORAL CO for Controlled Works consisting of an earthen storage, channels and levees on the Lower Gwydir Floodplain on Lots 4, 39 and 30 in DP 457504, Parish of Moomin, County of Benarba on the property known as "Alma", Rowena for conservation of water and prevention of inundation of land by floodwaters. All work is within the Moomin Creek Floodplain guidelines. L.O. Papers 90CW800196. GA2:472139.

Written objections to the application specifying the grounds thereof may be made by any statutory authority or local occupier within the Proclaimed Area, whose interest may be affected must be lodged with the Department's Resource Access Manager at Tamworth by 27 February, 2004.

Plans showing the location of the works referred to in the above application may be viewed at the Moree office of the Department of Infrastructure, Planning and Natural Resources.

GEOFF CAMERON,
Manager Resource Access

Department of Infrastructure, Planning and Natural Resources
P O Box 550, Tamworth NSW 2340

Department of Lands

DUBBO OFFICE

142 Brisbane Street (PO Box 865), Dubbo, NSW 2830

Phone: (02) 6841 5200 Fax: (02) 6841 5231

NOTICE PLACING RESERVE UNDER CONTROL OF RURAL LANDS PROTECTION BOARD

IN pursuance of the provisions of section 85, Rural Lands Protection Act 1998, the reserve specified hereunder is placed under the control of the Rural Lands Protection Board for the Rural Lands Protection District as from the date of this notification.

TONY KELLY, M.L.C.,
Minister Assisting the Minister for
Natural Resources (Lands)

DESCRIPTION

Land District: Dubbo.

Local Government Area: Dubbo City Council.

Rural Lands Protection District: Dubbo.

Parish: Terramungamine.

County: Lincoln.

Reserve 1005228 for travelling stock, notified this day.

File No.: DB80 R 22/7.

SCHEDULE

COLUMN 1

Land District: Dubbo.
Local Government Area: Dubbo
City Council.
Locality: Terramungamine.
Parish: Terramungamine.
County: Lincoln.
Description: Lot 135, DP 754328
and Lot 1 being Part 118,
DP 754328, as shown in the
following diagram.
Area: 6.689 hectares.
File No.: DB80 R 22/7.

COLUMN 2

Reserve No.: 1005388.
Public Purpose: Public
recreation and preservation
of Aboriginal Cultural
Heritage.

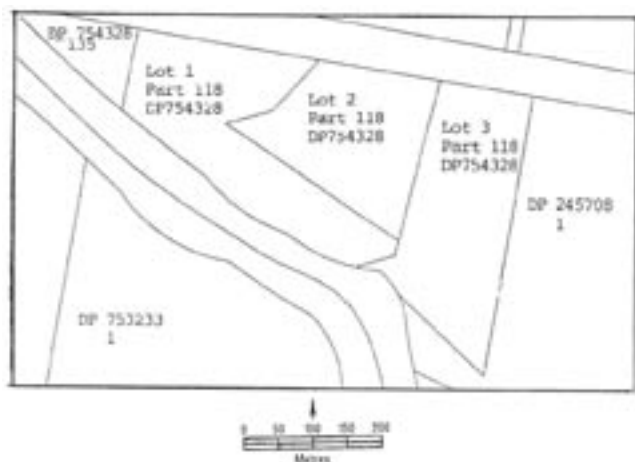

APPOINTMENT OF CORPORATION TO MANAGE RESERVE TRUST

PURSUANT to section 95 of the Crown Lands Act 1989, the corporation specified in Column 1 of the Schedules hereunder, is appointed to manage the affairs of the reserve trust specified opposite thereto in Column 2, which is trustee of the reserve referred to in Column 3 of the Schedules.

TONY KELLY, M.L.C.,
Minister Assisting the Minister for
Natural Resources (Lands)

SCHEDULE 1

COLUMN 1	COLUMN 2	COLUMN 3
Dubbo City Council.	Terramungamine Reserve Reserve Trust.	Reserve No.: 1005388. Public Purpose: Public recreation and preservation of Aboriginal Cultural Heritage. Notified: This day. File No.: DB80 R 22/7.

Term of Office

For a term commencing the date of this notice.

SCHEDULE 2

COLUMN 1	COLUMN 2	COLUMN 3
Dubbo City Council.	Tubbagah Aboriginal Burial Ground Reserve Trust.	Dedication No.: 1004888. Public Purpose: Aboriginal Burial Ground. Notified: This day. File No.: DB80 R 22/7

Term of Office

For a term commencing the date of this notice.

ESTABLISHMENT OF RESERVE TRUST

PURSUANT to section 92(1) of the Crown Lands Act 1989, the reserve trust specified in Column 1 of the Schedules hereunder, is established under the name stated in that Column and is appointed as trustee of the reserve specified opposite thereto in Column 2 of the Schedules.

TONY KELLY, M.L.C.,
Minister Assisting the Minister for
Natural Resources (Lands)

SCHEDULE 1

COLUMN 1	COLUMN 2
Terramungamine Reserve Reserve Trust.	Reserve No.: 1005388. Public Purpose: Public recreation and preservation of Aboriginal Cultural Heritage. Notified: This day. File No.: DB80 R 22/7.

SCHEDULE 2

COLUMN 1

Tubbagah Aboriginal Burial Ground Reserve Trust.

COLUMN 2

Dedication No.: 1004888.
Public Purpose: Aboriginal Burial Ground.
Notified: This day.
File No.: DB80 R 22/7.

DEDICATION OF CROWN LAND FOR A PUBLIC PURPOSE

PURSUANT to section 80 of the Crown Lands Act 1989, the Crown Land specified in Column 1 of the Schedules hereunder, is reserved as specified opposite thereto in Column 2 of the Schedules.

TONY KELLY, M.L.C.,
Minister Assisting the Minister for Natural Resources (Lands)

SCHEDULE 1

COLUMN 1

Land District: Dubbo.
Local Government Area: Dubbo City Council.
Locality: Terramungamine.
Parish: Terramungamine.
County: Lincoln.
Lot Part 118, DP No. 754328, Parish Terramungamine, County Lincoln, shown as Lot 3 being Part Lot 118, DP 754328 in the following diagram.
Area: 5.5 hectares.
File No.: DB80 R 22/7.

COLUMN 2

Reserve No.: 1004888.
Public Purpose: Aboriginal Burial Ground.

SCHEDULE 2

COLUMN 1

Land District: Dubbo.
Local Government Area: Dubbo City Council.
Locality: Terramungamine.
Parish: Terramungamine.
County: Lincoln.
Description: Lot 135, DP 754328 and Lot 1 being Part Lot 118, DP 754328 as shown in the following diagram.
Area: 6.689 hectares.
File No.: DB80 R 22/7.

COLUMN 2

Reserve No.: 1005388.
Public Purpose: Public recreation and preservation of Aboriginal Cultural Heritage.



RESERVATION OF CROWN LAND

PURSUANT to section 87 of the Crown Lands Act 1989, the Crown Land specified in Column 1 of the Schedules hereunder, is reserved as specified opposite thereto in Column 2 of the Schedules.

TONY KELLY, M.L.C.,
Minister Assisting the Minister for Natural Resources (Lands)

SCHEDULE 1

COLUMN 1

Land District: Dubbo.
Local Government Area: Dubbo City Council.
Locality: Terramungamine.
Lot Part 118, DP No. 754328, Parish Terramungamine, County Lincoln, shown as Lot 2 being Part Lot 118, DP 754328 in the following diagram.
Area: 4.0 hectares.
File No.: DB80 R 22/7.

COLUMN 2

Reserve No.: 1005228.
Public Purpose: Travelling stock.

SCHEDULE 2

COLUMN 1

Land District: Dubbo.
Local Government Area: Dubbo City Council.
Locality: Terramungamine.
Lot 135, DP No. 754328, Parish Terramungamine, County Lincoln;
Lot Part 118, DP No. 754328, Parish Terramungamine, County Lincoln;
shown as Lot 135, DP 754328 and Lot 1 being Part Lot 118, DP 754328 in the following diagram.
Area: 6.689 hectares.
File No.: DB80 R 22/7.

COLUMN 2

Reserve No.: 1005388.
Public Purpose: Public recreation and preservation of Aboriginal Cultural Heritage.

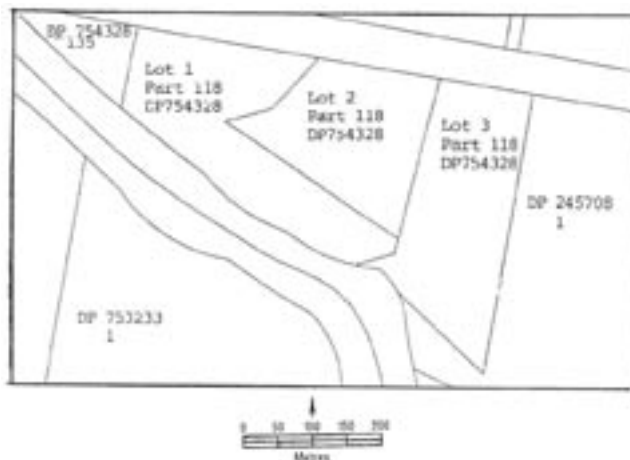

GRAFTON OFFICE**76 Victoria Street (Locked Bag 10), Grafton, NSW 2460****Phone: (02) 6640 2000 Fax: (02) 6640 2035****ADDITION TO RESERVED CROWN LAND**

PURSUANT to section 88 of the Crown Lands Act 1989, the Crown Land specified in Column 1 of the Schedule hereunder, is added to the reserved land specified opposite thereto in Column 2 of the Schedule.

TONY KELLY, M.L.C.,
Minister Assisting the Minister for
Natural Resources (Lands)

SCHEDULE**COLUMN 1**

Land District: Casino.
Local Government Area: Kyogle
Shire Council.
Locality: Toonumbar.
Lot Part 44, DP No. 820011,
Parish Toonumbar,
County Rous.
Area: 31.89 hectares as show
hatched in the diagram below.
File No.: GF86 R 44/1.

COLUMN 2

Reserve No.: 87153.
Public Purpose: Public
recreation.
Notified: 24 April 1969.
Lot Part 44, DP No. 820011,
Parish Toonumbar,
County Rous.
New Area: 32.7 hectares.

Note: Part Reserve 46975 for travelling stock and camping, notified 6 September 1911, and the whole of Reserve 93400, for future public requirements, notified 15 August 1980, is hereby revoked by this notification.

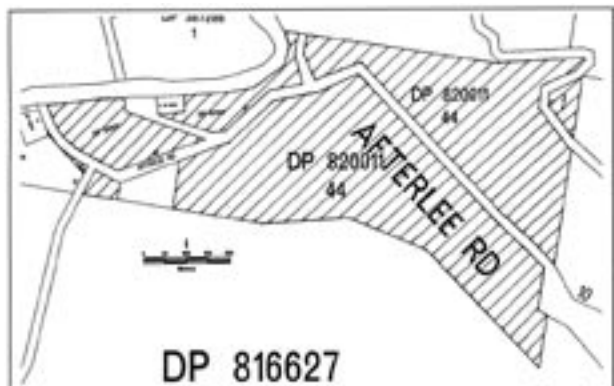
**APPOINTMENT OF TRUST BOARD MEMBERS**

PURSUANT to section 93 of the Crown Lands Act 1989, the persons whose names are specified in Column 1 of the Schedule hereunder are appointed, for the terms of office specified thereunder, as members of the trust board for the reserve trust specified opposite thereto in Column 2, which has been established and appointed as trustee of the reserve referred to opposite thereto in Column 3 of the Schedule.

TONY KELLY, M.L.C.,
Minister Assisting the Minister for
Natural Resources (Lands)

SCHEDULE**COLUMN 1**

Geraldine Patricia
MELIA-DAVIES
(re-appointment),
Brian Bertram
PHILLIPS
(new member),
Catherine Ann
LOWERY
(new member).

COLUMN 2

Whiporie Public
Recreation Reserve
Trust.

COLUMN 3

Dedication No.: 540093.
Public Purpose: Public
recreation.
Notified: 3 September 1913.
File No.: GF81 R 33.

Term of Office

For a term commencing the date of this notice and expiring
29 January 2009.

GRIFFITH OFFICE
2nd Floor, Griffith City Plaza,
120–130 Banna Avenue (PO Box 1030), Griffith NSW 2680
Phone: (02) 6962 7522 Fax: (02) 6962 5670

NOTIFICATION OF CLOSING OF PUBLIC ROAD

IN pursuance of the provisions of the Roads Act 1993, the road hereunder described is closed and the land comprised therein ceases to be a public road and the rights of passage and access that previously existed in relation to the road are extinguished.

TONY KELLY, M.L.C.,
 Minister Assisting the Minister for
 Natural Resources (Lands)

Description

Land District – Narrandera;
Local Government Area – Narrandera.

Road being Lot 3, DP 1060441, Parish Uroly, County Boyd.

Note: On closing, the land within the former road remains vested in Narrandera Shire Council as operational land for the purposes of the Local Government Act 1993.

File No.: GH01 H 80.

Council Reference: R/0127.

HAY OFFICE

126 Lachlan Street (PO Box 182), Hay, NSW 2711
Phone: (02) 6993 1306 Fax: (02) 6993 1135

APPOINTMENT OF TRUST BOARD MEMBERS

PURSUANT to section 93 of the Crown Lands Act 1989, the persons whose names are specified in Column 1 of the Schedule hereunder are appointed, for the terms of office specified thereunder, as members of the trust board for the reserve trust specified opposite thereto in Column 2, which has been established and appointed as trustee of the reserve referred to opposite thereto in Column 3 of the Schedule.

TONY KELLY, M.L.C.,
 Minister Assisting the Minister for
 Natural Resources (Lands)

SCHEDULE

COLUMN 1	COLUMN 2	COLUMN 3
Gloria Ann FOWLER (new member), Trevor George MUIRHEAD (new member).	Merriwagga Racecourse and Recreation Reserve Trust.	Reserve No.: 88922. Public Purpose: Public recreation. Notified: 18 May 1973.
		Reserve No.: 57488. Public Purpose: Public recreation. Notified: 3 October 1924. File No.: HY81 R 118.

Term of Office

For a term commencing the date of this notice and expiring 30 June 2005.

NOWRA OFFICE**5 O'Keefe Avenue (PO Box 309), Nowra, NSW 2541****Phone: (02) 4428 6900 Fax: (02) 4428 6988****REMOVAL FROM OFFICE OF CORPORATION
MANAGER OF RESERVE TRUST**

PURSUANT to section 96(2) of the Crown Lands Act 1989, the corporation specified in Schedule 1 hereunder is removed from the office of manager of the reserve trust specified in Schedule 2, which is trustee of the reserve referred to in Schedule 3.

TONY KELLY, M.L.C.,
Minister Assisting the Minister for
Natural Resources (Lands)

SCHEDULE 1

RSL Custodian Pty Ltd.

SCHEDULE 2

Ulladulla War Memorial Trust.

SCHEDULE 3

Dedication No.: 580100.

Public Purpose: War Memorial.

Notified: 2 September 1938.

File No.: NA80 R 429/1.

Effective Date: 29 January 2004.

Note: RSL Custodian Pty Ltd requested that a community trust board be appointed in its place to manage the affairs of the Ulladulla War Memorial Trust – see notification of community trust board members this day.

APPOINTMENT OF TRUST BOARD MEMBERS

PURSUANT to section 93 of the Crown Lands Act 1989, the persons whose names are specified in Column 1 of the Schedule hereunder are appointed, for the terms of office specified thereunder, as members of the trust board for the reserve trust specified opposite thereto in Column 2, which has been established and appointed as trustee of the reserve referred to opposite thereto in Column 3 of the Schedule.

TONY KELLY, M.L.C.,
Minister Assisting the Minister for
Natural Resources (Lands)

SCHEDULE**COLUMN 1**Rick Francis
COSTER
(new member),
Gordon BruceHORWOOD
(new member),
Edith JeanMILLIKIN
(new member),
Douglas HiltonSINCLAIR
(new member),
Everard HerbertMANNING
(new member),
Leonard KENYON(new member),
Alan LIMN (new member).**COLUMN 2**Ulladulla War
Memorial Trust.**COLUMN 3**Dedication No.: 580100.
Public Purpose: War Memorial.
Notified: 2 September 1938.
File No.: NA80 R 429.

Term of Office

For a term commencing this day and expiring 29 January 2009.

ROADS ACT 1993**ORDER**

Transfer of a Crown Road to a Council

IN pursuance of the provisions of Section 151, Roads Act 1993, the Crown road specified in Schedule 1 is transferred to the Roads Authority specified in Schedule 2, hereunder, as from the date of publication of this notice and as from that date the road specified in Schedule 1 cease to be a Crown road.

TONY KELLY, M.L.C.,
Minister Assisting the Minister for
Natural Resources (Lands)

Description

SCHEDULE 1

*Land District – Nowra; Council – Shoalhaven City;
Parish – Nowra; County – St. Vincent.*

THE Crown public roads known as (1) Browns Road, (2) Quinns Lane and (3) part of Old Southern Road at South Nowra. (1) Browns Road from the Princes Highway at the most northern corner of Lot 1, DP 718150 in an easterly direction for about 1.5 kilometres to the Currumbene State Forest at the north eastern corner of Lot 289, DP 755952. (2) Quinns Lane from the Princes Highway at the south western corner of Lot 1, DP 795730 in an easterly direction for about 1.3 kilometres to the Currumbene State Forest at the north eastern corner of Lot 2, DP 791418. (3) part of Old Southern Road from the most northern point of Lot 225, DP 755952 in a southerly direction for about 3.4 kilometres to the Princes Highway adjoining the eastern boundary of Lot 6, DP 533163. Crown Reference: NA03 H 235.

SCHEDULE 2

Roads Authority: Shoalhaven City Council.

Reference: 29219.

SYDNEY METROPOLITAN OFFICE
Level 12, Macquarie Tower, 10 Valentine Avenue, Parramatta 2150
(PO Box 3935), Parramatta, NSW 2124
Phone: (02) 9895 7657 Fax: (02) 9895 6227

ADDITION TO RESERVED CROWN LAND

PURSUANT to section 88 of the Crown Lands Act 1989, the Crown Land specified in Column 1 of the Schedule hereunder, is added to the reserved land specified thereto in Column 2 of the Schedule.

TONY KELLY, M.L.C.,
Minister Assisting the Minister for
Natural Resources (Lands).

SCHEDULE

COLUMN 1

Land District: Penrith.
Local Government Area: Blue
Mountains City Council.
Locality: Blaxland.
Lot: 376.
DP No.: 823999.
Parish: Strathdon.
County: Cook.
Area: 5.154 hectares.
File No.: MN85 R 60/1.

COLUMN 2

Reserve No.: 75379.
Public Purpose: Rubbish depot
and sanitary purposes.
Notified: 10 October 1952.
Lots: 303 and 323.
DP No.: 751662.
Parish: Strathdon.
County: Cook.
New Area: 35.868 hectares.

WAGGA WAGGA REGIONAL OFFICE
Corner Johnston and Tarcutta Streets (PO Box 60), Wagga Wagga, NSW 2650
Phone: (02) 6937 2700 Fax: (02) 6921 1851

**APPOINTMENT OF CORPORATION TO
MANAGE RESERVE TRUST**

PURSUANT to section 95 of the Crown Lands Act 1989, the corporation specified in Column 1 of the Schedule hereunder, is appointed to manage the affairs of the reserve trust specified opposite thereto in Column 2, which is trustee of the reserve referred to in Column 3 of the Schedule.

TONY KELLY, M.L.C.,
Minister Assisting the Minister for
Natural Resources (Lands)

SCHEDULE

COLUMN 1	COLUMN 2	COLUMN 3
Kalianna Enterprises Inc.	Kalianna Reserve Trust.	Reserve No.: 86442. Public Purpose: School for sub-normal children. Notified: 20 October 1967. File No.: WA83 R 14/1.

For a term commencing this day

APPOINTMENT OF TRUST BOARD MEMBERS

PURSUANT to section 93 of the Crown Lands Act 1989, the persons whose names are specified in Column 1 of the Schedules hereunder are appointed, for the terms of office specified thereunder, as members of the trust board for the reserve trust specified opposite thereto in Column 2, which has been established and appointed as trustee of the reserve referred to opposite thereto in Column 3 of the Schedules.

TONY KELLY, M.L.C.,
Minister Assisting the Minister for
Natural Resources (Lands)

SCHEDULE 1

COLUMN 1	COLUMN 2	COLUMN 3
George Ernest DENYER (re-appointment), Lindsay Arthur TIDD (re-appointment), Maxwell Philip Alfred GOULTER (re-appointment), Geoffrey Robert TIDD (re-appointment).	Mandamah West Recreation Reserve and Public Hall Trust.	Reserve No.: 50051. Public Purpose: Public hall. Notified: 8 July 1914.
		Reserve No.: 50053. Public Purpose: Public recreation. Notified: 8 July 1914. File No.: WA82 R 97.

Term of Office

For a term commencing the date of this notice and expiring 31 December 2008.

SCHEDULE 2

COLUMN 1	COLUMN 2	COLUMN 3
Bronwyn Elizabeth SMITHWICK (new member), Thomas Richard GREENHILL (re-appointment), Stuart Donald GREENHILL (new member).	Talmalmo Recreation Reserve Trust.	Reserve No.: 81786. Public Purpose: Public recreation. Notified: 17 July 1959. File No.: WA82 R 12.

Term of Office

For a term commencing the date of this notice and expiring 30 May 2007.

SCHEDULE 3

COLUMN 1	COLUMN 2	COLUMN 3
Marie Lorraine PATON (new member), David John McKIMMIE (re-appointment), Donal Henry PATON (re-appointment).	Welaregang Recreation Reserve Trust.	Reserve No.: 65128. Public Purpose: Public recreation. Notified: 15 March 1935.
		Reserve No.: 71561. Public Purpose: Public recreation (addition). Notified: 29 June 1945. File No.: WA79 R 117.

Term of Office

For a term commencing the date of this notice and expiring 30 November 2008.

SCHEDULE 4

COLUMN 1	COLUMN 2	COLUMN 3
Kerry James BLAKE (re-appointment), Alan Raymond KENDAL (re-appointment), Rosemary Elisabeth JERVOIS (new member), Rex Vernon BLAKE (re-appointment), John Richard JERVOIS (re-appointment).	Courabyra Public Hall Trust.	Reserve No.: 65879. Public Purpose: Public hall. Notified: 13 March 1936. File No.: WA81 R 53.

Term of Office

For a term commencing the date of this notice and expiring 30 November 2008.

SCHEDULE 5

COLUMN 1	COLUMN 2	COLUMN 3
Peter STEAD (new member), Mark John NICHOLS (new member), Wayne Douglas WATSON (re-appointment).	Holbrook Recreation Ground Trust.	Reserve No.: 37798. Public Purpose: Public recreation. Notified: 11 June 1904. File No.: WA79 R 118.

Term of Office

For a term commencing the date of this notice and expiring
31 May 2007.

SCHEDULE 6

COLUMN 1	COLUMN 2	COLUMN 3
Michael John DYER (new member). Kaye Lorraine DYER (re-appointment). Lawrence Mervyn COCHRANE (re-appointment). Bernice Margaret LEAHY (re-appointment).	Yathella Recreation Reserve and Public Hall Trust.	Reserve No.: 89386. Public Purpose: Public recreation and public hall. Notified: 21 February 1975. File No.: WA81 R 115.

Term of Office

For a term commencing 1 February 2004 and expiring
31 January 2009.

Department of Mineral Resources

NOTICE is given that the following applications have been received:

ASSESSMENT LEASE APPLICATION

(C04-0043)

No. 31, CENTENNIAL HUNTER PTY LIMITED (ACN 101 509 111), area of about 7896 hectares, for coal, dated 20 January 2003. (Singleton Mining Division).

EXPLORATION LICENCE APPLICATIONS

(T04-0011)

No. 2275, G S BYRNES & SONS, area of 1 unit, for Group 2, dated 15 January 2004. (Broken Hill Mining Division).

(T04-0013)

No. 2276, TELMINEX NL (ACN 003 309 911), area of 99 units, for Group 1 and Group 6, dated 20 January 2004. (Inverell Mining Division).

(T04-0014)

No. 2277, MARK FREEMAN, area of 12 units, for Group 1, dated 21 January 2004. (Orange Mining Division).

(T04-0015)

No. 2278, ELEPHANT MINES PTY LIMITED (ACN 097 799 025), area of 4 units, for Group 1, dated 22 January 2004. (Sydney Mining Division).

(T04-0016)

No. 2279, ELEPHANT MINES PTY LIMITED (ACN 097 799 025), area of 7 units, for Group 1, dated 22 January 2004. (Sydney Mining Division).

KERRY HICKEY, M.P.,
Minister for Mineral Resources

NOTICE is given that the following applications have been granted:

EXPLORATION LICENCE APPLICATION

(T03-0846)

No. 2169, now Exploration Licence No. 6176, TELMINEX NL (ACN 003 309 911), Counties of Dowling and Gipps, Map Sheet (8230), area of 5 units, for Group 1, dated 7 January 2004, for a term until 6 January 2006.

MINING LEASE APPLICATION

(C03-0265)

Orange No. 231, now Mining Lease No. 1545 (Act 1992), CHARBON COAL PTY LIMITED (ACN 064 237 118) and SK AUSTRALIA PTY LIMITED (ACN 003 964 225), Parish of Clandulla, County of Roxburgh, Map Sheet (8832-2-S), area of 204.7 hectares, to mine for coal, dated 9 January 2004, for a term until 8 January 2025.

PETROLEUM APPLICATION

(C03-0402)

No. 5, now Petroleum Production Lease No. 3, NARRABRI POWER LIMITED (ACN 104 570 943), area of 2640 hectares, for petroleum, dated 15 December 2003, for a term until 14 December 2024. For exact location details refer to the Department's NSW State Map of Petroleum Titles. As a result of the grant of this title, Petroleum Exploration Licence No. 238 (Act 1955) has partly ceased to have effect.

KERRY HICKEY, M.P.,
Minister for Mineral Resources

NOTICE is given that the following applications have been withdrawn:

EXPLORATION LICENCE APPLICATIONS

(T03-0988)

No. 2246, BARRICK GOLD OF AUSTRALIA LIMITED (ACN 008 143 137), County of Cowper, Map Sheets (8036, 8037, 8136 and 8137). Withdrawal took effect on 19 January 2004.

(T04-0004)

No. 2268, TELMINEX NL (ACN 003 309 911), County of Clarke and County of Hardinge, Map Sheets (9137, 9138 and 9337). Withdrawal took effect on 20 January 2004.

KERRY HICKEY, M.P.,
Minister for Mineral Resources

NOTICE is given that the following applications for renewal have been received:

(L98-0254)

Exploration Licence No. 5560, GEODYNAMICS LIMITED (ACN 095 006 090), area of 50 units. Application for renewal received 21 January 2004.

(T99-0135)

Exploration Licence No. 5692, DOWMILL PTY LIMITED (ACN 002 329 615), NOSEBI MINING & MANAGEMENT PTY LTD (ACN 002 516 109) and UNIVERSAL RESOURCES LIMITED (ACN 090 468 018), area of 33 units. Application for renewal received 20 January 2004.

(T99-0159)

Exploration Licence No. 5697, HEEMSKIRK RESOURCES PTY LIMITED (ACN 085 881 232), area of 24 units. Application for renewal received 22 January 2004.

(T01-0189)

Exploration Licence No. 5923, CENTRAL WEST GOLD NL (ACN 003 178 591) and MOUNT CONQUEROR MINERALS NL (ACN 003 312 721), area of 7 units. Application for renewal received 22 January 2004.

KERRY HICKEY, M.P.,
Minister for Mineral Resources

RENEWAL OF CERTAIN AUTHORITIES

NOTICE is given that the following authorities have been renewed:

(T00-0114)

Exploration Licence No. 5885, DAVID CHARLES PRENDERGAST, Counties of Rankin and Werunda, Map Sheet (7734), area of 4 units, for a further term until 19 August 2005. Renewal effective on and from 17 November 2003.

KERRY HICKEY, M.P.,
Minister for Mineral Resources

EXPIRIES

Mineral Claim No. 230 (Act 1992), MARBLE AGGREGATES HOLDINGS PTY LTD (ACN 060 680 284), Parish of Lowry, County of Bathurst. This title expired on 24 January 2004.

Mineral Claim No. 231 (Act 1992), MARBLE AGGREGATES HOLDINGS PTY LTD (ACN 060 680 284), Parish of Lowry, County of Bathurst. This title expired on 24 January 2004.

KERRY HICKEY, M.P.,
Minister for Mineral Resources

TRANSFERS

(T04-0282)

Exploration Licence No. 5777, formerly held by MARLBOROUGH RESOURCES NL (ACN 010 126 708) has been transferred to REPUBLIC GOLD LIMITED (ACN 106 399 311). The transfer was registered on 20 January 2004.

KERRY HICKEY, M.P.,
Minister for Mineral Resources

Roads and Traffic Authority

ROADS ACT 1993

Notice of Dedication of Land as Public Road at Lower
Tarcutta and Yarragundry in the Wagga Wagga City
Council area

THE Roads and Traffic Authority of New South Wales,
by its delegate, dedicates the land described in the
schedule below as public road under section 10 of the
Roads Act 1993.

K J Durie
Manager, Compulsory Acquisition & Road Dedication
Roads and Traffic Authority of New South Wales

SCHEDULE

All those pieces or parcels of land situated in the Wagga
Wagga City Council area, Parishes of Tarcutta and
Uranquinty and Counties of Wynyard and Mitchell,
shown as:

Lots 2 to 5 inclusive Deposited Plan 573837; and

Lot 101 Deposited Plan 583658.

(RTA Papers: FPP 14/468.1121)

Other Notices

ASSOCIATIONS INCORPORATION ACT 1984

Transfer of Incorporation Pursuant to Section 48(4)(a)

TAKE NOTICE that the company "Kempsey Macleay Off Road Club Ltd" formerly registered under the provisions of the Corporations Act 2001, is now incorporated under the Associations Incorporation Act 1984 as "Kempsey Macleay Off Road Club Incorporated" effective 23 January 2004.

Dated: 27 January 2004.

LINDA FULLER,
Delegate of Commissioner,
Office of Fair Trading.

Proposed Name: Douglass Square.
Designation: Urban Place.
L.G.A.: Blue Mountains City Council.
Parish: Linden.
County: Cook.
L.P.I. Map: Katoomba.
1:100,000 Map: Katoomba 8930.
Reference: GNB 4968.

CHILDREN (PROTECTION AND PARENTAL RESPONSIBILITY) ACT 1997

Safer Community Compact – Order

I, the Honourable BOB DEBUS, Attorney General of the State of New South Wales, in pursuance of section 39(1) of the Children (Protection and Parental Responsibility) Act 1997, do, by this my Order, approve the Orange Crime Prevention Plan July 2003 – June 2006 as a Safer Community Compact for the purposes of Division 3 of Part 4 of that Act.

This Order takes effect on 2 February 2004 remaining in force until 1 February 2007.

Signed at Sydney, this 21st day of January 2004.

BOB DEBUS, M.P.,
Attorney General

Proposed Name: Pritchard Park.
Designation: Reserve.
L.G.A.: Lismore City Council.
Parish: North Lismore.
County: Rous.
L.P.I. Map: Lismore.
1:100,000 Map: Lismore 9540.
Reference: GNB 4970.

Proposed Name: Heritage Park.
Designation: Reserve.
L.G.A.: Lismore City Council.
Parish: Lismore.
County: Rous.
L.P.I. Map: Lismore.
1:100,000 Map: Lismore 9540.
Reference: GNB 4970.

Proposed Name: The Riviera.
Designation: Reserve.
L.G.A.: Lismore City Council.
Parish: Lismore.
County: Rous.
L.P.I. Map: Lismore.
1:100,000 Map: Lismore 9540.
Reference: GNB 4970.

Proposed Name: The Stops.
Designation: Reserve.
L.G.A.: Lismore City Council.
Parish: North Lismore.
County: Rous.
L.P.I. Map: Lismore.
1:100,000 Map: Lismore 9540.
Reference: GNB 4970.

Proposed Name: The Ramp.
Designation: Reserve.
L.G.A.: Lismore City Council.
Parish: Lismore.
County: Rous.
L.P.I. Map: Lismore.
1:100,000 Map: Lismore 9540.
Reference: GNB 4970.

GEOGRAPHICAL NAMES ACT 1966

Notice of Definition of a New Suburb in Holroyd City

PURSUANT to the provisions of section 10 of the Geographical Names Act 1966, the Geographical Names Board has this day assigned the name and boundaries of a new suburb within Holroyd City, Pemulwuy, as shown on map GNB3709/B.

Names and boundaries for suburbs in Holroyd City are shown on plot GNB3709.

WARWICK WATKINS,
Chairperson.

Geographical Names Board,
PO Box 143, Bathurst, NSW 2795.

GEOGRAPHICAL NAMES ACT 1966

PURSUANT to the provisions of section 8 of the Geographical Names Act 1966, the Geographical Names Board hereby notifies that it proposes to assign the names listed hereunder as geographical names.

Any person wishing to make comment upon these proposals may within one (1) month of the date of this notice, write to the Secretary of the Board with that comment.

Proposed Name: Upperby Reserve.
 Designation: Reserve.
 L.G.A.: Blacktown City Council.
 Parish: Gidley.
 County: Cumberland.
 L.P.I. Map: Riverstone.
 1:100,000 Map: Penrith 9030.
 Reference: GNB 4971.

Proposed Name: Alexander Egoroff Reserve.
 Designation: Reserve.
 L.G.A.: Blacktown City Council.
 Parish: Rooty Hill.
 County: Cumberland.
 L.P.I. Map: Riverstone.
 1:100,000 Map: Penrith 9030.
 Reference: GNB 4972.

Proposed Name: James Watts Reserve.
 Designation: Reserve.
 L.G.A.: Blacktown City Council.
 Parish: Prospect.
 County: Cumberland.
 L.P.I. Map: Prospect.
 1:100,000 Map: Penrith 9030.
 Reference: GNB 4979.

Proposed Name: Pat Thompson Park.
 Designation: Reserve.
 L.G.A.: Woollahra Municipal Council.
 Parish: Alexandria.
 County: Cumberland.
 L.P.I. Map: Botany Bay.
 1:100,000 Map: Sydney 9130.
 Reference: GNB 4975.

Proposed Name: Garavel Playground.
 Designation: Reserve.
 L.G.A.: Marrickville Council.
 Parish: Petersham.
 County: Cumberland.
 L.P.I. Map: Botany Bay.
 1:100,000 Map: Sydney 9130.
 Reference: GNB 4976.

Proposed Name: Yowie Bay Old Baths Reserve.
 Designation: Reserve.
 L.G.A.: Sutherland Shire Council.
 Parish: Sutherland.
 County: Cumberland.
 L.P.I. Map: Port Hacking.
 1:100,000 Map: Port Hacking 9129.
 Reference: GNB 4949.

Proposed Name: Everinghams Crossing.
 Designation: Ford.
 L.G.A.: Hastings Council.
 Parish: Johns River.
 County: Macquarie.
 L.P.I. Map: Lorne.
 1:100,000 Map: Camden Haven 9434.
 Reference: GNB 4980.

Proposed Name: Doring Park.
 Designation: Reserve.
 L.G.A.: Tamworth City Council.
 Parish: Calala.
 County: Parry.
 L.P.I. Map: Tamworth.
 1:100,000 Map: Tamworth 9035.
 Reference: GNB 4981.

The position and the extent for these features are recorded and shown within the Geographical Names Register of New South Wales. This information can be accessed through the Board's Web Site at www.gnb.nsw.gov.au

WARWICK WATKINS,
 Chairperson.

Geographical Names Board,
 PO Box 143, Bathurst, NSW 2795.

GEOGRAPHICAL NAMES ACT 1966

PURSUANT to the provisions of section 14 and section 8 of the Geographical Names Act 1966, the Geographical Names Board hereby notifies that it proposes to discontinue the name Darling Mills State Forest and assign the geographical name Bidjigal Reserve to an area of land formally known as Excelsior Park and Darling Mills State Forest.

Any person objecting to this proposal may within one (1) month of the date of this notice give to the Secretary of the Board, notice in writing of that objection, setting out the grounds of the objection.

The position and extent of this feature is recorded and shown within the Geographical Names Register of New South Wales. This information can be accessed through the Board's web site at www.gnb.nsw.gov.au.

WARWICK WATKINS,
 Chairman.

Geographical Names Board,
 PO Box 143, Bathurst, NSW 2795.

LOCAL GOVERNMENT ACT 1993

Alstonville/Wollongbar Water Supply Augmentation Stage 2

THE Minister for Land and Water Conservation of the State of New South Wales, declares that all right, title and interest in the works described in the Schedule hereto, which were constructed for the purpose of Alstonville / Wollongbar Water Supply Augmentation Stage 2 Scheme are vested in Rous County Council.

FRANK ERNEST SARTOR, M. P.
 Minister for Energy and Utilities

SCHEDULE

Works of water supply known as Alstonville/Wollongbar Water Supply Augmentation Stage 2 comprising trunk mains, upgrade of pumping station, telemetry and all works incidental thereto.

DoC Reference W596

LOCAL GOVERNMENT ACT 1993

Tottenham Water Supply Augmentation

THE Minister for Land and Water Conservation of the State of New South Wales, declares that all right, title and interest in the works described in the Schedule hereto, which were constructed for the purpose of Tottenham Water Supply Augmentation Scheme are vested in Lachlan Shire Council.

FRANK ERNEST SARTOR, M. P.
Minister for Energy and Utilities

SCHEDULE

Works of water supply for the town of Tottenham comprising water treatment plant, roofing of existing reservoir, pipeline, telemetry system and all works incidental thereto.

DoC Reference W520

LOCAL GOVERNMENT ACT 1993

Bathurst Sewerage Augmentation and Villages Stage 1

THE Minister for Land and Water Conservation of the State of New South Wales, declares that all right, title and interest in the works described in the Schedule hereto, which were constructed for the purpose of Bathurst Sewerage Augmentation and Villages Stage 1 Scheme are vested in Bathurst City Council.

FRANK ERNEST SARTOR, M. P.
Minister for Energy and Utilities

SCHEDULE

Works of sewerage for the City of Bathurst comprising remedial works of the treatment plant, aeration equipment, sludge handling and de-watering system and all works incidental thereto.

DoC Reference S781

LOCAL GOVERNMENT ACT 1993

Tamworth Water Supply – Dungowan Dam Pipeline and Aeration

THE Minister for Land and Water Conservation of the State of New South Wales, declares that all right, title and interest in the works described in the Schedule hereto, which were constructed for the purpose of Tamworth Water Supply – Dungowan Dam Pipeline and Aeration Scheme are vested in Tamworth City Council.

FRANK ERNEST SARTOR, M. P.
Minister for Energy and Utilities

SCHEDULE

Works of water supply for the City of Tamworth comprising a destratification system for Dungowan Dam and all works incidental thereto.

DoC Reference W642

LOCAL GOVERNMENT ACT 1993

Bathurst Sewerage Augmentation Stage 2

THE Minister for Land and Water Conservation of the State of New South Wales, declares that all right, title and interest in the works described in the Schedule hereto, which were constructed for the purpose of Bathurst Sewerage Augmentation Stage 2 Scheme are vested in Bathurst City Council.

FRANK ERNEST SARTOR, M. P.
Minister for Energy and Utilities

SCHEDULE

Works of sewerage for the City of Bathurst comprising upgrading of treatment works and increase of biosolids treatment and handling facilities and all works incidental thereto.

DoC Reference S960

LOCAL GOVERNMENT ACT 1993

Dubbo Water Supply Augmentation

THE Minister for Land and Water Conservation of the State of New South Wales, declares that all right, title and interest in the works described in the Schedule hereto, which were constructed for the purpose of Dubbo Water Supply Augmentation Scheme are vested in Dubbo City Council.

FRANK ERNEST SARTOR, M. P.
Minister for Energy and Utilities

SCHEDULE

Works of water supply for the City of Dubbo comprising upgrading of existing water treatment plant including clear water and booster pumps, chlorine detention tank, dosing equipment, PAC dosing and automation of the water treatment plant and all works incidental thereto.

DoC Reference W567

LOCAL GOVERNMENT ACT 1993

Finley Water Supply

THE Minister for Land and Water Conservation of the State of New South Wales, declares that all right, title and interest in the works described in the Schedule hereto, which were constructed for the purpose of Finley Water Supply Scheme are vested in Berrigan Shire Council.

FRANK ERNEST SARTOR, M. P.
Minister for Energy and Utilities

SCHEDULE

Works of water supply for the town of Finley comprising augmentation of the raw water reticulation system and all works incidental thereto.

DoC Reference W755

LOCAL GOVERNMENT ACT 1993

Kootingal / Moonbi Water Supply Augmentation

THE Minister for Land and Water Conservation of the State of New South Wales, declares that all right, title and interest in the works described in the Schedule hereto, which were constructed for the purpose of Kootingal / Moonbi Water Supply Augmentation Scheme are vested in Parry Shire Council.

FRANK ERNEST SARTOR, M. P.
Minister for Energy and Utilities

SCHEDULE

Works of water supply for the town of Kootingal comprising trunk main from Tamworth to Kootingal including one new booster pump station and all works incidental thereto.

DoC Reference W615

LOCAL GOVERNMENT ACT 1993

Perthville Sewerage

THE Minister for Land and Water Conservation of the State of New South Wales, declares that all right, title and interest in the works described in the Schedule hereto, which were constructed for the purpose of Perthville Sewerage Scheme are vested in Bathurst City Council.

FRANK ERNEST SARTOR, M. P.
Minister for Energy and Utilities

SCHEDULE

Works of sewerage for the town of Perthville comprising reticulation, rising and gravity mains, pumping stations, soil deodorisation system at Bathurst, connection to Bathurst reticulation and all works incidental thereto.

DoC Reference S784

LOCAL GOVERNMENT ACT 1993

Perthville Water Supply

THE Minister for Land and Water Conservation of the State of New South Wales, declares that all right, title and interest in the works described in the Schedule hereto, which were constructed for the purpose of Perthville Water Supply Scheme are vested in Bathurst City Council.

FRANK ERNEST SARTOR, M. P.
Minister for Energy and Utilities

SCHEDULE

Works of water supply for the town of Perthville comprising service reservoir, trunkmain, reticulation, meters and connections, telemetry and all works incidental thereto.

DoC Reference W354

LOCAL GOVERNMENT ACT 1993

Coffs Harbour Northern Areas Sewerage – S777

Vesting of Land in Coffs Harbour City Council

THE Minister for Energy and Utilities of the State of New South Wales, declares that the land described in the Schedule hereto, which was acquired for the purpose of the Coffs Harbour Northern Areas Sewerage – S777 Scheme is vested in Coffs Harbour City Council.

FRANK ERNEST SARTOR, M. P.
Minister for Energy and Utilities

SCHEDULE

Land: Lot 123 in Deposited Plan 1052566.

DoC Reference 223

NATIONAL PARKS AND WILDLIFE ACT 1974

PROCLAMATION

I, Professor MARIE BASHIR, A.C., Governor of the State of New South Wales, with the advice of the Executive Council and in pursuance of the powers vested in me under section 68 of the National Parks and Wildlife Act 1974, with the consent of every owner and occupier do, on the recommendation of the Director-General of the Department of Environment and Conservation, by this my Proclamation declare the lands described hereunder to be a wildlife refuge for the purposes of the abovementioned Act.

To be known as “Third Crossing Wildlife Refuge”.

Signed and sealed at Sydney, this 14th day of January 2004.

MARIE BASHIR,
Governor.

By Her Excellency’s Command,

BOB DEBUS, M.P.,
Minister for the Environment

GOD SAVE THE QUEEN!

Description

Land District – Orange; L.G.A. – Cabonne.

Counties Bathurst and Wellington, Parishes Clinton and March, 56.42 hectares, being Lot 12, DP 756890 and Lots 68 and 74, DP 750372. NPWS 03/12155.

NATIONAL PARKS AND WILDLIFE ACT 1974

PROCLAMATION

I, Professor MARIE BASHIR, A.C., Governor of the State of New South Wales, with the advice of the Executive Council and in pursuance of the powers vested in me under section 68 of the National Parks and Wildlife Act 1974, with the consent of every owner and occupier do, on the recommendation of the Director-General of the Department of Environment and Conservation, by this my Proclamation declare the lands

described hereunder to be a wildlife refuge for the purposes of the abovementioned Act.

To be known as "Willow Vale Wildlife Refuge".

Signed and sealed at Sydney, this 14th day of January 2004.

MARIE BASHIR,
Governor.

By Her Excellency's Command,

BOB DEBUS, M.P.,
Minister for the Environment

GOD SAVE THE QUEEN!

—————
Description

Land District – Orange; L.G.A. – Cabonne.

County Bathurst, Parish Clinton, 51.14 hectares, being Lots 76, 83, 84, 92 and 117, DP 750372. NPWS 03/11285.

ERRATUM

THE Order under the Workers Compensation Act 1987 which was published on page 206 of the *Government Gazette* No. 12 on 16 January 2004 had an error in clause 1. That version cited the year in the Order's name as 2003 rather than 2004. The correct version of the Order follows:

WORKERS COMPENSATION (DOMESTIC ASSISTANCE) ORDER 2004

under the

WORKERS COMPENSATION ACT 1987

I, JON BLACKWELL, Chief Executive Officer of the WorkCover Authority of New South Wales, pursuant to section 61 (2) of the Workers Compensation Act 1987, make the following Order.

Dated this 12th day of January 2004.

JOHN WATSON
Acting Chief Executive Officer
WorkCover Authority

Explanatory Note

Section 61 (2) of the Workers Compensation Act 1987 provides that the maximum amount for which an employer is liable for any particular medical or related treatment is not to exceed the sum fixed by the WorkCover Authority in respect of that treatment by order published in the Gazette. Paragraph (f1) of the definition of "medical or related treatment" in section 59 of that Act includes domestic assistance services.

This Order sets out the maximum amount for which an employer may be liable for the provision of domestic assistance services provided gratuitously and domestic assistance services for which an injured worker has paid or is liable to pay.

1. Name of Order

This Order is the Workers Compensation (Domestic Assistance) Order 2004 No. 1.

2. Explanatory note

The explanatory note does not form part of this Order.

3. Commencement

This Order commences on the date of its publication in the Gazette.

4. Application of Order

This Order applies to domestic assistance services provided on or after the commencement of this Order.

5. Definitions

gratuitous domestic assistance has the same meaning as it has in section 60AA (6) of the Act.

Home Care Service of New South Wales means the Home Care Service of New South Wales constituted by the Home Care Service Act 1988.

the Act means the Workers Compensation Act 1987.

6. Maximum amount payable for domestic assistance services for which worker is liable to pay

(1) The maximum fee amount for which an employer is liable under the Act for domestic assistance services for which an injured worker has paid or is liable to pay is the rate payable by government and corporate clients in respect of domestic assistance services provided by the Home Care Service of New South Wales, as published from time to time on the Internet site of the Home Care Service of New South Wales.

(2) Rates published by the Home Care Service of New South Wales in respect of personal care, overnight care or live-in care have no effect for the purposes of this Order.

7. Maximum amount payable for gratuitous domestic assistance

(1) The maximum hourly fee amount for which an employer is liable under the Act for gratuitous domestic assistance services is the hourly rate calculated by dividing by 35 the amount estimated by the Australian Bureau of Statistics as the average weekly total earnings (full time adult ordinary time) of all employees in New South Wales from time to time.

(2) The maximum number of hours per week for which the hourly rate referred to in subclause (2) is payable is 35.

DISTRICT COURT OF NEW SOUTH WALES

Practice Note No. 66

Coal Miners' Workers Compensation List

THIS Practice Note will apply from 21 January 2004 to all proceedings in the Coal Miners' Workers Compensation List.

Schedule 6, Part 18, clause 3 (1) of the Workers Compensation Act 1987 provides that subject to that clause the 2001 amendments do not apply to coal miners and that that Act and the Workplace Injury Management and Workers Compensation Act 1998 (and the regulations made thereunder) apply to coal miners' claims as if the 2001 amendments had not been enacted.

Furthermore, Schedule 1.15, cl 4, of the Compensation Court Repeal Act 2002 amends the 1998 Act so that from 1

January 2004, the District Court has exclusive jurisdiction to examine hear and determine all coal miner matters (except matters arising under Part 5 of the 1987 Act – common law matters)

Hence from 1 January 2004 a Coal Miners' Workers Compensation List will be kept in Sydney and Newcastle and will operate in accordance with Part 24D of the Rules.

A party seeking to lodge a statement of claim must lodge with the statement a certificate of compliance certifying that the commencement of such proceedings is not contrary to the provisions of section 101,102 or 103 of the 1998 Act as the case may be.

The Registrars at Sydney and Newcastle shall refer all such statements of claim to the District Court Conciliator for conciliation.

The conciliator will hold a face-to-face conciliation conference approximately 3 months after the filing of the statement of claim.

Where a matter does not resolve at conciliation the Conciliator will return the matter to the list for hearing. Coal Miners Workers Compensation Lists will be kept for Newcastle, Wollongong and Katoomba.

Where the matter is in the Newcastle list parties will receive a preliminary notice of hearing 12 weeks prior to the hearing date. Where conciliation occurs less than 12 weeks prior to hearing the conciliator will provide the parties with notice of the hearing date at the conclusion of conciliation. The Court will issue a confirmation of hearing notice 4 weeks prior to the hearing.

Where the matter is to be listed in Wollongong or Katoomba there will be a call over 6 weeks prior to the circuit. The call over will be held in Sydney. Dates for hearing will be allocated at the call over. The Court will issue a confirmation of hearing notice four weeks prior to the hearing.

The Hon. Justice R. O. BLANCH,
Chief Judge

21 January 2004

DISTRICT COURT RULES 1973

Forms

IN pursuance of Part 47, Rule 2 (2) of the District Court Rules 1973, I have approved the following forms for use in Court.

Dated 21 January 2004.

The Hon. Justice R. O. BLANCH,
Chief Judge of the District Court

Form 8a – Coal Miners' Workers Compensation List Statement of Claim.

Form 8b – Statement of Claim in respect of death of worker.

Form 8c – Statement of Claim – Miscellaneous Acts.

Form 8d – Statement of Claim in respect of application for termination, diminution or redemption.

Form 149 – Application for Medical Panel.

Form 150 – Certificate of Compliance.

Form 8a – Coal Miners' Workers Compensation List statement of claim

**IN THE DISTRICT COURT OF NEW SOUTH WALES
COAL MINERS' WORKERS COMPENSATION LIST**

STATEMENT OF CLAIM

(if amended statement of claim precede with first, second, etc as applicable and add matter number to heading)

by a worker seeking an original award/a review of an existing award in matter no:

(delete where inapplicable) under the Workers Compensation Act 1987.

Note: 1. If this is an amended claim, information that has been added or varied must be clearly identified by being italicised or underlined.

2. Claims seeking the review of an existing award must be accompanied by a copy of the award.

PLAINTIFF *(Injured Person's details - if the plaintiff is not the injured person, eg a tutor or guardian, details of both the plaintiff and the injured person are required)*

Given Names		Family Name	
Date of Birth		Sex	
Address			
Suburb		Postcode	

DEFENDANT *(Employer details)*

Name			
Address			
Suburb		Postcode	

DEFENDANT'S INSURER

Name		Claim No. (If Known)	
Address			
Suburb		Postcode	
Period of Insurance	<i>(if all of the relevant period state 'whole')</i>		

Repeat Insurer details for each insurer of the employer that is relevant to this application.

Then repeat Employer and Insurer details for each other employer involved, nominating the first mentioned employer as "First Defendant" and so on.

For uninsured periods state "uninsured" and the period of non-insurance. NB In uninsured cases, the WorkCover Authority must also be a defendant to the application -see below.

SECOND *(or as the case may be) DEFENDANT - use only for cases where the employer was uninsured for a relevant period.*

Where there is more than one defendant, the first should be described, as First Defendant and additional defendants should be numbered consecutively.

Name	WorkCover Authority of New South Wales		
Address	60-70 Elizabeth St		
Suburb	SYDNEY	Postcode	2000
Why is it believed that the employer was uninsured?			

PLAINTIFF'S SOLICITOR

Firm Name		Solicitor's Name	
DX		Reference	
Telephone		Fax	
Address for Service (If Not DX)			

Application is hereby made, particulars of which are set out herein, for the determination of the liability of, and amount of compensation payable by, the Defendant(s).

For applications seeking the review of an existing award, substitute - Application is hereby made, particulars of which are set out herein, with respect to the review of the weekly payment awarded in respect of the injury received by the Plaintiff.

Where orders are sought in Uninsured Liability & Indemnity Scheme matters, modify the above order to include an application for an award

- (a) Declaring that the First *(or as the case may be)* Defendant was not insured as required by the Act at the time of the Plaintiff's injury.
- (b) Ordering the Second *(or as the case may be)* Defendant to cause payment of the compensation and costs awarded against the First Defendant to be made out of the WorkCover Authority Fund established under section 34 of the Workplace Injury Management and Workers Compensation Act 1989.
- (c) Ordering the First *(or as the case may be)* Defendant to reimburse the WorkCover Authority such amount or amounts as may be paid out of such Fund in respect of the compensation and costs awarded against the First Defendant and in respect of the costs of the Second Defendant.

Where orders are to be sought under section 162, modify the above order to include an application-

For a declaration that the *(name of the defendant employer)* entered a contract with *(name of insurer)* in respect of the employer's liability under the Act to the worker and that the employer has died *(or, "is permanently resident outside the Commonwealth of Australia and its Territories" or, as the case may be)*.

(Solicitor for the) Plaintiff

NOTICE TO THE DEFENDANT(S)

You are liable to have an Award for the compensation claimed or other order made against you unless, within 28 days after service of this Statement of Claim upon you, you file a Defence in the Registry of the Court and you comply with the Rules of the Court in defending this matter.

Registrar of the Court

LISTING INFORMATION

A.	State the desired venue for the hearing: <i>(available are - Sydney, Newcastle, Wollongong or Katoomba)</i>	
B.	State day or days of week desired for the hearing: <i>(available are - any day, Monday, Tuesday, Wednesday, Thursday or Friday)</i>	
C.	State whether the application involves the following: <i>(delete where inapplicable)</i>	
	<ul style="list-style-type: none"> ● sections 61, 62, 63 or 63A - increase in liability of employer for medical and related treatment, hospital, ambulance or occupational rehabilitation expenses. ● sections 76 or 77- increase in liability of employer for damage to artificial limbs, spectacles or damage to clothing. section 83 - manner of payment of compensation. section 85- payment to the WorkCover Authority for the benefit of beneficiaries. section 16, 1926 Act. section 66, 1987 Act section 67, 1987 Act.	

PARTICULARS

Where there is more than one defendant employer, the following particulars are to be on separate sheets for each defendant employer headed Schedule A, etc, with each schedule commencing with "Particulars of Application in relation to the First (or as the case may be) Defendant".

1.	<p>(a) Date of injury (if over a period of time, state the period as accurately as possible):</p> <p>(b) Place where the injury happened:</p> <p>(c) What work was being done at the time of injury:</p> <p>(d) How did the injury occur: (for review applications, state the grounds on which the increase is sought)</p>	<p>(a)</p> <p>(b)</p> <p>(c)</p> <p>(d)</p>
2.	<p>(a) Nature of injury:</p> <p>(b) Incapacity for work (state whether total, partial, or partial claimed as total and the periods for each): (omit (b) for review applications)</p>	<p>(a)</p> <p>(b)</p>
3.	<p>Particulars of compensation claimed:</p> <ul style="list-style-type: none"> ● Section 66 details must be in terms of the Table of Compensation for Permanent Injuries in the Workers Compensation Act 1987 or, if applicable, the Table to section 16 Workers Compensation Act 1926 ● For loss of hearing in both ears state the loss claimed monaurally and binaurally 	<p>(a) (i) \$_____ pw from ____/____/____ to ____/____/____ (or continuing) under section _____.</p> <p>(ii) s42 (1) - name of industrial award or agreement _____.</p> <p>(b) (i) s66 lump sum \$_____ in respect of _____.</p> <p>(ii) s66 _____ % loss of _____.</p> <p>(c) section 60 expenses.</p> <p>(d) section 67.</p> <p>(e) interest.</p> <p>(f) Other (specify) _____.</p>
4.	<p>(a) Date of notice of injury:</p> <p>(b) Date of notice of incapacity given:</p> <p>(c) Date of claim for compensation:</p> <p>(d) Reason for the omission of any notice: (leave blank for review applications)</p>	<p>(a)</p> <p>(b)</p> <p>(c)</p> <p>(d)</p>
5.	<p>(a) Was the plaintiff directly employed by the defendant employer?</p> <p>(b) If yes, nature of the plaintiff's employment at the time of injury:</p> <p>(c) If no, how is defendant alleged to be liable for compensation.</p> <p>(d) Nature of work undertaken by the plaintiff, if the defendant employer not the direct employer: (leave blank for review applications)</p>	<p>(a)</p> <p>(b)</p> <p>(c)</p> <p>(d)</p>
6.	<p>(a) Plaintiff's current weekly wage rate:</p> <p>(b) Plaintiff's average weekly earnings:</p> <p>(c) Plaintiff's actual weekly earnings during the periods claimed:</p>	<p>(a)</p> <p>(b)</p> <p>(c)</p>

7.	Payment, allowance or benefit received from the employer during the period of incapacity and the date on the payment ceased:	
8.	Where the injury is a disease contracted by a gradual process, the names and address of all other employers by whom the plaintiff was employed during the twelve months previous to date of incapacity in any employment to the nature of which the disease was due: <i>(leave blank for review applications)</i> <i>(for Boilermakers Deafness applications, state the name of all employers during the past 5 years and the periods of employment with each).</i>	
9.	Name, date of birth and relationship to plaintiff of each person alleged to be dependant upon the plaintiff and the extent of the allege dependency:	

Note: Further particulars may be appended.

Particulars must be given of any other facts alleged, failure to give which may take the defendant by surprise.

Form 8b - statement of claim in respect of death of worker

IN THE DISTRICT COURT OF NEW SOUTH WALES

COAL MINERS' WORKERS COMPENSATION LIST STATEMENT OF CLAIM

(if amended application precede with first, second, etc as applicable and add matter number to heading)
in respect of the death of a worker, seeking an original award under the Workers Compensation Act 1987

Note: If this is an amended application, information that has been added or varied must be clearly identified by being italicised or underlined.

DECEASED PERSON

Given Names		Family Name	
Date of Birth		Sex	
Address			
		Postcode	

DEFENDANT (*Employer details*)

Name			
Address			
		Postcode	

DEFENDANT'S INSURER

Name		Claim No. (if known)	
Address		Postcode	
Period of Insurance (<i>if all of the relevant period state "whole"</i>)			

*Repeat Insurer details for each insurer of the employer that is relevant to this application.
Then repeat Employer and Insurer details for each other employer involved, nominating the first mentioned employers as "First Defendant" and so on.
For uninsured periods state "uninsured" and the period of non-insurance. NB In uninsured cases, the WorkCover Authority must also be a defendant to the application - see below.*

SECOND (or as the case may be) **DEFENDANT** - use only for cases where the employer was uninsured for relevant period.

Where there is more than one defendant, the first should be described as First Defendant and additional defendants should be numbered consecutively.

Name	WorkCover Authority of New South Wales		
Address	60-70 Elizabeth Street		
	SYDNEY	Postcode	2000
Why is it believed that the employer was uninsured?			

THIRD (or as the case may be) **DEFENDANT** - use only where an additional defendant is required eg: where there is a person other than the plaintiff who claims to be or may be entitled to claim to be a dependant.

Given Names		Family Name	
Address			
		Postcode	
Reason for joining the defendant			

PLAINTIFF

Given Names		Family Name	
Address			
		Postcode	
Capacity of the plaintiff (eg dependant)			

PLAINTIFF'S SOLICITOR

Firm Name		Solicitor's Name	
DX		Reference	
Telephone		Fax	
Address for Service (if not DX)			

Application is hereby made, particulars of which are set out herein, for the determination of the liability of, and amount of compensation payable by, the Defendant(s).

Where orders are sought in Uninsured Liability & Indemnity Scheme matters, modify the above order to include and application for an award -

- (a) Declaring that the First (or as the case may be) Defendant was not insured as required by the Act at the time of the Plaintiff's injury.
- (b) Ordering the Second (or as the case may be) Defendant to cause payment of the compensation and costs awarded against the First Defendant to be made out of the WorkCover Authority Fund established under section 34 of the Workplace Injury Management and Workers Compensation Act 1989.
- (c) Ordering the First (or as the case may be) Defendant to reimburse the WorkCover Authority such amount or amounts as may be paid out of such Fund in respect of the compensation and costs awarded against the First Defendant and in respect of the costs of the Second Defendant

Where orders are to be sought under section 162, modify the above order to include an application -

For a declaration that the (name of the defendant employer) entered a contract with (name of insurer) in respect of the employer's liability under the Act to the worker and that the employer has died (or, "is permanently resident outside the Commonwealth of Australia and its Territories" or as the case may be).

(Solicitor for the) Plaintiff

NOTICE TO THE DEFENDANT(S)

You are liable to have an Award for the compensation claimed or other order made against you unless, within 28 days after service of the Statement of Claim upon you, you file a Defence in the Registry of the Court and you comply with the Rules of the Court in defending this claim.

Registrar of the Court

LISTING INFORMATION

A. State the desired venue for the hearing: <i>(available are – Sydney, Katoomba, Newcastle or Wollongong)</i>	
State day or days of the week desired for the hearing: <i>(available are - any day, Monday to Friday)</i>	
C. State whether the application involves the following: <i>(delete where in inapplicable)</i>	
<ul style="list-style-type: none"> • section 83 - manner of payment of compensation • section 85 - payment to the WorkCover Authority for the benefit of beneficiaries. 	

PARTICULARS

Where there is more than one defendant employer, the following particulars are to be on separate sheets for each defendant employer headed Schedule A, etc, with each schedule commencing with "Particulars of Application in relation to the First (or as the case may be) Defendant."

1.	(a) Date of injury <i>(if over a period of time, state the period as accurately as possible)</i> (b) Place where the injury happened: (c) What work was being done at the time of injury. (d) How did the injury occur:	(a) (b) (c) (d)
2.	Date and cause of death:	
3.	Particulars of compensation claimed:	(a) Lump sum: \$ _____ (b) \$_____ pw under section _____. (c) other <i>(specify)</i> _____. (d) interest.
4.	(a) Date of notice of injury: (b) Date of notice of incapacity given: (c) Date of claim for compensation: (d) Reason for the omission of any notice:	(a) (b) (c) (d)
5.	(a) Was the deceased directly employed by the defendant employer? (b) If yes, nature of the deceased's employment at the time of injury: (c) If no, how is defendant alleged to be liable for compensation: (d) Nature of work undertaken by the deceased, if the defendant employer was not the direct employer:	(a) (b) (c) (d)

6.	Deceased's average weekly earnings:	
7.	Where the death was due to a disease contracted by a gradual process, the names and address of all other employers by whom the deceased was employed during the twelve months previous to date of incapacity in any employment to the nature of which the disease was due:	
8.	Name, date of birth and relationship to deceased of each person alleged to be dependant upon the deceased and the extent of the alleged dependency:	

Note:

Further particulars may be appended

Particulars must be given of any other facts alleged, failure to give which may take the defendant by surprise

**IN THE DISTRICT COURT OF NEW SOUTH WALES
SPECIAL STATUTORY COMPENSATION LIST**

STATEMENT OF CLAIM

(if amended claim precede with first, second, etc as applicable and add matter number to heading)
by a fire fighter / worker / member of the Police Force / registered player / registered participant / enrolled participant

seeking an original award / a review of an existing award in matter no: _____
under the Workers Compensation (Bush Fire, Emergency and Rescue Services) Act 1987, Workers Compensation (Dust Diseases) Act 1942, Police Regulation (Superannuation) Act 1906, Police Act 1900, Sporting Injuries Insurance Act 1978 *(delete where inapplicable)*

- Note:*
1. *If this is an amended application, information that has been added or varied must be clearly identified by being italicised or underlined.*
 2. *Applications seeking the review of an existing award must be accompanied by a copy of the original award*

PLAINTIFF *(Injured Person's details - if the plaintiff is not the injured person, eg a tutor or guardian, details of both the plaintiff and the injured person are required)*

Given Names		Family Name	
Date of Birth		Sex	
Address			
Suburb		Postcode	

DEFENDANT

Name	WorkCover Authority of New South Wales / Sporting Injuries Committee / Workers Compensation (Dust Diseases) Board / Commissioner of Police / State Authorities Superannuation Board <i>(delete where inapplicable)</i>		
Address			
Suburb		Postcode	

PLAINTIFF'S SOLICITOR

Firm Name		Solicitor's Name	
DX		Reference	
Telephone		Fax	
Address for service <i>(if no DX)</i>			
Suburb		Postcode	

Application is hereby made, particulars of which are set out herein, for the determination of the liability of, and amount of compensation payable by, the Defendant.

For applications seeking the review of an existing award, substitute - Application is hereby made, particulars of which are set out herein, with respect to the review of the weekly payments awarded under the said Act in respect of the injury received by the Plaintiff.

(Solicitor for the) Plaintiff

NOTICE TO THE DEFENDANT

You are liable to have an Award for the compensation claimed or other order made against you unless, within 28 days after service of the Statement of Claim upon you, you file a Defence in the Registry of the Court and you comply with the Rules of the Court in defending this matter.

Registrar of the Court

LISTING INFORMATION

A. State the desired venue for the hearing: <i>(available are - Sydney, Parramatta, Newcastle or Wollongong or a circuit town selected from the Court's calendar for the current year)</i>	
B. State day or days of the week desired for the hearing: <i>(available are - any day, Monday to Friday)</i>	
C. If this application related to benefits under the Workers Compensation Act 1987, state whether the application involves the following: <i>(delete where in inapplicable)</i> <ul style="list-style-type: none"> • sections 61, 62, 63 or 63A - increase in liability of employer for medical and related treatment, hospital, ambulance or occupational rehabilitation expenses. • section 76 or 77 - increase in liability of employer for damage to artificial limbs, spectacle or damage to clothing. • section 83 - manner of payment of compensation • section 85 - payment to the WorkCover Authority for the benefit of beneficiaries. • section 16 - 1926 Act. • section 66 up to \$40,000 and over, excluding back, neck, or brain damage. • section 66 back, neck or brain damage • section 67 - 1987 Act 	

PARTICULARS

1.	(a) Date of injury: <i>(if over a period of time, state the period as accurately as possible)</i> (b) Place where the injury happened: (c) What work <i>(use "activity" for Sporting Injuries applications)</i> was being done at the time of injury: (d) How did the injury occurred: <i>(for review applications, state the grounds on which the increase is sought)</i>	(a) (b) (c) (d)
2.	(a) Nature of the injury: (b) Incapacity for work <i>(state whether total, partial or partial claimed as total and the periods for each: (omit (b) for Sporting Injuries and review applications)</i>	(a) (b)
3.	Particulars of compensation claimed: <ul style="list-style-type: none"> ● <i>Specify the benefit claimed under the relevant act.</i> ● <i>Details of claims under section 66 of the Workers Compensation Act 1987 must be in terms of the Table of Compensation for Permanent Injuries in the Act.</i> ● <i>Details of claims under the Sporting Injuries Insurance Act 1978 must be in terms of the Benefits Tables contained in Schedule 1 to that Act</i> 	(a) Lump sum \$_____ (b) \$_____ pw under section _____. (c) Other <i>(specify)</i> _____. (d) Interest.

4.	(a) Date of notice of injury: (b) Date of notice of incapacity given: (c) Date of claim for compensation: (d) Reason for omission of any notice: <i>(leave blank for Police Superannuation and Sporting Injuries applications)</i>	(a) (b) (c) (d)
5.	(a) Workers current weekly wage rate: (b) Workers average weekly earnings: (c) Workers actual weekly earnings during periods claimed: <i>(leave blank for Police Superannuation and Sporting Injuries applications)</i>	(a) (b) (c)
6.	Payment, allowance or benefit received from the employer during the period of incapacity and the date on which the payment ceased: <i>(leave blank for Police Superannuation and Sporting Injuries applications)</i>	
7.	Where the injury is a disease contracted by a gradual process, the names and address of all other employers by whom the injured person was employed during the twelve months previous to date on incapacity in any employment to the nature of which the disease: <i>(leave blank for Police Superannuation, Sporting Injuries and review applications)</i>	
8.	Name, date of birth and relationship to injured person of each person alleged to be dependant upon the injured person and the extent of the alleged dependency: <i>(leave blank for Sporting Injuries applications)</i>	
9.	(a) Date of the decision that is subject of this application: (b) Date when the application was notified of the decision: (c) Particulars of the decision: <i>(a copy of decision must be annexed)</i> <i>(only complete for Police Superannuation applications)</i>	(a) (b) (c)

Note: Further particulars may be appended.

Particulars must be given of any facts alleged, failure to give which may take the defendant by surprise.

Form 8d - Application for termination, diminution, or redemption

**IN THE DISTRICT COURT OF NEW SOUTH WALES
COAL MINERS' WORKERS COMPENSATION LIST
STATEMENT OF CLAIM**

(if amended application precede with first, second, etc, as applicable)
by an employer seeking a review of an existing award in matter no: _____
or redemption
under the Workers Compensation Act 1987 *(delete where inapplicable)*.

- Note:* 1. *If this is an amended application, information that has been added or varied must be clearly identified by being italicised or underlined.*
2. *Applications seeking the review, redemption or commutation of an existing award must be accompanied by a copy of the award.*

DEFENDANT WORKER *(Injured person's details)*

Given Names		Family Name	
Date of birth		Sex	
Address			
		Postcode	

PLAINTIFF *(Employer details)*

Name			
Address			
		Postcode	

PLAINTIFF'S INSURER

Name		Claim no. (if known)	
Address		Postcode	
Period of insurance <i>(if all state the relevant period state 'whole')</i>			

PLAINTIFF'S SOLICITOR

Firm Name		Solicitor's Name	
DX		Reference	
Telephone		Fax	
Address for Service (if not DX)			

Application is hereby made, particulars of which are set out herein, for the review of the weekly payment awarded / redemption / commutation of the employer's liability *(delete where inapplicable)* under the said Act in respect of the injury received by the Defendant Worker.

(Solicitor for the) Plaintiff

NOTICE TO THE DEFENDANT

You are liable to have an Award or other order made against you unless, within 28 days after service of the Statement of Claim upon you, you file a Defence in the Registry of the Court and you comply with the Rules of the Court in defending this matter.

Registrar of the Court

LISTING INFORMATION

A.	State the desired venue for the hearing: <i>(available are - Sydney, Katoomba, Newcastle or Wollongong)</i>	
B.	State day or days of week desired for the hearing: <i>(available are - any day, Monday, Tuesday, Wednesday, Thursday or Friday)</i>	

PARTICULARS

1.	(a) Date of injury <i>(if over a period of time, state the period as accurately as possible)</i> (b) Grounds on which the variation is sought: <i>(omit (b) for redemption and commutation applications)</i>	(a) (b)
2.	(a) Nature of injury: (b) Incapacity for work (state whether total, partial or partial claimed as total and the periods for each): (c) Estimated duration of incapacity: (d) Work for which defendant worker is fit during partial incapacity	(a) (b) (c) (d)
3.	Particulars of variation sought of weekly payment awarded: <i>(in redemption and commutation applications, substitute 'Lump Sum proposed for redemption or commutation:')</i>	(a) Diminution to \$ — pw as from / / (b) Termination as from / / .

The following particulars need only be supplied for redemption and commutation applications

4.	Defendant worker's occupation at time of injury	
5.	(a) Worker's present weekly earnings: (b) Worker's average weekly earnings in the last year: (c) Estimated ability of worker to earn (if not in employment): (d) Workers average weekly earnings in the last year: (e) Probable weekly earnings but for the injury - s.38	(a) \$ — pw in the occupation of _____ (b) \$ — pw in the occupation(s) of _____ (c) \$ — pw in the occupation(s) of _____ (d) \$ — pw in the occupation(s) of _____ (e) \$ — pw in the occupation of _____

6.	Particulars of compensation paid in respect of the injury: <i>(vary or add to as necessary, delete where inapplicable)</i>	(a) Periods of payment at - (i) maximum weekly rate (ii) less than maximum weekly rate (b) s 66 lump sum \$ _____ in respect of _____ (c) s 60 expenses - Medical \$ _____ Hospital \$ _____ Rehabilitation \$ _____ (d) s 67 (e) interest (f) other (<i>specify</i>) _____
7.	Particulars of compensation claimed by the worker but unpaid:	(a) Weekly payments \$ _____ pw from / (b) s 60 expenses (c) other
8.	Medical examinations of worker on employer's behalf on the past year:	Dr(s) _____ on / / .
9.	State whether determination is sought in the circumstances set out in either s 51(1) (a), (b) or (c) If 51(1)(c), state date of approval of WorkCover Authority and attach a copy of the approval: <i>(only for commutation applications)</i>	

Note:

Further particulars may be appended.

Particulars must be given of any other fact alleged, failure to give which may take the defendant by surprise

Form 149

IN THE DISTRICT COURT OF NEW SOUTH WALES

APPLICATION FOR MEDICAL PANEL

In the matter of the Workplace Injury Management and Workers Compensation Act
1998

_____ Worker,

and

_____ Employer.

Application is made, particulars of which are set out herein, for referral of (a) medical dispute(s) to a Medical Referee or Medical Panel. A copy of a medical practitioner's report of the examination of the applicant relevant to the medical dispute(s) is attached.

The particulars herein are declared to be correct.

Dated:

Signed:

Worker/Employer/Insurer/Worker's Solicitor/Insurer's Solicitor (*delete whichever is inapplicable*)

NOTES:

1. This form may be abbreviated by deleting injuries referred to in particulars 5(a) and 5(b) for which no certification is sought.
2. Certification may only be made in respect of the totality of a condition not including causes or intercurrent conditions. No certification can be given in respect of any previous injury or pre-existing condition or abnormality as referred to in section 68A of the 1987 Act.
3. The role of a Medical Panel is to act in accordance with legislative requirements and not to provide medical advice or treatment.
4. Applications under section 122(12) of the 1998 Act must be made jointly by the worker and the employer (Part 24E Rule 3 of the District Court Rules).

PARTICULARS

1. (a) Worker's surname and given names:	(a)		
(b) Street address, suburb and State:	(b)		
(c) Day, month and year of birth :	(c)		
(d) Male/Female :	(d)		
(e) Workers' telephone number :	(e) Home:		
	Work :		
(f) Workers' Solicitors (if applicable):	(f)		
(g) Solicitors' Address:	(g)		
(h) Solicitors' telephone number:	(h)		
2. (a) Name and place of business of employer:	(a)		
(b) Nature of business of employer:	(b)		
(c) Employer's telephone number:	(c)		
3. Date when claim for compensation was made upon the employer:			
4. (a) Name and address of insurer of employer:	(a)		
(b) Insurer's telephone number:	(b)		
(c) Insurer's solicitors (if applicable)	(c)		
(d) Solicitor's address	(d)		
(e) Solicitor's telephone number	(e)		
5. (a) Tick the box relevant to the injury in respect of which the Medical Panel Certificate is required.	Condition Section 66	Fitness for Employment	
<u>Injury after 4pm 30 June 1987 only (1987 Act)</u>			
<i>Speech Loss</i>			
Loss of power of speech.....	<input type="checkbox"/>	<input type="checkbox"/>	
<i>Sensory Loss</i>			
Loss of sense of taste.....	<input type="checkbox"/>	<input type="checkbox"/>	
Loss of sense of smell.....	<input type="checkbox"/>	<input type="checkbox"/>	
Loss of sense of taste and smell.....	<input type="checkbox"/>	<input type="checkbox"/>	

	Condition Section 66		Fitness or Employment
<i>Hearing Loss</i>			
Loss of hearing of both ears.....	<input type="checkbox"/>		<input type="checkbox"/>
Loss of hearing of one ear.....	<input type="checkbox"/> Left	<input type="checkbox"/> Right	<input type="checkbox"/>
<i>Loss of vision</i>			
Loss of sight of both eyes.....	<input type="checkbox"/>		<input type="checkbox"/>
Loss of sight of an only eye.....	<input type="checkbox"/>		<input type="checkbox"/>
Loss of sight of one eye, together with serious diminution of the sight of the other eye.....	<input type="checkbox"/>		<input type="checkbox"/>
Loss of sight of one eye.....	<input type="checkbox"/> Left	<input type="checkbox"/> Right	<input type="checkbox"/>
Loss of binocular vision (where not otherwise compensable under the table of permanent injuries).....	<input type="checkbox"/>		<input type="checkbox"/>
Loss of eyeball (in addition to compensation for loss of sight of the eye)	<input type="checkbox"/> Left	<input type="checkbox"/> Right	<input type="checkbox"/>
<i>Arm Injuries</i>			
<i>Dominant arm</i>	<input type="checkbox"/> Left	<input type="checkbox"/> Right	
Loss of right arm at or above elbow.....	<input type="checkbox"/>		<input type="checkbox"/>
*Loss of right arm below elbow	<input type="checkbox"/>		<input type="checkbox"/>
Loss of left arm at or above elbow	<input type="checkbox"/>		<input type="checkbox"/>
*Loss of left arm below elbow.....	<input type="checkbox"/>		<input type="checkbox"/>
(* where no loss at or above elbow is in dispute)			
<i>Hand Injuries (where no loss of the arm is in dispute)</i>			
<i>Dominant hand</i>	<input type="checkbox"/> Left	<input type="checkbox"/> Right	
Loss of right hand.....	<input type="checkbox"/>		<input type="checkbox"/>
Loss of left hand.....	<input type="checkbox"/>		<input type="checkbox"/>
*Loss of thumb of right hand.....	<input type="checkbox"/>		<input type="checkbox"/>
*Loss of thumb of left hand.....	<input type="checkbox"/>		<input type="checkbox"/>
*Loss of a joint of the thumb.....	<input type="checkbox"/> Left	<input type="checkbox"/> Right	<input type="checkbox"/>
*Loss of forefinger of the right hand.....	<input type="checkbox"/>		<input type="checkbox"/>
*Loss of forefinger of the left hand.....	<input type="checkbox"/>		<input type="checkbox"/>

	Condition Section 66	Fitness for Employment	
*Loss of 2 joints of forefinger of the right hand	<input type="checkbox"/>		<input type="checkbox"/>
*Loss of 2 joints of forefinger of the left hand	<input type="checkbox"/>		<input type="checkbox"/>
*Loss of the first joint of the forefinger of the right hand	<input type="checkbox"/>		<input type="checkbox"/>
*Loss of the first joint of the forefinger of the left hand.....	<input type="checkbox"/>		<input type="checkbox"/>
*Loss of middle finger of either hand.....	<input type="checkbox"/> Left	<input type="checkbox"/> Right	<input type="checkbox"/>
*Loss of 2 joints of middle finger of either hand.....	<input type="checkbox"/> Left	<input type="checkbox"/> Right	<input type="checkbox"/>
*Loss of first joint of middle finger of either hand.....	<input type="checkbox"/> Left	<input type="checkbox"/> Right	<input type="checkbox"/>
*Loss of little finger of either hand.....	<input type="checkbox"/> Left	<input type="checkbox"/> Right	<input type="checkbox"/>
*Loss of ring finger of either hand.....	<input type="checkbox"/> Left	<input type="checkbox"/> Right	<input type="checkbox"/>
*Loss of 2 joints of little finger of either hand.....	<input type="checkbox"/> Left	<input type="checkbox"/> Right	<input type="checkbox"/>
*Loss of 2 joints of ring finger of either hand.....	<input type="checkbox"/> Left	<input type="checkbox"/> Right	<input type="checkbox"/>
*Loss of the first joint of little finger of either hand.....	<input type="checkbox"/> Left	<input type="checkbox"/> Right	<input type="checkbox"/>
*Loss of the first joint of ring finger of either hand.....	<input type="checkbox"/> Left	<input type="checkbox"/> Right	<input type="checkbox"/>
(* where no loss of the arm or hand is in dispute)			
<i>Leg Injuries</i>			
Loss of either leg at or above the knee.....	<input type="checkbox"/> Left	<input type="checkbox"/> Right	<input type="checkbox"/>
*Loss of either leg below the knee.....	<input type="checkbox"/> Left	<input type="checkbox"/> Right	<input type="checkbox"/>
(* where no loss at or above knee is in dispute)			
<i>Foot Injuries (where no loss of the leg is in dispute)</i>			
Loss of a foot.....	<input type="checkbox"/> Left	<input type="checkbox"/> Right	<input type="checkbox"/>
*Loss of great toe of either foot	<input type="checkbox"/> Left	<input type="checkbox"/> Right	<input type="checkbox"/>
*Loss of a joint of the great toe of either foot.....	<input type="checkbox"/> Left	<input type="checkbox"/> Right	<input type="checkbox"/>
*Loss of any other toe	<input type="checkbox"/> Left	<input type="checkbox"/> Right	<input type="checkbox"/>
*Loss of any joint of any other toe	<input type="checkbox"/> Left	<input type="checkbox"/> Right	<input type="checkbox"/>
(* where no loss of the leg or foot is in dispute)			
<i>Bowel Injury</i>			
Permanent loss of bowel function	<input type="checkbox"/>		<input type="checkbox"/>

	Condition Section 66	Fitness for Employment	
<i>Loss of Sexual Organs etc</i>			
Loss of sexual organs	<input type="checkbox"/>	<input type="checkbox"/>	
Loss of both breasts.....	<input type="checkbox"/>	<input type="checkbox"/>	
Loss of one breast.....	<input type="checkbox"/> Left	<input type="checkbox"/> Right	<input type="checkbox"/>
Loss of penis.....	<input type="checkbox"/>	<input type="checkbox"/>	
Loss of one testicle.....	<input type="checkbox"/> Left	<input type="checkbox"/> Right	<input type="checkbox"/>
Loss of two testicles	<input type="checkbox"/>	<input type="checkbox"/>	
Loss of an only testicle	<input type="checkbox"/>	<input type="checkbox"/>	
<i>Brain Damage</i>			
Permanent brain damage (being an injury which is not or is not wholly an injury otherwise compassable under the table of permanent injuries).....	<input type="checkbox"/>	<input type="checkbox"/>	
<i>Permanent impairment of back, neck, pelvis</i>			
Permanent impairment of the back.....	<input type="checkbox"/>	<input type="checkbox"/>	
Permanent impairment of the neck.....	<input type="checkbox"/>	<input type="checkbox"/>	
Permanent impairment of the pelvis.....	<input type="checkbox"/>	<input type="checkbox"/>	
<i>Disfigurement</i>			
Severe facial disfigurement (being an injury which is not or is not wholly compassable under the table of permanent injuries).....	<input type="checkbox"/>	<input type="checkbox"/>	
Severe bodily disfigurement (being an injury which is not or is not wholly compassable under the table of permanent injuries).....	<input type="checkbox"/>	<input type="checkbox"/>	
<i>Mining Condition</i>			
Pneumoconiosis, bronchitis and/or emphysema.....	<input type="checkbox"/>	<input type="checkbox"/>	
<i>Disease</i>			
HIV Infection.....	<input type="checkbox"/>	<input type="checkbox"/>	
AIDS.....	<input type="checkbox"/>	<input type="checkbox"/>	
5. (b) Tick the box relevant to the injury in respect of which the Medical Panel Certificate is required.			
<u>Injury up to 4pm 30 June 1987 only (1926 Act)</u>			
Loss of either arm, or the greater part there of.....	<input type="checkbox"/> Left	<input type="checkbox"/> Right	<input type="checkbox"/>
Loss of lower part of either arm, either hand or five fingers of either hand.....	<input type="checkbox"/> Left	<input type="checkbox"/> Right	<input type="checkbox"/>

	Condition Section 16	Fitness for Employment	
Loss of leg or the greater part thereof	<input type="checkbox"/> Left	<input type="checkbox"/> Right	<input type="checkbox"/>
Loss of the lower part of a leg.....	<input type="checkbox"/> Left	<input type="checkbox"/> Right	<input type="checkbox"/>
Loss of a foot.....	<input type="checkbox"/> Left	<input type="checkbox"/> Right	<input type="checkbox"/>
Loss of sight of one eye with serious diminution of the sight of the other.....	<input type="checkbox"/> Left	<input type="checkbox"/> Right	<input type="checkbox"/>
Loss of sight of both eyes.....	<input type="checkbox"/>		<input type="checkbox"/>
Loss of sight of one eye.....	<input type="checkbox"/> Left	<input type="checkbox"/> Right	<input type="checkbox"/>
Loss of hearing of both ears.....	<input type="checkbox"/>		<input type="checkbox"/>
Loss of hearing of one ear.....	<input type="checkbox"/> Left	<input type="checkbox"/> Right	<input type="checkbox"/>
Loss of power of speech.....	<input type="checkbox"/>		<input type="checkbox"/>
Loss of thumb.....	<input type="checkbox"/> Left	<input type="checkbox"/> Right	<input type="checkbox"/>
Loss of a forefinger.....	<input type="checkbox"/> Left	<input type="checkbox"/> Right	<input type="checkbox"/>
Loss of a joint of a thumb.....	<input type="checkbox"/> Left	<input type="checkbox"/> Right	<input type="checkbox"/>
Loss of little finger.....	<input type="checkbox"/> Left	<input type="checkbox"/> Right	<input type="checkbox"/>
Loss of middle finger.....	<input type="checkbox"/> Left	<input type="checkbox"/> Right	<input type="checkbox"/>
Loss of ring finger.....	<input type="checkbox"/> Left	<input type="checkbox"/> Right	<input type="checkbox"/>
Loss of a joint of a finger.....	<input type="checkbox"/> Left	<input type="checkbox"/> Right	<input type="checkbox"/>
Loss of joint of forefinger	<input type="checkbox"/> Left	<input type="checkbox"/> Right	<input type="checkbox"/>
Loss of a toe.....	<input type="checkbox"/> Left	<input type="checkbox"/> Right	<input type="checkbox"/>
Loss of a joint of a toe.....	<input type="checkbox"/> Left	<input type="checkbox"/> Right	<input type="checkbox"/>
Loss of a great toe.....	<input type="checkbox"/> Left	<input type="checkbox"/> Right	<input type="checkbox"/>
Loss of joint of great toe..	<input type="checkbox"/> Left	<input type="checkbox"/> Right	<input type="checkbox"/>
Loss of taste.....	<input type="checkbox"/>		<input type="checkbox"/>
Loss of smell.....	<input type="checkbox"/>		<input type="checkbox"/>
Loss of eyeball (in addition to any payment for loss of sight).....	<input type="checkbox"/> Left	<input type="checkbox"/> Right	<input type="checkbox"/>
Severe facial disfigurement.....	<input type="checkbox"/>		<input type="checkbox"/>
Loss of sexual organs.....	<input type="checkbox"/>		<input type="checkbox"/>
Loss of both breasts.....	<input type="checkbox"/>		<input type="checkbox"/>

5. (c) Is the condition stable? Yes No
6. (a) Has the medical practitioner's report (of which a copy is attached) of the examination of the applicant relevant to the medical dispute been furnished to the other party? Yes No
- (b) Was the report furnished to that party within 30 days of being received from the medical practitioner? Yes No
- (c) If it was not so furnished within that time, what circumstances are submitted under section 122(4) as justifying referral of the dispute to a medical referee or medical panel? (c)
7. Has agreement been reached between the worker and the employer as to whether a certificate is required as to:
- (a) The worker's condition? Yes No
- or
- (b) The worker's fitness for employment? Yes No
- and/or
- (c) The kind of employment for which the worker is fit? Yes No
8. (a) Date of injury: (a)
- (b) Nature of injury: (b)
- (c) Nature of accident: (c)
9. (a) Is the worker receiving medical treatment? Yes No
- (b) If yes, from whom? (b)

10. State the names and addresses of **ALL** medical practitioners who have treated or examined the worker in respect of the injury:
11. (a) Has the worker received hospital treatment in respect of the injury? Yes No
- If Yes, state:
- (b) Name of hospital: (b)
- (c) As an outpatient or an inpatient: (c)
- (d) State brief details of periods and nature of treatment: (d)
- 12.(a) Are available medical records as to treatment and condition and x-ray reports attached? Yes No
- (b) If not, do you undertake to arrange for them to be delivered to the Court's Medical Section at least 7 days before the date fixed for examination? (b)
13. What work has the worker done since the injury?
14. What work is the worker doing at present?
15. (a) Is the worker fit to travel? Yes No
- (b) If not, give details: (b)
16. (a) Has the worker been examined at any time by a Medical Referee or Panel, pursuant to the 1987 or 1998 Acts or by a Medical Board pursuant to the 1926 Act in respect of the present or any other condition? Yes No
- (b) If yes, give Medical Panel or Board reference number: (b)

17. (a) Have any proceedings in respect of compensation been taken in relation to this or any other injury received by the worker? Yes No

(b) If yes, give Court reference number: (b)

18. (a) Does the worker require the services of an interpreter? Yes No

(b) If yes, what is the worker's preferred language? (b)

FURTHER PARTICULARS

Form 150

IN THE DISTRICT COURT OF NEW SOUTH WALES

CERTIFICATE OF COMPLIANCE UNDER PART 24D RULE 4 IN REPECT OF CLAIMS FOR COMPENSATION REFERRED TO IN SECTIONS 101, 102, AND 103 OF THE WORKPLACE INJURY MANAGEMENT AND WORKERS COMPENSATION ACT 1998 (1998 ACT) AS MODIFIED BY CLAUSES 235, 236 AND 237 RESPECTIVELY OF THE WORKERS COMPENSATION REGULATION 2003.

PLAINTIFF

Given Names		Family Name	
-------------	--	-------------	--

DEFENDANT

Name	
------	--

PLAINTIFF'S SOLICITOR

Firm Name		Solicitor's Name	
DX		Reference	
Telephone		Fax	
Address for service (if not DX)			

I certify that the attached application to the Court relates to a claim or claims referred to in sections 101, 102 and / or 103 of the 1998 Act and that the matter hereinafter stated are true and correct:

Dated:

Solicitor for Plaintiff/ Plaintiff

Note:

- (1) All inapplicable parts of this form and/or the statements within those Parts are to be DELETED BY CROSSING THEM OUT IN THEIR ENTIRETY.
- (2) This form must be annexed to the initiating process at the time of filing.

PART 1 (GENERAL)

The attached application relates to:

- (a) a claim for compensation in respect of an injury received by a coal miner;

The preferred venue for the conciliation of the coal mining claim is SYDNEY/
NEWCASTLE/ WOLLONGONG.

PART 2 (WEEKLY PAYMENTS)

A claim for compensation has been made and

- (a) 21 days have elapsed after the worker made the claim for that compensation
in respect of a claim referred to in Part 1 (b) and (c) above;

OR

- (b) 28 days have elapsed after the worker made the claim for that compensation
in respect of a claim referred to in Part 1 (a) above;

OR

- (c) the Plaintiff seeks an order under section 53 of the Workers Compensation
Act 1987 (1987 Act);

OR

- (d) the claim concerns weekly payments that are the subject of an Award of the
Court;

OR

- (e) the claim concerns weekly payments in respect of an injury occurring before
4 p.m. on 30 June 1987;

OR

- (f) the claim is exempt from the provisions of section 101 of the 1998 Act by
regulation (specify).

PART 3 (SECTION 66 (1987 ACT) PERMANENT IMPAIRMENTS)

A claim for compensation has been made and

- (a) 2 months have elapsed after the worker made the claim for that
compensation;

OR

- (b) 14 days have elapsed since a medical panel gave its certificate in relation to
an application under section 122 of the 1998 Act by the person on whom a claim for
compensation was made.

PART 4 (SECTION 67 (1987 ACT) PAIN AND SUFFERING)

A claim for compensation has been made and there has been compliance with :

(i) Part 3 (a) above;

OR

(ii) Part 3 (b) above.

PART 5 (MEDICAL, HOSPITAL AND OTHER EXPENSES)

A claim has been made for compensation:

(i) for medical, hospital or rehabilitation expenses;

OR

(ii) for property damage;

AND

(a) 28 days have elapsed after the worker made the claim for that compensation;

OR

(b) the Plaintiff is entitled to bring proceedings either for weekly payments of compensation or compensation under sections 66 or 67 of the 1987 Act.

TENDERS**Department of Commerce****SUPPLIES AND SERVICES FOR THE PUBLIC SERVICE**

Information in relation to the Department of Commerce proposed, current and awarded tenders is available on:

<http://www.tenders.nsw.gov.au>

PRIVATE ADVERTISEMENTS

COUNCIL NOTICES

LAKE MACQUARIE CITY COUNCIL

Proposed Naming of Road/s in Subdivisions

In pursuance of section 162.1 of the Roads Act 1993, as amended, Council proposes to name the following roads:

Location	Name
Lot 5, DP 1002247, Grattoir Place, Toronto.	Leo Lewis Close.
Lot 630, DP 1027743, Corella Close, Fennell Bay.	Greystone Close. Bluerock Close.

A period of one month from the date of publication of this notice is allowed, during which time any person may lodge written objection to the proposed naming. Any objections should set out fully the reasons for such objections. For further information contact Margaret Cumpson on (02) 4921 0323. KEN HOLT, General Manager, Lake Macquarie City Council, Box 1906, Hunter Region Main Centre, NSW 2310. [0049]

LAKE MACQUARIE CITY COUNCIL

Dedication of Land as Public Road

NOTICE is hereby given that Lake Macquarie City Council in pursuance of section 10 of the Roads Act 1993, dedicates the land held by it and described in the Schedule below as public road. KEN HOLT, General Manager, Lake Macquarie City Council, Main Road, Speers Point, NSW 2284, tel.: (02) 4921 0333.

Schedule

Lot 2 in Deposited Plan 376513. [0004]

LAKE MACQUARIE CITY COUNCIL

Roads Act 1993, Section 10

Dedication of Land as Public Road

NOTICE is hereby given that Lake Macquarie City Council in pursuance of section 10 of the Roads Act 1993, dedicates the land held by it and described in the Schedule below as public road. KEN HOLT, General Manager, Lake Macquarie City Council, Administration Centre, Main Road, Speers Point, NSW 2284, tel.: (02) 4921 0333.

Schedule

Part Lot 6321 in Deposited Plan 1060387. [0053]

LIVERPOOL CITY COUNCIL

Roads Act 1993, Section 10

NOTICE is hereby given that The Council of the City of Liverpool dedicates the lands described in the Schedule below as public road under section 10 of the Roads Act 1993. GENERAL MANAGER, The Council of the City of Liverpool, Locked Bag 7064, Liverpool BC, NSW 1871.

Schedule

All that piece or parcel of land known as Lot 12 in DP 706559 in The Council of the City of Liverpool, Parish of St Luke, County of Cumberland and as described in Folio Identifier 12/706559. [0042]

SHOALHAVEN CITY COUNCIL

Tree Preservation Order

NOTICE is hereby given that under the provisions of Clause 8 of the Environmental Planning and Assessment Model Provisions 1980, as adopted by the City of Shoalhaven Local Environmental Plan 1985, the Council of the City of Shoalhaven has by resolution adopted at its meeting of 20 January 2004, firstly, rescinded any Tree Preservation Order made prior to this notice, and secondly, made a Tree Preservation Order as set out hereunder:

1. Citation

This Order may be cited as "City of Shoalhaven Tree Preservation Order 2004".

2. Commencement

This Order commences on the date of its notification in the NSW *Government Gazette*.

3. Application of the Order

- i) This Order prohibits the ring-barking, cutting down, lopping, topping, removing, injuring, poisoning or wilful destruction of any tree growing on land within the City of Shoalhaven and as particularly described in Schedules 1 and 2, without the written consent of Council.
- ii) This Order does not apply:
 - a) to those works listed in Schedule 4 unless the tree is located on land listed in Schedules 1 and 2.
 - b) to those works listed in Schedule 3 or any tree listed in Schedule 5.

4. Relationship to an environmental planning instrument or development control plan.

If this Order is inconsistent with any environmental planning instrument (EPI), made before or after this Order, or development control plan (DCP) adopted by the Council of the City of Shoalhaven before or after this Order, the EPI or DCP prevails to the extent of the inconsistency.

Note: There may be other legislation controlling the removal of trees within the Shoalhaven, which overrides this Order. For example Council's local environmental plan has provisions controlling vegetation removal. Further information is contained within Council's Tree Management Policy.

5. Definitions

- i) Under this Order, trees are defined as a perennial plant with at least one self-supporting woody or fibrous stem, being:
 - a) More than 5 metres tall; or

- b) More than 5 metres wide across the foliage crown; or
- c) Having a trunk circumference of more than 500 millimetres measured 1 metre above ground level;

But does not include the tree species referred to in Schedule 5.

- ii) The definitions cited in the Council of the City of Shoalhaven Tree Management Policy are adopted for the purposes of this Order.

Schedule 1

- Land where there are any conditions of development consent or “Section 88B” restriction to user instruments relating to the land that restrict part or all of the activity; or
- The tree or the land it is on is a heritage item or in a heritage conservation area
- Land within 20 metres of the edge of a water body (including riparian areas); or
- Land where Shoalhaven City Council Development Control Plan 62 “Residential Development in Foreshore Areas” applies; or
- Within 30metres of a rural road boundary; or

Schedule 2

- i) Lands in the following Deposited Plans: 8082, 8362, 8590, 8591, 8592, 8769, 8770, 8771, 8772, 9063, 9289, 9699, 9897, 11386, 11387, 11388, 11629, 12592, 12599, 13393, 14958, 15060, 15103, 15266, 15461, 15507, 15559, 16196, 17199, 25671, 27575, 27814, 28785, 29970.
- ii) Toona Australis (Red Cedar) on any land
- iii) Land supporting rainforest vegetation species as identified on Sheet 6 of 17 sheets titled Policy Map Land Supporting Rainforest Vegetation Species, Illawarra Regional Environmental Plan No. 1.

Schedule 3

- Tree works for the purposes of Bushfire Hazard Reduction Work carried out under the Bush Fire Environmental Assessment Code 2003.
- Wire Clearance – any work carried out under Section 48 of the Electricity Supply Act 1995
- Emergency Works – any work carried out by Council, the State Emergency Services, the Rural Fire Service of NSW, or a public authority in response to an emergency.
- Tree works carried out by Council or its agents on land owned or under the care and control of Council, provided that assessment of the tree work has been carried out in accordance with this policy.
- Severe Weather Event or Windstorm – any work to prune or remove a tree posing an immediate risk to persons or property during or immediately following a storm event (within 3 days) where the land owner has:
 - o Given verbal notification to Council, via either the normal enquiry process or outside normal working hours on Council’s after hours

emergency number, the following details; name of caller, address of property, location of tree within the property, approx size of tree, species of tree, reason for the work (eg broken branches, broken trunk, roots lifting, severe lean etc) and the name of the person or company undertaking the work.

- o Where contact cannot be made with Council, all of the above information must be recorded by the tree owner and forwarded to Council within 14 days of the removal. It is also recommended that the tree owner take photographs and obtain a statement or report from the person removing the tree (eg arborist, SES etc) confirming the hazard
- Crown Maintenance Pruning in accordance with the Australian Standards for Pruning of Amenity Trees, by up to ten percent (10%) in any one year.
- Removal of field grown trees from approved or permitted commercial horticultural or agricultural enterprises specifically producing advanced tree specimens for reselling
- Tree removal approved by a current Development Consent issued by Council, or

Schedule 4

- Tree works on private land where any part of a tree is above a line 45o from the vertical extension of the wall of any building measured from its base; or
- Tree works within six (6) metres of an approved dwelling; or three (3) metres of an approved garage or outbuilding; zoned residential under Shoalhaven Local Environmental Plan 1985.
- Tree works within twelve (12) metres of an approved dwelling; or six (6) metres of an approved garage or outbuilding; or six (6) metres of a rural fence; zoned rural under Shoalhaven Local Environmental Plan 1985; or
- Tree works on land zoned rural 1(a), 1(b) and 1(d) under Shoalhaven Local Environmental Plan 1985

Schedule 5

Any of the following species, regardless of size (unless listed as a Heritage Item, growing within the curtilage of a Heritage Item, or within a Heritage Conservation Area under Shoalhaven Local Environmental Plan 1985) are exempt from this policy:

Fruit trees being specifically grown for their edible fruit for human consumption

Cootamundra Wattle	<i>Acacia baileyana</i>
Black Wattle	<i>Acacia decurrens</i>
Cape Leeuwin Wattle	<i>Albizia lophantha</i>
Evergreen Alder	<i>Alnus jorullensis</i>
Tree Lucerne	<i>Chamaecytisus sp</i>
Indian Coral Tree	<i>Erythrina x sykesii</i>
Silky Oak	<i>Grevillea robusta</i>
Privet	<i>Ligustrum species</i>
African Olive	<i>Olea africana</i>
Canary island Date Palm	<i>Phoenix canariensis</i>

Sweet Pittosporum	<i>Pittosporum undulatum</i>
Umbrella Trees	<i>Schefflera species</i>
Cocos or Queen Palm	<i>Syagrus romanzoffianum</i>
Rubber Trees	<i>Ficus elastica</i>

Any of the following species only if less than 10metres tall:

Camphor laurel	<i>Cinnamomum camphora</i>
Liquidambar	<i>Liquidambar styraciflua</i>
Radiata Pine	<i>Pinus radiata</i>
Poplars	<i>Populus species</i>
Willows	<i>Salix species</i>

Any tree that is listed as a Declared Noxious Weed in the Shoalhaven City Council area (unless growing within the curtilage of a Heritage Item under Shoalhaven Local Environmental Plan 1985). SHOALHAVEN CITY COUNCIL, Bridge Road (PO Box 42), Nowra, NSW 2541, tel.: (02) 4429 3111. [0050]

WINGECARRIBEE SHIRE COUNCIL

ERRATUM

Heritage Act 1977

NOTICE is given of an erratum to a notice published in the *Government Gazette* of 16 January 2004, Folio 0003. Schedule 'B' of Interim Heritage Order No. 1 should read as follows:

Schedule 'B'

All those pieces or parcels of land known as Lot 1, DP 510721, Blue Gum Road, Bundanoon, shown edged heavy black on the plan catalogued WSC IHO 01/04 in the office of the Wingecarribee Shire Council. RAY DARNEY, Director, Environment and Planning, Wingecarribee Shire Council, PO Box 141, Moss Vale, NSW 2577, tel.: (02) 4868 0888 [0051]

WYONG SHIRE COUNCIL

Naming of Roads in Subdivision

NOTICE is hereby given that in accordance with Part 162.1 of the Roads Act 1993, as amended, Council has named the roads shown hereunder:

Naming of Road in Subdivision – Stage 2E Johns Road, Wadalba, Lots 261 and 262, DP 1038214 and Part Lot 28, DP 755245.

Location	Name
Stage 2E – Johns Road, Wadalba, Road No. 1.	Orchid Way.
Stage 2E – Johns Road, Wadalba, Road No. 2.	Mavie Place.
Stage 2E – Johns Road, Wadalba, Road No. 3.	Kuttabul Road.
Stage 2E – Johns Road, Wadalba, Road No. 4.	Kelat Avenue.
Stage 2E – Johns Road, Wadalba, Road No. 5.	Yarra Place.
Stage 2E – Johns Road, Wadalba, Road No. 6.	Nestor Place.
Stage 2E – Johns Road, Wadalba, Road No. 7.	Hulda Road.
Stage 2E – Johns Road, Wadalba, Road No. 8.	Kuttabul Road.
Stage 2E – Johns Road, Wadalba, Road No. 9.	Terka Street.
No objections to the proposed names were received within the prescribed period of time. K. YATES, General Manager, PO Box 20, Wyong, NSW 2259. [0054]	

CENTRAL DARLING SHIRE COUNCIL

Local Government Act 1993, Section 713

Proposed Sale of Land for Rates

Sale of Land for Overdue Rates.

NOTICE is hereby given to the persons named hereunder that the Council of the Shire of Central Darling has resolved, in pursuance of section 713 of the Local Government Act 1993, to sell the land described hereunder of which the persons named appear to be the owners or in which appear to have an interest and on which the amount of rates stated in each case as at 1 January 2004, is due:

LOCALITY: IVANHOE

Property Owner:	MARGARET B PHILLIPS ESTATE	LPI Prop. Id: 2623813
Property Address:	Leichhardt Street, Ivanhoe	Levied: 2801.39
Description of land:	Section 8, Lot 5, Vol. 11, Folio 119, 40.23 x 50.29	Chgs/Pmts: 1047.51
Valuation:	\$1,300.00	Total: 3848.9
Property Owner:	ERIC MAH	LPI Prop. Id: 2623801
Property Address:	John Street, Ivanhoe	Levied: 3264.61
Description of land:	6, 7//29640	Chgs/Pmts: 1459.73
Valuation:	\$1,500.00	Total: 4724.34
Property Owner:	KOLSTAD RAYMOND BERNARD	LPI Prop. Id: 2623843
Property Address:	Livingstone Street, Ivanhoe	Levied: 2929.89
Description of land:	Section 8, Lot 8, Vol. 1200, Folio 102 40.23 x 50.29	Chgs/Pmts: 1235.69
Valuation:	\$1,100.00	Total: 4165.58

Property Owner:	CHARLES F and GWENETH EVESTON	LPI Prop. Id: 2623858
Property Address:	Raleigh Street, Ivanhoe	Levied: 9528.09
Description of land:	4/7/758537	Chgs/Pmts: 1581.92
Valuation:	\$1,500.00	Total: 11110.01
Property Owner:	WOODS CAROL ANNE	LPI Prop. Id: 2623692
Property Address:	Balranald Road, Ivanhoe	Levied: 2774.5
Description of land:	1//27400 Lot 1, DP 27400, 20.12 x 45.11	Chgs/Pmts: 1357.6
Valuation:	\$900.00	Total: 4132.1
Property Owner:	MAH ERIC	LPI Prop. Id: 2623796
Property Address:	John Street, Ivanhoe	Levied: 2770.83
Description of land:	9//25210	Chgs/Pmts: 1290.56
Valuation:	\$900.00	Total: 4061.39

LOCALITY: MENINDEE

Property Owner:	MARGARET LOUISA PHILP	LPI Prop. Id: 2624054
Property Address:	Menindee Street, Menindee	Levied: 3776.25
Description of land:	2/17/758669	Chgs/Pmts: -766.88
Valuation:	\$2,000.00	Total: 3009.37
Property Owner:	NOLLA ANNE KOOSNEY	LPI Prop. Id: 2623997
Property Address:	Holding Street, Menindee	Levied: 2882.39
Description of land:	11/35/758669, Western Land Lease 12825	Chgs/Pmts: 1666.5
Valuation:	\$800.00	Total: 4548.89
Property Owner:	KARL WILLIAMS	LPI Prop. Id: 2624159
Property Address:	Railway Land, Menindee	Levied: 3009.01
Description of land:	1//195406	Chgs/Pmts: 1523.24
Valuation:	\$1,000.00	Total: 4532.25
Property Owner:	SAMUEL ROBINSON	LPI Prop. Id: 2624038
Property Address:	Menindee Street, Menindee	Levied: 4655.38
Description of land:	8/12/758669	Chgs/Pmts: 2195.55
Valuation:	\$3,600.00	Total: 6850.93
Property Owner:	ALFRED MERVYN JACK ESTATE LATE SPENCER	LPI Prop. Id: 2624027
Property Address:	Menindee Street, Menindee	Levied: 5690.2
Description of land:	9/10/758669	Chgs/Pmts: -2400.4
Valuation:	\$2,000.00	Total: 3289.8

LOCALITY: MENINDEE (ENVIRONS)

Property Owner:	JOHN ALBERT MADDREN	LPI Prop. Id: 2624384
Property Address:	Menindee Environments	Levied: 2388.69
Description of land:	6680//820450, WLL 9380, Lot 6680, DP 820450	Chgs/Pmts: 711.82
Valuation:	\$3,500.00	Total: 3100.51

LOCALITY: RURAL

Property Owner:	R H CHERITON, T F JAMES and A H LAIRD	LPI Prop. Id: 2625438
Property Address:	Freehold Portions	Levied: 1164.84
Description of land:	1//915769	Chgs/Pmts: 864.48
Valuation:	\$100.00	Total: 2029.32

LOCALITY: SUNDRY VILLAGES

Property Owner:	CLIVE LEONARD AIKMAN	LPI Prop. Id: 2624522
Property Address:	Tilpa Tilpa	Levied: 1253.26
Description of land:	5A//9112, Village of Tilpa (Clinic)	Chgs/Pmts: 128.51
Valuation:	\$200.00	Total: 1381.77

LOCALITY: WHITE CLIFFS

Property Owner:	ANTHONY DAVID LITTLEJOHN	LPI Prop. Id: 2624583
Property Address:	PH Kirk Parish Portions, White Cliffs	Levied: 2742.02
Description of land:	1, 2, 3//922693	Chgs/Pmts: 1457.44
Valuation:	\$200.00	Total: 4199.46
Property Owner:	DEBRA ELLEN MCDONALD	LPI Prop. Id: 2624633
Property Address:	PH Kirk Parish Portions, White Cliffs	Levied: 3194.04
Description of land:	169//757488, PH Kirk Portion 169, Vol. 1315, Folio 103	Chgs/Pmts: 1680.98
Valuation:	\$200.00	Total: 4875.02

Property Owner:	WILLIAM TURLEY	LPI Prop. Id: 2624637
Property Address:	PH Kirk Parish Portions, White Cliffs	Levied: 3186.82
Description of land:	178//757488	Chgs/Pmts: 1079.22
Valuation:	\$200.00	Total: 4266.04
Property Owner:	TROY CLARK	LPI Prop. Id: 2624638
Property Address:	PH Kirk Parish Portions, White Cliffs	Levied: 3194.04
Description of land:	179//757488	Chgs/Pmts: 1686.29
Valuation:	\$200.00	Total: 4880.33
Property Owner:	JOSEPH JAMES BARRATT	LPI Prop. Id: 2624608
Property Address:	PH Kirk Miscellaneous, White Cliffs	Levied: 2484.89
Description of land:	125//757488	Chgs/Pmts: 782.42
Valuation:	\$200.00	Total: 3267.31
Property Owner:	WILLIAM RICHARDSON	LPI Prop. Id: 2624576
Property Address:	PH Kirk Parish Portions, White Cliffs	Levied: 3194.04
Description of land:	66//757488 PH Kirk, Portion 66, Vol. 128, Folio 242 50.29 x 70.41, Town Of White Cliffs	Chgs/Pmts: 1072
Valuation:	\$200.00	Total: 4266.04
Property Owner:	RONALD JAMES BENNEY	LPI Prop. Id: 2624570
Property Address:	PH Kirk Parish Portions, White Cliffs	Levied: 3024.54
Description of land:	54//757488 PH Kirk Portion 54, Vol. 1374, Folio 14	Chgs/Pmts: 1443.15
Valuation:	\$200.00	Total: 4467.69

LOCALITY: WILCANNIA

Property Owner:	ERIC MAH	LPI Prop. Id: 2624888
Property Address:	38 Hood Street, Wilcannia	Levied: 2494.76
Description of land:	B//402894	Chgs/Pmts: 1597.2
Valuation:	\$480.00	Total: 4091.96
Property Owner:	RONALD VICTOR EDWARDS, ESTATE	LPI Prop. Id: 2624906
Property Address:	106 Hood Street, Wilcannia	Levied: 20657.54
Description of land:	PT 3/37/759091	Chgs/Pmts: -307.36
Valuation:	\$210.00	Total: 20350.18
Property Owner:	ERIC MAH	LPI Prop. Id: 2624914
Property Address:	136-138 Hood Street, Wilcannia	Levied: 4187.86
Description of land:	2//668446, 1//723969 3, 4, 5, 6, 7, 9/39/759091, Lot 2, DP 668446	Chgs/Pmts: 4265.3
Valuation:	\$1,140.00	Total: 8453.16
Property Owner:	GEORGE HUNTER DOAKE	LPI Prop. Id: 2624918
Property Address:	156 Hood Street, Wilcannia	Levied: 3525.2
Description of land:	2//913181	Chgs/Pmts: 554.63
Valuation:	\$150.00	Total: 4079.83
Property Owner:	D. J. and R. McQUEEN	LPI Prop. Id: 2624935
Property Address:	James Street, Wilcannia	Levied: 2034.17
Description of land:	1//983694	Chgs/Pmts: 742.3
Valuation:	\$210.00	Total: 2776.47
Property Owner:	CECILIA ANN ESTATE LATE COOKE	LPI Prop. Id: 2624938
Property Address:	27 James Street, Wilcannia	Levied: 3681.61
Description of land:	B//402009	Chgs/Pmts: 486.69
Valuation:	\$450.00	Total: 4168.3
Property Owner:	KENNETH JOHN FREEMAN	LPI Prop. Id: 2624941
Property Address:	13 James Street, Wilcannia	Levied: 1467.88
Description of land:	PT 9/34/759091	Chgs/Pmts: 269.49
Valuation:	\$300.00	Total: 1737.37
Property Owner:	ERIC MAH	LPI Prop. Id: 2624815
Property Address:	2 Bourke Street, Wilcannia	Levied: 2151.06
Description of land:	7//1509	Chgs/Pmts: 1058.1
Valuation:	\$100.00	Total: 3209.16
Property Owner:	WILLIAM CHARLES PALMER	LPI Prop. Id: 2624937
Property Address:	29 James Street, Wilcannia	Levied: 2034.17
Description of land:	1//119707	Chgs/Pmts: 954.21
Valuation:	\$210.00	Total: 2988.38

Property Owner:	JOHN ROOKS	LPI Prop. Id: 2624875
Property Address:	Hood Street, Wilcannia	Levied: 1789.06
Description of land:	1//905685	Chgs/Pmts: 485.54
Valuation:	\$450.00	Total: 2274.6
Property Owner:	DANNY JAMES MARTIN	LPI Prop. Id: 2624868
Property Address:	67 Hood Street, Wilcannia	Levied: 9821.39
Description of land:	9//650834, A//900668	Chgs/Pmts: -1765.15
Valuation:	\$600.00	Total: 8056.24
Property Owner:	PHILLIP L. JONES and PAMELA J. BUGMY	LPI Prop. Id: 2624863
Property Address:	103 Hood Street, Wilcannia	Levied: 8606.93
Description of land:	1//923976	Chgs/Pmts: 5379.31
Valuation:	\$210.00	Total: 13986.24
Property Owner:	ERIC MAH	LPI Prop. Id: 2624859
Property Address:	28 Martin Street, Wilcannia	Levied: 2181.37
Description of land:	1//983990	Chgs/Pmts: 1078.43
Valuation:	\$150.00	Total: 3259.8
Property Owner:	ROBERT BEHSMAN	LPI Prop. Id: 2624819
Property Address:	18-22 Bourke Street, Wilcannia	Levied: 2609.33
Description of land:	1, 2, 3, 4, 5, 6//1524 3, 4/8/759091	Chgs/Pmts: 792.29
Valuation:	\$450.00	Total: 3401.62
Property Owner:	RONALD JOHN and CATHERINE YOUNG	LPI Prop. Id: 2624814
Property Address:	19-23 Bonney Street, Wilcannia	Levied: 10044.2
Description of land:	A//901402	Chgs/Pmts: 398.99
Valuation:	\$1,200.00	Total: 0443.19
Property Owner:	ERIC MAH	LPI Prop. Id: 2624816
Property Address:	2 Bourke Street, Wilcannia	Levied: 3785.78
Description of land:	3, 6, 8//1509 7, 8/8/759091 1, 2//916556	Chgs/Pmts: 4049.06
Valuation:	\$750.00	Total: 7834.84
Property Owner:	REGINALD LOUIS KIRCHLER	LPI Prop. Id: 2624953
Property Address:	McRae Street, Wilcannia	Levied: 1537.39
Description of land:	13//1606	Chgs/Pmts: 409.73
Valuation:	\$100.00	Total: 1947.12
Property Owner:	JOHN HESSELDIN	LPI Prop. Id: 2625085
Property Address:	Wills Street, Wilcannia	Levied: 1721.68
Description of land:	2//1509	Chgs/Pmts: 541.02
Valuation:	\$100.00	Total: 2262.7
Property Owner:	ERIC MAH	LPI Prop. Id: 2624818
Property Address:	12 Bourke Street, Wilcannia	Levied: 2266.85
Description of land:	5/8/759091	Chgs/Pmts: 1102.2
Valuation:	\$240.00	Total: 3369.05
Property Owner:	HENRY EDWARD SULLIVAN	LPI Prop. Id: 2624789
Property Address:	17 Adams Street, Wilcannia	Levied: 2152.89
Description of land:	PT 6/42/759091	Chgs/Pmts: 884.26
Valuation:	\$120.00	Total: 3037.15
Property Owner:	JOHN McRAE	LPI Prop. Id: 2625189
Property Address:	156-158 Woore Street, Wilcannia	Levied: 1647.89
Description of land:	1/23/759091	Chgs/Pmts: 786.82
Valuation:	\$240.00	Total: 2434.71
Property Owner:	PAUL A. TREASURE and MARNIE K. VAN DIEPEN	LPI Prop. Id: 2625130
Property Address:	65-67 Woore Street, Wilcannia	Levied: 13671.95
Description of land:	14, 15/13/759091	Chgs/Pmts: 762.18
Valuation:	\$960.00	Total: 14434.13
Property Owner:	REGINALD PHILLPISON	LPI Prop. Id: 2625118
Property Address:	105 Woore Street, Wilcannia	Levied: 2240.47
Description of land:	PT 4/15/759091	Chgs/Pmts: 150.82
Valuation:	\$450.00	Total: 2391.29
Property Owner:	WORKING MANS CO PTY LTD	LPI Prop. Id: 2625111
Property Address:	135 Woore Street, Wilcannia	Levied: 2022.94
Description of land:	PT 10/21/759091	Chgs/Pmts: 738.22
Valuation:	\$210.00	Total: 2761.16

Property Owner:	ERIC MAH	LPI Prop. Id: 2625106
Property Address:	Woore Street, Wilcannia	Levied: 1956.83
Description of land:	1//981951	Chgs/Pmts: 1046.93
Valuation:	\$120.00	Total: 3003.76
Property Owner:	ERIC MAH	LPI Prop. Id: 2625104
Property Address:	155-157 Woore Street, Wilcannia	Levied: 3219.55
Description of land:	1//125960, 1, 2, 3/20/759091, 1//983708	Chgs/Pmts: 3235.66
Valuation:	\$720.00	Total: 6455.21
Property Owner:	ERIC MAH	LPI Prop. Id: 2625089
Property Address:	22 Wilson Street, Wilcannia	Levied: 2378.93
Description of land:	5//668274, 1//907101, 1//909366	Chgs/Pmts: 2211.95
Valuation:	\$180.00	Total: 4590.88
Property Owner:	ERIC MAH	LPI Prop. Id: 2625054
Property Address:	102-104 Reid Street, Wilcannia	Levied: 2323.83
Description of land:	1/21/759091	Chgs/Pmts: 1124.33
Valuation:	\$300.00	Total: 3448.16
Property Owner:	ERIC MAH	LPI Prop. Id: 2625055
Property Address:	106 Reid Street, Wilcannia	Levied: 2209.86
Description of land:	1//981947	Chgs/Pmts: 1080.01
Valuation:	\$180.00	Total: 3289.87
Property Owner:	ERIC MAH	LPI Prop. Id: 2624960
Property Address:	38 Martin Street, Wilcannia	Levied: 3255.9
Description of land:	1//724076 2, 9/37/759091, 1//908447	Chgs/Pmts: 2858.47
Valuation:	\$750.00	Total: 6114.37
Property Owner:	ERIC MAH	LPI Prop. Id: 2625052
Property Address:	94-96 Reid Street, Wilcannia	Levied: 2494.76
Description of land:	3/21/759091	Chgs/Pmts: 1108.7
Valuation:	\$480.00	Total: 3603.46
Property Owner:	MARGARET ELIZABETH STEVENSON	LPI Prop. Id: 2625036
Property Address:	48 Reid Street, Wilcannia	Levied: 4777.85
Description of land:	9//666444	Chgs/Pmts: 1560.2
Valuation:	\$1,050.00	Total: 6338.05
Property Owner:	PRESU PTY LTD (RESIDENCE)	LPI Prop. Id: 2625028
Property Address:	36 Reid Street, Wilcannia	Levied: 13641.67
Description of land:	B//348485 1//380600 A//399923	Chgs/Pmts: 1477.48
Valuation:	\$900.00	Total: 15119.15
Property Owner:	GRAHAM PATRICK GOWER	LPI Prop. Id: 2624996
Property Address:	77 Reid Street, Wilcannia	Levied: 15942.97
Description of land:	1//936994	Chgs/Pmts: 7502.98
Valuation:	\$300.00	Total: 23445.65
Property Owner:	ERIC MAH	LPI Prop. Id: 2624988
Property Address:	101-103 Reid Street, Wilcannia	Levied: 2380.8
Description of land:	1/16/759091	Chgs/Pmts: 1146.25
Valuation:	\$360.00	Total: 3527.05
Property Owner:	A. E. TOLLEY and F. O. TOLLEY	LPI Prop. Id: 2624987
Property Address:	105 Reid Street, Wilcannia	Levied: 2095.9
Description of land:	PT 5/17/759091	Chgs/Pmts: 865.2
Valuation:	\$60.00	Total: 2961.1
Property Owner:	ERIC MAH	LPI Prop. Id: 2624986
Property Address:	109-111 Reid Street, Wilcannia	Levied: 2181.37
Description of land:	1//907211	Chgs/Pmts: 1069.1
Valuation:	\$150.00	Total: 3250.47
Property Owner:	ERIC MAH	LPI Prop. Id: 2624985
Property Address:	123 Reid Street, Wilcannia	Levied: 4698.27
Description of land:	1, 2, 3, 4, 5, 6, 7, 8, 9, 10, 11//1470 3/17/759091	Chgs/Pmts: 5977.42
Valuation:	\$720.00	Total: 10675.69
Property Owner:	ERIC MAH	LPI Prop. Id: 2625086
Property Address:	1 Wills Street, Wilcannia	Levied: 2009.31
Description of land:	1//1509	Chgs/Pmts: 1197.67
Valuation:	\$100.00	Total: 3206.98

In Default of payment to the Council of the amount stated above and any other rates (including extra charges) becoming due and payable after publication of this notice, before the time fixed for the sale, the said land will be offered for sale by public auction.

SALE OF LAND FOR UNPAID RATES

The Central Darling Shire Council wishes to advise the general public that the sale of land on unpaid rates will be taking place at the following locations and dates:

INFORMATION DAYS:

Date:	Town:	Time:	Venue:
15 April 2004	Menindee	9:00 am	Menindee Hall
	Ivanhoe	3:00 pm	Ivanhoe Hall
16 April 2004	Wilcannia	9:00 am	Wilcannia Hall
	White Cliffs	4:00 pm	White Cliffs Hall

SALE:				No of Blocks
5 May 2004	Menindee	9:00 am	Menindee Hall	6
	Ivanhoe	3:00 pm	Ivanhoe Hall	6
6 May 2004	Wilcannia	9:00 am	Wilcannia Hall	40
	White Cliffs	4:00 pm	White Cliffs Hall	7

For further information please do not hesitate to contact Kylie Smith at Central Darling Shire Council on (08) 8091 5909 or email: council@centraldarling.nsw.gov.au. BILL O'BRIEN, General Manager, Central Darling Shire Council, 21 Reid Street, Wilcannia, NSW 2836. [0052]

ESTATE NOTICES

NOTICE of intended distribution of estate.—Any person having any claim upon the estate of RONALD JAMES McBURNEY, late of Cabramatta, in the State of New South Wales, who died on 3 July 2003, must send particulars of his claim to the executrix, Gwennyth Anne Brown (in the will called Gwenneth Anne Brown), c.o. Kencalo & Ritchie, Solicitors, 96 Moore Street, Liverpool, NSW 2170, within one (1) calendar month from publication of this notice. After that time the executrix may distribute the assets of the estate having regard only to the claims of which at the time of distribution she has notice. Probate was granted in New South Wales on 9 January 2004. KENCALO & RITCHIE, Solicitors, 96 Moore Street, Liverpool, NSW 2170 (PO Box 651, Liverpool BC 1871) (DX5003, Liverpool), tel.: (02) 9602 8333. Reference: 1K/03/4428. [0043]

NOTICE of intended distribution of estate.—Any person having any claim upon the estate of FREDERICK JAMES LAIT, late of Canley Vale Nursing Home, in the State of New South Wales, who died on 4 July 2003, must send particulars of his claim to the executors, Una Jean Bridge and Neil Bridge, c.o. Kencalo & Ritchie, Solicitors, 96 Moore Street, Liverpool, NSW 2170, within one (1) calendar month from publication of this notice. After that time the executors may distribute the assets of the estate having regard only to the claims of which at the time of distribution they have notice. Probate was granted in New South Wales on 5 January 2004. KENCALO & RITCHIE, Solicitors, 96 Moore Street, Liverpool, NSW 2170 (PO Box 651, Liverpool BC 1871) (DX5003, Liverpool), tel.: (02) 9602 8333. Reference: 1K/03/4424. [0044]

NOTICE of intended distribution of estate.—Any person having any claim upon the estate of GERTRUDE MAY GWILLIAM, late of Yagoona Nursing Home, 253 Cooper Road, Yagoona, in the State of New South Wales, who died

on 18 August 2003, must send particulars of his claim to the executor, Vernon Vaughan Gwilliam, c.o. Colin J. Duff, Solicitor, 7 Morts Road, Mortdale, NSW 2223, within one (1) calendar month from publication of this notice. After that time the assets of the estate may be conveyed and distributed having regard only to the claims of which at the time of conveyance or distribution the executor has notice. Probate was granted in New South Wales on 17 December 2003. COLIN J. DUFF, Solicitor, 7 Morts Road, Mortdale, NSW 2223 (DX11307, Hurstville), tel.: (02) 9570 2022. [0045]

NOTICE of intended distribution of estate.—Any person having any claim upon the estate of MARK SIMON HARRISON, late of 18 Wills Road, Long Point, in the State of New South Wales, unemployed, who died on 19 October 2002, must send particulars of his/her claim to the administrators, Marie Harrison and Bruce Harrison, c.o. Doherty Partners, Solicitors, Level 1, 171 Bigge Street, Liverpool, NSW 2170, within one (1) calendar month from publication of this notice. After that time the assets of the estate may be conveyed and distributed having regard only to the claims of which at the time of distribution the administrators have notice. Letters of Administration were granted in New South Wales on 29 December 2003. DOHERTY PARTNERS, Solicitors, Level 1, 171 Bigge Street, Liverpool, NSW 2170 (PO Box 1163, Liverpool BC 1871) (DX5034, Liverpool), tel.: (02) 9601 7300. Reference: JULIE SHEDDEN:RAS:22056. [0047]

COMPANY NOTICES

NOTICE of final general meeting.—TOOLSHEED SYDNEY SOUTH PTY LIMITED, ACN 000 633 607.—Notice is hereby given that in terms of the Corporations Act a final general meeting of the company will be held at the office of the liquidator, Suite 3/11 West Street, North Sydney, NSW 2060, at 9:00 a.m., on 27 February 2004, for the purpose of having laid before it by the liquidator an

account showing how the winding up has been conducted and the property of the company disposed of. Dated this 22nd day of January 2004. E. M. COWLEY, Liquidator, c.o. E. M. Cowley & Co., Chartered Accountants, 3/11 West Street, North Sydney, NSW 2060, tel.: (02) 9955 6488. [0046]

NOTICE of members' voluntary liquidation.—FIRSTCALL BEST SOLUTION PTY LIMITED.—Notice is hereby given that at an extraordinary general meeting of members of the abovenamed company held on 19 January 2004, it was resolved to wind up the company as a members' voluntary liquidation and that Bun Kiem Lee, Chartered Accountant, was appointed to act as liquidator. BUN KIEM LEE, Chartered Accountant, c.o. Mitchell & Partners, Suite 1, Level 2, 1 York Street, Sydney, NSW 2000, tel.: (02) 9251 3838. Reference: kl:mw. [0048]