



Government Gazette

OF THE STATE OF
NEW SOUTH WALES

Number 3
Friday, 7 January 2005

Published under authority by Government Advertising and Information

OFFICIAL NOTICES

Appointments

REGISTRAR GENERAL ACT 1973

Appointment of Deputy Registrars General
Department of Lands

THE following officers are recommended for appointment as Deputy Registrars General pursuant to section 3 of the Registrar General Act 1973:

Warrick Kevin BEACROFT, Barry Frederick DOUSE,
Douglas Eric WALSHAM, Grahame Michael WALLIS,
Kenneth Charles HALL and Ross Michael CLEARY.

WARWICK WATKINS,
Director General

TONY KELLY, M.L.C.,
Minister for Lands

Department of Infrastructure, Planning and Natural Resources

Infrastructure and Planning



New South Wales

Kiama Local Environmental Plan 1996 (Amendment No 60)

under the

Environmental Planning and Assessment Act 1979

I, the Minister Assisting the Minister for Infrastructure and Planning (Planning Administration), make the following local environmental plan under the *Environmental Planning and Assessment Act 1979*. (W03/00002/PC)

DIANE BEAMER, M.P.,
Minister Assisting the Minister for Infrastructure
and Planning (Planning Administration)

Clause 1 Kiama Local Environmental Plan 1996 (Amendment No 60)

Kiama Local Environmental Plan 1996 (Amendment No 60)

under the

Environmental Planning and Assessment Act 1979

1 Name of plan

This plan is *Kiama Local Environmental Plan 1996 (Amendment No 60)*.

2 Aims of plan

This plan aims to amend *Kiama Local Environmental Plan 1996 (the 1996 plan)*:

- (a) to rezone part of the land to which this plan applies for business and residential purposes, and
- (b) to amend certain provisions of the 1996 plan to restrict subdivision of existing large lots in rural and environmental protection (scenic) zones, and
- (c) to provide for the development of several sites in accordance with requirements in the 1996 plan and with regard to a master plan prepared to guide the development of those sites, and
- (d) to allow, with the consent of the Council of the Municipality of Kiama, the carrying out of development for the purpose of an existing motel and restaurant to be converted to serviced apartments.

3 Land to which plan applies

- (1) To the extent that this plan rezones land, it applies to certain land near Bong Bong Street, at the corner of Hothersal and Gipps Streets and in Farmer Street, Kiama, as shown edged heavy black on Sheets 1–3 of the map marked “Kiama Local Environmental Plan 1996 (Amendment No 60)” deposited in the office of the Council of the Municipality of Kiama.
- (2) To the extent that this plan restricts subdivision of existing large lots, it applies to land zoned Rural “A” and Rural Environmental Protection (Scenic) under the 1996 plan.

Kiama Local Environmental Plan 1996 (Amendment No 60)

Clause 4

-
- (3) To the extent that this plan enables development of certain sites after consideration of a master plan, it applies to land at the corner of Manning and Terralong Streets, Kiama (known as “Commonwealth Bank Corner”), to the east of Manning Street, Kiama (known as the “New ‘Church Lane’ Sub-Precinct”), at the corner of Jupiter and Morrow Streets, Gerringong (known as the “Boat Harbour Mixed Residential Precinct”), and at Belvedere Street, Kiama, as shown edged heavy black and diagonally hatched on Sheets 5, 6, 7 and 8, respectively, of that map.
 - (4) To the extent that this plan permits an additional use, it applies to land in Fern Street, Gerringong, as shown edged heavy black on Sheet 9 of that map.
 - (5) This plan does not apply to land shown as “deferred matter” on Sheets 1 and 4 of that map, which has been excluded from this plan under section 68 (5) of the *Environmental Planning and Assessment Act 1979*.

4 Amendment of Kiama Local Environmental Plan 1996

Kiama Local Environmental Plan 1996 is amended as set out in Schedule 1.

Kiama Local Environmental Plan 1996 (Amendment No 60)

Schedule 1 Amendments

Schedule 1 Amendments

(Clause 4)

[1] Clause 6 Definitions

Insert in appropriate order in the definition of *the map* in clause 6 (1):

Kiama Local Environmental Plan 1996 (Amendment No 60),
Sheets 1–3

[2] Clause 10 Rural “A” Zone—Subdivision

Omit clause 10 (4) (a). Insert instead:

- (a) the allotment having an area no greater than 4,000 square metres will be used for the purpose of a dwelling and is being excised from a parcel of land, consolidated into a single lot after the commencement of *Kiama Local Environmental Plan 1996 (Amendment No 60)*, comprised of two or more former lots in the same ownership having a combined area of 60.4 hectares or more, and

[3] Clause 30 Rural Environmental Protection (Scenic) Zone—Subdivision

Omit clause 30 (4) (a). Insert instead:

- (a) the allotment having an area no greater than 4,000 square metres will be used for the purpose of a dwelling and is being excised from a parcel of land, consolidated into a single lot after the commencement of *Kiama Local Environmental Plan 1996 (Amendment No 60)*, comprised of two or more former lots in the same ownership having a combined area of 60.4 hectares or more, and

[4] Part 9A

Insert after clause 47:

Part 9A Master plan development

47AA Definitions

In this Part:

master plan means an instrument and supporting diagrams, or a number of instruments and supporting diagrams, that outline proposals and principles to guide master plan development of a master plan site.

Kiama Local Environmental Plan 1996 (Amendment No 60)

Amendments

Schedule 1

master plan development for a master plan site, means development described in Schedule 5 as master plan development for the master plan site.

master plan site means land described in Schedule 5 as a master plan site.

47AB Development of master plan sites

- (1) Despite any other provision of this plan, master plan development may be carried out with development consent on a master plan site, but only if:
 - (a) the development complies with the development requirements specified for the site in Schedule 5, and
 - (b) the consent authority has taken into consideration the master plan for the site as adopted by the Council for the time being in accordance with this Part.
- (2) Provisions or instruments identified in Schedule 5 as comprising the initial master plan for a master plan site are taken to have been adopted by the Council with the approval of the Minister in accordance with this Part as a master plan at the commencement of this Part, but nothing prevents the amendment or replacement of any such master plan in accordance with this Part.
- (3) *State Environmental Planning Policy No 1—Development Standards* does not apply to any development standard imposed on master plan development by a development requirement specified in Schedule 5, except as provided otherwise in that Schedule.
- (4) *State Environmental Planning Policy No 71—Coastal Protection* does not require a master plan to be adopted by the Minister under that Policy before consent is granted for master plan development of a master plan site.
- (5) The Council must make a copy of each master plan, as adopted by the Council for the time being, available for inspection at the office of the Council during ordinary office hours.
- (6) Nothing in this Part prevents development from being carried out on a master plan site in accordance with the other provisions of this plan, subject to the conditions of any consent granted for master plan development.

Kiama Local Environmental Plan 1996 (Amendment No 60)

Schedule 1 Amendments

47AC Amendment or replacement of master plans

- (1) A master plan for a master plan site, as adopted by the Council for the time being, may be amended, or revoked and replaced, by a subsequent master plan adopted by the Council in accordance with this clause.
- (2) A master plan may be amended or revoked and replaced only if the master plan as proposed to be amended or the replacement master plan will illustrate and demonstrate proposals for the following:
 - (a) the use or uses to be carried out on the development site, including the use of buildings,
 - (b) design principles drawn from an analysis of the development site and its context,
 - (c) desired future locality character,
 - (d) the location of any development, considering the natural features of the site, including coastal processes and coastal hazards,
 - (e) the scale of any development and its integration with the existing landscape,
 - (f) impact on, and improvements to, the public domain,
 - (g) phasing of development,
 - (h) public access to and along the coastal foreshore,
 - (i) pedestrian, cycle and road access and circulation networks,
 - (j) subdivision pattern,
 - (k) infrastructure provision,
 - (l) building envelopes and built form controls,
 - (m) heritage conservation, including both Aboriginal and European heritage,
 - (n) remediation of the site,
 - (o) provision of public facilities and services,
 - (p) car parking provision,
 - (q) provision of open space, its function and landscaping,
 - (r) conservation of natural waters, including their riparian corridors, water quality and use,
 - (s) identification and conservation of native flora and fauna and their habitat on the site, including any threatened species, populations or ecological communities,
 - (t) conservation of fish and aquatic animals and their habitats.

Kiama Local Environmental Plan 1996 (Amendment No 60)

Amendments

Schedule 1

-
- (3) A draft master plan prepared to amend, or to revoke and replace, a master plan must be publicly exhibited by the Council for not less than 28 days and a copy must be sent to the Director-General.
 - (4) After considering any written submissions made to it within that time, the Council:
 - (a) with the approval of the Minister, may adopt the draft master plan either with or without alteration, or
 - (b) may reject the draft master plan.
 - (5) The Minister is taken to have approved adoption of a draft master plan if, within 28 days after a copy of it was sent to the Director-General, neither the Director-General nor the Minister has made any written response to the Council concerning adoption of the draft master plan.
 - (6) Before adopting a draft master plan that has been altered, the Council must re-exhibit it with the alterations:
 - (a) if the Minister has required re-exhibition, or
 - (b) if the Council is of the opinion that the alterations are sufficiently significant to require re-exhibition.
 - (7) When the Council adopts a draft master plan, it must:
 - (a) notify the Minister, the person who prepared the master plan (if it was not the Council) and any person who made a written submission about it of the adoption of the master plan, and
 - (b) advertise the adoption of the master plan in a newspaper circulating in the locality, and
 - (c) make a copy of the adopted master plan available for inspection at the office of the Council during ordinary office hours.

[5] Schedule 4 Development for certain additional purposes

Insert at the end of the Schedule:

- Lot 900, DP 616677, No 1 Fern Street, Gerringong, as shown edged heavy black on Sheet 9 of the map marked “Kiama Local Environmental Plan 1996 (Amendment No 60)” —development of the existing building (that was used before the commencement of this item as a motel and restaurant) for the purpose of serviced apartments that do not include residential accommodation for permanent residents.

Kiama Local Environmental Plan 1996 (Amendment No 60)

Schedule 1 Amendments

[6] **Schedule 5**

Insert after Schedule 4:

Schedule 5 Development of master plan sites

(Clauses 47AA and 47AB)

1 Commonwealth Bank Corner master plan site

Land fronting Manning Street and Terralong Street, Kiama, as shown edged heavy black and with diagonal hatching on Sheet 5 of the map marked “Kiama Local Environmental Plan 1996 (Amendment No 60)”.

Master plan development for this site

Development for the purpose of mixed tourist, commercial, retail and residential uses that meets the *Kiama Town Centre Charrette Objectives* (in so far as they relate to this master plan site) and the *Design Brief for Commonwealth Bank Corner*, copies of which are available at the office of the Council.

Initial master plan

The section titled *Indicative Design for the Commonwealth Bank Corner* and other provisions that relate to this master plan site in the report titled *Kiama Town Centre Charrette 25–29th July 2002—A report on the Charrette Outcomes* (the ***Kiama Charrette Report***), copies of which are available at the office of the Council, comprise the initial master plan for this site.

Development requirements

The following requirements apply to master plan development on this site:

- (a) lots must be consolidated to create a single lot with not less than the minimum area required for this site by the Kiama Charrette Report,
- (b) the single lot must be occupied by a significant building in which the mixed tourist, commercial, retail and residential uses will be carried out,

Kiama Local Environmental Plan 1996 (Amendment No 60)

Amendments

Schedule 1

-
- (c) the building may have a maximum building height of 4 storeys above ground level, subject to there being terraces not less than 3 metres wide along more than half of the top floor punctuated by corner and centrally disposed habitable towers aligning with the street-front property lines of the building as described in the Kiama Charrette Report,
 - (d) the building must include a hotel with a reception area and related restaurants, cafes and shops at street level,
 - (e) the building must be designed so that people visiting the building will have access to indoor and outdoor areas on the top floor and so that use of the top floor will encourage such access (for example, a restaurant or function room would be a suitable use for the top floor),
 - (f) the architectural design of the building must have regard to the heritage value of the streetscapes of the streets to which it has frontage. The building must have a traditional and reasonably symmetrical exterior that, in the opinion of the consent authority, makes a landmark contribution to Kiama's character. There must be double verandahs over the footpaths of both Terralong and Manning Streets that are at least 2 metres deep. All window and door openings and spacings between verandah posts must have greater height than width and be vertically aligned between floors as described in the Kiama Charrette Report,
 - (g) a basement storey for car parking is to be located below ground level with some unenclosed on-site parking at grade behind the location of the L-shaped building shown in the Kiama Charrette Report "indicative design".

For the purpose of allowing development to be carried out in accordance with the above development requirements, *State Environmental Planning Policy No 1—Development Standards* applies to a maximum floorspace ratio set by clause 21 to the extent that compliance with that development standard would be unreasonable or unnecessary to achieve the setbacks shown for buildings on this site in the Kiama Charrette Report "indicative design".

Kiama Local Environmental Plan 1996 (Amendment No 60)

Schedule 1 Amendments

2 New “Church Lane” sub-precinct master plan site

Land to the east of Manning Street, Kiama, as shown edged heavy black and with diagonal hatching on Sheet 6 of the map marked “Kiama Local Environmental Plan 1996 (Amendment No 60)”.

Master plan development for this site

Development for the purpose of mixed uses, including shops, commercial premises and serviced apartments and residential apartments above the ground level storey, that meets the *Kiama Town Centre Charrette Objectives* (in so far as they relate to this master plan site) and the *Design Brief for Church Lane*, copies of which are available at the office of the Council.

Initial master plan

The section titled *Indicative Design for Church Lane* and other provisions that relate to this master plan site in the report titled *Kiama Town Centre Charrette 25–29th July 2002—A report on the Charrette Outcomes*, copies of which are available at the office of the Council, comprise the initial master plan for this site.

Development requirements

The following requirements apply to master plan development on this site:

- (a) the building may have a maximum building height of 4 storeys above ground level, subject to top floor terraces being provided to residential or serviced apartments facing streets for at least half those street frontages,
- (b) the building must include shops and commercial premises, serviced apartments, visitor accommodation and home based businesses or church-related uses at the street level with residential or serviced apartments above,
- (c) the architectural design of buildings must have regard to the heritage value of the streetscapes of the streets to which they have frontage. The building must have a traditional and reasonably symmetrical exterior that, in the opinion of the consent authority, makes a sympathetic contribution to Kiama’s visual character. There must be verandahs at least 2 metres deep at ground level. All window and door openings and spacings between verandah posts must have greater height than width and be vertically aligned between floors,

Kiama Local Environmental Plan 1996 (Amendment No 60)

Amendments

Schedule 1

-
- (d) On-site parking at grade is to be minimised and must be located behind buildings rather than in front of them. Below ground basement parking is to be provided for residential development.

For the purpose of allowing development to be carried out in accordance with the above development requirements, *State Environmental Planning Policy No 1—Development Standards* applies to a maximum floorspace ratio set by clause 21 to the extent that compliance with that development standard would be unreasonable or unnecessary to achieve the setbacks shown for buildings on this site in the Kiama Charrette Report “indicative design”.

3 Boat Harbour Gerringong mixed residential precinct master plan site

Land fronting Coal, Jupiter and Morrow Streets, Gerringong, as shown edged heavy black and hatched on Sheet 7 of the map marked “Kiama Local Environmental Plan 1996 (Amendment No 60)”.

Master plan development for this site

Development for the purpose of a residential flat building.

Initial master plan

The instrument titled *Mixed Residential Housing Precinct Boat Harbour Gerringong*, prepared by PRM Architects + Town Planners and dated 25 November 2002, copies of which are available at the office of the Council, amended to the extent necessary to allow development on this site to comply with any inconsistent development requirements specified below, comprises the initial master plan for this site.

Development requirements

The following requirements apply to master plan development on this site:

- (a) buildings are to be grouped in the locations shown in the instrument titled *Mixed Residential Housing Precinct Boat Harbour Gerringong*,
- (b) the number of dwellings is not to exceed 49,
- (c) building height is not to exceed:
 - (i) 3 storeys where the lowest storey is identified in the initial master plan as providing basement underground car parking, and

Kiama Local Environmental Plan 1996 (Amendment No 60)

Schedule 1 Amendments

-
- (ii) 2 storeys plus loft room in a building identified for the purpose in the initial master plan and situated on another part of the site, and
 - (iii) 2 storeys elsewhere on the site,
 - (d) the existing 3 mature fig trees on the site must be retained and buildings designed in a manner that will not interfere with these trees including their root systems,
 - (e) a new public street (identified in the initial master plan as "Harbour Link Road") having an overall road reserve width of 8 metres must be provided through the site, in the same or approximately the same location as shown in the initial master plan,
 - (f) part of the site must be dedicated to the Council for public road widening purposes in Morrow Street to provide a variable width street enabling two-way vehicular movement, car parking and a pedestrian footpath,
 - (g) all requirements of this plan and of development control plans that apply to development for the purpose of multiple dwelling housing in Zone No 2 (a), except to the extent, if any, those requirements:
 - (i) are inconsistent with any other of the development requirements included in this item, or
 - (ii) would prevent master plan development for this site from being carried out.

4 Belvedere Street master plan site

Lot 5, DP 628003, Belvedere Street, Kiama (which also has frontage to Garden Avenue), as shown edged heavy black and with diagonal hatching on Sheet 8 of the map marked "Kiama Local Environmental Plan 1996 (Amendment No 60)".

Master plan development for this site

Development for the purpose of residential flat buildings comprised of groups of buildings.

Initial master plan

The instrument titled *Garden Avenue Housing*, prepared by BHI Architects and dated September 2003, copies of which are available at the office of the Council, amended to the extent necessary to allow development on this site to comply with any inconsistent development requirements specified below, comprises the initial master plan for this site.

Kiama Local Environmental Plan 1996 (Amendment No 60)

Amendments

Schedule 1

Development requirements

The following requirements apply to master plan development on this site:

- (a) buildings are to be grouped in the locations shown in the instrument titled *Garden Avenue Housing*,
- (b) the number of dwellings is not to exceed 40, and the single detached lot shown on the master plan drawings that is accessed from Garden Avenue is taken to be required to be used for public purposes, including a public pedestrian access linking to the unformed Thomson Street road reserve and then to the adjacent Stead Reserve,
- (c) building height is not to exceed 2 storeys,
- (d) all requirements of this plan and of development control plans that apply to development for the purpose of multiple dwelling housing in Zone No 2 (a), except to the extent, if any, that those requirements:
 - (i) are inconsistent with any other of the development requirements included in this item, or
 - (ii) would prevent master plan development for this site from being carried out,
- (e) the consent authority is satisfied that the design of the turning head in Garden Avenue south will ensure minimum adverse impact on the creek corridor,
- (f) at least 2 of the dwellings resulting from carrying out the development are designed with a floor plan suited to the needs of seniors or people with a disability,
- (g) the consent authority is satisfied that environmental restoration and management of the creek corridor will be adequate, and that limited public access will be provided, as referred to in the *Garden Avenue Development Strategy Report*, copies of which are available from the office of the Council.



Tweed Local Environmental Plan 2000 (Amendment No 46)

under the

Environmental Planning and Assessment Act 1979

I, the Minister Assisting the Minister for Infrastructure and Planning (Planning Administration), make the following local environmental plan under the *Environmental Planning and Assessment Act 1979*. (G03/00062/PC)

DIANE BEAMER, M.P.,
Minister Assisting the Minister for Infrastructure
and Planning (Planning Administration)

Clause 1 Tweed Local Environmental Plan 2000 (Amendment No 46)

Tweed Local Environmental Plan 2000 (Amendment No 46)

under the

Environmental Planning and Assessment Act 1979

1 Name of plan

This plan is *Tweed Local Environmental Plan 2000 (Amendment No 46)*.

2 Aims of plan

This plan aims to amend *Tweed Local Environmental Plan 2000* so as:

- (a) to change the interpretation of building height to reflect finished ground level rather than natural ground level, and
- (b) to change the definition of *storey* so that a storey that exceeds a specified height is counted as two storeys.

3 Land to which plan applies

This plan applies to all land to which *Tweed Local Environmental Plan 2000* applies.

4 Amendment of Tweed Local Environmental Plan 2000

Tweed Local Environmental Plan 2000 is amended as set out in Schedule 1.

Tweed Local Environmental Plan 2000 (Amendment No 46)

Amendments

Schedule 1

Schedule 1 Amendments

(Clause 4)

[1] Clause 16 Height of buildings

Insert after clause 16 (2):

- (3) If an application for development consent made to the consent authority prior to the commencement of *Tweed Local Environmental Plan 2000 (Amendment No 46)* is not determined by the consent authority before that date:
 - (a) the amendments made to Schedule 1 to this plan by *Tweed Local Environmental Plan 2000 (Amendment No 46)* do not apply to the determination of the application, and
 - (b) the application is to be determined under this plan as if those amendments had not been made (that is, having regard to the definitions of **height** in relation to a building and **storey** in force under this plan immediately before that commencement).

[2] Schedule 1 Meanings of terms

Insert in alphabetical order:

- | | |
|---|--|
| <p><i>finished ground level,</i>
in relation to
land</p> | <p>means the following (and, if more than one of the following paragraphs applies in relation to the land, whichever is the highest):</p> <ol style="list-style-type: none"> (a) the natural ground level of the land that was the level of the land at the appointed day, or the level of the land after such earthworks (excluding any basement excavations) as are consented to by the consent authority, whichever is the lower, (b) the level of the land approved by the consent authority as the finished ground level of the land prior to the commencement of <i>Tweed Local Environmental Plan 2000 (Amendment No 46)</i>, |
|---|--|

Tweed Local Environmental Plan 2000 (Amendment No 46)

Schedule 1 Amendments

-
- (c) if the land is within an area identified by the Council as flood liable land, the level of the land after filling the land in accordance with the consent of the consent authority to the adopted design flood level under *Tweed Development Control Plan No 5—Development of Flood Liable Land*, as adopted by the Council on 6 March 1996.

[3] Schedule 1, definition of “height” in relation to a building

Omit “natural ground level”. Insert instead “finished ground level”.

[4] Schedule 1, definition of “storey”

Omit the definition. Insert instead:

storey

means:

- (a) the space between two floors, or
- (b) the space between a floor and any ceiling or roof immediately above it, or
- (c) foundation areas, garages, workshops, storerooms and the like, excluding access paths to basement areas, where the height between the finished ground level and the top of the floor immediately above them exceeds 1.5 metres in height.

A storey which exceeds 4.5 metres for residential buildings is counted as two storeys.

A storey which exceeds 5 metres for commercial buildings is counted as two storeys.

For the purpose of counting the number of storeys in a building, the number is to be the maximum number of storeys of the building which may be intersected by the same vertical line, not being a line which passes through any wall of the building.

Natural Resources

WATER ACT 1912

APPLICATIONS for a licence under the section 10 of Part 2 of the Water Act 1912, as amended, has been received as follows:

Michael Fraser PEEL, John Butler KENNY and Peter Wilfred McGEE for a pump on the Nepean River on Part 4/1071699, Parish of Weromba, County of Camden, for water supply for stock and domestic purposes and the irrigation of 9.0 hectares (improved pasture – part replacement licence – part replaces 10SL28371 and fully replaces 10SL21043 – no increase in authorised area – no increase in annual water allocation – not subject to the 1995 Hawkesbury/Nepean embargo) (Reference: 10SL56623) (GA2:493391).

John Butler KENNY and Peter Wilfred McGEE for a pump on the Nepean River on Part 4/1071699, Parish of Weromba, County of Camden, for water supply for stock and domestic purposes and the irrigation of 4.0 hectares (part replacement licence – part replaces 10SL28371 – no increase in authorised area – no increase in annual water allocation – not subject to the 1995 Hawkesbury/Nepean embargo) (Reference: 10SL56624) (GA2:493391).

Glen Robert DENHOLM, Wendy Ann DENHOLM, John Butler KENNY and Peter Wilfred McGEE for a pump on the Nepean River on Part 4/1071699, Parish of Weromba, County of Camden, for water supply for stock and domestic purposes and the irrigation of 8.0 hectares (lucerne, improved pasture) (part replacement licence – part replaces 10SL28371 – no increase in authorised area – no increase in annual water allocation – not subject to the 1995 Hawkesbury/Nepean embargo) (Reference: 10SL56625) (GA2:493391).

Cindy Michelle DOWSE for a pump on the Tuglow River on Lot 1/85207, Parishes of Kowmung and Drogheda, 55/757049, Parish of Drogheda and 3/757060 and 78/757060, Parish of Kowmung, all County of Westmoreland, for the irrigation of 10.0 hectares (improved pasture) (part replacement licence – part replaces 10SL56350 – no increase in authorised area – no increase in annual water allocation – not subject to the 1995 Hawkesbury/Nepean Embargo) (Reference: 10SL56626) (GA2:493318).

Any inquiries regarding the above should be directed to the undersigned (telephone: 9895 7194).

Written objections specifying grounds thereof must be lodged with the Department within twenty-eight (28) days of the date of this publication as prescribed by the Act.

WAYNE CONNERS,
Natural Resource Project Officer,
Sydney/South Coast Region

Department of Infrastructure, Planning and
Natural Resources,
PO Box 3935, Parramatta NSW 2124.

Department of Lands

DUBBO OFFICE

142 Brisbane Street (PO Box 865), Dubbo NSW 2830

Phone: (02) 6841 5200 Fax: (02) 6841 5231

NOTIFICATION OF CLOSING OF ROADS

IN pursuance of the provisions of the Roads Act 1993, the roads hereunder specified are closed and the lands comprised therein are freed and discharged from any rights of the public or any other person to the same as highways.

TONY KELLY, M.L.C.,
Minister for Lands

Description

*Local Government Area of Coolah;
Land District of Dunedoo.*

Lot 2, DP 1075944, Parish of Dunedoo, County of Lincoln
(not being land under the Real Property Act).

File No.: DB01 H 557/2.

Note: On closing, the title for Lot 2 shall remain vested in
The State of New South Wales as Crown Land.

FAR WEST REGIONAL OFFICE
45 Wingewarra Street (PO Box 1840), Dubbo NSW 2830
Phone: (02) 6883 3000 Fax: (02) 6883 3099

ERRATA

IN the notification appearing in the *Government Gazette* of 26 November 2004, Folio 8804, under the heading Assignment of Name to a Reserve Trust in the last Schedule showing Yantabulla Recreation Reserve B Trust in Column 1 Reserve No. 86815 Public Purpose: Public Recreation Notified: 2 August 1968 should not have appeared in Column 2

(WL99R48)

TONY KELLY, M.L.C.,
 Minister for Lands

IN the notification appearing in the *Government Gazette* of 10 September 2004, Folio 7492, under the heading Forfeiture of a Western Lands Lease (being Western Lands Lease 10759), the description of the area forfeited should have read Lot 2 Section 12 DP 758612.

ALTERATION OF PURPOSE OF A WESTERN LANDS LEASE

IT is hereby notified that in pursuance of the provisions of section 18J, Western Lands Act 1901, the purpose and conditions of the undermentioned Western Lands Lease have been altered as shown.

CRAIG KNOWLES, M.P.,
 Minister for Infrastructure and Planning
 and Minister for Natural Resources

Description

*Administrative District – Balranald; Shire – Balranald;
 Parish – Nullawong and Yough; County – Caira.*

The purpose of Western Lands Lease 11494, being the land contained within Folio Identifier 4189/766756 has been altered from "Grazing" to "Grazing and Feedlot" effective from 11 October 2004.

As a consequence of the alteration of purpose rent will be assessed annually in line with the Western Lands Act 1901 and Regulations.

The conditions have been altered by the inclusion of the special conditions following.

SPECIAL CONDITIONS ATTACHED TO WESTERN LANDS LEASE 11494

1. The lessee shall only conduct a feedlot within the area of 5 hectares indicated on the diagram hereunder. Any other feedlot operation outside this area will only be allowable with the consent of the Commissioner or the Minister.
2. The lessee shall not clear any native vegetation or remove any timber within the area of the feedlot unless written approval has been granted by either the Commissioner or the Minister.
3. The lessee shall ensure that the feedlot and associated activities do not interfere with any road formation within the allowable area.

4. Aboriginal sites are protected under the National Parks and Wildlife Act 1974, and are extremely vulnerable to many kinds of agricultural development.

Should any Aboriginal archaeological relics or sites be uncovered during the proposed works, work is to cease immediately. The lessee must consider the requirements of the National Parks and Wildlife Act 1974, with regard to Aboriginal relics. Under Section 90 it is an offence to damage or destroy relics without prior consent of the Director-General of the Department of Environment and Conservation.

If an Aboriginal site is found in this area, the subject of this alteration, the activity must cease until the consent holder has notified the Department of Environment and Conservation of the existence of the Aboriginal site. Contact details are: The Manager, Cultural Heritage Unit, Department of Environment and Conservation, Phone (02) 6883 5324 or at 58-62 Wingewarra Street, Dubbo.

5. The lessee shall establish windbreaks at his/her own expense as may be ordered by the Commissioner or the Minister to provide adequate protection of the soil.

6. The lessee shall undertake any appropriate measures, at his/her own expense, ordered by the Commissioner or the Minister to rehabilitate any degraded areas.

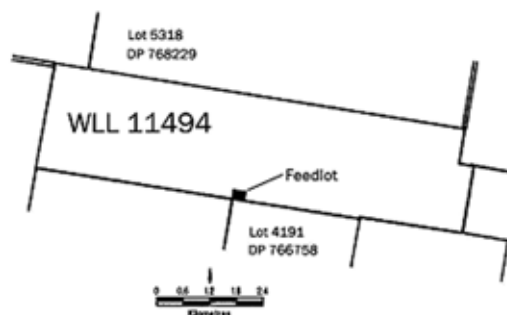

REVOCATION OF RESERVATION OF CROWN LAND

PURSUANT to section 90 of the Crown Lands Act 1989, the reservation of Crown Land specified in Column 1 of the Schedule hereunder, is revoked to the extent specified opposite thereto in Column 2 of the Schedule.

TONY KELLY, M.L.C.,
 Minister for Lands

SCHEDULE

COLUMN 1

Land District: Cobar.
 Local Government Area: Cobar Shire Council.
 Locality: Canbelego.
 Reserve No.: 84480.
 Public Purpose: Future public requirements.
 Notified: 14 June 1963.
 File No.: WL04 H 89/1.

COLUMN 2

The whole being Lot 14, section 1, DP No. 758218, Parish Florida, County Canbelego, of an area of 2061 square metres.

ESTABLISHMENT OF RESERVE TRUST

PURSUANT to section 92(1) of the Crown Lands Act 1989, the reserve trust specified in Column 1 of the Schedules hereunder, is established under the name stated in that Column and is appointed as trustee of the reserve specified opposite thereto in Column 2 of the Schedules.

TONY KELLY, M.L.C.,
Minister for Lands

SCHEDULE 1**COLUMN 1**

Rubbish Depot Menindee Reserve Trust.

COLUMN 2

Reserve No.: 90833.
Public Purpose: Rubbish depot.
Notified: 15 July 1977.
File No.: WL87 R 79/1.

SCHEDULE 2**COLUMN 1**

Rubbish Depot White Cliffs Reserve Trust.

COLUMN 2

Reserve No.: 97755.
Public Purpose: Rubbish depot.
Notified: 4 April 1985.
File No.: WL86 R 78/1.

SCHEDULE 3**COLUMN 1**

Rubbish Depot Wilcannia Reserve Trust.

COLUMN 2

Reserve No.: 90899.
Public Purpose: Rubbish depot.
Notified: 16 September 1977.
File No.: WL86 R 59/1.

APPOINTMENT OF CORPORATION TO MANAGE RESERVE TRUST

PURSUANT to section 95 of the Crown Lands Act 1989, the corporation specified in Column 1 of the Schedules hereunder, is appointed to manage the affairs of the reserve trust specified opposite thereto in Column 2, which is trustee of the reserve referred to in Column 3 of the Schedules.

TONY KELLY, M.L.C.,
Minister for Lands

SCHEDULE 1**COLUMN 1**

Central Darling Shire Council.

COLUMN 2

Rubbish Depot Menindee Reserve Trust.

COLUMN 3

Reserve No.: 90833.
Public Purpose: Rubbish depot.
Notified: 15 July 1977.
File No.: WL87 R 79/1.

For a term commencing this day.

SCHEDULE 2**COLUMN 1**

Central Darling Shire Council.

COLUMN 2

Rubbish Depot White Cliffs Reserve Trust.

COLUMN 3

Reserve No.: 97755.
Public Purpose: Rubbish depot.
Notified: 4 April 1985.
File No.: WL86 R 78/1.

For a term commencing this day.

SCHEDULE 3**COLUMN 1**

Central Darling Shire Council.

COLUMN 2

Rubbish Depot Wilcannia Reserve Trust.

COLUMN 3

Reserve No.: 90899.
Public Purpose: Rubbish depot.
Notified: 16 September 1977.
File No.: WL86R59/1.

For a term commencing this day.

ASSIGNMENT OF NAME TO A RESERVE TRUST

PURSUANT to Clause 4(3) of Schedule 8 to the Crown Lands Act 1989, the name specified in Column 1 of the Schedule hereunder, is assigned to the reserve trust constituted as trustee of the reserve specified opposite thereto in Column 2 of the Schedule.

TONY KELLY, M.L.C.,
Minister for Lands

SCHEDULE**COLUMN 1**

Lake Benanee Reserve Trust.

COLUMN 2

Reserve No.: 64605.
Public Purpose: Recreation.
Notified: 22 June 1934.
File No.: WL86 R 278/1.

SYDNEY METROPOLITAN OFFICE
Level 12, Macquarie Tower, 10 Valentine Avenue, Parramatta 2150
(PO Box 3935, Parramatta NSW 2124)
Phone: (02) 9895 7657 Fax: (02) 9895 6227

**PLAN OF MANAGEMENT FOR A CROWN RESERVE,
 MOSMAN PARK AT MOSMAN UNDER PART 5,
 DIVISION 6 OF THE CROWN LANDS ACT 1989
 AND CROWN LANDS REGULATION 2000.**

A draft plan of management has been prepared for the Crown reserve being, Mosman Park, described hereunder, which is under the trust management of Mosman Municipal Council.

Inspection of the draft plan can be made at Mosman Council's Administration Centre, Mosman Library and can be viewed on Council's Website www.mosman.nsw.gov.au.

Representations are invited from the public on the draft plan. The Plan will be on exhibition from Monday, 10 January 2005, for a period of 40 days. Submissions will be received up to 18 February 2005 and should be sent to The General Manager, Mosman Municipal Council, PO Box 211, Spit Junction NSW 2088.

TONY KELLY, M.L.C.,
 Minister for Lands

Description of Reserve

*Land District – Metropolitan; L.G.A. – Mosman;
 Parish – Willoughby; County – Cumberland.*

Crown Reserve: Land dedicated D500470, gazetted 1 September 1900, being Lot 7116, DP 752067, being about 2.56 hectares.

Location: Bounded by Myahgah Road, The Crescent and Gouldsbury Street, Mosman.

File No.: MN85 R 155.

APPOINTMENT OF TRUST BOARD MEMBERS

PURSUANT to section 93 of the Crown Lands Act 1989, the persons whose names are specified in Column 1 of the Schedule hereunder, are appointed, for the term of office specified thereunder, as members of the trust board for the reserve trust specified opposite thereto in Column 2, which has been established and appointed as trustee of the reserve referred to opposite thereto in Column 3 of the Schedule.

TONY KELLY, M.L.C.,
 Minister for Lands

SCHEDULE

COLUMN 1	COLUMN 2	COLUMN 3
Members Appointed Steven Thomas BRETT, Bronwyn Kay MERRITT, Graeme Robert POSTLETHWAITE, Ian John Bundeluk WATSON. The person for the time being holding the office of Vice Chairperson, Darug Custodian Aboriginal Corporation - currently Chris TOBIN (ex-officio member). The person for the time being holding the office of Deputy Chair, Darug Tribal Aboriginal Corporation - currently Cheryl GOH (ex-officio member). The person for the time being holding the office of Director, Services Delivery, Baulkham Hills Shire Council - currently Russell LOYD (ex-officio member). The person for the time being holding the office of Environmental Programs Officer, Upper Parramatta River Catchment Trust - currently Peter James MORISON (ex-officio member). The person for the time being holding the office of Chairperson, Baulkham Hills Shire Bushland Conservation Committee - currently Carol ISAACS (ex-officio member).	Bidjigal (D1010489) Reserve Trust.	Land located at West Pennant Hills, North Rocks, Baulkham Hills and Castle Hill, dedicated (D1010489) on 22 October 2004, for the purposes of preservation of Aboriginal Cultural Heritage, the preservation of flora and fauna and public recreation. File No.: MN04 R 19.

Term of Office

For a period of five (5) years commencing this day.

TAREE OFFICE**98 Victoria Street (PO Box 440), Taree NSW 2430****Phone: (02) 6552 2788 Fax: (02) 6552 2816****NOTIFICATION OF CLOSING OF PUBLIC ROAD**

IN pursuance of the provisions of the Roads Act 1993, the road hereunder described is closed and the land comprised therein ceases to be a public road and the rights of passage and access that previously existed in relation to the road are extinguished.

TONY KELLY, M.L.C.,
Minister for Lands

Description

*Land District – Port Macquarie;
Local Government Area – Hastings.*

Road Closed: Lot 1, DP 1077475 at Cooperabung, Parish of Prospect, County of Macquarie.

File No.: TE03 H 252.

Note: On closing, the land within Lot 1 remains vested in the State of New South Wales as Crown Land.

WAGGA WAGGA REGIONAL OFFICE**Corner Johnston and Tarcutta Streets (PO Box 60), Wagga Wagga NSW 2650****Phone: (02) 6937 2700 Fax: (02) 6921 1851****APPOINTMENT OF TRUST BOARD MEMBERS**

PURSUANT to section 93 of the Crown Lands Act 1989, the persons whose names are specified in Column 1 of the Schedule hereunder are appointed, for the terms of office specified thereunder, as members of the trust board for the reserve trust specified opposite thereto in Column 2, which has been established and appointed as trustee of the reserve referred to opposite thereto in Column 3 of the Schedule.

TONY KELLY, M.L.C.,
Minister for Lands

SCHEDULE

COLUMN 1	COLUMN 2	COLUMN 3
Stanley Chester THELANDER (new member), Julia Lina BROWN (new member), Elsie Ann DRISCOLL (re-appointment), Margaret Gai WILLIAMS (re-appointment), Andrew SCOTT (re-appointment), Kelvin BROWN (new member), David HOLMES (new member).	Coolac Recreation Reserve and Public Hall Trust.	Dedication No.: 620029. Public Purpose: Public recreation. Notified: 13 April 1888. Reserve No.: 47671. Public Purpose: Public hall. Notified: 27 March 1912. File No.: WA99 R 6.

Term of Office

For a term commencing the date of this notice and expiring
14 October 2009.

Department of Primary Industries

NSW Fisheries

Fisheries Management (Continuation of Activities in Lowland Darling River Catchment) Interim Order 2005 No 1

under the

Fisheries Management Act 1994

I, Ian Macdonald, Minister for Primary Industries, in pursuance of section 221IG of the *Fisheries Management Act 1994*, make the following interim Order.

Dated, this 4th day of January 2005.

IAN MACDONALD, M.L.C.,
Minister for Primary Industries

Explanatory note

The aquatic ecological community in the natural drainage system of the lowland catchment of the Darling River is listed as an endangered ecological community under the *Fisheries Management Act 1994 (the Act)*.

However, the Act enables the Minister to make an order authorising a class of persons to carry out an activity that may result in harm to an endangered species, population or ecological community or damage to its habitat. While such a proposed order is being assessed under the Act, the Minister may make an interim order lasting up to 6 months to allow an existing activity to be continued. The Act also provides for the remaking of an interim order.

The object of this interim Order is to remake the *Fisheries Management (Continuation of Activities in the Lowland Darling River Catchment) Interim Order 2004 No 2* (which took effect on 4 July 2004 for a period of 6 months) to allow certain recreational and commercial fishing activities in the natural drainage system of the lowland catchment of the Darling River to continue for a further period of 6 months.

The activities the subject of this interim Order may only continue subject to compliance with any applicable fishing regulatory controls imposed by or under the *Fisheries Management Act 1994*.

The recommendation of the Fisheries Scientific Committee referred to in this interim Order is available for inspection at all NSW Fisheries Offices and on the Internet at www.fisheries.nsw.gov.au/fsc/recomend.htm.

This interim Order is made under section 221IG of the *Fisheries Management Act 1994*.

Fisheries Management (Continuation of Activities in Lowland Darling River Catchment) Interim Order 2005 No 1

under the Fisheries Management Act 1994

1 Name of interim Order

This interim Order is the *Fisheries Management (Continuation of Activities in Lowland Darling River Catchment) Interim Order 2005 Number 1*.

2 Commencement and duration

This interim Order:

- (a) takes effect on 4 January 2005 and
- (b) ceases to have effect 6 months after that day.

3 Continuation of existing activities

(1) The activities referred to in subclauses (2) and (3) may continue in the Lowland Darling River Catchment subject to compliance with any applicable fishing regulatory controls.

(2) A recreational fisher may take from the Lowland Darling River Catchment any of the following species of fish, may possess any such species of fish taken from the Lowland Darling River Catchment, or may carry out any routine activity in connection with any such taking or possession:

- (a) *Paratya australiensis* (freshwater shrimp),
- (b) *Macrobrachium australiense* (freshwater prawn),
- (c) *Caridina mccullochi* (freshwater shrimp),
- (d) *Cherax destructor* (yabby),
- (e) *Tandanus tandanus* (freshwater catfish),
- (f) *Gadopsis marmoratus* (river blackfish),
- (g) *Maccullochella peelii peelii* (Murray cod),
- (h) *Macquaria ambigua* (golden perch),
- (i) *Bidyanus bidyanus* (silver perch),
- (j) *Nematalosa erebi* (bony bream),
- (k) *Lelopotherapon unicolor* (spangled perch).

(3) A person holding a commercial fishing licence that has a Class A: Yabby and carp endorsement (transferable) in the inland restricted fishery may:

- (a) take *Cherax destructor* (yabby) from the Lowland Darling River Catchment, or
- (b) possess or sell yabby taken from the Lowland Darling River Catchment, or
- (c) carry out any routine activities in connection with any such taking, possession or sale.

(4) In this clause:

applicable fishing regulatory controls means requirements imposed by or under the *Fisheries Management Act 1994* that apply to or in respect of the activities concerned.

inland restricted fishery has the same meaning as in the *Fisheries Management (General) Regulation 2002*.

Lowland Darling River Catchment means the aquatic ecological community in the natural drainage system of the lowland catchment of the Darling River (described in the recommendation of the Fisheries Scientific Committee to list that aquatic ecological community, as the area covered by that recommendation).

Roads and Traffic Authority

ROADS ACT 1993

Notice Under Clause 17 of the Road Transport (Mass, Loading and Access) Regulation 1996

JERILDERIE SHIRE COUNCIL, in pursuance of Division 2 of Part 3 of the Road Transport (Mass, Loading and Access) Regulation 1996, by this Notice, specify the routes and areas on or in which B-Doubles may be used subject to any requirements or conditions set out in the Schedule.

DAVID TAMLYN,
Acting General Manager,
Jerilderie Shire Council
(by delegation from the Minister for Roads)

SCHEDULE

1. Citation

This Notice may be cited as the Jerilderie Shire Council B-Doubles Notice No. 3/2004.

2. Commencement

This Notice takes effect from the date of gazettal.

3. Effect

This Notice remains in force until 20 September 2007, unless it is amended or repealed earlier.

4. Application

This Notice applies to B-Doubles which comply with Schedule 1 to the Road Transport (Mass, Loading and Access) Regulation 1996 and Schedule 4 to the Road Transport (Vehicle Registration) Regulation 1998.

5. Routes

B-Double routes within the Jerilderie Shire Council.

Type	Road No.	Road Name	Starting Point	Finishing Point	Conditions
25	000	Colliers Lane	0.0km (Regional Road 323 – Oaklands Road)	1.9km South on Colliers Lane	Seasonal 1 November to 30 May

ROADS ACT 1993

Order – Sections 46, 48, 54 and 67

Wollongong City Council Area

Declaration as Freeway of part of the Southern Freeway between Mullet Creek and Illawarra Railway, Unanderra

I, the Minister for Roads, pursuant to Sections 46, 48, 54 and 67 of the Roads Act, 1993, by this order -

1. dedicate as public road the land described in Schedules 1 and 2 under;
2. declare to be a main road the said public road described in Schedule 2 and the public road described in Schedule 3 under;
3. declare to be a freeway the said main road described in Schedules 2 and 3;
4. declare that access to the said freeway is restricted; and
5. specify in Schedule 4 under, the points along the freeway at which access may be gained to or from other public roads.

CARL SCULLY MP
Minister for Roads

—————
SCHEDULE 1

ALL those pieces or parcels of land situated in the Wollongong City Council area, Parishes of Kembla and Wollongong and County of Camden shown as:

Lot 32 Deposited Plan 241455;

Lots 2 and 3 Deposited Plan 1074474;

Lots 27 and 28 Deposited Plan 259921; and

Lot 17 Deposited Plan 240859.

The above Lots are all shown on sheets 1 or 2 in RTA Plan 6006 497 AC 0231.

—————
SCHEDULE 2

ALL those pieces or parcels of land situated in the Wollongong City Council area, Parishes of Kembla and Wollongong and County of Camden shown as:

Lots 5 and 6 Deposited Plan 246076;

Lots 4 and 5 Deposited Plan 249814;

Lots 50, 51 and 52 Deposited Plan 1059023;

Lot 1442 Deposited Plan 237049;

Lot 10 Deposited Plan 258635;

Lot 14 Deposited Plan 544692;

Lots 27 to 31 inclusive and 34 Deposited Plan 241455;

Lots 20 and 21 Deposited Plan 1058587;

Lot 1 Deposited Plan 1074474;

Lots 7, 8, 10, 11, 13 and 18 to 26 inclusive Deposited Plan 259921; and

Lots 70, 71, 73, 74 and 75 Deposited Plan 259919.

The above Lots are all shown on sheets 1 or 2 in RTA Plan 6006 497 AC 0231.

—————
SCHEDULE 3

ALL those pieces or parcels of public road situated in the Wollongong City Council area, Parishes of Kembla and Wollongong and County of Camden shown as:

Lots 33 and 35 Deposited Plan 241455; and

Lots 29 and 30 Deposited Plan 259921.

The above Lots are all shown on sheets 1 or 2 in RTA Plan 6006 497 AC 0231.

—————
SCHEDULE 4

Between the points A and B;

between the points C and D;

between the points E and F; and

between the points G and H, all shown on sheets 1 or 2 in RTA Plan 6006 497 AC 0231

(RTA Papers F6/497.129)

ROADS ACT 1993

Notice of Dedication of Land as Public Road
at Belmont in the Lake Macquarie City Council area

THE Roads and Traffic Authority of New South Wales,
by its delegate, dedicates the land described in the
schedule below as public road under section 10 of the
Roads Act 1993.

T D Craig
Manager, Compulsory Acquisition & Road Dedication
Roads and Traffic Authority of New South Wales

SCHEDULE

ALL those pieces or parcels of land situated in the Lake
Macquarie City Council area, Parish of Kahibah and
County of Northumberland, shown as:

Lot 1 Deposited Plan 1064540;

Lot 1 Deposited Plan 1064512;

Lot 1 Deposited Plan 449549;

Lot 1 Deposited Plan 345210;

Lots 1 and 2 Deposited Plan 344009;

Lot 1 Deposited Plan 348350;

Lots 1 to 5 inclusive, Deposited Plan 1064685;

Lot 1 Deposited Plan 410400; and

Lot 2 Deposited Plan 333797.

(RTA Papers: 10/252.1338)

Other Notices

APPRENTICESHIP AND TRAINEESHIP TRAINING ACT 2001

Notice of Making of a Vocational Training Order

NOTICE is given that the Commissioner for Vocational Training, in pursuance of section 6 of the Apprenticeship and Traineeship Act 2001, has made the following Vocational Training Order in relation to the recognised traineeship vocation of Health Services.

Citation

The Order is cited as the Health Services Order.

Order

A summary of the Order is given below.

(a) Term of Training

(i) Full-time

Training shall be given for a nominal term of 12 months for Certificate II or 24 months for Certificate III and IV, or until achievement of the relevant competencies to this Vocational Training Order is demonstrated.

(ii) Part-time

The nominal term for a part time traineeship is determined by the average weekly hours worked in the traineeship (including structured training) and the nominal full-time term for that traineeship.

The table below identifies the allowable hours which may be undertaken and the nominal terms for part-time traineeships.

Full-time Traineeship Term	6 mths	12 mths	18 mths	24 mths	30 mths	36 mths	48 mths
Weekly Hours	Nominal Term Required (Months)						
15	15	30	45	Not Allowable			
16	15	29	44				
17	14	28	42				
18	14	27	41				
19	13	26	39				
20	13	25	38				
21	12	24	36	48			
22	12	23	35	46			
23	11	22	33	44	55		
24	11	21	32	42	53		
25	10	20	30	40	50	60	
26	10	19	29	38	48	57	
27	9	18	27	36	45	54	72
28	9	17	26	34	43	51	68
29	8	16	24	32	40	48	64
30	8	15	23	30	38	45	60
31	Not Allowable		22	28	35	42	56
32	Not Allowable		20	26	33	39	52

(b) Competency Outcomes

Trainees will be trained in and achieve competence in the endorsed National Health Services Competency Standards.

(c) Course of Study to be undertaken

Trainees will undertake the following course of study:

- **Certificate III in Aboriginal and Torres Strait Islander Health TAFE NSW Course Code 2094**
- **Certificate II in Health Support Services (Cleaning Support Services) HLT20802**
- **Certificate II in Health Support Services (Laundry Support Services) HLT20302**
- **Certificate II in Health Support Services (Food Support Services) HLT20602**
- **Certificate II in Health Support Services (Grounds Maintenance) HLT20402**
- **Certificate II in Health Support Services (General Maintenance) HLT20502**
- **Certificate II in Health Support Services (Client/Patient Support Services) HLT20702**
- **Certificate II in Health Support Services (Stores) HLT20102**
- **Certificate II in Health Support Services (General Transport Support) HLT20202**

- **Certificate III in Health Support Services (Cleaning Support Services) HLT30902**
- **Certificate III in Health Support Services (Laundry Support Services) HLT30402**
- **Certificate III in Health Support Services (Grounds Maintenance) HLT30502**
- **Certificate III in Health Support Services (General Maintenance) HLT30602**
- **Certificate III in Health Support Services (Client/Patient Support Services) HLT30802**
- **Certificate III in Health Support Services HLT31002**
- **Certificate III in Health Service Assistance (Client/Patient Services) HLT31602**
- **Certificate III in Health Service Assistance (Allied Health Assistance) HLT31702**
- **Certificate III in Health Service Assistance (Hospital and Community Health Pharmacy Assistance) HLT31402**
- **Certificate III in Health Service Assistance (Pathology Assistance) HLT31202**
- **Certificate III in Health Service Assistance (Operating Theatre Support) HLT31302**
- **Certificate III in Health Service Assistance (Nutrition and Dietetic Support) HLT31502**
- **Certificate III in Health Service Assistance (Sterilisation Services) HLT31102**
- **Certificate III in Pathology Specimen Collection HLT30102**
- **Certificate IV in Health Services (Supervision) HLT42202**
- **Certificate IV in Health Support Services (Supervision) HLT40402**
- **Certificate IV in Health Service Assistance (Hospital and Community Health Pharmacy Technician) HLT40502**
- **Certificate III in Non-Emergency Patient Transport HLT30202**
- **Certificate III in Ambulance Communications (Call Taking) HLT31902**
- **Certificate IV in Ambulance Communications (Despatch) HLT41102**
- **Certificate IV in Basic Emergency Care HLT41002**
- **Certificate III in Dental Assisting HLT31802**
- **Certificate IV in Dental Assisting (Oral Health Education) HLT40602**
- **Certificate IV in Dental Assisting (Dental Radiography) HLT40702**
- **Certificate III in Prosthetic/Orthotic Technology HLT32102.**

Availability for Inspection

A copy of the Vocational Training Order may be inspected at any State Training Centre of the Department of Education and Training or on the Internet at <http://apprenticeship.det.nsw.edu.au>.

GEOGRAPHICAL NAMES ACT 1966

PURSUANT to the provisions of section 10 of the Geographical Names Act 1966, the Geographical Names Board has this day assigned the forty names listed below as dual names to the features described:

“Gubbuh Gubbuh” as an indigenous dual name for a headland known as “Middle Head” and situated about 1km SSE of Grotto Point.

“Gooree” as an indigenous dual name for a bay known as “Chowder Bay” and situated in Sydney Harbour within Georges Head to the North and Chowder Head to the South.

“Gooragal” as an indigenous dual name for a headland known as “Chowder Head” and situated about 1 km SW of Georges Head and about 3 km W of The Gap.

“Booraghee” as an indigenous dual name for a point known as “Bradleys Head” and situated on Port Jackson about 2km E of Fort Denison.

“Goram Bullagong” as an indigenous dual name for a bay known as “Mosmans Bay” and situated within Port Jackson about 1km S of Cremorne Junction.

“Weeyuh Weeyuh” as an indigenous dual name for a bay known as “Careening Cove” and situated within Neutral Bay about 1km SE by E of North Sydney Railway Station.

“Gooweebahree” as an indigenous dual name for a bay known as “Lavender Bay” and situated within Port Jackson about 1km South of North Sydney.

“Warungareeyuh” as an indigenous dual name for a point known as “Blues Point” and situated within Port Jackson about 1km SSW of Nth Sydney.

“Tumbalong” as an indigenous dual name with the designation of bay for a bay known as “Darling Harbour” and designated as a port which is situated within Port Jackson about 4km S of Crows Nest.

“Meeliyahwool” as an indigenous dual name for a cove known as “Campbells Cove” and situated within Sydney Cove between the Overseas Passenger Terminal and Dawes Point Reserve.

“Warrane” as an indigenous dual name for a cove known as “Sydney Cove” and situated within Port Jackson North of Circular Quay.

“Dubbagullee” as an indigenous dual name for a point known as “Bennelong Point” and situated approx 500m SE by E of Dawes Point / Tar-ra.

“Wahganmuggalee” as an indigenous dual name for a cove known as “Farm Cove” and situated within Port Jackson about 1 km S of Kirribilli Point.

“Yurong” as an indigenous dual name for a point known as “Mrs Macquaries Point” and situated in Port Jackson about 2km WNW of Darling Point.

“Muddawahnyuh” as an indigenous dual name for an island known as “Fort Denison” and situated within Port Jackson about 1 km E by N of Bennelong Point.

“Darrawunn” as an indigenous dual name for a point known as “Potts Point” for a point now partly joined to Garden Island and located on the east side of Woolloomooloo Bay.

“Gurrajin” as an indigenous dual name for a bay known as “Elizabeth Bay” and situated within Port Jackson about 1 km S of Garden Island.

“Jarowan” as an indigenous dual name for a point known as “Elizabeth Point” and situated adjacent to Elizabeth Bay about 2 km SE by S of Bennelong Point.

“Yurrandubbee” as an indigenous dual name for a point known as “Macleay Point” and situated adjacent to Rushcutters Bay about 1km WSW of Darling Point.

“Boowambillee” as an indigenous dual name for an island known as “Shark Island” and situated in Sydney Harbour about 1 km SW of Steel Point.

The above forty names have been entered into the Geographical Names Register as dual names and in each case neither name will have precedence over the other.

The position and extents and pronunciation for these features are recorded and shown within the Geographical Names Register of New South Wales. This information can be accessed through the Boards Web Site at www.gnb.nsw.gov.au.

WARWICK WATKINS,
Chairperson

Geographical Names Board,
PO Box 143, Bathurst NSW 2795.

GEOGRAPHICAL NAMES ACT 1966

Notice of New Address Locality in The Liverpool City
Local Government Area

PURSUANT to the provisions of section 10 of the Geographical Names Act 1966, the Geographical Names Board has this day amended the locality boundaries to create a new suburb called “Middleton Grange” in the Liverpool City Local Government Area as shown on map GNB3573.

The position and the extent for these features are recorded and shown within the Geographical Names Register of New South Wales. This information can be accessed through the Boards Web Site at www.gnb.nsw.gov.au.

WARWICK WATKINS,
Chairperson

Geographical Names Board,
PO Box 143, Bathurst NSW 2795.

GEOGRAPHICAL NAMES ACT 1966

PURSUANT to the provisions of section 10 of the Geographical Names Act 1966, the Geographical Names Board amended the locality name of “Uroly”, which is in the Leeton Shire Council Area, to “Euroley”.

The position and extent of these features is recorded and shown within the Geographical Names Register of New South Wales. This information can be accessed through the Board’s web site at www.gnb.nsw.gov.au.

WARWICK WATKINS,
Chairman

Geographical Names Board,
PO Box 143, Bathurst NSW 2795.

GEOGRAPHICAL NAMES ACT 1966

PURSUANT to the provisions of section 10 of the Geographical Names Act 1966, the Geographical Names Board hereby notifies that it has this day determined the names and boundaries for address localities Narrandera Local Government Area as shown on map GNB3793.

The position and extent of these features is recorded and shown within the Geographical Names Register of New South Wales. This information can be accessed through the Board’s web site at www.gnb.nsw.gov.au.

WARWICK WATKINS,
Chairman

Geographical Names Board,
PO Box 143, Bathurst NSW 2795.

THE LAND & ENVIRONMENT COURT OF NEW SOUTH WALES

Practice Direction Number 1 of 2005

Court Appointed Experts – Practice Direction

THIS Practice Direction commences on 1 February 2005.

1. The purpose of this Practice Direction is to give guidance to parties and to expert witnesses as to the process of appointment of experts by the Court in proceedings in Classes 1, 2 and 3, how such experts are to conduct themselves and prepare their evidence, provide it to the parties and give evidence at any hearing. If a party believes that in the circumstances of a particular appeal the process should be varied from that contemplated in this Practice Direction the proposed variation should be raised with the other parties and the Court.
2. Expert evidence is commonly given in proceedings in classes 1, 2 and 3 of the Court’s jurisdiction. It may involve the identification of facts as well as the expression of opinions following analysis of the facts. In an endeavour to reduce costs and to ensure that the Court has the benefit of evidence from a person who is not engaged by only one party, the Court has adopted procedures which provide for the Court to appoint experts.
3. For this purpose the Land and Environment Court has adopted Part 39 of the Supreme Court Rules 1970, which makes provision for the Court to appoint an expert to inquire into and report on any question in the proceedings. The rules make provision for the appointment of the expert, provision of a report, the remuneration of the expert and the receipt of the expert’s report into evidence.
4. Pre-Hearing Practice Direction No 17 makes provision for expert evidence and the appointment of experts by the Court. This Practice Direction should be read in conjunction with Pre-Hearing Practice Direction No. 17. Where there is conflict between this Practice Direction and Practice Direction No 17 this Practice Direction prevails. In due course Practice Direction No 17 will be revised.
5. At the first call over, or as soon as possible thereafter, the Court will consider whether it is appropriate to appoint a person as the court expert to give evidence with respect to any issue or issues in the proceedings. Before a person

is appointed it is expected that the parties, or their legal advisers, will have agreed with the expert the basis upon which that person will be remunerated and the quantum of the remuneration. If there is no agreement on the basis for remuneration of the expert the Court will determine it. The basis for remuneration may provide for a capped fee arrangement, an hourly rate or a combination or variation of these arrangements.

6. It will be necessary for the parties or their legal advisers to approach experts to discuss their possible appointment by the Court, identify their availability and agree upon the appropriate remuneration. However, a party must not seek the preliminary views of the expert on any question before offering that person's name as an expert. If such an enquiry is made by a legal practitioner it may constitute professional misconduct or contempt of court and may disqualify the expert from giving evidence.
7. If an expert is approached for appointment that person must disclose to the party making the approach whether he or she has had any prior dealings with the applicant or respondent, the landowner or the developer of the project or otherwise in relation to the project itself. If the expert has concerns that he or she may not be able to bring an impartial mind to the issues in dispute, this must be disclosed to the party making the approach.
8. The Court expects that the basis for remuneration of the expert will be that which the expert normally charges when undertaking court work for individual parties. The Court will not fix a level of remuneration which is greater than that person's usual rate of charging and may require evidence of the expert's usual rate before making the appointment. The parties are jointly and severally liable for the expert's fees and the expert must look to the parties for payment. The legal profession owes the usual obligation to an expert which a practitioner has engaged for payment of the expert's fees. If requested by the parties appropriate arrangements will be made for the expert's fees to be paid into court and held pending the resolution of the matter. As an alternative the parties could agree that each party's share of the fees will be held in an appropriate account on trust and paid out when owing to the expert. It would be preferable for the parties to confirm the fee arrangement with an expert in writing.
9. The evidence of an expert appointed by the Court will, subject to the objection of any party, be received as evidence in the proceedings. It will be considered by the Court together with any other evidence relating to the relevant issues.
10. A Court expert may approach any party, at any time, to obtain information, but must inform the other parties. Any party may also approach the expert with relevant information, but must inform the other parties.
11. To ensure that the expert is both perceived to be and remains independent from any party, discussions about the issues in the matter or any communication of the opinion of the expert should only occur when a representative of each party is involved in the discussion. Communication about incidental matters eg requests for basic information such as the relevant planning controls, plans, survey material, copies of other reports and the like may take place with one party provided the other parties are informed as to the information sought and the response which was given. Wherever possible such communication should be by email and copied to the other parties. Experts appointed by the Court are to conduct themselves in a manner which maintains the confidence of the parties and any objectors in their independence.
12. Although the Court will decide whether an expert or experts should be appointed the Court expects the parties to agree on the particular person or persons to be appointed. Failing agreement the Court will make the appointment. Where there is no agreement the parties shall provide a list of up to three experts acceptable to that party and the fee arrangement which each expert requires.
13. As soon as convenient after an expert has been appointed the parties must provide the expert with copies of all relevant documentation in relation to the project including, plans, relevant correspondence and reports which may be of assistance to the expert appointed by the Court. Each party must inform the other party, or parties of the information which they have provided to the expert and, where appropriate, provide the other party with copies of documents. The parties must ensure the expert is informed of any directions made by the Court relevant to the tasks requiring completion by that expert.
14. The Court may direct the expert to report orally to the parties and subsequently provide a written report. In some cases, only an oral or written report may be required. If, after reviewing the oral or written report of the expert, a party intends to seek leave to call another expert at the hearing that party shall immediately notify the Court and the other parties that an application is to be made. The Registrar shall then arrange for the Chief Judge to appoint a judge or commissioner to hear the matter and arrangements will be made for the application for leave to be heard at the earliest convenient date. If leave is granted, the Court will, if possible, give directions which ensure that, if a hearing date has been fixed, it is not lost. The communication with the Registrar and any application thereafter may be made by telephone or e-court if this is convenient. A written motion will not be required. The Court encourages the use of these processes which can save time and expense for parties.
15. In summary, the obligations of an expert appointed by the Court include the following:
 - (a) To receive and review written documentation provided by the parties to the proceedings.
 - (b) If required by a party or parties, or if the expert believes it to be necessary, to meet with a representative of each party for the purpose of obtaining any information relevant to the issue or issues requiring report by the expert. Such meetings should only occur in the presence of a representative of each party unless the parties otherwise agree.
 - (c) If the expert is of the opinion that it is necessary, visit the site in the presence of the parties or with their knowledge, and make any inquiries, including visiting objectors' properties, necessary to enable the expert to report to the Court.
 - (d) Experts should address objectors concerns, if any, even when these are not identified separately in the Statement of Issues.

- (e) If so directed by the Court, or if otherwise appropriate in the expert’s opinion, provide an oral report to the parties indicating the view the expert has reached in relation to the issue or issues, on which the expert has been directed to report, such report to be made on or before any date appointed by the Court. If the expert believes an issue could be satisfactorily resolved by an amendment of the plans or by the imposition of suitable conditions this should be stated in any oral or written report.
- (f) If so directed by the Court, to provide a written report to the Registrar of the Court and provide a copy to each party, such report to be provided on or before any date appointed by the Court. The report shall express the views the expert has reached in relation to the issue or issues on which the expert has been directed to report in order to assist the Court to determine the proceedings. The report is to be prepared with appropriate efficiency, having regard to the issues in dispute and the nature and likely cost of the proposed development.
- (g) Unless advised to the contrary, be available on the date fixed for the hearing of the matter to attend the view and give oral evidence and, if required, be cross-examined. If necessary further directions will be given during the hearing as to the need for further attendance by the expert. An expert appointed by the Court must be available to give evidence even when the outcome of the matter has been agreed between the parties.
- (h) If an expert is unsure about any aspect of his or her responsibilities, he or she should contact the Registrar for advice. The Registrar may be contacted on telephone number 9228 8388.
Email: lecourt@agd.nsw.gov.au. The address for filing reports and other correspondence is Land & Environment Court, GPO Box 3565, Sydney, NSW, 2001
- (i) Experts are to conduct themselves in a manner which maintains the confidence of the parties in their independence.

PETER DAVID McCLELLAN,
Chief Judge

Dear

In X v Y

I am writing to confirm that the Court has appointed you as an expert to give evidence in this matter in relation to

The directions which have been made which are relevant to you are as follows:

- (a) appoint.....as the Court expert to inquire into and report on.....
- (b) the parties are to provide the expert with copies of all relevant documentation by
- (c) the court expert is to consider the matter and confer with the parties and provide an oral/written opinion on relevant matters on or before....., and/or the court expert is to confer with the parties and provide a written report to the Registrar and provide copies to the parties on or before.....

- (d) the court expert’s remuneration is fixed at
- (e) the matter is fixed for hearing on.....
The hearing will commence on site at 9.30am/or will be conducted as an on site hearing or section 34 conference/or will commence at

I enclose for your information a copy of the expert witness code of conduct together with a copy of Pt 39 of the Rules under which you have been appointed, together with a copy of the Court Appointed Experts Practice Direction.

NATIONAL PARKS AND WILDLIFE ACT 1974

Parks and Reserves of the Tweed Caldera
Plan of Management

A plan of management for the Parks and Reserves of the Tweed Caldera (incorporating Mount Warning National Park, Border Ranges National Park, Mebbin National Park, Nightcap National Park, Mount Jerusalem National Park, Goonengerry National Park, Limpinwood Nature Reserve, Numinbah Nature Reserve and Snows Gully Nature Reserve) was adopted by the Minister for the Environment on 15 November 2004.

Copies of the plan may be obtained from the NPWS Northern Rivers Regional Office, 75 Main Street, Alstonville (phone 6627 0200); the Tweed Area Office, corner Alma Street and Pacific Highway, South Murwillumbah; and the Kyogle Area Office, 136 Summerland Way, Kyogle. The cost of the plan is \$8.50.

The plan is also available on the NPWS web site: www.nationalparks.nsw.gov.au.

PESTICIDES ACT 1999

Notice Under Section 48(4)

NOTICE is hereby given, pursuant to section 48(4) of the Pesticides Act 1999, that I have granted a Pilot (Pesticide Rating) Licence, particulars of which are stated in the Schedule.

ALAN RITCHIE,
Manager,
Dangerous Goods,
Environment Protection Authority
(by delegation)

SCHEDULE

Pilot (Pesticide Rating) Licence

Name and address of Licensee	Date of Granting of Licence
Mr Lachlan Jerome CRAIG, Lot 1, Boomi Road, Garah NSW 2405.	4 January 2005.

POISONS AND THERAPEUTIC GOODS ACT 1966

Order Under Clause 171(1)

Poisons and Therapeutic Goods Regulation 2002

Withdrawal of Drug Authority

IN accordance with the provisions of Clause 171(1) of the Poisons and Therapeutic Goods Regulation 2002, an Order has been made on Rachel Ann McGRATH of 11 Atlanta

Avenue, Woodrising 2284, prohibiting her, until further notice, as a nurse from having possession of and supplying drugs of addiction as authorised by Clauses 101 and 103 of the Regulation. This order is to take effect on and from Monday, 20 December 2004.

ROBYN KRUK,
Director-General

Department of Health, New South Wales.
Sydney, Thursday, 16 December 2004.

THREATENED SPECIES CONSERVATION ACT 1995

DEPARTMENT OF ENVIRONMENT AND CONSERVATION

Notice of Exhibition of the Draft Southern Brown Bandicoot (*Isodon obesulus*) Recovery Plan

THE Department of Environment and Conservation hereby gives notice of the exhibition of the Draft Southern Brown Bandicoot (*Isodon obesulus*) Recovery Plan. Public submissions are invited from 10 January to 4 March 2005. Exhibition details and information relating to the sale and inspection of the recovery plans will be published during the week commencing Monday, 10 January 2005, in the *Bega District News*, *Bombala Times*, *Hills Shire Times*, *Hornsby and Upper North Shore Advocate*, *Imlay Magnet*, *Manly Daily*, *Merimbula News Weekly*, *Narooma News*, *Parramatta Advertiser*, *South Coast Register* and *Sydney Morning Herald*.

TANIA DURATOVIC,
A/Manager,
Threatened Species Unit,
Conservation Programs and Planning Branch,
Metropolitan Environment Protection and
Regulation Division

WINE GRAPES MARKETING BOARD (RECONSTITUTION) ACT 2003

Wine Grapes Marketing Board (Terms and Conditions of Payment) Order 2005

THE Wine Grapes Marketing Board, for the City of Griffith and the local government areas of Leeton, Carrathool and Murrumbidgee in pursuance of Part 2, section 5 of the Wine Grapes Marketing Board (Reconstitution) Act 2003, make the following Order.

Dated, this 7th day of January 2005.

Wine Grapes Marketing Board (Terms and Conditions of
Payment) Order 2005 under the Wine Grapes Marketing
Board (Reconstitution) Act 2003

1. Name of Order

Wine Grapes Marketing Board (Terms and Conditions of
Payment) Order 2005.

2. Commencement

This Order commences on 7th January 2005, by motion
of the Wine Grapes Marketing Board.

3. Duration

This Order has effect for the 2005 calendar year only.

4. Validity of Order

- (1) The making of this Order by the Wine Grapes Marketing Board under Section 5 of the Wine Grapes Marketing Board (Reconstitution) Act 2003 is specifically authorised for the purposes of section 51 of the Trade Practices Act 1974 of the Commonwealth and the Competition Code of New South Wales.
- (2) The making of this Order does not limit or remove any obligations parties to this Order may have under the Wine Grapes Marketing Board (Reconstitution) Act 2003.

5. Definitions

In this Order:

Act means the Wine Grapes Marketing Board (Reconstitution) Act 2003.

Board means the Wine Grapes Marketing Board established by the regulation set out in Schedule 1 of the Wine Grapes Marketing Board (Reconstitution) Act 2003.

Board's area of operations means the City of Griffith and the local government areas of Carrathool, Leeton and Murrumbidgee

complying contract means:

- (a) a contract that fixes:
 - (i) the prices to be paid for consignments of MIA wine grapes delivered during the current calendar year only, or the manner in which those prices are to be calculated, and
 - (ii) the date or dates by which those prices, or the various instalments of those prices, will be paid,
 being a contract entered into before the first Monday in December of the previous calendar year, or
- (b) a contract that fixes:
 - (i) the prices to be paid for consignments of MIA wine grapes delivered during both the current calendar year and one or more future calendar years, or the manner in which those prices are to be calculated, and
 - (ii) the date or dates by which those prices, or the various instalments of those prices, will be paid,
 being a contract entered into at any time before the first delivery of winegrapes under the contract, or
- (c) a contract the subject of an approval in force under section 13 of the Act.

consignee means a person to or for whom a consignment of MIA wine grapes is delivered.

consignor means a person by or from whom a consignment of MIA wine grapes is delivered.

constituted grower means for any calendar year, the class of primary producers for which the Board is constituted includes all growers within the Board's area of operation who, during the previous calendar year, harvested more than 20 tonnes of MIA wine grapes, but does not include:

- (a) in the case of a corporation:
 - (i) a grower that is also a winery, or

- (ii) a grower in which a winery has a controlling interest, or
- (b) in the case of an individual:
 - (i) a grower who is also a winery, or
 - (ii) a grower who is a director of a corporation that is a winery and who (as a grower) supplies the winery with all of the MIA wine grapes that he or she harvests.

duly contracted delivery means a consignment of MIA wine grapes that is delivered pursuant to a complying contract.

EFT means electronic funds transfer.

MIA wine grapes means any variety of grapes grown in the Board's area of operations for use for processing into wine, must, juice or wine spirit.

6. Application of sections

- (1) Section 7, 8 and 9 of this Order applies to the Terms and Conditions of Payment for all MIA wine grapes delivered to consignees by consignors that are not a duly contracted delivery.
- (2) Section 10 of this Order applies to the Terms and Conditions of Payment for the rates levied by the Wine Grapes Marketing Board under the Agricultural Industry Services Act 1998, in relation to deliveries of all MIA winegrapes from constituted growers within the Board's area of operations.

7. Terms and Conditions of Payment for the year 2005

- (1) The purchase price for all MIA wine grapes purchased shall be paid by consignees to the Board or as directed by the Board as noted in the timetables in this section and where appropriate in accordance with Section 9 of this order.
- (2) Payments made by consignees directly to the Board pertaining to deliveries of MIA wine grapes delivered to consignees by consignors.

Table 1: Payments made to the Board by Consignees

Timetable	Structure
10th May 2005	1/3 total delivery value (33.33%)
21st June 2005	1/3 total delivery value (33.33%)
11th October 2005	1/3 total delivery value (33.34%) including all bonus payments

- (3) The Board may direct payments for MIA wine grapes to be made directly to consignors by consignees only upon completion in full of an "Application to Make Payment Directly to Growers" made and received by the Board on or prior to 25th February 2005.
 - (i) Applications are available from the Board.
 - a. No fees or charges for processing of applications will apply.
 - b. Notification of Board direction will be made 25th March 2005.
 - (ii) Failure to comply with any or all conditions of the application made in accordance with this Order may result in the revocation of any direction made by the Board pursuant to the application.
- (4) Payments made directly to consignors by consignees excluding all applicable levies for MIA wine grapes delivered to consignees by consignors under direction by the Board.

Table 2: Payments Made to Consignors by Consignees and the Board

Timetable	Structure
13th May 2005	1/3 total delivery value (33.33%)
24th June 2005	1/3 total delivery value (33.33%)
14th October 2005	1/3 total delivery value (33.34%) including all bonus payments

- (i) All payments made to the Board by consignees on MIA wine grapes delivered by consignors are to be paid to growers in accordance with Table 2 of this Section or at earlier dates by notice to the Board.

8. Default payments for deliveries of MIA wine grapes

- (1) Interest shall apply on all late payments made for purchased MIA winegrapes whether the consignee has been directed by the Board to make payments directly to consignors or not at the rate prescribed under section 95 (1) of the Supreme Court Act 1970 for payment of interest on a judgement debt, plus 5 per cent.
- (2) Payments made in accordance with this section shall occur in accordance with instruction of the Board.
- (3) Any money due to the Board, including any money that becomes payable as a consequence of the revocation of a direction under section 10 of the Wine Grapes Marketing Board (Reconstitution) Act 2003 may be recovered as a debt.

9. Manner and timing in which payments are to be made

- (1) Notwithstanding any previous section in this Order this clause applies to payment by all consignees accepting deliveries of MIA wine grapes from consignors otherwise than pursuant to a direction by the Board. Payments are to be:
 - (i) Paid as a valid bank cheque made out to the Wine Grapes Marketing Board and received by the Board by 12 midday of the due date, or
 - (ii) Transferred to the Board's nominated banking account by EFT so as to cause all funds to be cleared by the due date. A confirmation of the transaction must be forwarded by facsimile to the Board on the same day.
- (2) Notwithstanding any previous section in this Order this clause applies to all payments made to consignors by consignees accepting deliveries of MIA wine grapes from consignors pursuant to a direction under the Act by the Board:
 - (i) Made available as a cheque made out to the consignor for pickup by consignors by 12 midday on the due dates, or
 - (ii) Transferred by EFT to consignor's nominated banking account so that funds are cleared by the due dates. A confirmation of the transaction must be forwarded to the grower on the same day, or
 - (iii) Sent as a cheque made out of the consignor via Australia Post to consignors post marked on the date directed.
- (2) No payments made available for consignor pickup are to be retained by the consignee for greater than 24 hours.

- (3) Revocation of a Board direction may result from non-compliance of the manner within this Order.

10. Calculation and payment of Wine Grapes Marketing Board levies

- (1) Levies are applicable on deliveries of MIA wine grapes on all constituted growers.
- (2) The leviable rate for 2005 is \$3.90 per tonne (fresh weight) of winegrapes.
- (3) In the case of a consignee receiving Board direction to make payments to consignors directly the levy amount shall be deducted by the consignee from the payment for deliveries of MIA wine grapes and then remitted to the Board in the following timetables and structure.

Table 3: Payments of Levies to the Board

Timetable	Structure
13th May 2005	\$1.30 per tonne delivered
24th June 2005	\$1.30 per tonne delivered
14th October 2005	\$1.30 per tonne delivered

Table 4: Alternate Payments of Levies to the Board

Timetable	Structure
30th June 2005	\$3.90 per tonne delivered

- (4) Payments of levies by consignees in accordance with Table 4: Alternate Payments of Levies to the Board are required to advise the Board in writing by 29th April 2005. No penalty or discount will be provided to the consignee for payments made in this manner.

- (5) Failure to remit levies to the Board within the timetable, structure and the approved manner may cause a revocation of a Board direction made in accordance with this Order.

- (6) All levies payable to the Board in accordance with the timetable in Subsection 3 of this Section are to be paid to the Board in the following manner:

- (i) To the Board's nominated banking account by EFT on the due dates, including a confirmation of the transaction sent by facsimile to the Board on the same day, or
- (ii) Sent as a business cheque made out to the Wine Grapes Marketing Board via Australia Post postmarked on the due dates.
- (iii) Delivered to the registered offices of the Board on the due dates.

All enquiries in relation to this Order should be directed to:

Mr Brian Simpson
 Chief Executive Officer
 Riverina - Wine Grapes Marketing Board
 182 Yambil Street, Griffith NSW 2680
 PO Box 385, Griffith NSW 2680
 Phone: 02-6962 3944 Fax: 02-6962 6103
 Mobile: 0438 388 828
 Email: bsimpson@wgmb.net.au

Copies of this Order can be downloaded from the Board's website in PDF format: <http://www.wgmb.net.au>.

TRAVEL AGENTS ACT 1986 LIST OF LICENSED TRAVEL AGENTS

SECTION 40 (2) of the Travel Agents Act 1986 requires the Commissioner for Fair Trading to publish in the Government Gazette from time to time a list of licence holders.

Section 40 (7) of the Act deems the supplier of travel services to an unlisted travel agent to have aided and abetted that person in carrying on business as a travel agent. Thus the supplier could be subject to the same penalty of 500 penalty units as the agent is trading without a licence.

Suppliers of travel services should not deal with an unlisted person or corporation unable to produce a travel agent's licence.

Commissioner for Fair Trading

LIST OF LICENSED TRAVEL AGENTS

Date of Preparation: **05-Jan-2005**
Date list comes into force: **19-Jan-2005**
Date list ceases to be in force: **02-Feb-2005**

2TA5436	(A U) OCEANIA TOURS PTY LTD	
2TA5507	1CAR1 CAR RENTALS PTY LTD	2UK
2TA003473	2MAX INVESTMENTS PTY LTD	THE CLASSIC SAFARI COMPANY
2TA5672	33 DEGREES WORLDWIDE PTY LTD	
2TA4305	A & H INTERNATIONAL TRAVEL PTY LTD	
2TA4681	A A T INTERNATIONAL CO PTY LTD	A A T TRAVEL
2TA5111	A B C WORLD PTY LTD	ABC WORLD TRAVEL
2TA5421	A B C WORLD TRAVEL MARRICKVILLE PTY LTD	QUANTUM FLIGHT CENTRE
2TA000416	A E (TONY) FORNASIER WORLD TRAVEL CENTRE PTY LTD	FORNASIER WORLD TRAVEL CENTRE
2TA5251	A F P TRAVEL PTY LTD	NEWPORT TRAVEL
2TA001793	A F S INTERCULTURAL PROGRAMS AUSTRALIA	FASTRAVEL
2TA5098	A J P W TRAVEL PTY LTD	TRAVELWORLD ORANGE
2TA004140	A K D HOLDINGS PTY LTD	DES SPACE TRAVEL ZODIAC TRAVEL RAM WORLD TRAVEL REDTREE TRAVELS MITSUI TRAVEL
2TA001537	A MITSUI TRAVEL SERVICES PTY LTD	
2TA5657	A N C TRAVEL PTY LTD	
2TA5561	A O T GROUP PTY LTD	NEED IT NOW
2TA5627	A T I TOURS PTY LTD	A T I TOURS
2TA002870	A T S PACIFIC PTY LTD	
2TA5457	A W L PITT AUSTRALIA PTY LTD	PITT TRAVEL SYDNEY JAPAN PACKAGE
2TA4687	AAT KINGS TOURS PTY LTD	
2TA5268	ABBOTT	PHILIPPA MARY
2TA002881	ABROFILM PTY LTD	VERITAS TRAVEL
2TA003101	ABROROB PTY LTD	GRIFFITH TRAVEL & TRANSIT WOLLONGONG TRAVEL CENTRE
2TA4907	ABSOLUTE TRAVEL PROFESSIONALS PTY LTD	ABSOLUTE TRAVEL
2TA003355	ABTOURK (SYD NO 358) PTY LTD	ST GEORGE TRAVEL
2TA003747	ACE TRAVEL SERVICE PTY LTD	
2TA4889	ACN 083 682 740 PTY LTD	PURE TRAVEL
2TA003570	ACRA PTY LTD	GROUP TRAVEL MANAGEMENT
2TA5565	ADAMS FAMILY TRAVEL PTY LTD	
2TA5623	ADCORP PTY LTD	
2TA4493	ADVANCE AUSTRALIA TRAVEL PTY LTD	
2TA5287	ADVANCE TRAVEL CENTRE PTY LTD	
2TA5087	ADVANCE TRAVEL PTY LTD	
2TA003405	ADVANCE-OLYMPIC INTERNATIONAL PTY LTD	ADVANCE-OLYMPIC TRAVEL
2TA000351	ADVENTURE ASSOCIATES PTY LTD	
2TA001198	ADVENTURE INTERNATIONAL PTY LTD	ADVENTURE WORLD CRUISE SPIRIT INTERNATIONAL A W SPORTS INTERNATIONAL TRAVEL & TOURS

2TA004116	ADVENTURE TOURS & TRAVEL PTY LTD		COOGEE TRAVEL
2TA5038	AEO TRAVEL PTY LTD		
2TA5264	AERIUS TRAVEL HOLDINGS PTY LTD		AERIUS TRAVEL COMPANY
2TA001940	AEROFLOT RUSSIAN AIRLINES		
2TA003915	AGENCY TRAVEL PTY LTD		
2TA5529	AIDA'S TRAVEL PTY LTD		
2TA5458	AIHUA INTERNATIONAL TRAVEL PTY LTD		AIHUA INTERNATIONAL TRAVEL
2TA4393	AIR CALEDONIE INTERNATIONAL		AIR CALEDONIE HOLIDAYS
2TA4865	AIR N TRAVEL PTY LTD		
2TA000192	AIR NEW ZEALAND LTD		
2TA004013	AIR TRAVEL EXPRESS PTY LTD		
2TA5149	AIR UNIVERSE TRAVEL PTY LTD		
2TA003425	AIRCALM PTY LTD		SOUTHSIDE WORLD TRAVEL
2TA5352	AIRLINE MARKETING AUSTRALIA PTY LTD		
2TA4841	AIRMASTER TRAVEL & TOURS PTY LTD		
2TA003160	AIRSONIC AUSTRALIA TRAVELS PTY LTD		
2TA4480	AIRTYPE PTY LTD		TRAVELSCENE KOGARAH BENCHMARK TRAVEL A S TRAVEL AGENCY
2TA4830	AITKEN SPENCE TRAVEL PTY LTD		
2TA4637	AKI TRAVEL PTY LTD		
2TA5610	AL RAIS AUSTRALIA PTY LTD		AL RAIS TRAVEL SUMMIT AIR TRAVEL
2TA001125	AL-MALAH INTERNATIONAL TRAVEL PTY LTD		COLUMBIA INTERNATIONAL TRAVEL
2TA4997	ALAM	SHEIKH MOHAMMAD MAHABUB	ROUSHAN SPACE TRAVEL
2TA5533	ALBURY KENT PTY LTD		ALBURY KENT TRAVEL
2TA5418	ALEETHERI PTY LTD		HARVEY WORLD TRAVEL RANDWICK
2TA001750	ALIMANA PTY LTD		PRIER WORLD TRAVEL
2TA5555	ALISON TWIST TRAVEL PTY LTD		HARVEY WORLD TRAVEL 175 PITT ST
2TA5134	ALL LINK INTERNATIONAL PTY LTD		ALL LINK TRAVEL HARVEY WORLD TRAVEL (ASHFIELD) HARVEY WORLD TRAVEL (WYNYARD)
2TA003134	ALL TOURS & TRAVEL PTY LTD		
2TA001652	ALLEN'S TRAVEL PTY LTD		ALLEN'S TRAVEL
2TA5175	ALLFLIGHT TRAVEL PTY LTD		
2TA001669	ALLIED SUMMA TRAVEL AND TOURS PTY LTD		AH ALLIED HOLIDAYS TRAVELACCESS
2TA5559	ALLSUN HOLIDAYS PTY LTD		
2TA001253	ALLWAYS TRAVEL PTY LTD		
2TA5585	ALMAX SERVICES PTY LTD		TRAVELSCENE SINGLETON
2TA5437	AMACO PTY LTD		AMACO TRAVEL AND CONFERENCES W & B TRAVEL CENTRE
2TA5557	AMADON TRAVEL MANAGEMENT PTY LTD		
2TA000113	AMERICAN EXPRESS INTERNATIONAL INC		AMERICAN EXPRESS TRAVEL AGENCY AMERICAN EXPRESS TRAVEL SERVICE TRAVELSCENE ROSEVILLE WING ON TOURS
2TA001886	AMICA TRAVEL PTY LTD		
2TA003050	ANANDA TRAVEL SERVICE (AUST) PTY LTD		
2TA003893	ANDCAR PTY LTD		WILDLIFE SAFARI CONSULTANTS JOURNEYS UNLIMITED (AUST)
2TA5360	ANDRETIC	GEORGE PAUL	TRIP ABOUT TOURS AVANTI TOURS TRAVELWORLD CARLINGFORD
2TA5078	ANGIE'S TRAVEL PTY LTD		
2TA4510	ANTIPODEANS ABROAD PTY LTD		
2TA5512	ANZEC'S INTERNATIONAL GROUP PTY LTD		AUSTRALIA WIN WORLD TRAVEL
2TA5100	APOLLO TRAVEL CENTRE PTY LTD		
2TA002728	APOSTOLOPOULOS	APOSTOLOS	COSMOS TRAVEL AGENCY
2TA001425	APP INTERNATIONAL AGENCY PTY LTD		APP INTERNATIONAL TRAVEL EZY FLIGHTS
2TA4719	APTC PTY LTD		ALL PACIFIC TRAVEL CONCEPT

2TA003875	ARADEE PTY LTD		TRAVELSCENE TIME 2 TRAVEL
2TA4706	ARCHITOUR PTY LTD		DESTINATION TERRA AUSTRALIS
2TA003724	AROUND AUSTRALIA TOUR SERVICE PTY LTD		
2TA5080	ASA INTERNATIONAL PTY LTD		
2TA5503	ASARGIOTIS	NICKOLAS	ZORBAS TRAVEL SERVICE - THE TRAVEL SPOT
2TA5246	ASIA HONG KONG TRAVEL PTY LTD		
2TA002526	ASIA PACIFIC TRAVEL MARKETING SERVICES PTY LTD		
2TA4603	ASIAN TRAVELLER PTY LTD		
2TA4955	ASKBAY PTY LTD		HARVEY WORLD TRAVEL (ROUSE HILL) ST MARTINS TRAVEL
2TA001068	ASMARK PTY LTD		
2TA4324	ASSISTANCE TRAVEL (AUSTRALASIA) PTY LTD		
2TA003777	ASTRAL TRAVEL & TOURS PTY LTD		
2TA4547	ATITOWN PTY LTD		TRAVELSCENE AT OUR TOWN TRAVEL
2TA003870	ATLANTIC & PACIFIC BUSINESS TRAVEL PTY LTD		
2TA4736	ATLANTIS TRAVEL (FAIRFIELD) PTY LTD		
2TA5286	AUFAN INTERNATIONAL PTY LTD		NEW ASIA PACIFIC TRAVEL
2TA5266	AUGA TRAVEL SERVICE PTY LTD		
2TA5593	AUGMENT AIR PTY LTD		
2TA5284	AUGUSTINE	TOMI	AUGUST TRAVEL CENTRE POLAR JOURNEYS
2TA4498	AURORA EXPEDITIONS PTY LTD		
2TA5486	AUS CENTIV PTY LTD		
2TA5006	AUS WONDER TRAVEL PTY LTD		AUS WONDER HOLIDAY
2TA5594	AUSLEE TRADING PTY LTD		ALL CONTINENTS TRAVEL
2TA5393	AUSSIE FLIGHT CENTRE PTY LTD		
2TA5548	AUST-SINO CONNECTION PTY LTD		
2TA5028	AUSTRAL.TO PTY LTD		
2TA004056	AUSTRALAIR PTY LTD		ST IVES TRAVEL
2TA003483	AUSTRALASIAN CONFERENCE ASSOCIATION LTD		S P D TRAVEL SERVICE
2TA5615	AUSTRALIA & NEW ZEALAND EXPRESS TRAVEL SERVICES PTY LTD		
2TA5091	AUSTRALIA 2 SEE PTY LTD		
2TA5045	AUSTRALIA AND BEYOND TRAVEL PTY LTD		BROKEN HILL OUTBACK HOLIDAYS
2TA5592	AUSTRALIA BAILEY INTERNATIONAL PTY LTD		AUTHENTIC TRAVEL
2TA5645	AUSTRALIA CHINA TRADE ASSOCIATION PTY LTD		AUSTRALIA PEACE INTL TRAVEL
2TA003445	AUSTRALIA GLOBAL HOLIDAYS PTY LTD		
2TA5084	AUSTRALIA PARADISE TRAVEL PTY LTD		AUSTAR TRAVEL
2TA5586	AUSTRALIA TOURS & TRAVEL PTY LTD		
2TA5624	AUSTRALIA TRAVEL PTY LTD		AUSTRALIAN TRAVEL MARKETING
2TA4763	AUSTRALIA WIDE HOLIDAYS PTY LTD		MACQUARIE EDUCATIONAL TOURS
2TA5109	AUSTRALIAN & NEW ZEALAND COLLEGE FOR SENIORS LTD		ODYSSEY TRAVEL ODYSSEY EDVENTURES ODYSSEY TRAVEL
2TA003039	AUSTRALIAN BUSINESS & CONFERENCE TRAVEL PTY LTD		
2TA003982	AUSTRALIAN CHINA INVESTMENT & TRADING DEVELOPMENT PTY LTD		SPRING INTERNATIONAL TRAVEL
2TA5384	AUSTRALIAN COMMERCIAL RESOURCES PTY LTD		A C R INTERNATIONAL TRAVEL & TOURS
2TA4611	AUSTRALIAN INTERNATIONAL DEVELOPMENTS PTY LTD		OPEN WORLD TRAVEL
2TA4890	AUSTRALIAN NEW FRONTIERS PTY LTD		AGRITOURS AUSTRALIA EXPLORE AUSTRALIA NEW ENGLAND CONFERENCE BUREAU SOUTH PACIFIC SAFARIS AUSTRALIAN PACIFIC DAY TOURS
2TA000778	AUSTRALIAN PACIFIC TOURING PTY LTD		
2TA4725	AUSTRALIAN TAYLORED TOURS PTY		

2TA5562	LTD AUSTRALIAN TRAVEL CLUB PTY LTD		
2TA5514	AUSTRALIAN TRAVELWORKS PTY LTD		PENNANT HILLS TRAVEL THE HILLS CRUISE CENTRE WORLD EXPEDITIONS
2TA001418	AUSTRALIAN WORLD EXPEDITIONS PTY LTD		
2TA4527	AUSTRALIE TOURS PTY LTD		PACIFIC SPIRIT TRAVEL
2TA4750	AUSTRALINDE PTY LTD		NEWCASTLE TRAVEL SERVICE- NEWCASTLE NEWCASTLE TRAVEL SERVICE - WARNERS BAY NEWCASTLE TRAVEL SERVICE - WARNERS BAY HEMINGWAY TRAVEL
2TA001658	AUSTRAVCO INTERNATIONAL PTY LTD		
2TA003551	AUSVINACO TRAVEL PTY LTD		
2TA001430	AUTOHOME RENTALS INTERNATIONAL PTY LTD		A R I TOURS
2TA001656	AVALON TRAVEL PTY LTD		TRAVELSCENE AT AVALON TRAVEL
2TA5575	AVIA TRAVEL PTY LTD		
2TA4521	AVIATION TRAVEL SERVICES PTY LTD		
2TA4424	AVTOURS OSHKOSH EXPRESS PTY LTD		AVTOURS AUSTRALIA
2TA004091	AW ROYAL ORCHID HOLIDAYS AUSTRALIA PTY LTD		
2TA002797	AWAD TOURIST & TRAVEL SERVICE PTY LTD		
2TA5460	AWAY WE GO TOURS PTY LTD		ALPINE INFORMATION CENTRE
2TA002580	AXIS EVENTS GROUP PTY LTD		AXIS CORPORATE TRAVEL SERVICE AXIS INCENTIVE PLANNERS AXIS CONFERENCE PLANNERS AZZI TRAVEL SERVICE PACIFIC AUSTRALIA TRAVEL JETSET TRAVEL MLC CENTRE ALBURY TRAVEL
2TA5402	AZZI	WALID	
2TA5433	B E O - TRAVEL PTY LTD		
2TA003810	B G TRAVEL SERVICES PTY LTD		
2TA5630	B K & P F MAHONY PTY LTD		
2TA4595	B T I AUSTRALIA PTY LTD		
2TA5461	BACK	ALEKSANDRA MARY	UNIQUE ESCAPES
2TA5336	BACKPACKERS WORLD TRAVEL (WHOLESALE) PTY LTD		EXPERIENCE ADVENTURES
2TA4806	BACKPACKERS WORLD TRAVEL PTY LTD		BACKPACKERS WORLD
2TA4661	BAINI MANAGEMENT SERVICES PTY LTD		THE CONFERENCE ROOM
2TA4881	BAKER	IAN GEORGE	FLYING START TRAVEL SERVICES
2TA003844	BAKLA	ALICE	ALICE'S WONDERLAND TRAVEL - NORTH SYDNEY
2TA003845	BAKLA	PAUL BOGHOS	ALICE'S WONDERLAND TRAVEL - NORTH SYDNEY
2TA4254	BALGOWNIE WORLD TRAVEL PTY LTD		
2TA000055	BALI TRAVEL SERVICE PTY LTD		
2TA003537	BALLAO HOLDINGS PTY LTD		DIVE ADVENTURES (AUSTRALIA) ISLAND ADVENTURES TRAVEL DIVE ADVENTURES JETSET BALLINA JETSET BALLINA GLOBAL VACATIONS PICCADILLY TRAVEL SERVICE MUSWELLBROOK TRAVEL CENTRE TRAVELSCENE MENAI METRO NORFOLK SELECT MARKETING NORFOLK SELECT MARKETING TRAVELAND ON KING TRAVELWORLD ON KING MAITLAND WORLD TRAVEL
2TA5017	BALLINGALL	KATHRYN ROSE	
2TA5018	BALLINGALL	DAVID ANDREW	
2TA003721	BALUS TRAVEL PTY LTD		
2TA4693	BAMA BAA PTY LTD		
2TA003919	BANBEP PTY LTD		
2TA003240	BANGOR TRAVEL PTY LTD		
2TA5508	BANTOFT	DAVID ALBERT	
2TA5509	BANTOFT	KYLIE	
2TA004160	BARHIL PTY LTD		
2TA4932	BARNARD	MATTHEUS DANIEL	MAITLAND WORLD TRAVEL
2TA4933	BARNARD	KAREN MILDRED	MAITLAND WORLD TRAVEL
2TA003187	BARRENJOEY TRAVEL SERVICES PTY LTD		
2TA002766	BARROBRIDGE PTY LTD		NON STOP TRAVEL
2TA004154	BATHURST REGIONAL COUNCIL		BATHURST VISITOR INFORMATION

2TA4336	BAXTER'S TRAVEL PTY LTD		CENTRE
2TA002736	BAY TRAVEL PTY LTD		BAY TRAVEL AUSTRALIA E-BAY TRAVEL BAY TRAVEL AUSTRALIA TRAVELWORLD CHIFLEY PLAZA TRAVELWORLD PARRAMATTA COMMODORE TOURS
2TA004098	BECKINSALE PTY LTD		
2TA003212	BEDFORD	MICHAEL TERRANCE	
2TA003234	BEDFORD	DOROTHY JANE	COMMODORE TOURS
2TA4409	BEEHIVE AUSTRALIAN INBOUND TOUR SERVICE PTY LTD		
2TA000811	BENCH INTERNATIONAL PTY LTD		BEAUVENTURES TRAVEL TRAVELSCENE CRONULLA AD TOURS TRAVEL
2TA003510	BENDEN HOLDINGS PTY LTD		
2TA5041	BENNETT	DENISE ROSEMARY ALLAN LESLIE	
2TA5042	BENNETT		AD TOURS TRAVEL SCANDINAVIAN BUSINESS & HOLIDAY TRAVEL
2TA001141	BENTOURS INTERNATIONAL PTY LTD		BDCU TRAVEL SERVICE HARVEY WORLD TRAVEL-ORANGE PTC EXPRESS TRAVEL ARIELA TRAVEL TRAVEL 2000 SKIMAX
2TA5242	BERIL-JONE	WENDIE	
2TA5117	BERNIE PTY LTD		
2TA4399	BERNLEY ENTERPRISE PTY LTD		
2TA003811	BESIM PTY LTD		
2TA5029	BEST FLY TRAVEL PTY LTD		
2TA4787	BEST HOLIDAYS PTY LTD		
2TA001757	BESTWAY TRAVEL PTY LTD		
2TA4403	BETANZA PTY LTD		HARVEY WORLD TRAVEL FRANCHISE MANAGEMENT HARVEY WORLD TRAVEL TICKET CENTRE
2TA5649	BEYOND SLOVENIA PTY LTD		
2TA5659	BFIRST TRAVEL PTY LTD		BFIRST TRAVEL PAYLESS WORLD TRAVEL
2TA002814	BHULLER	MANZOOR (MICHAEL)	
2TA003601	BICAIR PTY LTD		THE TRAVELLERS HUT
2TA003547	BILL PEACH JOURNEYS PTY LTD		
2TA5641	BIRRELL	MICHAEL DAMIAN	B C ARCHAEOLOGY ADRIATIC ADVENTURES TRAVEL AND TOURS TRAVELSCENE THIRROUL
2TA4659	BLAZENKA'S TRAVEL PTY LTD		
2TA5161	BLOM	TRACEY ANNE	
2TA5632	BLUESKY TOURS & OVERSEAS CONSULTING PTY LTD		
2TA5013	BLUROSE PTY LTD		WHITESANDS TRAVEL A & C TRAVEL PAN REGAL HOLIDAYS TRAVEL ON Q BELLINGEN WORLD TRAVEL TRAVELSCENE ORANGE TRAVELSCENE ORANGE INSIGHT AUSTRALIA TRAVEL FALCON WINGS TRAVEL FALCON WINGS TRAVEL AUSTRALIA BY AIR
2TA5665	BODON	ANESA MARY	
2TA5030	BOLIJA PTY LTD		
2TA003820	BONARD PTY LTD		
2TA4771	BONETT	ELIZABETH ANN TIMOTHY JOHN FIONA ELIZABETH BIRGIT MAGDI SANAA BENJAMIN PATRICK	
2TA5278	BOUFFLER		
2TA5277	BOUFFLER		
2TA5374	BOURNE		
2TA003803	BOUTROS		
2TA003804	BOUTROS		
2TA5442	BOWLEY		
2TA003719	BOWRAL TRAVEL PTY LTD		TRAVELSCENE BOWRAL HARVEY WORLD TRAVEL (MUDGEE)
2TA4935	BOX	JAMIE	
2TA4936	BOX	GLENN CHRISTOPHER GAYLE ELIZABETH	HARVEY WORLD TRAVEL (MUDGEE) HARVEY WORLD TRAVEL (MUDGEE)
2TA003868	BOX		
2TA4456	BRAGA CONSOLIDATED PTY LTD		
2TA5160	BRAKENRIDGE	SALLY MEEGAN ELAINE	TRAVELSCENE THIRROUL AFRICAN ENCOUNTER BREAKAWAY TRAVEL CLUB SOUTHERN CROSSINGS AUSTRALIA
2TA5644	BRAKSPEAR		
2TA004207	BREAKAWAY TRAVEL CLUB PTY LTD		
2TA5467	BRIGHTON SHELLEY LTD		
2TA001803	BRITISH AIRWAYS PLC		
2TA5077	BRNOVIC	MARKO	MASTER TRAVEL PTC PENINSULA TRAVEL CENTRE K J LYNCH TRAVEL SERVICE K J LYNCH TRAVEL SERVICE
2TA4752	BROAD	IRENE ENSOMO DOUGLAS CHARLES	
2TA4753	BROAD		
2TA002550	BROAD HORIZONS PTY LTD		BROAD HORIZONS TRAVEL GRAFTON TRAVEL AGENCY

2TA5373 2TA5466	BROEKING BROMFIELD HOLDING PTY LTD	KYLIE ELIZABETH	INSIGHT AUSTRALIA TRAVEL SOUTHERN CROSSINGS AUSTRALIA
2TA5223 2TA4991 2TA5128 2TA004119	BROOKS BROWN BUDGET OZ TRAVEL PTY LTD BUDIDEA PTY LTD	CAROLYN GAYE TRUDI ANN	TRUDI'S TRAVEL CENTRE TRAVEL SHOP NARRANDERA TRAVEL SHOP COLEAMBALLY GLOBE INTERNATIONAL TRAVEL SERVICE TRAVELSCENE MAITLAND ALDINGA TOURS TRAVELSCENE BURWOOD
2TA003307	BUDLILY PTY LTD		
2TA5500 2TA5095 2TA5629	BUNDABAH TRAVEL PTY LTD BURGESS BURWOOD INTERNATIONAL TRAVEL PTY LTD	PAUL IVAN	HARVEY WORLD TRAVEL (BURWOOD) BUSHELL TRAVEL HARVEY WORLD TRAVEL (DUBBO)
2TA001608	BURWOOD TRAVEL PTY LTD		
2TA002917 2TA5547	BUSHELL BUSY TRAVEL PTY LTD	PETER ALLAN	
2TA5220 2TA5587 2TA4790 2TA5441 2TA002635 2TA001805	C & E TOURS AUSTRALIA PTY LTD C B S TRAVEL PTY LTD C E TRAVEL & TOURS PTY LTD C X C TRAVEL PTY LTD CADIA COACH TOURS PTY LTD CAFTAX PTY LTD		CXC TRAVEL HARVEY WORLD TRAVEL (KIAMA VIEW)
2TA002588 2TA002823	CAHILL CALAMBELL PTY LTD	BRENDA	SYDNEY UNIVERSAL TRAVEL TOURS
2TA4654 2TA000008 2TA5526 2TA001073 2TA5639 2TA5538	CALTOE PTY LTD CAMMARERI CAMP BOOMERANG PTY LTD CAMPBELLTOWN TRAVEL PTY LTD CANAM PTY LTD CAPE BYRON HOSTEL TRAVEL PTY LTD	VINCENZO	V CAMMARERI TRAVEL AGENCY
2TA000118	CAPUTO	ANTONIO	BROOKVALE TRAVEL CAPUTO TRAVEL CAPUTO TRAVEL BROOKVALE TRAVEL BROOKVALE TRAVEL CAPUTO TRAVEL
2TA002218	CAPUTO	MARCO	
2TA002219	CAPUTO	GIOVANNI DOMENICO	
2TA5252	CAREAWAY TOURS AUSTRALIA PTY LTD		
2TA5580 2TA5097	CARNIVAL PLC CARROLL	ROBERT CHRISTOPHER MEGAN MARY	P & O CRUISES THE BIG PICTURE TRAVEL COMPANY NATIONAL CAPITAL EXCURSION SERVICES BERNIE CARTWRIGHT TOURS
2TA5671	CARTERS		
2TA002954	CARTWRIGHT	BERNARD THOMAS DIANNE JOYCE	BERNIE CARTWRIGHT TOURS CASINO TRAVEL SHOPPE FORZA TRAVEL
2TA002955 2TA5182 2TA004028	CARTWRIGHT CASINO TRAVEL SHOPPE PTY LTD CASSANITI	GERARDO CONCETTO	
2TA4407	CASTERIN PTY LTD		HARVEY WORLD TRAVEL LANE COVE RIVERLAND TRAVEL CULBURRA COACHES HARVEY WORLD TRAVEL (KEMPSEY)
2TA4232 2TA5192 2TA004069	CASTLE CAVADIL PTY LTD CAVTRAV PTY LTD	JUDITH ANN	
2TA003945 2TA4923	CELTIC TRAVEL SERVICES PTY LTD CHAN	KIN (MILLIAN)	BM LUCKY DRAGON TRAVEL SERVICE
2TA002970 2TA4959 2TA4669 2TA4670 2TA5525 2TA4612 2TA004142	CHAN & LAM PTY LTD CHATSWOOD TRAVEL PTY LTD CHAUDHARY CHAUDHARY CHEN CHENG CHIEM	RITU ABID ALI XIAO HONG RINGO WAN WAH KIM	ROYAL INTERNATIONAL TRAVEL ROYAL INTERNATIONAL TRAVEL A PERFECT CHOICE TRAVEL HARVEST TRAVEL SERVICES LUCKY INTERNATIONAL TRAVEL SERVICE CHINA BESTOURS CHINA SOUTHERN AIRLINES CTS INTERNATIONAL TRADING
2TA5431 2TA5176 2TA001849	CHINA BESTOURS (AUST) PTY LTD CHINA SOUTHERN AIRLINES CO LTD CHINA TRAVEL SERVICE		

	(AUSTRALIA) PTY LTD		COMPANY
2TA4391	CHOI	SEOUNG HYUN	CHINA VACATIONS
2TA000368	CHUNG PAK TRAVEL PTY LTD		K O D/ PALM TOURS
2TA5420	CIRCOSTA	ANGELA	CHUNG PAK TRAVEL
		GIOCONDA	TRAVELSCENE PLUMPTON
2TA000637	CIRCUIT TRAVEL PTY LTD		
2TA000457	CIT AUSTRALIA PTY LTD		CIT WORLD TRAVEL GROUP
2TA001245	CLAPOUDIS	EVA	FIVE DOCK TRAVEL AGENCY
2TA5299	CLARK	DIANA ST JOHN	THE ROCKS TRAVEL
2TA5622	CLASSIC INTERNATIONAL CRUISES PTY LTD		
2TA4996	CLASSIC ORIENTAL TOURS PTY LTD		
2TA000612	CLUB MEDITERRANEE (AUSTRALIA) PTY LTD		
2TA004162	COASTAL TRAVEL PTY LTD		HARVEY WORLD TRAVEL (BATEMANS BAY)
2TA5666	COBALT BLUE TRAVEL PTY LTD		
2TA003452	COHEN	FAY CHRISTINE	TRAVEL PHASE
2TA4572	COLYER	BRIAN JAMES	IRIS TOURS
2TA4573	COLYER	VALENTINA	IRIS TOURS
		WENDY	
2TA4811	COMEALONG TOURS PTY LTD		
2TA5613	COMFORT TOUR COACH CO SYDNEY PTY LTD		COMFORT TOURS & COACH COMPANY
2TA001804	COMPLETE TRAVEL SERVICES PTY LTD		
2TA4435	COMPSON	LESLIE JAMES	THRIFTY TRAVEL
2TA002558	CONCORDE INTERNATIONAL TRAVEL PTY LTD		CONCORDE HOLIDAYS
			AIR TICKETS SYDNEY
			NATIONAL AIR TICKETS
			TRAVEL INDOCHINA
			VIETNAM HOLIDAYS
			CONCORDE SMART TRAVEL
			RAIL TICKETS
			SKYWAYS AVIATION SERVICES
			SMART MONEY
			SMART TRAVEL SOLUTIONS
			ALIA RJ
2TA5152	CONRAN ENTERPRISES PTY LTD		
2TA5357	CONSOLIDATED TRAVEL PTY LTD		
2TA001868	CONTIKI HOLIDAYS (AUSTRALIA) PTY LTD		
2TA001472	CONTIKI TRAVEL (AUSTRALIA) PTY LTD		
2TA003506	COOK	JILL ELIZABETH	TORII TOURS
			AOM HOLIDAYS
			ANCHOR TRAVEL
2TA002822	COOMA WORLD TRAVEL PTY LTD		HARVEY WORLD TRAVEL (COOMA)
2TA5306	COOPER	FIONA MARY	HARVEY WORLD TRAVEL ALBURY
2TA4241	CORAL SEAS TRAVEL PTY LTD		SOUTH PACIFIC ADVENTURES
2TA000862	CORBY	ROSS ALLAN	CORBY'S BUS LINES
			CORBY'S COACHES
2TA003248	CORPORATE CONFERENCE INTERNATIONAL PTY LTD		
2TA5569	CORPORATE TRAVEL HEADQUARTERS PTY LTD		
2TA5518	CORPORATE TRAVEL MANAGEMENT GROUP PTY LTD		CORPORATE TRAVEL MANAGEMENT
2TA5316	CORRIMAL TRAVEL PTY LTD		TRAVELSCENE AT CORRIMAL TRAVEL
2TA4699	CORTRAVEL PTY LTD		CRUISE NOW
2TA5542	COSTA TRAVEL PTY LTD		
2TA5444	CRAIG	VIVIENNE CHERYL	VIV'S TRAVEL BUG
2TA001140	CRAMPTON INVESTMENTS PTY LTD		TRAVELSCENE WAGGA WAGGA
2TA5376	CREATION ENTERPRISES & DEVELOPMENTS PTY LTD		
2TA003878	CREATIVE CRUISING GROUP PTY LTD		CREATIVE CRUISING
2TA002632	CREATIVE TOURS PTY LTD		
			CREATIVE HOLIDAYS
			CREATIVE VACATIONS AUSTRALIA
			CREATIVE CREDITS
2TA4901	CRONULLA TRAVEL PTY LTD		CRONULLA TRAVEL
2TA003038	CROSBY RURAL AND TRAVEL PTY LTD		THE AUSTRALIAN FARMERS TRAVEL SERVICE

2TA5052	CROSS	GREGORY JOHN	RESPONSIBLE TRAVEL
2TA001248	CRUISE & COACH CORPORATION PTY LTD		LISMORE TRANSIT CENTRE CHATOURS
2TA5125	CRYSTAL TOURS PTY LTD		SOUTHVINA TRAVEL & TOURS
2TA4975	CRYWANE PTY LTD		TRAVELWORLD BEGA
2TA003916	CULHAM	PETER ERIC	TRAVELSCENE ULLADULLA
			TRAVELSCENE BATEMANS BAY
2TA4762	CULHAM	PATRICIA KATHLEEN	TRAVELSCENE ULLADULLA
			TRAVELSCENE BATEMANS BAY
2TA4781	CUNARD LINE LTD		
2TA5539	CUY	CHERYL LEE	JETSET BROKEN HILL
2TA5540	CUY	WINCEN JOHN	JETSET BROKEN HILL
2TA4348	CW TRAVEL AUSTRALIA PTY LTD		CARLSON WAGONLIT TRAVEL
2TA003801	CYC TRAVEL SERVICES PTY LTD		CYC SERVICES
2TA001381	CZESLOTUR AIR SERVICES PTY LTD		
2TA4246	D & A ORCHARD INVESTMENTS PTY LTD		IT'S EASY TOURS
2TA5159	D M BELIN DEVELOPMENTS PTY LTD		VALUE INTERNATIONAL TRAVEL
2TA002903	D Q INTERNATIONAL TRAVEL SERVICE PTY LTD		
2TA4487	D'ALESSANDRO	JULIANNE	J D'S GLOBAL TRAVEL
2TA003713	DAEHO PTY LTD		DAEHO TRAVEL AGENCY
2TA5350	DAINBAR PTY LTD		CLASSIC COACHES
2TA4782	DALEN FINANCE PTY LTD		PRESTIGE WORLD TRAVEL
2TA4227	DALY	TRISHA	INISHFREE TRAVEL
			F O D TRAVEL/ FRIENDS OF DOROTHY TRAVEL
2TA4536	DANADINA PTY LTD		LOIS GUBBAY TRAVEL
2TA5342	DANLIE PTY LTD		HARVEY WORLD TRAVEL (WYOMING)
2TA002545	DANPIT PTY LTD		PROFI TOURS
			GERMAN TRADE FAIRS TRAVEL
2TA5253	DAWNEW PTY LTD		PROFI TRAVEL
			HARVEY WORLD TRAVEL(BLACKTOWN)
2TA003162	DAYSTAR TRAVEL & TOURS PTY LTD		
2TA4647	DE STIGTER	JAMES	NEW ZEALAND LEISURE TOURS
2TA001909	DELIGHT TRAVEL AGENCY PTY LTD		
2TA4571	DELMEGE	MAXWELL PHILIP	JETSET MONA VALE
2TA001864	DELTROW PTY LTD		KERRY PHILLIP'S GREAT EVENTS
2TA5181	DENNIS	SANDRA ELIZABETH	TRAVELLERS ACCOMMODATION SERVICE
2TA002765	DESEDU PTY LTD		HARVEY WORLD TRAVEL (FORBES)
2TA5073	DESTINATION PACIFIC AUSTRALIA PTY LTD		
2TA000206	DEUTSCHE LUFTHANSA AKTIENGESELLSCHAFT		
2TA003084	DEVULA PTY LTD		HARVEY WORLD TRAVEL (GRIFFITH)
2TA5468	DHARMA WORLD PTY LTD		ADVENTURE TRAVEL BUGS
2TA4954	DI MATTEO	MARYANNE	COMPLETE HOLIDAY SOLUTIONS
2TA000284	DIAMOND TOURS PTY LTD		
2TA4433	DIGITAL TRAVEL (SYDNEY) PTY LTD		
2TA003432	DIRECT FLIGHTS INTERNATIONAL PTY LTD		
2TA4436	DIRECT LINK TRAVEL PTY LTD		
2TA5359	DIRECT-HOLIDAYS AUSTRALIA PTY LTD		
2TA5183	DISCOVER THE WORLD MARKETING TRAVEL PTY LTD		
2TA001284	DISCOVERY TRAVEL CENTRE PTY LTD		CRUISECO CAMMERAY CRUISE CENTRE
2TA4388	DIXON TRAVEL & TOUR PTY LTD		
2TA5329	DOCKWISE AUSTRALIA PTY LTD		NEW WAVE TRAVEL
2TA001467	DOMESTIC & INTERNATIONAL TOUR BROKERS PTY LTD		FORGE TRAVEL
2TA002626	DONCROW PTY LTD		JETSET TRAVEL BYRON BAY BYRON BUS & COACH TRANSIT AND TRAVEL CENTRE BYRON BUS & BACK PACKER CENTRE

2TA5492	DONGYU INTERNATIONAL PTY LTD		JETSET TRAVEL BYRON BAY
2TA002764	DONNA BARLOW TRAVEL PTY LTD		BYRON BUS & COACH TRANSIT
2TA002678	DONNETT PTY LTD		AND TRAVEL CENTRE
			BYRON BUS & BACK PACKER
			CENTRE
2TA5631	DORO TRAVEL & TOURS SERVICES		BYRON OZ WIDE TRAVEL
	PTY LTD		FENGHUANG TRAVEL
2TA5651	DOUBLE BAY INBOUND TRAVEL PTY		CRUISESCENE
	LTD		HARVEY WORLD TRAVE
2TA004184	DOUBTFIRE PTY LTD		(INGLEBURN)
			JETSET PARRAMATTA - CHARLES
			ST
2TA003588	DOUGLAS	PETER	HARVEY WORLD TRAVEL
		FREDERICK	(GREENHILLS)
		MOIRA	JETAWAY TRAVEL
2TA003589	DOUGLAS		JETAWAY TRAVEL
2TA4475	DOWNUNDER DESTINATION		
	HOLDINGS PTY LTD		
2TA4831	DOWNUNDER DESTINATION		
	SERVICES PTY LTD		
2TA5535	DOWSETT	IRENE	YOUNG TRAVEL
2TA5532	DOWSETT	FRANCIS IRWIN	YOUNG TRAVEL
2TA5338	DREAM TRAVEL CENTRE PTY LTD		TRAVELSCENE AT DREAM TRAVEL
			CENTRE
2TA001724	DRINDOE PTY LTD		TRAVELABOUT
			TRAVELABOUT AT RYDE-
			EASTWOOD
			TRAVELABOUT AT RYDE-
			EASTWOOD
			TRAVELWORLD GYMEA
2TA5224	DRINDOS PTY LTD		
2TA002841	DRIVE AWAY HOLIDAYS PTY LTD		VISITORS SERVICES
2TA5523	DRIVER GROUP PTY LTD		DURHAMS COACHES
2TA002900	DURHAM	HILARY GORDON	ENDLESS TRAVEL
2TA5520	DUROVIC	JULIE	NOVA TRAVEL
2TA002596	DYLALINE PTY LTD		CHILE TOUR
2TA002947	E & L INTERNATIONAL PTY LTD		C T T WORLD TRAVEL
			TRAVELSCENE FAIRFIELD
2TA4814	E A & D K PTY LTD		HARVEY WORLD TRAVEL
2TA4826	EASTWOOD TRAVEL CENTRE PTY		(EASTWOOD)
	LTD		ANDY'S WORLD TRAVEL
2TA5144	EASY GROUP AUSTRALIA PTY LTD		
2TA002746	EASY TRAVEL PTY LTD		ECRUISING4KIDZ.COM.AU
2TA5076	ECRUISING PTY LTD		CRUISEAGENTS.COM.AU
			ECRUISING.COM.AU
2TA5190	EDDY	DARREL JOHN	SCENIC HORIZON TOURS
2TA5191	EDDY	KERRIE LYNETTE	SCENIC HORIZON TOURS
2TA003733	EDUCATIONAL WORLD TRAVEL PTY		G'DAY USA-UNITED STATES
	LTD		CULTURAL EXCHANGE AUSTRALIA
			CATHOLIC CULTURAL TOURS
2TA5415	EDWARDS TOURS PTY LTD		
2TA001131	EL SADIK	MOHAMAD	M ELSADIK ORIENT TRAVEL
			CENTRE
2TA5288	ELEGANT TRAVEL PTY LTD		
2TA4564	ELITE WORLD TRAVEL PTY LTD		TRAVELEADERS TUMUT
2TA5337	ELJAY TRAVEL PTY LTD		HARVEY WORLD TRAVEL
2TA4834	ELJOHN NEW SOUTH WALES PTY		CIRCULAR QUAY
	LTD		HARVEY WOLD TRAVEL
			(WARRAWONG)
2TA4497	ENCORE TOURS PTY LTD		
2TA4444	ENGAUSCAN PTY LTD		TOUR MARVEL
2TA4496	ENSIGN MARINE SERVICES PTY LTD		TRAVELSCENE TWEED VALLEY
2TA001228	EPCOB PTY LTD		NEW ENGLAND TRAVEL CENTRE
2TA5487	EQUITY CONSULTING SERVICES PTY		EQUITY TRAVEL
	LTD		
2TA002609	EST SKI TOURS PTY LTD		ESTOURS TRAVEL
2TA5491	EUROPE TRAVEL CENTRE PTY LTD		
2TA002714	EVANS	JOHN WAYNE	SNOWLINER TRAVEL
2TA002715	EVANS	PETER JOHN	SNOWLINER TRAVEL
2TA002716	EVANS	MYRTLE MAY	SNOWLINER TRAVEL
2TA002717	EVANS	PETER ROBERT	SNOWLINER TRAVEL

2TA5553	EVENTSCAPE PTY LTD		
2TA4746	EVER SUN TRAVEL PTY LTD		EVER SUN TOURS & TRAVEL EVERSUN HOLIDAYS EVERWIN TRAVEL
2TA5545	EVERWIN PTY LTD		
2TA001719	EVERYTHING TRAVEL PTY LTD		
2TA5648	EXCELSIOR TOURS & TRAVEL PTY LTD		EXCELSIOR HOLIDAY
2TA5233	EXPANDING HORIZONS (AUST) PTY LTD		POTTER TRAVEL
2TA5260	EXPERIENCE SPORT! PTY LTD		MID CITY TRAVEL
2TA001237	EXPRESS TRAVEL PTY LTD		EXPRESS TRAVELINK
2TA5409	EXPRESSLINK HOLDINGS PTY LTD		
2TA5298	EXTREME TRAVEL PTY LTD		
2TA5205	FAR EAST SERVICES PTY LTD		VIEN DONG TOURIST SERVICE ALLIED-WAH MIN TRAVEL ALLIED WAH MIN TRAVEL - BANKSTOWN TRAVELSCENE ULTIMO
2TA002522	FASORI PTY LTD		
2TA003131	FASTBOOK HOLIDAYS PTY LTD		
2TA002702	FEARNES TOURS PTY LTD		
2TA4425	FELICE TRAVEL PTY LTD		PENDLE HILL TRAVEL PISANI TRAVEL MALTA TRAVEL
2TA4777	FELIX TRAVEL PTY LTD		
2TA001616	FELSTOP PTY LTD		HARVEY WORLD TRAVEL (COWRA) MEDITERRANEAN HOLIDAYS & TOURS
2TA4879	FICHERA	MARIA DOMENICA (DONNA)	HARVEY WORLD TRAVEL - WETHERILL PARK
2TA4880	FICHERA	JOHN ANDREW	HARVEY WORLD TRAVEL - WETHERILL PARK GRANGE TRAVEL
2TA4506	FINEFLEX PTY LTD		
2TA4303	FINESSE SOUTH PACIFIC TRAVEL PTY LTD		
2TA4449	FIRST BARACUDA PTY LTD		INCENTIVE HOUSE TRAVEL FIRST CHOICE TRAVEL FIRST CHOICE TRAVEL HOLIDAY COAST FIRST CHOICE TRAVEL
2TA4945	FIRST CHOICE TRAVEL PTY LTD		
2TA004074	FIU	TELESIA	SAMOAN TRAVEL AGENCY FLIGHT CENTRE STUDENT FLIGHTS FLIGHT CENTRE FLIGHT CENTRE CORPORATE TRAVELLER FLIGHT CENTRE ESCAPE TRAVEL FLIGHT CENTRE CORPORATE TRAVELLER FLIGHT CENTRE ESCAPE TRAVEL LOW & JAMES TRAVEL ASSOCIATES FLIGHT CENTRE STUDENT FLIGHTS FLIGHT CENTRE FLIGHTCENTRE.COM ESCAPE TRAVEL FLIGHT CENTRE CORPORATE TRAVELLER FLIGHT CENTRE STUDENT FLIGHTS FLIGHT CENTRE ESCAPE TRAVEL FLIGHT CENTRE ESCAPE TRAVEL FLIGHT CENTRE STUDENT FLIGHTS FLIGHT CENTRE PETERSON & TURNER TRAVEL ASSOCIATES FLIGHT CENTRE ESCAPE TRAVEL VFR FLIGHTS FLIGHT CENTRE CRUISEABOUT
2TA002719	FLIGHT CENTRE LTD		

			TURRAMURRA TRAVEL ASSOCIATES FLIGHT CENTRE STUDENT FLIGHTS FLIGHT CENTRE STUDENT FLIGHTS FLIGHT CENTRE STUDENT FLIGHTS FLIGHT CENTRE ESCAPE TRAVEL AUSTRALIA NEW ZEALAND TRAVEL MARKETING TRAVELOGIC NET LINK TRAVEL
2TA001587	FLIGHT DECK (AUST) PTY LTD		
2TA003512	FLORON NOMINEES PTY LTD		
2TA004052	FORMTINE PTY LTD		
2TA000551	FOTI	SALVATORE	
2TA002216	FOTI	VINCENZO	
2TA4340	FRANCIS TRAVEL REPRESENTATION PTY LTD		
2TA003698	FRASER'S COACHES DUBBO PTY LTD		
2TA5257	FRATE	LUANA KELLY	
2TA003754	FREQUENT FLYERS PTY LTD		SYDNEY BUSINESS TRAVEL S B T BUSINESS TRAVEL SOLUTIONS HARVEY WORLD TRAVEL- LITHGOW D-TRAVEL
2TA4394	FRIDLAND TRAVEL PTY LTD		
2TA5281	FRIENDSHIPXCHANGE NETWORK PTY LTD		
2TA5324	FRINGE OF THE DESERT TOURS PTY LTD		
2TA001297	FUCHS	HELEN MARY	TRAVELSCENE AT CHESS TRAVEL
2TA5164	FUSSELL	BRADLEY STUART	WANDERERS AUSTRALIA
2TA5165	FUSSELL	KYLIE LOUISE	WANDERERS AUSTRALIA TRAVEL MAESTRO (INBOUND)
2TA5000	FUTURE TRAVEL PTY LTD		
2TA003440	G & J INTERNATIONAL TRAVEL PTY LTD		
2TA003709	GABRIELLE	MILAD (MARK)	PACIFIC GATEWAY TRAVEL
2TA003710	GABRIELLE	CHAKIB CARLO	
2TA000944	GALACTICA TOURS PTY LTD		SUMMERLAND TRAVEL LISMORE TRAVELSCENE SUMMERLAND TRAVEL
2TA003998	GALAXY WORLD TRAVEL PTY LTD		
2TA5616	GAMAX PTY LTD		S E TRAVEL
2TA003664	GARDENFIELD PTY LTD		JETOVER TOURS
2TA001441	GARUDA ORIENT HOLIDAYS PTY LTD		
2TA000888	GATEWAY TRAVEL PTY LTD		GATEWAY TOURS
2TA5143	GEBRAEL	SONIA MARY	TRAVEL TIME
2TA4476	GEGU HOLDINGS PTY LTD		TRAVELWORLD BONNYRIGG
2TA001151	GEM EZY FLIGHTS PTY LTD		GEM EZY FLIGHTS
2TA4364	GEMTRIP PTY LTD		TRAVELAND BATHURST TRAVELSCENE BATHURST TRAVELLA TRAVEL
2TA003533	GEMZEAL PTY LTD		SYDNEY LINK TRAVEL CENTRE
2TA4767	GENDY	ADEL	GSA SKY AIR SERVICES (NSW)
2TA001139	GENERAL SALES AGENTS INTERNATIONAL PTY LTD		
2TA001930	GENERAL TRAVEL GROUP PTY LTD		WORLD INTERLINE TOURS GENERAL TRAVEL AUSTRALIA THE CONGRESS TRAVEL OFFICE EASYWAY HOLIDAYS GENKI TRAVEL TRAVELWORLD CROWS NEST TRAVELWORLD HORNSBY TRAVELWORLD CASTLE HILL HIDEAWAY HOLIDAYS
2TA5670	GENKI TRAVEL PTY LTD		
2TA000868	GENTRY TRAVEL PTY LTD		
2TA001352	GEORGE COPELAND HOLDINGS PTY LTD		
2TA5673	GERRINGONG TRAVEL PTY LTD		TRAVELSCENE AT GUIDEPOST
2TA003552	GET SET TRAVEL PTY LTD		FRENCH TRAVEL CONNECTION INTERNATIONAL TRAVEL CONNECTION AEGEANTOURS TRAVEL WITH ME
2TA003715	GIANAKOULI	SYLVIA	
2TA5377	GILLIES	KERRI ANN	
2TA003403	GILPIN TRAVEL MANAGEMENT PTY LTD		
2TA4355	GINGA EXPRESS TRAVEL SERVICE PTY LTD		

2TA4249	GITANI TRAVEL AGENCY PTY LTD		
2TA4817	GLADES TRAVEL SERVICE PTY LTD		
2TA001511	GLEN TRAVEL SERVICE PTY LTD		TRAVELSCENE BELROSE
2TA000938	GLENQUARIE TRAVEL PTY LTD		
2TA003438	GLENSONE PTY LTD		FOUR SEASONS HOLIDAYS TRAVEL
2TA4916	GLOBAL BOUND PTY LTD		CARIBBEAN BOUND MARCO POLO TRAVEL CARIBBEAN HOLIDAYS CUBA HOLIDAYS GLOBAL BOUND HERITAGE DESTINATIONS
2TA002597	GLOBAL EXPRESS PTY LTD		
2TA5294	GLOBAL TRAVEL ENTERPRISES PTY LTD		TRAVEL DIRECT OF KINGSCLIFF
2TA5363	GLOBAL TRAVEL SPECIALISTS PTY LTD		COSMOS HOTELS ONLINE EXCITE HOLIDAYS TRAVELSCENE HAYMARKET
2TA5560	GLOBAL TROTTERS PTY LTD		
2TA5358	GO TRAVEL GROUP PTY LTD		
2TA5046	GO TRAVELING PTY LTD		AIRFARE.COM.AU
2TA001171	GOBRAN	WAFIK	TWIN WINGS AIR TRAVEL TWIN WINGS TRAVEL ATKING MEDINA TOURS & TRAVEL (HAJJ & UMROH PLUS)
2TA001505	GOLD AIR TRAVEL (NSW) PTY LTD		
2TA4651	GOLD MEDIA PRODUCTIONS PTY LTD		AERO WORLD SOLUTIONS
2TA003926	GOLDEN BOW PTY LTD		DWITOUR AUSTRALIA
2TA5071	GOLDEN DRAGON TRAVEL PTY LTD		
2TA4815	GOLDEN GLOBAL INTERNATIONAL TRAVEL PTY LTD		
2TA002770	GOLDEN MANLY MANAGEMENT SERVICES PTY LTD		FANTASTIC AUSSIE TOURS TRAVELWORLD SPRINGWOOD
2TA5141	GOLDEN MILES TRAVEL & TOURS INTERNATIONAL PTY LTD		
2TA5282	GOLDEN TRAVEL AGENT PTY LTD		
2TA5093	GOLDEN WATTLE TRAVEL SERVICES PTY LTD		
2TA003840	GOLDEN WORLD TRAVEL PTY LTD		
2TA5496	GOLDMAN TRAVEL CORPORATION PTY LTD		
2TA5598	GOLF TRAVEL HEADQUARTERS PTY LTD		
2TA5194	GOODES' TRAVEL PTY LTD		HARVEY WORLD TRAVEL (TUMUT)
2TA003737	GOODMAN	ROSS MAXWELL	HARVEY WORLD TRAVEL (GORDON) HARVEY WORLD TRAVEL (ST IVES)
2TA5453	GORMAN	SUSAN JOY	TRAVELSCENE KEMPSEY GOSFORD TRAVEL CENTRE (RETAIL)
2TA000812	GOSFORD TRAVEL CENTRE PTY LTD		HARVEY WORLD TRAVEL MITTAGONG AUSTRALIAN TRAVEL & INFORMATION CENTRE PACESETTER TRAVEL
2TA5263	GOULBURN TRAVEL PTY LTD		
2TA003022	GOWAY TRAVEL PTY LTD		
2TA5410	GRACE EDUCATIONAL SERVICES INTERNATIONAL PTY LTD		
2TA5243	GRAND CIRCLE AUSTRALIA PTY LTD		
2TA5215	GRAND TOURING INTERNATIONAL PTY LTD		HARVEY WORLD TRAVEL (MERRYLANDS) GTI WORLD GTI SPORTS
2TA001779	GRANNY MAYS TRAVEL PTY LTD		
2TA004137	GRANTHAM-SMITH	CLAIRE MARIE	HARVEY WORLD TRAVEL (KYOGLE)
2TA4626	GRAY	IAN ROBERT	WINGHAM WORLDWIDE TRAVEL
2TA4627	GRAY	PENELOPE JOY	WINGHAM WORLDWIDE TRAVEL
2TA4738	GRAY	RUSSELL JAMES	GRAYS TOURS NEWCASTLE
2TA4739	GRAY	KRISTINE ADELL	GRAYS TOURS NEWCASTLE
2TA5187	GREAT AUSTRALIAN TOURS PTY LTD		DISCOVERY AIR TOURS
2TA5340	GREAT SOUTHERN LAND TRAVEL SERVICES PTY LTD		TRAVELSCENE HORSLEY PARK
2TA5544	GREAT TREND MANAGEMENT PTY		G T I M

2TA5275	LTD GREAT WALL TRAVEL SERVICE PTY LTD		
2TA5411	GREECE & MEDITERRANEAN TRAVEL CENTRE PTY LTD		
2TA001170	GREEN TRAVEL SERVICE PTY LTD		ARTARMON TRAVEL G T S TRAVEL MANAGEMENT ALL AUSSIE TRAVELERS EZY TRAVEL DIAL-A-HOLIDAY WOY WOY
2TA4912	GREENBERG	DAVID NEAL	
2TA5588	GREENTEEES MARKETING PTY LTD		
2TA003591	GRIFFIN	JEFFREY KENNETH JULIE	DIAL-A-HOLIDAY WOY WOY GET INCENTIVES GET EVENTS GET GROUP ENTERTAINMENT TRAVEL GET CRUISING GET CONFERENCES GET LOYALTY GROUPS R US EDUCATION ACTIVE TOURS NEW ZEALAND GROUP TOUR SPECIALISTS
2TA003593	GRIFFIN		
2TA4839	GROUP EVENT TRAVEL SYDNEY PTY LTD		
2TA4495	GROUP EVENTS PTY LTD		
2TA003040	GSM AUSTRALIA PTY LTD		
2TA4749	GTA AUSTRALASIA PTY LTD		
2TA001347	GULLIVER'S TRAVELS PTY LTD		
2TA001303	GULLIVERS SPORT TRAVEL PTY LTD		GULLIVERS SPORT & MUSIC TRAVEL
2TA003283	GUNDAGAI SHIRE COUNCIL		
2TA003447	GURUTRAVEL INTERNATIONAL PTY LTD		
2TA5355	GUZZUNI PTY LTD		VILLAGE TRAVEL OR ST IVES VILLAGE TRAVEL
2TA002977	GWYDIR SHIRE COUNCIL		
2TA002544	H I N TRAVEL PTY LTD		TRAVELSCENE WOLLONGONG AT INTERNET TRAVEL
2TA4672	H I S AUSTRALIA PTY LTD		
2TA5455	HACOBIAN	SHAKEH JACKIE	
2TA5456	HACOBIAN	HARMICK	TRAVEL CAFE LANE COVE TRAVEL CAFE LANE COVE
2TA5289	HALE	JANELLE KAYE	NORTH COAST TRAVEL
2TA5290	HALE	ALAN JOHN	NORTH COAST TRAVEL
2TA003454	HALEY	DAVID JOHN	
2TA002529	HAMERLINE PTY LTD		HARVEY WORLD TRAVEL CROWS NEST
2TA5104	HAMILTON ISLAND TRAVEL PTY LTD		
2TA4362	HAMMOUD	MAHMOUD	UNITED WORLD TRAVEL EGYPT BY NILE TOURS
2TA5554	HANA TOUR AUSTRALIA PTY LTD		
2TA5174	HANCOCK EVENTS INTERNATIONAL PTY LTD		HANCOCK CORPORATE TRAVEL
2TA003567	HANNAFORDS AUSTRALIAN TOURS PTY LTD		
2TA001129	HANS H KRISTENSEN TRAVEL PTY LTD		
2TA002726	HANSU PTY LTD		
2TA4713	HARBOUR CITY INTERNATIONAL PTY LTD		EVENT MANAGEMENT & TRAVEL
2TA5193	HARKHAM HOLDINGS PTY LTD		
2TA004111	HARRIS TRAVEL PTY LTD		
2TA001236	HARRIS TRAVEL SERVICE PTY LTD		NAGI TRAVEL INTERNATIONAL
2TA5210	HART	JONGKOLNEE	
2TA003632	HARVEST AUSTRALIA PTY LTD		HARVEY WORLD TRAVEL (PARKES) CHARMING TOURS HARVEST PILGRIMAGES HARVEST YOUTH TOURS VARIETY TRAVEL HARVEY'S CHOICE HOLIDAYS UNIQUE JOURNEYS CITY-LINK TRAVEL KIAMA TOURING COMPANY
2TA4657	HARVESTMAN ENTERPRISE PTY LTD		
2TA004072	HARVEY HOLIDAYS PTY LTD		
2TA5617	HASTINGS MARKETING PTY LTD		
2TA003986	HAU	THI MY NGOC	
2TA5302	HAWKES	JILL ELIZABETH	
2TA003687	HAWTON	PETER JOHN	
2TA4999	HEBANI INTERNATIONAL PTY LTD		HARVEY WORLD TRAVEL CHULLORA EGYPT RESERVATION CENTRE AFRICA TRAVEL COMPANY WORLDWIDE ADVENTURE TRAVEL
2TA4709	HEDLEY TRAVEL PTY LTD		

2TA4914	HEFFERNAN	MARGARET LOUISE DESLIE GAI	THE ADVENTURE SPECIALISTS PANORAMA TOURS FREELINE INDONESIAN SURF ADVENTURES DUCK CREEK MOUNTAIN TRAVEL
2TA5474	HENDERSON SALCEDO		GO LATIN AMERICA
2TA003499	HERON AIRLINES TRAVEL PTY LTD		SUMMERLAND TRAVEL
2TA001496	HIFURE PTY LTD		MERIMBULA
2TA003549	HIGH RANK TRAVEL PTY LTD		CARINGBAH TRAVEL SERVICE
2TA000832	HIGHFIELD ENTERPRISES PTY LTD		
2TA5331	HIGHFLI PTY LTD		TRAVELSCENE AT HILLS TRAVEL CENTRE
2TA5158	HILLS TRAVEL CENTRE PTY LTD		ST MARYS TRAVEL TRAVELWORLD ST MARY'S TENZING'S INTERNATIONAL STUDY TOURS
2TA001600	HILTCAN PTY LTD		HIMALAYAN TRAVEL CENTRE TRAVELWORLD- NORTH SYDNEY TRAVEL ADVANTAGE MONA VALE PTC EVENTS NATIONAL WORLD TRAVEL- WOLLONGONG TRAVELWORLD WOLLONGONG
2TA4690	HIMALAYAN TRAVEL CENTRE (AUST) PTY LTD		PHOENIX TRAVEL
2TA004084	HINTERE PTY LTD		HONEY TRAVEL & TOURS AGENCY
2TA5498	HOBSON & SPIGHT PTY LTD		
2TA5291	HOLIDAY EDGE PTY LTD		OPAL TRAVEL
2TA4327	HOLIDAY TOURS WOLLONGONG PTY LTD		
2TA4251	HOLIDAY-KING TRAVEL PTY LTD		HARVEY WORLD TRAVEL (HORNSBY) HOWARD'S COACHES
2TA5229	HOLMES CONSULTING PTY LTD		
2TA003205	HOMA TRAVEL PTY LTD		HOWARD'S COACHES
2TA5023	HONEW TOURS PTY LTD		HOWARD'S COACHES
2TA003404	HONEY TRADING PTY LTD		HOWARD'S COACHES
2TA4995	HONEYMOON WORLDWIDE HOLIDAYS PTY LTD		VICTORIA TELE WORLD TRAVEL
2TA004000	HONLINK PTY LTD		
2TA5440	HORIZON SPORTING EVENTS PTY LTD		HUNTER TRAVEL GROUP TRAVELWORLD BELMONT TRAVELWORLD CHARLESTOWN SQUARE TRAVELWORLD GARDEN CITY KOTARA TRAVELWORLD TORONTO TRAVELWORLD GLENDALE JETSET RAYMOND TERRACE TRAVELWORLD CESSNOCK TRAVELWORLD NEWCASTLE RUSSIA AND BEYOND RENAISSANCE TOURS
2TA003812	HORNSBY TRAVEL PTY LTD		
2TA003516	HOWARD	ALPHONSUS ANDREW MICHAEL ANDREW KATHLEEN MARGARET ANTHONY JOSEPH YAO HUNG	HARVEY WORLD TRAVEL (BROOKVALE) HARVEY WORLD TRAVEL (CROWN CENTRAL) TRAVELSCENE MONA VALE
2TA003517	HOWARD		
2TA003518	HOWARD		IMAGINE TRAVEL HARVEY WORLD TRAVEL - SHELLHARBOUR SQUARE IMMANUEL TRAVEL
2TA003519	HOWARD		
2TA003346	HUANG		
2TA002936	HUMAN MOTIVATION PTY LTD		
2TA4986	HUNTER TRAVEL GROUP PTY LTD		KUMUKA EXPEDITIONS
2TA4526	I S B H PTY LTD		
2TA5614	I T D PTY LTD		
2TA5265	IAN SPIGHT PTY LTD		
2TA4938	ICET TRAVEL PTY LTD		
2TA000984	ID SOUTH PACIFIC PTY LTD		
2TA001709	ILLAWARRA TRAVEL PTY LTD		
2TA000806	IMAGINE TRAVEL PTY LTD		
2TA003070	IMMANUEL C T T PTY LTD		
2TA4485	INCENTIVE TRAVEL INTERNATIONAL PTY LTD		
2TA4696	INDEPENDENT TRAVEL ADVENTURE PTY LTD		

2TA4868	INFO TRAVEL & ACCOMMODATION PTY LTD		
2TA001564	INSIGHT VACATIONS PTY LTD		
2TA003603	INTEGRA INTERNATIONAL RESERVATIONS PTY LTD		
2TA5308	INTEGRATED TRAVEL SERVICES PTY LTD		HOLIDAYSONSALE.COM.AU CRUISESONSALE.COM.AU ALTITUDE TRAVEL
2TA4638	INTELETRAVEL PTY LTD		
2TA001538	INTERCONTINENTAL TRAVEL PTY LTD		
2TA5558	INTERCORP TRAVEL PTY LTD		HARVEY WORLD TRAVEL (HURSTVILLE) HARVEY WORLD TRAVEL (BANKSTOWN) INTERTRAVEL LINDFIELD TRAVELSCENE AT INTERTRAVEL LINDFIELD
2TA003728	INTERHOLD PTY LTD		
2TA5573	INTERNATIONAL CONFERENCE & TRAVEL PTY LTD		
2TA4560	INTERNATIONAL CONFERENCE MANAGEMENT PTY LTD		COMPLETE CONFERENCE MANAGEMENT & TRAVEL SYDNEY EXPRESS TRAVCOA RHYTHM EXPRESS TRAVEL VISITFRANCE.COM.AU SYNERGI GLOBAL TRAVEL UNITOURS WORLD TRAVEL SYDNEY EXPRESS TRAVEL EXPRESS EVENTS CLIQBOOK OUTTASK TRAVEL VOGUE SYDNEY EXPRESS INTERNATIONAL SPORTS TOURS IST TRAVEL GLOBAL FORUMS FLIGHT POINT WALLACE ARNOLD HOLIDAYS OPEN ROAD HOLIDAYS
2TA000566	INTERNATIONAL EXPRESS PTY LTD		
2TA4426	INTERNATIONAL SPORTS TOURS PTY LTD		
2TA003637	INTERNATIONAL TRAVEL ASSOCIATES PTY LTD		
2TA5378	INTERNATIONAL TRAVEL CENTRE PTY LTD		
2TA5480	INTERPAC INTERNATIONAL PTY LTD		AIMHIGH TOURS
2TA003001	INVERELL BUS SERVICE PTY LTD		
2TA4609	IRISHAM PTY LTD		CRUISE REPS
2TA4490	ISAAC	EPHRAIM NIRDOSH	BALLINA TRAVEL VALUE
2TA001556	ISIROO PTY LTD		TRAVELSCENE DENILIQUIN TQ3 TRAVEL SOLUTIONS TQ3 TRAVELSCENE ON CROWN
2TA002547	ITG PTY LTD		
2TA5663	J & N HICKMAN PTY LTD		
2TA5082	J B E HOLDINGS PTY LTD		
2TA003952	J C B INTERNATIONAL (OCEANIA) PTY LTD		
2TA5621	J C TRAVEL PROFESSIONALS PTY LTD		
2TA5605	J D TRAVEL PTY LTD		
2TA5389	J V L TRAVEL PTY LTD		
2TA4731	J V M TRAVEL PTY LTD		JETSET TRAVEL ORANGE
2TA5572	JABER	CLAUDINE HABIB	SWAN TRAVEL
2TA002842	JABIR		
2TA5102	JADE TRAVEL PTY LTD		
2TA003444	JADELEN PTY LTD		HARVEY WORLD TRAVEL (TERRIGAL)
2TA5126	JAEPOR PTY LTD		
2TA001551	JAIARA PTY LTD		JADE EXPRESS TRAVEL JALPAK JALPAK TRAVEL ITC - INCENTIVE TOUR & CONFERENCE MANAGEMENT HAMPDEN TRAVEL
2TA001647	JALPAK INTERNATIONAL OCEANIA PTY LTD		
2TA003784	JAMADU PTY LTD		
2TA5034	JANUS TOURS AUSTRALIA PTY LTD		
2TA000131	JAPAN AIRLINES INTERNATIONAL CO LTD		
2TA4894	JAPAN AUSTRALIA TOURISM PTY LTD		

2TA004046	JARGAN PTY LTD		TRAVELSCENE - MIRANDA TRAVEL
2TA001877	JARIT (AUST) PTY LTD		COMPASS TRAVEL (GALSTON)
2TA002873	JARVIS	ROBERT ALLAN	
2TA5403	JAX (AUSTRALIA) PTY LTD		JAX TRAVEL
2TA5244	JAYES TRAVEL SERVICES PTY LTD		
2TA4840	JCM DESTINATION AUSTRALIA PTY LTD		
2TA4615	JEFFERY	CHRISTOPHER JOHN GUY	TRAVELSCENE AT LAKELINE
2TA4616	JEFFERY	BAMBINA PINA LUCY	TRAVELSCENE AT LAKELINE
2TA5667	JEMIMA ENTERPRISES PTY LTD		PAYLESS WORLD TRAVEL
2TA003237	JENNIFER GORRIE & ASSOCIATES PTY LTD		RIGHT DIRECTIONS
2TA001250	JET-SEA ENTERPRISES PTY LTD		HARVEY WORLD TRAVEL (JANNALI)
2TA003291	JETAROUND HOLIDAYS PTY LTD		
2TA4784	JETAWAY CONNECTIONS PTY LTD		NEUTRAL BAY TRAVEL TRAVELWORLD NEUTRAL BAY
2TA001801	JETGLOBE TRAVEL PTY LTD		
2TA5519	JETSAFE TRAVEL PTY LTD		
2TA001916	JETSET TOURS (ROSE BAY) PTY LTD		
2TA002579	JETSET TOURS (TAMWORTH) PTY LTD		
2TA5361	JETSET TRAVELWORLD LTD		THOMAS COOK TRAVEL (LIVERPOOL)
2TA5335	JETTIN PTY LTD		HARVEY WORLD TRAVEL (CHATSWOOD)
2TA4730	JETUP BEI-AO TRAVEL PTY LTD		
2TA4968	JIANCE PTY LTD		TRAVELEADERS LEETON
2TA5589	JIM'S HOLIDAY TRAVEL PTY LTD		
2TA4818	JIREH KARALAE PTY LTD		ADVANCE TRAVEL CENTRAL COAST
2TA5419	JNR TRAVEL PTY LTD		TRAVELEADERS WAGGA
2TA001230	JOHN REID TRAVEL PTY LTD		JETSET TRAVEL NEWCASTLE
2TA004180	JOLLY SWAGMAN TRAVEL AGENCY PTY LTD		
2TA5256	JONES	NAOMI JENNIFER	
2TA003995	JRL INVESTMENTS (AUST) PTY LTD		JRL TRAVEL
2TA001663	JTA OCEANIA PTY LTD		KOALA BUS
2TA001972	JTB AUSTRALIA PTY LTD		
2TA4710	JULIE KEEGAN TOURS PTY LTD		GARDEN LOVERS TOURS AUSTRALIAN WINE & FOOD TOURS
2TA4684	JULIETTA TRAVEL PTY LTD		DANCE TRAVEL TRAVELSCENE PORT TO PORT TRAVEL
2TA4963	JULROS PTY LTD		BUSINESS & LEISURE TRAVEL HARVEY WORLD TRAVEL (BRIGHTON-LE-SANDS)
2TA5464	JURY	NOELINE FRANCES	ALL AUSSIE HOLIDAYS
2TA003902	JUSTRAVEL PTY LTD		ARMIDALE TRAVEL CENTRE ARMIDALE FLIGHT CENTRE E-TICKET TRAVEL CENTRE ARMIDALE
2TA002877	JW ASEAN TRAVEL SPECIALIST PTY LTD		MALAYSIA SINGAPORE TRAVEL SPECIALIST MALAYSIAN HOLIDAYS & TOURS K & A TRAVEL SERVICES HARVEY WORLD TRAVEL (NOWRA)
2TA5478	K & A TRAVEL SERVICE PTY LTD		
2TA002811	K & C LONGFORD PTY LTD		
2TA003636	K & H TRAVEL CENTRE PTY LTD		
2TA4707	KADDAK PTY LTD		MILLENNIUM TRAVEL SERVICES VANUATU ESCAPES OCEAN BLUE VANUATU
2TA4470	KANA TRAVEL PTY LTD		
2TA4369	KARCHER	AMANDA LOUISE MAROLYN	AMANDA KARCHER TRAVEL ZORBAS TRAVEL SERVICE - THE TRAVEL SPOT
2TA5504	KAREFYLAKIS		TRAVELSCENE KEANS MUSWELLBROOK
2TA002784	KEANS TRAVEL SERVICE PTY LTD		JETSET TRAVEL GRIFFITH JETSET TRAVEL GRIFFITH COROWA TRAVEL LINK SPORTSLINK INTERNATIONAL
2TA003538	KEENAN	PAUL DANIEL	
2TA003539	KEENAN	JANINE MARIE	
2TA5118	KELLY	SUSAN ANNE	

2TA4397	KELLY TRAVEL COMPANY PTY LTD		TOURS TRAVELSCENE COFFS HARBOUR KELLY TRAVEL COMPANY TRAVELSCENE HAMILTON
2TA4593	KELMIK PTY LTD		
2TA5477	KEMPE	MELANIE LIETTE	
2TA5556	KENNEDY'S TOURS PTY LTD		KENNEDY'S TOURS
2TA5517	KENTROSE PTY LTD		KENTROSE INTERNATIONAL TRAVEL
2TA002960	KERBA	NICHOLAS	AUSONIA TRAVEL SERVICE
2TA4688	KEYOR PTY LTD		JET SET DEE WHY
2TA004062	KHOURY	ABRAHAM	TRAVELSCENE MERRYLANDS
2TA001439	KING	GRAHAME KEITH	THE KINGS OF NEWCASTLE BUS & COACH SERVICES
2TA002258	KING	HELEN JOY	THE KINGS OF NEWCASTLE THE KINGS OF NEWCASTLE BUS & COACH SERVICES
2TA5662	KING	BELINDA CHRISTINE	THE KINGS OF NEWCASTLE A S A TRAVEL
2TA5546	KING PACIFIC INTERNATIONAL PTY LTD		KING PACIFIC TRAVEL & TOURS
2TA001558	KINGSFORD TRAVEL AGENCY PTY LTD		
2TA002654	KINTETSU INTERNATIONAL EXPRESS (OCEANIA) PTY LTD		KINTETSU TRAVEL CENTRE SYDNEY
2TA5550	KISS	WENDY ANNE	TRAVELWORLD GOSFORD
2TA001826	KITCHEN MAID PTY LTD		NARRABEEN TRAVEL CENTRE
2TA5285	KLEDO PTY LTD		HARVEY WORLD TRAVEL (CHARLESTOWN)
2TA4383	KNECHT REISEN AUSTRALIA PTY LTD		KN - TRAVEL AUSTRALIA
2TA003862	KNESPAL	GARRY JOHN	ASSOCIATION TRAVEL
2TA5391	KNIGHT	GARY EDWARD	TRAVELSCENE BYRON BAY
2TA4755	KOALA TRAVEL PTY LTD		
2TA5022	KOBRA	NUSRET	ARENA TRAVEL
2TA003854	KOLIMDA PTY LTD		HARVEY WORLD TRAVEL- NARELLAN
2TA000369	KONINKLIJKE LUCHTVAART MAATSCHAPPIJ N V		KLM ROYAL DUTCH AIRLINES
2TA5325	KORALIA TOURS PTY LTD		
2TA5002	KOREA TRAVEL AGENCY PTY LTD		
2TA003973	KORYO TRAVEL SERVICE PTY LTD		KORYO TRAVEL SERVICE
2TA003206	KOSTRALIA TOUR & TRAVEL PTY LTD		
2TA5060	KOUDRINA	IRINA	AUSTRALIANA DISCOVERY
2TA5059	KOUDRINE	IGOR	AUSTRALIANA DISCOVERY
2TA001702	KRSOSKA	BLAGA	CENTROTURIST TRAVEL SERVICE
2TA4550	KULPER	MILU	ALL PLANET TRAVEL & ALL BUS COMPANY
2TA4549	KULPER	JOHN BRADLEY	ALL PLANET TRAVEL & ALL BUS COMPANY
2TA002521	KYLBLUE PTY LTD		HARVEY WORLD TRAVEL (WOLLONGONG)
2TA001778	KYRENIA TRAVEL SERVICE PTY LTD		SUN ISLAND TOURS
2TA5170	KYU HEE PTY LTD		
2TA000828	LABBOZZETTA	FRANK	MARCONI TRAVEL
2TA002229	LABBOZZETTA	DOMENICO	MARCONI TRAVEL
2TA002230	LABBOZZETTA	ANTHONY	MARCONI TRAVEL
2TA003735	LACAN PTY LTD		LACAN TRAVEL
2TA001932	LAKE	ROBERT WALTER	
2TA002287	LAKE	BERVENE ELIZABETH	
2TA000783	LAKEMBA TRAVEL CENTRE PTY LTD		
2TA4832	LAL	MARCEL SUMESH	REAL INTERNATIONAL TRAVEL
2TA5258	LAMIL PTY LTD		F I FIJI ISLAND TOURS
2TA004152	LAND VOYAGES PTY LTD		ISLAND & CORPORATE TRAVEL COAST & COUNTRY AUSTRALIA TOURS
2TA5502	LANDMARK TRAVEL PTY LTD		LANDMARK TRAVEL
2TA003289	LANDSUN PTY LTD		SEOUL TRAVEL
2TA5157	LANI TRAVEL PTY LTD		HARVEY WORLD TRAVEL (BONDI JUNCTION)
2TA4351	LANJAK PTY LTD		TRAVEL WORLD MOUNT DRUITT NATIONAL WORLD TRAVEL - MOUNT DRUITT

2TA003353 2TA4642	LANSIX PTY LTD LARKEY	JULIE-ANNE	EASTERN SUBURBS TRAVEL HARVEY WORLD TRAVEL (COFFS HARBOUR)
2TA5110	LASTMINUTE.COM AUSTRALIA PTY LTD		
2TA4225 2TA003922	LATERAL LIVING PTY LTD LATITUDE TRAVEL PTY LTD		AUSIN INTERNATIONAL TRAVEL KENT CARS & HOTELS AMERICA WEST MARKETING
2TA003792 2TA000816 2TA5123 2TA5369 2TA003343 2TA003259 2TA003741 2TA4323 2TA000742 2TA003223 2TA004196 2TA003577 2TA003303	LAURENCE TRAVEL PTY LTD LAZARIS LE LEADBEATTER LEADWAY TRAVEL PTY LTD LEAL LEE LEE FU PTY LTD LEISUREWORLD TRAVEL PTY LTD LET'S TRAVEL AUSTRALIA PTY LTD LETHANG LETICIA TRAVEL PTY LTD LEVER	GEORGE THUY DINH THI KYLIE LOUISE GRAHAM ALFRED CHOI LING ROSA TIEN DAWN JUNE LOUISE	ASTRA TRAVEL SERVICE THAI-BINH TRAVEL CENTRE WARNERS BAY TRAVEL JUNEE TRAVEL ROSA'S TRAVEL GRAND ELITE TRAVEL KAY AT LEISURE WORLD TRAVEL SKYBUS MEKONG TRAVEL TRAVEL CARE
2TA4870 2TA5661 2TA003340 2TA003668	LI & FUNG TRAVEL PTY LTD LIAISON TRAVEL PTY LTD LIANG LIBERTY TRAVEL SERVICES PTY LTD	XIAO HONG	UNEEDA HOLIDAYS DISCOUNT AIR TRAVEL (LAKEMBA) ANSWIRS RESERVATIONS NEW ZEALAND TRAVEL
2TA5148 2TA001918 2TA003388 2TA003157 2TA4694	LIDO TRAVEL PTY LTD LIM LINDFIELD TRAVEL PTY LTD LINDSAYS TRAVEL PTY LTD LINDY ARCHER & ASSOCIATES PTY LTD	ALICE GEK MOI	ADVCON TRAVEL SERVICES TRAVELWORLD COFFS HARBOUR HARVEY WORLD TRAVEL (CASTLE HILL)
2TA003595 2TA4605	LINEAJOHNS PTY LTD LION INTERNATIONAL TRAVEL SERVICE PTY LTD		GLOBAL VILLAGE TRAVEL LION INTERNATIONAL TRAVEL
2TA5074 2TA003796 2TA003797 2TA004164 2TA4500 2TA001518	LITHGOW TRAVEL PTY LTD LIU LIU LONGHURST LONGWAY ENTERPRISES PTY LTD LOTTE TRAVEL & FREIGHT SERVICE PTY LTD	ALEXANDER GWYNETH EDNA D	TRAVELSCENE LITHGOW E D L INTERNATIONAL LONGWAY TRAVEL
2TA5625 2TA004025	LOVAN PTY LTD LOVELOCKS RADIO PTY LTD		TRAVELSCENE ON CLARENCE HARVEY WORLD TRAVEL (WAGGA WAGGA)
2TA003096	LOWDER & SONS BUS & COACH SERVICE PTY LTD		
2TA001389 2TA001806 2TA4577	LTM TRAVEL PTY LTD LUANGRATH LUKA	KEO OUDONE KAREN MARGARET	APAC TRAVEL SPORTEX TRAVEL
2TA5173 2TA4641	LUNG HANG INDUSTRY PTY LTD LUXURY TRAVEL PTY LTD		TARA HOLIDAYS AUSTRALIA HARVEY WORLD TRAVEL SYLVANIA
2TA003265	LYN PULLEN'S WORLD TRAVEL PTY LTD		
2TA5567 2TA4447 2TA001397	LYNCH LYNDWOOD TOURS PTY LTD LYSNACE PTY LTD	DARREN LESLIE	OUTBACK TRAVEL SHOP HARVEY WORLD TRAVEL (WINSTON HILLS)
2TA001041 2TA4588	M & G TRAVEL PTY LTD M A GASPAR & SONS PTY LTD		PETERSHAM TRAVEL CENTRE HARVEY WORLD TRAVEL PETERSHAM TRAVELSCENE CASULA
2TA5482 2TA003025 2TA5511 2TA5081 2TA5053 2TA4610 2TA5180 2TA002992 2TA5387 2TA4943	M M TRAVEL PTY LTD M P TRAVEL PTY LTD MA MACARTHUR TRAVEL PTY LTD MACEDON TRAVEL PTY LTD MACKIE MACLEAY VALLEY TRAVEL PTY LTD MAHON MAI MAITLAND TRAVEL SERVICES PTY	EMMA YING HELEN LORRAINE DENISE EDNA LI JING	SUNYDO TRAVEL AGENCY MACARTHUR TRAVEL CAMDEN D J TRAVEL LACHLAN TRAVEL (YOUNG) DENISE MAHON TRAVEL MAKLI TRAVEL SERVICE HARVEY WORLD TRAVEL

	LTD		(MAITLAND)
2TA002918	MAJESTIC TRAVEL PTY LTD		
2TA4896	MAKEHAM	ANNETTE VERONA	MAKEHAM'S COACHES
2TA4897	MAKEHAM	LINDSAY JOHN	MAKEHAM'S COACHES
2TA000530	MALAYSIAN AIRLINE SYSTEM BERHAD		MALAYSIA AIRLINES
2TA5423	MANLY TRAVEL SERVICE PTY LTD		MANLY TRAVEL SERVICE
2TA001348	MAPEN PTY LTD		A J A STANMORE TRAVEL AGENCY
2TA4474	MARIA ROSA TRAVEL PTY LTD		
2TA001888	MARINOPOULOS	DIMITRIOS	ARGO TRAVEL SERVICE
2TA5398	MARK PEARMAN PTY LTD		
2TA4795	MARKAR TRAVEL PTY LTD		
2TA4682	MARKOVSKI	BORIS	B M CENTURY TRAVEL
2TA004059	MARSHALL	SUSAN LEA	HARVEY WORLD TRAVEL (GUNNEDAH) GUNNEDAH TRAVEL AGENCY TRAVEL TOGETHER TRAVELSCENE AT MARTINS ALBURY EASTERN EUROPE TRAVEL BUREAU RUSSIAN TRAVEL CENTRE
2TA4579	MARTIN OWENS PTY LTD		
2TA002744	MARTINS TRAVEL & TOURS PTY LTD		
2TA002531	MARTRON PTY LTD		
2TA001148	MARY LEE PTY LTD		
2TA002503	MASLENBRIDGE PTY LTD		HARVEY WORLD TRAVEL (KATOOMBA) HARVEY WORLD TRAVEL - SINGLETON TRAVELSCENE ALBION PARK TRAVELSCENE ALBION PARK TRAVELPORT HARVEY WORLD TRAVEL (NORTH RICHMOND) HARVEY WORLD TRAVEL (NORTH RICHMOND)
2TA5344	MASON	KEVIN JOSEPH	
2TA5345	MASON	JENNIFER JEAN	
2TA4748	MATLAKE PTY LTD		
2TA5607	MAVIN	DEBRA MICHELLE	
2TA5606	MAVIN	ANDREW ROBERT	
2TA001776	MAXIMS TRAVEL PTY LTD		
2TA5459	MAYLAND ANZTOUR PTY LTD		
2TA5417	MAZUMDER	S A M ZAKIR HUSSAIN	ZAAZ INTERNATIONAL
2TA001807	MCCARROLL'S (INTERNATIONAL) TRAVEL WORLD PTY LTD		RZ TRAVEL HARVEY WORLD TRAVEL (EMU PLAINS)
2TA5371	MCCULLOCH	TERENCE ERIC	
2TA003179	MCDERMOTT	ORMOND KEVIN	SYDNEY CITY CENTRE TRAVEL AGENT
2TA003180	MCDERMOTT	MAUREEN ANNE	SYDNEY CITY CENTRE TRAVEL AGENT
2TA001372	MCGANN TRAVEL CENTRE PTY LTD		TRAVELSCENE TAREN POINT
2TA003293	MCKEOUGH	COLIN JOHN	COCONUT GROVE TRAVEL MALABAR COCO RESORT INVESTMENT AND TRAVEL
2TA003294	MCKEOUGH	KARIL LORRAINE	COCONUT GROVE TRAVEL MALABAR COCO RESORT INVESTMENT AND TRAVEL
2TA5301	MCKEOWN	ROENA GAY	
2TA5300	MCKEOWN	WARREN JAMES	
2TA5462	MCLEOD	MAXWELL WILLIAM	TRAVELLERS ACCOMMODATION SERVICE
2TA003244	MEADOW TRAVEL SERVICE PTY LTD		
2TA5250	MEDIATRAVEL PTY LTD		MEDIATRAVEL
2TA5326	MEDICAL MEETINGS HOLDINGS PTY LTD		MEDICAL MEETINGS
2TA5655	MEGA TRAVEL PTY LTD		
2TA004209	MELHUIISH	NARELLE FAYE	TRAVELWORLD SALAMANDER BAY TRAVELWORLD GREEN HILLS TRAVELWORLD SALAMANDER BAY
2TA004210	MELHUIISH	DOUGLAS RAYMOND	
2TA002731	MENDES	ROGERIO ROMAO	TRAVELWORLD GREEN HILLS MENDES TRAVEL WOOLLAHRA TRAVELWORLD EPPING HARVEY WORLD TRAVEL (MERIMBULA)
2TA4330	MENON BROTHERS TRAVEL PTY LTD		
2TA4662	MERIMBULA BOOKING SERVICES PTY LTD		
2TA5189	MEROLA	DAMIAN	MEROLA'S TRAVEL SERVICE
2TA5375	MEROLA	LEONORA MARIA	MEROLA'S TRAVEL SERVICE

2TA5604	MERYL MCDONALD TRAVEL PTY LTD		TRAVELWORLD LIVERPOOL
2TA003564	MESAN ENTERPRISES PTY LTD		ASIAWIDE TRAVEL
2TA001029	MESSAGE TRAVEL PTY LTD		
2TA4234	METROPOLE TRAVEL PTY LTD		
2TA000987	MICHAEL EDEN PTY LTD		EDEN TRAVEL
			EDEN CORPORATE TRAVEL
			AFRICAN EDEN
			EDEN TRAVEL
			BUS BOOKING CENTRE
2TA5536	MILLENIUM TRAVEL PTY LTD		
2TA5147	MILOLU PTY LTD		KEAN TRAVEL & TOURS
2TA4636	MILPAT PTY LTD		HARVEY WORLD TRAVEL (CORRIMAL)
2TA5390	MIN GYO TOUR PTY LTD		
2TA002668	MINHINNETT	KEITH RULE	WOOLGOOLGA TRAVEL CENTRE
2TA5140	MINT TRIPS PTY LTD		
2TA003736	MITCHELL	ADELE KAYE	HARVEY WORLD TRAVEL (GORDON)
			HARVEY WORLD TRAVEL (ST IVES)
2TA5416	MOHAMMAD	RIAZUL ISLAM	ZAAZ INTERNATIONAL
			RZ TRAVEL
2TA003423	MONSEES		CHERRYBROOK TRAVEL
2TA5528	MORAMARK PTY LTD	MONIQUE MARIA	GREAT AUSSIE TRAVEL & TOURS
			WORLDSTAR TRAVEL
			GUILD TRAVEL
			PHARMACY ALUMNI TRAVEL
2TA4390	MORAY TRAVEL COMPANY PTY LTD		
2TA4392	MORNING CALM PTY LTD		
2TA003855	MOSS VALE TRAVEL PTY LTD		BONG BONG HIGHLAND COTTAGES
2TA4990	MOSTRAVEL PTY LTD		TRAVEL SPECIALIST MOSMAN
			EUROPE SPECIALISTS
2TA4800	MOUNTAIN & SEA TRAVEL PTY LTD		
2TA001672	MOUNTSTEPHEN TRAVEL PTY LTD		TRAVELSCENE ENGADINE
2TA5026	MOVES TRAVEL GROUP PTY LTD		
2TA003126	MSC TRAVEL PTY LTD		
2TA002869	MULLUMBIMBY TRAVEL PTY LTD		TRAVELSCENE MULLUMBIMBY
2TA5362	MULPHA HOTEL PTY LTD		HAYMAN RESORT
2TA5364	MULTI PACIFIC PTY LTD		
2TA003885	MURRAY RIVER DEVELOPMENT LTD		
2TA4987	MURRAYS AUSTRALIA LTD		
2TA001967	MURRI	MARION NERIDA	MOUNTAIN MAGIC TRAVEL
2TA5255	MYALL TRAVEL PTY LTD		
2TA5493	MYPLANET AUSTRALIA PTY LTD		
2TA5396	N T & T INVESTMENTS PTY LTD		ASEAN TRAVEL & TOURS
2TA4703	N W T B PTY LTD		TRAVELWORLD BATHURST
2TA5203	NAJDI	JAMAL	LAMAR TRAVEL AGENCY
2TA5626	NAJDI	GUNWAH	LAMAR TRAVEL AGENCY
2TA4927	NAJJAR	JOHN	PARKLAND TRAVEL
2TA5065	NARELLAN TRAVEL CENTRE PTY LTD		
2TA003342	NARUKO PTY LTD		CONDOBOLIN TRAVEL SERVICE
2TA5571	NATIONAL TICKET CENTRE PTY LTD		
2TA5207	NATIONWIDE JEWELLERS PTY LTD		NATIONWIDE TRAVEL
2TA001364	NATOLI	PATRICK	TRAVELSCENE AT LAZE AWAY
		GIACOMO	TRAVEL
2TA002254	NATOLI	CATHERINE	LAZE-AWAY TRAVEL
		DANIELA	
2TA002959	NAVEM PTY LTD		SEVEN STAR TRAVEL
2TA001136	NEDIM	RIFAT	GALAXY TRAVEL SERVICES
2TA5311	NELSON BAY R S L TRAVEL CLUB PTY LTD		HARVEY WORLD TRAVEL- NELSON BAY
2TA001114	NELSON BAY TRAVEL PTY LTD		RAYMOND TERRACE TRAVEL
			TRAVELWORLD RAYMOND TERRACE
2TA4926	NEMIROVSKA	OLGA	BONDI TRAVEL
		LEONIDOVNA	
2TA4541	NEW CENTURY HOLIDAYS PTY LTD		NEW CENTURY HOLIDAYS TRAVEL INTERNATIONAL
2TA004063	NEW LAND TRAVEL PTY LTD		
2TA4477	NEW LINE TOURS PTY LTD		
2TA001961	NEW WORLD TRAVEL INTERNATIONAL PTY LTD		H I S
2TA4620	NGUYEN	DUY VUONG	CBD - TRAVELVISION
2TA4921	NGUYEN	ROSA HONG	AUS-ZEALAND TRAVEL & TOURISM

2TA001760	NICOL TRAVEL PTY LTD	NHUNG	SAIGON DU LICH WYONG PLAZA TRAVEL TRAVELPLANNERS LAKE HAVEN SACHI TOURS
2TA001939	NIPPON TRAVEL AGENCY (AUSTRALIA) PTY LTD		
2TA001455	NIUGINI TOURS PTY LTD		NEW GUINEA TRAVEL CENTRE MELANESIAN TOURS BORNEO TOUR SPECIALISTS NEW GUINEA TOURS CONTEMPORARY EXPERIENCES WALINDI DIVING NEW GUINEA EXPEDITIONS NIUGINI HOLIDAYS EAST TIMOR TOURS TIMOR TOURS CORAL SEA TOURS BODY AND SOUL HOLIDAYS KOKODA EXPEDITIONS TRAVELWORLD TAREE
2TA004109	NORLING	KARENNE ELIZABETH	
2TA001286	NORROB PRODUCTS PTY LTD		TRAVELWORLD FORSTER MOORE LEISURE TRAVEL MLT TRAVEL & EVENT MANAGEMENT SERVICES HARVEY WORLD TRAVEL NORTH RYDE NORTHERN HIGHLAND TRAVEL
2TA4898	NORTH RYDE TRAVEL PTY LTD		
2TA5150	NORTHERN HIGHLAND TRAVEL PTY LTD		
2TA003666	NORTHERN TERRITORY TOURISM & PROMOTIONS PTY LTD		
2TA003790	NORTHSHORE TRAVEL PTY LTD		
2TA002772	NORTHSIDE BUSINESS TRAVEL PTY LTD		
2TA5643	NOVICE	BERYL NORMA	GREAT EXPECTATIONS NCT TOURS & TRAVEL AUSTRALIA TRAVELWORLD NOWRA FAIR NRMA TRAVEL
2TA003410	NOWRA COACH TRAVEL PTY LTD		
2TA4948	NOWRA TRAVEL PTY LTD		
2TA5522	NRMA TRAVEL PTY LTD		
2TA002535	NUMBER ONE TRAVEL PTY LTD		
2TA001502	NUTAVE PTY LTD		SKI HOLIDAY HOTLINE AUSTRALIAN HOLIDAY HOTLINE GOLF HOLIDAY HOTLINE TRAVELSCENE MACKSVILLE TRAVELSCENE MACKSVILLE FORESTVILLE TRAVEL SERVICE WHITESANDS TRAVEL WHITESANDS TRAVEL WHITESANDS TRAVELS QUEANBEYAN CITY TRAVEL CAPITAL EDUCATIONAL TOURS SERVICES
2TA5019	O'DONNELL	SUZANNE MARIE	
2TA5020	O'DONNELL	MAURICE WALTER	
2TA000860	O'MALLEY	VERE PAULINE	
2TA5271	O'REGAN	TANIA LEE	
2TA5272	O'REGAN	CRAIG WILLIAM	
2TA003681	OAKDATE PTY LTD		
2TA5590	OAKHILL CONSOLIDATED PTY LTD		
2TA5245	OCEAN PACIFIC INTERNATIONAL TOURS & TRAVEL PTY LTD		
2TA5485	OCEAN SPIRIT TRAVEL PTY LTD		
2TA5248	OCEANIA TOUR SERVICE PTY LTD		
2TA5452	OCEANS ALIVE PTY LTD		HARVEY WORLD TRAVEL RHODES WATERSIDE
2TA5304	OCTOPUSTRAVEL.COM (AUSTRALIA) PTY LTD		
2TA003541	OGDENS TRAVEL PTY LTD		
2TA001682	OLAQUEST PTY LTD		INGLEBURN TRAVEL CENTRE TRAVELSCENE AT SOUTH WEST TRAVEL CRESTVIEW TRAVEL HARVEY WORLD TRAVEL (NAMBUCCA) HARVEY WORLD TRAVEL (NAMBUCCA)
2TA5025	OLCAYTO	OZLEM	
2TA003017	OLIVER	KENNETH GEORGE MARGARET LORRAINE	
2TA003078	OLIVER		
2TA002856	OLIVERI'S RELAXAWAY TOURS & TRAVEL PTY LTD		
2TA001317	OLYMPIA WORLD TRAVEL PTY LTD		SPLENDOR HOLIDAYS OLYMPIA HOLY LAND TOURS
2TA5595	OLYMPIC AIRLINES S A		
2TA001898	OMEGA WORLD TRAVEL PTY LTD		OMEGA TRAVEL DISCOVER AUSTRALIA TOURS VINA WORLD TRAVEL
2TA003163	ONG	VAN HUNG	

2TA5063	ONG	JULIA HUA	AUSTIME TRAVEL SERVICE
2TA5064	ONG	GARRY TAT-LIAM	AUSTIME TRAVEL SERVICE
2TA002927	ORANA COACHES PTY LTD		
2TA4429	ORIENT EXPRESS TOUR & TRAVEL SERVICES PTY LTD		
2TA5609	ORIENT EXPRESS TRAVEL INTERNATIONAL PTY LTD		ASIAN STUDENT TRAVEL ORIENT EXPRESS CORPORATE TRAVEL ORIENT EXPRESS HOLIDAYS ORIENT EXPRESS TRAVEL-SYDNEY EXPRESS TICKETING - SYDNEY
2TA5608	ORIENT EXPRESS TRAVEL SERVICES PTY LTD		
2TA5636	ORION XPEDITIONS PTY LTD		
2TA003335	OSTAQUARTZ PTY LTD		TRAVELSCENE HAY SYDNEY INTERNATIONAL TRAVEL CENTRE
2TA5292	OTC TRAVEL PTY LTD		
2TA4575	OUTBACK SPIRIT TOURS PTY LTD		
2TA002754	OVERTEX PTY LTD		HARVEY WORLD TRAVEL LAKE HAVEN HARVEY WORLD TRAVEL - TUGGERAH TRAVELSCENE WAHROONGA
2TA001206	OWGLOSS PTY LTD		
2TA4448	OXFORD TRAVEL (ANDREW VASS GROUP) PTY LTD		
2TA003766	OXLEY TRAVEL PTY LTD		
2TA003354	OZ INTERNATIONAL PTY LTD		OZ CULTURAL TOURS TAIWAN TRAVEL SERVICE
2TA5620	OZ KOREA TRAVEL PTY LTD		
2TA5212	OZINDAH TOUR & TRAVEL PTY LTD		
2TA5201	OZJOY PTY LTD		JETSET NOWRA
2TA002825	P G TOURS AUSTRALIA PTY LTD		
2TA003250	P T GARUDA INDONESIA LTD		
2TA5047	PACIFIC GREEN TOURS PTY LTD		
2TA4283	PALENZUELA	NELLIE DAVID	TOURLAND WORLDLINK HOLIDAYS JETSET TRAVEL WOLLONGONG I TRAVEL PROFESSIONAL PAN PACIFIC INCENTIVE SERVICES
2TA004128	PALMRAFT PTY LTD		
2TA4368	PAN CONTINENTAL TRAVEL PTY LTD		
2TA000763	PAN PACIFIC TRAVEL (AUSTRALIA) PTY LTD		
2TA003867	PAN WORLD TRAVEL PTY LTD		
2TA003939	PARCELS INTERNATIONAL PTY LTD		CONTAL TRAVEL TAJ TRAVEL SERVICE
2TA5399	PARIKH	VIKASH KUMAR	
2TA001765	PARISI TRAVEL PTY LTD		
2TA5197	PARKER	CHRISTOPHER ROBERT	AUZEALAND TOURS
2TA5339	PARSONS TRAVEL PTY LTD		HARVEY WORLD TRAVEL (WAUCHOPE) HARVEY WORLD TRAVEL (PORT MACQUARIE) NATOUR AUSTRALIA PATGAY TRAVEL AGENT
2TA5652	PASCHEN	KARL HEINZ	
2TA000269	PATGAY PTY LTD		
2TA000676	PATRIS TRAVEL PTY LTD		
2TA5016	PAXTOURS INTERNATIONAL TRAVEL PTY LTD		
2TA4244	PAYLESS FLIGHT CENTRE PTY LTD		BEST & LESS TRAVEL
2TA000360	PBT TRAVEL PTY LTD		
2TA002952	PEARCE	DAVID GEORGE	FIGTREE TRAVEL CENTRE TRAVELSCENE DAPTO TRAVELSCENE DAPTO FIGTREE TRAVEL CENTRE TRAVELSCENE DAPTO TRAVELSCENE DAPTO PEARCE COACHES
2TA002953	PEARCE	ANNE-MARIE	
2TA001229	PEARCE OMNIBUS PTY LTD		
2TA003942	PEREGRINE ADVENTURES PTY LTD		
2TA001755	PERFECT TRAVEL PTY LTD		
2TA5434	PERFORMANCE INCENTIVES PTY LTD		PERFORMANCE INCENTIVES
2TA002925	PETER MILLING (TRAVEL) PTY LTD		
2TA5499	PETER PAN'S BACKPACKER ADVENTURE TRAVEL PTY LTD		PETER-PANS BACKPACKER-LAND
2TA002725	PETRITSIS	DENNIS	DENNY'S TRAVEL CENTRE
2TA003585	PHAN DAM	HELEN HUE	FIVE STAR WORLD TRAVEL
2TA003008	PHIL TRAVEL SERVICE PTY LTD		
2TA003700	PHILIPPINE HOLIDAYS (NSW) PTY LTD		PHILIPPINE HOLIDAYS
2TA4468	PHU	CINDY	CINDY PACIFIC TRAVEL

2TA5024 2TA002973	PIERI PINETREES LORD HOWE ISLAND TRAVEL PTY LTD	ROBERT	INTERNET BAKPAK TRAVEL PINETREES TRAVEL
2TA002974	PINPOINT TRAVEL GROUP PTY LTD		VISA TRAVEL HOTLINE UNITED VACATIONS ROSIE HOLIDAYS TRAVEL HOTLINE FREESTYLE HOLIDAYS SINGAPORE AIRLINES HOLIDAYS ISLAND AFFAIR HOLIDAYS ASIAN AFFAIR HOLIDAYS EUROPEAN AFFAIR HOLIDAYS FLIGHT REWARDS
2TA4629 2TA4630	PIRANI PIRANI	CATHERINE ANITA DAVID	BELLINI TRAVEL BELLINI TRAVEL
2TA003415 2TA4704 2TA000831	PITT STREET TRAVEL PTY LTD POPULAR TRAVEL SERVICE PTY LTD PORT MACQUARIE TRAVEL AGENCY PTY LTD		CAMDEN HAVEN TRAVEL SETTLEMENT CITY TRAVEL
2TA001484	PORT STEPHENS BUSES (TRAVEL) PTY LTD		
2TA4698 2TA5279	POTTER PREMIER WORLD AUSTRALIA PTY LTD	SUSAN GAYE	THE AFRICA SAFARI CO NARA AIR TRAVEL
2TA5061	PREMIER WORLD TRAVEL PTY LTD		TRAVEL KNOW HOW GLADESVILLE FLIGHT AND HOLIDAY CENTRE SOLO VOYAGER HOLIDAYS TRAVEL KNOW HOW SOLO VOYAGER HOLIDAYS JETSET HAYMARKET NATIONAL WORLD TRAVEL GOULBURN TRAVEL WORLD GOULBURN KOREA EXPERIENCE TOURS JAPAN HOTEL RESERVATIONS JAPAN EXPERIENCE TOURS LEA'S WORLD TRAVEL SECURE TRAVEL TRAVELWORLD RICHMOND TRAVELWORLD PENRITH
2TA4334	PREPURE PTY LTD		
2TA4341	PRICE TRAVEL SERVICES PTY LTD		
2TA3204 2TA4464 2TA5001	PRODOMOU PROFIT PROFILES PTY LTD PROTOCOL ENTERPRISES PTY LTD	HARICLEA	LEA'S WORLD TRAVEL SECURE TRAVEL TRAVELWORLD RICHMOND TRAVELWORLD PENRITH
2TA4469 2TA5137 2TA003042	PRYMER TOUR SERVICES PTY LTD PUNT INVESTMENTS PTY LTD PURTILL	NEVILLE RAYMOND	HARVEY WORLD TRAVEL (LEETON) PURTILLS COACH TOURS AND TRAVEL SERVICES DIPLOMA WORLD TRAVEL SERVICE
2TA003633	Q T TRAVEL PTY LTD		
2TA000237 2TA003004	QANTAS AIRWAYS LTD QANTAS HOLIDAYS LTD		QANTAS AUSTRALIAN HOLIDAYS QANTAS JETABOUT HOLIDAYS VIVA! HOLIDAYS JETABOUT HOLIDAYS JETABOUT QFHOLS QFHOLIDAYS OAK FLATS TRAVEL CENTRE OAK FLATS TRAVEL CENTRE HARVEY WORLD TRAVEL - TORONTO HARVEY WORLD TRAVEL - KOTARA JETSET TRAVEL CASTLE HILL M I M INTERNATIONAL TRAVEL AGENT
2TA5505 2TA5506 2TA4798	QUARMBY QUARMBY R & G PEARSON PTY LTD	RHONDA LEE DAVID CHARLES	
2TA4794 2TA5578	R G B TRAVEL PTY LTD RAHMAN	BODIUR	
2TA5050 2TA5543	RAKSO AUSTRALIA PTY LTD RAMBLEGATE PTY LTD		K P KOMPAS TOURS AND TRAVEL GO SEE AUSTRALIA TRAVEL
2TA002598	RAMSGATE TRAVEL SERVICE PTY LTD		
2TA4983	RCW HOLDINGS PTY LTD		MOBILE TRAVEL SERVICE AUSTRALIAN ANDEAN ADVENTURES ANTARCTIC HORIZONS
2TA001820	REACTION TRAVEL PTY LTD		

2TA001594 2TA5069	REHO TRAVEL (AUSTRALIA) PTY LTD REID	JONATHAN JAMES	MANLY INTERNET AND TRAVEL CENTRE
2TA001493 2TA5129	RELIANCE TRAVEL PTY LTD RETAIL TRAVEL INVESTMENTS PTY LTD		TRAVEL ADVANTAGE CASTLE HILL HARVEY WORLD TRAVEL (MOSMAN) HARVEY WORLD TRAVEL (ARMIDALE) TRAVELSCENE REVESBY
2TA003705 2TA5092 2TA5401 2TA5579	REVESBY TRAVEL PTY LTD RHONDARAY PTY LTD RICHMOND VALLEY TRAVEL PTY LTD RISING STARS MANAGEMENT GROUP PTY LTD		RISING STARS SPORTS MANAGEMENT RISING STARS TRAVEL
2TA002615	RITCHIES EXPLORER TOURS PTY LTD		
2TA000935	RIVERINA WORLD TRAVEL PTY LTD		TRAVELSCENE NARRANDERA TRAVELSCENE GRIFFITH HAWKESBURY TRAVEL
2TA000015	RIX	WILLIAM ERIC KEVIN	
2TA4764	ROAD RUNNER TOURS WYONG PTY LTD		
2TA5408 2TA5465 2TA000282 2TA4985 2TA5581	ROAD TOUR & TRAVEL PTY LTD ROAD TRIP MEDIA PTY LTD ROBERT PAXTON (TRAVEL) PTY LTD ROBERTS ROBERTS	DOROTHY DAVID WILLIAM JOHN JACKALIN RUTH	PAXTON TRAVEL WALKER'S TRAVEL CENTRE WALKER'S TRAVEL CENTRE CENTRAL COAST TRAVEL BELLINGEN WORLD TRAVEL
2TA5582 2TA002794 2TA4773 2TA5633 2TA4466	ROBERTS ROBIN BELL PTY LTD ROBINSON ROBINSON RODNEY'S TRAVEL SOLUTIONS PTY LTD	KAAREN LAUNA SHERILYN	ALL AIRLINE RESERVATIONS AND TICKETING TRAVELSCENE ROSELANDS WONDERLAND TRAVEL FAIRFIELD BREAKAWAY TRAVEL (FAIRFIELD) BUDGET TRAVEL BYRON BAY
2TA003207	ROKACA PTY LTD		
2TA5407 2TA5488	ROLAND TRAVEL SERVICE PTY LTD ROSEDALE TRAVEL SERVICES PTY LTD		
2TA4431	ROSS GARDEN TOURS INTERNATIONAL PTY LTD		
2TA003290 2TA000839	ROSSBERG HOLDINGS PTY LTD ROTONDA WORLD TRAVEL SERVICE PTY LTD		DIANNA'S TRAVEL SERVICE WONDERLAND TRAVEL BREAKAWAY TRAVEL (BLACKTOWN) ROVER MOTORS TRAVEL CENTRE ROVER COACHES CESSNOCK BUS LINES ROYAL BRUNEI AIRLINES
2TA000132	ROVER MOTORS PTY LTD		
2TA5635	ROYAL BRUNEI AIRLINES SENDIRIAN BERHAD		
2TA5008 2TA5472 2TA5473 2TA001054	ROYAL HOLIDAYS TRAVEL PTY LTD RUTHERFORD RUTHERFORD RYAN	WAYNE TRISH CECILE	TWEED CITY TRAVEL TWEED CITY TRAVEL TRAVELSCENE TWEED HEADS TRAVELSCENE AT TWIN TOWN TRAVELSCENE TWEED HEADS TRAVELSCENE AT TWIN TOWN GOLD COUNTRY TOURS GOLD COUNTRY TOURS RICHMOND TRAVEL CENTRE
2TA002241	RYAN	DALLAS PATRICK	TRAVEL FAST INTERNATIONAL
2TA003305 2TA003306 2TA001969 2TA4230 2TA5365	RYAN RYAN RYLEA PTY LTD S & R TRAVEL PTY LTD S A H INTERNATIONAL TRADING PTY LTD	GERALD IGNATIUS JENNIFER ANNE	S K TRAVEL
2TA5432	S K INTERNATIONAL CULTURE EXCHANGE PTY LTD		
2TA5637 2TA001112 2TA5036 2TA001701 2TA003536	S S K TOUR PTY LTD S T A TRAVEL PTY LTD SABHLOK SABRA TRAVEL PTY LTD SADELLE PTY LTD	LYNDEN	S S K & E T C TOUR S T A TRAVEL BAY WORLD TRAVEL HARVEY WORLD TRAVEL (BROKEN HILL) ALL SEASONS TRAVEL
2TA003192	SAFWAT	ARFAN SAYED	

2TA4420	SAINTEN PTY LTD		MBL TRAVEL CENTRE
2TA5475	SALCEDO QUISPE	MARIO ALEJANDRO FEUPE	GO LATIN AMERICA
2TA5037	SALCRUZ PTY LTD		DESIGNER TRAVEL
2TA001185	SAMSUN PTY LTD		HARVEY WORLD TRAVEL (REVESBY)
2TA000879	SAN MICHELE TRAVEL PTY LTD		HARVEY WORLD TRAVEL DOUBLE BAY
2TA4252	SANFORD INTERNATIONAL TRAVEL PTY LTD		OVERSEAS EXPRESS TRAVEL
2TA002999	SAPUPPO	MARY ELIZABETH BOZIDAR	SAVIC'S TRAVEL CENTRE
2TA001184	SAVIC		
2TA001811	SCANDINAVIAN AIRLINES SYSTEM DENMARK NORWAY SWEDEN		
2TA002633	SCENIC TOURS PTY LTD		AUSTRALIAN SCENIC WORLD SCENIC TRAVEL OUTBACK ADVENTURE TOURS AUSTRALIAN FELLOWSHIP TOURS OUTBACK EXPLORER TOURS WARRNAMBOOL SCENIC TOURS AUSTRALIAN SCENIC SPORTS EVERGREEN TOURS TRAVELSCENE KIAMA KIAMA TRAVEL SERVICE HARVEY WORLD TRAVEL (SCONE)
2TA002563	SCOMETAL PTY LTD		
2TA000973	SCONE TRAVEL PTY LTD		
2TA4622	SCOTT	KEITH DAVID	
2TA4623	SCOTT	ANN-MAREE	
2TA4683	SEALANDAIR TRAVEL CONSULTANTS PTY LTD		
2TA001452	SEALIFE INTERNATIONAL PTY LTD		PRO-DIVE TRAVEL
2TA002984	SEALUM PTY LTD		HAPPY HOLIDAY & TRAVEL CENTRE
2TA002560	SEATEM TRAVEL PTY LTD		EXPOTEL EXECUTIVE TRAVEL KEITH PROWSE TOURS KEITH PROWSE ENTERTAINMENT TRAVEL KEITH PROWSE SPORTS SYDNEY INTERNATIONAL CHOIR FESTIVAL AND COMPETITION SYDNEY INTERNATIONAL CHOIR FESTIVAL SEKIDO TOUR AUSTRALIA
2TA5119	SEKIDO ENTERPRISES PTY LTD		
2TA4523	SELC TOURS PTY LTD		
2TA5237	SELECT TRAVEL SPECIALISTS PTY LTD		
2TA5219	SELECT-WORLD PTY LTD		SELECT TOURS AUSTRALIA
2TA001591	SELWOODS TRAVEL LISMORE PTY LTD		HARVEY WORLD TRAVEL (LISMORE)
2TA003917	SENIOR TOURS PTY LTD		
2TA5510	SERENDIPITY JOURNEYS PTY LTD		SERENDIPITY JOURNEYS NATURE TRAILS NORDIC TRAVEL SHEAN AND PARTNERS TRAX TRAVEL
2TA002582	SEWAH INTERNATIONAL PTY LTD		INHOUSE TRAVEL SERVICE
2TA003466	SHEAN AND PARTNERS PTY LTD		TRAVELSCENE AT WESTERN PLAINS TRAVEL HARVEY WORLD TRAVEL (BALLINA)
2TA5185	SHEARS	JULIE MARIE	ACCESS INTERNATIONAL TRAVEL CENTRE
2TA4335	SHELDRIK	PHILIP JAMES	TRAVELSCENE CAMDEN TRAVELSCENE CAMDEN TRAVELSCENE TUNCURRY
2TA003688	SHELLBALL PTY LTD		SHOWSPORT SHOWFREIGHT SHOWTRAVEL SHOWFILM
2TA003550	SHELLRIFT PTY LTD		
2TA5669	SHENG HENG AUSTRALIA PTY LTD		
2TA003749	SHERACK	GINA ANNETTE	
2TA003750	SHERACK	ROBERT JOHN	
2TA4360	SHILLALAE PTY LTD		
2TA5283	SHOW GROUP ENTERPRISES PTY LTD		
2TA001456	SID FOGG'S TRAVEL WORLD PTY LTD		
2TA002963	SIECLE PTY LTD		LORRAINES HOUSE OF TRAVEL
2TA003722	SILRIFT PTY LTD		2M TRAVEL IPANEMA TOURS HARVEY WORLD TRAVEL (ERINA) HARVEY WORLD TRAVEL (ERINA)
2TA5208	SIMCOTT PTY LTD		

2TA4695	SINACORI	MARISA SARA	FAIR)
2TA000314	SINGAPORE AIRLINES LTD		MARISA'S TRAVEL AGENCY
2TA4455	SINTUPANUTS	SUTTHIDA	GLOBAL AFFAIR
2TA001674	SIX CONTINENTS TRAVEL PTY LTD		DETOUR HOLIDAYS
2TA001680	SIYULI PTY LTD		HARVEY WORLD TRAVEL (NARRABRI)
			NAMOI TRAVEL SERVICE
2TA4524	SKYLIFE TRAVEL PTY LTD		
2TA003194	SKYLINK TRAVEL PTY LTD		
2TA4525	SKYWAY TRAVEL INTERNATIONAL PTY LTD		
2TA5564	SKYWINGS INTL PTY LTD		SKYWINGS TRAVEL
2TA003675	SLIMNICANOVSKI	TOM (METODIA)	UNIVERSAL FLIGHT CENTRE
2TA4410	SMARK TRAVEL PTY LTD		
2TA003951	SMILE INTERNATIONAL TRAVEL & TRADE PTY LTD		SMILE CITY TRAVEL
2TA004138	SMITH	BRIAN VINCENT	SMILE INTERNATIONAL HARVEY WORLD TRAVEL (KYOGL)
2TA5577	SMOKE DEPOT PTY LTD		METRO TRAVEL CENTRE
2TA4821	SMYTH	ROBERT GRAEME	HARVEY WORLD TRAVEL (MENAI)
			HARVEY WORLD TRAVEL FORSTER
2TA4822	SMYTH	LAUREN MELVA	HARVEY WORLD TRAVEL (MENAI)
			HARVEY WORLD TRAVEL FORSTER
2TA004121	SNOWAVE PTY LTD		SNOWAVE TRAVEL
2TA4437	SNOWED INN PTY LTD		SNOWY RIVER TRAVEL
			KOSCIUSKO ACCOMMODATION CENTRE
2TA003386	SNOWED UNDER HOLIDAYS PTY LTD		SKIONE
			ALPINE WORLD
			ALPINE NEW ZEALAND
			ALPINE WORLD REWARDS
			CLUB ALPINE
			SKI KAOS
2TA004043	SNOWTIME TOURS PTY LTD		
2TA5660	SNOWY MOUNTAINS HOLIDAY CENTRE PTY LTD		
2TA000230	SOCIETE AIR FRANCE		AIR FRANCE
2TA5323	SONSHINE TRAVEL PTY LTD		SONSHINE TRAVEL BYRON BAY
2TA5211	SONTHORPE PTY LTD		
2TA4517	SOUPIDIS	JEAN	BLUE DOLPHIN TRAVEL
2TA000948	SOUTH SYDNEY TRAVEL PTY LTD		
2TA004122	SOUTH WEST PACIFIC PTY LTD		TRAVELWORLD ULTIMO & PYRMONT
2TA5603	SOUTH WEST TRAVEL GROUP PTY LTD		TRAVELWORLD ROSELANDS
2TA003559	SOUTHERN CROSS TRAVEL PTY LTD		
2TA4686	SOUTHERN CROSS UNIVERSITY UNION LTD		
2TA003557	SOUTHERN SKY TRAVEL PTY LTD		
2TA4685	SOUTHERN TRAVELNET PTY LTD		
2TA4238	SOUTHERN WINGS (AUSTRALIA) PTY LTD		
2TA4583	SOUTHERN WORLD VACATIONS (AUST) PTY LTD		
2TA4993	SPECTRA TRAVEL PTY LTD		
2TA4829	SPENCER TRAVEL PTY LTD		
2TA5075	SPORTS TRAVEL PTY LTD		SPORTS TRAVEL
2TA5217	SPORTSWORLD PACIFIC PTY LTD		
2TA4518	SPREE HOLIDAYS PTY LTD		GOLDEN HOLIDAYS
			BREAK FREE PROMOTIONS TRAVEL
			BREAKFREE HOLIDAYS & TRAVEL
			MALAYSIA GOLDEN HOLIDAYS
			ONLINE TRAVEL SPREE
			COMPANION HOLIDAYS CLUB 55
2TA001882	SPRINGSHORE PTY LTD		HARVEY WORLD TRAVEL (BATHURST)
2TA5392	ST CLAIRE	BRENDA MAREE	TRAVELSCENE BYRON BAY
			BYRON BAY TRAVEL CENTRE
2TA001051	ST LEONARDS TRAVEL CENTRE PTY LTD		ST LEONARDS FLIGHT CENTRE
2TA4363	STAGE & SCREEN TRAVEL &		ST LEONARDS TRAVEL

2TA003640	FREIGHT SERVICES PTY LTD		
2TA002733	STANCZYK STANDARD INTERNATIONAL TRAVEL PTY LTD	BOGUSLAW	ORBIS EXPRESS
2TA003764	STAR FARES PTY LTD		
2TA5236	STAR INTERNATIONAL TRAVEL PTY LTD		
2TA004060	STAR THAI TRAVELS PTY LTD		
2TA000227	STARPAX PTY LTD		MARY ROSSI TRAVEL MARY ROSSI INTERNATIONAL STEWARTS TOURS & TRAVEL STEWARTS TOURS & TRAVEL
2TA003277	STEWART	ANDREW MURRAY	
2TA003278	STEWART	STEPHEN	
2TA4471	STUART'S TRAVEL PTY LTD		
2TA5597	STYLISH TRAVELLER PTY LTD		STYLISH TRAVELLER
2TA004175	SU	CHAN CUONG	NICE ADVENTURE TRAVEL
2TA5469	SULLIVAN	AMANDA JANE	DYNAMIC TRAVEL GROUP
2TA5470	SULLIVAN	JOHN MICHAEL	DYNAMIC TRAVEL GROUP
2TA5618	SUMMERLAND TOURS PTY LTD		
2TA003661	SUNCONE PTY LTD		SUNCONE TRAVEL & TOURS
2TA000718	SUNFLOWER TRAVEL PTY LTD		NORTHBRIDGE TRAVEL
2TA001910	SUNHAVEN COURT PTY LTD		3D TRAVEL
2TA5413	SUNLAND HOLIDAYS PTY LTD		
2TA004081	SUNNY WORLD TRAVEL PTY LTD		TRAVEL-ETICKETS.COM.AU
2TA4910	SUNRISE GLOBAL GROUP PTY LTD		TRAVELWORLD HURSTVILLE
2TA5214	SUNSHINE AUSTRALIA TRAVEL PTY LTD		
2TA4988	SUNSHINE TRAVEL PTY LTD		
2TA5521	SURYATAMI	ELLY	FELLOW TOUR
2TA5040	SWANSEA TRAVEL PTY LTD		TRAVELSCENE SWANSEA TRAVELSCENE BELMONT GREAT WORLD TRAVEL
2TA4708	SYDNEY FLYING EAGLE INTERMODAL TRANSPORTATION COMPANY PTY LTD		
2TA5552	SYDNEY MARKETS TRAVEL PTY LTD		TRAVELSCENE SYDNEY MARKETS
2TA003276	SYDNEY SEA & AIR CENTRE PTY LTD		
2TA002928	SYMES	GREGORY BRUCE	SYMES BUS SERVICE
2TA002929	SYMES	CLARA JEAN	SYMES BUS SERVICE
2TA002930	SYMES	RAYMOND LESLIE	SYMES BUS SERVICE
2TA002931	SYMES	FREDERICK GEORGE	SYMES BUS SERVICE
2TA5303	SYNERGI TRAVEL AUSTRALIA PTY LTD		
2TA000569	SZOZDA	ANDREW MIECZYSLAW	MAGNA CARTA TRAVEL
2TA5576	T C B ASSOCIATES PTY LTD		
2TA5348	T D & M J JOYCE PTY LTD		MARINER BOATING
2TA5640	T D H TRAVEL SERVICES PTY LTD		
2TA003433	TADROS TRAVEL SERVICE PTY LTD		
2TA5239	TAIBA	ABEER	AL MADINNAH TRAVEL
2TA001784	TALOMO PTY LTD		
2TA001345	TALPACIFIC HOLIDAYS SYDNEY PTY LTD		HAWAIIAN ISLAND TOURIST CENTRE ISLAND SPECIALIST HOLIDAYS NORFOLK ISLAND BOOKING CENTRE NORFOLK ISLAND TOURIST CENTRE PACIFIC ISLANDS TRAVEL CENTRE LORD HOWE BOOKING OFFICE PACIFIC & LORD HOWE ISLAND TOURIST CENTRE CVT TRAVEL
2TA003378	TAMA	CHARLES VINCENT	HARVEY WORLD TRAVEL ((TAMWORTH)
2TA4479	TAMWORTH BUSINESS TRAVEL PTY LTD		
2TA5602	TAPA TRAVEL & TECHNOLOGY PTY LTD		
2TA003857	TARA HOLIDAYS SYDNEY PTY LTD		TRAVEL QUEEN HOLIDAYS
2TA5241	TAYLOR	SANDRA LESLEY	B D C U TRAVEL SERVICE
2TA5646	TAYLOR	BRUNA	COASTLINE TRAVEL
2TA5647	TAYLOR	ALESSANDRA MICHAEL ANTHONY	COASTLINE TRAVEL
2TA4700	TAYLOR MADE TOURS PTY LTD		
2TA003027	TAYLOR MADE TRAVEL PTY LTD		TAYLOR MADE TRAVEL

2TA003281	TELFORD EDUCATIONAL TOURS PTY LTD		TRAVELSCENE TMT
2TA001005	TELSTAR TRAVEL SERVICES PTY LTD		TELSTAR GROUP & CONVENTION SERVICES
2TA003597	TEMPLE TRAVEL PTY LTD		JETSET BOWRAL JETSET CAMPBELLTOWN TRAVELWORLD CAMPBELLTOWN
2TA003555	TERRA AUSTRALIS TOURS PTY LTD		TERRA AUSTRALIS TRAVEL SERVICE
2TA4979	TERRA PTY LTD		NLK TOURS
2TA000500	THAI AIRWAYS INTERNATIONAL PUBLIC COMPANY LTD		THAI INTERNATIONAL THAI AIRWAYS INTERNATIONAL EXPLORE THAILAND ROYAL ORCHID HOLIDAYS
2TA4417	THATCHER	MERVYN JAMES	HIMALAYAN EXCURSIONS
2TA4418	THATCHER	ELIZABETH	HIMALAYAN EXCURSIONS
2TA003464	THE AUSTRALIAN TRAVEL & TRADING COMPANY PTY LTD		
2TA003990	THE BROKEN HILL LEGION CLUB LTD		BROKEN HILL'S OUTBACK TOURS
2TA003487	THE COSTLESS TRAVEL & TOUR DISCOUNTS PTY LTD		
2TA5328	THE EASTWOOD TRAVEL SHOP PTY LTD		TRAVELSCENE EASTWOOD
2TA4482	THE FIRST CHALLENGE PTY LTD		TRAVEL KYOWA-KOKU
2TA4540	THE FUNKHOUSE PTY LTD		
2TA003929	THE GLOBAL CONNECTION PTY LTD		
2TA001138	THE HOLIDAY TRAVEL SHOPPE PTY LTD		
2TA5481	THE IMPULSE TRAVEL GROUP PTY LTD		
2TA001579	THE JOURNEY MASTERS PTY LTD		
2TA001195	THE JUNCTION TRAVEL (NCLE) PTY LTD		HARVEY WORLD TRAVEL (THE JUNCTION)
2TA001691	THE JUNCTION TRAVEL PTY LTD		
2TA4929	THE MASTERS TOURS PTY LTD		
2TA003492	THE MDM MARKETING GROUP PTY LTD		RESORT MARKETING
2TA5513	THE PETER RANDALL TRAVEL COMPANY PTY LTD		BLUE FULL SERVICE TRAVEL CRUISES TOURS
2TA5541	THE SOUTH AUSTRALIAN TRAVEL COMPANY PTY LTD		SOUTH AUSTRALIAN TRAVEL CENTRE
2TA5443	THE SURF TRAVEL COMPANY PTY LTD		
2TA5570	THE TRAVEL AUTHORITY PTY LTD		THE TRAVEL AUTHORITY
2TA003392	THE TRAVEL BROKERS (AUST) PTY LTD		THE CRUISE BROKERS
2TA000561	THE TRAVEL CENTRE PTY LTD		
2TA4481	THE TRAVEL COMPANY (NSW) PTY LTD		JETSET TRAVEL COFFS HARBOUR
2TA5414	THE TRAVEL SERVICE CENTRE PTY LTD		
2TA4825	THE TRAVELSPIRIT GROUP LTD		EXPLORE HOLIDAYS TRAVEL IMPRESSIONS THE AFRICAN TRAVELLER VENTURE HOLIDAYS
2TA5501	THE ULTIMATE TRAVELLER PTY LTD		
2TA4486	THE WORLD TRAVEL CLUB PTY LTD		
2TA5388	THINK ADVENTURE PTY LTD		
2TA003889	THOM	JAMES CRUICKSHANK	TRAVELSCENE BAULKHAM HILLS BAULKHAM HILLS TRAVEL (SYDNEY)
2TA4578	THOMPSON	ANN ELIZABETH	SPORTEX TRAVEL
2TA004058	THOMSON	ROSALIND ANN	HARVEY WORLD TRAVEL (GUNNEDAH) GUNNEDAH TRAVEL AGENCY
2TA5058	THORNBERRY	ROBERT JOHN	TRAVELSCENE ORANGE
2TA4796	THORNTON TRAVEL PTY LTD		
2TA4408	THREDBO RESORT CENTRE PTY LTD		THREDBO RESORT CENTRE
2TA5267	TIBURON TECHNOLOGY PTY LTD		FLIGHTBIZ
2TA001708	TIMOTHY MCMAHON ASSOCIATES PTY LTD		
2TA5495	TINGHA TRAVEL PTY LTD		TINGHA TRAVEL
2TA4733	TINK	KATHRYN DELL	HARVEY WORLD TRAVEL (COONABARABRAN)

2TA4428	TIP TOP TRAVEL SERVICE PTY LTD		HARVEY WORLD TRAVEL CHERRYBROOK TRAVELMODE INTERNATIONAL
2TA5221	TMODE PTY LTD		
2TA4976	TOBARAOI TRAVEL PTY LTD		
2TA001891	TODIKI PTY LTD		TRAVELWAYS AUSTRALIA HOPPIE'S TOURS TRAVELWORLD MERRYLANDS TRAVELWORLD WOY WOY
2TA001833	TONY ARICO'S TRAVEL PTY LTD		
2TA5101	TOORAK TRAVEL PTY LTD		
2TA002742	TOP TRAVEL PTY LTD		TRAVELSCENE PADSTOW
2TA5341	TOPFAIR GROUP PTY LTD		
2TA001422	TORONA PTY LTD		ANYWHERE TRAVEL ANYWHERE TRAVEL CBD ANYWHERE TRAVEL CBD
2TA000521	TORONTO BUS SERVICES PTY LTD		
2TA5276	TOTAL TRAVEL CONCEPTS PTY LTD		HARVEY WORLD TRAVEL ROCKDALE PLAZA
2TA5656	TOUR DESIGN PTY LTD		
2TA001144	TOUR HOSTS PTY LTD		CONFERENCE INTERPRETER SERVICES TOUR HOSTS DESTINATION MANAGEMENT PACIFIC EXPERIENCE D M C
2TA5628	TOUR VILLAGE PTY LTD		
2TA5591	TOURIST MANIA PTY LTD		2 RISTMANIA
2TA4539	TOURNET AUSTRALIA PTY LTD		
2TA002872	TOVELO PTY LTD		JUSTMEG TRAVEL CONSULTING
2TA003016	TRABOULSI	OUSSAMA	TORA TRAVEL
2TA003232	TRABOULSI	MASAKO UEDA	TORA TRAVEL CLUB TRAVEL OURWORLD TRAVEL WOLLONGONG T S A TRAVEL
2TA5228	TRADE TRAVEL PTY LTD		
2TA4668	TRADELINE TRAVEL PTY LTD		
2TA5330	TRADELINK SERVICES AUSTRALIA PTY LTD		
2TA001889	TRAFALGAR TOURS (AUST) PTY LTD		
2TA001031	TRAFALGAR TRAVEL (AUSTRALIA) PTY LTD		
2TA003936	TRAIKTONE PTY LTD		HARVEY WORLD TRAVEL (CARLINGFORD) TRAILFINDERS (AUSTRALIA)
2TA4723	TRAILFINDERS (AUSTRALIA) PTY LTD		
2TA001832	TRANS AM TRAVEL PTY LTD		TRANS CHARTER DIRECTOURS AUSTRALIA NAVI TOUR TRAVEL TARZAN TURKISH TRAVEL SERVICES TRANS TURK TRAVEL
2TA5151	TRANS MED TRAVEL PTY LTD		
2TA002688	TRANS ORBIT PTY LTD		
2TA001318	TRANS TURK TRAVEL SERVICES PTY LTD		
2TA000626	TRANSGLOBAL TRAVEL SERVICE PTY LTD		STARLIGHT TOURS TRAVBIZ INTERNATIONAL CONCORDE VFR INTERNATIONAL
2TA4855	TRANSHEMISPHERE PTY LTD		
2TA5404	TRAVBIZ INTERNATIONAL PTY LTD		
2TA5317	TRAVCOM INTERNATIONAL TRAVEL PTY LTD		
2TA5516	TRAVEL & LEISURE PTY LTD		
2TA5531	TRAVEL & LIVING PTY LTD		HARVEY WORLD TRAVEL MANLY TIMELESS TOURS & TRAVEL
2TA4343	TRAVEL & TOURISM MARKETING CONSULTANTS PTY LTD		
2TA4563	TRAVEL & TRAVEL PTY LTD		
2TA001406	TRAVEL ACTION PTY LTD		
2TA4827	TRAVEL AIR INTERNATIONAL PTY LTD		
2TA5274	TRAVEL BEYOND PTY LTD		
2TA5479	TRAVEL BLITZ PTY LTD		TRAVEL BLITZ GLOBAL CREATIVE EVENTS
2TA001445	TRAVEL BUSINESS SERVICES PTY LTD		
2TA4876	TRAVEL CENTRE INTERNATIONAL PTY LTD		
2TA003218	TRAVEL CENTRE SUSSEX PTY LTD		SUSSEX INLET TRAVEL MOSMAN CRUISE CENTRE
2TA003723	TRAVEL CHOICE PTY LTD		
2TA001096	TRAVEL CO PTY LTD		
2TA002713	TRAVEL COMPONENTS PTY LTD		
2TA003442	TRAVEL CONNECT PTY LTD		THE GOLD TOUR COMPANY BANORA TRAVELWORLD
2TA004102	TRAVEL CREATIONS PTY LTD		
2TA5333	TRAVEL LINK INTERNATIONAL PTY LTD		

2TA004101	TRAVEL MART PTY LTD		
2TA003934	TRAVEL PERSPECTIVE PTY LTD		SYDNEY ADVENTURE CENTRE FLIGHT 'N' TRAVEL HARVEY WORLD TRAVEL (PARRAMATTA)
2TA5273	TRAVEL PLUS PTY LTD		
2TA4803	TRAVEL RESERVATIONS PTY LTD		
2TA003261	TRAVEL SEEKERS PTY LTD		
2TA003774	TRAVEL THE WORLD PTY LTD		TRAVEL THE WORLD (TTW)
2TA5654	TRAVEL UTOPIA PTY LTD		
2TA5307	TRAVEL WITH US PTY LTD		
2TA5003	TRAVEL WORLD (AUSTRALIA) PTY LTD		
2TA4656	TRAVEL.COM.AU LTD		
2TA5206	TRAVELATIONS PTY LTD		CRUISE EXPRESS INTERNATIONAL TRAVELBOOKERS
2TA4949	TRAVELBOOKERS.COM PTY LTD		
2TA003256	TRAVELBOX PTY LTD		
2TA4992	TRAVELBROKERS PTY LTD		TRAVELWORLD ALBURY KIDS CORP TRAVEL
2TA003921	TRAVELCORP (AUST) PTY LTD		
2TA5658	TRAVELDREAMERS PTY LTD		
2TA5090	TRAVELEDGE PTY LTD		TRAVELEDGE NEWCASTLE
2TA000658	TRAVELFORCE PTY LTD		
2TA5476	TRAVELGLIDE (AUSTRALIA) PTY LTD		
2TA5232	TRAVELINE INTERNATIONAL PTY LTD		
2TA000229	TRAVELINE PTY LTD		
2TA5031	TRAVELLERCENTRE INTERNATIONAL PTY LTD		AUSA TRAVEL
2TA003568	TRAVELLERS WORLD INTERNATIONAL PTY LTD		
2TA004048	TRAVELMAX PTY LTD		
2TA4982	TRAVELNET INTERNATIONAL (AUSTRALIA) PTY LTD		
2TA5394	TRAVELPAK TRAVEL SERVICES PTY LTD		
2TA000270	TRAVELPLAN AUSTRALIA PTY LTD		
2TA003629	TRAVELSCENE TICKETS PTY LTD		
2TA5668	TRAVELSHOP PTY LTD		TRAVELSHOP NORTH SYDNEY TRAVELSHOP LINDFIELD TRAVELSHOP DEE WHY
2TA5062	TRAVELSTYLE PTY LTD		
2TA5135	TRAVELTICKET PTY LTD		
2TA004141	TRAVELTIX INTERNATIONAL PTY LTD		TRAVELTIX
2TA001962	TRAVELTOO PTY LTD		
2TA5596	TRAVELWIZE PTY LTD		
2TA4591	TRAZPOUND PTY LTD		ON COURSE TOURS & TRAVEL
2TA003971	TREFILO	ALFIO	TRAVELWORLD GRIFFITH
2TA003972	TREFILO	TRACY	TRAVELWORLD GRIFFITH
2TA003465	TRENDSETTER TRAVEL PTY LTD		
2TA5497	TRENDWEST SOUTH PACIFIC TRAVEL PTY LTD		
2TA4715	TRENSHORE PTY LTD		
2TA4885	TRIARCHON PTY LTD		WORLD DISCOVERY HOLIDAYS TRAVELSCAPE GREECE2C.COM HARVEY WORLD TRAVEL MORISSET TWIN WINGS 2 AIR TRAVEL
2TA5356	TRIMACC ENTERPRISES PTY LTD		
2TA003707	TRINH	DINH LOC	
2TA4950	TRIPLE O TRAVEL SERVICE PTY LTD		
2TA004193	TRIUMPH TOURS PTY LTD		
2TA004041	TRUEPLUM PTY LTD		DISCERNING TRAVELLER WING SING TRAVEL
2TA001875	TRUONG	LAP QUOC	
2TA5653	TRUTH OF PARADISE PTY LTD		
2TA002729	TRYABOUT PTY LTD		M & J EXECUTIVE TRAVEL
2TA002935	TSANG	SOW YIN	LESHAN TOURS
2TA002669	TUBOND PTY LTD		JETSET TRAVEL EARLWOOD WORLD NETWORK TRAVEL
2TA4884	TUCAN TRAVEL PTY LTD		
2TA5057	TURNER	SCOTT ANDREW	TRAVELSCENE ORANGE
2TA5611	TWEED & COOLANGATTA TOURISM INC		
2TA5309	TWOFOLD TRAVEL PTY LTD		
2TA5650	U T C PACIFIC PTY LTD		
2TA003731	UMINA BEACH TRAVEL CENTRE PTY LTD		HARVEY WORLD TRAVEL (UMINA)
2TA5549	UN-LIMITED TRAVEL PTY LTD		UN-LIMITED TRAVEL

2TA001040	UNIQUE TRAVEL SERVICES PTY LTD		
2TA001843	UNITED AIRLINES INC		
2TA001666	UNITED TRAVEL (B H) PTY LTD		TRAVELWORLD BROKEN HILL
2TA5612	UNITY TRAVEL SERVICE PTY LTD		UNITY TRAVEL SERVICE
2TA5484	UNIVERSAL TRAVEL SERVICES PTY LTD		
2TA001584	UNIWORLD TRAVEL AND FREIGHT SERVICE PTY LTD		
2TA5551	UNO TRAVEL PTY LTD		K W K TOURS
2TA001869	URSULA KING TRAVEL PTY LTD		
2TA5172	V N ENTERPRISES PTY LTD		V N INTERNATIONAL TRAVEL
2TA4415	V TRAVEL CENTRES PTY LTD		TRAVELSCENE AT V TRAVEL SYDNEY
2TA003513	VALDARA PTY LTD		SAWTELL-TOORMINA TRAVEL SERVICE
2TA5395	VALENZ WORLD TRAVEL PTY LTD		
2TA003190	VALUE TOURS (AUST) PTY LTD		
2TA001072	VAN DA MONT & ASSOCIATES PTY LTD		UNIAO TRAVEL
2TA003938	VANATA PTY LTD		CONTAL TRAVEL
2TA000411	VASSALIOS	ANDREW	ANDREW VASS ANDREW VASS TRAVEL AGENCY ANDREW VASS TRAVEL AGENCY ANDREW VASS
2TA002285	VASSALIOS	ELENA	SATELLITE HOLIDAYS SATELLITE HOLIDAYS ONDA TRAVEL AGENCY OUTBACK TRAVEL SHOP
2TA5583	VENKATAYA	NARAYAN	
2TA5584	VENKATAYA	SARESWATI	
2TA003055	VEROZI PTY LTD		
2TA5566	VERSLUIJS	WILLEMINA MAARTJE ANTONIOS	ATHINA TRAVEL AGENCY A T I TOURS
2TA001964	VERTSETIS		
2TA000469	VIATOUR TRAVEL PTY LTD		
2TA5568	VIET NAM HOLIDAY'S INTERNATIONAL PTY LTD		
2TA5471	VIETNAM TOURIST SERVICES PTY LTD		
2TA003702	VIEWDAZE PTY LTD		BRAVO INTERNATIONAL HOLIDAYS BEYOND 2001 TRAVEL & TOURS BRAVO CONSOLIDATION BRAVO 4 TICKETS BREAKAWAY TRAVEL ON YORK FLAG TRAVEL
2TA5527	VIRTUAL BRAINET PTY LTD		
2TA5405	VIRTUALIT SERVICES PTY LTD		
2TA002808	VOCE PTY LTD		BOLAND'S TRAVEL
2TA4974	VOYAGER TRAVEL CORPORATION PTY LTD		
2TA5054	VOYAGES HOTELS & RESORTS PTY LTD		
2TA4965	VOYAGES LODGES PTY LTD		
2TA5524	VUONG	DAI PHUOC	DAVID VUONG TRAVEL TRAVELSCENE AT WCL TRAVEL PROFESSIONALS
2TA5494	W C L TRAVEL PROFESSIONALS PTY LTD		WADES TRAVEL
2TA4236	WADE	ROBERT JOHN GREGORY LISA ANN	WADES TRAVEL JETSET WAHROONGA VILLAGE
2TA4237	WADE		
2TA5327	WAHROONGA VILLAGE TRAVEL PTY LTD		
2TA4389	WALES	LEONIE RUTH	WALES COACH TRAVEL AGENCY HARVEY WORLD TRAVEL (COOTAMUNDRA)
2TA002704	WALL STREET TRAVEL PTY LTD		
2TA001225	WALLSEND TRAVEL SERVICE PTY LTD		TRAVELSCENE (WALLSEND)
2TA5638	WALSH	RUTH	
2TA5343	WALSHES WORLD AGENCIES AUSTRALIA PTY LTD		WALSHES WORLD AGENCIES AUSTRALIA TRAVELLING FIT WANDERERS-TRAVEL.COM
2TA5139	WALTON	MARIA DEL MAR	
2TA5209	WANDERERS TRAVEL.COM (N S W) PTY LTD		
2TA4250	WASTRECK PTY LTD		IMPERIAL TRAVEL
2TA4221	WATCHTOWER BIBLE AND TRACT SOCIETY OF AUSTRALIA		WATCHTOWER TRAVEL
2TA002655	WATTLELAND PTY LTD		
2TA4511	WAUGH	KATHLEEN MARY ALEC	THE BLUE SKIES PROJECT THE BLUE SKIES PROJECT CALL INCENTIVES
2TA4512	WAUGH		
2TA003775	WAYLAS PTY LTD		

2TA4235	WAYWIND PTY LTD		
2TA5642	WEB OPTIONS PTY LTD		
2TA5406	WEIDE MAROSY CORP PTY LTD		A T S AUSTRALIAN TRAVEL SPECIALISTS N S W OZ SNOW ADVENTURES TRAVEL BALTIC CONNECTIONS CORAL CONNECTIONS WELL CONNECTED TOURS WELLINGTON TRAVEL FIJI SPECIALIST HOLIDAYS SPORTSWELL TOURS AND TOURNAMENTS PACIFIC SPECIALIST HOLIDAYS NEW CALEDONIA SPECIALIST HOLIDAYS HAWAII SPECIALIST HOLIDAYS BALI SPECIALIST HOLIDAYS VANUATU SPECIALIST HOLIDAYS COACH TOURS OF FIJI COOK ISLANDS SPECIALIST HOLIDAYS
2TA5534	WELBY PTY LTD		
2TA4224	WELL CONNECTED TRAVEL PTY LTD		
2TA000128	WELLINGTON SHIRE COUNCIL		
2TA001985	WELLS TRADING PTY LTD		
2TA4792	WENDY WU TOURS PTY LTD		
2TA001726	WENTWORTH TRAVEL PTY LTD		
2TA4423	WEST WYALONG TRAVEL PTY LTD		HARVEY WORLD TRAVEL (WEST WYALONG)
2TA5600	WESTERN MEDIA PROMOTIONS PTY LTD		
2TA5634	WESTERN ROAD LINERS (PARKES) PTY LTD		
2TA003894	WESTWOOD	PAUL HOWARD	CITY CENTRE TRAVEL SERVICE
2TA003895	WESTWOOD	CHRISTINE CHERRY	CITY CENTRE TRAVEL SERVICE
2TA003024	WHITE	LAURIS	HARVEY WORLD TRAVEL (NAMBUCCA)
2TA002296	WHITEHOUSE	MARGARET	JETSET TRAVEL BLUE MOUNTAINS
2TA002297	WHITEHOUSE	GLENDIA JOY HOWARD	JETSET TRAVEL BLUE MOUNTAINS
2TA4904	WHITLING	LONGLEY TRACY	LAURIETON WORLD TRAVEL NAMBUCCA WORLD TRAVEL TRAVELWORLD LAURIETON NAMBUCCA WORLD TRAVEL LAURIETON WORLD TRAVEL TRAVELWORLD LAURIETON
2TA4905	WHITLING	GILBERT DAMIEN	
2TA5305	WICKED TRAVEL PTY LTD		
2TA5368	WICKS		
2TA004001	WIDEICE PTY LTD	KELLY LOUISE	WARNERS BAY TRAVEL BRITANNIA TRAVEL
2TA4645	WIEDEMANN TRAVEL AUSTRALIA PTY LTD		
2TA5249	WILDERNESS AUSTRALIA PTY LTD		
2TA5386	WILTRANS AUSTRALIA PTY LTD		
2TA4607	WINDBIND PTY LTD		
2TA4962	WINDSONG TRAVEL PTY LTD		CENTRE ONE TOURS AUSTRALIA HARVEY WORLD TRAVEL (INVERELL)
2TA4953	WINGLONG TRAVEL PTY LTD		
2TA002901	WINKLEY	ELEANOR URSULA	DURHAMS COACHES
2TA004148	WISELY'S TRAVEL SERVICE PTY LTD		
2TA4942	WITANDER TRAVEL PTY LTD		ALASKA BOUND/AUSTRALIA BOUND
2TA4842	WONDERFUL PACIFIC PTY LTD		
2TA004027	WONDERFUL WORLD TRAVEL SERVICE PTY LTD		
2TA004051	WONDERLAND WORLD TRAVEL PTY LTD		
2TA5674	WORLD AVENUE PTY LTD		RYUGAKU PLAZA DIVING PLAZA
2TA002557	WORLD AVIATION SYSTEMS (AUSTRALIA) PTY LTD		
2TA4960	WORLD CARS PTY LTD		
2TA003690	WORLD CORPORATE TRAVEL PTY LTD		WORLD CARS CRUISE JOURNEYS WORLD CONFERENCE & INCENTIVE MANAGEMENT WORLD FLIGHT CENTRE ALUMNI TRAVEL IMPERIAL CHINA TOURS JUST GOOD FRIENDS
2TA5240	WORLD FLIGHT CENTRE PTY LTD		
2TA003088	WORLD LINKS EDUCATION PTY LTD		

2TA4346	WORLD MARKETING PTY LTD		ABOUTFRANCE TRAVEL
2TA004103	WORLD TRADE TRAVEL PTY LTD		MANDALA EAST
2TA5537	WORLD WIDE TRAVEL CENTRE PTY LTD		HELEN WONG TOURS
2TA5133	WORLD WIDE TRAVEL SERVICES PTY LTD		
2TA4947	WORLDCAR AND TRAVEL.COM.AU PTY LTD		GLOBALCARS.COM.AU
2TA004034	WORLDTRAVEL.COM.AU PTY LTD		GLOBALRES.COM.AU
2TA5319	WORLDWIDE HOLIDAYS PTY LTD		KIDS WORLD TRAVEL
			WORLD TRAVEL PROFESSIONALS
			HARVEY WORLD TRAVEL (MIRANDA)
			HARVEY WORLD TRAVEL CARINGBAH
2TA5574	WORLDWIDE TRAVEL PROFESSIONALS PTY LTD		WORLDWIDE TRAVEL PROFESSIONALS
2TA003460	WYCHWODE INVESTMENTS PTY LTD		MOSMAN TRAVEL CENTRE
2TA001257	WYFINE PTY LTD		TRAVELSCENE NOWRA
2TA5664	YAMMINE	CAROL	A & C TRAVEL
2TA5563	YANG	JING (JENNY)	J Y TRAVEL
2TA4931	YARRUMBI PTY LTD		HARVEY WORLD TRAVEL (MURWILLUMBAH)
2TA002629	YHA NSW LTD		YHA TRAVEL
			SYDNEY CENTRAL YHA
			YHA TRAVEL
			PANTHERS TRAVEL
2TA001085	YONEP PTY LTD		
2TA4819	YOSICA INTERNATIONAL TRAVEL PTY LTD		YTA TRAVEL
2TA4542	YTA TRAVEL (AUSTRALIA) PTY LTD		ZIGNAL TRAVELS
2TA003482	ZIGNAL INTERNATIONAL PTY LTD		
2TA5370	ZUJI PTY LTD		
2TA4619	ZUZARTE	MARIA MATILDE	AIR TRAVEL 2000
2TA4618	ZUZARTE	ROY LEVY	AIR TRAVEL 2000

TENDERS**Department of Commerce****SUPPLIES AND SERVICES FOR THE PUBLIC SERVICE**

Information in relation to the Department of Commerce proposed, current and awarded tenders is available on:

<http://www.tenders.nsw.gov.au>

PRIVATE ADVERTISEMENTS

COUNCIL NOTICES

BLUE MOUNTAINS CITY COUNCIL

Roads Act 1993, Section 16(2)

Notice of Dedication of Land as a Public Road

NOTICE is hereby given by the Council of the City of Blue Mountains that in accordance with section 16(2) of the Roads Act 1993, the land as described in the Schedule below is hereby dedicated as public road. Dated at Katoomba, 30th December 2004. M. WILLIS, General Manager, Blue Mountains City Council, Locked Bag 5, Katoomba NSW 2780.

SCHEDULE

All of that land in Deposited Plan 1266 that is noted as road and named Kundibar, Gundar, Minyago, Kamillaroi and Kubya Streets and part of Shipley Road (known in DP 1266 as Kamillaroi) and comprised in Certificate of Title, Volume 948, Folio 88 and Certificate of Title, Volume 960, Folio 115. [0936]

CABONNE COUNCIL

Re-naming of Roads

NOTICE is hereby given that Cabonne Council, in pursuance of section 162 of the Roads Act 1993, has renamed the following road:

Description	New Name
Slaughterhouse Road, Eugowra.	Hillview Lane.

Authorised by resolution of Council on 20th December 2004. G. L. P. FLEMING, General Manager, Cabonne Council, PO Box 17, MOLONG NSW 2866. [0933]

PARKES SHIRE COUNCIL

Roads Act 1993, Section 162.1

Naming of Public Roads

Ted McGlynn Court, Rex Aubrey Place, Westlime Road, Crowley Road, Tucker Lane, McGrath Lane, Genaren Lane, Stones Road, Coradgery Road, Allwood Lane, Strahorn Forest Road, Goldfield Road, Watershed Lane, Ganantagi Road and Kittos Bridge Road

NOTICE is hereby given that in accordance with section 162.1 of the Roads Act 1993, as amended, Council has named the roads shown hereunder:

Location	Name
Cul-de-sac off Close Street, Parkes.	Ted McGlynn Court.
Cul-de-sac off Best Street, Parkes.	Rex Aubrey Place.
Link road between Brologan Road and Condobolin Road, Parkes.	Westlime Road.
Formerly named Kadungle Road.	Crowley Road.
Lane between Currajong and Glover Streets, Parkes.	Tucker Lane.
Shire Road 44 from Shire Road 82 and Main Road 61.	McGrath Lane.
Shire Road 126C.	Genaren Lane.
Shire Road 135.	Stones Road.
Shire Road 136.	Coradgery Road.
Shire Road 139A.	Allwood Lane.
Shire Road 140.	Strahorn Forest Road.
Shire Road 143.	Goldfield Road.
Shire Road 156.	Watershed Lane.
Shire Road 188 from Shire Road 175 to Shire Road 189.	Ganantagi Road.
Shire Road 220 west of State Highway 17.	Kittos Bridge Road.

No objections to the proposed names were received within the prescribed period of time. A. McCORMACK, General Manager, Parkes Shire Council, PO Box 337, Parkes NSW 2870. [0938]

MOREE PLAINS SHIRE COUNCIL

Local Government Act 1993, Section 713

Sale of Land for Overdue Rates and Charges

NOTICE is hereby given to the persons named hereunder, that the Council of Moree Plains has resolved, in pursuance of section 713 of the Local Government Act 1993, to sell the land described hereunder of which the persons named are known to the Council to be the owners of or to have an interest in the land on which the amount of rates stated in each case, as at 26th November 2004, is due:

Property Schedule

Assessment Number	1. Owner(s) 2. Registered Interest 3. Other	Property Description	Property Area	Amount of Rates, Charges and Interest Outstanding for more than 5 years	Amount of all other Rates, Charges and Interest Outstanding	Total Rates, Charges and Interest Outstanding
576	1. Ms D. R., M. L., Messrs E. M. and M. R. J. HITCHINS 2. NATIONAL AUSTRALIA BANK LIMITED	Unit 11, 113 Balo Street, Moree NSW, Lot 11, SP 14534	0.1 Hec	\$7,714.32	\$16,261.19	\$23,975.51
577	1. Mr Max HITCHENS 2. NATIONAL AUSTRALIA BANK LIMITED	Unit 12, 113 Balo Street, Moree NSW, Lot 11, SP 14534	0.1 Hec	\$6,546.85	\$14,729.04	\$21,275.89
578	1. Ms D. R., M. L., Messrs E. M. and M. R. J. HITCHINS 2. NATIONAL AUSTRALIA BANK LIMITED	Unit 13, 113 Balo Street, Moree NSW, Lot 11, SP 14534	0.1 Hec	\$6,547.27	\$14,204.96	\$20,752.23
579	1. Ms D. R., M. L., Messrs E. M. and M. R. J. HITCHINS 2. NATIONAL AUSTRALIA BANK LIMITED	Unit 14, 113 Balo Street, Moree NSW, Lot 11, SP 14534	0.1 Hec	\$6,726.75	\$14,567.89	\$21,294.64
580	1. Ms D. R., M. L., Messrs E. M. and M. R. J. HITCHINS 2. NATIONAL AUSTRALIA BANK LIMITED 3. Easement for Air Duct	Unit 15, 113 Balo Street, Moree NSW, Lot 11, SP 14534	0.1 Hec	\$6,726.75	\$14,522.13	\$21,248.88
581	1. Ms D. R., M. L., Messrs E. M. and M. R. J. HITCHINS 2. NATIONAL AUSTRALIA BANK LIMITED	Unit 16, 113 Balo Street, Moree NSW, Lot 11, SP 14534	0.1 Hec	\$6,547.23	\$20,724.73	\$27,271.96
582	1. Ms D. R., M. L., Messrs E. M. and M. R. J. HITCHINS 2. NATIONAL AUSTRALIA BANK LIMITED	Unit 17, 113 Balo Street, Moree NSW, Lot 11, SP 14534	0.1 Hec	\$6,367.69	\$13,832.54	\$20,200.23

Assessment Number	1. Owner(s) 2. Registered Interest 3. Other	Property Description	Property Area	Amount of Rates, Charges and Interest Outstanding for more than 5 years	Amount of all other Rates, Charges and Interest Outstanding	Total Rates, Charges and Interest Outstanding
583	1. Mr Max HITCHENS 2. NATIONAL AUSTRALIA BANK LIMITED	Unit 18, 113 Balo Street, Moree NSW, Lot 11, SP 14534	0.1 Hec	\$6,344.34	\$14,445.83	\$20,790.17
1865	1. Mr W. B. PITT	7 Florence Street, Moree NSW, Lot 8, DP 39738	921.4 sqm	\$3,650.29	\$12,928.87	\$16,579.16
3764	1. Mr W. J. WALL (Deceased)	50 Goondiwindi Street, Mungindi NSW, Lot 14, DP 19336	1296 sqm	\$3,650.29	\$12,928.87	\$16,579.16
3801	1. The Estate of T. J. WEBSTER	13 Loftus Street, Mungindi NSW, Lot 7, section 8, DP 758729	2023 sqm	\$8,274.30	\$9,906.01	\$18,180.31
3894	1. The Estate of Mr J. I. BARLOW 2. Covenant	209 St George Street, Mungindi NSW, Lot 23, section C, DP 11331	2833 sqm	\$6,762.59	\$9,011.07	\$15,773.66
4117	1. Mr J. C. REEVES	37 Merriwa Street, Boggabilla NSW, Lot 7, section 6, DP 758127	2023 sqm	\$1,895.52	\$4,145.28	\$6,040.80
Total				\$77,754.19	\$172,208.41	\$249,962.60

In default of payment to the Council of the amount stated under Total Rates, Charges and Interest outstanding in the column above and any other rates (including extra charges) becoming due and payable after this notice or any arrangements satisfactory to the Council for payment of all such rates being entered into by the rateable person before the time fixed for the sale, the said land will be offered for sale by public auction by Moree Real-Estate (Moree), at the Moree Memorial Hall, 36 Balo Street, Moree NSW 2400, on Saturday, 9th of April 2005, at 11:00 a.m. THE GENERAL MANAGER, Moree Plains Shire Council, PO Box 420, Moree NSW 2400. [0937]

SHIRE OF TENTERFIELD

Sale of Land for Overdue Rates

NOTICE is hereby given to the persons named hereunder that the Council of the Shire of Tenterfield has resolved, in pursuance of section 713 of the Local Government Act 1993, to sell the land described hereunder of which the persons named appear to be owners or in which they appear to have an interest, and on which the rates stated in each case, as at 16th December 2004, is due:

Assessment Number	Owners or Persons Having an Interest in the Land	Description of Land	Amount of Rates (including Extra Charges) Overdue for more than Five Years (C)	Amount of All Other Rates (including Extra Charges) Due and in Arrears (D)	Total (E)
	(A)	(B)			
7195	Ms Lucille Cora WALSH and Mr Jack Edward WALSH	Lot 130, DP 1076941	467.04	7173.74	7640.78
17871	Messers D. J. and G. S. PAMPLING	Lot 95, DP 751039	546.38	1295.06	1841.44
30544	Mr G. B. OSBORNE	Lot 19, DP 635165	31.13	2252.66	2283.79
33589	Mr J. V. and Mrs A. C. O'BRIEN	Lot 13, DP 709551	348.05	2206.16	2554.21
41152	Mr M. W. WALKER and ABORIGINAL DEVELOPMENT COMMISSION	section 49, Lot 1, DP 758359	162.16	2617.16	2779.32

In default of payment to the Council of the amount stated in Column (E) above and any other Rates (including extra charges) becoming due and payable after publication of this notice, before the time fixed for the sale, the said Land will be offered for sale by public auction in the Tenterfield School of Arts, on Saturday, 9th April 2005, commencing at 10:00 a.m. This sale will be conducted by Harold Curry Auctioneers of 125 High Street, Tenterfield. Enquiries can be made to Council's Revenue Officer, Mrs Paula Krahe on (02) 6736 1744. GENERAL MANAGER, Tenterfield Shire Council, PO Box 214, Tenterfield NSW 2372. [0934]

ESTATE NOTICES

NOTICE of intended distribution of estate.—Any person having any claim upon the estate of LENA HALBERSTAD, late of 144 Pretoria Parade, Hornsby, in the State of New South Wales, dressmaker, who died on 26th September 2004, must send particulars of his/her claim to the executors, Jeannette Guttman and Sonja De Jong, c.o. Collins & Thompson, Solicitors, 8 Coronation Street, Hornsby NSW 2077, within one (1) calendar month from publication of this notice. After that time the assets of the estate may be conveyed and distributed having regard only to the claims of which at the time of distribution the executors have notice. Probate was granted in New South Wales on 6th December 2004. Collins & Thompson, Solicitors, 8 Coronation Street, Hornsby NSW 2077. Reference: DJT:JAC:86766. [0931]

COMPANY NOTICES

NOTICE of voluntary liquidation.—KOALAHYDROPONICS LIMITED, ACN 058 353 558 (in liquidation).—Notice is hereby given pursuant to the CORPORATIONS ACT 2001, Section 491(2) that a meeting of members of Koala Hydroponics Limited held at the registered office, Lower Ground Floor, 8 Cliff Street, Milsons Point on Friday,

17th December 2004, at 3:00 p.m., whereby the following special resolution was passed. Special Resolution: By unanimous vote. The Members resolve that the Company being solvent and able to pay all debts within 12 months be wound up and that Martin Green of the firm Green Krajic be appointed Liquidator of the Company for that purpose. LBW & PARTNERS, Chartered Accountants, Ground Floor, 19 Havilah Street, Chatswood NSW 2057, tel.: (02) 9411 4866. [0932]

NOTICE of members voluntary liquidation.—BID CORPORATION PTY LIMITED, ACN 071 856 132.—At an extraordinary general meeting of members of Bid Corporation Pty Limited, ACN 071 856 132, duly convened and held at 31-35 Bank Street, Pyrmont NSW 2009, on 20th December 2004, the special resolution set out below was duly passed: "That the company be wound up as a members voluntary liquidation under section 491(1) of the Corporations Act". It was also resolved that Edwin Maxwell Cowley of Suite 3/11 West Street, North Sydney, be appointed liquidator for the purposes of the winding up. Dated this 22nd day of December 2004. Barry Larry Berson, Director. EDWIN MAXWELL COWLEY, Liquidator, c.o. E. M. Cowley & Co., Chartered Accountant, 3/11 West Street, North Sydney NSW 2060, tel.: (02) 9955 6488. [0935]

Authorised to be printed

ROBERT J. GALLAGHER, Government Printer.

ISSN 0155-6320