



# *Government Gazette*

OF THE STATE OF  
NEW SOUTH WALES

**Number 113**

**Friday, 25 November 2011**

Published under authority by Government Advertising

## LEGISLATION

### Online notification of the making of statutory instruments

Week beginning 14 November 2011

THE following instruments were officially notified on the NSW legislation website ([www.legislation.nsw.gov.au](http://www.legislation.nsw.gov.au)) on the dates indicated:

#### Regulations and other statutory instruments

Mining Amendment (Transitional) Regulation 2011 (2011-586) — published LW 18 November 2011

Ombudsman Amendment (Audit Office of New South Wales) Proclamation 2011 (2011-587) —  
published LW 18 November 2011

Passenger Transport Amendment (Taxi Fare Pre-payment Trial) Regulation 2011 (2011-588) —  
published LW 18 November 2011

Supreme Court Rules (Amendment No 418) 2011 (2011-589) — published LW 18 November 2011

Uniform Civil Procedure Rules (Amendment No 49) 2011 (2011-590) — published LW 18 November 2011

#### Environmental Planning Instruments

Byron Local Environmental Plan 1988 (Amendment No 150) (2011-591) — published LW 18 November 2011

Great Lakes Local Environmental Plan 1996 (Amendment No 81) (2011-592) —  
published LW 18 November 2011

Lake Macquarie Local Environmental Plan 2004 (Amendment No 46) (2011-593) —  
published LW 18 November 2011

Port Macquarie-Hastings Local Environmental Plan 2011 (Amendment No 7) (2011-594) —  
published LW 18 November 2011

---

## Assents to Acts

---

### ACTS OF PARLIAMENT ASSENTED TO

Legislative Council Office, Sydney, 16 November 2011

IT is hereby notified, for general information, that Her Excellency the Governor has, in the name and on behalf of Her Majesty, this day assented to the undermentioned Acts passed by the Legislative Council and Legislative Assembly of New South Wales in Parliament assembled, viz.:

Act No. 56, 2011 – An Act to amend the Aboriginal Land Rights Act 1983 with respect to certain residential tenancy agreements and land dealing approval requirements. [**Aboriginal Land Rights Amendment (Housing) Act 2011**]

Act No. 57, 2011 – An Act to amend the Sporting Venues Authorities Act 2008 and to repeal the Parramatta Stadium Trust Act 1988, to constitute Venues NSW, to abolish existing regional sporting venues authorities and the Parramatta Stadium Trust and to transfer the assets and liabilities of those bodies to Venues NSW; and for other purposes. [**Sporting Venues Authorities Amendment (Venues NSW) Act 2011**]

DAVID BLUNT,  
Clerk of the Parliaments

---

### ACTS OF PARLIAMENT ASSENTED TO

Legislative Council Office, Sydney, 17 November 2011

IT is hereby notified, for general information, that Her Excellency the Governor has, in the name and on behalf of Her Majesty, this day assented to the undermentioned Acts passed by the Legislative Council and Legislative Assembly of New South Wales in Parliament assembled, viz.:

Act No. 64, 2011 – An Act to amend the Crimes (Sentencing Procedure) Act 1999 to make it an aggravating factor in sentencing for certain traffic offences where a child was present in the offender's vehicle. [**Crimes (Sentencing Procedure) Amendment (Children in Vehicles) Act 2011**]

DAVID BLUNT,  
Clerk of the Parliaments

---

### ACTS OF PARLIAMENT ASSENTED TO

Legislative Assembly Office, Sydney, 17 November 2011

IT is hereby notified, for general information, that Her Excellency the Governor has, in the name and on behalf of Her Majesty, this day assented to the undermentioned Acts passed by the Legislative Assembly and Legislative Council of New South Wales in Parliament assembled, viz.:

Act No. 58, 2011 – An Act to amend the Liquor Act 2007 to introduce a 3 strikes disciplinary system for licences in respect of premises on which multiple breaches of that Act have occurred; and for other purposes. [**Liquor Amendment (3 Strikes) Bill**]

Act No. 59, 2011 – An Act to regulate certain plumbing and drainage work and to establish a single regulator for that work, and for related purposes. [**Plumbing and Drainage Bill**]

Act No. 60, 2011 – An Act to amend the Community Services (Complaints, Reviews and Monitoring) Act 1993 with respect to the Child Death Review Team; and for other purposes. [**Children Legislation Amendment (Child Death Review Team) Bill**]

Act No. 61, 2011 – An Act to repeal the Redfern-Waterloo Authority Act 2004; to dissolve the Redfern-Waterloo Authority and to transfer the assets, rights, liabilities and certain functions of that Authority to the Sydney Metropolitan Development Authority; and for other purposes. [**Redfern-Waterloo Authority Repeal Bill**]

Act No. 62, 2011 – An Act to repeal certain Acts and instruments and to amend certain other Acts and instruments in various respects and for the purpose of effecting statute law revision; and to make certain savings. [**Statute Law (Miscellaneous Provisions) Bill (No. 2)**]

Act No. 63, 2011 – An Act to amend environment protection legislation to create the office of Chairperson of the Environment Protection Authority and to make further provision with respect to the notification and management of pollution incidents; and for other purposes. [**Protection of the Environment Legislation Amendment Bill**]

RONDA MILLER,  
Clerk of the Legislative Assembly

---

---

## Other Legislation

---

### THREATENED SPECIES CONSERVATION ACT 1995

#### Notice of Preliminary Determinations

THE Scientific Committee has made Preliminary Determinations proposing that the following be listed in the relevant Schedules of the Threatened Species Conservation Act 1995.

**Endangered Species** (Part 1 of Schedule 1)

*Eucalyptus largeana* Blakely & Beuzev., a tree

**Endangered Ecological Community** (Part 3 of Schedule 1)

Coolibah – Black Box Woodland in the Darling Riverine Plains, Brigalow Belt South, Cobar Penepplain and Mulga Lands bioregions,

Explanatory Note: The Coolibah – Black Box woodland was listed as an endangered ecological community in 2004 and this preliminary determination does not change its threat status. This preliminary determination has been prepared to provide a more up-to-date description and information on the community following a review of the information that has become available since 2004 and the recent (2011) Commonwealth Government's listing of the Coolibah – Black Box Woodlands under the Environment Protection and Biodiversity Conservation Act 1999.

Any person may make a written submission regarding these Preliminary Determinations. Send submissions to Suzanne Chate, NSW Scientific Committee, PO Box 1967, Hurstville BC 1481. Submissions close 3 February 2012.

Copies of these Determinations, which contain the reasons for the determinations, may be obtained free of charge on the Internet [www.environment.nsw.gov.au](http://www.environment.nsw.gov.au), by contacting the Scientific Committee Unit, PO Box 1967, Hurstville BC 1481. Tel: (02) 9585 6940 or Fax (02) 9585 6989 or in person at the Office of Environment and Heritage Information Centre, Level 14, 59-61 Goulburn Street, Sydney. Copies of the determinations may also be obtained from National Parks and Wildlife Service Area Offices and Visitor Centres, subject to availability.

Dr RICHARD MAJOR,  
Chairperson,  
Scientific Committee



New South Wales

## Notice of Determination

under the

Threatened Species Conservation Act 1995

The Scientific Committee established under the *Threatened Species Conservation Act 1995 (the Act)* has determined to amend the descriptions of species referred to in paragraphs (a)–(e) below pursuant to section 36A (1) (a) of the Act (being amendments that are necessary or desirable to reflect changes in the name of species, or a reclassification of any such species into further species, as a result of taxonomic revision).

(a) Part 1 of Schedule 1 to the Act is amended as follows:

(i) Omit the following from the matter relating to Rostratulidae (under the headings **Animals**, **Vertebrates** and **Birds**):

* <i>Rostratula benghalensis australis</i> (Gould, 1838)	Painted Snipe (Australian subspecies)
--	---------------------------------------

Insert instead:

* <i>Rostratula australis</i> (Gould, 1838)	Australian Painted Snipe
---	--------------------------

(ii) Omit the following from the matter relating to Laridae (under the headings **Animals**, **Vertebrates** and **Birds**):

*Sterna albifrons* Pallas, 1764

Insert instead:

*Sternula albifrons* (Pallas, 1764)

## Notice of Determination

- 
- (iii) Omit the following under the headings **Animals, Vertebrates and Birds**:

## Pardalotidae

- \* *Dasyornis brachypterus* Eastern Bristlebird  
(Latham, 1802)

Insert instead:

## Dasyornithidae

- \* *Dasyornis brachypterus* Eastern Bristlebird  
(Latham, 1801)

- (iv) Omit the following under the headings **Animals, Vertebrates and Birds**:

## Passeridae

- \* *Poephila cincta cincta* (Gould, Black-throated Finch (southern  
1837) subspecies)

Insert instead:

## Estrildidae

- \* *Poephila cincta cincta* (Gould, Black-throated Finch (southern  
1837) subspecies)

- (v) Omit the following from the matter relating to Myrtaceae (under the heading **Plants**):

*Babingtonia prominens* A.R. Bean

*Babingtonia silvestris* A.R. Bean

Insert in alphabetical order:

*Kardomia prominens* (A.R. Bean) Peter G. Wilson

*Kardomia silvestris* (A.R. Bean) Peter G. Wilson

## Notice of Determination

- (vi) Omit the following from the matter relating to Myrtaceae (under the heading **Plants**):

*Homoranthus bornhardtiensis* J.T. Hunter

- (b) Part 2 of Schedule 1 to the Act is amended by omitting the following from the matter relating to Chrysomelidae (under the headings **Animals**, **Invertebrates** and **Coleoptera**):

*Menippus fugitivus*

*Menippus fugitivus* population  
in the Sutherland Shire

and by inserting instead:

*Menippus darcyi* Reid & Nally, 2008

*Menippus darcyi* population in  
the Sutherland Shire

- (c) Part 4 of Schedule 1 to the Act is amended by omitting the following under the headings **Animals**, **Vertebrates** and **Birds**:

Pardalotidae

- |   |                    |
|---|--------------------|
| * <i>Gerygone igata insularis</i> Ramsay,<br>1878 | Lord Howe Gerygone |
|---|--------------------|

Dicruridae

- |   |  |
|---|--|
| * <i>Rhipidura fuliginosa cervina</i><br>Ramsay, 1879 | Grey Fantail (Lord Howe Is.<br>subsp.) |
|---|--|

Passeridae

- |   |            |
|---|------------|
| * <i>Neochmia ruficauda</i> (Gould, 1837) | Star Finch |
|---|------------|

Zosteropidae

- |   |                  |
|---|------------------|
| * <i>Zosterops tenuirostris strenuus</i><br>Gould, 1855 | Robust White-eye |
|---|------------------|

Muscicapidae

- |  |   |
|--|---|
| * <i>Turdus poliocephalus vinitinctus</i><br>(Gould, 1855) | Island Thrush (Lord Howe Is.<br>subsp.) |
|--|---|

Sturnidae

- |  |   |
|--|---|
| * <i>Aplonis fusca hulliana</i> Mathews,<br>1912 | Tasman Starling (Lord Howe Is.<br>subsp.) |
|--|---|

## Notice of Determination

---

and by inserting instead:

## Acanthizidae

- \* *Gerygone insularis* Ramsey, 1878      Lord Howe Gerygone

## Rhipiduridae

- \* *Rhipidura fuliginosa* (Sparman, 1787)      New Zealand Fantail (Lord House Is. subsp.)

## Sturnidae

- \* *Aplonis fusca hulliana* Mathews, 1912      Tasman Starling (Lord Howe Is. subsp.)

## Timaliidae

- \* *Zosterops strenuus* Gould, 1855      Robust White-eye

## Turdidae

- \* *Turdus poliocephalus vinitinctus* (Gould, 1855)      Island Thrush (Lord Howe Is. subsp.)

## Estrildidae

- \* *Neochmia ruficauda* (Gould, 1837)      Star Finch

- (d) Part 1 of Schedule 1A to the Act is amended by omitting the following from the matter relating to Burhinidae (under the headings **Animals**, **Vertebrates** and **Birds**):

*Esacus neglectus* Mathews, 1912

and by inserting instead:

*Esacus magnirostris* Vieillot, 1818

- (e) Part 1 of Schedule 2 to the Act is amended as follows:
- (i) Omit the following from the matter relating to Gekkonidae (under the headings **Animals**, **Vertebrates** and **Reptiles**):

*Diplodactylus elderi* Stirling and Zietz, 1893      Jewelled Gecko

*Diplodactylus stenodactylus* Boulenger, 1896      Crowned Gecko

## Notice of Determination

---

Insert instead:

*Lucasium stenodactylum* (Boulenger, 1896)      Crowned Gecko

*Strophurus elderi* (Stirling & Zietz, 1893)      Jewelled Gecko

- (ii) Omit the following from the matter relating to Scincidae (under the headings **Animals**, **Vertebrates** and **Reptiles**):

\* *Cyclodina lichenigera* (O'Shaughnessy, 1874)      Lord Howe Island Skink

Insert in alphabetical order:

\* *Oligosoma lichenigera* (O'Shaughnessy, 1874)      Lord Howe Island Skink

- (iii) Omit the following from the matter relating to Boidae (under the headings **Animals**, **Vertebrates** and **Reptiles**):

*Liasis stimsoni* Smith, 1985      Stimson's Python

Insert in alphabetical order:

*Antaresia stimsoni* (Smith, 1985)      Stimson's Python

- (iv) Omit the following from the matter relating to Procellariidae (under the headings **Animals**, **Vertebrates** and **Birds**):

*Puffinus carneipes* Gould, 1844      Flesh-footed Shearwater

Insert in alphabetical order:

*Ardenna carneipes* (Gould, 1844)      Flesh-footed Shearwater



## Notice of Determination

- 
- (v) Omit the following under the headings **Animals, Vertebrates** and **Birds**:

## Hydrobatidae

- \* *Fregetta grallaria* (Vieillot, 1817)      White-bellied Storm-petrel

Insert after the matter relating to Procellariidae:

## Oceanitidae

- \* *Fregetta grallaria* (Vieillot, 1818)      White-bellied Storm-Petrel

- (vi) Omit the following from the matter relating to Accipitridae (under the headings **Animals, Vertebrates** and **Birds**):

- Pandion haliaetus* (Linnaeus, 1758)      Osprey

Insert instead:

- Pandion cristatus* (Vieillot, 1816)      Eastern Osprey

- (vii) Omit the following from the matter relating to Rallidae (under the headings **Animals, Vertebrates** and **Birds**):

- Amaurornis olivaceus* (Meyen, 1834)      Bush-hen

Insert instead:

- Amaurornis moluccana* (Wallace, 1865)      Pale-vented Bush-hen

- (viii) Omit the following from the matter relating to Turnicidae (under the headings **Animals, Vertebrates** and **Birds**):

- Turnix maculosa* (Temminck, 1815)

## Notice of Determination

---

Insert instead:

*Turnix maculosus* (Temminck, 1815)

- (ix) Omit the following from the matter relating to Laridae (under the headings **Animals**, **Vertebrates** and **Birds**):

*Sterna fuscata* Linnaeus, 1766      Sooty Tern

Insert in alphabetical order:

*Onychoprion fuscata* (Linnaeus, 1766)      Sooty Tern

- (x) Omit the following from the matter relating to Cacatuidae (under the headings **Animals**, **Vertebrates** and **Birds**):

*Cacatua leadbeateri* (Vigors, 1831)      Major Mitchell's Cockatoo

Insert in alphabetical order:

*Lophochroa leadbeateri* (Vigors, 1831)      Major Mitchell's Cockatoo

- (xi) Omit the following from the matter relating to Tytonidae (under the headings **Animals**, **Vertebrates** and **Birds**):

*Tyto capensis* (Smith, 1834)      Grass Owl

Insert instead:

*Tyto longimembris* (Jerdon, 1839)      Eastern Grass Owl

- (xii) Omit the following under the headings **Animals**, **Vertebrates** and **Birds**:

Pardalotidae

*Hylacola cauta* Gould, 1843      Shy Heathwren

## Notice of Determination

---

*Pyrrholaemus brunneus* Gould, 1841 Redthroat

*Pyrrholaemus saggitatus* (Latham, 1802) Speckled Warbler

Insert the following in alphabetical order in the matter relating to Acanthizidae:

*Chthonicola sagittata* (Latham, 1801) Speckled Warbler

*Hylacola cautus* Gould, 1843 Shy Heathwren

*Pyrrholaemus brunneus* Gould, 1841 Redthroat

- (xiii) Omit the following under the headings **Animals, Vertebrates and Birds**:

## Cinclosomatidae

*Cinclosoma castanotus* Gould, 1840 Chestnut Quail-thrush

Insert instead:

## Psophodidae

*Cinclosoma castanotum* Gould, 1840 Chestnut Quail-thrush

- (xiv) Omit the following under the headings **Animals, Vertebrates and Birds**:

## Dicruridae

*Monarcha leucotis* Gould, 1850 White-eared Monarch

## Notice of Determination

---

Insert instead:

## Monarchidae

*Carterornis leucotis* (Gould, 1850)      White-eared Monarch

- (xv) Omit the following under the headings **Animals**, **Vertebrates** and **Birds**:

## Passeridae

*Stagonopleura guttata* (Shaw, 1796)      Diamond Firetail

## Zosteropidae

*Zosterops lateralis tephroleurus* Gould, 1855      Silvereye (Lord Howe Is. subsp.)

Insert instead:

## Timaliidae

*Zosterops lateralis tephroleurus* Gould, 1855      Silvereye (Lord Howe Is. subsp.)

## Estrildidae

*Stagonopleura guttata* (Shaw, 1796)      Diamond Firetail

- (xvi) Omit the following from the matter relating to Vespertilionidae (under the headings **Animals**, **Vertebrates** and **Mammals**):

\* *Nyctophilus timoriensis* (Geoffroy, 1806) (South-eastern form)      Greater Long-eared Bat

Insert instead:

\* *Nyctophilus corbeni* Parnaby, 2009      Corben's Long-eared Bat

- (xvii) Omit the following from the matter relating to Fabaceae (under the heading **Plants**):

Notice of Determination

---

\* *Pultenaea parrisiae* J.D. Briggs & Crisp subsp. *parrisiae*

Insert instead:

\* *Pultenaea parrisiae* J.D. Briggs & Crisp

(xviii) Omit the following from the matter relating to Myrtaceae (under the heading **Plants**):

\* *Babingtonia granitica* A.R. Bean

Insert in alphabetical order:

\* *Kardomia granitica* (A.R. Bean) Peter G. Wilson

(xix) Omit the following from the matter relating to Myrtaceae (under the heading **Plants**):

*Melaleuca* sp. Megalong Valley Craven, Mallison & Douglas  
10442

Insert instead:

*Melaleuca megalongensis* Craven & S.M. Douglas

This Notice commences on the day on which it is published in the Gazette.

Dated, this 9th day of November 2011.

Dr Richard Major  
Chairperson of the Scientific Committee

**Copies of determination and reasons**

Copies of the determination and the reasons for it are available to members of the public (free of charge) as follows:

- (a) on the Internet at [www.environment.nsw.gov.au](http://www.environment.nsw.gov.au),

Notice of Determination

- 
- (b) by contacting the Scientific Committee Unit, by post C/- Office of Environment and Heritage, PO Box 1967, Hurstville BC NSW 1481, by telephone (02) 9585 6940 or by facsimile (02) 9585 6989,
  - (c) in person at the Office of Environment and Heritage Information Centre, Level 14, 59–61 Goulburn Street, Sydney.



New South Wales

## Notice of Determination

under the

### Threatened Species Conservation Act 1995

The Scientific Committee established under the *Threatened Species Conservation Act 1995* (**the Act**) has made a determination to amend the descriptions of certain species referred to in paragraphs (a)–(d) below pursuant to section 36A (1) (b) of the Act (being amendments that are necessary or desirable to correct minor errors).

- (a) Part 1 of Schedule 1 to the Act is amended as follows:
- (i) Omit the following from the matter relating to Agamidae (under the headings **Animals**, **Vertebrates** and **Reptiles**):

*Ctenophorus decresii* (Duméril and Bibron) 1837

- \* *Tympanocryptis pinguicolla* (Mitchell, 1948)

Insert instead:

*Ctenophorus decresii* (Duméril & Bibron, 1837)

- \* *Tympanocryptis pinguicolla* Mitchell, 1948

- (ii) Omit the following from the matter relating to Gekkonidae (under the headings **Animals**, **Vertebrates** and **Reptiles**):

- \* *Diplodactylus conspicillatus* Lucas and Frost (1897)

*Oedura rhombifer* Gray, 1845

Insert instead:

- \* *Diplodactylus conspicillatus* Lucas & Frost, 1897

*Oedura rhombifer* J.E. Gray, 1845

## Notice of Determination

- 
- (iii) Omit the following from the matter relating to Scincidae (under the headings **Animals, Vertebrates** and **Reptiles**):

*Cyclodomorphus venustus* Shea and Miller (1995)

Insert instead:

*Cyclodomorphus venustus* Shea & Miller, 1995

- (iv) Omit the following from the matter relating to Anatidae (under the headings **Animals, Vertebrates** and **Birds**):

*Nettapus coromandelianus* (Gmelin, 1789)

Insert instead:

*Nettapus coromandelianus* (J.F. Gmelin, 1789)

- (v) Omit the following from the matter relating to Procellariidae (under the headings **Animals, Vertebrates** and **Birds**):

\* *Macronectes giganteus* (Gmelin, 1789)

Insert instead:

\* *Macronectes giganteus* (J.F. Gmelin, 1789)

- (vi) Omit the following from the matter relating to Rallidae (under the headings **Animals, Vertebrates** and **Birds**):

*Gallirallus sylvestris* (Sclater, 1869)

Insert instead:

*Gallirallus sylvestris* (P.L. Sclater, 1869)



## Notice of Determination

- 
- (vii) Omit the following from the matter relating to Otididae (under the headings **Animals, Vertebrates** and **Birds**):

*Ardeotis australis* (Gray, 1829)

Insert instead:

*Ardeotis australis* (J.E. Gray, 1829)

- (b) Part 2 of Schedule 1 to the Act is amended as follows:

- (i) Omit the following from the matter relating to Casuariidae (under the headings **Animals, Vertebrates** and **Birds**):

*Dromaius novaehollandiae*

Insert instead:

*Dromaius novaehollandiae* (Latham, 1790)

- (ii) Omit the following from the matter relating to Orchidaceae (under the heading **Plants**):

*Rizanthella slateri* (Rupp)  
M.A. Clem. & Cribb

*Rizanthella slateri* (Rupp)  
M.A. Clem. & Cribb in the  
Great Lakes local government  
area

Insert instead:

*Rhizanthella slateri* (Rupp)  
M.A. Clem. & Cribb

*Rhizanthella slateri* (Rupp)  
M.A. Clem. & Cribb in the  
Great Lakes local government  
area

## Notice of Determination

- 
- (c) Part 1 of Schedule 1A to the Act is amended as follows:
- (i) Omit the following from the matter relating to Accipitridae (under the headings **Animals**, **Vertebrates** and **Birds**):
- \* *Erythrotriorchis radiatus* (Latham, 1802)
- Insert instead:
- \* *Erythrotriorchis radiatus* (Latham, 1801)
- (ii) Omit the following from the matter relating to Pachycephalidae (under the headings **Animals**, **Vertebrates** and **Birds**):
- \* *Pachycephala rufogularis* (Gould, 1841)
- Insert instead:
- \* *Pachycephala rufogularis* Gould, 1841
- (d) Part 1 of Schedule 2 to the Act is amended as follows:
- (i) Omit the following from the matter relating to Hylidae (under the headings **Animals**, **Vertebrates** and **Amphibians**):
- \* *Litoria littlejohni* A.W. White, Whitford and Mahony, 1994
- Insert instead:
- \* *Litoria littlejohni* A.M. White, Whitford and Mahoney, 1994
- (ii) Omit the following from the matter relating to Scincidae (under the headings **Animals**, **Vertebrates** and **Reptiles**):
- \* *Coeranoscincus reticulatus* (Gunther, 1873)
- Insert instead:
- \* *Coeranoscincus reticulatus* (Günther, 1873)

## Notice of Determination

- 
- (iii) Omit the following from the matter relating to Elapidae (under the headings **Animals, Vertebrates** and **Reptiles**):

*Demansia torquata* (Gunther, 1862)

Insert instead:

*Demansia torquata* (Günther, 1862)

- (iv) Omit the following from the matter relating to Diomedeidae (under the headings **Animals, Vertebrates** and **Birds**):

\* *Thalassarche cauta* (Gould, 1841)      Black-browed Albatross

\* *Thalassarche melanophris*      Shy Albatross  
(Temminck, 1828)

Insert instead:

\* *Thalassarche cauta* (Gould, 1841)      Shy Albatross

\* *Thalassarche melanophris*      Black-browed Albatross  
(Temminck, 1828)

- (v) Omit the heading “Ardeidae” (under the headings **Animals, Vertebrates** and **Birds**).

Insert instead:

Ardeidae

- (vi) Omit the following from the matter relating to Petroicidae (under the headings **Animals, Vertebrates** and **Birds**):

*Melanodryas cucullata cucullata* (Latham, 1802)

Insert instead:

*Melanodryas cucullata cucullata* (Latham, 1801)

Notice of Determination

---

- (vii) Omit the following from the matter relating to Neosittidae (under the headings **Animals**, **Vertebrates** and **Birds**):

*Daphoenositta chrysoptera* (Latham, 1802)

Insert instead:

*Daphoenositta chrysoptera* (Latham, 1801)

- (viii) Omit the following from the matter relating to Pachycephalidae (under the headings **Animals**, **Vertebrates** and **Birds**):

*Pachycephala pectoralis contempa* Hartert, 1898

Insert instead:

*Pachycephala pectoralis contempta* Hartert, 1898

This Notice commences on the day on which it is published in the Gazette.

Dated, this 9th day of November 2011.

Dr Richard Major  
Chairperson of the Scientific Committee

**Copies of determination and reasons**

Copies of the determination and the reasons for it are available to members of the public (free of charge) as follows:

- (a) on the Internet at [www.environment.nsw.gov.au](http://www.environment.nsw.gov.au),
- (b) by contacting the Scientific Committee Unit, by post C/- Office of Environment and Heritage, PO Box 1967, Hurstville BC NSW 1481, by telephone (02) 9585 6940 or by facsimile (02) 9585 6989,
- (c) in person at the Office of Environment and Heritage Information Centre, Level 14, 59–61 Goulburn Street, Sydney.

# OFFICIAL NOTICES

## Appointments

### COMBAT SPORTS ACT 2008

Appointment of Member to the Combat Sports Authority  
of New South Wales

HER Excellency the Governor, with the advice of the Executive Council, pursuant to section 60(4) of the Combat Sports Act 2008, has appointed Detective Superintendent Arthur Katsogiannis as a member of the Combat Sports Authority of NSW for a term of office commencing on 25 November 2011 and terminating on 30 September 2012.

GRAHAM ANNESLEY, M.P.,  
Minister for Sport and Recreation

Department of Premier and Cabinet, Sydney  
23 November 2011

### CONSTITUTION ACT, 1902

Ministerial arrangements during the absence of the Deputy Premier, Minister for Trade and Investment, Minister for Regional Infrastructure and Services

PURSUANT to section 36 of the Constitution Act, 1902, Her Excellency the Governor, with the advice of the Executive Council, has authorised the Honourable G Souris MP, Minister for Tourism, Major Events, Hospitality and Racing, and Minister for the Arts to act for and on behalf of the Minister for Trade and Investment, and Minister for Regional Infrastructure and Services, on and from 27 November 2011, with a view to his performing the duties of the Honourable A Stoner MP, during his absence from duty.

BARRY O'FARRELL, M.P.,  
Premier

### NATURAL RESOURCES COMMISSION ACT 2003

Appointment under Section 7

HER Excellency the Governor with the advice of the Executive Council, pursuant to the provisions of the Natural Resources Commission Act 2003, has appointed the officer listed below to the position as specified:

Natural Resources Commission

Mr John WILLIAMS, Commissioner [11 November 2011 to 9 December 2011].

The Hon. B. O'FARRELL, M.P.,  
Premier  
and Minister for Western Sydney

### SPORTING INJURIES INSURANCE ACT 1978

Appointment of Member  
Sporting Injuries Committee

HER Excellency the Governor, with the advice of the Executive Council, pursuant to Schedule 2 of the Sporting Injuries Insurance Act 1978, has appointed Ms SARAH STEWART on the nomination of the Minister for Sport and Recreation as a member of the Sporting Injuries Committee. The appointment is for the term beginning 14 September 2011 for three years.

GREG PEARCE, M.L.C.,  
Minister for Finance and Services  
and Minister for the Illawarra

## Roads and Maritime Services

### ROAD TRANSPORT (GENERAL) ACT 2005

Notice Under the Roads Transport (Mass, Loading and Access) Regulation 2005

I, Peter Duncan, Chief Executive of the Roads and Maritime Services, in pursuance of the Road Transport (Mass, Loading, Access) Regulation 2005, by this Notice, specify the routes and areas on or in which 25 metre B-Doubles may be used subject to any requirements or conditions set out in the Schedule.

PETER DUNCAN,  
Chief Executive,  
Roads and Maritime Services

#### SCHEDULE

##### 1. Citation

This Notice may be cited as the Roads and Maritime Services B-Double Notice No. 8/2011.

##### 2. Commencement

This Notice takes effect from 28 November 2011.

##### 3. Effect

This Notice remains in force until 6 December 2011.

##### 4. Application

This Notice applies to those B-Double vehicles which comply with Schedule 1 of the Road Transport (Mass, Loading and Access) Regulation 2005 and Schedule 2 of the Road Transport (Vehicle Registration) Regulation 2007 travelling on routes and areas specified in clause 5.

##### 5. Routes

<i>Type</i>	<i>Road Name</i>	<i>Starting Point</i>	<i>Finishing Point</i>
25	Australia Avenue, Sydney Olympic Park	Homebush Bay Drive	Kevin Coombs Avenue
25	Sarah Durack Avenue	Olympic Boulevard	Australia Avenue
25	Olympic Boulevard	Sarah Durack Avenue	Kevin Coombs Avenue
25	Herb Elliott Avenue	Olympic Boulevard	Showground Road
25	Showground Road	Herb Elliott Avenue	Murray Rose Avenue
25	Park Street	Murray Rose Avenue	Herb Elliott Avenue
25	Murray Rose Avenue	Showground Road	Park Street
25	Bennelong Parkway	Australia Avenue	Marjorie Jackson Parkway
25	Marjorie Jackson Parkway	Bennelong Parkway	Kevin Coombs Avenue
25	Kevin Coombs Avenue	Marjorie Jackson Parkway	Olympic Boulevard

**ROAD TRANSPORT (GENERAL) ACT 2005**

Notice under Clause 20 of the Road Transport (Mass, Loading and Access) Regulation 2005

CABONNE COUNCIL, in pursuance of Division 4 of Part 2 of the Road Transport (Mass, Loading, Access) Regulation 2005, by this Notice, specify the routes and areas on or in which 4.6 metre High Vehicles may be used subject to any requirements or conditions set out in the Schedule.

Dated: 22 November 2011.

G. L. P. FLEMING,  
General Manager,  
Cabonne Council  
(by delegation from the Minister for Roads)

---

**SCHEDULE****1. Citation**

This Notice may be cited as Cabonne Council 4.6 Metre High Vehicle Route Notice No. 1/2011.

**2. Commencement**

This Notice takes effect on the date of gazettal.

**3. Effect**

This Notice remains in force until 31 December 2012 unless it is amended or repealed earlier.

**4. Application**

This Notice applies to those 4.6 metre high vehicles which comply with Schedule 1 of the Road Transport (Mass, Loading and Access) Regulation 2005 and Schedule 2 of the Road Transport (Vehicle Registration) Regulation 2007.

**5. Routes**

All classified and local roads in Cabonne Council area.

**ROAD TRANSPORT (GENERAL) ACT 2005**

Road Transport (Mass, Loading and Access) Regulation 2005

Class 3 Rectangular Baled Cotton Exemption Notice 2011

I, Peter Duncan, Chief Executive of the Roads and Maritime Services, pursuant to Clause 25 of the Road Transport (Mass, Loading and Access) Regulation 2005 (the "Regulation"), exempt vehicles to which this Notice applies from the requirements of Clause 8 (1) of Schedule 1 to the Regulation, as provided in the Schedule to this Notice.

PETER DUNCAN,  
Chief Executive,  
Roads and Maritime Services

---

**SCHEDULE****PART 1 – PRELIMINARY****1.1 Citation**

This Notice may be cited as the Class 3 Rectangular Baled Cotton Exemption Notice 2011.

**1.2 Commencement**

This Notice takes effect on and from the date of publication in the NSW Government Gazette.

**1.3 Effect**

This Notice remains in force up to and including 30 October 2012 unless it is repealed earlier.

**1.4 Interpretation**

- 1.4.1 Unless stated otherwise in this Notice, words and expressions used in this Notice have the same meaning as those defined in the Road Transport (General) Act 2005.
- 1.4.2 Except as stated, a vehicle to which this Notice applies must comply with the Road Transport (Mass, Loading and Access) Regulation 2005 and the Road Transport (Vehicle Registration) Regulation 2007.
- 1.4.3 Notes in this Notice do not form part of the Notice.

**PART 2 – APPLICATION OF NOTICE****2.1 Application**

2.1.1 This Notice applies to a vehicle or combination which is:

- (i) a rigid vehicle;
- (ii) a prime mover and semi-trailer combination;
- (iii) a B-Double combination; and
- (iv) a Class 2 Road Train.

and which

- (a) has a gross vehicle mass or a gross combination mass exceeding 4.5 tonnes; and
- (b) has a constructed maximum width not exceeding 2.5 metres; and
- (c) is being used to transport rectangular cotton bales produced at a cotton gin.

2.1.2 This Notice does not apply to a:

- (a) Truck and dog trailer combination;
- (b) Truck and pig trailer combination; and
- (c) A B-Triple or AB Triple combination.

Note: The vehicles described in Clause 2.1.2 (c) may only be operated in accordance with a specific permit issued by the RTA Special Permits Unit.

**PART 3 – DIMENSION LIMITS****3.1 Dimension Limits**

3.1.1 Subject to Clause 3.2 a vehicle operating under this Notice, together with its load, must not exceed:

- (a) 4.6 metres in height; and / or
- (b) 2.7 metres in width.

3.2.1 A load on a vehicle must not project more than 100 mm from the outermost part of either side of the vehicle.

**3.2 Road Trains**

3.2.1 Despite Clause 3.1 a road train operating under this Notice, together with its load must not exceed 2.6 metres in width.

Note: This Notice permits prescribed heavy vehicles to carry a load of rectangular bales of cotton, that have been produced at a cotton gin, which exceeds statutory dimension limits. This Notice does not apply if the vehicle without a load exceeds 2.5m in width.



## PART 4 – OPERATING AND TRAVEL CONDITIONS

**4.1 Operating Conditions:**

A copy of this Notice (excluding the APPENDICES), must be carried in the driving compartment whenever the vehicle is operating under this Notice and must be produced when the driver is requested to do so by a police officer or an authorised officer.

**4.2 Travel Conditions:**

## 4.2.1 Loads exceeding 2.6 metres in width.

- (a) A vehicle with a load which exceeds 2.6 metres in width may only be operated on the roads and areas prescribed in Appendix 1 to this Notice, and the driver must observe any applicable travel condition set out in Appendix 1.
- (b) In addition, a vehicle with a load which exceeds 2.6 metres wide must observe the conditions that apply to critical locations, set out in Part 2, Appendix 1 to this Notice.

## 4.2.2 Loads 4.6 metres in height.

- (a) A vehicle with a load which exceeds 4.3 metres in height, but does not exceed 4.6 metres in height is only permitted to be operated on a route approved as set out in the 4.6 Metre High Vehicle Route Notice 2008, and the vehicle driver must observe the conditions of travel as set out in that notice.
- (b) A vehicle with a load which exceeds 2.6 metres in width, but does not exceed 2.7 metres in width, and exceeds 4.3 metres in height, but does not exceed 4.6 metres in height, must comply with 4.2.1 and 4.2.2 (a).

**4.3 Road Trains**

Road Trains operating under this Notice are only permitted to operate on a route approved as set out in the Class 2 Road Train Notice 2010.

Note: A B-Double that exceeds 19 metres in length and is operating under this Notice, must also comply with the Class 2 B-Double Notice 2010.

## PART 5 – WARNING DEVICES AND TRAVEL RESTRICTIONS

**5.1 Warning Devices and Travel Restrictions**

5.1.1 A vehicle with a load which exceeds 2.6 metres wide must comply with the requirements of Appendix 2 of this Notice.

5.1.2 A vehicle with a load which exceeds 2.6 metres wide is exempt from Clause 65 of Schedule 2 to the Road Transport (Vehicle Registration) Regulation 2007.

Note: Warning Signs

Vehicles exceeding 22m in length to must display warning signs in accordance with Clause 65 of Schedule 2 to the Road Transport (Vehicle Registration) Regulation 2007.

## Load Requirements

In accordance with Clause 61 of the Road Transport (Mass, Loading and Access) Regulation 2005;

- (1) A load on a vehicle or trailer must not be placed in a way that makes the vehicle unstable or unsafe.
- (2) A load on a vehicle or trailer must be secured so that it is unlikely to fall or be dislodged from the vehicle.
- (3) an appropriate method must be used to restrain the load on a vehicle.

The recommended performance standards are set out in Load Restraint Guide: Guidelines and performance standards for the safe carriage of loads on road vehicles, Second Edition, as published by the National Transport Commission in April 2004.

## ***Class 3 Rectangular Baled Cotton Exemption Notice 2011***

### ***APPENDIX 1 – Approved Routes and Travel Restrictions***

## **Table of Contents**

<b>PREFACE .....</b>	<b>2</b>
<b>PART 1 – NSW URBAN ZONE .....</b>	<b>2</b>
1.1 Definition.....	2
1.2 Clearway and transit lane travel .....	3
1.3 Night travel.....	3
1.4 Sundays and public holidays .....	3
1.5 Public holiday periods (including 23 December to 3 January).....	4
<b>1.6 Limited Access Locations and Zones – NSW Urban Zone.....</b>	<b>5</b>
1.6.1 Sydney & Inner Suburbs.....	5
1.6.2 Sydney North.....	7
1.6.3 Sydney South .....	7
1.6.4 Sydney West .....	8
1.6.5 Wollongong.....	9
1.6.6 Limited Access Locations: Newcastle and Central Coast .....	10
<b>PART 2 – NSW REGIONAL ZONE .....</b>	<b>15</b>
2.1 Public holiday periods (including 23 December to 3 January).....	15
<b>2.2 Limited Access Locations and Zones – NSW Regional Zone.....</b>	<b>16</b>
2.2.1 Limited Access Locations: Northern Ranges & North Coast NSW .....	16
2.2.2 Limited Access Locations: Central NSW.....	17
2.2.3 Limited Access Locations: South Western and Southern NSW .....	17
2.2.4 Limited Access Locations: Southern Ranges and South Coast NSW .....	18

## Preface

Vehicles operating pursuant to the *Class 3 Rectangular Baled Cotton Exemption Notice 2011* that exceed 2.6 metres are subject to the travel conditions that apply in the NSW Urban Zone and NSW Regional Zone as set out below.

Despite the dimension limits allowable under the *Class 3 Rectangular Baled Cotton Exemption Notice 2011*, a vehicle must not exceed a dimension limit which applies to a Limited Access Location or Zone as set out below.

### Part 1 – NSW Urban Zone

#### 1.1 Definition

The NSW Urban Zone is defined as the area bounded by and including the named roads,

- the Pacific Ocean and the North Channel of the Hunter River, then north from Stockton bridge along
- Nelson Bay Road (MR108) to Williamtown, then west along
- Cabbage Tree Road (MR302) to Masonite Road near Tomago, then along
- Masonite Road to the Pacific Highway (HW10) at Heatherbrae, then south along the
- Pacific Highway (HW10) to Hexham, then west along the
- New England Highway (HW9) to Weakleys Drive Thornton, then south along
- Weakleys Drive to the Sydney-Newcastle Freeway (F3) at Beresfield, then along the
- F3 Freeway to the Hawkesbury River bridge, then along the
- Hawkesbury River and the Nepean River to Cobbity, then a line drawn south from
- Cobbity to Picton, then via
- Picton Rd and Mount Ousley Rd (MR95) to the start of the F6 Freeway at Mount Ousley, then via the
- F6 Freeway to the Princes Hwy at West Wollongong, then the
- Princes Hwy and Illawarra Hwy to Albion Park with a branch west on West Dapto Rd to Tubemakers, then
- Tongarra Rd to the Princes Hwy, then
- Princes Highway south to the intersection of South Kiama Drive at Kiama Heights.

## 1.2 Clearway and transit lane travel

A vehicle that is wider than 2.6 metres must not travel on Clearways or Transit Lanes in the NSW Urban Zone between the hours of 6.00am and 10.00am and between the hours of 3.00pm and 7.00pm when clearway or transit lane restrictions apply.

<b>MIDNIGHT</b>	Travel Yes	
1	Travel Yes	
2	Travel Yes	
3	Travel Yes	
4	Travel Yes	
5	Travel Yes	
6	<b>No travel</b>	<b>6am to 10am</b>
7	<b>No travel</b>	
8	<b>No travel</b>	
9	<b>No travel</b>	
10	Travel Yes	
11	Travel Yes	
<b>NOON</b>	Travel Yes	
1	Travel Yes	
2	Travel Yes	
3	<b>No travel</b>	<b>3pm to 7pm</b>
4	<b>No travel</b>	
5	<b>No travel</b>	
6	<b>No travel</b>	
7	Travel Yes if daylight	
8	Travel Yes if daylight	
9	<b>No travel</b>	
10	Travel Yes	
11	Travel yes	

*Note: Clearway and transit lane time restrictions can apply to just one side of the road or to both sides. Check prior to travel.*

## 1.3 Night Travel

Vehicles wider than 2.6 metres travelling at night may only operate in the NSW Urban Zone between 10pm and sunrise.

## 1.4 Sundays and public holidays

Vehicles wider than 2.6 metres are not permitted to travel after 4.00pm on Sundays or state-wide public holidays on the following roads:

Road or area subject to restriction
Hume Highway between the Picton Rd interchange and the M7 and M5 interchange at Prestons
Western Motorway (M4) between the Nepean River at Emu Plains and Prospect
Sydney–Newcastle Freeway (F3) between the Hawkesbury River and the Central Coast Highway interchange at Kariiong

### 1.5 Public holiday periods (including 23 December to 3 January)

Vehicles wider than 2.6 metres are not permitted to travel in the daytime during public holiday periods (including 23 December to 3 January of the following year inclusive) on the following roads:

Road or area subject to restriction
Princes Highway – from Broadway to south Kiama
Hume Highway – from Parramatta Rd to Picton Rd interchange
Pacific Highway – from Warringah Freeway North Sydney to Masonite Rd Heatherbrae
New England Highway – from Hexham Bridge to Weakleys Drive
Central Coast Highway – from F3 at Kariong to Pacific Highway Doyalson
Newcastle Bypass – from Pacific Highway Windale to Pacific Highway Sandgate
Cumberland Highway – from Hume Highway Liverpool to Pacific Highway Wahoonga
Great Western Highway – from Broadway to Nepean River Emu Plains
F1 Warringah Freeway – from Sydney Harbour Bridge to Willoughby Rd Naremburn
M2 Hills Motorway – from North Ryde to Seven Hills
F3 Sydney Newcastle Freeway – from Wahoonga to Beresfield
F4 Western Motorway – from Concord Rd to Nepean River Leonay
F5 South Western Freeway – from Kyeemagh to Prestons
F6 Southern Freeway – from waterfall to Yallah
M7 Westlink – from Seven Hills to Prestons
Gore Hill Freeway – Naremburn to Lane Cove

*Note: A public holiday period means a period of three or more consecutive days covering a gazetted NSW public holiday and adjacent weekend days (for example Easter and every long weekend); or the period between 23 December and 3 January of the following year (inclusive).*

## 1.6 Limited Access Locations and Zones – NSW Urban Zone

Travel on or through a Limited Access Location or Zone is not permitted under this Notice if the vehicle exceeds an applicable limit. If a vehicle exceeds an applicable limit, a specific permit must be obtained before travelling on or in any of the following Limited Access Locations in the NSW Urban Zone, subject to any restrictions or conditions which apply at that location or Zone. A permit cannot be granted for access at some locations.

### 1.6.1 Sydney & Inner Suburbs

Sydney CBD zone: The area bounded by and including George Street from Railway Square to Hay Street, Hay Street from George Street to Sussex Street, Sussex Street from Hay Street to Erskine Street, Erskine Street from Sussex Street to Kent Street, Kent Street from Erskine Street to as far north as Jamison Street, then a line drawn to Jamison Street and along Jamison Street to York Street, York Street from Jamison Street to Grosvenor Street, Grosvenor Street from York Street to George Street, George Street from Grosvenor Street to Alfred Street, Alfred Street from George Street to Circular Quay East, Circular Quay East from Alfred Street to Macquarie Street, Macquarie Street from Circular Quay East to Prince Albert Road, Prince Albert Road from Macquarie Street to College Street, College Street from Prince Albert Road to Wentworth Avenue, Wentworth Avenue from College Street to Elizabeth Street, Elizabeth Street from Wentworth Avenue to Hay Street, Hay Street from Elizabeth Street to Pitt Street, Pitt Street from Hay Street to George Street at Railway Square;

#### Sydney CBD Zone



**Limited Access Locations: Sydney CBD and Inner suburbs**

Location / Road	Dimension Limit (metres)			Condition of access for vehicles which exceed a dimension limit which applies to a limited access location
	Width	Height	Length	
Sydney CBD Zone	2.6	4.3	12.5	Specific permit required
Boundary Street Darlinghurst railway underpass (MR625)	N/A	4.0	N/A	Height limited railway underpass. Access not permitted
Bradfield Highway (MR632) from the Southern Toll Plaza to Lavender Street	2.6	4.3	19.0	Access not permitted
Brown Street Leichhardt (Tebbutt St to Cook St) (MR652)	2.6	4.3	19.0	Access not permitted
Cross City Tunnel from McLachlan Ave Rushcutters Bay to Harbour St at Darling Harbour	2.6	4.3	19.0	Access not permitted
Cahill Expressway (MR592) from the Southern Toll Plaza to the Eastern Distributor toll road	2.6	4.3	19.0	Access not permitted
Frederick Street Ashfield railway underpass (MR650)	N/A	4.0	N/A	Height limited railway underpass Access not permitted
Johnston Street Annandale railway underpass (MR655)	N/A	4.0	N/A	Height limited railway underpass Access not permitted
King Street Newtown (HW1) between Lord Street and Carillon Avenue	2.6	4.3	19.0	Access not permitted
M5 East Motorway (tunnel) between King Georges Road interchange Beverly Hills and General Holmes Drive Mascot	2.6	4.3	19.0	Access not permitted
Raw Square Strathfield railway underpass (MR668)	N/A	3.9	N/A	Height limited railway underpass. Access not permitted
(Old) Ryde Bridge (MR200) from Concord Road to Church Street	N/A	4.5	N/A	Specific permit required
Sydney Harbour Bridge (MR632) from the Southern Toll Plaza to Lavender Street North Sydney.	2.6	4.3	19.0	Access not permitted unless for works on bridge – Specific permit required
Sydney Harbour Tunnel from Warringah Freeway to the Cahill Expressway; from Eastern Distributor to Baker Street Kensington	2.6	4.3	19.0	Access not permitted

### 1.6.2 Sydney North

Location / Road	Dimension Limit (metres)			Condition of access for vehicles which exceed a dimension limit applying to a limited access location
	Width	Height	Length	
Lane Cove Tunnel from the Pacific Hwy to Lane Cove River at Lane Cove North	2.6	4.3	25.0	Dimensions must be met for access
M2 Motorway and tunnel from the toll plaza at Macquarie Park to Beecroft Rd (MR139)	2.6	4.3	25.0	Dimensions must be met for access
Berowra Waters Road (RR332) at Berowra Ferry	2.6	4.3	12.5	Access not permitted
Boundary Street Roseville railway underpass (MR328)	N/A	4.1	N/A	Height limited railway underpass, access not permitted
Galston Road (MR161) at Galston Gorge between Montview Parade Hornsby Heights and Calderwood Road Galston	2.6	4.3	12.5	Access not permitted
McCarrs Creek Road (MR174) from Church Point to Terrey Hills	2.6	4.3	12.5	Access not permitted
Wisemans Ferry Road (RR225) from Berecry Rd Mangrove Mountain to the Hawkesbury River Wisemans Ferry.	2.6	4.3	19.0	Specific permit required, not for through travel
Strathallen Ave (MR599) at the suspension bridge (BN172), Northbridge.	N/A	4.3	N/A	Overmass access not permitted

### 1.6.3 Sydney South

Location / Road	Dimension Limit (metres)			Condition of access for vehicles which exceed a dimension limit applying to a limited access location
	Width	Height	Length	
Heathcote Road (MR512) between New Illawarra Road Lucas Heights and the Princes Highway Heathcote	2.6	N/A	19.0	Specific permit required
Lady Wakehurst Drive, Sir Bertram Stevens Drive, Audley Road and Farnell Avenue (MR393) between Bald Hill Lookout and the Princes Highway	2.6	4.3	14.5	Specific permit required
McKell Avenue (MR393) from Waterfall to the Royal National Park	2.6	4.3	14.5	Specific permit required
Princes Highway (HW1) on (old) Tom Ugly's Bridge (northbound)	N/A	4.3	19.0	Height Limited Bridge, use Taren Point rd
Seven Ways Rockdale (MR169) between the Princes Highway and Watkin Street	N/A	4.3	19.0	Specific permit required
Wollongong Road Arncliffe – railway underpass	N/A	3.5	19.0	Narrow height limited railway underpass



### 1.6.4 Sydney West

#### Limited Access Zone – Parramatta CBD

**Parramatta CBD restricted road zone:** The area bounded by and including Phillip Street from the intersection with Marsden Road to the intersection with Charles Street, Charles Street to the intersection with Macquarie Street, Macquarie Street to the intersection with Smith Street, Smith Street to the intersection with Darcy Street, Darcy Street to the intersection with Church Street, Church Street Mall to the intersection with Macquarie Street, Macquarie Street to the intersection with Marsden Street and Marsden Street to the intersection with Phillip Street. The zone also includes Fitzwilliam Street from the intersection with Wentworth Street to the intersection with Church Street and Argyle Street from the intersection with Church Street to the intersection with Fitzwilliam Street;

**Parramatta CBD**

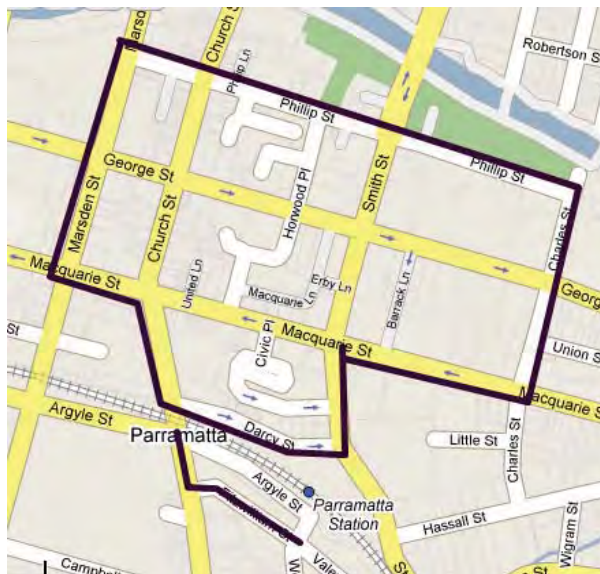

#### Limited Access Locations: Sydney West

Location / Road	Dimension Limit (metres)			Condition of access for vehicles which exceed a dimension limit which applies to a limited access location
	Width	Height	Length	
Parramatta CBD Zone	2.6	4.3	19.0	Specific permit required
Gasworks Bridge Parramatta.	2.6	N/A	N/A	Load limited bridge 30t gross
Macquarie St underpass Windsor	N/A	4.3	N/A	Railway underpass height limit, access not permitted
Windsor Bridge George St Windsor	2.6	4.3	22.0	Specific permit
Victoria Bridge over Nepean River at Penrith	2.6	4.3	19.0	Access not permitted beyond these dimensions

## 1.6.5 Wollongong

### Limited Access Zone – Wollongong CBD

**Wollongong CBD zone:** Wollongong CBD is the area bounded by and including Smith Street from the intersection with Flinders Street to the intersection with Corrimal Street, the western side of Corrimal Street to the intersection with Bank Street, Bank Street to the intersection with Church Street, Church Street to the intersection with Ellen Street, and Ellen Street to the intersection with Auburn Street, then a straight line drawn from the intersection of Ellen Street and Auburn Street to the intersection of Rowland Avenue and Gladstone Avenue, Gladstone Avenue to the intersection with Crown Street, Crown Street and Denison Street to the intersection with Victoria Street, Victoria Street to the intersection with Keira Street, and Keira Street to the intersection with Smith Street;



### Limited Access Locations: Wollongong CBD

Location / Road	Dimension Limit (metres)			Condition of access for vehicles which exceed a dimension limit which applies to a limited access location
	Width	Height	Length	
Wollongong CBD Zone	2.6	4.3	19.0	Class 3 permit required
Broughton Pass (RR610) from Appin Road to Wilton Road	2.6	4.3	19.0	No oversize access
Bulli Pass (HW1) from Mount Ousley Road to Lawrence Hargrave Drive	2.6	4.6	19.0	Class 3 permit required
Lawrence Hargrave Drive (MR185) from the Princes Highway at the foot of Bulli Pass via Thirroul, Austinmer, Clifton and Bald Hill to the Princes Highway south of Helensburgh	2.6	4.3	19.0	Class 3 permit required

**1.6.6 Limited Access Locations: Newcastle and Central Coast**

Location / Road	Dimension Limit (metres)			Condition of access for vehicles which exceed a dimension limit which applies to a limited access location
	Width	Height	Length	
George Booth Drive (MR527) from the F3 Freeway west to the Tasman Mine entrance.	2.6	N/A	19.0	Class 3 permit required
Henry Parry Drive Gosford (MR673) between York Street and Etna Street	2.6	4.3	19.0	Class 3 permit required
Old Pacific Highway from the Hawkesbury River to Kariong	N/A	4.6	19.0	Class 3 permit required
Woy Woy Bay Road (RR7751) from Woy Woy to Kariong	2.6	4.6	19.0	Class 3 permit required



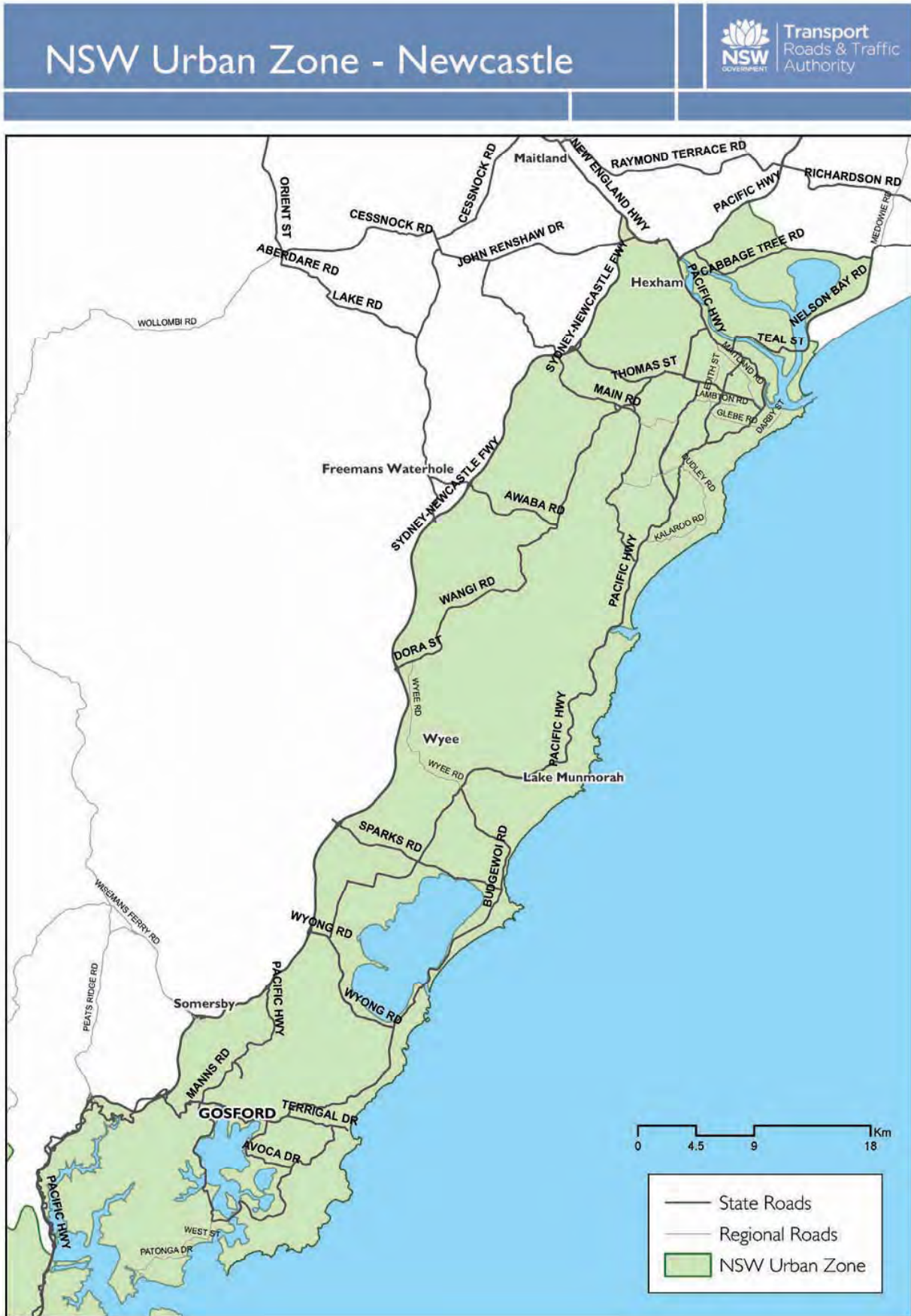



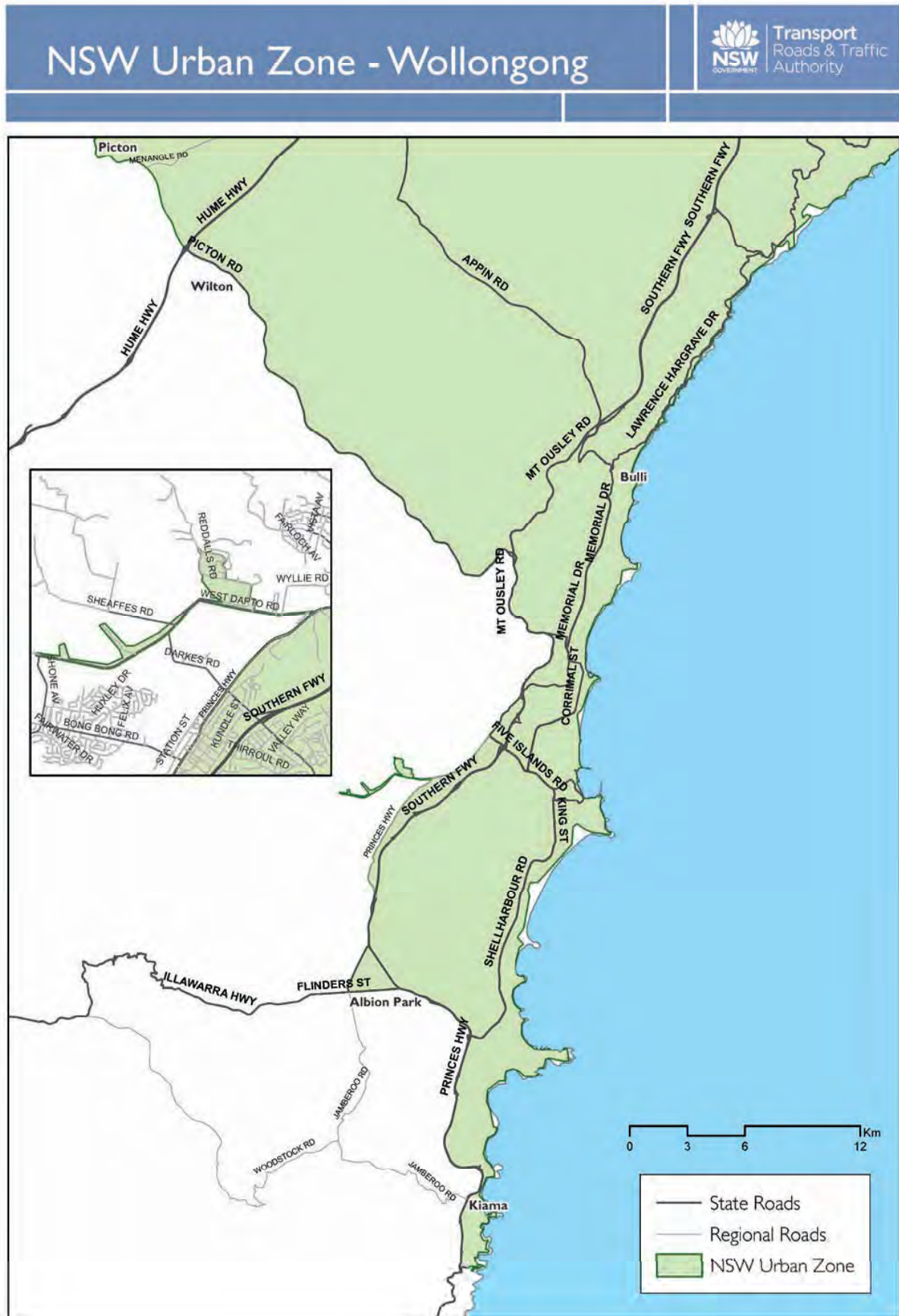

## Part 2 – NSW Regional Zone

The NSW Regional Zone is that part of the State of New South Wales that is not part of the area declared to be the NSW Urban Zone

### 2.1 Public holiday periods (including 23 December to 3 January)

Vehicles wider than 2.6 metres are not permitted to travel in the daytime during **public holiday periods** (including 23 December to 3 January of the following year inclusive) on the following roads:

Travel Restriction applies to
Pacific Highway – from Heatherbrae to Qld border
Princes Highway – from South Kiama to Victorian border
Hume Highway – from Picton Rd to Victorian border
Great Western Highway – from Nepean River to Bathurst
New England Highway – from Weakleys Drive to Qld border
Golden Highway – from New England Highway to Dubbo
Mitchell Highway – from Bathurst to Dubbo
Castlereagh Highway – from Marrangaroo to Gilgandra
Kamilaroi Highway – from Willow Tree to Narrabri
Newell Highway – from Tocumwal to Goondiwindi
Mid Western Highway – from Bathurst to Marsden
Sturt Highway – from Lower Tarcutta to Narrandera
Riverina Highway – from Bethanga to Finley
Monaro Highway – from ACT border to Victorian border near Rockton
Snowy Mountains Highway – from Bega to the Hume Highway
Oxley Highway – from Port Macquarie to Coonabarabran
Gwydir Highway – from South Grafton to Moree
Bruxner Highway – from Ballina to Boggabilla
Gold Coast Highway – from Tweed Interchange to Coolangatta
Illawarra Highway – from Albion Park to the Hume Highway



Travel Restriction applies to
Federal Highway – from Hume Highway to ACT border
Barton Highway – from Hume Highway to ACT border
Burley Griffin Way (MR84) between the Hume Highway west of Bowning and the Irrigation Way (MR80) at Yoogali east of Griffith
Kidman Way (MR321 + MR80) between the Newell Highway 16km north of Jerilderie and the Mid Western Highway at Goolgowi
Lachlan Valley Way (MR56) between the Newell Highway at Forbes and its intersection with the Hume Highway northwest of Yass
Kings Highway (MR51) between Braidwood and Batemans Bay
Olympic Highway (MR78) between the Hume Highway north of Albury, and Cowra

*Note: A public holiday period means a period of three or more consecutive days covering a gazetted NSW public holiday and adjacent weekend days (for example Easter and every long weekend); or the period between 23 December and 3 January of the following year (inclusive).*

## 2.2 Limited Access Locations and Zones – NSW Regional Zone

Travel is not permitted if you exceed the stated dimension limits for that road or location. A specific permit must be obtained before travelling on any of the following restricted roads:

### 2.2.1 Limited Access Locations: Northern Ranges & North Coast NSW

Location / Road	Dimension Limit (metres)			Condition of Access
	Width	Height	Length	
Coramba Rd (RR120) between Dorrigo and Coramba.	2.6	N/A	19.0	Class 3 permit required
Waterfall Way between Church St Bellingen and Maynards Plains Rd Dorrigo.	2.6	N/A	19.0	Class 3 permit required
Tomewin Rd (RR143) from Murwillumbah to the Qld border.	2.6	N/A	19.0	No oversize access
Bruxner Hwy between Drake and Tenterfield.	2.6	N/A	19.0	Class 3 permit required
Ebor to Grafton Rd (RR74) between Tyringham and Nymboida.	2.6	N/A	19.0	Class 3 permit required
Oxley Hwy from Ralfes Creek bridge west to Yarowitch.	2.6	N/A	19.0	Class 3 permit required

### 2.2.2 Limited Access Locations: Central NSW

Location / Road	Dimension Limit (metres)			Condition of Access
	Width	Height	Length	
Crookwell to Trunkey Creek (Binda Rd MR54) between Abercrombie Caves and Tuena.	2.6	N/A	19.0	Class 3 permit required
Abercrombie Rd (Taralga to Goulburn Road RR256) for 5 km north and south of Abercrombie Bridge.	2.6	N/A	19.0	Class 3 permit required
Hawkesbury Road (MR570) between the lookout near Roberts Pde and north to the Blue Mountains City Council boundary.	2.6	N/A	12.5	Class 3 permit required for access, no through travel
Putty Road (MR503) from East Kurrajong Rd to Milbrodale School.	2.6	4.3	19.0	Class 3 permit required
Paytens Bridge over Lachlan River near Bandon.	2.6	4.3	19.0	No oversize access
Jenolan Caves Road (RR253) from 10km north of Jenolan Caves to 10km west of Jenolan Caves.	2.6	4.3	12.5	Class 3 permit required

### 2.2.3 Limited Access Locations: South Western and Southern NSW

Location / Road	Dimension Limit (metres)			Condition of Access
	Width	Height	Length	
Echuca Bridge on Cobb Highway between Moama and Echuca.	2.6	N/A	N/A	Daytime travel restrictions Mon – Fri 7.30am to 9.30am, and Noon to 1pm, and 3pm to 6pm Sat – Sun 7.30am to 9am, and Noon to 1pm No overmass permitted
Burley Griffin Way between Binalong and Stockinbingal.	2.6	N/A	N/A	Contact Police Southern Region RTC before travel
Gocup Rd between Gundagai and Tumut.	2.6	N/A	N/A	Contact Police Southern Region RTC before travel
Grahamstown Rd between Tumblong and Mt Horeb.	2.6	N/A	N/A	Contact Police Southern Region RTC before travel

Snowy Mountains Highway from Tumut Plains Rd Tumut to Kosciusko Rd Cooma.	2.6	N/A	19.0	Class 3 Permit required and contact Police Southern Region RTC for escorts before travel
---	-----	-----	------	--

#### 2.2.4 Limited Access Locations: Southern Ranges and South Coast NSW

Location / Road	Dimension Limit (metres)			Condition of Access
	Width	Height	Length	
Illawarra Highway (HW25) from the Broughton Ave roundabout near Tullimbar westward to Jamberoo Mountain Rd near Robertson.	2.6	N/A	19.0	Class 3 permit required, no through travel permitted
Moss Vale Road (MR261) between Barfield Rd Cambewarra and Fitzroy Falls.	2.6	N/A	19.0	Contact Nowra Police if wider than 2.6m; Police escort required if wider than 3.0 metres
Moss Vale Road (RR261) at Fitzroy Falls.	2.6	4.6	19.0	Class 3 permit required
Kangaroo Valley Road between Berry and Moss Vale Rd.	2.6	N/A	19.0	Contact Nowra Police if wider than 2.6m; Police escort required if wider than 3.0 metres
Hampden Bridge in Kangaroo Valley.	2.6	4.6	19.0	Class 3 permit required; no overmass permitted
Mount Keira Road at Mount Keira between Harry Graham Dve and Gipps Rd.	2.6	4.3	12.5	Class 3 permit required
Araluen Rd from Majors Creek to Kiora.	2.6	N/A	19.0	Class 3 permit required, no through travel permitted
Princes Highway at Narooma bridge between Dalmeny Drive and Riverside drive.	N/A	4.5	N/A	Contact Batemans Bay Police if wider than 3.0 metres or higher than 4.4 metres
Princes Highway at South bound Shoalhaven Bridge at Nowra	N/A	4.4	N/A	No through travel permitted

## Class 3 Rectangular Baled Cotton Exemption Notice 2011

## APPENDIX 2

A vehicle operating under this Notice, which exceeds 2.6 metres in width, must comply with the conditions set out in this Appendix.

## PART 1 – WARNING DEVICES

**1.1 Travelling during the period between sunrise and sunset**

1.1.1 When travelling between sunrise and sunset, it must have affixed:

- (a) one warning sign at its front; and
- (b) one warning sign at its rear; and
- (c) at least two yellow, rigid pieces of material (in this clause called delineators), where the load projects on one side of the vehicle only, attach one to the front of the lead trailer and one to the rear of the last trailer on the side of the projection; and
- (d) Where the load projects beyond both sides of the vehicle there must be at least 4 delineators—at least one on each side at the front and at least one on each side at the rear.

1.1.2 Headlights

A vehicle must have its low-beam headlights on while travelling in the daytime, unless it is not required under the Road Transport (Vehicle Registration) Regulation 2007 to have headlights.

**1.2 Travelling during the period between sunset and sunrise**

1.2.1 When travelling between sunset and sunrise, a vehicle that is being operated under this Notice must have affixed:

- (a) one warning sign at its front, and
- (b) one warning sign at its rear; and
- (c) at least two yellow, rigid pieces of material (in this clause called delineators), where the load projects on one side of the vehicle only, attach one to the front of the lead trailer and one to the rear of the last trailer on the side of the projection and
- (d) Where the load projects beyond both sides of the vehicle there must be at least 4 delineators—at least one on each side at the front and at least one on each side at the rear.
- (e) A warning light attached to the top of the cabin of the vehicle or combination.

**1.3 Requirements of warning devices required under this Notice**

1.3.1 Warning signs must comply with the Australian/New Zealand Standard AS/NZS 1906.1:2007, Retroreflective materials and devices for road control purposes and also with Part 7 of Schedule 2 to the Road Transport (Mass, Loading and Access) Regulation 2005.

1.3.2 A delineator must:

- (a) be at least 300 mm long and at least 300 mm wide, and
- (b) comply with Class 1 or 2 of Australian/New Zealand Standard AS/NZS 1906.1:2007, Retroreflective materials and devices for road control purposes; and
- (c) if at the front of the lead trailer, be attached so that its reflective surface is facing forward of the vehicle, and does not exceed the extremity of the load, and
- (d) if at the rear of the last trailer, be attached so that its reflective surface is facing rearward from the vehicle.

1.3.3 When switched on, a warning light that is required to be fitted to a vehicle operating under this Notice must:

- (a) emit a rotating, flashing, yellow coloured light, and
- (b) flash between 120 and 200 times a minute, and
- (c) have a power of at least 55 watts, and
- (d) not be a strobe light.

1.3.4 A warning sign must not be displayed on a vehicle or combination that is not operating under the Notice [see clause 45 of Schedule 2 of the Road Transport (Mass, Loading and Access) Regulation 2005].

1.3.5 Any warning light which a vehicle or combination is required to have under this Notice must only be switched on when the vehicle or combination is travelling or is stationary in a position that is likely to cause danger to other road users. [See clause 40 of Schedule 2 of the Road Transport (Mass, Loading and Access) Regulation 2005].

1.3.6 If a vehicle or combination is not required under this Notice to have a warning light, it must not have one that is switched on.

## PART 2 – TRAVEL RESTRICTIONS

**2.1 No travelling if low visibility**

- 2.1.1 A vehicle must not begin to travel if, due to circumstances such as fog, heavy rain, smoke, dust or insect plague:
- (a) visibility is less than 250 m in the daytime; or
  - (b) the headlights of a vehicle approaching within 250 m could not be seen at night.
- 2.1.2 If a vehicle is already travelling when visibility is reduced to the level described in 2.1.1, the driver must drive it into the nearest safe parking area, and wait until visibility improves beyond that level before continuing to travel.

**2.2 Minimum following distance**

A vehicle must maintain a distance of at least 200 m from an oversize vehicle or combination travelling in front of it, unless:

- (a) it is overtaking the front one or the front one is stopping; or
- (b) there is a separate lane available for the use of overtaking traffic; or
- (c) it is in an urban area and it is not reasonably practicable to maintain a distance of 200 m.

**2.3 Assessing routes**

- 2.3.1 Before a vehicle or combination is driven along any route, its driver and owner must be satisfied that the route has been assessed and that the vehicle or combination can be driven along it as per Appendix 1 to the Notice.

**ROADS ACT 1993****LAND ACQUISITION (JUST TERMS  
COMPENSATION) ACT 1991**

Notice of Compulsory Acquisition of Land at South  
Nowra in the Shoalhaven City Council area

Roads and Maritime Services by its delegate declares, with the approval of Her Excellency the Governor, that the land described in the schedule below is acquired by compulsory process under the provisions of the Land Acquisition (Just Terms Compensation) Act 1991 for the purposes of the Roads Act 1993.

T D Craig  
Manager, Compulsory Acquisition & Road Dedication  
Roads and Maritime Services

---

**SCHEDULE**

ALL those pieces or parcels of Crown land situated in the Shoalhaven City Council area, Parish of Nowra and County of St Vincent, shown as:

Lot 32 Deposited Plan 1158088, being part of the land in Certificate of Title 461/1062117; and

Lots 33 and 34 Deposited Plan 1158088, being parts of the land in Certificate of Title 7309/1151761.

(RMS Papers: 11M2372; RO 1/404.11149)

## Department of Trade and Investment, Regional Infrastructure and Services

NOTICE is given that the following applications have been received:

### EXPLORATION LICENCE APPLICATIONS

(T11-0363)

No. 4441, ALTIUS MINING LIMITED (ACN 126 540 547), area of 4 units, for Group 1, dated 15 November 2011. (Orange Mining Division).

(T11-0367)

No. 4444, JUBA MINERALS PTY LIMITED, area of 14 units, for Group 1 and Group 10, dated 16 November 2011. (Armidale Mining Division).

CHRIS HARTCHER, M.P.,  
Minister for Resources and Energy

NOTICE is given that the following applications for renewal have been received:

(Z07-7589)

Exploration Licence No. 5645, ARGENT MINERALS LIMITED (ACN 124 780 276), area of 3 units. Application for renewal received 16 November 2011.

(T03-0087)

Exploration Licence No. 6155, COBAR CONSOLIDATED RESOURCES LIMITED (ACN 118 684 576), area of 6 units. Application for renewal received 15 November 2011.

(T03-0836)

Exploration Licence No. 6162, YTC RESOURCES LIMITED (ACN 108 476 384), area of 49 units. Application for renewal received 17 November 2011.

(Z05-0243)

Exploration Licence No. 6482, COBAR CONSOLIDATED RESOURCES LIMITED (ACN 118 684 576), area of 92 units. Application for renewal received 17 November 2011.

(Z05-0252)

Exploration Licence No. 6483, BIACIL HOLDINGS PTY LTD (ACN 114 218 549), area of 100 units. Application for renewal received 18 November 2011.

(Z08-0241)

Exploration Licence No. 7249, ILLAWARRA COAL HOLDINGS PTY LTD (ACN 093 857 286), area of 31.52 hectares. Application for renewal received 21 November 2011.

CHRIS HARTCHER, M.P.,  
Minister for Resources and Energy

### RENEWAL OF CERTAIN AUTHORITIES

Notice is given that the following authorities have been renewed:

(11-2769)

Exploration Licence No. 6776, ULAN STONE PTY LTD (ACN 123 199 191), County of Bligh, Map Sheet (8833),

area of 2 units, for a further term until 15 May 2013. Renewal effective on and from 16 November 2011.

(10-4215)

Exploration Licence No. 6835, MINERALS AUSTRALIA PTY LTD and JACARANDA MINERALS LTD, County of Denison, Map Sheet (8026, 8126), area of 25 units, for a further term until 19 July 2013. Renewal effective on and from 16 November 2011.

(09-7090)

Coal Lease No. 352 (Act 1973), BLOOMFIELD COLLIERIES PTY LTD (ACN 000 106 972), Parish of Auckland, County of Durham and Parish of Darlington, County of Durham, Map Sheet (9132-4-N, 9133-3-S), area of 1814.7 hectares, for a further term until 20 October 2031. Renewal effective on and from 13 September 2011.

CHRIS HARTCHER, M.P.,  
Minister for Resources and Energy

### TRANSFERS

(11-2875)

Exploration Licence No. 4918, formerly held by WHITE MINING (NSW) PTY LIMITED (ACN 089 414 595), AUSTRAL-ASIA COAL HOLDINGS PTY LTD (ACN 113 038 663) and ICRA ASHTON PTY LTD (ACN 097 499 780) has been transferred to WHITE MINING (NSW) PTY LIMITED (ACN 089 414 595) and ICRA ASHTON PTY LTD (ACN 097 499 780). The transfer was registered on 14 November 2011.

(11-2875)

Exploration Licence No. 5860, formerly held by WHITE MINING (NSW) PTY LIMITED (ACN 089 414 595), AUSTRAL-ASIA COAL HOLDINGS PTY LTD (ACN 113 038 663) and ICRA ASHTON PTY LTD (ACN 097 499 780) has been transferred to WHITE MINING (NSW) PTY LIMITED (ACN 089 414 595) and ICRA ASHTON PTY LTD (ACN 097 499 780). The transfer was registered on 14 November 2011.

(11-2875)

Mining Lease No. 1529 (Act 1992), formerly held by WHITE MINING (NSW) PTY LIMITED (ACN 089 414 595), AUSTRAL-ASIA COAL HOLDINGS PTY LTD (ACN 113 038 663) and ICRA ASHTON PTY LTD (ACN 097 499 780) has been transferred to WHITE MINING (NSW) PTY LIMITED (ACN 089 414 595) and ICRA ASHTON PTY LTD (ACN 097 499 780). The transfer was registered on 14 November 2011.

(11-2875)

Mining Lease No. 1533 (Act 1992), formerly held by WHITE MINING (NSW) PTY LIMITED (ACN 089 414 595), AUSTRAL-ASIA COAL HOLDINGS PTY LTD (ACN 113 038 663) and ICRA ASHTON PTY LTD (ACN 097 499 780) has been transferred to WHITE MINING (NSW) PTY LIMITED (ACN 089 414 595) and ICRA ASHTON PTY LTD (ACN 097 499 780). The transfer was registered on 14 November 2011.

(11-2875)

Mining Lease No. 1623 (Act 1992), formerly held by WHITE MINING (NSW) PTY LIMITED (ACN 089 414 595), AUSTRAL-ASIA COAL HOLDINGS PTY LTD (ACN 113 038 663) and ICRA ASHTON PTY LTD (ACN 097 499 780) has been transferred to WHITE MINING (NSW) PTY LIMITED (ACN 089 414 595) and ICRA ASHTON PTY LTD (ACN 097 499 780). The transfer was registered on 14 November 2011.

CHRIS HARTCHER, M.P.,  
Minister for Resources and Energy

---



## PRIMARY INDUSTRIES

### FISHERIES MANAGEMENT ACT 1994

#### Section 8 Notification – Fishing Closure

##### Australian Salmon

I, GEOFF ALLAN, Acting Executive Director, Fisheries NSW, with the delegated authority of the Minister for Primary Industries and the Director-General pursuant to sections 227 and 228 of the Fisheries Management Act 1994 (“the Act”) and pursuant to section 8 of the Act do by this notification prohibit the taking of the species of fish described in Column 1 of Schedule 1 to this notification, by all endorsement holders in the Ocean Hauling Fishery and the Estuary General Fishery, by the methods of fishing specified opposite in Column 2 of Schedule 1, from the waters described in Column 3 of Schedule 1, except when those fish are taken in accordance with the conditions specified in Schedule 2 to this notification.

#### SCHEDULE 1

<i>Column 1 Species</i>	<i>Column 2 Methods</i>	<i>Column 3 Waters</i>
Australian salmon	All methods other than set lines, hand held lines and drift lines and a landing net when used in conjunction with the above methods.	All waters north of a line drawn in a generally easterly direction from Barrenjoey Headland

#### SCHEDULE 2

Endorsement holders in the Ocean Hauling Fishery must not take or be in possession of, during any day or from the time of departure on a fishing trip to the time of return (if longer than a day), Australian salmon of more than the following amounts:

- (a) if lawfully taken by use of a hauling net (general purpose) – no more than 3,000 kg whole weight; or
- (b) if taken by use of any other net that may be lawfully used to take fish in the Ocean Hauling Fishery – no more than 50 kg whole weight.

Endorsement holders in the Estuary General Fishery must not take or be in possession of, during any day or from the time of departure on a fishing trip to the time of return (if longer than a day), more than 50 kg whole weight of Australian salmon taken using any net that may be lawfully used to take fish in the Estuary General Fishery.

In this notification:

“drift line” has the same meaning as in clause 2 of the Appendix to the Fisheries Management (Estuary General Share Management Plan) Regulation 2006.

“Estuary General Fishery” means the share management fishery of that name, as described in Schedule 1 to the Act.

“hand held line” means a rod and line or handline.

“landing net” has the same meaning as in clause 11A of the Appendix to the Fisheries Management (Supporting Plan) Regulation 2006.

“Ocean Hauling Fishery” means the share management fishery of that name, as described in Schedule 1 to the Act.

“set line” has the same meaning as in clause 2 of the Appendix to the Fisheries Management (Estuary General Share Management Plan) Regulation 2006.

“whole weight” means the weight of fish prior to any processing or removal of any part of the fish.

The provisions of this fishing closure in respect of endorsement holders in the Ocean Hauling Fishery have effect despite any provision in the Fisheries Management (Ocean Hauling Share Management Plan) Regulation 2006.

The provisions of this fishing closure in respect of endorsement holders in the Estuary General Fishery have effect despite any provision in the Fisheries Management (Estuary General Share Management Plan) Regulation 2006.

This fishing closure notification is effective from the date of publication in the *NSW Government Gazette* until 30 November 2016, unless sooner amended or revoked.

Dated this 18th day of November 2011.

DR GEOFF ALLAN,  
Acting Executive Director, Fisheries NSW,  
Department of Primary Industries  
(an office within the Department of Trade and  
Investment, Regional Infrastructure and Services)

### PLANT DISEASES (FRUIT FLY OUTBREAK AMENDMENT) ORDER 2011

under the Plant Diseases Act 1924

I, SATENDRA KUMAR, Director, Plant Biosecurity of the Department of Trade and Investment, Regional Infrastructure and Services, with the delegated authority of the Minister for Primary Industries in pursuance of section 3A of the Plant Diseases Act 1924 (“the Act”), and in pursuance of sections 3 (2) and 4 of the Act hereby revoke Plant Diseases (Fruit Fly Outbreak, Yanco NTN 2494) Order 2011 (Department reference O-332) dated 4 April 2011 and published in *NSW Government Gazette* No. 35 on 8 April 2011 at pages 2441-23445 and any other Order revived as a result of this revocation.

Dated this 21st of November 2011.

SATENDRA KUMAR,  
Director, Plant Biosecurity,  
Department of Trade and Investment, Regional  
Infrastructure and Services

Note: The Department’s reference is O-332R

## LANDS

## DUBBO CROWN LANDS OFFICE

45 Wingewarra Street (PO Box 1840), Dubbo NSW 2830

Phone: (02) 6883 3300 Fax: (02) 6884 2067

## REVOCATION OF RESERVATION OF CROWN LAND

PURSUANT to section 90 of the Crown Lands Act 1989, the reservation of Crown Land specified in Column 1 of the Schedule hereunder, is revoked to the extent specified opposite thereto in Column 2 of the Schedule.

KATRINA HODGKINSON, M.P.,  
Minister for Primary Industries

## SCHEDULE

Column 1	Column 2
Land District: Mudgee. Local Government Area: Mid-Western Regional Council. Locality: Windeyer. Reserve No.: 84815. Public Purpose: Future public requirements. Notified: 26 March 1964. File No.: 11/06330.	The whole being Lot 1, DP No. 722818, Parish Windeyer, County Wellington, of an area of 282 square metres.

Note: Sale of Land to Stephen Brian Kenyon.

APPOINTMENT OF ADMINISTRATOR TO  
MANAGE A RESERVE TRUST

PURSUANT to section 117, Crown Lands Act 1989, the person specified in Column 1 of the Schedules hereunder, is appointed as administrator for the term also specified, of the reserve trust specified opposite thereto in Column 2, which is trustee of the reserve referred to in Column 3 of the Schedules.

KATRINA HODGKINSON, M.P.,  
Minister for Primary Industries

## SCHEDULE 1

Column 1	Column 2	Column 3
Richard CHEWINGS.	Cudgegong River Park Trust.	Reserve No.: 84236. Public Purpose: Public recreation. Notified: 14 June 1963. File No.: DB80 R 65.

For a term commencing 29 November 2011 and expiring  
28 May 2012.

## SCHEDULE 2

Column 1	Column 2	Column 3
Richard CHEWINGS.	Lake Burrendong State Park Trust.	Dedication No.: 1001355. Public Purpose: Public recreation. Notified: 1 June 1997. File No.: DB97 R 4.

For a term commencing 29 November 2011 and expiring  
28 May 2012.

Note: This notice hereby revokes all previous appointments  
of administrators to manage the affairs of the Trusts  
specified in Column 2 in the Schedules above.

NOTICE OF INTENTION TO REVOKE (PART OF) A  
RESERVATION OF CROWN LAND

PURSUANT to section 90 (2) of the Crown Lands Act 1989, it is notified that the Minister administering the Crown Lands Act intends at the expiration of 14 days after the date of this notice to publish a notification in the *New South Wales Government Gazette* under section 90 (1) of that Act, revoking part of the following reservation of Crown Land.

Reserve No.: 756896.

Purpose: Future public requirements.

Notified: 29 June, 2007.

Locality: Mumbil, Parish of Mumbil, County of  
Wellington.

Comprised of: Lot 124 in DP 756896 of 4047 square  
metres.

Part Revoked: Lot 124 in DP 756896 of 4047 square  
metres.

File No.: DB07 H 6.

**GOULBURN OFFICE****159 Auburn Street (PO Box 748), Goulburn NSW 2580****Phone: (02) 4824 3700 Fax: (02) 4822 4287****ERRATUM**

AS per the notification of Correction of Defective Instrument which appeared in *New South Wales Government Gazette* dated 11 November 2011, Folio 6562, part of the description is hereby amended. The description the words "Lot 1, DP 1170084 (not being land under the Real Property Act)" is deleted and replaced with "Lot 1, DP 1170084 (not being land under the Real Property Act and subject to easement for right of carriageway 20.115 wide (A) created by Deposited Plan 1170084)".

File No.: 07/5880:BA.

**NOTIFICATION OF CLOSING OF A ROAD**

IN pursuance of the provisions of the Roads Act 1993, the road hereunder described is closed and the lands comprised therein cease to be public road and the rights of passage and access that previously existed in relation to the road is extinguished. Upon closing, title to the land, comprising the former public road, vests in the body specified in the Schedule hereunder.

KATRINA HODGKINSON, M.P.,  
Minister for Primary Industries

## Description

*Parish – Pomeroy; County – Argyle;  
Land District – Goulburn;  
L.G.A. – Upper Lachlan Shire Council*

Lot 1, DP 1170080 (not being land under the Real Property Act).

File No.: GB05 H 204:BA.

## Schedule

On closing, the title for the land in Lot 1, DP 1170080 remains vested in the State of New South Wales as Crown Land.

## Description

*Parish – Pomeroy; County – Argyle;  
Land District – Goulburn;  
L.G.A. – Upper Lachlan Shire Council*

Lot 2, DP 1170080 (not being land under the Real Property Act).

File No.: 10/05994:BA.

## Schedule

On closing, the title for the land in Lot 2, DP 1170080 remains vested in the State of New South Wales as Crown Land.

## Description

*Parish – Murringo; County – Monteagle;  
Land District – Young; L.G.A. – Young Shire Council*

Lot 1, DP 1169766 (not being land under the Real Property Act).

File No.: GB06 H 219:BA.

## Schedule

On closing, the title for the land in Lot 1, DP 1169766 remains vested in the State of New South Wales as Crown Land.

## Description

*Parish – Murringo; County – Monteagle;  
Land District – Young; L.G.A. – Young Shire Council*

Lot 2, DP 1169766 (not being land under the Real Property Act).

File No.: 10/00345:BA.

## Schedule

On closing, the title for the land in Lot 2, DP 1169766 remains vested in the State of New South Wales as Crown Land.

## Description

*Parish – Bombala; County – Wellesley;  
Land District – Bombala; L.G.A. – Bombala Council*

Lot 1, DP 1170572 (not being land under the Real Property Act).

File No.: GB07 H 272:BA.

## Schedule

On closing, the title for the land in Lot 1, DP 1170572 remains vested in the State of New South Wales as Crown Land.

**GRAFTON OFFICE**  
**76 Victoria Street (PO Box 272), Grafton NSW 2460**  
**Phone: (02) 6640 3400 Fax: (02) 6642 5375**

**PLAN OF MANAGEMENT FOR A CROWN  
 RESERVE UNDER DIVISION 6 OF PART 5 OF THE  
 CROWN LANDS ACT 1989 AND CROWN LANDS  
 REGULATION 2006**

A draft plan of management has been prepared for the Glenreagh Recreation Reserve described hereunder, which is under the trusteeship of the Glenreagh Public Recreation Reserve Trust.

The draft plan of management may be inspected during normal business hours at:

1. Grafton Crown Lands Office  
 Department of Primary Industries – Catchments & Lands,  
 76 Victoria Street, Grafton NSW;
2. Clarence Valley Council Chambers,  
 Civic Centre, Prince Street, Grafton NSW;
3. Glenreagh Post Office  
 Coramba Street, Glenreagh NSW.

The draft plan may also be viewed on the Crown Lands website: [www.crownland.nsw.gov.au](http://www.crownland.nsw.gov.au).

Representations in relation to the draft plan of management are invited from the public. These may be made in writing for a period of 28 days commencing 25 November 2011 and should be sent to the Senior Manager Crown Lands, Catchments & Lands, Department of Primary Industries, PO Box 272, Grafton NSW 2460.

KATRINA HODGKINSON, M.P.,  
 Minister for Primary Industries

Description of Reserve

*Land District – Grafton; Parish – Tallawudgah;  
 Local Government Area – Clarence Valley;  
 County – Fitzroy*

Reserve 81867, notified in the *New South Wales Government Gazette* of 21 August 1959 and comprising Lot 97, DP 752843 and Lot 1, DP 823625.

Location: Glenreagh NSW.

Public Purpose: Public recreation.

File No.: GF06 R 24.

**NOTIFICATION OF CLOSING OF ROAD**

IN pursuance of the provisions of the Roads Act 1993, the road hereunder described is closed and the land comprised therein ceases to be a public road and the rights of passage and access that previously existed in relation to the road are extinguished. On road closing, title to the land comprising the former public road vests in the body specified in the Schedule hereunder.

KATRINA HODGKINSON, M.P.,  
 Minister for Primary Industries

Description

*Land District – Grafton; L.G.A. – Clarence Valley*  
 Road Closed: Lot 1, DP 1169323 at Glenugie, Parish Lavadia, County Clarence.  
 File No.: 07/3088.

Schedule

On closing, the land within Lot 1, DP 1169323 remains vested in the State of New South Wales as Crown Land.

Description

*Land District – Grafton; L.G.A. – Clarence Valley*  
 Road Closed: Lot 1, DP 1169866 at Lawrence, Parish Lawrence, County Clarence.  
 File No.: 10/19147.

Schedule

On closing, the land within Lot 1, DP 1169866 remains vested in the State of New South Wales as Crown Land.

**ROADS ACT 1993**

ORDER

Transfer of a Crown Road to a Council

IN pursuance of the provisions of section 151, Roads Act 1993, the Crown roads specified in Schedule 1 is hereby transferred to the Roads Authority specified in Schedule 2 hereunder, as from the date of publication of this notice and as from the date, the road specified in Schedule 1, ceases to be Crown road.

KATRINA HODGKINSON, M.P.,  
 Minister for Primary Industries

SCHEDULE 1

*Parish – Newry; County – Raleigh;  
 Shire – Bellingen Shire Council*

Crown public road within Lot 236, DP 755552 at Urunga.

Width to be Transferred: Whole width.

SCHEDULE 2

Roads Authority: Bellingen Shire Council.

Council's Reference: DA 2011/AF-188.

LPMA Reference: 11/00891.

---

**GRIFFITH OFFICE**  
**2nd Floor, Griffith City Plaza,**  
**120–130 Banna Avenue (PO Box 1030), Griffith NSW 2680**  
**Phone: (02) 6960 3600 Fax: (02) 6962 5670**

**ERRATUM**

IN the notification appearing in the *New South Wales Government Gazette* No. 109 of 11 November 2011, Folio 6566, appearing under the heading of 'Reservation of Crown land' (Reserve 1032928), reference to Lots 7305-7306, DP 1155818, are in Parish of Warburn not Parish of Mirrool.

---

**HAY OFFICE****126 Lachlan Street (PO Box 182), Hay NSW 2711****Phone: (02) 6993 1800 Fax: (02) 6993 1135****ERRATUM**

IN the notice appearing in the *New South Wales Government Gazette* of the 17th September 2010, Folio 4553, under the heading of "APPOINTMENT OF TRUST BOARD MEMBERS" this notice should not have included Alen KRAUSE as described in Column 1 of Schedule 1 in regard to Trust Board Members for Reserve 57488 for Public Recreation.

File No.: HY81 R 118.

KATRINA HODGKINSON, M.P.,  
Minister for Primary Industries

---

## MAITLAND OFFICE

Corner Newcastle Road and Banks Street (PO Box 6), East Maitland NSW 2323

Phone: (02) 4937 9300 Fax: (02) 4934 2252

APPOINTMENT OF CORPORATION TO MANAGE  
RESERVE TRUST

PURSUANT to section 95 of the Crown Lands Act 1989, the corporation specified in Column 1 of the Schedule hereunder, is appointed to manage the affairs of the reserve trust specified opposite thereto in Column 2, which is trustee of the reserve referred to in Column 3 of the Schedule.

KATRINA HODGKINSON, M.P.,  
Minister for Primary Industries

## SCHEDULE

Column 1	Column 2	Column 3
Samaritans Foundation, Diocese of Newcastle.	Broadmeadow Community Purposes (R.170138) Reserve Trust.	Reserve No.: 170138. Public Purpose: Community purposes. Notified: 26 October 1990. File No.: MD90 R 37.

For a term commencing 25 November 2011.

## ASSIGNMENT OF NAME TO A RESERVE TRUST

PURSUANT to Clause 4(3) of Schedule 8 of the Crown Lands Act 1989, the name specified in Column 1 of the Schedules hereunder, is assigned to the reserve trust constituted as trustee of the reserve specified opposite thereto in Column 2 of the Schedules.

KATRINA HODGKINSON, M.P.,  
Minister for Primary Industries

## SCHEDULE 1

Column 1	Column 2
Wangi Wangi Public Recreation (R83203) Reserve Trust.	Reserve No.: 83203. Public Purpose: Public recreation. Notified: 2 June 1961. File No.: 11/06312.

## SCHEDULE 2

Column 1	Column 2
Whitebridge Public Recreation (R97735) Reserve Trust.	Reserve No.: 97735. Public Purpose: Public recreation. Notified: 15 March 1985. File No.: 11/06312.

## SCHEDULE 3

Column 1	Column 2
Wye Public Recreation (R86864) Reserve Trust.	Reserve No.: 86864. Public Purpose: Public recreation. Notified: 20 September 1968. File No.: 11/06312.

## SCHEDULE 4

Column 1	Column 2
Dungog Bush Fire Brigade (R210048) Reserve Trust.	Reserve No.: 210048. Public Purpose: Bush fire brigade purposes, local government purposes and state emergency services. Notified: 31 March 1988. File No.: 11/06312.

## SCHEDULE 5

Column 1	Column 2
Hillsborough Public Recreation (R91094) Reserve Trust.	Reserve No.: 91094. Public Purpose: Public recreation. Notified: 21 April 1978. File No.: 11/06312.

## SCHEDULE 6

Column 1	Column 2
Mayfield Public Recreation (R570093) Reserve Trust.	Public Park No.: 570093. Public Purpose: Public recreation. Notified: 30 August 1918. File No.: 11/06312.

## SCHEDULE 7

Column 1	Column 2
Tanilba Bay Public Recreation (R63324) Reserve Trust.	Reserve No.: 63324. Public Purpose: Public recreation. Notified: 6 May 1932. File No.: 11/06312.

## SCHEDULE 8

Column 1	Column 2
Fishermans Bay Residential Development by the Department of Housing (R170067) Reserve Trust.	Reserve No.: 170067. Public Purpose: Residential development by the department of housing. Notified: 30 October 1987. File No.: 11/06312.

## SCHEDULE 9

Column 1	Column 2
East Maitland Gas Works (R1000344) Reserve Trust.	Dedication No.: 1000344. Public Purpose: Site for gas works and addition. Notified: 7 April 1916. File No.: 11/06312.

**ROADS ACT 1993**

**ORDER**

Transfer of Crown Road to a Council

IN pursuance of the provisions of section 151, Roads Act 1993, the Crown road specified in Schedule 1 is transferred to the Roads Authority specified in Schedule 2 hereunder, as from the date of publication of this notice and as from that date, the road specified in Schedule 1 cease to be a Crown road.

**KATRINA HODGKINSON, M.P.,**  
Minister for Primary Industries

**SCHEDULE 1**

*Parish – Allandale; County – Northumberland;  
Land District – Maitland;  
Local Government Area – Cessnock*

Crown public road south of Lots 4121 and 4122, DP 861463 at Lovedale, as shown on the diagram hereunder.



**SCHEDULE 2**

Roads Authority: Cessnock City Council.  
File No.: 11/13063.

**ROADS ACT 1993**

**ORDER**

Transfer of Crown Road to a Council

IN pursuance of the provisions of section 151, Roads Act 1993, the Crown road specified in Schedule 1 is transferred to the Roads Authority specified in Schedule 2 hereunder, as from the date of publication of this notice and as from that date, the roads specified in Schedule 1 cease to be Crown road.

**KATRINA HODGKINSON, M.P.,**  
Minister for Primary Industries

**SCHEDULE 1**

*Parish – Cessnock; County – Northumberland;  
Land District – Maitland;  
Local Government Area – Cessnock*

Crown public road known as Evans Street, part Crown public road known as Quarrybylong Street and the Crown lane ways between Railway and Edgeworth Streets, Vincent

and Houston Streets, Houston and Oliver Streets and Oliver and Quarrybylong Streets at Cessnock, as shown on the diagram hereunder.



**SCHEDULE 2**

Roads Authority: Cessnock City Council.  
File No.: 10/14048.

**ROADS ACT 1993**

**ORDER**

Transfer of a Crown Road to a Council

IN pursuance of the provisions of section 151, Roads Act 1993, the Crown road specified in Schedule 1 is transferred to the Roads Authority specified in Schedule 2 hereunder, as from the date of publication of this notice and as from that date, the road specified in Schedule 1 ceases to be a Crown road.

**KATRINA HODGKINSON, M.P.,**  
Minister for Primary Industries

**SCHEDULE 1**

*Parish – Rothbury; County – Northumberland;  
Land District – Singleton;  
Local Government Area – Singleton*

Part Crown public road known as Mistletoe Lane, commencing from the eastern boundary of Lot 2, DP 113358 to a point 10 metres west of the south east corner of Lot 3, DP 626879 at Pokolbin, as shown on the diagram hereunder.

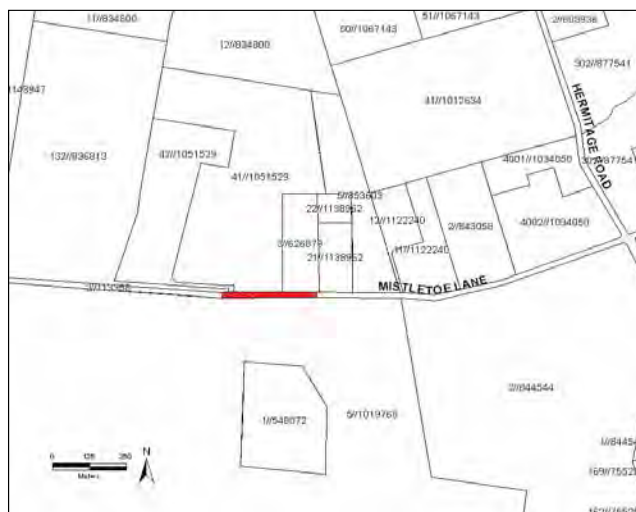



SCHEDULE 2

Roads Authority: Singleton Council.  
File No.: MD97 H 226.

**ROADS ACT 1993**

ORDER

Transfer of Crown Road to a Council

IN pursuance of the provisions of section 151, Roads Act 1993, the Crown road specified in Schedule 1 is transferred to the Roads Authority specified in Schedule 2 hereunder, as from the date of publication of this notice and as from that date, the roads specified in Schedule 1 cease to be Crown road.

KATRINA HODGKINSON, M.P.,  
Minister for Primary Industries

SCHEDULE 1

*Parish – Cessnock; County – Northumberland;  
Land District – Maitland;  
Local Government Area – Cessnock*

The Crown public roads known as Government Road and Anzac Avenue at Cessnock, as shown on the diagram hereunder.



SCHEDULE 2

Roads Authority: Cessnock City Council.  
File No.: 11/01445.

**DISSOLUTION OF RESERVE TRUST**

PURSUANT to section 92(3) of the Crown Lands Act 1989, the reserve trust specified in Column 1 of the Schedule hereunder, which was established in respect of the reserve specified opposite thereto in Column 2 of the Schedule, is dissolved.

KATRINA HODGKINSON, M.P.,  
Minister for Primary Industries

SCHEDULE

<i>Column 1</i>	<i>Column 2</i>
George Smith (R1033308) Reserve Trust.	Reserve No.: 1033308. Public Purpose: Public recreation. Notified: 30 September 2011. File No.: 10/16592.

## ERRATUM

IN the New South Wales Government Gazette of 23 November 1990, Folio's 10192, 10194, 10195, 10196, 10197 and 10204 under the heading "Assignment of Corporate Names to Reserve Trusts", in the Schedule for Maitland Lands Office, the following Reserves mentioned in Column "A"; the assigned Corporate Names in Column "C" and the "Trust Manager" shown in Column "D" were notified in error and are hereby cancelled by this notification.

KATRINA HODGKINSON, M.P.,  
Minister for Primary Industries

## SCHEDULE

<i>Column A</i>	<i>Column B</i>	<i>Column C</i>	<i>Column D</i>
62992.	Somersby.	Somersby Recreation Flora and Birds (R62292) Reserve Trust.	Gosford City Council.
63248.	Anna Bay.	Anna Bay Resting Place (R63248) Reserve Trust.	Port Stephens Council.
64357.	Peats Ridge.	Peats Ridge Recreation, Flora and water (R64357) Reserve Trust.	Gosford City Council.
64359.	Peats Ridge.	Peats Ridge Recreation and Flora (R64359) Reserve Trust.	Gosford City Council.
77779.	Swansea.	Swansea Public Hall (R77779) Reserve Trust.	Lake Macquarie City Council.
78506.	Morrisset.	Morrisset Recreation (R78506) Reserve Trust.	Lake Macquarie City Council.
80788.	Windale.	Windale Recreation (R80788) Reserve Trust.	Lake Macquarie City Council.
81784.	Merriwa.	Merriwa Recreation (R81784) Reserve Trust.	Merriwa Shire Council.
85894.	Kincumber.	Kincumber Recreation (R85894) Reserve Trust.	Gosford City Council.
86605.	Nelson Bay.	Nelson Bay Recreation (R86605) Reserve Trust.	Port Stephens Council.
170016.	Hexham.	Hexham Swamp (R170016) Reserve Trust.	The Shortland Wetlands Centre Limited.

## NEWCASTLE OFFICE

437 Hunter Street, Newcastle NSW 2300 (PO Box 2185, Dangar NSW 2309)

Phone: (02) 4925 4104 Fax: (02) 4925 3517

## NOTIFICATION OF CLOSING OF PUBLIC ROAD

IN pursuance of the provisions of the Roads Act 1993, the road hereunder described is closed and the land comprised therein ceases to be a public road and the rights of passage and access that previously existed in relation to the road are extinguished. On road closing, title to the land comprising the former public road vests in the body specified in the Schedule hereunder.

KATRINA HODGKINSON, M.P.,  
Minister for Primary Industries

## Description

*Parish – Wingen; County – Brisbane;  
Land District – Scone; L.G.A. – Upper Hunter*

Road Closed: Lot 1, DP 1168008 (not being land under the Real Property Act).

File No.: 08/2679.

## Schedule

On closing, the land within Lot 1, DP 1168008 remains vested in the State of New South Wales as Crown Land.

## Description

*Parish – Maudry; County – Forbes;  
Land District – Grenfell; L.G.A. – Weddin*

Road Closed: Lot 1, DP 1169026 (not being land under the Real Property Act).

File No.: CL/00411.

## Schedule

On closing, the land within Lot 1, DP 1169026 remains vested in the State of New South Wales as Crown Land.

## Description

*Parish – Sedgfield; County – Durham;  
Land District – Singleton; L.G.A. – Singleton*

Road Closed: Lot 1, DP 1168706 (not being land under the Real Property Act).

File No.: MD06 H 192.

## Schedule

On closing, the land within Lot 1, DP 1168706 remains vested in the State of New South Wales as Crown Land.

**NOWRA OFFICE**  
**5 O'Keefe Avenue (PO Box 309), Nowra NSW 2541**  
**Phone: (02) 4428 9100      Fax: (02) 4421 2172**

**NOTIFICATION OF CLOSING OF ROAD**

IN pursuance of the provisions of the Roads Act 1993, the road hereunder described is closed and the land comprised therein ceases to be public road and the rights of passage and access that previously existed in relation to the road are extinguished. On road closing, title to the land comprising the former public road vests in the body specified in the Schedule hereunder.

KATRINA HODGKINSON, M.P.,  
Minister for Primary Industries

Description

*Parish – Bombala; County – Wellesley;*  
*Land District – Bombala;*  
*Local Government Area – Bombala*

Road Closed: Lots 1, 2 and 3, DP 1168009 at Bombala.

File No.: GB07 H 172.

Schedule

On closing, the land within Lots 1, 2 and 3, DP 1168009 remains vested in the State of New South Wales as Crown Land.

**ORANGE OFFICE**  
**92 Kite Street (PO Box 2146), Orange NSW 2800**  
**Phone: (02) 6391 4300      Fax: (02) 6362 3896**

**ROADS ACT 1993**

**ORDER**

Transfer of Crown Road to Council

IN pursuance of the provisions of section 151, Roads Act 1993, the Crown public roads specified in Schedule 1 are transferred to the Roads Authority specified in Schedule 2 hereunder, as from the date of publication of this notice and as from that date, the roads specified in Schedule 1 cease to be Crown public roads.

KATRINA HODGKINSON, M.P.,  
Minister for Primary Industries

**SCHEDULE 1**

*Parish – Tabrabucca; County – Roxburgh;  
Land District – Rylstone*

A part of the Castlereagh Highway (shown in black as per diagram below).



**SCHEDULE 2**

Roads Authority: Mid-Western Regional Council.

Crown Lands Reference: 10/04167.

Council Reference: Castlereagh Highway, Lot 33, DP 1135745.

**ROADS ACT 1993**

**ORDER**

Transfer of Crown Road to Council

IN pursuance of the provisions of section 151, Roads Act 1993, the Crown public roads specified in Schedule 1 are transferred to the Roads Authority specified in Schedule 2 hereunder, as from the date of publication of this notice and as from that date, the roads specified in Schedule 1 cease to be Crown public roads.

KATRINA HODGKINSON, M.P.,  
Minister for Primary Industries

**SCHEDULE 1**

*Parish – Errol; County – Bathurst;  
Land District – Blayney; Town – Blayney*

Part of Athol Street (shown in black on diagram below).



**SCHEDULE 2**

Roads Authority: Blayney Shire Council.

Crown Lands Reference: 11/12926.

Council Reference: Athol Street, Blayney.

**SYDNEY METROPOLITAN OFFICE**  
**Level 12, Macquarie Tower, 10 Valentine Avenue, Parramatta 2150**  
**(PO Box 3935, Parramatta NSW 2124)**  
**Phone: (02) 8836 5300      Fax: (02) 8836 5365**

**APPOINTMENT OF CORPORATION TO MANAGE  
RESERVE TRUST**

PURSUANT to section 95 of the Crown Lands Act 1989, the corporation specified in Column 1 of the Schedule hereunder, is appointed to manage the affairs of the reserve trust specified opposite thereto in Column 2, which is trustee of the reserve referred to in Column 3 of the Schedule.

KATRINA HODGKINSON, M.P.,  
Minister for Primary Industries

SCHEDULE

<i>Column 1</i>	<i>Column 2</i>	<i>Column 3</i>
Girl Guides Association (New South Wales).	Warrimoo Boy Scouts (R88001) Reserve Trust.	Reserve No.: 88001. Public Purpose: Boy scouts. Notified: 18 December 1970. File No.: MN84 R 263.

For a term commencing the date of this notice.

**TAMWORTH OFFICE**  
**25-27 Fitzroy Street (PO Box 535), Tamworth NSW 2340**  
**Phone: (02) 6764 5100      Fax: (02) 6766 3805**

**NOTIFICATION OF CLOSING OF A ROAD**

IN pursuance to the provisions of the Roads Act 1993, the road hereunder specified is closed and the land comprised therein ceases to be a public road and the rights of passage and access that previously existed in relation to the road are extinguished.

KATRINA HODGKINSON, M.P.,  
Minister for Primary Industries

Description

*Locality – Weabonga; Land District – Tamworth;*  
*L.G.A. – Tamworth Regional*

Road Closed: Lot 1 in Deposited Plan 1169699, Parish Walcha, County Parry.

File No.: 07/5743.

Note: On closing, title to the land comprised in Lot 1 will remain vested in the State of New South Wales as Crown Land.

Description

*Locality – Barraba; Land District – Tamworth;*  
*L.G.A. – Tamworth Regional*

Road Closed: Lots 1 and 2 in Deposited Plan 1169709, Parishes Tiabundie and North Barraba, County Darling.

File No.: 07/1747.

Note: On closing, title to the land comprised in Lot 1 will remain vested in the State of New South Wales as Crown Land.

**WAGGA WAGGA OFFICE****Corner Johnston and Tarcutta Streets (PO Box 60), Wagga Wagga NSW 2650****Phone: (02) 6937 2700 Fax: (02) 6921 1851****NOTIFICATION OF CLOSING OF A ROAD**

IN pursuance of the provisions of the Roads Act 1993, the road hereunder described is closed, and the land comprised therein ceases to be a public road and the rights of passage and access that previously existed in relation to the road are extinguished. On road closing, title to the land comprising the former public road vests in the body specified in the Schedule hereunder

KATRINA HODGKINSON, M.P.,  
Minister for Primary Industries

## Description

*Parish – Yathong South; County – Urana;  
Land District – Deniliquin; L.G.A. – Jerilderie*

Lot 4, DP 1129671 at Jerilderie.

File No.: HY87 H 63.

## Schedule

On closing, the land within Lot 4, DP 1129671 remains vested in the State of New South Wales as Crown Land.

## Description

*Parish – Ashcroft; County – Mitchell;  
Land District – Wagga Wagga; L.G.A. – Lockhart*

Lots 1 and 2, DP 1168493 at Milbrulong.

File No.: 10/09908.

## Schedule

On closing, the land within Lots 1 and 2, DP 1168493 remains vested in the State of New South Wales as Crown Land.

## Description

*Parish – Munyabla; County – Urana;  
Land District – Urana; L.G.A. – Lockhart*

Lot 1, DP 1162106 at Ryan.

File No.: WA05 H 398.

## Schedule

On closing, the land within Lot 1, DP 1162106 remains vested in the State of New South Wales as Crown Land.



**WESTERN REGION OFFICE**  
**45 Wingewarra Street (PO Box 1840), Dubbo NSW 2830**  
**Phone: (02) 6883 3000 Fax: (02) 6883 3099**

**ALTERATION OF PURPOSE/CONDITIONS OF A  
WESTERN LANDS LEASE**

IT is hereby notified that in pursuance of the provisions of section 18J, Western Lands Act 1901, the purpose and conditions of the undermentioned Western Lands Lease have been altered as shown.

KATRINA HODGKINSON, M.P.,  
Minister for Primary Industries

*Administrative District – Cobar; Shire – Cobar;  
Parish of Beauport; County of Blaxland;  
Parish of Meldior; County of Blaxland*

The purpose/conditions of Western Lands Lease 10393, being the land contained within Folio Identifier 4365/767202 respectively has been altered from “Grazing” to “Grazing and Cultivation (Dryland)” effective from 23 November, 2011.

As a consequence of the alteration of purpose and conditions rent will be assessed annually in line with the Western Lands Act 1901 and Regulations.

The conditions previously annexed to Western Lands Lease 10393 have been revoked and the following conditions have been annexed thereto.

**CONDITIONS AND RESERVATIONS ATTACHED TO  
WESTERN LANDS LEASE No. 10393**

- (1) In the conditions annexed to the lease, the expression “the Minister” means the Minister administering the Western Lands Act 1901, and any power, authority, duty or function conferred or imposed upon the Minister by or under those conditions may be exercised or performed either by the Minister or by such officers of the Department of Primary Industries as the Minister may from time to time approve.
- (2) In these conditions and reservations the expression “the Commissioner” means the Commissioner charged with the administration of the Western Lands Act 1901 (“the Act”) in accordance with section 4(2) of the Act.
- (3) (a) For the purposes of this clause the term Lessor shall include Her Majesty the Queen Her Heirs and Successors the Minister and the agents servants employees and contractors of the Lessor Her Majesty Her Majesty’s Heirs and Successors and the Minister.  
 (b) The lessee covenants with the Lessor to indemnify and keep indemnified the Lessor from and against all claims for injury loss or damage suffered by any person or body using or being in or upon the Premises or any adjoining land or premises of the Lessor arising out of the Holder’s use of the Premises and against all liabilities for costs charges and expenses incurred by the Lessor in respect of the claim of any such person or body except to the extent that any such claims and demands arise wholly from any negligence or wilful act or omission on the part of the Lessor.  
 (c) The indemnity contained in this clause applies notwithstanding that this Lease authorised or required the lessee to undertake or perform the activity giving rise to any claim for injury loss or damage.
- (d) The lessee expressly agrees that the obligations of the Holder under this clause shall continue after the expiration or sooner determination of this Lease in respect of any act deed matter or thing occurring before such expiration or determination.
- (4) The rent of the lease shall be assessed in accordance with Part 6 of the Western Lands Act 1901.
- (5) The rent shall be due and payable annually in advance on 1 July in each year.
- (6) (a) “GST” means any tax on goods and/or services, including any value-added tax, broad-based consumption tax or other similar tax introduced in Australia.  
 “GST law” includes any Act, order, ruling or regulation, which imposes or otherwise deals with the administration or imposition of a GST in Australia.  
 (b) Notwithstanding any other provision of this Agreement:
  - (i) If a GST applies to any supply made by either party under or in connection with this Agreement, the consideration provided or to be provided for that supply will be increased by an amount equal to the GST liability properly incurred by the party making the supply.
  - (ii) If the imposition of a GST or any subsequent change in the GST law is accompanied by or undertaken in connection with the abolition of or reduction in any existing taxes, duties or statutory charges (in this clause “taxes”), the consideration payable by the recipient of the supply made under this Agreement will be reduced by the actual costs of the party making the supply that are reduced directly or indirectly as a consequence of the abolition of or reduction in taxes.
- (7) The lessee must pay all rates and taxes assessed on or in respect of the land leased during the currency of the lease.
- (8) The lessee must hold and use the land leased bona fide for the lessee’s own exclusive benefit and must not transfer, convey or assign the land or any portion thereof without having first obtained the written consent of the Minister.
- (9) The lessee must not enter into a sublease of the land leased unless the sublease specifies the purpose for which the land may be used under the sublease, and it is a purpose which is consistent with the purpose for which the land may be used under this lease.
- (10) If the lessee enters into a sublease of the land leased, the lessee must notify the Commissioner of the granting of the sublease within 28 days after it is granted.
- (11) The land leased must be used only for the purpose of Grazing & Cultivation (Dryland).

- (12) The lessee must maintain and keep in reasonable repair all improvements on the land leased during the currency of the lease and shall permit the Minister or the Commissioner or any person authorised by the Minister or the Commissioner at all times to enter upon and examine the whole or any part of the land leased and the buildings or other improvements thereon.
- (13) The lessee must not remove or permit any person to remove gravel, stone, clay, shells or other material for the purpose of sale from the land leased unless the lessee or the person is the holder of a quarry license under regulations made under the Crown Lands Act 1989 or, in respect of land in a State forest, unless the lessee or the person is the holder of a forest materials licence under the Forestry Act 1916, and has obtained the special authority of the Minister to operate on the land, but the lessee may, with the approval of the Commissioner, take from the land such gravel, stone, clay, shells or other material for building and other purposes upon the land as may be required by the lessee.
- (14) The lessee must not erect or permit any person to erect any buildings or extend any existing buildings on the land leased except to the satisfaction of the Commissioner.
- (15) The lessee must ensure that the land leased is kept in a neat and tidy condition to the satisfaction of the Commissioner and not permit refuse to accumulate on the land.
- (16) Upon termination or forfeiture of the lease the Commissioner may direct that the former lessee remove any structure or material from the land at his own cost and without compensation. Where such a direction has been given the former lessee must leave the land in a clean and tidy condition free from rubbish and debris.
- (17) The lessee must, within 1 year from the date of commencement of the lease or such further period as the Commissioner may allow, enclose the land leased, either separately or conjointly with other lands held in the same interest, with a suitable fence to the satisfaction of the Commissioner.
- (18) The lessee must not obstruct or interfere with any reserves, roads or tracks on the land leased, or the lawful use thereof by any person.
- (19) The lessee must erect gates on roads within the land leased when and where directed by the Commissioner for public use and must maintain those gates together with approaches thereto in good order to the satisfaction of the Commissioner.
- (20) The right is reserved to the public of free access to, and passage along the bank of any watercourse adjoining the land leased and the lessee must not obstruct access or passage by any member of the public to or along the bank.
- (21) The Crown shall not be responsible to the lessee or the lessee's successors in title for provision of access to the land leased.
- (22) The lessee must comply with requirements of section 18DA of the Western Lands Act 1901 which provides that except in circumstances referred to in subsection (3) of that section, cultivation of the land leased or occupied may not be carried out unless the written consent of the Authority has first been obtained and any condition to which the consent is subject under sub section (6) is complied with.
- (23) The lessee must, as the Commissioner may from time to time direct, foster and cultivate on the land leased such edible shrubs and plants as the Commissioner may consider can be advantageously and successfully cultivated.
- (24) Whenever so directed by the Commissioner, the lessee must, on such part or parts of the land leased as shall be specified in the direction, carry out agricultural practices, or refrain from agricultural practices, of such types and for such periods as the Commissioner may in the direction specify.
- (25) The lessee must, if the Commissioner so directs, prevent the use by stock of any part of the land leased for such periods as the Commissioner considers necessary to permit of the natural reseeded and regeneration of vegetation and, for that purpose, the lessee must erect within the time appointed by the Commissioner such fencing as the Commissioner may consider necessary.
- (26) The lessee must furnish such returns and statements as the Commissioner may from time to time require on any matter connected with the land leased or any other land (whether within or outside the Western Division) in which the lessee has an interest.
- (27) The lessee must, within such time as may be specified by the Commissioner take such steps and measures as the Commissioner shall direct to destroy vermin and such animals and weeds as may, under any Act, from time to time be declared (by declaration covering the land leased) noxious in the Gazette and must keep the land free of such vermin and noxious animals and weeds during the currency of the lease to the satisfaction of the Commissioner.
- (28) The lessee must ensure that cultivation and associated activities do not interfere with any road formation within the allowable area.
- (29) Access tracks to the area to be cultivated must be arranged in such a manner as to minimise the disturbance of any land surfaces within the areas required to be left uncultivated to comply with the conditions of this consent.
- (30) The lessee must ensure incised drainage lines, other than manmade structures which carry water after storms are left uncultivated in the channels and for a distance of at least 20 metres on either side of the banks of the channels, except when the Commissioner specifies otherwise.
- (31) The lessee must establish windbreaks at his/her own expense as may be ordered by Commissioner to provide adequate protection of the soil.
- (32) The lessee must undertake any fuel management and/or provision of fire trail access in accordance with fire mitigation measures to the satisfaction of the NSW Rural Fire Service.
- (33) The lessee must undertake any appropriate measures, at his/her own expense, ordered by the Commissioner to rehabilitate any degraded cultivated areas.

- (34) The lessee must ensure stubble is retained on the soil surface and must not be burnt, except with the approval of the Commissioner or his delegate. Where such approval is granted, stubble burning is to be carried out as per requirements of the NSW Rural Fire Service.
- (35) The lessee must ensure that sand hills and other soils with a surface texture of loamy sand or coarser are left uncultivated unless specifically approved by the commissioner.
- (36) The lessee must ensure that areas with a slope greater than 2% remain uncultivated until any soil conservation measures documented in a plan approved by the Commissioner have been implemented at the lessee's expense.
- (37) The lessee must ensure that land within 60 metres of any texture contrast or duplex soil area remains uncultivated except in accordance with a plan approved by the Commissioner. Texture contrast (or duplex) soils are soil types which have sandy to loamy topsoil abruptly overlying a clay subsoil and are prone to scalding (producing clay pans and hummocks).
- (38) The lessee must only dryland cultivate an area of 2196 ha shown hatched on the diagram hereunder. Cultivation is permitted over the whole areas shown hatched, unless the Commissioner has required that specific areas remain uncultivated.

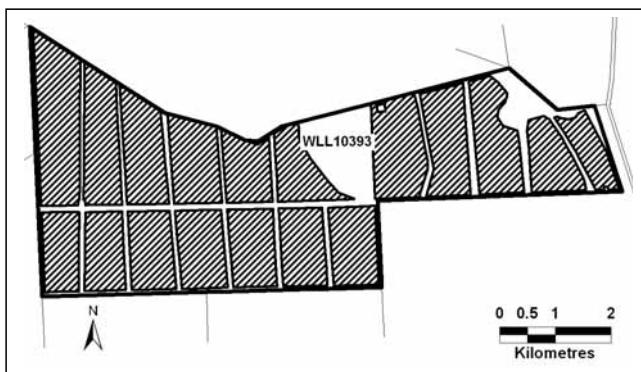

## WATER

### WATER ACT 1912

AN application for a licence under section 10 of Part 2 of the Water Act 1912, as amended, has been received as follows:

ENDEAVOUR COAL PTY LTD for an existing concrete overshot dam and pump on Brennans Creek, Lot 7318, DP 1164103 (Consolidated Coal Lease 724), Parish of Wedderburn, County of Cumberland, for the conservation of water and water supply for mining purposes (replacement licence – replacing 10SL038404) (no amendment to works – increase in an annual entitlement from 1100.0 megalitres to 2750.0 megalitres) (application will be subject to flow conditions as set out in the West Cliff CCP Water Management Plan). (Reference: 10SL057072). (GA1822209).

Any inquiries should be directed to (02) 8838 7531.

Written objections from any local occupier or statutory authority, specifying grounds and how their interests are affected, must be lodged with the NSW Office of Water, PO Box 3720, Parramatta NSW 2124, within 28 days of this publication.

WAYNE CONNERS,  
Senior Licensing Officer

---

### WATER ACT 1912

APPLICATIONS under Part 8 of the Water Act 1912, being within a proclaimed (declared) local area under section 5 (4) of the Water Act 1912, for approval of controlled works under section 167 has been received as follows:

LACHLAN EDWARD and KATHRINE EMMA JAMES for controlled works consisting of an Earthen Levee on the Liverpool Plain Floodplain on Lot 6, DP 47187, Parish of Curlewis, County of Pottinger, on the property known as “Marriot Park” for prevention of inundation of land by floodwater (new approval). (Reference: 90CW810992). (GA1822210).

NOEL MARK and KERRY LEE SWAIN for controlled works consisting of supply and tailwater channels on the Liverpool Plain Floodplain on Lots 66-67 and 125-126, DP 751007 and Lot 1, DP 409700, Parish of Carroll, County of Inglis, on the property known as ‘Aminya’ for irrigation development on the floodplain (new approval). (Reference: 90CW810993). (GA1822211).

Any inquiries should be directed to (02) 6799 6621.

Written objections from any local occupier or statutory authority, specifying grounds and how their interests are affected, must be lodged with the NSW Office of Water, PO Box 382, Narrabri NSW 2390, within 28 days of this publication.

ROBERT ALBERT,  
Licensing Officer

### WATER ACT 1912

APPLICATIONS for an Approval of a Controlled Work under section 167 (1), Part 8 of the Water Act 1912, being within a proclaimed (declared) local area under section 5 (4) of the said Act, has been received as follows:

Gregory Gordon LAWRENCE and Nigel LAWRENCE for an existing earthen levee and a proposed earthen levee adjacent Stephens Creek, Lot 243//760922 and Lot 246//760925, Parish of Mount Gipps, County of Yancowinna, for prevention of land from inundation by floodwaters. (Reference: 60CW807614). (GA1822214).

WESTERN MURRAY IRRIGATION LTD, Frank MARTIN, Helen MARTIN and Janice HARRIS for an existing earthen levee part replacing Approval 60CW800791 and an existing earthen levee (access road to Buronga pump station) adjacent the Murray River, part Lot 1//616588, part Lot 1//1167087, part Lot 1//853492 and part Lot 2//1105000, Parish of Mourquong, County of Wentworth, for prevention of land from inundation by floodwaters. (Reference: 60CW807615) (GA1822216).

Any inquiries should be directed to (03) 5051 6200.

Written objections from any local occupier or statutory authority, specifying grounds and how their interests are affected, must be lodged with the NSW Office of Water PO Box 363, Buronga NSW 2739, within 28 days of this publication.

PETER WINTON,  
Licensing Officer

## Other Notices

### ASSOCIATIONS INCORPORATION ACT 2009

Reinstatement of Cancelled Association Pursuant to Section 84

TAKE notice that the incorporation of ACCELERATE PACIFIC LEARNING INCORPORATED (Inc9883138) cancelled on 9 September 2011 is reinstated pursuant to section 84 of the Associations Incorporation Act 2009.

Dated this 18th day of November 2011.

ROBYNE LUNNEY,  
A/Manager, Case Management,  
Registry of Co-operatives & Associations,  
NSW Fair Trading,  
Department of Finance & Services

Greenwell Point Meals on Wheels Incorporated – Y2562225

Mid Mountains Historical Society Incorporated – Inc9876587

Institute of Counselling Incorporated – Y2499638

St George's Association (Sydney) Inc – Y1121221

Birth Choices Incorporated – Inc9893936

WGNSW Incorporated – Y0442103

Wenty Estate Sports Project Incorporated – Inc9890129

Freight and Logistics Council of New South Wales Incorporated – Inc9890259

Upper Hunter Tennis Association Incorporated – Y2195714

Dated 21st day of November 2011.

ROBYNE LUNNEY,  
A/Manager, Case Management,  
Registry of Co-operatives & Associations,  
NSW Fair Trading,  
Department of Finance & Services

### ASSOCIATIONS INCORPORATION ACT 2009

Reinstatement of Cancelled Association Pursuant to Section 84

TAKE notice that the incorporation of KOREAN CULTURAL CENTRE INCORPORATED – Y2996230 cancelled on 4 April 2008 is reinstated pursuant to section 84 of the Associations Incorporation Act 2009.

Dated this 22nd day of November 2011.

ROBYNE LUNNEY,  
A/Manager, Case Management,  
Registry of Co-operatives & Associations,  
NSW Fair Trading,  
Department of Finance & Services

### CO-OPERATIVES ACT 1992

Notice Under Section 601AC of the Corporations Act 2001 as Applied by Section 325 of the Co-Operatives Act 1992

NOTICE is hereby given that the co-operative mentioned below will be deregistered when three months have passed since the publication of this notice:

EDGE Beef Co-operative Limited

Dated this 17th day of November 2011 at Bathurst.

R. LUNNEY,  
Delegate of the Registrar of Co-Operatives

### ASSOCIATIONS INCORPORATION ACT 2009

Cancellation of Incorporation Pursuant to Section 72

TAKE notice that the incorporation of the following associations is cancelled by this notice pursuant to section 72 of the Associations Incorporation Act 2009.

Cancellation is effective as at the date of gazettal.

Community Independence Support Services  
Incorporated – Y1830724

Midwest Community Care Inc – Y0415302

Trinity Basketball Club Incorporated – Inc9887900

Cape Byron Canoe Club Inc – Y0047206

Opera South Incorporated – Inc9877066

Illawarra Breast Cancer Support Group Incorporated  
– Inc9883847

Talent Enrichment Project Incorporated – Inc9893114

Bowen Therapists Association of NSW and ACT Inc.  
– Inc2955002

Helensburgh & District News Incorporated –  
Inc9878152

Bradfield Park Pre-School and Child Care Centre Inc  
– Y0545138

South Grafton Ex-Servicemens Bowling Club  
Incorporated – Inc9891308

### CHILDREN (PROTECTION AND PARENTAL RESPONSIBILITY) ACT 1997

Safer Community Compact – Order

I, the Honourable Greg Smith, S.C., Attorney General and Minister for Justice of the State of New South Wales, in pursuance of section 39 (1) of the Children (Protection and Parental Responsibility) Act 1997, do, by this my Order, approve Cobar Shire Council's Crime Prevention Plan as a Safer Community Compact for the purposes of Division 3 of Part 4 of that Act.

This Order takes effect on 1 December 2011 remaining in force until 5 December 2014.

Signed at Sydney, this 11th day of November 2011.

GREG SMITH, M.P.,  
Attorney General and Minister for Justice

**CHILDREN (PROTECTION AND PARENTAL RESPONSIBILITY) ACT 1997**

Safer Community Compact – Order

I, the Honourable Greg Smith, S.C., Attorney General and Minister for Justice of the State of New South Wales, in pursuance of section 39 (1) of the Children (Protection and Parental Responsibility) Act 1997, do, by this my Order, approve Kempsey Council's Crime Prevention Plan as a Safer Community Compact for the purposes of Division 3 of Part 4 of that Act.

This Order takes effect on 1 December 2011 remaining in force until 5 December 2014.

Signed at Sydney, this 11th day of November 2011.

GREG SMITH, M.P.,  
Attorney General and Minister for Justice

**CHILDREN (PROTECTION AND PARENTAL RESPONSIBILITY) ACT 1997**

Safer Community Compact – Order

I, the Honourable Greg Smith, S.C., Attorney General and Minister for Justice of the State of New South Wales, in pursuance of section 39 (1) of the Children (Protection and Parental Responsibility) Act 1997, do, by this my Order, approve Port Macquarie-Hastings Council's Crime Prevention Plan as a Safer Community Compact for the purposes of Division 3 of Part 4 of that Act.

This Order takes effect on 1 December 2011 remaining in force until 5 December 2014.

Signed at Sydney, this 11th day of November 2011.

GREG SMITH, M.P.,  
Attorney General and Minister for Justice

**ENERGY AND UTILITIES ADMINISTRATION ACT 1987**

Energy and Utilities Administration (Energy Contributions) Order 2011

I, The Hon. ROBYN PARKER, M.P., Minister for the Environment, with the concurrence of The Hon. CHRIS HARTCHER, M.P., Minister for Resources and Energy and The Hon. MIKE BAIRD, M.P., Treasurer, make the following Order under section 34J of the Energy and Utilities Administration Act 1987.

This Order takes effect on the date that it is published in the *NSW Government Gazette*.

Dated at Sydney, this 22nd day of November 2011.

ROBYN PARKER, M.P.,  
Minister for the Environment

Explanatory note

Section 34J of the Energy and Utilities Administration Act 1987 provides that the Minister may, by order published in the *NSW Government Gazette*, require any one or more distribution network service providers to make an annual contribution for a specified financial year to the Climate Change Fund. The purpose of this Order is to require defined

distribution network service providers to make an annual contribution to the Climate Change Fund for the financial year commencing 1 July 2011.

1. Name of Order

This Order is the Energy and Utilities Administration (Energy Contributions) Order 2011.

2. Commencement

This Order commences on the date that it is published in the *NSW Government Gazette*.

3. Interpretation

The Explanatory Note to this Order does not form part of the Order.

4. Definitions

**distribution network service provider** means a distribution network service provider listed in column 1 of Schedule 1.

5. Annual contribution

- (1) A distribution network service provider is required to make an annual contribution to the Climate Change Fund for the financial year commencing 1 July 2011.
- (2) The amount of the annual contribution to be paid by a distribution network service provider is as set out in column 2 of Schedule 1.

6. Time for payment

The annual contribution is to be paid in three instalments (each being equal to one-third of the annual contribution payable) on or before the first day of December 2011, February 2012 and April 2012.

SCHEDULE 1

<i>Column 1</i>	<i>Column 2</i>
Distribution network service provider	Annual contribution
Ausgrid	\$71,012,219
Endeavour Energy	\$44,683,536
Essential Energy	\$34,753,861

**POISONS AND THERAPEUTIC GOODS ACT 1966**

Order Under Clause 175 (1),  
Poisons and Therapeutic Goods Regulation 2008

Withdrawal of Drug Authority

IN accordance with the provisions of clause 175 (1) of the Poisons and Therapeutic Goods Regulation 2008 an Order has been made on ANN-MAREE SWEENEY, (NMW0001295800), 332 Cleveland Street, Surry Hills NSW 2010, prohibiting her until further notice, as a nurse from having possession of and supplying drugs of addiction as authorised by clauses 101 and 103 of the Regulation.

This Order is to take effect on and from 23 November 2011.

Dated at Sydney, 16 November 2011.

Dr MARY FOLEY,  
Director-General,  
NSW Ministry of Health

**SYDNEY WATER CATCHMENT MANAGEMENT  
ACT 1998**

Notice Under Section 38 (5)

Execution of Revised Memorandum of Understanding  
Between the Sydney Catchment Authority and  
the Environment Protection Authority

THE Sydney Water Catchment Management Act 1998 requires the Sydney Catchment Authority to enter into a Memorandum of Understanding with the Environment Protection Authority.

Following public exhibition from 6 July to 4 August 2011, a revised Memorandum of Understanding has now been executed. The MoU can be viewed at [www.sca.nsw.gov.au](http://www.sca.nsw.gov.au).

MICHAEL BULLEN,  
Chief Executive

---

# PRIVATE ADVERTISEMENTS

## COUNCIL NOTICES

### THE HILLS SHIRE COUNCIL

Roads Act 1993, Section 10

NOTICE is hereby given that The Hills Shire Council dedicates the land described in the Schedule below as public road under section 10 of the Roads Act 1993. GENERAL MANAGER, The Hills Shire Council, 129 Showground Road, Castle Hill NSW 2154.

#### SCHEDULE

All that piece or parcel of land known as Lot 38 in DP 855997 in The Hills Shire Council, Parish of Castle Hill, County of Cumberland and as described in Folio Identifier 38/855997. [6202]

### LIVERPOOL CITY COUNCIL

Roads Act 1993 – Section 162

Naming of Public Roads

NOTICE is hereby given that Liverpool City Council in pursuance of section 162 of the Roads Act 1993 and the Roads (General) Regulation has resolved to name the unnamed roads listed below within the suburb of Elizabeth Hills:

Antrim Drive	Bentwing Avenue
Braford Avenue	Brahman Lane
Burlina Circuit	Charbray Lane
Charolais Avenue	Corduroy Road
Dobroyd Drive	Duxford Street
Eber Avenue	Freetail Avenue
Gowanlea Avenue	Hertfordshire Street
Jenkinson Drive	Montadale Avenue
Newgate Boulevard	Nelore Avenue
Poplar Avenue	Pye Road
Regentville Drive	Rosebank Avenue
Setrop Avenue	Sherrard Avenue
Simbrah Lane	Varney Avenue
Vermont Avenue	Vidal Avenue
Wixstead Avenue	Wylde Close

FAROOQ PORTELLI, General Manager, Liverpool City Council, Locked Bag 7064, Liverpool BC NSW 1871.

[6203]

### MAITLAND CITY COUNCIL

Naming of Public Roads

NOTICE is hereby given that Maitland City Council, in pursuance of section 162 of the Roads Act 1993 and Part 2 of The Roads (General) Regulation 2000, has approved the following new road name/s for gazettal:

<i>Deposited Plan/Location</i>	<i>Road Name</i>
DP 1167029, off Cessnock Road, Gillieston Heights.	Yew Street, Pine Street, Oak Circuit, Redwood Drive, Juniper Street, Camelia Street, Pear Street, Chestnut Avenue, Lime Street,

*Deposited Plan/Location*

*Road Name*

Quince Street,  
Acmena Street,  
Dogwood Street,  
Fir Street,  
Medlar Circuit,  
Mulberry Street,  
Sorbus Way,  
Tangerine Street,  
Aspen Drive,  
Banyan Circuit  
and Apple Street.

The above road names have been advertised and notified. No objections to the proposed names have been received during the prescribed 28 day period. DAVID EVANS, General Manager, Maitland City Council, High Street (PO Box 220), Maitland NSW 2320. [6204]

### PENRITH CITY COUNCIL

Erratum

PURSUANT to Clause 9 of the Roads Regulation 2008, the following notice replaces the one advertised on page 5124, of the New South Wales Government Gazette No. 78, dated 29 July 2011.

#### *Road Name Changes in Jordan Springs*

Rowland Street is now known as Rowland Place (which replaced Thomas Place) Jordan Springs  
Governor Street replaced Rowland Street Jordan Springs  
Scarlet Street is now known as Crimson Street Jordan Springs  
Tyler Street is now known as Sturt Street Jordan Springs.

For further information please contact The General Manager, Mr ALAN STONEHAM, Penrith City Council on (02) 4732 7777. [6205]

### QUEANBEYAN CITY COUNCIL

Section 162, Roads Act 1993

Naming of Public Roads

PURSUANT to section 162 (1) Council has assigned the following street names as described below:

Description:

**BUNGENDORE ROAD** – Changing the point at which Bungendore Road finishes. Bungendore Road's eastern extent now ends at its junction with Thurrallilly Street. The section which wound its way around the northern side of Bungendore Hill has now been closed and the surface ripped. The intention is to re-landscape the road reserve and make it available as walking trail in the future.

**KINGS HIGHWAY** – Now commences at its intersection with Thurrallilly Street travelling along the new road alignment in an easterly direction until it rejoins the existing Kings Highway road alignment approximately 830 metres from its starting point.



HILL LANE – A small cul-de-sac created by the dissection and truncation of Bungendore Road at its former eastern end. Hill Lane now intersects with the new portion of the Kings Highway.

GARY CHAPMAN, General Manager, Queanbeyan City Council, PO Box 90, Queanbeyan NSW 2620. [6206]

### SHELLHARBOUR CITY COUNCIL

Roads Act 1993, Section 162

Naming of Public Roads

UNDER section 162 of the Roads Act 1993, Shellharbour City Council has named the following roads:

<i>Location</i>	<i>Name</i>
Tullimbar.	Mittagong Street and Wingello Crescent.

Authorised by Shellharbour City Council on 11 November 2011. MICHAEL WILLIS, General Manager, Shellharbour City Council, Locked Bag 155, Shellharbour City Centre NSW 2529. [6207]

### TUMUT SHIRE COUNCIL

Local Government Act 1993

Land Acquisition (Just Terms Compensation) Act 1991

Notice of Compulsory Acquisition of Land

TUMUT SHIRE COUNCIL declares with the approval of Her Excellency the Governor that the easements described in Schedule 1 below, excluding the interest described in Schedule 2 below and excluding any mines or deposits of minerals in the easements, are acquired by compulsory process in accordance with the provisions of the Land Acquisition (Just Terms Compensation) Act 1991, for access and obstacle lighting stations. Dated at Tumut, this 22nd day of November 2011. R. K. STEWART, General Manager, Tumut Shire Council, 76 Capper Street, Tumut NSW 2720.

#### SCHEDULE 1

Right of access over track shown as “G” in DP 1164537.

Easement for Light Station 15 wide shown as “H” in DP 1164537.

Right of access of track shown as “G” in DP 1164545.

Easement for Light Station 15 wide shown as “H” in DP 1164545.

#### SCHEDULE 2

Easement for Transmission Line 30.48 wide shown as “E” in DP 1164545. [6208]

### TUMUT SHIRE COUNCIL

Roads Act 1993

Land Acquisition (Just Terms Compensation) Act 1991

Notice of Compulsory Acquisition of Land

TUMUT SHIRE COUNCIL declares with the approval of her Excellency the Governor that the lands described in the Schedule below, excluding any mines or deposits of minerals in the land, are acquired by compulsory process in accordance with the provisions of the Land Acquisition (Just

Terms Compensation) Act 1991, for road widening. Dated at Tumut, this 22nd day of November 2011. R. K. STEWART, General Manager, Tumut Shire Council, 76 Capper Street, Tumut NSW 2720.

#### SCHEDULE

Lots 32 and 33, DP 1164540. [6209]

### WINGECARRIBEE SHIRE COUNCIL

Local Government Act 1993

Land Acquisition (Just Terms Compensation) Act 1991

Notice of Compulsory Acquisition of Land

WINGECARRIBEE SHIRE COUNCIL declares, with the approval of Her Excellency the Governor, that the lands and easements described in the Schedule below, excluding any mines or deposits of minerals in the lands, are acquired by compulsory process in accordance with the provisions of the Land Acquisition (Just Terms Compensation) Act 1991, for water supply purposes. Dated at Moss Vale, this 1st day of September 2011. JASON R. GORDON, General Manager, PO Box 141, Moss Vale NSW 2577.

#### SCHEDULE

Lot 1 in Deposited Plan 1158322.

Lot 2 in Deposited Plan 1158322.

Interest in Land

Easement rights as described under the heading Services in the terms set out hereunder over the site shown in:

Deposited Plan 1158322 as ‘(A) PROPOSED EASEMENT FOR SERVICES (18 WIDE)’.

Easement rights as described under the heading Access in Memorandum E780099 filed in the Office of Land and Property Information NSW over the site shown in:

Deposited Plan 1158322 as ‘(B) PROPOSED EASEMENT FOR ACCESS (5 WIDE)’.

Easement for Services

FULL AND FREE right for the Body having the benefit of this easement (being a public or local authority) and every person authorised by any of them from time to time and at all times to pass and convey water and electricity in any quantities through the servient tenement TOGETHER WITH the right to use for the purposes of the easement any line of pipes, cables or conduits (including works ancillary thereto), already laid within the servient tenement for the purposes of the passage and conveyance of such water and electricity, any pipes, cables or conduits in replacement, substitution or duplication therefor and where no such line of pipes, cables or conduits exists to lay place and maintain a line of pipes or cables or conduits of sufficient internal diameter beneath or upon the surface of the servient tenement AND TOGETHER WITH the right for the Body having the benefit of this easement (being a public or local authority) and every person authorised by any of them with any tools implements, or machinery, necessary for the purposes, to enter upon the servient tenement and to remain there for any reasonable time for the purpose of laying, inspecting, cleansing, repairing, maintaining, or renewing such pipelines or conduits or any part thereof (including works ancillary thereto) AND for any of the aforesaid purposes to open the soil of the servient tenement to such extent as may be necessary PROVIDED

THAT the Body having the benefit of this easement (being a public or local authority) and every person authorised by any of them will take all reasonable precautions to ensure as little disturbance as possible to the surface of the servient tenement and will restore that surface as nearly as practicable to its original condition. [6210]

### ESTATE NOTICES

NOTICE of intended distribution of estate. – Any person having any claim upon the estate of BETTY LOUISE NELSON, late of Neutral Bay, in the State of New South Wales, company director, who died on 30 April 2011, must send particulars of their claim to the executrix, Christina Ann Marshall, care of Newnhams Solicitors, 233 Castlereagh Street, Sydney, within one calendar month from publication of this notice. After that time the executrix may distribute the assets of the estate having regard only to the claims of which at the time of distribution she has notice. Probate was granted in New South Wales on 2 November 2011. NEWNHAMS, Solicitors, Level 7, 233 Castlereagh Street, Sydney NSW 2000 (DX11495, Sydney Downtown), tel.: (02) 9264 7788. [6211]

NOTICE of intended distribution of estate. – Estate of ARMANDO ANTHONY CEFAL, New South Wales Grant made 7 November 2011. – Any person having any claim upon the estate of Armando Anthony Cefai, late of Picnic Point, in the State of New South Wales, who died on 20 September 2010, must send particulars of the claim to the legal representative for the estate, c.o. Colin J. Duff, Solicitor, 7 Morts Road, Mortdale NSW 2223, within 30 days from publication of this notice. After that time and after 6 months from the date of death of the deceased the legal representative intends to distribute the property in the estate having regard only to the claims of which the legal representative had notice at the time of distribution. COLIN J. DUFF, Solicitor, 7 Morts Road, Mortdale NSW 2223 (DX 11307, Hurstville), tel.: (02) 9570 2022. Reference: CJD:2104832. [6212]

NOTICE of intended distribution of estate. – Any person having any claim upon the estate of DESPINA AMDITIS late of Blakehurst in the State of New South Wales, who died on 5th day of October 2011, must send particulars of their claim to The Executor/Executrix, c/- Mercuri & Co, Solicitors, PO Box 719, Drummoyne NSW 1470 within one (1) calendar month from publication of this notice. After that time the Executor/Executrix may distribute the assets of the estate having regard only to the claims of which at the time of distribution they have notice. Probate was granted in New South Wales on 17 November 2011. MERCURI & CO, Solicitors, PO Box 719, Drummoyne, NSW 1470, tel.: (02) 9818 8375. [6213]

### COMPANY NOTICES

NOTICE of voluntary liquidation. – JOHN D. LUXFORD PTY LTD (in liquidation), ACN 010 980 999. – Notice is hereby given pursuant to section 491 (2) of the Corporations Act 2001, that at a meeting of Shareholders of John D. Luxford Pty Ltd, duly convened and held on 21 November 2011, it was resolved that the company be wound up voluntarily as a Members Voluntary Liquidation and that the assets of the company may be distributed in whole or in part to the members in specie should the liquidator so desire and by ordinary resolution that Brent Antony Perkins be appointed liquidator. Dated 21 November 2011. BRENT ANTONY PERKINS, Liquidator, Box 29, Hunter Region Mail Centre NSW 2310, tel.: (02) 4923 4000. [6214]

NOTICE of voluntary liquidation. – FANTED PTY LTD (in liquidation), ACN 054 149 674. – Notice is hereby given pursuant to section 491 (2) of the Corporations Act 2001, that at a meeting of shareholders of Fanted Pty Ltd, duly convened and held on 21 November 2011, it was resolved that the company be wound up voluntarily as a Members Voluntary Liquidation and that the assets of the company may be distributed in whole or in part to the members in specie should the liquidator so desire and by ordinary resolution that Brent Antony Perkins be appointed liquidator. Dated 21 November 2011. BRENT ANTONY PERKINS, Liquidator, Box 29, Hunter Region Mail Centre NSW 2310, tel.: (02) 4923 4000. [6215]

### OTHER NOTICES

#### PARTNERSHIP ACT 1892 (NSW)

#### HYDRO ALUMINIUM KURRI KURRI HOLDINGS a Limited Partnership

PURSUANT to section 36 of the Partnership Act 1892 (NSW), the partners of Hydro Aluminium Kurri Kurri Holdings, a Limited Partnership, registered as such under that Act, hereby notify the retirement of Mr Truls GAUTESEN as a General Partner from the partnership and of the admission of Mr Olaf WIGSTØL to the partnership also as a General Partner. These changes took effect on 11 November 2011.

By Order of the Partners  
Hydro Aluminium Kurri Kurri Holdings,  
a Limited Partnership

[6216]

Authorised to be printed

PETER MUSGRAVE, Government Printer.

ISSN 0155-6320