



# *Government Gazette*

of the State of  
New South Wales

**Number 31**  
**Friday, 10 March 2017**

---

The *New South Wales Government Gazette* is the permanent public record of official notices issued by the New South Wales Government. It also contains local council and other notices and private advertisements.

The Gazette is compiled by the Parliamentary Counsel's Office and published on the NSW legislation website ([www.legislation.nsw.gov.au](http://www.legislation.nsw.gov.au)) under the authority of the NSW Government. The website contains a permanent archive of past Gazettes.

To submit a notice for gazettal – see Gazette Information.

# GOVERNMENT NOTICES

## Miscellaneous Instruments



New South Wales

## Notice of Determination

under the

Threatened Species Conservation Act 1995

The Scientific Committee established under the *Threatened Species Conservation Act 1995* has made a determination to amend the descriptions of the species referred to below pursuant to section 36A of that Act and, accordingly, that Act is amended as follows:

- (a) by omitting “*Cassia brewsteri* var. *marksiana* Bailey” from the matter relating to Fabaceae under the heading **Plants** in Part 1 of Schedule 1 and inserting instead “*Cassia marksiana* (F.M. Bailey) Domin”,
- (b) by omitting “*Philothea myoporoides* subsp. *obovatifolia* M.J. Bayly” from the matter relating to Rutaceae under the heading **Plants** in Part 1 of Schedule 1 and inserting instead “*Philothea obovatifolia* (Bayly) P.I. Forst.”.

This Notice commences on the day on which it is published in the Gazette.

Dated, this 19th day of January 2017.

Dr Mark Eldridge  
Chairperson of the Scientific Committee

### Copies of determination and reasons

Copies of the determination and the reasons for it are available to members of the public (free of charge) as follows:

- (a) on the Internet at [www.environment.nsw.gov.au](http://www.environment.nsw.gov.au),
- (b) by contacting the Scientific Committee Unit, by post C/- Office of Environment and Heritage, PO Box 1967, Hurstville BC NSW 1481, by telephone (02) 9585 6940 or by facsimile (02) 9585 6606,
- (c) in person at the Office of Environment and Heritage Information Centre, Level 14, 59–61 Goulburn St, Sydney.



New South Wales

## Notice of Determination for Provisional Listing on an Emergency Basis

under the

Threatened Species Conservation Act 1995

The Scientific Committee established under the *Threatened Species Conservation Act 1995* has made a determination for provisional listing, on an emergency basis, of the following species as an endangered species under that Act, and, accordingly, Schedule 1 to that Act is taken to have been amended by inserting in Part 1 in alphabetical order in the matter relating to Myobatrachidae (under the headings **Animals**, **Vertebrates** and **Amphibians**):

*Uperoleia mahonyi* Clulow, Anstis, Keogh & Catullo, 2016      Mahony's Toadlet

This Notice commences on the day on which it is published in the Gazette.

Dated, this second day of March 2017.

Dr Mark Eldridge  
Chairperson of the Scientific Committee

### Copies of determination and reasons

Copies of the determination and the reasons for it are available to members of the public (free of charge) as follows:

- (a) on the Internet at [www.environment.nsw.gov.au](http://www.environment.nsw.gov.au),
- (b) by contacting the Scientific Committee Unit, by post C/- Office of Environment and Heritage, PO Box 1967, Hurstville BC NSW 1481, by telephone (02) 9585 6940 or by facsimile (02) 9585 6606,
- (c) in person at the Office of Environment and Heritage Information Centre, Level 14, 59–61 Goulburn St, Sydney.

# SCIENTIFIC COMMITTEE

## Notice of Preliminary Determination

The Scientific Committee, has made Preliminary Determinations proposing that the following be listed in the relevant Schedule of the *Threatened Species Conservation Act 1995*.

### **Critically Endangered Species (Part 1 of Schedule 1A)**

*Hibbertia fumana* Sieber ex Toelken

This species is currently provisionally listed as a Critically endangered species.

## Notice of Preliminary Determination Proposed amendment to Schedules 1A and 1

The Scientific Committee has also made a Preliminary Determination to list the shrub *Leionema lamprophyllum* subsp. *fractum* S.A.J.Bell as a CRITICALLY ENDANGERED SPECIES in Part 1 of Schedule 1A of the Act and, as a consequence, removing the population of *Leionema lamprophyllum* (F. Muell.) Paul G. Wilson subsp. *obovatum* F.M. Anderson in the Hunter Catchment from Part 2 of Schedule 1 (Endangered populations) of the Act

## Notice of Preliminary Determination Removal from Schedule 1

The Scientific Committee has also made a Preliminary Determination proposing the removal of the following species from the list of Species presumed extinct in Part 4 of Schedule 1 of the Act.

*Aphanes pentamera* Rothm., a herb

Any person may make a written submission regarding these Preliminary Determinations. Send submissions to Suzanne Chate, NSW Scientific Committee Unit, PO Box 1967, Hurstville BC 1481. Submissions close 5<sup>th</sup> May 2017.

A copy of the Determinations, which contain the reasons for the determination, may be obtained free of charge on the Internet [www.environment.nsw.gov.au](http://www.environment.nsw.gov.au), by contacting the Scientific Committee Unit, PO Box 1967 Hurstville BC 1481. Tel: (02) 9585 6940 or Fax (02) 9585 6606, or in person at the Office of Environment and Heritage Information Centre, Level 14, 59-61 Goulburn Street, Sydney. Copies of the determination may also be obtained from National Parks and Wildlife Service Area Offices and Visitor Centres, subject to availability.

Dr Mark Eldridge, Chairperson

## Electricity (Consumer Safety) Act 2004

### Order under Section 5

I, John Tansey, Executive Director, Building & Construction Service, New South Wales Fair Trading, Department of Finance, Services and Innovation:

- (1) revoke, on and from the date on which this Order is published in the *New South Wales Government Gazette*, the Order dated 16 November 2016 published in the *New South Wales Government Gazette* of 18 November 2016 No. 95 at page 3179; and
- (2) pursuant to sections 5(2) and 5(3) of the *Electricity (Consumer Safety) Act 2004* by this Order, declare the electrical articles of a class described in Schedule 1 to be, on and from the date on which this Order is published in the *New South Wales Government Gazette*, declared electrical articles for the purposes of Part 2 of the *Electricity (Consumer Safety) Act 2004* and the specifications, including modifications, specified in Schedule 1 to be those applicable to electrical articles of that class.

Signed this 7th day of March 2017

JOHN TANSEY  
EXECUTIVE DIRECTOR, BUILDING & CONSTRUCTION SERVICE  
NSW FAIR TRADING  
DEPARTMENT OF FINANCE, SERVICES AND INNOVATION

## Schedule 1

### Declared Electrical Articles

#### Interpretation:

In this schedule a reference to-

AS/NZS 60335.1 means AS/NZS 60335.1:2011+A1-3;  
AS/NZS 3100 means AS/NZS 3100:2009+A1-4;  
AS/NZS 60745.1 means AS/NZS 60745.1:2009 or AS/NZS 60745.1:2003+A1-3. The 2009 edition will supersede AS/NZS 60745.1:2003 and its amendments after all of the Parts 2 of that standard have been superseded;  
AS/NZS 60598.1 means AS/NZS 60598.1:2013;  
AS/NZS 61347.1 means AS/NZS 61347.1: 2016;  
AS/NZS 61535.1 means AS/NZS 61535.1:2011;  
AS/NZS 61558.1 means AS/NZS 61558.1:2008+A1-2;  
AS/NZS 62841.1 means AS/NZS 62841.1 : 2015.

#### 1. APPLIANCE CONNECTOR - an electrical device which -

- (a) is for attachment to a flexible cord; and
- (b) makes a detachable connection between the conductors of the cord and the pins or contacts of any low voltage appliance or equipment of a type intended or generally used for household applications;

but does not include -

- (c) a connector within the scope of AS/NZS 3123; or
- (d) a plug or socket-outlet within the scope of AS/NZS 3131; or
- (e) an installation coupler within the scope of AS/NZS 61535.1.

Class specification:

Appliance connector –  
AS/NZS 60320.1:2012.

Plug connector  
AS/NZS 60320.1:2012 and AS/NZS 60320.2.2:2004.

Sewing machine connector -  
AS/NZS 60320.2.1:2004.

#### 2. ARC WELDING MACHINE - an electrical appliance which –

- (a) is for use in the electric arc welding process;
- (b) is for connection to single phase low voltage supply;
- (c) is fitted with a flexible cord and plug rated at not more than 16 A;
- (d) can easily be moved from one place to another while it is connected to supply; and
- (e) has, for GMAW (gas metal arc welding), GTAW (gas tungsten arc welding), and FCAW (flux cored arc welding) machines, a 100% output rating not exceeding 65 A.

The 100% rating is calculated from the square root of the marked duty cycle expressed in decimal form multiplied by the marked output current associated with the duty cycle in amperes;

but does not include –

- (f) an arc welding machine promoted exclusively to industry.

Class specification:

IEC 60974.6:2015 or AS60974.6:2006.

**3. BAYONET LAMPHOLDER** - an electrical device which –

- (a) accommodates a lamp with a bayonet cap of 15 mm or 22 mm nominal diameter; but does not include -
- (b) a lampholder which by design is restricted to specific appliances; or
- (c) a lampholder which is for incorporation in industrial equipment only.

Class specification:

AS/NZS 3100 and AS/NZS 3117:2007 (until 30 December 2016); or  
AS/NZS 3100 and AS/NZS3117:2015+A1; or  
AS/NZS 61184:2015.

**4. BAYONET LAMPHOLDER ADAPTOR** - an electrical device which –

- (a) is for insertion into a B22 bayonet lampholder; and
- (b) is for connection to a flexible cord; or
- (c) has one or more lampholders.

Class specification:

AS/NZS 3100 and AS 3119:2015.

**5. BLANKET** - an electrical appliance which –

- (a) is for the application of heat to a bed or human body;
- (b) is flexible;
- (c) has a fabric enclosure; and
- (d) has a projected surface area exceeding 0.6 square metres;

and includes -

- (e) any associated power supply or controller.

But does not include –

- (f) appliances specifically intended for use under direct medical supervision.

Class specification:

AS/NZS 60335.1 and AS/NZS 60335.2.17:2012 + A1.

**6. BREAD TOASTER** - an electrical appliance which –

- (a) is a household type; and
- (b) is for toasting bread or similar foods.

Class specification:

AS/NZS 60335.1 and AS/NZS 60335.2.9: 2009+A1 (until 28 November 2017) or AS/NZS 60335.2.9:2014+A1.

## 7. BUILDING WIRING CABLE

This definition becomes mandatory on 29 January 2018.

A single or multicore electric cable insulated with polymeric materials; that:-

- (a) Has one to five conductors of stranded or solid cores of copper conductors.
- (b) Has an insulated and laid up flat or circular configuration.
- (c) Is sheathed or unsheathed.
- (d) Has a nominal cross-sectional area of 0.5 mm<sup>2</sup> to 16mm<sup>2</sup>.
- (e) Is intended for use in electrical installations at working voltages up to:-
  - (i) 450/750V; or
  - (ii) 0.6/1 (1.2) kV

But does not include –

- (f) armoured, metallic screened and metal sheathed cables.

Class Specification:-

For working voltages up to 450/750V - AS/NZS 5000.2 : 2006; or  
For working voltages up to 0.6/1 (1.2)kV – AS/NZS 5000.1 : 2005.

## 8. CLOTHES DRYER - an electrical appliance which -

- (a) is a household type; and
- (b) is for drying textile material.

but does not include –

- (c) a heated towel rail.

Class specification:

Rotary type –  
AS/NZS 60335.1 and AS/NZS 60335.2.11:2009+A1-4.

Cabinet type-  
AS/NZS 60335.1 and AS/NZS 60335.2.43:2005+A1-2.

High Speed Spin Extractor-  
AS/NZS 60335.1 and AS/NZS 60335.2.4:2010 A1-3.

## 9. CONTROL OR CONDITIONING DEVICE - an electrical device which –

- (a) is a household type;



- (b) is for automatically controlling or conditioning the electrical input to electrical apparatus via outlet facilities of the control or conditioning device.
- (c) is self contained and portable; and
- (d) connects to supply by means of a flexible cord and plug, appliance inlet or pins for engagement with a socket-outlet.

Class specification:

AS/NZS 3100 and AS/NZS 3105:2014.

**10. COOKING APPLIANCE - PORTABLE TYPE** - an electrical appliance which -

- (a) is a household type;
- (b) is for cooking or warming food by electrical energy; and
- (c) is portable.

Class specification:

Griller, roaster, or oven (including breadmaker)-

AS/NZS 60335.1 and AS/NZS 60335.2.9: 2009+A1 (until 28 November 2017) or AS/NZS 60335.2.9:2014+A1.

Warming plate and similar-

AS/NZS 60335.1 and AS/NZS 60335.2.12:2004+A1.

Frying pan, deep fryer or wok-

AS/NZS 60335.1 and AS/NZS 60335.2.13:2010.

Outdoor barbecue-

AS/NZS 60335.1 and AS/NZS 60335.2.78:2005+A1-2.

**11. CORD EXTENSION SOCKET** - an electrical device which –

- (a) is for attachment to a flexible cord;
- (b) has a maximum rating of 20 A at low voltage; and
- (c) has contacts whereby a detachable connection may be made with the corresponding pins of a plug or an inlet;

but does not include -

- (d) a connector or appliance connector designated in AS/NZS 3123; or
- (e) a socket outlet designated in AS/NZS 3131.
- (f) an installation coupler designated in AS/NZS 61535.1.

Class specification:

AS/NZS 3100 and AS/NZS 3120:2011+A1.

**12. CORD-LINE SWITCH** - an electrical device which -

- (a) is for attachment in a flexible cord;
- (b) manually opens and closes an electrical circuit; and
- (c) has a rating not exceeding 16 A at low voltage;

but does not include -

- (d) bell push and pendant switches.

Class specification:

AS/NZS 3100 and AS/NZS 3127:2005.

**13. DECORATIVE LIGHTING OUTFIT** - an electrical appliance which –

- (a) is for decorative, display or illumination purposes;
- (b) is portable;
- (c) consists of -
  - (i) electric light sources or lampholders interconnected by flexible cord of less than 2.5 mm sq cross-sectional area; or
  - (ii) electric light sources within a flexible enclosure; and
- (d) may be integral with a frame or similar support; and includes -
- (e) any integral power supply or control device.

Class specification:

AS/NZS 60598.1 and AS/NZS 60598.2.20:2002.

**14. DISHWASHING MACHINE** - an electrical appliance which –

- (a) is a household type; and
- (b) is for washing of eating or cooking utensils.

Class specification:

AS/NZS 60335.1 and AS/NZS 60335.2.5:2002+A1-3 (until 27 June 2017) or AS/NZS 60335.2.5:2014+A1.

**15. DOUBLE CAPPED LIGHT EMITTING SEMICONDUCTOR LAMP**

An electrical appliance that—

- (a) is a tubular light emitting semiconductor light source;
- (b) is a double capped lamp; and
- (c) has integral, built-in or independent control gear

but does not include—

- (d) a self-ballasted light emitting semiconductor light source within the scope of AS/NZS IEC 62560.

Class specification:

AS/NZS 60598.2.1 2014 + A1 Appendix A.

**16. EDISON SCREW LAMPHOLDER** - an electrical device which –

- (a) accommodates a lamp with an Edison screw cap of 14 mm or 27 mm nominal outside diameter;

but does not include –

- (b) a lampholder which by design is restricted to specific appliances; or
- (c) a lampholder which is for incorporation in industrial equipment only.

Class specification:

AS/NZS 3100 and AS/NZS 3140:2014+A1 (until 30 December 2016) or AS/NZS 60238:2015+A1.

**17. FAN** - an electrical appliance which –

- (a) is a household type;
- (b) has a primary function of moving air in its vicinity for comfort or extraction purposes; and
- (c) is self-contained;

and includes -

- (d) any associated ancillary equipment.

Class specification:

AS/NZS 60335.1 and AS/NZS 60335.2.80:2004+A1 (until 30/06/2019) or AS/NZS 60335.1 and AS/NZS 60335.2.80 : 2016.

**18. FENCE ENERGISER** – an electrical appliance which regulates and controls the supply of electrical energy to an electric fence.

Class specification:

AS/NZS 60335.1 and AS/NZS 60335.2.76:2003+A1-4.

**19. FLEXIBLE HEATING PAD** - an electrical appliance which -

- (a) is for application of heat to parts of the human body;
- (b) is in the form of a flexible pad; and
- (c) has a projected area not exceeding 0.6 square metres.

But does not include –

- (d) appliances specifically intended for use under direct medical supervision.

Class specification:

Foot warmer and foot mat-

AS/NZS 60335.1 and AS/NZS 60335.2.81:2012 (until 30 November 2018) or AS/NZS 60335.2.81:2015.

Other-

AS/NZS 60335.1 and AS/NZS 60355.2.17:2012+A1.

**20. FLOOR POLISHER/SCRUBBER** – an electrical appliance which –

- (a) is a household type; and
- (b) is used to polish or scrub floors.

Class specification:

AS/NZS 60335.1 and AS/NZS 60335.2.10:2006+A1.

**21. FLUORESCENT LAMP BALLAST** - an electrical device which –

- (a) is for controlling the magnitude of current flowing through the discharge path of a fluorescent lamp;
- (b) is of the independent or built-in type intended for use with luminaires (portable or fixed); or
- (c) is of the integral type, rated at 60 watts or less, such that it forms a non-replaceable part of a fluorescent lamp/ballast combination; or
- (d) is of the adaptor type such that it allows the insertion of a fluorescent lamp into the ballast by the user;

and includes -

- (e) any capacitor incorporated in or supplied with the ballast;

but does not include -

- (f) a ballast which is incorporated in luminaires certified for compliance with the requirements for electrical equipment with increased safety type protection (Ex e) for use in hazardous locations.

Class specification:

Integral (self-ballasted lamp) magnetic and electronic types-  
AS/NZS 60968:2001.

Other magnetic type-  
AS/NZS 61347.1 and AS/NZS 61347.2.8:2003.

Other electronic type  
AS/NZS 61347.1 and AS/NZS 61347.2.3:2004.

Fluorescent lamp adaptors (T8:T5)  
AS/NZS 61347.1 and AS/NZS 61347.2.3:2004 and the relevant requirements of AS/NZS 60598.2.1 :  
2016 A1.

**22. FLUORESCENT LAMP STARTER** - an electrical device which –

- (a) is for starting preheat type fluorescent lamps;
- (b) is a glow-start type; and
- (c) has an enclosure of insulating material.

Class specification:

AS/NZS 60155:2000 (Section 1)+A1-2.

**23. HAIR CARE APPLIANCE** - an electrical appliance which –

- (a) is a household type or a commercial hand-held type; and
- (b) is for drying, styling or the caring of human hair.

Class specification:

AS/NZS 60335.1 and AS/NZS 60335.2.23:2012+A1.

For Hair Straighteners only –

- (i) the approval period is limited to two years.
- (ii) the test report must indicate testing carried out no more than twelve months prior to the application date; and
- (iii) the test report must clearly identify the model number and brand name, OR the manufacturer must provide a clear and concise statement that clarifies any deviation from the report details.

**24. HEDGE CLIPPER** – an electrical appliance which –

- (a) is for trimming hedges; and
- (b) is hand held.

Class specification:

AS/NZS 60745.1 and AS/NZS 60745.2.15:2010.

**25. IMMERSION HEATER** - an electrical appliance which –

- (a) is a household type;
- (b) is for heating liquid in which it may be immersed; and
- (c) is self-contained;

and includes -

- (d) aquarium type immersion heaters.

Class specification:

Aquarium type-

AS/NZS 60335.1 and AS/NZS 60335.2.55:2011.

Portable (other than aquarium) type-

AS/NZS 60335.1 and AS/NZS 60335.2.74:2005+A1-2.

Fixed type-

AS/NZS 60335.1 and AS/NZS 60335.2.73:2005+A1-2.

**26. INSECT ELECTROCUTOR** - an electrical appliance which –

- (a) is a household type; and
- (b) kills insects by the application of electrical energy.

Class specification:

AS/NZS 60335.1 and AS/NZS 60335.2.59:2005+A1-3.

**27. INSPECTION HANDLAMP** - an electrical appliance which –

- (a) is for inspection purposes using illumination;
- (b) contains an electric light source and
- (c) is hand held;

but does not include -

- (d) handlamps with a magnification facility.

Class specification:

AS/NZS 60598.1 and AS/NZS 60598.2.8:2015.

**28. IRON** - an electrical appliance which –

- (a) is a household type;
- (b) is for smoothing or pressing fabric by the application of heat or steam; and
- (c) is hand held except for any separate steam generator;

and includes -

- (d) any associated equipment.

Class specification:

Fabric steamer -

AS/NZS 60335.1 and AS/NZS 60335.2.85:2005+A1.

Other -

AS/NZS 60335.1 and AS/NZS 60335.2.3:2012+A1.

**29. KITCHEN MACHINE** - an electrical appliance which –

- (a) is a household type;
- (b) is for the preparation of food by mechanical means; or
- (c) is for opening cans; or
- (d) is for sharpening of knives.

Class specification:

AS/NZS 60335.1 and AS/NZS 60335.2.14:2007+A1 (until 25 October 2016) or  
AS/NZS 60335.2.14: 2013.

**30. LAWN CARE APPLIANCE** - an electrical appliance which –

- (a) is a household type; and
- (b) is for cutting grass or lawn.

Class specification:

Mower (except for robotic lawn mower) -

AS/NZS 60335.1 and AS/NZS 60335.2.77:2002+A1.

Robotic lawn mower-

AS/NZS 60335.1 and AS/NZS 60335.2.107:2013+A1.

Trimmer (with non-metallic filament line or cutter/s)-

AS/NZS 60335.1 and 60335.2.91:2008+A1.

Trimmer (other)-

AS/NZS 60335.1 and AS/NZS 60335.2.91:2008+A1.

Grass Shears:

AS/NZS 60335.1 and AS/NZS 60335.2.94:2008.

**31. LIQUID HEATING APPLIANCE** – an electrical appliance which –

- (a) is a household type;
- (b) is portable;
- (c) has a capacity not exceeding 10L; and
- (d) heats liquid for:
  - (i) humidifying room air; or
  - (ii) use in, or as, a hot beverage; or
  - (iii) cooking.

Class specification:

Humidifier-

AS/NZS 60335.1 and AS/NZS 60335.2.98:2005+A1-2.

Other-

AS/NZS 60335.1 and AS/NZS 60335.2.15:2013.

**32. LUMINAIRE - PORTABLE TYPE** - an electrical appliance which -

- (a) is a household type;
- (b) provides illumination or for decorative purposes, produces light;
- (c) is fitted with a supply flexible cord, an appliance inlet socket or a power supply unit with integral pins for insertion into a socket outlet;
- (d) is for standing on a table or floor, or is fitted with a clamp or similar for attachment to vertical or horizontal surfaces;
- (e) is for use with tungsten filament, tubular fluorescent or other discharge lamps or Light Emitting Diode “LED” types; and
- (f) is constructed to represent a model, person or animal and by its design and materials is likely to be treated by a child as a toy; or
- (g) has metal parts which are required to be earthed or double insulated from live parts (excluding live parts of an all insulated lampholder).

Class specification:

Child appealing type (refer to clause (f)-

AS/NZS 60598.1 and AS/NZS 60598.2.10:2015.

Type fitted with a built-in transformer or convertor-

AS/NZS 60598.1 and AS/NZS 60598.2.6:1998.

Type for Garden Use –

AS/NZS 60598.1 and AS/NZS 60598.2.7:2005.

Other-

AS/NZS 60598.1 and AS/NZS 60598.2.4:2005+A1.

**33. MASSAGE APPLIANCE** - an electrical appliance which -

- (a) is a household type;
- (b) is for massaging the human body;
- (c) is portable; and
- (d) is self-contained.

Class specification:  
AS/NZS 60335.1 or AS/NZS 60335.2.32:2014.

**34. MICROWAVE OVEN** - an electrical appliance which –

- (a) is a household type; and
- (b) applies heat to food, liquid or other substances in a chamber by means of high frequency electromagnetic radiation.

Class specification:  
AS/NZS 60335.1 and AS/NZS 60335.2.25:2011+A1.

**35. MINIATURE OVERCURRENT CIRCUIT-BREAKER** - an electrical device which -

- (a) is an enclosed air-break switch;
- (b) opens a low voltage circuit automatically under pre-determined conditions of overcurrent;
- (c) has a nominal rating not exceeding 125 A; and has -
  - (i) a current breaking capacity up to but not including 10 kA; and/or
  - (ii) a projected panel mounting area not exceeding 4000 square millimetres per pole;

but does not include -

- (d) miniature overcurrent circuit-breakers as defined but which:
  - i) are intended and marked as being only for use in industrial application; or
  - ii) are intended only for use within and for protection of electrical equipment as distinct from circuit wiring and are appropriately marked.

Class specification:  
AS/NZS 60898.1:2004 and AS/NZS 60898.2:2004.  
(or AS 60947.2:2015 for DC circuit breakers outside the scope of AS/NZS 60898.2) or AS/NZS 3111:2009+A1-2.

**36. OUTLET DEVICE** - an electrical device which –

- (a) is a household type;
- (b) as its primary function, extends supply from a socket-outlet;
- (c) is portable;
- (d) incorporates facilities for the insertion of a plug or plugs; and
- (e) has a rating not exceeding 20 A;

but does not include -

- (f) a cord extension set.

Class specification:  
Integral pin type (including travel adaptor) -  
AS/NZS 3100 and AS/NZS 3122:2005 (until 27 August 2017) or AS/NZS 3122:2015.

AS/NZS 3122:2005 is modified to preclude types that can be rewired by the user.

AS/NZS 3122:2005 is modified to include the requirements of AS/NZS 3122:2015 Appendix A3.2.2 – ‘Abnormal insertion of Travel Adaptors’.



Other -  
AS/NZS 3100 and AS/NZS 3105:2014.

**37. PLUG** - an electrical device which -

- (a) makes a detachable connection between the contacts of a socket-outlet and the conductors of a flexible cord;
- (b) has two, three or four pins for insertion into a socket-outlet; and
- (c) has a rating not exceeding 20A.;

but does not include -

- (d) a plug which is within the scope of AS/NZS 3123:2005 and is intended for industrial use; or
- (e) a plug which is within the scope of AS/NZS 3131:2001 or AS/NZS 61535:2011.

Class specification:

AS/NZS 3100 and AS/NZS 3112:2011+A1-3.

NOTE: It is intended to preclude plugs of a non-Australian type.

**38. POWER SUPPLY OR CHARGER** - an electrical appliance which -

- (a) provides an output not exceeding 50 volts a.c. or 120 volts ripple free d.c.; and
- (b) is a type to provide supply to separate luminaires; or
- (c) is a household type for either charging batteries or to provide a supply to separate equipment.

but does not include:

- (d) Information Technology and Audio Video equipment that can use the output to also transmit data that is not associated with a power supply or charger function.

Class specification:

Power supply for general use-

AS/NZS 61558.1 and AS/NZS 61558.2.6:2009+A1 or AS/NZS 61558.2.16: 2010 A1-3 (for switched mode types).

Power supply (electronic or transformer types) designated for use with specific electronic equipment-

AS/NZS 60065:2012+A1; or

AS/NZS 60950.1:2011+A1 (until 1 September 2017) or AS/NZS 60950.1:2015; or

AS/NZS 61558.1 and AS/NZS 61558.2.16: 2010+A1-3 (for switched mode types).

Note: Consideration is being given to the alternative adoption of IEC:62368 : 2015.

Power supply for toys-

AS/NZS 61558.1:2008 and 61558.2.7:2008+A1; or

AS/NZS 61558.2.16: 2010+A1-3 (for switched mode types).

Power supply for bells or chimes-

AS/NZS 61558.1 and AS/NZS 61558.2.8:2011+A1; or

AS/NZS 61558.2.16: 2010+A1-3 (for switched mode types).

Power supply for lighting purposes-

Electronic Type:

LED modules: AS/NZS 61347.1 and AS/NZS IEC 61347.2.13:2013

Other: AS/NZS 61347.1 and AS/NZS 61347.2.2:2007.

Ferromagnetic Type: AS/NZS 61558.2.6+A1: 2009.

Power supply for Handlamps-

AS/NZS 61558.1 and AS/NZS 61558.2.9:2011+A1; or

AS/NZS 61558.2.16: 2010+A1-3 (for switched mode types).

Power Supply for fence energiser-

AS/NZS 61558.1 and AS/NZS 61558.2.6:2009+A1 together with AS/NZS 60335.2.76:2003+A1-4; or

AS/NZS 61558.2.16:2010 A1-3 together with AS/NZS 60335.2.76:2003+A1-4 (for switched mode types).

Battery charger-

AS/NZS 60335.1 and AS/NZS 60335.2.29:2004+A1-2.

**39. PROJECTOR** - an electrical appliance which –

(a) is a household type; and

(b) is for projecting an image from a photographic slide or moving film.

Class specification:

AS/NZS 60335.1 and AS/NZS 60335.2.56:2006+A1-2.

**40. RANGE** - an electrical appliance which -

(a) is a household type;

(b) is for cooking food using heat produced by electrical energy; and

(c) is stationary.

Class specification:

Fixed outdoor barbecue-

AS/NZS 60335.1 and AS/NZS 60335.2.78:2005+A1-2.

Other-

AS/NZS 60335.1 and AS/NZS 60335.2.6:2008+A1-4 until 28 November 2017) or AS/NZS

60335.2.6:2014+A1.

**41. RANGE HOOD** - an electrical appliance which –

(a) is a household type;

(b) collects and/or filters air; and

(c) is for installation above, or adjacent to, a cooking appliance.

Class specification:

AS/NZS 60335.1 and AS/NZS 60335.2.31:2013+A1.

**42. RAZOR/HAIR CLIPPER** - an electrical appliance which –

- (a) is a household type; and
- (b) shaves, cuts or trims human hair.

Class specification:

AS/NZS 60335.1 and AS/NZS 60335.2.8: 2013.

**43. REFRIGERATOR/FREEZER** - an electrical appliance which -

- (a) is a household type; and
- (b) cools and stores food.

but does not include –

- (c) wine coolers

Class specification:

AS/NZS 60335.1 and AS/NZS 60335.1 and AS/NZS 60335.2.24:2010+A1.

**44. RESIDUAL CURRENT DEVICE** - an electrical device which –

- (a) isolates or initiates a tripping signal to isolate a low-voltage supply to protected circuits, sockets-outlets or equipment in the event of a current flow to earth which exceeds a pre-determined level;
- (b) may be fixed or portable
- (c) has a rated residual current not exceeding 300 mA for devices intended for connection to fixed wiring or 30 mA for other devices; and
- (d) has a rated load current not exceeding 125 A for devices intended for connection to fixed wiring or 20 A for other devices;

but does not include -

- (e) a device intended to be used with a particular circuit-breaker other than a miniature overcurrent circuit-breaker; or
- (f) a device intended to protect an electricity supply authority distribution system; or
- (g) a device covered by AS 2081 and intended for mines use.

Class specification:

Without integral overcurrent protection -

AS/NZS 61008.1:2015 or AS/NZS 3190:2011.

With integral overcurrent protection -

AS/NZS 61009.1:2015 or;  
AS/NZS 3190:2016 and AS/NZS 3111:2009+A1-2.

Type 'B' and 'F' devices: IEC 62423.

Type SPE – PRCD's: IEC 62335.

For portable types –

- (a) AS/NZS 3190:2016; or
- (b) AS/NZS 3190:2016 together with AS/NZS 3012:2010+A1 (Type PSOA); or

- (c) IEC 62335 (Type SPE); or
- (d) IEC 61540. In addition they shall comply with the PRCD and PSOA requirements of AS/NZS 3190.

**45. ROOM HEATER** - an electrical appliance which –

- (a) is a household type; and
- (b) is for heating, by electrical energy, the atmosphere for comfort purposes;

and includes –

- (c) an appliance that accommodates one or more heatlamps;

but does not include -

- (d) an air-conditioning appliance;
- (e) a heating system that is intended to heat the atmosphere of a room primarily by raising the temperature of any floor, wall, or ceiling area; or
- (f) an under-carpet heating system.

Class specification:

Thermal storage type-  
AS/NZS 60335.1 and AS/NZS 60335.2.61:2005+A1-2.

Other-  
AS/NZS 60335.1 and AS/NZS 60335.2.30:2009+A1-2 (until 30 June 2018) or AS/NZS 60335.2.30:2015.

**46. SEWING MACHINE** – an electrical appliance which –

- (a) is a household type; and
- (b) is for stitching fabric or other material.

Class specification:

AS/NZS 60335.1 and AS/NZS 60335.2.28:2006+A1.

**47. SOCKET-OUTLET** - an electrical device which –

- (a) is for fixing at a point at which fixed wiring terminates;
- (b) provides a detachable connection with the pins of a plug;
- (c) has two, three or four contacts; and
- (d) has a rating not exceeding 20A.;

but does not include -

- (e) an outlet within the scope of AS/NZS 3123 or AS/NZS 3131 or AS/NZS 61535.

Class specification:

AS/NZS 3100 and AS/NZS 3112:2011+A1-3  
AS/NZS 60884.1:2013 (including annex ZZ).

Socket Outlets shall not allow projected plug portions for any aperture set to be overlapped.

**48. SOLDERING IRON** - an electrical appliance which –

- (a) is for the application or removal of solder; and
- (b) is hand held;  
and includes -
- (c) any integral or associated power supply or controller;  
but does not include -
- (d) a soldering iron promoted exclusively to industry.

Class specification:

AS/NZS 60335.1 and AS/NZS 60335.2.45: 2012.

**49 . SUPPLY FLEXIBLE CORD** - an electrical cord which –

- (a) is unscreened and flexible;
- (b) is designed for use at low voltage;
- (c) consists of two or three elastomer or PVC insulated cores of multistrand construction;
- (d) has a cross-sectional area of each conductor not exceeding 2.5 square millimetres; and
- (e) has for other than tinsel cords, individual wire strandings not exceeding -
  - (i) 0.21 mm for conductor sizes up to 1 square millimetre; or
  - (ii) 0.26 mm for conductor sizes exceeding 1 square millimetre;

but does not include -

- (f) a flexible cord directly connected to equipment or approved non-rewirable accessories which is marked in accordance with the CENELEC HAR marking scheme for flexible cords.

Class specification:

General flexible cord-

AS/NZS 3191:2008; or

AS/NZS 60227.5:2003+A1 (PVC); or

AS/NZS 60245.4:2003+A1 (Rubber).

Halogen-free thermoplastic insulation cord-

EN 50525-3-11:2011.

Halogen-free crosslinked insulation cord-

EN 50525-3-21:2011.

**50. SWIMMING POOL OR SPA EQUIPMENT** - an electrical appliance or device –

- (a) that is a transportable spa pool or transportable spa-bath, or
- (b) that is for circulating air or water in a conventional bath; or
- (c) that is for use in the operation or cleaning of a swimming pool, non-transportable spa pool or non-transportable spa-bath.

But does not include –

- (d) an appliance or device exclusively promoted for commercial use; or
- (e) a heat pump

Class specification:

Pump-

AS/NZS 60335.1 and AS/NZS 60335.2.41:2004+A1 (until 25 October 2016) or AS/NZS 60335.2.41:2013.

Spa pool, Spa bath or an appliance intended to circulate air or water in a conventional bath-  
AS/NZS 60335.1 and AS/NZS 60335.2.60:2006+A1.

UV radiation water treatment appliances-  
AS/NZS 60335.2.109:2011+A1.

Other-

AS/NZS 3100 and AS/NZS 3136:2001+A1-2.

**51. TELEVISION RECEIVER** - an electrical appliance which –

- (a) is for household use;
- (b) is for the display of public or subscription television broadcasts; and
- (c) incorporates a single cathode ray picture tube.

Class specification:

AS/NZS 60065:2012+A1.

**52. THERAPEUTIC LAMP** - an electrical appliance which –

- (a) is a household type;
- (b) produces ultraviolet or infra-red radiation for personal, therapeutic or cosmetic purposes; and
- (c) is portable.

Class specification:

AS/NZS 60335.1 and AS/NZS 60335.2.27:2010+A1-2 (until 30 June 3 2018); or AS/NZS 60335.2.27 : 2016.

**53. TOOL - PORTABLE TYPE** - an electrical appliance which –

- (a) is for machining, drilling, sawing, or surface preparation; and
- (b) may be entirely supported by hand during operation;

but does not include -

- (c) a tool, portable type, promoted exclusively to industry.

Class specification:

Drill-

AS/NZS 60745.1 and AS/NZS 60745.2.1:2009.

Sander or polisher (other than disk types)-

AS/NZS 60745.1 and AS/NZS 60745.2.4:2009 (until 26 June 2018) or AS/NZS 62841.2.4:2015.

Circular saw-

AS/NZS 60745.1 and AS/NZS 60745.2.5:2011 (until 26 June 2018) or AS/NZS 62841.2.5:2015.

Jig or sabre saw-  
AS/NZS 60745.1 and AS/NZS 60745.2.11:2009.

Planer-  
AS/NZS 60745.1 and S/NZS 60745.2.14:2011 or  
AS/NZS 62841 and AS/NZS 62841.2.14:2016.

Router-  
AS/NZS 60745.1 and AS/NZS 60745.2.17:2011.

Grinder, polisher and disk type sander-  
AS/NZS 60745.1 and AS/NZS 60745.2.3:2011+A1.

Chain saw-  
AS/NZS 60745.1 and AS/NZS 60745.2.13:2010+A1.

Jointer-  
AS/NZS 60745.1 and AS/NZS 60745.2.19:2011.

Other: (in the 60745 Series)  
AS/NZS 60745.1 and the appropriate AS/NZS 60745 Part 2 when published;

Other: (in the 62841 Series)  
AS/NZS 62841.1 and the appropriate AS/NZS 62841 when published;

Other (where an AS/NZS 60745 Part 2 or AS/NZS 62841 is not available)  
AS/NZS 3100 and AS/NZS 3160:2009 A1.

**54. VACUUM CLEANER** - an electrical appliance which –

- (a) is a household type;
- (b) is portable; and
- (c) removes dust, dirt or moisture and the like from floor coverings by suction; or
- (d) removes garden refuse from lawns or paths and the like by suction.

Class specification:  
Hand held garden type-  
AS/NZS 60335.1 and AS/NZS 60335.2.100:2003.

Other-  
AS/NZS 60335.1 and AS/NZS 60335.2.2:2010+A1-3.

**55. WALL SWITCH** - an electrical device which –

- (a) is an air-break switch;
- (b) is for connection to the wiring of an electrical installation;
- (c) is primarily for mounting on a vertical surface;
- (d) is manually opened and manually closed; and
- (e) has a rating not exceeding 20 A.

Class specification:  
AS/NZS 3100 and AS/NZS 3133:2013+A1-2 or  
AS/NZS 60669.1:2013 and AS/NZS 60669.2.1:2013.

**56. WASHING MACHINE** - an electrical appliance which –

- (a) is a household type; and
- (b) is used for washing clothes.

Class specification:

AS/NZS 60335.1 and AS/NZS 60335.2.7:2012+A1.

**57. WATER BED HEATER** - an electrical appliance which –

- (a) is for installation under a water bed envelope; and
- (b) heats water contained in that envelope;

and includes -

- (c) any associated control device.

Class specification:

AS/NZS 60335.1 and AS/NZS 60335.2.66:2012.

**58. WATER HEATER** - an electrical appliance which –

- (a) is for heating and storage of water for bathing, washing or similar purposes;
- (b) incorporates a heating element;
- (c) is unvented; and
- (d) has a storage capacity not less than 4.5 L nor more than 680 L.

or

- (e) is for heating water
- (f) is of the instantaneous type; and
- (g) incorporates live parts in contact with water.

Class specification:

Pressure storage -

AS/NZS 60335.1 and AS/NZS 60335.2.21:2013.

Instantaneous -

AS/NZS 60335.1 and AS/NZS 60335.2.35:2013.



**WORKERS COMPENSATION ACT 1987**

## NOTICE

(Concerning indexation of death benefits)

The State Insurance Regulatory Authority, pursuant to section 82 of the *Workers Compensation Act 1987*, declares, by this Notice, that each of the adjustable amounts specified in Column 1 of the following Table is, on and from **1st April 2017**, to be construed as the adjusted amount specified opposite it in Column 2 of the Table.

TABLE

Provision Specifying, or providing for, the adjustable amount	Column 1	Column 2
	Adjustable Amount	Adjusted Amount
WORKERS COMPENSATION ACT 1987		
s.25 (1)(a)	\$750,000.00	\$775,600.00
s.25 (1)(b)	\$66.60	\$138.90

(Latest Index Number: 272.7)

ANTHONY LEAN  
CHIEF EXECUTIVE  
STATE INSURANCE REGULATORY AUTHORITY

**WORKERS COMPENSATION ACT 1987**

## NOTICE

(Concerning indexation of weekly benefits applying to amendments made by the Workers Compensation Legislation Amendment Act 2012)

The State Insurance Regulatory Authority, pursuant to section 82 of the *Workers Compensation Act 1987*, declares, by this Notice, that each of the adjustable amounts specified in Column 1 of the following Table is, on and from **1st April 2017**, to be construed as the adjusted amount specified opposite it in Column 2 of the Table.

TABLE

Provision Specifying, or providing for, the adjustable amount	Column 1	Column 2
	Adjustable Amount	Adjusted Amount
WORKERS COMPENSATION ACT 1987		
s.34(1)	\$1,838.70	\$2,084.90
Sched 6, Part 19H, Clause 2(1)	\$906.25	\$1,027.60

(Latest Index Number: 272.7)

ANTHONY LEAN  
CHIEF EXECUTIVE  
STATE INSURANCE REGULATORY AUTHORITY

**WORKERS COMPENSATION ACT 1987**

## NOTICE

(Concerning indexation of weekly benefits without regard to amendments to weekly benefits made by the Workers Compensation Legislation Amendment Act 2012)

The State Insurance Regulatory Authority, pursuant to section 82 of the *Workers Compensation Act 1987*, declares, by this Notice, that each of the adjustable amounts specified in Column 1 of the following Table is, on and from **1st April 2017**, to be construed as the adjusted amount specified opposite it in Column 2 of the Table.

TABLE

Provision Specifying, or providing for, the adjustable amount	Column 1	Column 2
	Adjustable Amount	Adjusted Amount
WORKERS COMPENSATION ACT 1987 (without regard to amendments to weekly benefits made by the <i>Workers Compensation Legislation Amendment Act 2012</i> )		
s.35	\$1,000.00	\$2,084.90
s.37 (1)(a)(i)	\$235.20	\$490.40
s.37 (1)(a)(ii)	\$187.10	\$390.10
s.37 (1)(a)(iii)	\$170.00	\$354.40
	\$153.00	\$319.00
s.37 (1)(b)	\$62.00	\$129.30
s.37 (1)(c)	\$44.30	\$92.40
	\$99.10	\$206.60
	\$164.16	\$342.30
	\$230.90	\$481.40
	\$66.60	\$138.90
s.40	\$1,000.00	\$2,084.90
Sched 6 Part 4 clause 7	\$341.30	\$711.60

(Latest Index Number: 272.7)

ANTHONY LEAN  
CHIEF EXECUTIVE  
STATE INSURANCE REGULATORY AUTHORITY

### WORKERS COMPENSATION ACT 1987

#### NOTICE

(Concerning indexation of benefits covered by the former Workers Compensation Act 1926)

The State Insurance Regulatory Authority, pursuant to Schedule 6 of the *Workers Compensation Act 1987*, declares, by this Notice, that each of the adjustable amounts specified in Column 1 of the following Table is, on and from **1st April 2017**, to be construed as the adjusted amount specified opposite it in Column 2 of the Table.

TABLE

Provision Specifying, or providing for, the adjustable amount	Column 1	Column 2
	Adjustable Amount	Adjusted Amount
WORKERS COMPENSATION ACT 1987		
Sched 6 Part 3 clause 2(2)	\$76,700.00	\$159,950.00
Sched 6 Part 3 clause 2(3)	\$38.30	\$79.90
Sched 6 Part 4 clause 4 (1)(b)(i)	\$44.80	\$93.40
Sched 6 Part 4 clause 4 (1)(b)(ii)	\$22.50	\$46.90
Sched 6 Part 4 clause 4A (2)(a)	\$196.00	\$408.60
Sched 6 Part 4 clause 4A (2)(b)	\$155.90	\$325.00
Sched 6 Part 4 clause 4A (2)(c)	\$141.60	\$295.20
Sched 6 Part 4 clause 4A (2)(c)	\$127.50	\$265.80

(Latest Index Number: 272.7)

ANTHONY LEAN  
CHIEF EXECUTIVE  
STATE INSURANCE REGULATORY AUTHORITY

**WORKERS' COMPENSATION (DUST DISEASES) ACT 1942**

## NOTICE

(Concerning indexation of death benefits)

The State Insurance Regulatory Authority, pursuant to section 82 of the *Workers Compensation Act 1987* as applied by section 8(3)(d) of the *Workers Compensation (Dust Diseases) Act 1942*, declares, by this Notice, that each of the adjustable amounts specified in Column 1 of the following Table is, on and from **1st April 2017**, to be construed as the adjusted amount specified opposite it in Column 2 of the Table.

TABLE

Provision Specifying, or providing for, the adjustable amount	Column 1	Column 2
	Adjustable Amount	Adjusted Amount
WORKERS COMPENSATION (DUST DISEASES) ACT 1942		
s.8 (2B)(b)(i)	\$311,050.00	\$347,100.00
s.8 (2B)(b)(ii)	\$137.30	\$286.30
s.8 (2B)(b)(iii)	\$69.40	\$144.70

(Latest Index Number: 272.7)

ANTHONY LEAN  
CHIEF EXECUTIVE  
STATE INSURANCE REGULATORY AUTHORITY

**WORKPLACE INJURY MANAGEMENT AND WORKERS COMPENSATION ACT 1998**

## NOTICE

(Concerning indexation of interim payment direction for payment of medical expenses compensation)

The State Insurance Regulatory Authority, pursuant to section 82 of the *Workers Compensation Act 1987*, declares, by this Notice, that the adjustable amount specified in Column 1 of the following Table is, on and from **1st April 2017**, to be construed as the adjusted amount specified opposite it in Column 2 of the Table.

TABLE

Provision Specifying, or providing for, the adjustable amount	Column 1	Column 2
	Adjustable Amount	Adjusted Amount
WORKPLACE INJURY MANAGEMENT AND WORKERS COMPENSATION ACT 1998		
s.297(2)	\$7,500.00	\$8,990.10

(Latest Index Number: 272.7)

ANTHONY LEAN  
CHIEF EXECUTIVE  
STATE INSURANCE REGULATORY AUTHORITY

## Appointments

---

### EDUCATION STANDARDS AUTHORITY ACT 2013

#### NOTIFICATION OF AN APPOINTMENT TO THE NSW EDUCATION STANDARDS AUTHORITY BOARD

I, ROB STOKES Minister for Education in pursuance of S6(2)(a) of the NSW *Education Standards Authority Act 2013* appoint Mr Tom Alegounarias as Chairperson of the governing Board of the NSW Education Standards Authority for a term commencing on and from 1 January 2017 until 31 December 2019.

Rob Stokes  
Minister for Education

---

### EDUCATION STANDARDS AUTHORITY ACT 2013

#### NOTIFICATION OF AN APPOINTMENT TO THE NSW EDUCATION STANDARDS AUTHORITY BOARD

I, ROB STOKES Minister for Education in pursuance of S6(2)(b)(iii) of the NSW *Education Standards Authority Act 2013* appoint Professor Paul Chandler as a member of the governing Board of the New South Wales Education Standards Authority for a term commencing on and from 1 January 2017 until 31 December 2019.

Rob Stokes  
Minister for Education

---

### EDUCATION STANDARDS AUTHORITY ACT 2013

#### NOTIFICATION OF AN APPOINTMENT TO THE NSW EDUCATION STANDARDS AUTHORITY BOARD

I, ROB STOKES Minister for Education in pursuance of S6(2)(b)(i) of the NSW *Education Standards Authority Act 2013* appoint Dr Brian Croke as member of the governing Board of the New South Wales Education Standards Authority for a term commencing on and from 1 January 2017 until 31 December 2019.

Rob Stokes  
Minister for Education

---

### EDUCATION STANDARDS AUTHORITY ACT 2013

#### NOTIFICATION OF AN APPOINTMENT TO THE NSW EDUCATION STANDARDS AUTHORITY BOARD

I, ROB STOKES Minister for Education in pursuance of S6(2)(c) of the NSW *Education Standards Authority Act 2013* appoint Professor Susan Dockett as a member of the governing Board of the New South Wales Education Standards Authority for a term commencing on and from 1 January 2017 until 31 December 2019.

Rob Stokes  
Minister for Education

---

### EDUCATION STANDARDS AUTHORITY ACT 2013

#### NOTIFICATION OF AN APPOINTMENT TO THE NSW EDUCATION STANDARDS AUTHORITY BOARD

I, ROB STOKES Minister for Education in pursuance of S6(2)(b)(ii) of the NSW *Education Standards Authority Act 2013* appoint Mr Denis Fitzgerald as a member of the governing Board of the New South Wales Education Standards Authority for a term commencing on and from 1 January 2017 until 31 December 2019.

Rob Stokes  
Minister for Education

---

**EDUCATION STANDARDS AUTHORITY ACT 2013**

NOTIFICATION OF AN APPOINTMENT TO THE NSW EDUCATION STANDARDS AUTHORITY BOARD

I, ROB STOKES Minister for Education in pursuance of S6(2)(c) of the NSW *Education Standards Authority Act 2013* appoint Ms Katherine Grace as a member of the governing Board of the New South Wales Education Standards Authority for a term commencing on and from 1 January 2017 until 31 December 2019.

Rob Stokes  
Minister for Education

---

**EDUCATION STANDARDS AUTHORITY ACT 2013**

NOTIFICATION OF AN APPOINTMENT TO THE NSW EDUCATION STANDARDS AUTHORITY BOARD

I, ROB STOKES Minister for Education in pursuance of S6(2)(c) of the NSW *Education Standards Authority Act 2013* appoint Ms Robyn McKerihan PSM as a member of the governing Board of the New South Wales Education Standards Authority for a term commencing on and from 1 January 2017 until 31 December 2019.

Rob Stokes  
Minister for Education

---

**EDUCATION STANDARDS AUTHORITY ACT 2013**

NOTIFICATION OF AN APPOINTMENT TO THE NSW EDUCATION STANDARDS AUTHORITY BOARD

I, ROB STOKES Minister for Education in pursuance of S6(2)(c) of the NSW *Education Standards Authority Act 2013* appoint Mrs Iris Nastasi as a member of the governing Board of the New South Wales Education Standards Authority for a term commencing on and from 1 January 2017 until 31 December 2019.

Rob Stokes  
Minister for Education

---

**EDUCATION STANDARDS AUTHORITY ACT 2013**

NOTIFICATION OF AN APPOINTMENT TO THE NSW EDUCATION STANDARDS AUTHORITY BOARD

I, ROB STOKES Minister for Education in pursuance of S6(2)(b)(i) of the NSW *Education Standards Authority Act 2013* appoint Dr Geoffrey Newcombe as member of the governing Board of the New South Wales Education Standards Authority for a term commencing on and from 1 January 2017 until 31 December 2019.

Rob Stokes  
Minister for Education

---

**EDUCATION STANDARDS AUTHORITY ACT 2013**

NOTIFICATION OF AN APPOINTMENT TO THE NSW EDUCATION STANDARDS AUTHORITY BOARD

I, ROB STOKES Minister for Education in pursuance of S6(2)(b)(ii) of the NSW *Education Standards Authority Act 2013* appoint Mr Mark Northam as a member of the governing Board of the New South Wales Education Standards Authority for a term commencing on and from 1 January 2017 until 31 December 2019.

Rob Stokes  
Minister for Education

**EDUCATION STANDARDS AUTHORITY ACT 2013**

NOTIFICATION OF AN APPOINTMENT TO THE NSW EDUCATION STANDARDS AUTHORITY BOARD

I, ROB STOKES Minister for Education in pursuance of S6(2)(c) of the NSW *Education Standards Authority Act 2013* appoint Mr Craig Petersen as a member of the governing Board of the New South Wales Education Standards Authority for a term commencing on and from 1 January 2017 until 31 December 2019.

Rob Stokes  
Minister for Education

---

**EDUCATION STANDARDS AUTHORITY ACT 2013**

NOTIFICATION OF AN APPOINTMENT TO THE NSW EDUCATION STANDARDS AUTHORITY BOARD

I, ROB STOKES Minister for Education in pursuance of S6(2)(b)(i) of the NSW *Education Standards Authority Act 2013* appoint Mr Mark Scott AO as a member of the governing Board of the NSW Education Standards Authority for a term commencing on and from 1 January 2017 until 31 December 2019.

Rob Stokes  
Minister for Education

---

**EDUCATION STANDARDS AUTHORITY ACT 2013**

NOTIFICATION OF AN APPOINTMENT TO THE NSW EDUCATION STANDARDS AUTHORITY BOARD

I, ROB STOKES Minister for Education in pursuance of S6(2)(c) of the NSW *Education Standards Authority Act 2013* appoint Ms Carol Taylor as a member of the governing Board of the New South Wales Education Standards Authority for a term commencing on and from 1 January 2017 until 31 December 2019.

Rob Stokes  
Minister for Education

---

**INDUSTRIAL RELATIONS ACT 1996**

APPOINTMENT OF ACTING CHIEF COMMISSIONER

INDUSTRIAL RELATIONS COMMISSION OF NSW

Notice is hereby given that, I, Dominic Perrottet, Minister for Industrial Relations, in pursuance of Clause 1(1) of Schedule 2 of the Industrial Relations Act 1996, have appointed **INAAM TABBAA AM** as Acting Chief Commissioner of the Industrial Relations Commission of New South Wales for the period commencing on 4 March 2017 and expiring on the day immediately before the position is filled on a substantive basis, or on 31 March 2017, **whichever is the sooner**

DOMINIC PERROTTET, MP  
Minister for Industrial Relations

## Roads and Maritime Notices

---

### ROADS ACT 1993

#### LAND ACQUISITION (JUST TERMS COMPENSATION) ACT 1991

Notice of Compulsory Acquisition of Land at Wallarah, Tuggerah and Wyong in the Central Coast Council Area Roads and Maritime Services by its delegate declares, with the approval of His Excellency the Governor, that the land described in the schedule below is acquired by compulsory process under the provisions of the *Land Acquisition (Just Terms Compensation) Act 1991* for the purposes of the *Roads Act 1993*.

K DURIE

Manager, Compulsory Acquisition & Road Dedication  
Roads and Maritime Services

#### Schedule

All those pieces or parcels of land situated in the Central Coast Council area, Parishes of Munmorah and Tuggerah and County of Northumberland, shown as:

Lots 2 and 3 Deposited Plan 1225069, being part of the land in Certificate of Title 1013/1191599;

Lot 5 Deposited Plan 1225795, being part of the land in Certificate of Title 1014/1191621 ;

Lot 6 Deposited Plan 1225795, being part of the land in Certificate of Title 1/1002949;

Lots 7 to 12 inclusive Deposited Plan 1225795, being part of the land in Certificate of Title 2/1002949;

Lot 13 Deposited Plan 1225795, being part of the land in Auto Consol 1347-79; and

Lot 3 Deposited Plan 1002949, being the whole of the land in Certificate of Title 3/1002949.

The land is said to be in the possession of Rail Corporation New South Wales.

(RMS Papers: SF2016/230856; RO SF2015/105644)

---

### ROADS ACT 1993

Notice of Dedication of Land as Public Road at Tumbarumba in the Tumbarumba Shire Council Area Roads and Maritime Services, by its delegate, dedicates the land described in the schedule below as public road under section 10 of the *Roads Act 1993*.

K DURIE

Manager, Compulsory Acquisition & Road Dedication  
Roads and Maritime Services

#### Schedule

All those pieces or parcels of land situated in Tumbarumba Shire Council area, Parish of Tumbarumba and County of Selwyn, shown as Lots 110 to 118 inclusive Deposited Plan 1187751 and Lots 58 to 62 inclusive Deposited Plan 1191690.

(RMS Papers: SF2017/046779; RO SF2012/011319)

---

### ROADS ACT 1993

Notice of Dedication of Land as Public Road at Morans Crossing in the Bega Valley Shire Council Area Roads and Maritime Services, by its delegate, dedicates the land described in the schedule below as public road under section 10 of the *Roads Act 1993*.

K DURIE

Manager, Compulsory Acquisition & Road Dedication  
Roads and Maritime Services

#### Schedule

All those pieces or parcels of land situated in the Bega Valley Shire Council area, Parish of Bemboka and County of Auckland, shown as Lots 401, 402 and 403 Deposited Plan 1193506.

(RMS Papers: SF2017/046796; RO SF2013/091393)

---



## Primary Industries Notices

---

### APIARIES ACT 1985

#### Appointment of Inspector

I, PETER DAY, Director General of the Department of Primary Industries pursuant to section 5 (1) of the *Apiaries Act 1985* (“the Act”) hereby appoint Rebecca LYSAGHT as an inspector for the purposes of this Act.

Dated this 8th day March 2017

PETER DAY

Director, Biosecurity & Food Safety Compliance

Department of Primary Industries

(an office within the Department of Industry, Skills and Regional Development)

---

### EXHIBITED ANIMALS PROTECTION ACT 1986

#### Appointment of Inspectors

I, PETER DAY, Director, Biosecurity & Food Safety Compliance, Department of Primary Industries with the delegated authority of the Secretary of the Department of Industry, Skills and Regional Development pursuant to section 38 of the *Exhibited Animals Protection Act 1986* (“the Act”), hereby appoint those named in the schedule below, as inspectors for the purposes of the Act.

Adrian KNOBEL

Aimee URBAN

Rebecca LYSAGHT

Darren BUTT

Daryl COOPER

David DEANE

David HASLETT

David SINCLAIR

Genevieve LEONARD

Hollie MUNRO

Kathy GOULDING

Mark MACKIE

Michael CAGNACCI

Michael RANKMORE

Mick THOMPSON

Peter TRELOAR

Ross TAYLOR

Ala SAMARA

Brett KERRUISH

Dated this 8th day of March 2017

PETER DAY

Director, Biosecurity & Food Safety Compliance

Department of Primary Industries

(an office within the Department of Industry, Skills and Regional Development)

---

### HEMP INDUSTRY ACT 2008

#### Section 18 Notification – Appointment of Inspectors

I, PETER DAY, Director Biosecurity & Food Safety Compliance, of the Department of Primary Industries, pursuant to Section 18 (1) of the *Hemp Industry Act 2008* (“the Act”), hereby appoint the persons named in the Schedule below, as inspectors for the purposes of this Act.

#### SCHEDULE

Aimee URBAN

Alicia MELLBERG

Rebecca LYSAGHT

Brett DALLISTON



Darren BUTT  
Daryl COOPER  
David HASLETT  
David SINCLAIR  
Hollie MUNRO  
James BOYCE  
Mark MACKIE  
Michael CAGNACCI  
Michael RANKMORE  
Mick THOMPSON  
Peter TRELOAR  
Ross TAYLOR  
Ala SAMARA  
Elizabeth YEATMAN

Dated this 8th day of March 2017

PETER DAY  
Director, Biosecurity & Food Safety Compliance  
Department of Primary Industries  
(an office within the Department of Industry, Skills and Regional Development)

---

### **STOCK DISEASES ACT 1923**

#### Appointment of Inspectors

I, PETER DAY, Director, Biosecurity & Food Safety Compliance, Department of Primary Industries with the delegated authority of the Secretary of the Department of Industry, Skills and Regional Development pursuant to section 22C of the *Stock Diseases Act 1923* (“the Act”) and pursuant to section 6(1) of the Act, hereby appoint Kirstin VAN RIEL, Kyra O’BRIEN, Lucy COLLINGRIDGE, Richard ALI, Grant DAVIS and Michelle WHILEY as inspectors for the purposes of the Act.

Dated this 7th day of March 2017

PETER DAY  
Director, Biosecurity & Food Safety Compliance  
Department of Primary Industries  
(an office within the Department of Industry, Skills and Regional Development)

# Crown Lands Notices

1300 886 235 [www.crownland.nsw.gov.au](http://www.crownland.nsw.gov.au)

## ARMIDALE OFFICE

### APPOINTMENT OF TRUST BOARD MEMBERS

Pursuant to section 93 of the *Crown Lands Act 1989*, the persons whose names are specified in Column 1 of the Schedule hereunder are appointed, for the terms of office specified in that Column, as members of the trust board for the reserve trust specified opposite thereto in Column 2, which has been established and appointed as trustee of the reserve referred to opposite thereto in Column 3 of the Schedule.

The Hon Paul Toole, MP  
Minister for Lands and Forestry

#### SCHEDULE

COLUMN 1	COLUMN 2	COLUMN 3
Stephen Paul Parry (re-appointment)  For a term commencing the date of this notice and expiring 31 December 2019.	Ben Lomond Recreation Reserve Trust	Reserve No. 37235 Public Purpose: Public Recreation Notified: 13 February 1904 File Reference: AE83R31-003

## DUBBO OFFICE

### NOTICE OF PURPOSE OTHER THAN THE DECLARED PURPOSE PURSUANT TO SECTION 34A(2)(b) OF THE CROWN LANDS ACT 1989

Pursuant to section 34A(2)(b) of the *Crown Lands Act 1989*, the Crown reserve(s) specified in Column 2 of the Schedule is to be used or occupied under a relevant interest granted for the purpose(s) specified in Column 1 of the Schedule where such use or occupation is other than the declared purpose of the reserve

The Hon Paul Toole, MP  
Minister for Lands and Forestry

#### SCHEDULE

COLUMN 1	COLUMN 2
PIPELINE; PUMP SITE; GRAZING	Reserve No. 750744 Public Purpose: Future Public Requirements Notified: 29 June 2007 File Reference: 16/09038

## GOULBURN OFFICE

### NOTICE OF PURPOSE OTHER THAN THE DECLARED PURPOSE PURSUANT TO SECTION 34A(2)(b) OF THE CROWN LANDS ACT 1989

Pursuant to section 34A(2)(b) of the *Crown Lands Act 1989*, the Crown reserve(s) specified in Column 2 of the Schedule is to be used or occupied under a relevant interest granted for the purpose(s) specified in Column 1 of the Schedule where such use or occupation is other than the declared purpose of the reserve

The Hon Paul Toole, MP  
Minister for Lands and Forestry

#### SCHEDULE

COLUMN 1	COLUMN 2
ACCESS	Reserve No. 89571 Public Purpose: Future Public Requirements Notified: 29 August 1975 File Reference: 16/08301

---

**SCHEDULE**

<b>COLUMN 1</b>	<b>COLUMN 2</b>
RECREATION	Reserve No. 91334 Public Purpose: After Auction Purchase Notified: 1 December 1978 File Reference: 17/00646 Reserve No. 751298 Public Purpose: Future Public Requirements Notified: 29 June 2007 File Reference: 17/00646

---

**GRAFTON OFFICE**

---

**NOTIFICATION OF CLOSING OF A ROAD**

In pursuance of the provisions of the *Roads Act 1993*, the road hereunder described is closed and the lands comprised therein cease to be public road and the rights of passage and access that previously existed in relation to the road is extinguished. Upon closing, title to the land, comprising the former public road, vests in the body specified in the Schedule hereunder.

The Hon Paul Toole, MP  
Minister for Lands and Forestry

**DESCRIPTION**

*Parishes – Cooma, The Brothers; County – Beresford  
Land District – Cooma; LGA – Snowy Monaro Regional*

Road Closed: Lot 1 DP 1222094

File No: 16/01534

**SCHEDULE**

On closing, the land within Lot 1 DP 1222094 remains vested in the State of New South Wales as Crown land.

---

**NOTIFICATION OF CLOSING OF A ROAD**

In pursuance of the provisions of the *Roads Act 1993*, the road hereunder described is closed and the lands comprised therein cease to be public road and the rights of passage and access that previously existed in relation to the road is extinguished. Upon closing, title to the land, comprising the former public road, vests in the body specified in the Schedule hereunder.

The Hon Paul Toole, MP  
Minister for Lands and Forestry

**DESCRIPTION**

*Parish – Bungawalbin; County – Richmond  
Land District – Lismore; LGA – Richmond Valley*

Road Closed: Lot 1 DP 1208372

File No: 14/07333

**SCHEDULE**

On closing, the land within Lot 1 DP 1208372 remains vested in the State of New South Wales as Crown land.

---

**NOTIFICATION OF CLOSING OF A ROAD**

In pursuance of the provisions of the *Roads Act 1993*, the road hereunder described is closed and the lands comprised therein cease to be public road and the rights of passage and access that previously existed in relation to the road is extinguished. Upon closing, title to the land, comprising the former public road, vests in the body specified in the Schedule hereunder.

The Hon Paul Toole, MP  
Minister for Lands and Forestry

**DESCRIPTION**

*Parish – Falconer; County – Sandon  
Land District – Armidale; LGA – Armidale Regional*

Road Closed: Lot 7 DP 1227957

File No: 16/04352

**SCHEDULE**

On closing, the land within Lot 7 DP 1227957 remains vested in the State of New South Wales as Crown land.

---

**NOTIFICATION OF CLOSING OF A ROAD**

In pursuance of the provisions of the *Roads Act 1993*, the road hereunder described is closed and the lands comprised therein cease to be public road and the rights of passage and access that previously existed in relation to the road is extinguished. Upon closing, title to the land, comprising the former public road, vests in the body specified in the Schedule hereunder.

The Hon Paul Toole, MP  
Minister for Lands and Forestry

**DESCRIPTION**

*Parish – Clifden; County – Clarence  
Land District – Grafton; LGA – Clarence Valley*

Road Closed: Lot 1 DP 1225100

File No: 14/08514

**SCHEDULE**

On closing, the land within Lot 1 DP 1225100 remains vested in the State of New South Wales as Crown land.

---

**NOTIFICATION OF CLOSING OF A ROAD**

In pursuance of the provisions of the *Roads Act 1993*, the road hereunder described is closed and the lands comprised therein cease to be public road and the rights of passage and access that previously existed in relation to the road is extinguished. Upon closing, title to the land, comprising the former public road, vests in the body specified in the Schedule hereunder.

The Hon Paul Toole, MP  
Minister for Lands and Forestry

**DESCRIPTION**

*Parish – Bumble; County – Courallie  
Land District – Moree; LGA – Moree Plains*

Road Closed: Lot 1 DP 1226199

File No: ME06H186

**SCHEDULE**

On closing, the land within Lot 1 DP 1226199 remains vested in the State of New South Wales as Crown land.

**NOTIFICATION OF CLOSING OF A ROAD**

In pursuance of the provisions of the *Roads Act 1993*, the road hereunder described is closed and the lands comprised therein cease to be public road and the rights of passage and access that previously existed in relation to the road is extinguished. Upon closing, title to the land, comprising the former public road, vests in the body specified in the Schedule hereunder.

The Hon Paul Toole, MP  
Minister for Lands and Forestry

**DESCRIPTION**

*Parish – Umbri; County – Benarba  
Land District – Moree; LGA – Moree Plains*

Road Closed: Lot 1 DP 1227958  
File No: 08/10120

**SCHEDULE**

On closing, the land within Lot 1 DP 1227958 remains vested in the State of New South Wales as Crown land.

---

**NOTIFICATION OF CLOSING OF A ROAD**

In pursuance of the provisions of the *Roads Act 1993*, the road hereunder described is closed and the lands comprised therein cease to be public road and the rights of passage and access that previously existed in relation to the road is extinguished. Upon closing, title to the land, comprising the former public road, vests in the body specified in the Schedule hereunder.

The Hon Paul Toole, MP  
Minister for Lands and Forestry

**DESCRIPTION**

*Parish – Cooma; County – White  
Land District – Narrabri; LGA – Narrabri*

Road Closed: Lots 1-4 DP 1226660  
File No: 11/04202

**SCHEDULE**

On closing, the land within Lots 1-4 DP 1226660 remains vested in the State of New South Wales as Crown land.

---

**NOTIFICATION OF CLOSING OF A ROAD**

In pursuance of the provisions of the *Roads Act 1993*, the road hereunder described is closed and the lands comprised therein cease to be public road and the rights of passage and access that previously existed in relation to the road is extinguished. Upon closing, title to the land, comprising the former public road, vests in the body specified in the Schedule hereunder.

The Hon Paul Toole, MP  
Minister for Lands and Forestry

**DESCRIPTION**

*Parish – Munro; County – Murchison  
Land District – Inverell; LGA – Gwydir*

Road Closed: Lots 1-3 DP 1225851  
File No: 07/2659

**SCHEDULE**

On closing, the land within Lots 1-3 DP 1225851 remains vested in the State of New South Wales as Crown land.

**NOTIFICATION OF CLOSING OF A ROAD**

In pursuance of the provisions of the *Roads Act 1993*, the road hereunder described is closed and the lands comprised therein cease to be public road and the rights of passage and access that previously existed in relation to the road is extinguished. Upon closing, title to the land, comprising the former public road, vests in the body specified in the Schedule hereunder.

The Hon Paul Toole, MP  
Minister for Lands and Forestry

**DESCRIPTION**

*Parish – Jinglemoney; County – Murray*

*Land District – Braidwood; LGA – Queanbeyan-Palerang Regional*

Road Closed: Lot 15 DP 1116227

File No: 16/10092

**SCHEDULE**

On closing, the land within Lot 15 DP 1116227 remains vested in the State of New South Wales as Crown land.

---

**NOTIFICATION OF CLOSING OF A ROAD**

In pursuance of the provisions of the *Roads Act 1993*, the road hereunder described is closed and the lands comprised therein cease to be public road and the rights of passage and access that previously existed in relation to the road is extinguished. Upon closing, title to the land, comprising the former public road, vests in the body specified in the Schedule hereunder.

The Hon Paul Toole, MP  
Minister for Lands and Forestry

**DESCRIPTION**

*Parish – Arding; County – Sandon*

*Land District – Armidale; LGA – Uralla*

Road Closed: Lot 3 DP 1227959

File No: 14/02493

**SCHEDULE**

On closing, the land within Lot 3 DP 1227959 remains vested in the State of New South Wales as Crown land.

---

**NOTIFICATION OF CLOSING OF A ROAD**

In pursuance of the provisions of the *Roads Act 1993*, the road hereunder described is closed and the lands comprised therein cease to be public road and the rights of passage and access that previously existed in relation to the road is extinguished. Upon closing, title to the land, comprising the former public road, vests in the body specified in the Schedule hereunder.

The Hon Paul Toole, MP  
Minister for Lands and Forestry

**DESCRIPTION**

*Parish – Guy Fawkes; County – Clarke*

*Land District – Armidale; LGA – Armidale Regional*

Road Closed: Lot 2 DP 1227895

File No: 16/05697

**SCHEDULE**

On closing, the land within Lot 2 DP 1227895 remains vested in the State of New South Wales as Crown land.

**NOTIFICATION OF CLOSING OF A ROAD**

In pursuance of the provisions of the *Roads Act 1993*, the road hereunder described is closed and the lands comprised therein cease to be public road and the rights of passage and access that previously existed in relation to the road is extinguished. Upon closing, title to the land, comprising the former public road, vests in the body specified in the Schedule hereunder.

The Hon Paul Toole, MP  
Minister for Lands and Forestry

**DESCRIPTION**

*Parish – Leitch; County – Mitchell*  
*Land District – Wagga Wagga; LGA – Lockhart*

Road Closed: Lot 1 DP 1226603  
File No: 15/08036

**SCHEDULE**

On closing, the land within Lot 1 DP 1226603 remains vested in the State of New South Wales as Crown land.

---

**NOTIFICATION OF CLOSING OF A ROAD**

In pursuance of the provisions of the *Roads Act 1993*, the road hereunder described is closed and the lands comprised therein cease to be public road and the rights of passage and access that previously existed in relation to the road is extinguished. Upon closing, title to the land, comprising the former public road, vests in the body specified in the Schedule hereunder.

The Hon Paul Toole, MP  
Minister for Lands and Forestry

**DESCRIPTION**

*Parish – Leitch; County – Mitchell*  
*Land District – Wagga Wagga; LGA – Lockhart*

Road Closed: Lot 2 DP 1226602  
File No: 15/09669

**SCHEDULE**

On closing, the land within Lot 2 DP 1226602 remains vested in the State of New South Wales as Crown land.

---

**NOTIFICATION OF CLOSING OF A ROAD**

In pursuance of the provisions of the *Roads Act 1993*, the road hereunder described is closed and the lands comprised therein cease to be public road and the rights of passage and access that previously existed in relation to the road is extinguished. Upon closing, title to the land, comprising the former public road, vests in the body specified in the Schedule hereunder.

The Hon Paul Toole, MP  
Minister for Lands and Forestry

**DESCRIPTION**

*Parishes – Gineroi, Wyndham; Counties – Burnett, Murchison*  
*Land District – Bingara; LGA – Gwydir*

Road Closed: Lot 1 DP 1220500  
File No: 16/01429

**SCHEDULE**

On closing, the land within Lot 1 DP 1220500 remains vested in the State of New South Wales as Crown land.

### NOTIFICATION OF CLOSING OF A ROAD

In pursuance of the provisions of the *Roads Act 1993*, the road hereunder described is closed and the lands comprised therein cease to be public road and the rights of passage and access that previously existed in relation to the road is extinguished. Upon closing, title to the land, comprising the former public road, vests in the body specified in the Schedule hereunder.

The Hon Paul Toole, MP  
Minister for Lands and Forestry

#### DESCRIPTION

*Parish – South Gundurimba; County – Rous*

*Land District – Lismore; LGA – Lismore*

Road Closed: Lot 1 DP 1226378

File No: 16/05856

#### SCHEDULE

On closing, the land within Lot 1 DP 1226378 remains vested in the State of New South Wales as Crown land.

---

### NOTIFICATION OF CLOSING OF A ROAD

In pursuance of the provisions of the *Roads Act 1993*, the road hereunder described is closed and the lands comprised therein cease to be public road and the rights of passage and access that previously existed in relation to the road is extinguished. Upon closing, title to the land, comprising the former public road, vests in the body specified in the Schedule hereunder.

The Hon Paul Toole, MP  
Minister for Lands and Forestry

#### DESCRIPTION

*Parish – Mulwala; County – Denison*

*Land District – Cowra; LGA – Federation*

Road Closed: Lot 1 DP 1219809

File No: 15/02054

#### SCHEDULE

On closing, that part of the land within Lot 1 DP 1219809 comprising Crown public road remains vested in the State of New South Wales as Crown land.

On closing, that part of the land within Lot, 1 DP1219809 comprising unformed Council public road becomes vested in the State of New South Wales as Crown Land.

### GRIFFITH OFFICE

#### ERRATUM

In the Government Gazette of 17 February 2017, Folio 438, under the heading “Reservation of Crown Land” the diagram below specifies the Part Lot 7310 DP 1154028 being Reserve 1038949.

File GH89H730

The Hon Paul Toole, MP  
Minister for Lands and Forestry



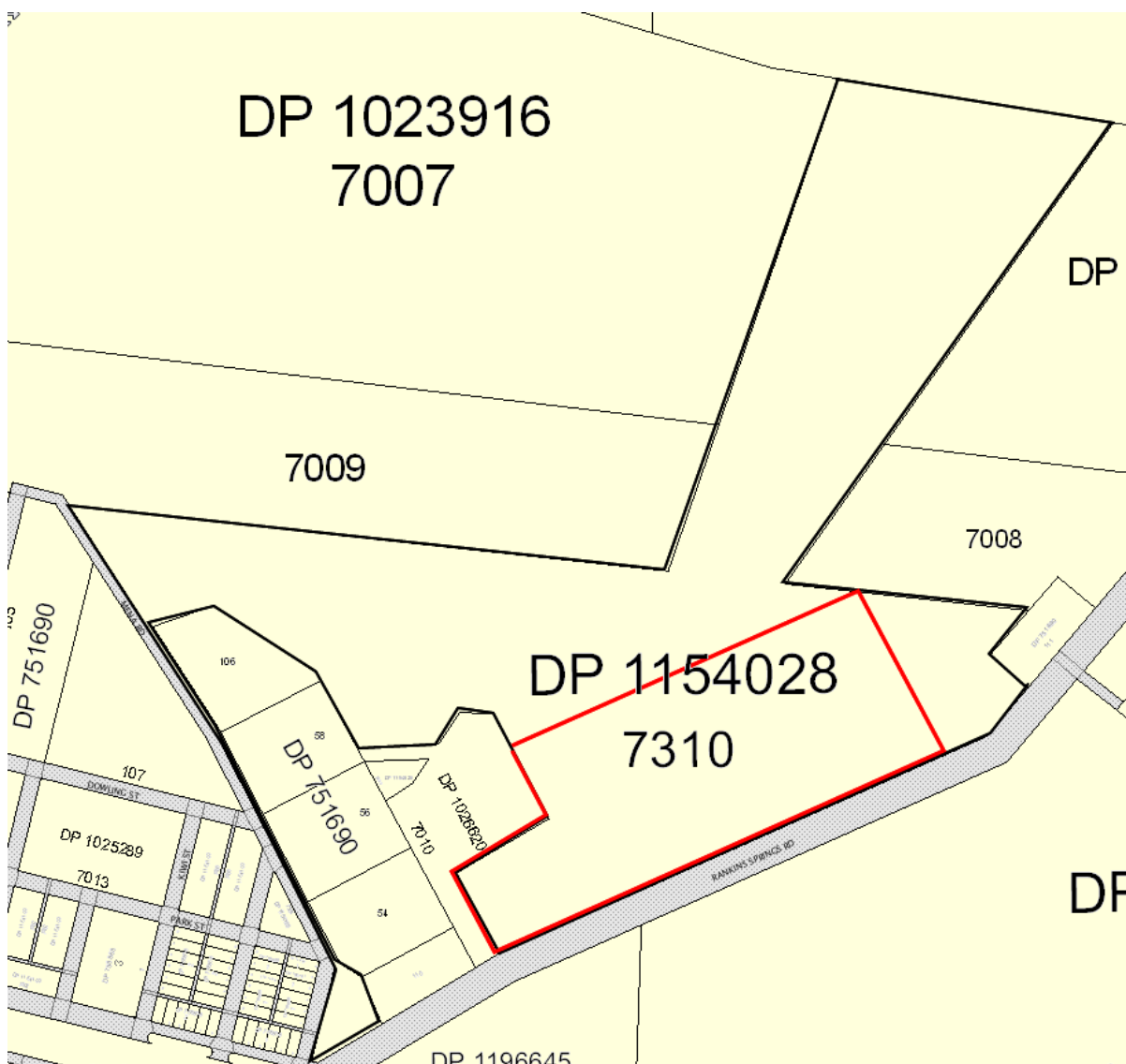

**MAITLAND OFFICE**

**NOTICE OF PURPOSE OTHER THAN THE DECLARED PURPOSE PURSUANT TO SECTION 34A(2)(b) OF THE CROWN LANDS ACT 1989**

Pursuant to section 34A(2)(b) of the *Crown Lands Act 1989*, the Crown reserve(s) specified in Column 2 of the Schedule is to be used or occupied under a relevant interest granted for the purpose(s) specified in Column 1 of the Schedule where such use or occupation is other than the declared purpose of the reserve

The Hon Paul Toole, MP  
Minister for Lands and Forestry

**SCHEDULE**

COLUMN 1	COLUMN 2
RECREATION	Reserve No. 755215 Public Purpose: Future Public Requirements Notified: 29 June 2007 File Reference: 17/00648

## MOREE OFFICE

### NOTICE OF PURPOSE OTHER THAN THE DECLARED PURPOSE PURSUANT TO SECTION 34A(2)(b) OF THE CROWN LANDS ACT 1989

Pursuant to section 34A(2)(b) of the *Crown Lands Act 1989*, the Crown reserve(s) specified in Column 2 of the Schedule is to be used or occupied under a relevant interest granted for the purpose(s) specified in Column 1 of the Schedule where such use or occupation is other than the declared purpose of the reserve

The Hon Paul Toole, MP  
Minister for Lands and Forestry

#### SCHEDULE

COLUMN 1	COLUMN 2
GRAZING	Reserve No. 19849 Public Purpose: Irrigation Notified: 31 March 1894 File Reference: 16/07338  Reserve No. 1116 Public Purpose: Access, Water Supply Notified: 28 February 1881 File Reference: 16/07338

#### SCHEDULE

COLUMN 1	COLUMN 2
DAM; AGRICULTURE	Reserve No. 80379 Public Purpose: Future Public Requirements Notified: 14 February 1958 File Reference: 16/07061

## NEWCASTLE OFFICE

### NOTIFICATION OF CLOSING OF A ROAD

In pursuance of the provisions of the *Roads Act 1993*, the road hereunder described is closed and the lands comprised therein cease to be public road and the rights of passage and access that previously existed in relation to the road is extinguished. Upon closing, title to the land, comprising the former public road, vests in the body specified in the Schedule hereunder.

The Hon Paul Toole, MP  
Minister for Lands and Forestry

#### DESCRIPTION

*Parish – Piallamore; County – Parry*

*Land District – Tamworth; LGA – Tamworth Regional*

Road Closed: Lot 2 DP 1226793

File No: 16/07274

#### SCHEDULE

On closing, the land within Lot 2 DP 1226793 remains vested in the State of New South Wales as Crown land.

### NOTIFICATION OF CLOSING OF A ROAD

In pursuance of the provisions of the *Roads Act 1993*, the road hereunder described is closed and the lands comprised therein cease to be public road and the rights of passage and access that previously existed in relation to the road is extinguished. Upon closing, title to the land, comprising the former public road, vests in the body specified in the Schedule hereunder.

The Hon Paul Toole, MP  
Minister for Lands and Forestry

**DESCRIPTION**

*Parish – Torrens; County – Macquarie*

*Land District – Port Macquarie; LGA – Port Macquarie-Hastings*

Road Closed: Lot 1 DP1228293

File No: 14/10101

**SCHEDULE**

On closing, the land within Lot 1 DP1228293 remains vested in Port Macquarie-Hastings Council as operational land for the purposes of the *Local Government Act 1993*.

Council Reference: SF12/13927

---

**NOTIFICATION OF CLOSING OF A ROAD**

In pursuance of the provisions of the *Roads Act 1993*, the road hereunder described is closed and the lands comprised therein cease to be public road and the rights of passage and access that previously existed in relation to the road is extinguished. Upon closing, title to the land, comprising the former public road, vests in the body specified in the Schedule hereunder.

The Hon Paul Toole, MP  
Minister for Lands and Forestry

**DESCRIPTION**

*Parish – Macquarie; County – Macquarie*

*Land District – Port Macquarie; LGA – Port Macquarie-Hastings*

Road Closed: Lot 1 DP1229040

File No: 16/06077

**SCHEDULE**

On closing, the land within Lot 1 DP1229040 remains vested in Port Macquarie-Hastings Council as operational land for the purposes of the *Local Government Act 1993*.

Council Reference: SF15/2483

---

**NOTIFICATION OF CLOSING OF A ROAD**

In pursuance of the provisions of the *Roads Act 1993*, the road hereunder described is closed and the lands comprised therein cease to be public road and the rights of passage and access that previously existed in relation to the road is extinguished. Upon closing, title to the land, comprising the former public road, vests in the body specified in the Schedule hereunder.

The Hon Paul Toole, MP  
Minister for Lands and Forestry

**DESCRIPTION**

*Parish – Goolma; County – Bligh*

*Land District – Wellington; LGA – Mid-Western Regional*

Road Closed: Lot 1 DP 1224727

File No: 16/04785

**SCHEDULE**

On closing, the land within Lot 1 DP 1224727 remains vested in the State of New South Wales as Crown land.

---

**NOTIFICATION OF CLOSING OF A ROAD**

In pursuance of the provisions of the *Roads Act 1993*, the road hereunder described is closed and the lands comprised therein cease to be public road and the rights of passage and access that previously existed in relation

to the road is extinguished. Upon closing, title to the land, comprising the former public road, vests in the body specified in the Schedule hereunder.

The Hon Paul Toole, MP  
Minister for Lands and Forestry

**DESCRIPTION**

*Parish – Tivy; County – Wellesley*  
*Land District – Bombala; LGA – Snowy Monaro Regional*

Road Closed: Lot 1 DP 1228302

File No: 16/08635

**SCHEDULE**

On closing, the land within Lot 1 DP 1228302 remains vested in the State of New South Wales as Crown land.

---

**NOTIFICATION OF CLOSING OF A ROAD**

In pursuance of the provisions of the *Roads Act 1993*, the road hereunder described is closed and the lands comprised therein cease to be public road and the rights of passage and access that previously existed in relation to the road is extinguished. Upon closing, title to the land, comprising the former public road, vests in the body specified in the Schedule hereunder.

The Hon Paul Toole, MP  
Minister for Lands and Forestry

**DESCRIPTION**

*Parishes – Waterbeach, Cunningham; Counties – Roxburgh, Wellington*  
*Land District – Bathurst; LGA – Bathurst Regional*

Road Closed: Lots 1-4 DP 1224493

File No: 12/03458

**SCHEDULE**

On closing, the land within Lots 1-4 DP 1224493 remains vested in the State of New South Wales as Crown land.

---

**NOTIFICATION OF CLOSING OF A ROAD**

In pursuance of the provisions of the *Roads Act 1993*, the road hereunder described is closed and the lands comprised therein cease to be public road and the rights of passage and access that previously existed in relation to the road is extinguished. Upon closing, title to the land, comprising the former public road, vests in the body specified in the Schedule hereunder.

The Hon Paul Toole, MP  
Minister for Lands and Forestry

**DESCRIPTION**

*Parish – Barbegal; County – Lincoln*  
*Land District – Dubbo; LGA – Dubbo Regional*

Road Closed: Lot 1 DP 1226337

File No: 12/06054

**SCHEDULE**

On closing, the land within Lot 1 DP 1226337 remains vested in the State of New South Wales as Crown land.

---

**NOTIFICATION OF CLOSING OF A ROAD**

In pursuance of the provisions of the *Roads Act 1993*, the road hereunder described is closed and the lands comprised therein cease to be public road and the rights of passage and access that previously existed in relation

to the road is extinguished. Upon closing, title to the land, comprising the former public road, vests in the body specified in the Schedule hereunder.

The Hon Paul Toole, MP  
Minister for Lands and Forestry

**DESCRIPTION**

*Parishes – Kempfield, Mulgunnia; County – Georgiana  
Land District – Blayney; LGA – Bathurst Regional*

Road Closed: Lot 1 DP 1225154

File No: CL/00622

**SCHEDULE**

On closing, the land within Lot 1 DP 1225154 remains vested in the State of New South Wales as Crown land.

---

**NOTIFICATION OF CLOSING OF A ROAD**

In pursuance of the provisions of the *Roads Act 1993*, the road hereunder described is closed and the lands comprised therein cease to be public road and the rights of passage and access that previously existed in relation to the road is extinguished. Upon closing, title to the land, comprising the former public road, vests in the body specified in the Schedule hereunder.

The Hon Paul Toole, MP  
Minister for Lands and Forestry

**DESCRIPTION**

*Parish – Kiama; County – Camden  
Land District – Kiama; LGA – Kiama*

Road Closed: Lot 1 DP 1221171

File No: 15/06237

**SCHEDULE**

On closing, the land within Lot 1 DP 1221171 remains vested in the State of New South Wales as Crown land.

---

**NOTIFICATION OF CLOSING OF A ROAD**

In pursuance of the provisions of the *Roads Act 1993*, the road hereunder described is closed and the lands comprised therein cease to be public road and the rights of passage and access that previously existed in relation to the road is extinguished. Upon closing, title to the land, comprising the former public road, vests in the body specified in the Schedule hereunder.

The Hon Paul Toole, MP  
Minister for Lands and Forestry

**DESCRIPTION**

*Parish – Alexandria; County – Cumberland  
Land District – Metropolitan; LGA – Randwick*

Road Closed: Lot 101 DP 1227486

File No: 15/08000

**SCHEDULE**

On closing, the land within Lot 101 DP 1227486 remains vested in Randwick City Council as operational land for the purposes of the *Local Government Act 1993*.

Council Reference: F2004/06116

**NOTIFICATION OF CLOSING OF A ROAD**

In pursuance of the provisions of the *Roads Act 1993*, the road hereunder described is closed and the lands comprised therein cease to be public road and the rights of passage and access that previously existed in relation to the road is extinguished. Upon closing, title to the land, comprising the former public road, vests in the body specified in the Schedule hereunder.

The Hon Paul Toole, MP  
Minister for Lands and Forestry

**DESCRIPTION**

*Parish – Balmoral; County – Durham*  
*Land District – Muswellbrook; LGA – Muswellbrook*

Road Closed: Lot 1 DP 1190803

File No: 12/02443

**SCHEDULE**

On closing, the land within Lot 1 DP 1190803 remains vested in the State of New South Wales as Crown land.

---

**NOTIFICATION OF CLOSING OF A ROAD**

In pursuance of the provisions of the *Roads Act 1993*, the road hereunder described is closed and the lands comprised therein cease to be public road and the rights of passage and access that previously existed in relation to the road is extinguished. Upon closing, title to the land, comprising the former public road, vests in the body specified in the Schedule hereunder.

The Hon Paul Toole, MP  
Minister for Lands and Forestry

**DESCRIPTION**

*Parish – Mulyan; County – Forbes*  
*Land District – Cowra; LGA – Cowra*

Road Closed: Lot 2 DP 1226890

File No: 15/06090

**SCHEDULE**

On closing, the land within Lot 2 DP 1226890 remains vested in the State of New South Wales as Crown land.

---

**NOTIFICATION OF CLOSING OF A ROAD**

In pursuance of the provisions of the *Roads Act 1993*, the road hereunder described is closed and the lands comprised therein cease to be public road and the rights of passage and access that previously existed in relation to the road is extinguished. Upon closing, title to the land, comprising the former public road, vests in the body specified in the Schedule hereunder.

The Hon Paul Toole, MP  
Minister for Lands and Forestry

**DESCRIPTION**

*Parish – Anson; County – Bathurst*  
*Land District – Orange; LGA – Cabonne*

Road Closed: Lots 1-3 DP 1225043

File No: 11/08768

**SCHEDULE**

On closing, the land within Lots 1 and 3 DP 1225043 remains vested in the State of New South Wales as Crown land.

On closing, the land within Lot 2 DP 1225043 becomes vested in the State of New South Wales as Crown Land.

Council's reference: W465294; Cluster 503986

### NOTIFICATION OF CLOSING OF A ROAD

In pursuance of the provisions of the *Roads Act 1993*, the road hereunder described is closed and the lands comprised therein cease to be public road and the rights of passage and access that previously existed in relation to the road is extinguished. Upon closing, title to the land, comprising the former public road, vests in the body specified in the Schedule hereunder.

The Hon Paul Toole, MP  
Minister for Lands and Forestry

#### DESCRIPTION

*Parish – Bulbodney; County – Kennedy  
Land District – Parkes; LGA – Lachlan*

Road Closed: Lot 1 DP 1223317  
File No: 16/04816:JT

#### SCHEDULE

On closing, the land within Lot 1 DP 1223317 remains vested in the State of New South Wales as Crown land.

---

### NOTIFICATION OF CLOSING OF A ROAD

In pursuance of the provisions of the *Roads Act 1993*, the road hereunder described is closed and the lands comprised therein cease to be public road and the rights of passage and access that previously existed in relation to the road is extinguished. Upon closing, title to the land, comprising the former public road, vests in the body specified in the Schedule hereunder.

The Hon Paul Toole, MP  
Minister for Lands and Forestry

#### DESCRIPTION

*Parish – Kundibakh; County – Gloucester  
Land District – Taree; LGA – Mid-Coast*

Road Closed: Lot 1 DP 1228017  
File No: 16/07074

#### SCHEDULE

On closing, the land within Lot 1 DP 1228017 remains vested in the State of New South Wales as Crown land.

## NOWRA OFFICE

### ROADS ACT 1993

#### ORDER

Transfer of a Crown Road to a Council

IN pursuance of the provisions of section 151, *Roads Act 1993*, the Crown roads specified in Schedule 1 is transferred to the Roads Authority specified in Schedule 2 hereunder, as from the date of publication of this notice and as from that date the roads specified in Schedule 1 cease to be a Crown road.

The Hon PAUL TOOLE, MP  
Minister for Lands and Forestry

#### Schedule 1

*Parish – Conjola; County – St Vincent  
Land District – Nowra; LGA – Shoalhaven*

Description: Crown road known as The Bounty (shown by red colour in diagram hereunder) at Cunjurong Point having an area of approx. 1.436 hectares.



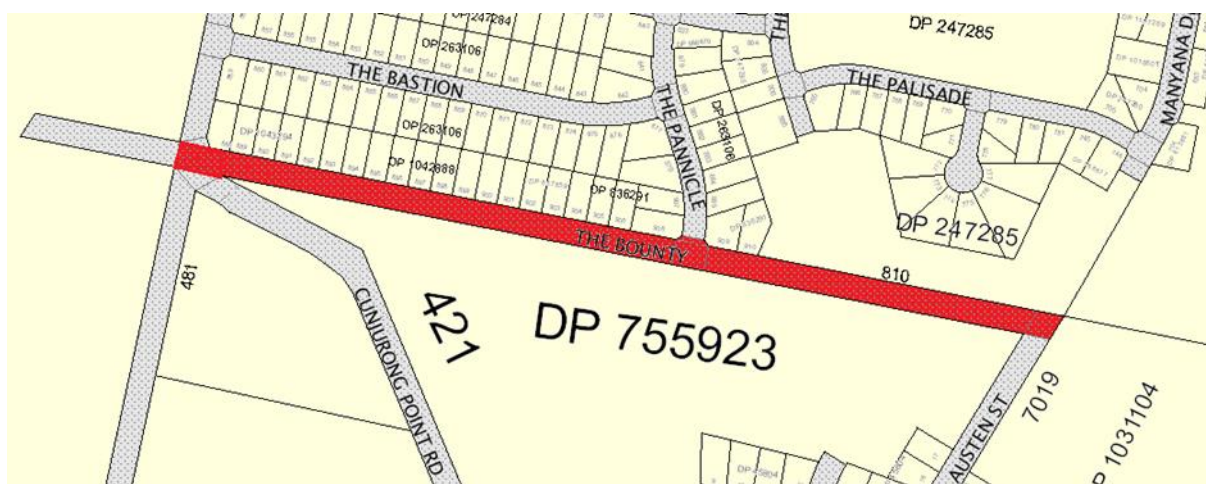

Road Authority: Shoalhaven City Council  
 Crown Lands File Ref: 17/02008 – W580451  
 Council Ref: SF9747-02 (D17/12862)

**NOTICE OF PURPOSE OTHER THAN THE DECLARED PURPOSE PURSUANT TO SECTION 34A(2)(b) OF THE CROWN LANDS ACT 1989**

Pursuant to section 34A(2)(b) of the *Crown Lands Act 1989*, the Crown reserve(s) specified in Column 2 of the Schedule is to be used or occupied under a relevant interest granted for the purpose(s) specified in Column 1 of the Schedule where such use or occupation is other than the declared purpose of the reserve

The Hon Paul Toole, MP  
 Minister for Lands and Forestry

**SCHEDULE**

<b>COLUMN 1</b>	<b>COLUMN 2</b>
ENVIRONMENTAL PROTECTION	Reserve No. 18792 Public Purpose: Trigonometrical Purposes Notified: 14 October 1893 File Reference: 16/09320

**ORANGE OFFICE**

**ROADS ACT 1993**

**ORDER**

Transfer of Crown Roads to Council

IN pursuance of the provisions of Section 151, *Roads Act 1993*, the Crown public road specified in Schedule 1 is transferred to the Roads Authority specified in Schedule 2, hereunder, as from the date of publication of this notice and as from that date, the road specified in Schedule 1 ceases to be a Crown public road.

The Hon Paul Toole, MP,  
 Minister for Lands and Forestry

**SCHEDULE 1**

*Parish – Beneree; County – Bathurst*

*Land District – Orange*

*Local Government Area – Blayney Shire Council*

The road known as Myers Lane as shown shaded on the diagram below.

Width to be transferred: Whole width



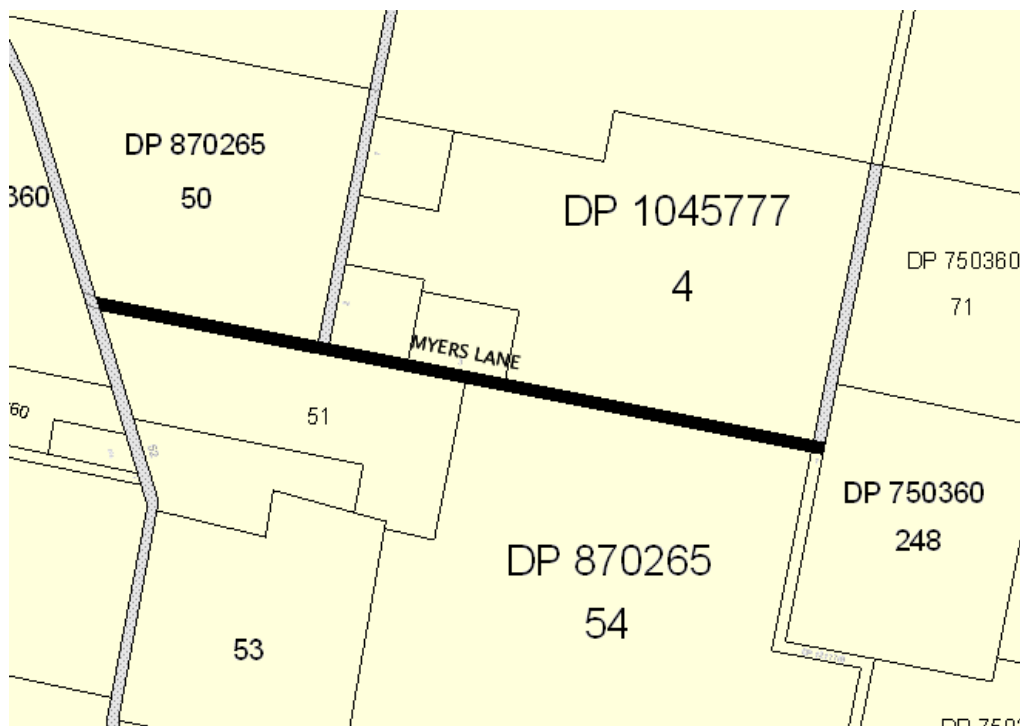

**SCHEDULE 2**

Roads Authority: Blayney Shire Council

Council Ref: G. Baker

File Ref:17/02378; W581061

**NOTICE OF PURPOSE OTHER THAN THE DECLARED PURPOSE PURSUANT TO SECTION 34A(2)(b) OF THE CROWN LANDS ACT 1989**

Pursuant to section 34A(2)(b) of the *Crown Lands Act 1989*, the Crown reserve(s) specified in Column 2 of the Schedule is to be used or occupied under a relevant interest granted for the purpose(s) specified in Column 1 of the Schedule where such use or occupation is other than the declared purpose of the reserve

The Hon Paul Toole, MP  
Minister for Lands and Forestry

**SCHEDULE**

<b>COLUMN 1</b>	<b>COLUMN 2</b>
GRAZING	Reserve No. 75119 Public Purpose: Public Utility Notified: 27 June 1952 File Reference: 16/05196

**SYDNEY METROPOLITAN OFFICE**

**RESERVATION OF CROWN LAND**

Pursuant to section 87 of the *Crown Lands Act 1989*, the Crown land specified in Column 1 of the schedule hereunder is reserved as specified opposite thereto in Column 2 of the Schedule.

The Hon Paul Toole, MP  
Minister for Lands and Forestry

## SCHEDULE

COLUMN 1	COLUMN 2
Land District: Metropolitan Local Government Area: Hornsby Shire Council Locality: Kangaroo Point  Lot 101 DP No 1223533 Parish Cowan County Cumberland  Area: About 1120.7m2 File Reference: 17/02319	Reserve No. 1038969 Public Purpose: Access, Public Recreation, Tourist Facilities and Services

## ESTABLISHMENT OF RESERVE TRUST

Pursuant to section 92(1) of the *Crown Lands Act 1989*, the reserve trust specified in Column 1 of the Schedule hereunder is established under the name stated in that Column and is appointed as trustee of the reserve specified opposite thereto in Column 2 of the Schedule.

The Hon Paul Toole, MP  
Minister for Lands and Forestry

## SCHEDULE

COLUMN 1	COLUMN 2
Kangaroo Point Wharf Reserve Trust	Reserve No. 1038969 Public Purpose: Access, Public Recreation, Tourist Facilities and Services Notified: This Day File Reference: 17/02319

## APPOINTMENT OF CORPORATION TO MANAGE RESERVE TRUST

Pursuant to section 95 of the *Crown Lands Act 1989*, the corporation specified in Column 1 of the Schedule hereunder is appointed to manage the affairs of the reserve trust specified opposite thereto in Column 2, which is trustee of the reserve referred to in Column 3 of the Schedule.

The Hon Paul Toole, MP  
Minister for Lands and Forestry

## SCHEDULE

COLUMN 1	COLUMN 2	COLUMN 3
Hornsby Shire Council  For a term commencing the date of this notice	Kangaroo Point Wharf Reserve Trust	Reserve No. 1038969 Public Purpose: Access, Public Recreation, Tourist Facilities and Services Notified: This Day File Reference: 17/02319

## TAREE OFFICE

## NOTICE OF PURPOSE OTHER THAN THE DECLARED PURPOSE PURSUANT TO SECTION 34A(2)(b) OF THE CROWN LANDS ACT 1989

Pursuant to section 34A(2)(b) of the *Crown Lands Act 1989*, the Crown reserve(s) specified in Column 2 of the Schedule is to be used or occupied under a relevant interest granted for the purpose(s) specified in Column 1 of the Schedule where such use or occupation is other than the declared purpose of the reserve

The Hon Paul Toole, MP

Minister for Lands and Forestry

**SCHEDULE**

<b>COLUMN 1</b>	<b>COLUMN 2</b>
SPORTING EVENT	Reserve No. 1011488 Public Purpose: Future Public Requirements Notified: 7 April 2006 File Reference: 17/02286

**WAGGA WAGGA OFFICE**

**NOTICE OF PURPOSE OTHER THAN THE DECLARED PURPOSE PURSUANT TO SECTION 34A(2)(b) OF THE CROWN LANDS ACT 1989**

Pursuant to section 34A(2)(b) of the *Crown Lands Act 1989*, the Crown reserve(s) specified in Column 2 of the Schedule is to be used or occupied under a relevant interest granted for the purpose(s) specified in Column 1 of the Schedule where such use or occupation is other than the declared purpose of the reserve

The Hon Paul Toole, MP  
Minister for Lands and Forestry

**SCHEDULE**

<b>COLUMN 1</b>	<b>COLUMN 2</b>
GRAZING	Reserve No. 81859 Public Purpose: Access Notified: 14 August 1959 File Reference: 14/10119

**WESTERN REGION OFFICE**

**ALTERATION OF CONDITIONS OF A WESTERN LANDS LEASE**

IT is hereby notified that in pursuance of the provisions of section 18FA (6) of the *Western Lands Act 1901*, the conditions of the undermentioned Western Lands Lease have been altered as shown.

The Hon PAUL TOOLE, MP  
Minister for Lands and Forestry

*Administrative District – Wilcannia*

*Shire – Central Darling*

*Parish/s – Perry, Hume & Titabaira County – Menindee & Tandora*

The conditions of Western Lands Lease 11928, being the land contained within Folio Identifier 4521/767598 have been altered effective from 6 March 2017.

As a consequence of the alteration of conditions rent will be assessed annually in line with the *Western Lands Act 1901* and Regulations.

The conditions have been altered by the inclusion of the special condition following;

**SPECIAL CONDITION ATTACHED TO WESTERN LANDS LEASE 11928**

1. The lessee shall only cultivate by irrigation an area of 312 ha as indicated by hatching on the diagram below.

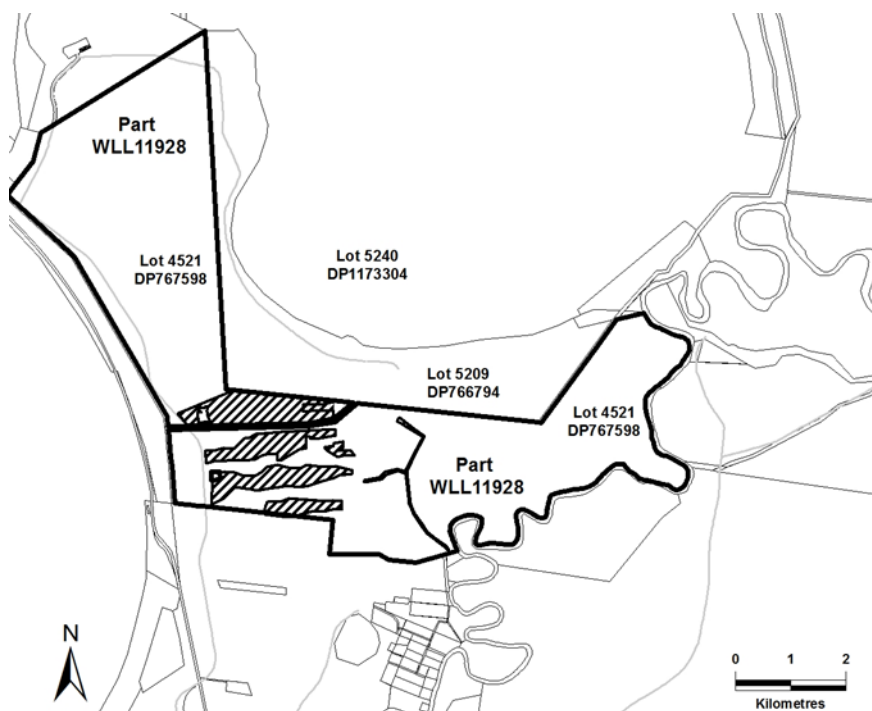

File Ref: 09/00266

**ERRATUM**

IN the notification appearing in the New South Wales Government Gazette of 3 March, 2017, Folio 580, appearing under the heading Extension Of The Term Of A Western Lands Lease, (being Western Lands Lease 14774) the Term of Lease should read:

Term of Lease	
From	To
12 June 2027	11 June 2047

**NOTICE OF PURPOSE OTHER THAN THE DECLARED PURPOSE PURSUANT TO SECTION 34A(2)(b) OF THE CROWN LANDS ACT 1989**

Pursuant to section 34A(2)(b) of the *Crown Lands Act 1989*, the Crown reserve(s) specified in Column 2 of the Schedule is to be used or occupied under a relevant interest granted for the purpose(s) specified in Column 1 of the Schedule where such use or occupation is other than the declared purpose of the reserve

The Hon Paul Toole, MP  
Minister for Lands and Forestry

**SCHEDULE**

COLUMN 1	COLUMN 2
AIR STRIP	Reserve No. 19267 Public Purpose: Travelling Stock Notified: 16 December 1893 File Reference: WL87H54-1 Reserve No. 75 Public Purpose: Temporary Common Notified: 25 June 1883 File Reference: WL87H54-1 Reserve No. 1013795 Public Purpose: Future Public Requirements Notified: 29 June 2007 File Reference: WL87H54-1

## Other Government Notices

### ASSOCIATIONS INCORPORATION ACT 2009

Cancellation of incorporation pursuant to section 74

TAKE NOTICE that the incorporation of the following associations is cancelled by this notice pursuant to section 74 of the *Associations Incorporation Act 2009*.

ACTIVE BROKEN HILL INCORPORATED	INC9891853
LISMORE SQUARE TUESDAY CLUB INCORPORATED	Y2788042
THE ROBIN HOOD SERVICE CLUB INCORPORATED	Y2132943
SOUTHERN NEW ENGLAND LANDCARE CO-ORDINATING COMMITTEE INCORPORATED	Y2495307
TUGGERAH LAKES CHURCH INCORPORATED	Y2233200
ZONTA CLUB OF GUNNEDAH INCORP	INC9874610

Cancellation is effective as at the date of gazettal.

Dated this 8th day of March 2017.

Robyne Lunney  
Delegate of the Commissioner  
NSW Fair Trading

### ASSOCIATIONS INCORPORATION ACT 2009

Cancellation of Registration pursuant to Section 76

TAKE NOTICE that the registration of the following associations is cancelled by this notice pursuant to section 76 of the *Associations Incorporation Act 2009*.

A SOCIETY FOR GOOD FEELING INCORPORATED	INC9882480
BICOL COMMUNITIES LEAGUE INCORPORATED	INC9885299
BURAJA GOLF CLUB INCORPORATED	Y2972005
COONAMBLE NETBALL ASSOCIATION INC	Y1614338
GLOUCESTER ADULT HORSE RIDING CLUB INCORPORATED	INC9887462
INDIGENOUS JUSTICE ADVOCACY NETWORK INCORPORATED	INC9883159
KING PARK COMMUNITY CENTRE BEFORE AND AFTER SCHOOL CARE INC	Y1164147
LITTLE BILLABONG TENNIS CLUB INCORPORATED	INC9891101
LITTLE BLACK DUCK ABORIGINAL HEALING AND MENTORING INC	INC1601284
MARSDEN PARK GOLFERS ASSOCIATION INCORPORATED	INC9887617
NELSON BAY RSL SUB-BRANCH AMATEUR SWIMMING CLUB INCORPORATED	INC9889805
NORTH ROTHBURY RESIDENTS GROUP INCORPORATED	INC9890940
NORTH WEST SYDNEY TIGERS CRICKET CLUB INCORPORATED	INC9891006
NORTHERN RIVERS ANGUS BREEDERS INC	Y0073108
SOUTH GIPPS WATER USERS' ASSOCIATION INCORPORATED	Y2200613
TASKER PARK CRICKET CLUB INCORPORATED	INC9881931
THE CONFRIERIE DE LA CHAINE DES ROTISSEURS BAILLIAGE DE NEW SOUTH WALES INCORPORATED	Y2993141
THE FORBES RIFLE CLUB INCORPORATED	Y2806908
WESTLAKES AMATEUR SWIMMING CLUB INCORPORATED	Y2068232
WISEMANS FERRY & DISTRICT SENIOR CITIZENS CLUB INCORPORATED	Y0175636

Cancellation is effective as at the date of gazettal.

Dated this 10th day of March 2017.

Christine Gowland  
Delegate of the Commissioner  
NSW Fair Trading

## HEALTH ADMINISTRATION ACT 1982

### NSW Safety and Quality Council Terms of Reference

Pursuant to section 23 of the *Health Administration Act 1982*, I Elizabeth Koff, Secretary, Ministry of Health acting as delegate of the Minister for Health, do hereby authorise the NSW Safety and Quality Council to conduct investigations and research in accordance with section 23 of the *Health Administration Act 1982* (the Act) as follows:

#### 1. Purpose

The NSW Safety and Quality Council (“the Council”) is responsible for:

- undertaking research in relation to the development of a NSW Health Safety and Quality Strategy to support and enhance patient safety initiatives across the NSW Public Health System and reduce morbidity and mortality;
- providing advice to the Secretary on the NSW Health Safety and Quality Strategy.

#### 2. Key Responsibilities

The Council will:

- consider current system performance and identify opportunities for sustainable improvement in safety and quality within the operating systems and culture of the entire NSW Health system;
- consider mechanisms for engagement with the health system and broader community on safety and quality matters;
- obtain and analyse information relevant to safety and quality in NSW Health and such other information as may be relevant to support the development of the Safety and Quality Strategy;
- access information held by other Committees authorised under Section 23 of the Act, where relevant to the work of the Council;
- Obtain advice and assistance as necessary from the Ministry of Health Executive, relevant Branches of the Ministry of Health, public health organisations or such other entities as the Council considered appropriate;
- Establish an expert advisory group or other expert or consultation forum as considered necessary to support the Council;

#### 3. Chair

The Council will be chaired by the Secretary, Ministry of Health with the Vice Chancellor and President, Macquarie University as Co-Chair

#### 4. Secretariat

The Secretariat for the Council will be provided by the Office of the Secretary, Ministry of Health.

#### 5. Membership

The membership of the Council is as follows:

- Secretary, Ministry of Health (Chair)
- Vice Chancellor and President of Macquarie University (Co-Chair)
- Deputy Secretary, System Purchasing and Performance, Ministry of Health
- Chief Executive, Clinical Excellence Commission
- Local Health District Chief Executive (2)
- Council of Board Chairs representative (1)
- Senior Clinician (1)

#### 6. Privilege under Section 23

- The Council is authorised under the terms of section 23 of the Act and, as such, material created or obtained in connection with the carrying out of the committee’s functions is privileged and cannot be disclosed or released other than as set out within these Terms of Reference without the approval of the Minister for Health or the Minister’s authorised delegate.
- This authorisation under section 23 applies from the date of the first meeting of the Council until 30 June 2017.

Elizabeth Koff  
Secretary

**ROADS ACT 1993**

**SYDNEY OLYMPIC PARK AUTHORITY**

Naming of Roads

Notice is hereby given that Sydney Olympic Park Authority, pursuant to section 162 of the *Roads Act 1993*, has officially named the road(s) as shown hereunder:

<b>Name</b>	<b>Location</b>
Betty Cuthbert Avenue	Sydney Olympic Park
Ian Thorpe Avenue	Sydney Olympic Park
Ferry Wharf Circuit	Sydney Olympic Park

CHARLES MOORE, Chief Executive Officer, Sydney Olympic Park Authority, 8 Australia Avenue, Sydney Olympic Park, NSW 2127



# COUNCIL NOTICES

## BREWARRINA SHIRE COUNCIL

Local Government Act 1993 Section 713

Sale of Land for Overdue Rates and Charges

NOTICE is hereby given to the persons named hereunder, that the Council of the Shire Of Brewarrina has resolved, in pursuance of Section 713 of the *Local Government Act 1993*, to sell the land described hereunder of which the persons named are known to the Council to be the owners or to have an interest in the land on which the amount of rates stated in each case, as at 30 November 2016, is due:

Owners or person having interest in land  (a)	Description of land  (b)	Amount of rates and charges (including extra charges) overdue as per Section 713(1)  (c) \$	Amount of all other rates and charges (including extra charges) payable and unpaid  (d) \$	Total  (e) \$
PIPPOS, Thalia (Estate)	Lot 1 DP 213684 42 Bathurst Street BREWARRINA NSW 2839	11,668.61	2,254.36	13,922.97
BREWARRINA ABORIGINAL HEALTH CENTRE LTD	Lot 9 Section 21 DP 758161 76 Bourke Street BREWARRINA NSW 2839	9,948.23	2,491.44	12,439.67
CLARKE, Patricia	Lot 12 Section 1 DP 2802 2 Byron Street BREWARRINA NSW 2839	717.75	13,543.84	14,261.59
SALES, Darren Samuel	Lot 22 DP 227232 13 Culgoa Street BREWARRINA NSW 2839	1,650.21	2,551.96	4,202.17
COUNTRY HOUSE & LAND PTY LTD	Lot 96 & 97 DP 751553 Narran Street BREWARRINA NSW 2839	10,560.25	2,003.72	12,563.97
COUNTRY HOUSE & LAND PTY LTD	Lot 13 DP 226926 8 Narran Street BREWARRINA NSW 2839	12,533.09	2,407.35	14,940.44
COUNTRY HOUSE & LAND PTY LTD	Lot 8 DP 226926 Walgett Street BREWARRINA NSW 2839	6,132.99	1,890.95	8,023.94
VAN LIESHOUT, Teresa Angela	Lot 1 Section 1 DP 2802 Wilson Street BREWARRINA NSW 2839	11,257.66	7,744.60	19,002.26
BREWARRINA ABORIGINAL HEALTH CENTRE LTD	Lot 7 Section 1 DP 2802 21 Young Street BREWARRINA NSW 2839	1,119.51	16,171.91	17,291.42
STEPHENS, Bonnom Joseph	Lot 1 DP 1091966 Wilson Street BREWARRINA NSW 2839	617.06	597.25	1,214.31
NEULAND, Thomas	Lot 1 DP 1091965, Lot 1 DP 1091967 Wilson Street BREWARRINA NSW 2839	617.06	597.25	1,214.31
DANGAR, Thomas Vivina Eclipse & Catherine Annabella	Lot 2 DP 751553 Kamilaroi Highway BREWARRINA NSW 2839	443.28	551.88	995.16



Owners or person having interest in land  (a)	Description of land  (b)	Amount of rates and charges (including extra charges) overdue as per Section 713(1)  (c) \$	Amount of all other rates and charges (including extra charges) payable and unpaid  (d) \$	Total  (e) \$
CHIPPENDALE, Albert Jack	Lot 8 Section 9 DP 2918 Petworth Street ANGLEDPOOL NSW 2834	503.16	564.75	1,067.91
COOK, William	Lot 1414 DP 720996 Bogan Street GONGOLGON NSW 2831	994.02	4,316.22	5,310.24
COOK, William	Lot 1 Section 15 DP 758459 59 Adams Street GOODDOOGA NSW 2831	9,914.59	7,514.92	17,429.51
GOLUBOVIC, Jorgovan	Lot 8 Section 14 DP 758459 56 Adams Street GOODDOOGA NSW 2831	15,854.54	2,084.71	17,939.25
EDGAR, John & Glenys Elizabeth	Lot 4 Section 17 DP 758459 23 Doyle Street GOODDOOGA NSW 2831	7,223.73	8,277.52	15,501.25
MOORE, Richard Charles	Lot 1 Section 20 DP 758459 Warraweena Street GOODDOOGA NSW 2831	1,078.34	177.46	1,255.80
VINCENT, James	Lot 6 DP 751926 Brewarrina Environs BREWARRINA NSW 2839	443.28	551.88	995.16

In default of payment to the Council of the amount stated in column (e) above and any other rates (including extra charges) becoming due and payable after this notice or any arrangements satisfactory to the Council for payment of all such rates being entered into by the rateable person before the time fixed for the sale, the said land will be offered for sale by public auction by Schute Bell Badgery Lumby at the Brewarrina Shire Council Chambers, 57 Bathurst Street, BREWARRINA NSW 2839, on Saturday 17 June 2017 at 10.00am.

Jeff Sowiak, General Manager, Brewarrina Shire Council, 57 Bathurst Street, BREWARRINA NSW 2839.

[9043]

### CENTRAL COAST COUNCIL

#### LOCAL GOVERNMENT ACT 1993

#### LAND ACQUISITION (JUST TERMS COMPENSATION) ACT 1991

#### NOTICE OF COMPULSORY ACQUISITION OF LAND

Central Coast Council declares with the approval of His Excellency the Governor that the land described in the Schedule below, excluding any mines or deposits of minerals in the land, is acquired by compulsory process in accordance with the provisions of the *Land Acquisition (Just Terms Compensation) Act 1991* for public road. Dated at Wyong this 20th day of February 2017. ROB NOBLE, Chief Executive Officer, Central Coast Council, PO Box 20, Wyong NSW 2259.

#### Schedule

Lot 1 DP 1216523

[9044]

**CENTRAL COAST COUNCIL**  
LOCAL GOVERNMENT ACT 1993  
LAND ACQUISITION (JUST TERMS COMPENSATION) ACT 1991  
NOTICE OF COMPULSORY ACQUISITION OF LAND

Central Coast Council declares with the approval of His Excellency the Governor that the easement described in the Schedule below, excluding any mines or deposits of minerals in the land, are acquired by compulsory process in accordance with the provisions of the *Land Acquisition (Just Terms Compensation) Act 1991* for drainage. Dated at Wyong this 20th day of February, 2017. ROB NOBLE, Chief Executive Officer, Central Coast Council, PO Box 20, Wyong NSW 2259.

**SCHEDULE**

Easement to Drain Water 1.65 wide over Lot 14 DP 14776 as shown on Deposited Plan 1217886 as (A) Proposed Easement to Drain Water 1.65 wide. [9045]

---

**CENTRAL COAST COUNCIL**

ROADS ACT 1993

Naming of Roads

Notice is hereby given that Central Coast Council, pursuant to section 162 of the *Roads Act 1993*, has officially named the road(s) as shown hereunder:

<b>Name</b>	<b>Locality</b>
NEXUS WAY	Lisarow
<b>Description</b>	
Commences at MacDonalds Road Lisarow and travels in a southerly direction to The Ridgeway Lisarow.	

ROB NOBLE, Chief Executive Officer, Central Coast Council, P.O. Box 20, WYONG NSW 2259  
GNB Ref: 0041 [9046]

---

**COFFS HARBOUR CITY COUNCIL**

ROADS ACT 1993

Naming of Roads

Notice is hereby given that Coffs Harbour City Council, pursuant to section 162 of the *Roads Act 1993*, has officially named the road(s) as shown hereunder:

<b>Name</b>	<b>Locality</b>
GRANDVIEW CLOSE	Sapphire Beach
<b>Description</b>	
Grandview Close extending off Split Solitary Road, Sapphire Beach.	

STEPHEN MCGRATH, General Manager, Coffs Harbour City Council, Locked Bag 155, COFFS HARBOUR NSW 2450  
GNB Ref: 0043 [9047]

---

**EUROBODALLA SHIRE COUNCIL**

ROADS ACT 1993

Naming of Roads

Notice is hereby given that Eurobodalla Shire Council, pursuant to section 162 of the *Roads Act 1993*, has officially named the road(s) as shown hereunder:

Name	Locality
GLENELLA ROAD	Catalina
<b>Description</b>	
Council is constructing a new distributor (primary collector) road from Glenella Road and its intersection with George Bass Drive. It will head west to meet the Princes Highway. The existing Glenella Road (cnr George Bass Drive) commences at 246240.038, 6041539.391, heads west and ceases 245051.587, 6041335.203 (at the western boundary of Lot 12 DP116593. The section between 245051.587, 6041335.203 heading west to 244368.530, 6041576.448 is proposed to be named Glenella Road and is currently unnamed. The section that commences at 244368.530, 6041576.448 heading north west and ceases at 244051.662, 6042230.915 at the intersection with Princes Highway is currently named The Ridge Road and is proposed to be renamed Glenella Road.	

DR CATHERINE DALE, General Manager, Eurobodalla Shire Council, PO Box 99, MORUYA NSW 2537  
GNB Ref: 0038 [9048]

**GUNNEDAH SHIRE COUNCIL**

ROADS ACT 1993

Naming of Roads

Notice is hereby given that Gunnedah Shire Council, pursuant to section 162 of the *Roads Act 1993*, has officially named the road(s) as shown hereunder:

Name	Locality
ALLGAYER DRIVE	Gunnedah
<b>Description</b>	
The road is a two way road servicing a recently approved 11 lot industrial subdivision at 16 Torrens Road, Gunnedah. The road is located to the north west of the Gunnedah Township. The road will be oriented in north easterly direction and will connect existing Torrens Road and existing Mathias Road. Mr Hans Allgayer is acknowledged for his contribution to the Gunnedah community as a Councillor, president of the Gunnedah Swimming Club, member of Rotary Club of Gunnedah West and Gunnedah Urban Landcare Group. He is also recognised for his involvement in the Pensioner's Hill rehabilitation project and the implementation of Koala habitat movement corridors within the Shire.	

ERIC GROTH, General Manager, Gunnedah Shire Council, PO Box 63, GUNNEDAH NSW 2380  
GNB Ref: 0042 [9049]

**WINGECARRIBEE SHIRE COUNCIL**

ROADS ACT 1993

Section 16

Dedication of Land as Public Road

NOTICE is hereby given by Wingecarribee Shire Council, pursuant to section 16 of the *Roads Act 1993*, that the land described in the Schedule below is hereby dedicated as public road. Dated at Moss Vale 27 February 2017. Ann Prendergast, General Manager, Wingecarribee Shire Council, Civic Centre, 68 Elizabeth St Moss Vale NSW 2577.

**SCHEDULE**

The roads shown within Deposited Plan 111201. [9050]

## PRIVATE NOTICES

### CHURCHES OF CHRIST IN NEW SOUTH WALES INCORPORATION ACT 1947

Registration Certificate No. 165

IN accordance with the provisions of Part V of the above Act, **Ecclesia Mission**, having complied with the requirements of the said Act and made application for registration under the said Act and such application having been duly approved by the Churches of Christ Property Trust it is hereby certified that the said Church of Christ has been registered under the above Act as a church entitled to the benefits of the said Act.

Dated at Rhodes this 16th day of February 2017

JOHN A. HOPPITT  
Registrar

[9051]

---

### CHURCHES OF CHRIST IN NEW SOUTH WALES INCORPORATION ACT 1947

Registration of Trustees. Certificate No. 185

IN accordance with the provisions of Part V of the above Act, **Ecclesia Mission**, having made application for the registration of the Churches of Christ Property Trust as Church Trustee under Section 27 of the said Act and having done all things necessary for such registration it is hereby certified that the Church Trustee of the said Church of Christ as from the date of this certificate is the Churches of Christ Property Trust.

Dated at Rhodes this 16th day of February 2017

JOHN A. HOPPITT  
Registrar

[9052]