

Government Gazette

of the State of
New South Wales

Number 34
Friday, 17 March 2017

The New South Wales Government Gazette is the permanent public record of official notices issued by the New South Wales Government. It also contains local council and other notices and private advertisements.

The Gazette is compiled by the Parliamentary Counsel's Office and published on the NSW legislation website (www.legislation.nsw.gov.au) under the authority of the NSW Government. The website contains a permanent archive of past Gazettes.

To submit a notice for gazettal – see Gazette Information.

PARLIAMENT

ACT OF PARLIAMENT ASSENTED TO

Legislative Council Office Sydney 14 March 2017

It is hereby notified, for general information, that His Excellency the Governor has, in the name and on behalf of Her Majesty, this day assented to the undermentioned Act passed by the Legislative Council and Legislative Assembly of New South Wales in Parliament assembled, viz.:

Act No. 5, 2016 – An Act to amend the *Biosecurity Act 2015* to make further provision with respect to biosecurity certifiers, biosecurity auditors, accreditation authorities, fees, evidentiary certificates and biosecurity orders. **[Biosecurity Amendment Bill 2017]**

David Blunt
Clerk of the Parliaments

ACTS OF PARLIAMENT ASSENTED TO

Legislative Assembly Office, Sydney 14 March 2017

It is hereby notified, for general information, that His Excellency the Governor, has, in the name and on behalf of Her Majesty, this day assented to the under mentioned Acts passed by the Legislative Assembly and Legislative Council of New South Wales in Parliament assembled, viz.:

Act No. 6 — An Act to amend the *Fines Act 1996* with respect to civil enforcement of fines; to enable the enforcement under that Act of amounts payable under orders for restitution; and to make related amendments to the *Victims Rights and Support Act 2013*. **[Fines Amendment Bill]**

Act No. 7 — An Act to amend the *Sporting Venues Authorities Act 2008* to enable the transfer of certain assets, rights and liabilities relating to Stadium Australia to Venues NSW; and for other purposes. **[Sporting Venues Authorities Amendment Bill]**

Helen Minnican
Clerk of the Legislative Assembly

GOVERNMENT NOTICES

Miscellaneous Instruments

ENVIRONMENTAL PLANNING & ASSESSMENT ACT 1979

ORDER

Declaration under section 89C(3)

I, the Minister for Planning, with the advice of the Planning Assessment Commission (dated 29 November 2016 and made publicly available on the 30 November 2016), declare the development specified in Schedule 1 on the land specified in Schedule 2 to be State significant development under 89C(3) of the *Environmental Planning and Assessment Act 1979*, for the purposes of that Act.

SCHEDULE 1

Development for the purpose of an 18 hole golf course and associated works/facilities as described in the development application (DA11/1728) submitted with Shoalhaven City Council.

SCHEDULE 2

Land within Lots 5 & 6 of DP 106511, located within the Shoalhaven local government area.

MINISTER ROBERTS

Dated: 7/3/xvii

This Order takes effect upon publication in the Government Gazette

Roads and Maritime Notices

MARINE SAFETY ACT 1998

MARINE NOTICE

Section 12(2)

REGULATION OF VESSELS – EXCLUSION ZONE

Location

Lake Albert, Wagga Wagga – all navigable waters.

Duration

7am to 6pm Saturday 25 and Sunday 26 March 2017.

Detail

Competitive powerboat racing will be conducted on the waters of Lake Albert, Wagga Wagga, involving the use of high speed power vessels which will be active in the area during the above times.

There will also be support vessels present to manage the event and competing vessels operating at speed presenting a significant potential hazard to other waterway users.

An **EXCLUSION ZONE** is specified during the event and will comprise the entirety of Lake Albert. This will in effect close the Lake between the above times for this event.

Unauthorised vessels and persons are strictly prohibited from entering the exclusion zone (the Lake) which will be patrolled by Roads and Maritime vessels.

Penalties may apply (section 12(5) – *Marine Safety Act 1998*)

For full details visit the Roads and Maritime Services website – www.rms.nsw.gov.au/maritime

Marine Notice: SO1728

Date: 14 March 2017

Mike Hammond
Principal Manager South, Boating Operations.
Delegate

MARINE SAFETY ACT 1998

MARINE NOTICE

Section 12(2)

REGULATION OF VESSELS – EXCLUSION ZONE

Location

Lake Mulwala – near the locality of the Mulwala Water Ski Club and within a buoyed area bounded:

- From a position adjacent to the Inglis Street public boat ramp, then
- South to a position adjacent to the Melbourne Street Bridge, then
- East to a position adjacent to the Yarrawonga Yacht Club (Victoria), then
- North to a position adjacent to the Inglis Street public boat ramp.

Duration

8am to 6pm Saturday 25 and Sunday 26 March 2017.

Detail

Competitive ski racing will be conducted on the waters of Lake Mulwala, as specified above, involving the use of high speed power vessels which will be active in the area described above on both days during the above times. There will also be support vessels present to manage the event, persons being towed at speed using tow-lines, and persons in the water from time to time – presenting a significant potential hazard to other waterway users.

An **EXCLUSION ZONE** is specified during between the times specified above and comprising the area detailed above.

No unauthorised vessels (i.e. vessels that are not already lawfully moored in the Zone) may enter the Zone between the specified times. The Zone will be marked by buoys and patrolled by Roads and Maritimes vessels.

Due to high speeds involved in the event, Roads and Maritime urges all spectators to exercise extreme caution when near the area including awareness of approaching race vessels and likely exit route in case of an emergency.

Penalties may apply (section 12(5) – *Marine Safety Act 1998*)

For full details visit the Roads and Maritime Services website – www.rms.nsw.gov.au/maritime

Marine Notice: SO1734

Date: 14 March 2017

Mike Hammond
Delegate

MARINE SAFETY ACT 1998

MARINE NOTICE

Section 12(2)

REGULATION OF VESSELS – EXCLUSION ZONE

Location

Murray River – Torrumbarry, between Murray River kilometre marker 1638km and Murray River kilometre marker 1648km.

Duration

7.30am to 6:00pm Saturday 1st April 2017, and

7:30am to 11:00am Sunday 2nd April 2017.

Detail

A fishing competition will be conducted on the waters of the Murray River, as specified above.

Due to the risk to safe navigation as a result of the large number of participating vessels, and amenity of participating vessels, an **EXCLUSION ZONE** is specified for the duration of the event, comprising the entirety of the River between the sections detailed above.

No unauthorised vessels may enter the Zone between the specified times. The Zone will be cordoned off by SES volunteers and will be patrolled by Roads and Maritime vessels.

In addition, pursuant to Section 12(3) of the *Marine Safety Act 1998*, aquaplaning (including water skiing, wakeboarding and tube riding) is prohibited within the Zone for the duration of the event.

All vessel operators and persons using the waters in the vicinity of the event must comply with the above restrictions, keep a proper lookout, and exercise caution.

Penalties may apply (section 12(5) – *Marine Safety Act 1998*)

For full details visit the Roads and Maritime Services website – www.rms.nsw.gov.au/maritime

Marine Notice: SO1732

Date: 9 March 2017

Mike Hammond
Principal Manager South, Boating Operations
Delegate

ROADS ACT 1993

LAND ACQUISITION (JUST TERMS COMPENSATION) ACT 1991

Notice of Compulsory Acquisition and Dedication as Public Road of Land at Oberon in the Oberon Council Area

Roads and Maritime Services by its delegate declares, with the approval of His Excellency the Governor, that the land described in the schedule below is acquired by compulsory process under the provisions of the *Land*

Acquisition (Just Terms Compensation) Act 1991 for the purposes of the *Roads Act 1993* and further dedicates the land as public road under section 10 of the *Roads Act 1993*.

K DURIE
Manager, Compulsory Acquisition & Road Dedication
Roads and Maritime Services

Schedule

All that piece or parcel of land situated in the Oberon Council area, Parish of Oberon and County of Westmoreland, shown as Lot 15 Deposited Plan 1185095, being part of the land in Certificate of Title 1/130125.

The land is said to be in the possession of the Estate of the Late Berice Pearl Robinson.

(RMS Papers: SF2016/271936; RO SF2012/057402)

ROADS ACT 1993

Notice of Dedication of Land as Public Road at Rixs Creek in the Singleton Council Area

Roads and Maritime Services, by its delegate, dedicates the land described in the schedule below as public road under section 10 of the *Roads Act 1993*.

K DURIE
Manager, Compulsory Acquisition & Road Dedication
Roads and Maritime Services

Schedule

All those pieces or parcels of land situated in the Singleton Council area, Parish of Darlington and County of Durham, shown as Lots 12 and 13 Deposited Plan 1187455.

(RMS Papers: SF2017/041699; RO SF2012/000549)

ROADS ACT 1993

Notice of Dedication of Land as Public Road at Morundah in the Federation Council Area

Roads and Maritime Services, by its delegate, dedicates the land described in the schedule below as public road under section 10 of the *Roads Act 1993*.

K DURIE
Manager, Compulsory Acquisition & Road Dedication
Roads and Maritime Services

Schedule

All those pieces or parcels of land situated in Federation Council area, Parish of Bingagong and County of Urana, shown as Lots 22 and 23 Deposited Plan 1218890.

(RMS Papers: SF2017/024532; RO SF2014/008903)

ROADS ACT 1993

Notice of Dedication of Land as Public Road at Bega in the Bega Valley Shire Council Area

Roads and Maritime Services, by its delegate, dedicates the land described in the schedule below as public road under section 10 of the *Roads Act 1993*.

K DURIE
Manager, Compulsory Acquisition & Road Dedication
Roads and Maritime Services

Schedule

All that piece or parcel of land situated in the Bega Valley Shire Council area, Parish of Bega and County of Auckland, shown as Lot 6 Deposited Plan 1227644.

(RMS Papers: SF2017/050542; RO SF2012/002012)

ROADS ACT 1993

Notice of Dedication of Land as Public Road at Chittaway Bay in the Central Coast Council Area

Roads and Maritime Services, by its delegate, dedicates the land described in the schedule below as public road under section 10 of the *Roads Act 1993*.

K DURIE

Manager, Compulsory Acquisition & Road Dedication
Roads and Maritime Services

Schedule

All those pieces or parcels of land situated in the Central Coast Council area, Parish of Tuggerah and County of Northumberland, shown as:

Lot 17 Deposited Plan 255990;

Lots 13, 14 and 15 Deposited Plan 1204383;

Lot 7 Deposited Plan 259648; and

Lot 60 Deposited Plan 818089.

(RMS Papers: SF2017/050699; RO SF2012/019391)

Mining and Petroleum Notices

NOTICE is given that the following applications have been received:

EXPLORATION LICENCE APPLICATIONS

(T17-1051)

No. 5465, OCHRE RESOURCES PTY LTD (ACN 112 833 351), area of 18 units, for Group 1, dated 1 March, 2017. (Cobar Mining Division).

(T17-1052)

No. 5466, OBERON GOLD PTY LTD, area of 69 units, for Group 1, dated 3 March, 2017. (Sydney Mining Division).

The Honourable Don Harwin MLC
Minister for Resources

NOTICE is given that the following applications have been granted:

EXPLORATION LICENCE APPLICATIONS

(T16-1065)

No. 5309, now Exploration Licence No. 8499, THE AUSTRAL BRICK CO PTY LTD (ACN 000 005 550), County of Camden, Map Sheet (9029), area of 13 units, for Group 5, dated 1 February, 2017, for a term until 1 February, 2020. As a result of the grant of this title, Exploration Licence No. 8429 has partly ceased to have effect.

(T16-1079)

No. 5322, now Exploration Licence No. 8522, ILUKA RESOURCES LIMITED (ACN 008 675 018), Counties of Caira and Kilfera, Map Sheet (7529, 7530, 7628, 7629, 7630), area of 669 units, for Group 10, dated 1 March, 2017, for a term until 1 March, 2020.

(T16-1087)

No. 5328, now Exploration Licence No. 8503, CRISTAL MINING AUSTRALIA LIMITED (ACN 009 247 858), Counties of Perry, Wentworth and Windeyer, Map Sheet (7330, 7331, 7430, 7431), area of 333 units, for Group 10, dated 6 February, 2017, for a term until 6 February, 2019. As a result of the grant of this title, Exploration Licence No. 7449 has ceased to have effect.

MINING LEASE APPLICATION

(T15-1600)

Singleton No. 488, now Mining Lease No. 1748 (Act 1992), COAL & ALLIED OPERATIONS PTY LTD (ACN 000 023 656) AND HVO RESOURCES PTY LTD (ACN 608 108 952), Parish of Ravensworth, County of Durham, Map Sheet (9033-2-S, 9133-3-S), area of 124.1 hectares, for the purpose of all purposes, dated 5 December, 2016, for a term until 5 December, 2037.

The Honourable Don Harwin MLC
Minister for Resources

NOTICE is given that the following applications have been withdrawn:

EXPLORATION LICENCE APPLICATIONS

(T16-1041)

No. 5284, SANDFIRE RESOURCES NL (ACN 105154185), County of Bland and County of Gipps, Map Sheet (8329, 8330). Withdrawal took effect on 3 March, 2017.

(T16-1049)

No. 5293, ALLIANCE (NSW) PTY LTD (ACN 096 947 223), County of Roxburgh and County of Wellington, Map Sheet (8832). Withdrawal took effect on 21 February, 2017.

(T16-1160)

No. 5393, ARDEA EXPLORATION PTY LTD (ACN 137 889 279), County of Gordon and County of Wellington, Map Sheet (8632, 8732). Withdrawal took effect on 2 March, 2017.

(T17-1048)

No. 5462, SILVER CITY MINERALS LIMITED (ACN 130 933 309), County of Monteagle, Map Sheet (8530). Withdrawal took effect on 1 March, 2017.

(T17-1049)

No. 5463, OBERON GOLD PTY LTD, County of Argyle and County of St Vincent, Map Sheet (8827, 8828). Withdrawal took effect on 7 March, 2017.

The Honourable Don Harwin MLC
Minister for Resources

NOTICE is given that the following applications for renewal have been received:

APPLICATIONS FOR RENEWAL

(V17-1856)

Exploration Licence No. 5818, BROKEN HILL OPERATIONS PTY LTD (ACN 054 920 893), area of 10 units. Application for renewal received 3 March, 2017.

(V17-1834)

Exploration Licence No. 6209, ALKANE RESOURCES LTD (ACN 000 689 216), area of 3 units. Application for renewal received 2 March, 2017.

(V17-1876)

Exploration Licence No. 6516, NEW SOUTH RESOURCES LIMITED (ACN 119557416), area of 6 units. Application for renewal received 5 March, 2017.

(V17-1884)

Exploration Licence No. 6525, NEW SOUTH RESOURCES LIMITED (ACN 119557416), area of 56 units. Application for renewal received 5 March, 2017.

(V17-1874)

Exploration Licence No. 8241, SANDFIRE RESOURCES NL (ACN 105154185), area of 22 units. Application for renewal received 3 March, 2017.

(V17-1791)

Exploration Licence No. 8256, THOMSON RESOURCES LTD (ACN 138 358 728), area of 10 units. Application for renewal received 1 March, 2017.

(V17-1833)

Exploration Licence No. 8358, WENDY RUTH YARNOLD, area of 6 units. Application for renewal received 2 March, 2017.

The Honourable Don Harwin MLC
Minister for Resources

RENEWAL OF CERTAIN AUTHORITIES

Notice is given that the following authorities have been renewed:

(T14-0256)

Exploration Licence No. 5675, ALKANE RESOURCES LTD (ACN 000 689 216), Counties of Ashburnham, Kennedy and Narromine, Map Sheet (8531, 8532), area of 87 units, for a further term until 17 January, 2023. Renewal effective on and from 1 March, 2017.

(Z16-1756)

Exploration Licence No. 7626, ILUKA RESOURCES LIMITED (ACN 008 675 018), Counties of Caira and Wakool, Map Sheet (7627, 7628), area of 89 units, for a further term until 11 October, 2019. Renewal effective on and from 3 March, 2017.

(T14-1097)

Exploration Licence No. 8311, BROKEN HILL MINERALS PTY LTD (ACN 600 094 415), County of Windeyer, Map Sheet (7132), area of 59 units, for a further term until 13 October, 2019. Renewal effective on and from 1 March, 2017.

(T14-1101)

Exploration Licence No. 8312, BROKEN HILL MINERALS PTY LTD (ACN 600 094 415), County of Tara, Map Sheet (7130, 7131), area of 100 units, for a further term until 13 October, 2019. Renewal effective on and from 1 March, 2017.

The Honourable Don Harwin MLC
Minister for Resources

REFUSAL OF APPLICATION FOR RENEWAL

Notice is given that the application for renewal in respect of the following authority has been refused:

(Z16-0124)

Exploration Licence No. 7045, ICARUS MINES PTY LTD (ACN 140 149 515), County of Gipps, Map Sheet (8331), area of 6 units. The authority ceased to have effect on 3 March, 2017.

The Honourable Don Harwin MLC
Minister for Resources

TRANSFERS

(Z07-4677)

Exploration Licence No. 5878, formerly held by TRIAUSMIN PTY LTD (ACN 062 002 475) has been transferred to OCHRE RESOURCES PTY LTD (ACN 112 833 351). The transfer was registered on 1 March, 2017.

(V16-7142)

Exploration Licence No. 5977, formerly held by CONRAD SILVER MINES PTY LTD (ACN 106 967 506) has been transferred to CONRAD RESOURCES PTY LTD (ACN 614125521). The transfer was registered on 1 March, 2017.

(Z07-4677)

Exploration Licence No. 7941, formerly held by TRIAUSMIN PTY LTD (ACN 062 002 475) has been transferred to OCHRE RESOURCES PTY LTD (ACN 112 833 351). The transfer was registered on 1 March, 2017.

(V16-7142)

Exploration (Prospecting) Licence No. 1050, formerly held by CONRAD SILVER MINES PTY LTD (ACN 106 967 506) has been transferred to CONRAD RESOURCES PTY LTD (ACN 614125521). The transfer was registered on 1 March, 2017.

(V16-7138)

Mineral Lease No. 5992 (Act 1906), formerly held by CONRAD SILVER MINES PTY LTD (ACN 106 967 506) has been transferred to CONRAD RESOURCES PTY LTD (ACN 614125521). The transfer was registered on 1 March, 2017.

(V16-7138)

Mineral Lease No. 6040 (Act 1906), formerly held by CONRAD SILVER MINES PTY LTD (ACN 106 967 506) has been transferred to CONRAD RESOURCES PTY LTD (ACN 614125521). The transfer was registered on 1 March, 2017.

(V16-7138)

Mineral Lease No. 6041 (Act 1906), formerly held by CONRAD SILVER MINES PTY LTD (ACN 106 967 506) has been transferred to CONRAD RESOURCES PTY LTD (ACN 614125521). The transfer was registered on 1 March, 2017.

The Honourable Don Harwin MLC
Minister for Resources

NOTICE is given that the following applications have been received:

EXPLORATION LICENCE APPLICATIONS

(T17-1053)

No. 5467, AWATI RESOURCES PTY LTD (ACN 106 020 419), area of 49 units, for Group 1, dated 7 March, 2017. (Broken Hill Mining Division).

(T17-1054)

No. 5468, AWATI RESOURCES PTY LTD (ACN 106 020 419), area of 17 units, for Group 1, dated 7 March, 2017. (Broken Hill Mining Division).

(T17-1055)

No. 5469, AWATI RESOURCES PTY LTD (ACN 106 020 419), area of 50 units, for Group 1, dated 7 March, 2017. (Broken Hill Mining Division).

(T17-1056)

No. 5470, SA EXPLORATION PTY LTD (ACN 152 429 377), area of 37 units, for Group 1, dated 10 March, 2017. (Broken Hill Mining Division).

(T17-1057)

No. 5471, GOLD AND COPPER RESOURCES PTY LIMITED (ACN 124 534 863), area of 4 units, for Group 1, dated 10 March, 2017. (Orange Mining Division).

MINING LEASE APPLICATION

(T17-1058)

No. 537, ARUMPO BENTONITE PTY LIMITED (ACN 001 831 483), area of about 108 hectares, to mine for bentonite, dated 14 March, 2017. (Broken Hill Mining Division).

The Honourable Don Harwin MLC
Minister for Resources

NOTICE is given that the following applications have been granted:

EXPLORATION LICENCE APPLICATIONS

(T16-1013)

No. 5257, now Exploration Licence No. 8526, TUENA RESOURCES PTY LTD (ACN 614 119 103), County of Georgiana, Map Sheet (8729, 8730), area of 62 units, for Group 1, dated 7 March, 2017, for a term until 7 March, 2022.

(T16-1030)

No. 5274, now Exploration Licence No. 8533, NBH RESOURCES PTY LTD (ACN 141 901 939), County of Farnell, Map Sheet (7135, 7235), area of 59 units, for Group 1, dated 10 March, 2017, for a term until 10 March, 2019.

(T16-1053)

No. 5297, now Exploration Licence No. 8524, EVOLUTION MINING (COWAL) PTY LIMITED (ACN 007 857 598), County of Gipps, area of 100 units, for Group 1, dated 2 March, 2017, for a term until 2 March, 2023.

(T16-1069)

No. 5313, now Exploration Licence No. 8525, PROVIDENCE METALS PTY LTD (ACN 612933981), Counties of Flinders and Kennedy, Map Sheet (8333), area of 67 units, for Group 1, dated 6 March, 2017, for a term until 6 March, 2020.

(T16-1078)

No. 5321, now Exploration Licence No. 8528, ILUKA RESOURCES LIMITED (ACN 008 675 018), County of Cairns, Map Sheet (7628, 7629, 7728, 7729), area of 254 units, for Group 10, dated 7 March, 2017, for a term until 7 March, 2020.

(T16-1095)

No. 5336, now Exploration Licence No. 8535, PTR RESOURCES PTY LTD (ACN 153 851 702), Counties of Clive, Drake and Gough, area of 100 units, for Group 1, dated 10 March, 2017, for a term until 10 March, 2019.

(T16-1109)

No. 5350, now Exploration Licence No. 8531, THOMSON RESOURCES LTD (ACN 138 358 728), Counties of Bourke and Cooper, Map Sheet (8228, 8229), area of 100 units, for Group 1, dated 8 March, 2017, for a term until 8 March, 2020.

(T16-1129)

No. 5369, now Exploration Licence No. 8532, ARDEA EXPLORATION PTY LTD (ACN 137 889 279), County of Gordon, Map Sheet (8532, 8632), area of 67 units, for Group 1, dated 7 March, 2017, for a term until 7 March, 2020.

The Honorable Don Harwin MLC
Minister for Resources

NOTICE is given that the following application has been withdrawn:

EXPLORATION LICENCE APPLICATION

(T16-1068)

No. 5312, SCANDIUM21 PTY LTD (ACN 008 755 155), County of Cunningham and County of Kennedy, Map Sheet (8332). Withdrawal took effect on 10 March, 2017.

The Honorable Don Harwin MLC
Minister for Resources

NOTICE is given that the following applications for renewal have been received:

(V17-2280)

Exploration Licence No. 4232, NYMAGEE RESOURCES PTY LTD (ACN 154 131 138) AND AUSMINDEX PTY LIMITED (ACN 003 287 634), area of 5 units. Application for renewal received 14 March, 2017.

(V17-2157)

Exploration Licence No. 6522, GRENFELL GOLD PTY LTD (ACN 106 245 238), area of 18 units. Application for renewal received 10 March, 2017.

(V17-2144)

Exploration Licence No. 8245, EMX EXPLORATION PTY LTD (ACN 139 612 427), area of 30 units. Application for renewal received 9 March, 2017.

(V17-2077)

Exploration Licence No. 8248, JODAMA PTY LTD (ACN 095 440 547), area of 8 units. Application for renewal received 7 March, 2017.

(V17-2273)

Exploration Licence No. 8255, SILVER CITY MINERALS LIMITED (ACN 130 933 309), area of 11 units. Application for renewal received 14 March, 2017.

The Honorable Don Harwin MLC
Minister for Resources

RENEWAL OF CERTAIN AUTHORITIES

Notice is given that the following authorities have been renewed:

(06-2975)

Authorisation No. 383, CENTENNIAL MANNERING PTY LTD (ACN 101 509 120), County of Northumberland, Map Sheet (9231), area of 788.53 hectares, for a further term until 21 March, 2021. Renewal effective on and from 7 March, 2017.

(16-1248)

Exploration Licence No. 5498, NEWCASTLE COAL COMPANY PTY LTD (ACN 074 900 208), County of Northumberland, Map Sheet (9132, 9232), area of 1475 hectares, for a further term until 23 July, 2019. Renewal effective on and from 2 March, 2017.

(V16-7585)

Exploration Licence No. 5645, ARGENT (KEMPFIELD) PTY LTD (ACN 155 759 550), County of Georgiana, Map Sheet (8730), area of 3 units, for a further term until 22 November, 2019. Renewal effective on and from 3 March, 2017.

(16-1500)

Exploration Licence No. 5977, CONRAD RESOURCES PTY LTD (ACN 614125521), County of Hardinge, Map Sheet (9138), area of 16 units, for a further term until 27 August, 2017. Renewal effective on and from 10 March, 2017.

(16-1681)

Exploration Licence No. 6482, MANUKA RESOURCES LTD (ACN 611 963 225), Counties of Booroodarra, Mouramba and Robinson, Map Sheet (7934, 8033, 8034), area of 92 units, for a further term until 18 November, 2021. Renewal effective on and from 7 March, 2017.

(V16-7553)

Exploration Licence No. 6483, BIACIL HOLDINGS PTY LTD (ACN 114 218 549), Counties of Hardinge and Sandon, Map Sheet (9136, 9137), area of 55 units, for a further term until 21 November, 2019. Renewal effective on and from 7 March, 2017.

(05-0246)

Exploration Licence No. 6501, ISOKIND PTY LIMITED (ACN 081 732 498), County of Mouramba, Map Sheet (8134), area of 15 units, for a further term until 5 January, 2020. Renewal effective on and from 7 March, 2017.

(V16-7448)

Exploration Licence No. 6661, CLANCY EXPLORATION LIMITED (ACN 105 578 756), Counties of Gordon and Wellington, Map Sheet (8632), area of 24 units, for a further term until 15 November, 2019. Renewal effective on and from 6 March, 2017.

(06-4171)

Exploration Licence No. 6695, PEEL MINING LIMITED (ACN 119 343 734), County of Blaxland, Map Sheet (8032), area of 29 units, for a further term until 8 January, 2020. Renewal effective on and from 1 March, 2017.

(V16-7486)

Exploration Licence No. 6706, 3E STEEL PTY LIMITED (ACN 140 046 939), Counties of Canbelego and Cowper, Map Sheet (8135, 8136, 8235, 8236), area of 96 units, for a further term until 23 January, 2019. Renewal effective on and from 3 March, 2017.

(12-0043)

Exploration Licence No. 6854, EMX EXPLORATION PTY LTD (ACN 139 612 427), County of Yungnulgra, Map Sheet (7436), area of 20 units, for a further term until 8 August, 2019. Renewal effective on and from 10 March, 2017.

(V16-7781)

Exploration Licence No. 6959, 3E STEEL PTY LIMITED (ACN 140 046 939), Counties of Mouramba and Robinson, Map Sheet (8034, 8134), area of 24 units, for a further term until 30 November, 2018. Renewal effective on and from 3 March, 2017.

(V16-7780)

Exploration Licence No. 6960, 3E STEEL PTY LIMITED (ACN 140 046 939), County of Mouramba, Map Sheet (8033, 8034, 8133, 8134), area of 71 units, for a further term until 30 November, 2018. Renewal effective on and from 3 March, 2017.

(V16-7782)

Exploration Licence No. 6961, 3E STEEL PTY LIMITED (ACN 140 046 939), County of Blaxland, Map Sheet (8032), area of 44 units, for a further term until 30 November, 2018. Renewal effective on and from 3 March, 2017.

(16-1045)

Exploration Licence No. 7355, PEAK GOLD MINES PTY LTD (ACN 001 533 777), Counties of Flinders and Mouramba, Map Sheet (8133, 8134, 8233), area of 25 units, for a further term until 24 June, 2021. Renewal effective on and from 3 March, 2017.

(T09-0176)

Exploration Licence No. 7484, PEEL MINING LIMITED (ACN 119 343 734), Counties of Blaxland and Mouramba, Map Sheet (8032, 8033, 8133), area of 59 units, for a further term until 23 March, 2019. Renewal effective on and from 10 March, 2017.

(T09-0285)

Exploration Licence No. 7750, EVOLUTION MINING (COWAL) PTY LIMITED (ACN 007 857 598), Counties of Bland and Gipps, Map Sheet (8330, 8430), area of 220 units, for a further term until 27 May, 2022. Renewal effective on and from 7 March, 2017.

(T11-0245)

Exploration Licence No. 7953, WESTLIME PTY LIMITED (ACN 090 152 828), County of Ashburnham, Map Sheet (8431), area of 6 units, for a further term until 27 June, 2019. Renewal effective on and from 10 March, 2017.

(T11-0318)

Exploration Licence No. 7977, EMC METALS AUSTRALIA PTY LTD (ACN 160 223 325), County of Flinders, Map Sheet (8234), area of 12 units, for a further term until 16 October, 2022. Renewal effective on and from 6 March, 2017.

(T12-1059)

Exploration Licence No. 7989, GOLDEN CROSS OPERATIONS PTY. LTD. (ACN 050 212 827), County of Wellesley, Map Sheet (8624, 8724), area of 16 units, for a further term until 23 October, 2018. Renewal effective on and from 1 March, 2017.

(V16-7883)

Exploration Licence No. 8212, ENDEAVOUR MINERALS PTY LTD (ACN 063 725 708), Counties of Bligh and Wellington, Map Sheet (8632, 8732), area of 40 units, for a further term until 12 December, 2019. Renewal effective on and from 3 March, 2017.

(T14-1038)

Exploration Licence No. 8296, AU EXPLORATION PTY LTD (ACN 160 240 746), County of Farnell, Map Sheet (7135, 7235), area of 18 units, for a further term until 20 August, 2022. Renewal effective on and from 10 March, 2017.

(T14-1099)

Exploration Licence No. 8309, BROKEN HILL MINERALS PTY LTD (ACN 600 094 415), County of Tara, Map Sheet (7131, 7231), area of 32 units, for a further term until 13 October, 2019. Renewal effective on and from 15 February, 2017.

(16-1818)

Exploration Licence No. 8316, EMC METALS AUSTRALIA PTY LTD (ACN 160 223 325), County of Flinders, Map Sheet (8234, 8334), area of 5 units, for a further term until 23 September, 2022. Renewal effective on and from 7 March, 2017.

(T98-0472)

Mining Lease No. 1372 (Act 1992), YELTARA PROSPECTING AND MINING COMPANY PTY LTD (ACN 099 558 915), Parish of Orr, County of Evelyn, Map Sheet (7238-2-N), area of 400 hectares, for a further term until 11 October, 2024. Renewal effective on and from 7 March, 2017.

(16-1721)

Mining Lease No. 1405 (Act 1992), CADIA HOLDINGS PTY LIMITED (ACN 062 648 006), area of 3116 hectares, for a further term until 5 October, 2038. Renewal effective on and from 5 October, 2017.

(16-1720)

Mining Lease No. 1449 (Act 1992), CADIA HOLDINGS PTY LIMITED (ACN 062 648 006), area of 99.16 hectares, for a further term until 5 October, 2038. Renewal effective on and from 5 October, 2017.

The Honorable Don Harwin MLC
Minister for Resources

TRANSFERS

(T16-1009)

Exploration Licence No. 8463, formerly held by EMMERSON RESOURCES LTD (ACN 117 086 745) AND KENEX PTY LTD has been transferred to LACHLAN RESOURCES PTY LTD (ACN 610 889 882) AND KENEX PTY LTD. The transfer was registered on 9 March, 2017.

(T16-1009)

Exploration Licence No. 8464, formerly held by EMMERSON RESOURCES LTD (ACN 117 086 745) AND KENEX PTY LTD has been transferred to LACHLAN RESOURCES PTY LTD (ACN 610 889 882) AND KENEX PTY LTD. The transfer was registered on 9 March, 2017.

The Honorable Don Harwin MLC
Minister for Resources

Primary Industries Notices

Local Land Services (Approval of Form of Transported Stock Statement) Order 2017

under the

Local Land Services Act 2013

I, SCOTT HANSEN, Director General, Department of Primary Industries, with the delegated authority of the Secretary of the Department of Industry, Skills and Regional Development in pursuance of section 18 of the *Local Lands Services Act 2013* (“the Act”) and pursuant to section 127(2) of the Act, for the purposes of approving the form of transport stock statement, make the following Order.

Dated this 9th day of March 2017.

SCOTT HANSEN,
Director General
Department of Primary Industries
(an office within the Department of Industry, Skills and Regional Development)
by Delegation

Explanatory note

This Instrument is made under section 127(2) of the *Local Land Services Act 2013* (the Act). The object of this Instrument is to approve a new transported stock statement for the purposes of Part 9 of the Act.

Local Land Services (Approval of Form of Transported Stock Statement) Order 2017

under the

Local Land Services Act 2013

1. Name of Order

This Order is the *Local Land Services (Approval of Form of Transported Stock Statement) Order 2017*.

2. Commencement

This Order commences on the date it is published in the *NSW Government Gazette*.

3. Interpretation

the Act means the *Local Lands Services Act 2013*.

Note: Transported stock statement has the same meaning as in the Act.

4. Approval of documents as a transported stock statement

The forms, as set out in Schedule 1, are approved as transported stock statements for the purposes of Part 9 of the *Act*.

Schedule 1
Section 127 Approval of form of Transported Stock Statement
Local Lands Services Act 2013

Form
eNVD – a completed electronic national vendor declaration obtained from the LPA website, the National Livestock Identification System website, or an eNVD licensed provider as specified by Meat and Livestock Australia.

Crown Lands Notices

1300 886 235 www.crownland.nsw.gov.au

DUBBO OFFICE

ROADS ACT 1993

ORDER

Transfer of a Crown Road to a Council

IN pursuance of the provisions of section 151, *Roads Act 1993*, the Crown road specified in Schedule 1 is transferred to the Roads Authority specified in Schedule 2 hereunder, as from the date of publication of this notice and as from that date the roads specified in Schedule 1 cease to be a Crown road.

The Hon Paul Toole, MP
Minister for Lands and Forestry

Schedule 1

Parish – King; Parish – Gilgies, County – Canbelego

Land District – Nyngan; LGA – Bogan

Crown road highlighted red on diagram hereunder:

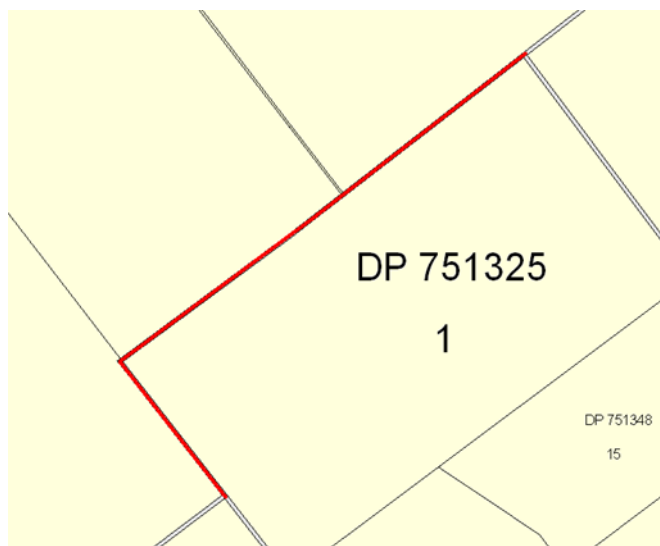

Schedule 2

Road Authority: Bogan Shire Council

File Ref: 16/10816 – W577575

Council Ref: SR60

ORDER – AUTHORISATION OF ADDITIONAL PURPOSE UNDER S121A

Pursuant to section 121A of the *Crown Lands Act 1989*, I authorise by this Order, the purpose specified in Column 1 to be an additional purpose to the declared purpose of the reserves specified opposite thereto in Column 2 of the Schedule.

The Hon Paul Toole, MP
Minister for Lands and Forestry

SCHEDULE

COLUMN 1	COLUMN 2
RURAL SERVICES	Reserve No. 50376 Public Purpose: Public Recreation Notified: 2 December 1914 File Reference: 16/09999

GOULBURN OFFICE

ERRATUM

IN the notification appearing in the NSW Government Gazette of 3 March 2017, folios 563 & 565, under the heading “Transfer of a Crown Road to a Council” in Schedule 1 replace “Town & Parish – Binalong” with “Town & Parish – Wingello”.

The Hon PAUL TOOLE, MP
Minister for Lands and Forestry

APPOINTMENT OF TRUST BOARD MEMBERS

Pursuant to section 93 of the *Crown Lands Act 1989*, the persons whose names are specified in Column 1 of the Schedule hereunder are appointed, for the terms of office specified in that Column, as members of the trust board for the reserve trust specified opposite thereto in Column 2, which has been established and appointed as trustee of the reserve referred to opposite thereto in Column 3 of the Schedule.

The Hon Paul Toole, MP
Minister for Lands and Forestry

SCHEDULE

COLUMN 1	COLUMN 2	COLUMN 3
Andrew George Divall (new member) For a term commencing the date of this notice and expiring 20 February 2019.	Towrang Stockade Trust	Reserve No. 79119 Public Purpose: Preservation of Graves Notified: 30 November 1956 Reserve No. 79121 Public Purpose: Memorial Notified: 30 November 1956 File Reference: GB80R58-004

ROADS ACT 1993

ORDER

Transfer of Crown Road to a Council

In pursuance of the provisions of Section 151 of the Act, the Crown Road specified in Schedule 1 is transferred to the roads authority specified in Schedule 2 hereunder as from the date of publication of this notice and as from that date the road specified in Schedule 1 ceases to be a Crown road.

The Hon PAUL TOOLE, MP
Minister for Lands and Forestry

Schedule 1

Parish – Gurrundah; County – Argyle

Land District – Goulburn

LGA – Upper Lachlan Shire Council

Crown road/s shown coloured in red on diagram/s hereunder.

Schedule 2

Roads Authority: Upper Lachlan Shire Council
 Council Reference: DAS17/26
 Lands Reference: 17/02568

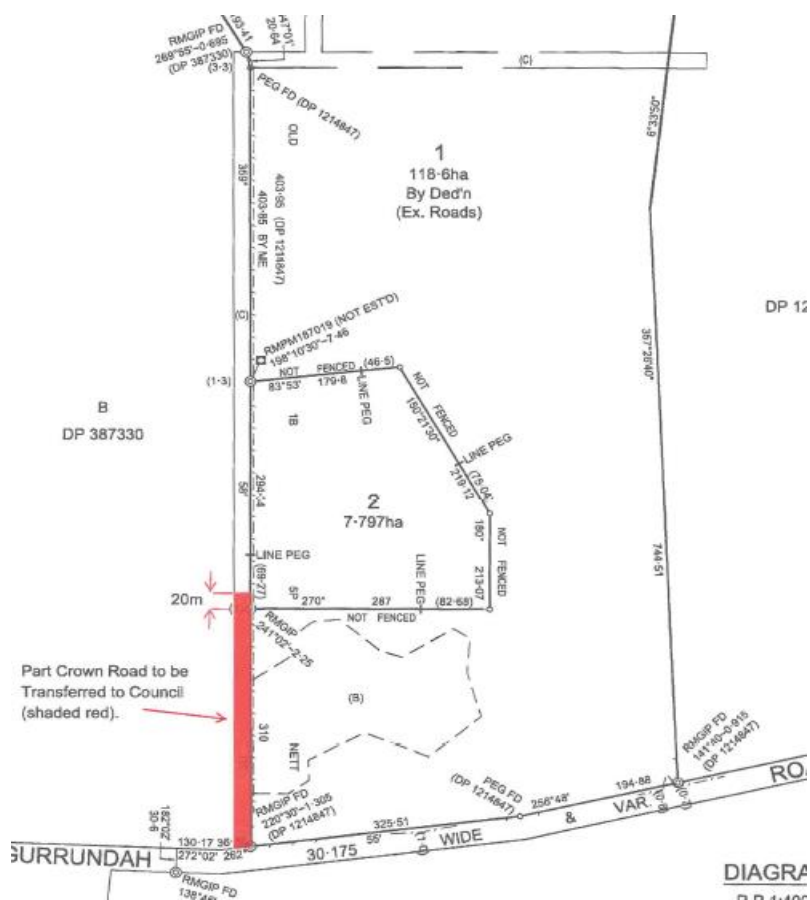

GRAFTON OFFICE

NOTIFICATION OF CLOSING OF A ROAD

In pursuance of the provisions of the *Roads Act 1993*, the road hereunder described is closed and the lands comprised therein cease to be public road and the rights of passage and access that previously existed in relation to the road is extinguished. Upon closing, title to the land, comprising the former public road, vests in the body specified in the Schedule hereunder.

The Hon Paul Toole, MP
 Minister for Lands and Forestry

DESCRIPTION

*Parish – Bungambil; County – Bourke
 Land District – Temora Central; LGA – Coolamon*

Road Closed: Lot 2 DP 1224126
 File No: 16/01542

SCHEDULE

On closing, the land within Lot 2 DP 1224126 remains vested in the State of New South Wales as Crown land.

NOTIFICATION OF CLOSING OF A ROAD

In pursuance of the provisions of the *Roads Act 1993*, the road hereunder described is closed and the lands comprised therein cease to be public road and the rights of passage and access that previously existed in relation

to the road is extinguished. Upon closing, title to the land, comprising the former public road, vests in the body specified in the Schedule hereunder.

The Hon Paul Toole, MP
Minister for Lands and Forestry

DESCRIPTION

Parish – Mukki; County – Hawes
Land District – Walcha; LGA – Walcha

Road Closed: Lot 2 DP 1218258

File No: 15/04047

SCHEDULE

On closing, the land within Lot 2 DP 1218258 remains vested in the State of New South Wales as Crown land.

NOTIFICATION OF CLOSING OF A ROAD

In pursuance of the provisions of the *Roads Act 1993*, the road hereunder described is closed and the lands comprised therein cease to be public road and the rights of passage and access that previously existed in relation to the road is extinguished. Upon closing, title to the land, comprising the former public road, vests in the body specified in the Schedule hereunder.

The Hon Paul Toole, MP
Minister for Lands and Forestry

DESCRIPTION

Parish – Glen Innes; County – Gough
Land District – Glen Innes; LGA – Glen Innes Severn Shire

Road Closed: Lot 3 DP 1227080

File No: AE07H135

SCHEDULE

On closing, the land within Lot 3 DP 1227080 remains vested in the State of New South Wales as Crown land.

NOTIFICATION OF CLOSING OF A ROAD

In pursuance of the provisions of the *Roads Act 1993*, the road hereunder described is closed and the lands comprised therein cease to be public road and the rights of passage and access that previously existed in relation to the road is extinguished. Upon closing, title to the land, comprising the former public road, vests in the body specified in the Schedule hereunder.

The Hon Paul Toole, MP
Minister for Lands and Forestry

DESCRIPTION

Parish – Urialla; County – Murray
Land District – Queanbeyan; LGA – Queanbeyan-Palerang Regional

Road Closed: Lot 4 DP 1224864

File No: 16/02497

SCHEDULE

On closing, the land within Lot 4 DP 1224864 remains vested in the State of New South Wales as Crown land.

NOTIFICATION OF CLOSING OF A ROAD

In pursuance of the provisions of the *Roads Act 1993*, the road hereunder described is closed and the lands comprised therein cease to be public road and the rights of passage and access that previously existed in relation

to the road is extinguished. Upon closing, title to the land, comprising the former public road, vests in the body specified in the Schedule hereunder.

The Hon Paul Toole, MP
Minister for Lands and Forestry

DESCRIPTION

*Parishes – Wyndham, Bangheet; County – Murchison
Land District – Bingara; LGA – Gwydir*

Road Closed: Lots 2-3 DP 1220495

File No: 16/01430

SCHEDULE

On closing, the land within Lots 2-3 DP 1220495 remains vested in the State of New South Wales as Crown land.

NOTIFICATION OF CLOSING OF A ROAD

In pursuance of the provisions of the *Roads Act 1993*, the road hereunder described is closed and the lands comprised therein cease to be public road and the rights of passage and access that previously existed in relation to the road is extinguished. Upon closing, title to the land, comprising the former public road, vests in the body specified in the Schedule hereunder.

The Hon Paul Toole, MP
Minister for Lands and Forestry

DESCRIPTION

*Parish – Irene; County – Westmoreland
Land District – Bathurst; LGA – Oberon*

Road Closed: Lot 1 DP 1226103

File No: 16/05089

SCHEDULE

On closing, the land within Lot 1 DP 1226103 remains vested in the State of New South Wales as Crown land.

NOTIFICATION OF CLOSING OF A ROAD

In pursuance of the provisions of the *Roads Act 1993*, the road hereunder described is closed and the lands comprised therein cease to be public road and the rights of passage and access that previously existed in relation to the road is extinguished. Upon closing, title to the land, comprising the former public road, vests in the body specified in the Schedule hereunder.

The Hon Paul Toole, MP
Minister for Lands and Forestry

DESCRIPTION

*Parishes – Greaves, Whalan; County – Benarba
Land District – Moree; LGA – Moree Plains*

Road Closed: Lot 1 DP 1188723

File No: 13/10883

SCHEDULE

On closing, the land within Lot 1 DP 1188723 remains vested in the State of New South Wales as Crown land.

NOTIFICATION OF CLOSING OF A ROAD

In pursuance of the provisions of the *Roads Act 1993*, the road hereunder described is closed and the lands comprised therein cease to be public road and the rights of passage and access that previously existed in relation

to the road is extinguished. Upon closing, title to the land, comprising the former public road, vests in the body specified in the Schedule hereunder.

The Hon Paul Toole, MP
Minister for Lands and Forestry

DESCRIPTION

*Parish – Timbarra; County – Drake
Land District – Casino; LGA – Tenterfield*

Road Closed: Lot 2 DP 1227286

File No: 15/06307

SCHEDULE

On closing, the land within Lot 2 DP 1227286 remains vested in the State of New South Wales as Crown land.

NOTIFICATION OF CLOSING OF A ROAD

In pursuance of the provisions of the *Roads Act 1993*, the road hereunder described is closed and the lands comprised therein cease to be public road and the rights of passage and access that previously existed in relation to the road is extinguished. Upon closing, title to the land, comprising the former public road, vests in the body specified in the Schedule hereunder.

The Hon Paul Toole, MP
Minister for Lands and Forestry

DESCRIPTION

*Parish – Richmond; County – Richmond
Land District – Casino; LGA – Richmond Valley*

Road Closed: Lot 1 DP 1227660

File No: 16/06225

SCHEDULE

On closing, the land within Lot 1 DP 1227660 remains vested in the State of New South Wales as Crown land.

NOTIFICATION OF CLOSING OF A ROAD

In pursuance of the provisions of the *Roads Act 1993*, the road hereunder described is closed and the lands comprised therein cease to be public road and the rights of passage and access that previously existed in relation to the road is extinguished. Upon closing, title to the land, comprising the former public road, vests in the body specified in the Schedule hereunder.

The Hon Paul Toole, MP
Minister for Lands and Forestry

DESCRIPTION

*Parish – Hadleigh; County – Burnett
Land District – Warialda; LGA – Gwydir*

Road Closed: Lot 3 DP 1226379

File No: 16/04581

SCHEDULE

On closing, the land within Lot 3 DP 1226379 remains vested in the State of New South Wales as Crown land.

NOTIFICATION OF CLOSING OF A ROAD

In pursuance of the provisions of the *Roads Act 1993*, the road hereunder described is closed and the lands comprised therein cease to be public road and the rights of passage and access that previously existed in relation

to the road is extinguished. Upon closing, title to the land, comprising the former public road, vests in the body specified in the Schedule hereunder.

The Hon Paul Toole, MP
Minister for Lands and Forestry

DESCRIPTION

Parish – Moorwatha; County – Hume
Land District – Albury; LGA – Greater Hume

Road Closed: Lot 2 DP 1226147

File No: 16/04681

SCHEDULE

On closing, the land within Lot 2 DP 1226147 which was formerly Crown road remains vested in the State of New South Wales as Crown land.

On closing, the land within Lot 2 DP 1226147 which was formerly council road becomes vested in the State of New South Wales as Crown Land.

NOTIFICATION OF CLOSING OF A ROAD

In pursuance of the provisions of the *Roads Act 1993*, the road hereunder described is closed and the lands comprised therein cease to be public road and the rights of passage and access that previously existed in relation to the road is extinguished. Upon closing, title to the land, comprising the former public road, vests in the body specified in the Schedule hereunder.

The Hon Paul Toole, MP
Minister for Lands and Forestry

DESCRIPTION

Parish – Arthurs Seat; County – Arrawatta
Land District – Inverell; LGA – Inverell

Road Closed: Lot 1 DP 1228513

File No: 16/07748

SCHEDULE

On closing, the land within Lot 1 DP 1228513 remains vested in the State of New South Wales as Crown land.

NOTIFICATION OF CLOSING OF A ROAD

In pursuance of the provisions of the *Roads Act 1993*, the road hereunder described is closed and the lands comprised therein cease to be public road and the rights of passage and access that previously existed in relation to the road is extinguished. Upon closing, title to the land, comprising the former public road, vests in the body specified in the Schedule hereunder.

The Hon Paul Toole, MP
Minister for Lands and Forestry

DESCRIPTION

Parish – Springmount; County – Sandon
Land District – Armidale; LGA – Armidale Dumaresq

Road Closed: Lot 1 DP 1212696

File No: 15/06224

SCHEDULE

On closing, the land within Lot 1 DP 1212696 remains vested in the State of New South Wales as Crown land.

NOTIFICATION OF CLOSING OF A ROAD

In pursuance of the provisions of the *Roads Act 1993*, the road hereunder described is closed and the lands comprised therein cease to be public road and the rights of passage and access that previously existed in relation to the road is extinguished. Upon closing, title to the land, comprising the former public road, vests in the body specified in the Schedule hereunder.

The Hon Paul Toole, MP
Minister for Lands and Forestry

DESCRIPTION

Parish – Marrinumbra; County – Wallace
Land District – Cooma; LGA – Snowy Monaro Regional

Road Closed: Lots 1-2 DP 1227663

File No: 16/07897

SCHEDULE

On closing, that part of Lot 1 DP 1227663 formerly Crown road remains vested in the State of New South Wales as Crown land and that part of Lot 1 DP 1227663 formerly Council road becomes vested in the State of New South Wales as Crown land.

On closing, the land within Lot 2 DP 1227663 remains vested in the State of New South Wales as Crown Land.

NOTIFICATION OF CLOSING OF A ROAD

In pursuance of the provisions of the *Roads Act 1993*, the road hereunder described is closed and the lands comprised therein cease to be public road and the rights of passage and access that previously existed in relation to the road is extinguished. Upon closing, title to the land, comprising the former public road, vests in the body specified in the Schedule hereunder.

The Hon Paul Toole, MP
Minister for Lands and Forestry

DESCRIPTION

Parishes – Langi-Kal-Kal, Quandary; County – Bourke
Land District – Temora Central; LGA – Temora

Road Closed: Lot 1 DP 1212373

File No: 15/06323

SCHEDULE

On closing, the land within Lot 1 DP 1212373 remains vested in the State of New South Wales as Crown land.

NOTIFICATION OF CLOSING OF A ROAD

In pursuance of the provisions of the *Roads Act 1993*, the road hereunder described is closed and the lands comprised therein cease to be public road and the rights of passage and access that previously existed in relation to the road is extinguished. Upon closing, title to the land, comprising the former public road, vests in the body specified in the Schedule hereunder.

The Hon Paul Toole, MP
Minister for Lands and Forestry

DESCRIPTION

Parish – Ballina; County – Rous
Land District – Lismore; LGA – Ballina

Road Closed: Lots 1-2 DP 1221472

File No: 10/06801

SCHEDULE

On closing, the land within Lots 1-2 DP 1221472 remains vested in the Council of the Shire of Ballina as operational land.

NOTIFICATION OF CLOSING OF A ROAD

In pursuance of the provisions of the *Roads Act 1993*, the road hereunder described is closed and the lands comprised therein cease to be public road and the rights of passage and access that previously existed in relation to the road is extinguished. Upon closing, title to the land, comprising the former public road, vests in the body specified in the Schedule hereunder.

The Hon Paul Toole, MP
Minister for Lands and Forestry

DESCRIPTION

Parish – Uralla; County – Sandon
Land District – Armidale; LGA – Uralla

Road Closed: Lot 2 DP 1221232

File No: 14/11221

SCHEDULE

On closing, the land within Lot 2 DP 1221232 remains vested in the State of New South Wales as Crown land.

NOTIFICATION OF CLOSING OF A ROAD

In pursuance of the provisions of the *Roads Act 1993*, the road hereunder described is closed and the lands comprised therein cease to be public road and the rights of passage and access that previously existed in relation to the road is extinguished. Upon closing, title to the land, comprising the former public road, vests in the body specified in the Schedule hereunder.

The Hon Paul Toole, MP
Minister for Lands and Forestry

DESCRIPTION

Parish – Condong; County – Rous
Land District – Murwillumbah; LGA – Tweed

Road Closed: Lot 2 DP 1192509

File No: 10/14552

SCHEDULE

On closing, the land within Lot 2 DP 1192509 remains vested in the State of New South Wales as Crown land.

NOTIFICATION OF CLOSING OF A ROAD

In pursuance of the provisions of the *Roads Act 1993*, the road hereunder described is closed and the lands comprised therein cease to be public road and the rights of passage and access that previously existed in relation to the road is extinguished. Upon closing, title to the land, comprising the former public road, vests in the body specified in the Schedule hereunder.

The Hon Paul Toole, MP
Minister for Lands and Forestry

DESCRIPTION

Parish – Condong; County – Rous
Land District – Murwillumbah; LGA – Tweed

Road Closed: Lot 1 DP 1192509

File No: 10/14552

SCHEDULE

On closing, the land within Lot 1 DP 1192509 remains vested in the State of New South Wales as Crown land.

NOTIFICATION OF CLOSING OF A ROAD

In pursuance of the provisions of the *Roads Act 1993*, the road hereunder described is closed and the lands comprised therein cease to be public road and the rights of passage and access that previously existed in relation to the road is extinguished. Upon closing, title to the land, comprising the former public road, vests in the body specified in the Schedule hereunder.

The Hon Paul Toole, MP
Minister for Lands and Forestry

DESCRIPTION

*Parishes – Carraa, Greaves, Coubal; County – Benarba
Land District – Moree; LGA – Moree Plains*

Road Closed: Lots 2-3 DP 1222045

File No: 16/02005

SCHEDULE

On closing, that part of the land within Lot 2-3 DP 1222045 which was formerly Crown road remains vested in the State of New South Wales as Crown Land.

On closing, that part of the land within Lot 2 DP 1222045 which was formerly Council road becomes vested in the State of New South Wales as Crown Land.

NOTIFICATION OF CLOSING OF A ROAD

In pursuance of the provisions of the *Roads Act 1993*, the road hereunder described is closed and the lands comprised therein cease to be public road and the rights of passage and access that previously existed in relation to the road is extinguished. Upon closing, title to the land, comprising the former public road, vests in the body specified in the Schedule hereunder.

The Hon Paul Toole, MP
Minister for Lands and Forestry

DESCRIPTION

*Parish – Careunga; County – Stapylton
Land District – Moree; LGA – Moree Plains*

Road Closed: Lot 2 DP 1227329

File No: 16/07696

SCHEDULE

On closing, the land within Lot 2 DP 1227329 remains vested in the State of New South Wales as Crown land.

NOTIFICATION OF CLOSING OF A ROAD

In pursuance of the provisions of the *Roads Act 1993*, the road hereunder described is closed and the lands comprised therein cease to be public road and the rights of passage and access that previously existed in relation to the road is extinguished. Upon closing, title to the land, comprising the former public road, vests in the body specified in the Schedule hereunder.

The Hon Paul Toole, MP
Minister for Lands and Forestry

DESCRIPTION

*Parish – Careunga; County – Stapylton
Land District – Moree; LGA – Moree Plains*

Road Closed: Lots 3-4 DP 1227329

File No: 16/07695

SCHEDULE

On closing, the land within Lots 3-4 DP 1227329 remains vested in the State of New South Wales as Crown land.

NOTIFICATION OF CLOSING OF A ROAD

In pursuance of the provisions of the *Roads Act 1993*, the road hereunder described is closed and the lands comprised therein cease to be public road and the rights of passage and access that previously existed in relation to the road is extinguished. Upon closing, title to the land, comprising the former public road, vests in the body specified in the Schedule hereunder.

The Hon Paul Toole, MP
Minister for Lands and Forestry

DESCRIPTION

*Parish – Careunga; County – Stapylton
Land District – Moree; LGA – Moree Plains*

Road Closed: Lot 1 DP 1227329

File No: 16/07697

SCHEDULE

On closing, the land within Lot 1 DP 1227329 remains vested in the State of New South Wales as Crown land.

NOTIFICATION OF CLOSING OF A ROAD

In pursuance of the provisions of the *Roads Act 1993*, the road hereunder described is closed and the lands comprised therein cease to be public road and the rights of passage and access that previously existed in relation to the road is extinguished. Upon closing, title to the land, comprising the former public road, vests in the body specified in the Schedule hereunder.

The Hon Paul Toole, MP
Minister for Lands and Forestry

DESCRIPTION

*Parish – Cobrabald; County – Vernon
Land District – Walcha; LGA – Walcha*

Road Closed: Lots 10-11 DP 1224178

File No: 16/05979

SCHEDULE

On closing, the land within Lots 10-11 DP 1224178 remains vested in the State of New South Wales as Crown land.

GRIFFITH OFFICE

ROADS ACT 1993

ORDER

TRANSFER OF A CROWN ROAD TO A COUNCIL

IN pursuance of the provisions of section 151, *Roads Act 1993*, the Crown road specified in Schedule 1, is transferred to the Roads Authority specified in Schedule 2, hereunder, as from the date of publication of this notice and as from that date the road specified in Schedule 1 ceases to be a Crown public road.

The Hon PAUL TOOLE MP
Minister for Lands and Forestry

Schedule 1

Parish: Stanbridge; County: Cooper

Land District – Griffith

LGA – Griffith City Council

The Crown road as shown shaded on the diagram below.

Width to be transferred: Whole width



Schedule 2

Roads Authority: Griffith City Council (Ref: Minute No. 17-056)

File Reference: 17/02117; W580659

APPOINTMENT OF TRUST BOARD MEMBERS

Pursuant to section 93 of the *Crown Lands Act 1989*, the persons whose names are specified in Column 1 of the Schedule hereunder are appointed, for the terms of office specified in that Column, as members of the trust board for the reserve trust specified opposite thereto in Column 2, which has been established and appointed as trustee of the reserve referred to opposite thereto in Column 3 of the Schedule.

The Hon Paul Toole, MP
Minister for Lands and Forestry

SCHEDULE

COLUMN 1	COLUMN 2	COLUMN 3
Mark Andrew Quilter (new member) For a term commencing the date of this notice and expiring 27 November 2019.	Sandigo Recreation And Hall Trust	Reserve No. 89786 Public Purpose: Public Recreation, Public Hall Notified: 30 April 1976 File Reference: GH89R162

HAY OFFICE

**NOTICE OF PURPOSE OTHER THAN THE DECLARED PURPOSE PURSUANT TO
SECTION 34A(2)(b) OF THE CROWN LANDS ACT 1989**

Pursuant to section 34A(2)(b) of the *Crown Lands Act 1989*, the Crown reserve(s) specified in Column 2 of the Schedule is to be used or occupied under a relevant interest granted for the purpose(s) specified in Column 1 of the Schedule where such use or occupation is other than the declared purpose of the reserve

The Hon Paul Toole, MP
Minister for Lands and Forestry

SCHEDULE

COLUMN 1	COLUMN 2
GRAZING; ACCESS TO WATER	Reserve No. 61033 Public Purpose: Access Notified: 15 March 1929 File Reference: 16/08425

SCHEDULE

COLUMN 1	COLUMN 2
GRAZING; CHANNEL; PUMP SITE	Reserve No. 756333 Public Purpose: Future Public Requirements Notified: 29 June 2007 File Reference: HY80H330

MAITLAND OFFICE

**NOTICE OF PURPOSE OTHER THAN THE DECLARED PURPOSE PURSUANT TO
SECTION 34A(2)(b) OF THE CROWN LANDS ACT 1989**

Pursuant to section 34A(2)(b) of the *Crown Lands Act 1989*, the Crown reserve(s) specified in Column 2 of the Schedule is to be used or occupied under a relevant interest granted for the purpose(s) specified in Column 1 of the Schedule where such use or occupation is other than the declared purpose of the reserve

The Hon Paul Toole, MP
Minister for Lands and Forestry

SCHEDULE

COLUMN 1	COLUMN 2
SEAWALL	Reserve No. 56146 Public Purpose: Generally Notified: 11 May 1923 File Reference: 16/02785 Reserve No. 1011268 Public Purpose: Future Public Requirements Notified: 3 February 2006 File Reference: 16/02785

MOREE OFFICE

NOTICE OF PURPOSE OTHER THAN THE DECLARED PURPOSE PURSUANT TO SECTION 34A(2)(b) OF THE CROWN LANDS ACT 1989

Pursuant to section 34A(2)(b) of the *Crown Lands Act 1989*, the Crown reserve(s) specified in Column 2 of the Schedule is to be used or occupied under a relevant interest granted for the purpose(s) specified in Column 1 of the Schedule where such use or occupation is other than the declared purpose of the reserve

The Hon Paul Toole, MP
Minister for Lands and Forestry

SCHEDULE

COLUMN 1	COLUMN 2
RESIDENCE	Reserve No. 80379 Public Purpose: Future Public Requirements Notified: 14 February 1958 File Reference: 16/02229

NEWCASTLE OFFICE

NOTIFICATION OF CLOSING OF A ROAD

In pursuance of the provisions of the *Roads Act 1993*, the road hereunder described is closed and the lands comprised therein cease to be public road and the rights of passage and access that previously existed in relation to the road is extinguished. Upon closing, title to the land, comprising the former public road, vests in the body specified in the Schedule hereunder.

The Hon Paul Toole, MP
Minister for Lands and Forestry

DESCRIPTION

Parish – Ashcroft; County – Mitchell
Land District – Wagga Wagga; LGA – Lockhart

Road Closed: Lot 3 DP 1227222

File No: 12/00142

SCHEDULE

On closing, the land within Lot 3 DP 1227222 remains vested in the State of New South Wales as Crown land.

NOTIFICATION OF CLOSING OF A ROAD

In pursuance of the provisions of the *Roads Act 1993*, the road hereunder described is closed and the lands comprised therein cease to be public road and the rights of passage and access that previously existed in relation to the road is extinguished. Upon closing, title to the land, comprising the former public road, vests in the body specified in the Schedule hereunder.

The Hon Paul Toole, MP
Minister for Lands and Forestry

DESCRIPTION

Parish – Gidley; County – Cumberland
Land District – Windsor; LGA – Blacktown

Road Closed: Lot 1 DP 1226148

File No: 16/01268

SCHEDULE

On closing, the land within Lot 1 DP 1226148 becomes vested in the State of New South Wales as Crown Land.

Council's reference: 080100

NOTIFICATION OF CLOSING OF A ROAD

In pursuance of the provisions of the *Roads Act 1993*, the road hereunder described is closed and the lands comprised therein cease to be public road and the rights of passage and access that previously existed in relation to the road is extinguished. Upon closing, title to the land, comprising the former public road, vests in the body specified in the Schedule hereunder.

The Hon Paul Toole, MP
Minister for Lands and Forestry

DESCRIPTION

*Parishes – Wombah, Mamanga; County – Caira
Land District – Balranald South; LGA – Balranald, Murray River*

Road Closed: Lots 1-2 DP 1228068

File No: 16/09133

SCHEDULE

On closing, the land within Lots 1-2 DP 1228068 remains vested in the State of New South Wales as Crown land.

NOTIFICATION OF CLOSING OF A ROAD

In pursuance of the provisions of the *Roads Act 1993*, the road hereunder described is closed and the lands comprised therein cease to be public road and the rights of passage and access that previously existed in relation to the road is extinguished. Upon closing, title to the land, comprising the former public road, vests in the body specified in the Schedule hereunder.

The Hon Paul Toole, MP
Minister for Lands and Forestry

DESCRIPTION

*Parish – Tabrabucca; County – Roxburgh
Land District – Rylstone; LGA – Mid-Western Regional*

Road Closed: Lot 2 DP 1224407

File No: CL/00415

SCHEDULE

On closing, the land within Lot 2 DP 1224407 remains vested in the State of New South Wales as Crown land.

NOTIFICATION OF CLOSING OF A ROAD

In pursuance of the provisions of the *Roads Act 1993*, the road hereunder described is closed and the lands comprised therein cease to be public road and the rights of passage and access that previously existed in relation to the road is extinguished. Upon closing, title to the land, comprising the former public road, vests in the body specified in the Schedule hereunder.

The Hon Paul Toole, MP
Minister for Lands and Forestry

DESCRIPTION

*Parish – Faulkland; County – Gloucester
Land District – Gloucester; LGA – Mid-Coast*

Road Closed: Lot 1 DP 1214282

File No: 15/01778

SCHEDULE

On closing, the land within Lot 1 DP 1214282 remains vested in the State of New South Wales as Crown land.

NOTIFICATION OF CLOSING OF A ROAD

In pursuance of the provisions of the *Roads Act 1993*, the road hereunder described is closed and the lands comprised therein cease to be public road and the rights of passage and access that previously existed in relation to the road is extinguished. Upon closing, title to the land, comprising the former public road, vests in the body specified in the Schedule hereunder.

The Hon Paul Toole, MP
Minister for Lands and Forestry

DESCRIPTION

Parishes – Faulkland, Trevor; County – Gloucester

Land District – Gloucester; LGA – Mid-Coast

Road Closed: Lot 4 DP 1214283, Lot 5 DP 1227008

File No: 15/01776

SCHEDULE

On closing, the land within Lot 4 DP 1214283, Lot 5 DP 1227008 remains vested in the State of New South Wales as Crown land.

NOTIFICATION OF CLOSING OF A ROAD

In pursuance of the provisions of the *Roads Act 1993*, the road hereunder described is closed and the lands comprised therein cease to be public road and the rights of passage and access that previously existed in relation to the road is extinguished. Upon closing, title to the land, comprising the former public road, vests in the body specified in the Schedule hereunder.

The Hon Paul Toole, MP
Minister for Lands and Forestry

DESCRIPTION

Parish – Huntawong; County – Nicholson

Land District – Hillston; LGA – Carrathool

Road Closed: Lots 1-2 DP 1227968

File No: 16/00168

SCHEDULE

On closing, the land within Lots 1-2 DP 1227968 remains vested in the State of New South Wales as Crown land.

NOTIFICATION OF CLOSING OF A ROAD

In pursuance of the provisions of the *Roads Act 1993*, the road hereunder described is closed and the lands comprised therein cease to be public road and the rights of passage and access that previously existed in relation to the road is extinguished. Upon closing, title to the land, comprising the former public road, vests in the body specified in the Schedule hereunder.

The Hon Paul Toole, MP
Minister for Lands and Forestry

DESCRIPTION

Parishes – Lucan, Somers, Lyndhurst; County – Bathurst

Land District – Blayney; LGA – Blayney

Road Closed: Lots 1-3 DP 1225153

File No: CL/00743

SCHEDULE

On closing, the land within Lots 1-3 DP 1225153 remains vested in the State of New South Wales as Crown land.

NOTIFICATION OF CLOSING OF A ROAD

In pursuance of the provisions of the *Roads Act 1993*, the road hereunder described is closed and the lands comprised therein cease to be public road and the rights of passage and access that previously existed in relation to the road is extinguished. Upon closing, title to the land, comprising the former public road, vests in the body specified in the Schedule hereunder.

The Hon Paul Toole, MP
Minister for Lands and Forestry

DESCRIPTION

Parishes – Warrangunia, Tabrabucca; County – Roxburgh

Land District – Rylstone; LGA – Mid-Western Regional

Road Closed: Lot 1 DP 1224319, Lot 4 DP 1224407

File No: CL/00415

SCHEDULE

On closing, the land within Lot 1 DP 1224319, Lot 4 DP 1224407 remains vested in the State of New South Wales as Crown land.

NOTIFICATION OF CLOSING OF A ROAD

In pursuance of the provisions of the *Roads Act 1993*, the road hereunder described is closed and the lands comprised therein cease to be public road and the rights of passage and access that previously existed in relation to the road is extinguished. Upon closing, title to the land, comprising the former public road, vests in the body specified in the Schedule hereunder.

The Hon Paul Toole, MP
Minister for Lands and Forestry

DESCRIPTION

Parish – Wallendoon; County – Harden

Land District – Young; LGA – Cootamundra-Gundagai Regional

Road Closed: Lot 1 DP 1215604

File No: 10/13230 RS

SCHEDULE

On closing, the land within Lot 1 DP 1215604 remains vested in the State of New South Wales as Crown land.

NOTIFICATION OF CLOSING OF A ROAD

In pursuance of the provisions of the *Roads Act 1993*, the road hereunder described is closed and the lands comprised therein cease to be public road and the rights of passage and access that previously existed in relation to the road is extinguished. Upon closing, title to the land, comprising the former public road, vests in the body specified in the Schedule hereunder.

The Hon Paul Toole, MP
Minister for Lands and Forestry

DESCRIPTION

Parishes – Wolabler, Manildra; County – Ashburnham

Land District – Molong; LGA – Cabonne

Road Closed: Lot 1 DP 1224317

File No: CL/00528

SCHEDULE

On closing, the land within Lot 1 DP 1224317 remains vested in the State of New South Wales as Crown land.

NOTIFICATION OF CLOSING OF A ROAD

In pursuance of the provisions of the *Roads Act 1993*, the road hereunder described is closed and the lands comprised therein cease to be public road and the rights of passage and access that previously existed in relation to the road is extinguished. Upon closing, title to the land, comprising the former public road, vests in the body specified in the Schedule hereunder.

The Hon Paul Toole, MP
Minister for Lands and Forestry

DESCRIPTION

*Parish – Wallabadah; County – Buckland
Land District – Tamworth; LGA – Liverpool Plains*

Road Closed: Lot 1 DP 1228437
File No: 16/09228

SCHEDULE

On closing, the land within Lot 1 DP 1228437 remains vested in the State of New South Wales as Crown land.

NOTIFICATION OF CLOSING OF A ROAD

In pursuance of the provisions of the *Roads Act 1993*, the road hereunder described is closed and the lands comprised therein cease to be public road and the rights of passage and access that previously existed in relation to the road is extinguished. Upon closing, title to the land, comprising the former public road, vests in the body specified in the Schedule hereunder.

The Hon Paul Toole, MP
Minister for Lands and Forestry

DESCRIPTION

*Parish – Terarra; County – Ashburnham
Land District – Molong; LGA – Cabonne*

Road Closed: Lots 1-2 DP 1226610
File No: 15/08365

SCHEDULE

On closing, the land within Lots 1-2 DP 1226610 remains vested in the State of New South Wales as Crown land.

NOTIFICATION OF CLOSING OF A ROAD

In pursuance of the provisions of the *Roads Act 1993*, the road hereunder described is closed and the lands comprised therein cease to be public road and the rights of passage and access that previously existed in relation to the road is extinguished. Upon closing, title to the land, comprising the former public road, vests in the body specified in the Schedule hereunder.

The Hon Paul Toole, MP
Minister for Lands and Forestry

DESCRIPTION

*Parish – Boro; County – Argyle
Land District – Goulburn; LGA – Goulburn Mulwaree*

Road Closed: Lot 2 DP 1211172
File No: 14/07644

SCHEDULE

On closing, the land within Lot 2 DP 1211172 remains vested in the State of New South Wales as Crown land.

NOTIFICATION OF CLOSING OF A ROAD

In pursuance of the provisions of the *Roads Act 1993*, the road hereunder described is closed and the lands comprised therein cease to be public road and the rights of passage and access that previously existed in relation to the road is extinguished. Upon closing, title to the land, comprising the former public road, vests in the body specified in the Schedule hereunder.

The Hon Paul Toole, MP
Minister for Lands and Forestry

DESCRIPTION

Parish – Bugong; County – Camden
Land District – Nowra; LGA – Shoalhaven

Road Closed: Lot 1 DP 1226946
File No: 16/07896

SCHEDULE

On closing, the land within Lot 1 DP 1226946 remains vested in the State of New South Wales as Crown land.

NOWRA OFFICE

ROADS ACT 1993

ORDER

Transfer of a Crown Road to a Council

IN pursuance of the provisions of section 151, *Roads Act 1993*, the Crown roads specified in Schedule 1 is transferred to the Roads Authority specified in Schedule 2 hereunder, as from the date of publication of this notice and as from that date the roads specified in Schedule 1 cease to be a Crown road.

The Hon PAUL TOOLE, MP
Minister for Lands and Forestry

Schedule 1

Parish – Benandarah; County – St Vincent
Land District – Moruya; LGA – Eurobodalla

Description: Crown road shown by red colour in diagram hereunder at Long Beach having an area of approx. 1705m².



Schedule 2

Road Authority: Eurobodalla Shire Council
 Crown Lands File Ref: 17/02009 – W580450
 Council Ref: 01.5510.S/E94.6618

APPOINTMENT OF TRUST BOARD MEMBERS

Pursuant to section 93 of the *Crown Lands Act 1989*, the persons whose names are specified in Column 1 of the Schedule hereunder are appointed, for the terms of office specified in that Column, as members of the trust board for the reserve trust specified opposite thereto in Column 2, which has been established and appointed as trustee of the reserve referred to opposite thereto in Column 3 of the Schedule.

The Hon Paul Toole, MP
 Minister for Lands and Forestry

SCHEDULE

COLUMN 1	COLUMN 2	COLUMN 3
Graham John Smith (new member) Julie Rae Price (new member) For a term commencing the date of this notice and expiring 23 December 2019.	Kangaroo Valley Pioneer Settlement Reserve Trust	Reserve No. 88460 Public Purpose: Public Recreation, Museum Notified: 7 January 1972 File Reference: NA79R115

ORANGE OFFICE

ROADS ACT 1993

ORDER

Transfer of Crown Roads to Council

IN pursuance of the provisions of Section 151, *Roads Act 1993*, the Crown public road specified in Schedule 1 is transferred to the Roads Authority specified in Schedule 2 hereunder, and as from the date of publication of this notice, the road specified in Schedule 1 ceases to be a Crown public road.

The Hon Paul Toole, MP,
 Minister for Lands and Forestry

SCHEDULE 1

Parish – Currajong; County – Ashburnham

Land District – Orange

Local Government Area – Parkes

The road as shown shaded on the diagram below.

Width to be transferred: Whole width

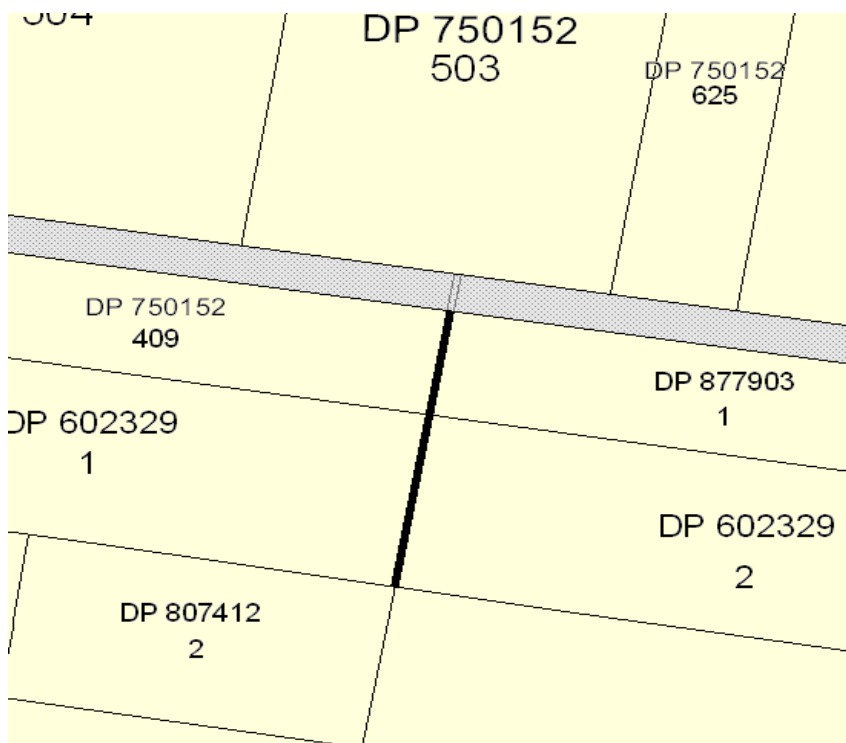

SCHEDULE 2

Roads Authority: Parkes Shire Council

Council Ref: LF:MW

File Ref: 17/02163; W581241

SYDNEY METROPOLITAN OFFICE

NOTICE OF PURPOSE OTHER THAN THE DECLARED PURPOSE PURSUANT TO SECTION 34A(2)(b) OF THE CROWN LANDS ACT 1989

Pursuant to section 34A(2)(b) of the *Crown Lands Act 1989*, the Crown reserve(s) specified in Column 2 of the Schedule is to be used or occupied under a relevant interest granted for the purpose(s) specified in Column 1 of the Schedule where such use or occupation is other than the declared purpose of the reserve

The Hon Paul Toole, MP
Minister for Lands and Forestry

SCHEDULE

COLUMN 1	COLUMN 2
ENVIRONMENTAL PROTECTION	Reserve No. 71235 Public Purpose: Public Recreation Notified: 16 June 1944 File Reference: 16/05755 Reserve No. 84882 Public Purpose: Public Recreation Notified: 22 May 1964 File Reference: 16/05755 Act Of Parliament No. 500065 Public Purpose: Public Recreation Notified: 20 May 1914 File Reference: 16/05755

COLUMN 1	COLUMN 2
	Reserve No. 1022908 Public Purpose: Surfing Recreation Notified: 16 October 2009 File Reference: 16/05755 Reserve No. 1031949 Public Purpose: Public Recreation and Coastal Environmental Protection Notified: 18 March 2011 File Reference: 16/05755

WAGGA WAGGA OFFICE

ERRATUM

IN the notice appearing in the NEW South Wales Government Gazette of the 11 August 2000, Folio 7646, under the heading of “ROADS ACT 1993” Order Transfer of Crown Road to a Council, in schedule 1 it reads ‘...west of Lot 1 in DP 753326...’ this should have read ‘...west of Lot 1 Section 2 DP 758453...’. Note Lot 1 Sec 2 DP 758453 is now part of Lot 50 DP 1135041. Ref WA00H113

The Hon Paul Toole, MP
 Minister for Lands and Forestry

WESTERN REGION OFFICE

NOTICE OF PURPOSE OTHER THAN THE DECLARED PURPOSE PURSUANT TO SECTION 34A(2)(b) OF THE CROWN LANDS ACT 1989

Pursuant to section 34A(2)(b) of the *Crown Lands Act 1989*, the Crown reserve(s) specified in Column 2 of the Schedule is to be used or occupied under a relevant interest granted for the purpose(s) specified in Column 1 of the Schedule where such use or occupation is other than the declared purpose of the reserve

The Hon Paul Toole, MP
 Minister for Lands and Forestry

SCHEDULE

COLUMN 1	COLUMN 2
ERECTION OF SIGNS	Reserve No. 1013830 Public Purpose: Future Public Requirements Notified: 29 June 2007 File Reference: 16/06156

Other Government Notices

ASSOCIATIONS INCORPORATION ACT 2009

Cancellation of incorporation pursuant to section 74

TAKE NOTICE that the incorporation of the following associations is cancelled by this notice pursuant to section 74 of the *Associations Incorporation Act 2009*.

ACTIVITIES CLUB M.C.C. INC	Y2093627
AGAPE ATTITUDINAL HEALING CENTRE INCORPORATED	INC1600546
THE BYRE – A PLACE OF SHELTER INCORPORATED	INC1300233
COFFS HARBOUR CITY SPORT AND RECREATION INCORPORATED	Y2559600
DANCE ETHOS AUSTRALIA INCORPORATED	INC1600668
LAKE MACQUARIE CARAVANNERS INCORPORATED	Y2988620
MACKSVILLE AND DISTRICT SENIOR CITIZENS CLUB INC	
MANILLA CREATIVE ARTISTS INCORPORATED	Y2525134
THE ROTARY CLUB OF TWEED COAST INCORPORATED	INC9893270
THE TUROSS MUSIC FESTIVAL INCORPORATED	INC9896379
WALLABY HILL HORSETRIALS INCORPORATED	INC9882931

Cancellation is effective as at the date of gazettal.

Dated this 15th day of March 2017.

Robyne Lunney
 Delegate of the Commissioner
 NSW Fair Trading

ASSOCIATIONS INCORPORATION ACT 2009

Cancellation of Registration pursuant to Section 76

TAKE NOTICE that the registration of the following associations is cancelled by this notice pursuant to section 76 of the *Associations Incorporation Act 2009*.

ARTBRIDGE COMMUNITY INCORPORATED	INC1501595
ASPIRE INCORPORATED	INC9891278
AUSTRALIA-CHINA ASSOCIATION FOR PROMOTION OF INDUSTRY & COMMERCE INCORPORATED	INC9891412
AUSTRALIAN ASSOCIATION OF SUSTAINABLE HEALTH CARE INCORPORATED	INC9889887
BARWON POLOCROSSE CLUB INC	Y1325836
COOL SCHOOLS INCORPORATED	INC1300507
COONAMBLE SENIOR CITIZENS ASSOCIATION INCORPORATED	Y0360204
EAST MOLONG TENNIS CLUB INCORPORATED	Y2790601
EUABALONG WEST LANDCARE GROUP INCORPORATED	Y2546025
EUGOWRA SWIMMING CLUB INCORPORATED	INC9888480
FIELDHOUSE ABORIGINAL FAMILY SERVICES INCORPORATED	INC1300645
INDIVIDUAL CLEANERS ASSOCIATION OF AUSTRALIA & NEW ZEALAND INCORPORATED	INC9889768
INGLEBURN MAGPIES BASEBALL CLUB INCORPORATED	INC9890093
LAKE MACQUARIE LIGHTNING INDOOR SPORTS ASSOCIATION INCORPORATED	Y2082438
LITTLE B'S INCORPORATED	INC1300541
MACARTHUR AREA NATURAL THERAPISTS REFERRAL ASSOCIATION INCORPORATED	INC9896488

MERRYGOEN DISTRICT COMMUNITY AND TENNIS CLUB INCORPORATED	Y2875001
MUTUAL BANKING CODE COMPLIANCE COMMITTEE ASSOCIATION INCORPORATED	INC9890889
N.S.W MICROSPRINT CLUB INCORPORATED	INC9885713
OVERSEAS FRIENDS OF TRS AUSTRALIA INCORPORATED	INC1600860
QUIRK-ABILITY INCORPORATED	INC9896880
QUOTA INTERNATIONAL OF THE SILVER CITY INCORPORATED	INC9882297
SITTERS CONNECTION INCORPORATED	INC9890628
SOCIETY FOR BIODIVERSITY POLICY INCORPORATED	INC1300455
SYDNEY QI MENG CHINESE CULTURE SCHOOL INCORPORATED	INC1500805
SYDNEY SHAKESPEARE FESTIVAL INCORPORATED	INC9887292
THE POTTERS HOUSE CHRISTIAN CHURCH LISMORE INCORPORATED	INC9889681
THE WAY TO HAPPINESS AUSTRALIA INCORPORATED	Y1941026
WARRAGAMBA RANGERS SOFTBALL CLUB INCORPORATED	INC9886289
YONG SUL KWAN EVENTS INCORPORATED	INC9897239

Cancellation is effective as at the date of gazettal.

Dated this 17th day of March 2017.

Christine Gowland
 Delegate of the Commissioner
 NSW Fair Trading

ASSOCIATIONS INCORPORATION ACT 2009

Cancellation of registration pursuant to section 80

TAKE NOTICE that NATIONAL N.E.I.S. ASSOCIATION INCORPORATED Y2190827 became registered under the *Corporations Act 2001* as NATIONAL NEIS ASSOCIATION LIMITED CAN 615 535 816, a company limited by guarantee, on the 1ST day of DECEMBER 2016, and accordingly its registration under the *Associations Incorporation Act 2009* is cancelled as of that date.

Robyne Lunney
 Delegate of the Commissioner,
 NSW Fair Trading

13TH MARCH 2017

COMPANION ANIMALS REGULATION 2008

ORDER

Organisations approved by the Chief Executive, Local Government
 under clause 16(d) of the Companion Animals Regulation 2008

Pursuant to clause 16(d) of the *Companion Animals Regulation 2008*, the organisation listed in Schedule 1 is hereby approved, subject to the conditions contained in Schedule 2.

SCHEDULE 1

Name of organisation	Address of organisation
Paws for Thought Rescue Inc	PO Box 18 NORTH RYDE BC NSW 1670

SCHEDULE 2

1. The exemption under clause 16(d) of the *Companion Animals Regulation 2008* from the requirements of section 9 of the *Companion Animals Act 1998* only applies to an animal in the custody of an organisation listed in Schedule 1:
 - a) if the organisation is holding that animal for the sole purpose of re-housing the animal with a new owner; and
 - b) if the organisation maintains appropriate records that show compliance with the *Companion Animals Act 1998*, *Companion Animals Regulation 2008* and the Guidelines for Approval to be an Organisation Exempt from Companion Animal Registration under clause 16(d) of the *Companion Animals Regulation 2008*; and
 - c) if the organisation maintains a register that is made available to the relevant local council and the Office of Local Government as requested. The Register must list the names of all carers involved in the rehoming of animals and the locations of all animals received under the exemption while in the custody of the organisation.
2. The exemption under clause 16(d) of the *Companion Animals Regulation 2008* from the requirements of section 9 of the *Companion Animals Act 1998* expires five years from the date of this order, unless revoked or varied at an earlier time.

Mark Hely
 Manager, Performance
 Office of Local Government

Date: 14 March 2017

DISTRICT COURT ACT 1973

District Court of New South Wales

Direction

Pursuant to section 32 of the *District Court Act 1973*, I direct that the District Court shall sit in its civil jurisdiction at the place and time shown as follows:

Armidale	10.00am	10 April 2017 (1 week) Sittings Cancelled
Taree	10.00am	27 March 2017 (1 week) Sittings Cancelled

Dated this 14th day of March 2017.

Justice D Price AM
 Chief Judge

DISTRICT COURT ACT 1973

District Court of New South Wales

Direction

Pursuant to section 173 of the *District Court Act 1973*, I direct that the District Court shall sit in its criminal jurisdiction at the place and time shown as follows:

Griffith	10am	6 November 2017 (3 weeks)
Nowra	10am	1 May 2017 (2 weeks) In lieu of 18 April 2017 (4 weeks) Special Fixture
Wagga Wagga	10am	27 November 2017 (4 weeks) Special Fixture

Dated this 15th day of March 2017

Justice D Price AM
 Chief Judge

GEOGRAPHICAL NAMES ACT 1966

PURSUANT to the provisions of Section 10 of the *Geographical Names Act 1966*, the Geographical Names Board has this day assigned the name listed hereunder as a geographical name.

Elsie Wearn Park for a reserve situated in Robert Street, Artarmon, in the Willoughby LGA.

The position and extent for this feature is recorded and shown within the Geographical Names Register of New South Wales. This information can be accessed through the Board's website at www.gnb.nsw.gov.au

NARELLE UNDERWOOD
Chair
Geographical Names Board
PO Box 143
BATHURST NSW 2795

GEOGRAPHICAL NAMES ACT 1966

PURSUANT to the provisions of Section 10 of the *Geographical Names Act 1966*, the Geographical Names Board has on this day assigned the name listed hereunder as a geographical name.

Robyn Kemmis Reserve for a reserve located at Franklyn Street in the locality of Glebe.

The position and extent for this feature is recorded and shown within the Geographical Names Register of New South Wales. This information can be accessed through the Board's website at www.gnb.nsw.gov.au

NARELLE UNDERWOOD
Chair
Geographical Names Board
PO Box 143
BATHURST NSW 2795

GEOGRAPHICAL NAMES ACT 1966

PURSUANT to the provisions of Section 10 of the *Geographical Names Act 1966*, the Geographical Names Board has this day assigned the name listed hereunder as a geographical name.

Willowdale Park for a reserve located on Jamboree Avenue, Denham Court in the Campbelltown LGA.

The position and extent for this feature is recorded and shown within the Geographical Names Register of New South Wales. This information can be accessed through the Board's website at www.gnb.nsw.gov.au

NARELLE UNDERWOOD
Chair
Geographical Names Board
PO Box 143
BATHURST NSW 2795

MOTOR RACING (SYDNEY AND NEWCASTLE) ACT 2008

Order approving person who may apply for an authorisation to conduct a Race
under the Motor Racing (Sydney and Newcastle) Act 2008

I, Adam Marshall, Minister for Tourism and Major Events, pursuant to section 13(1) of the *Motor Racing (Sydney and Newcastle) Act 2008* ("the Act") and having sought and obtained the advice of Destination NSW, do, by this Order approve V8 Supercars Australia Pty Ltd (ACN 077 053 484) as the person who may apply for an authorisation under section 15 of the Act.

The application must be made after 14 March 2017 for the Motor Racing Period for 2017.

The application must be made in a manner which is generally in accordance the Act.

Dated this seventh day of March 2017.

Adam Marshall MP
Minister for Tourism and Major Events

PARENTS AND CITIZENS ASSOCIATIONS INCORPORATION ACT 1976

Section 13 (4)

NOTICE OF INCORPORATION OF PARENTS AND CITIZENS ASSOCIATIONS

The following associations are hereby incorporated under the *Parents and Citizens Associations Incorporation Act 1976*.

1. Kyeemagh Infants School
2. Nangus Public School

Michael Waterhouse
General Counsel
Department of Education

15 March 2017

POISONS AND THERAPEUTIC GOODS REGULATION 2008

ORDER

Withdrawal of Drug Authority

In accordance with the provisions of clause 175(1) of the *Poisons and Therapeutic Goods Regulation 2008* an Order has been made on **Dr Shravan Kumar (DEN0001822822)**, of Wattle Grove NSW 2173, prohibiting him until further notice, as a dental practitioner, from supplying or having possession of drugs of addiction as authorised by clause 101 of the Regulation and issuing a prescription for a drug of addiction as authorised by clause 77 of the Regulation.

This Order is to take effect on and from 15 March 2017.

Dated at Sydney, 14 March 2017.

ELIZABETH KOFF
Secretary
NSW Health

POISONS AND THERAPEUTIC GOODS REGULATION 2008

ORDER

Withdrawal of Drug Authority

In accordance with the provisions of clause 175(1) of the *Poisons and Therapeutic Goods Regulation 2008* an Order has been made on **Dr Scott Byron CRAYTHORN (MED0001973189)**, of Warabrook NSW 2304, prohibiting him until further notice, as a medical practitioner, from supplying or having possession of drugs of addiction as authorised by clause 101 of the Regulation and issuing a prescription for a drug of addiction as authorised by clause 77 of the Regulation.

This Order is to take effect on and from 17 March 2017.

Dated at Sydney, 14 March 2017.

ELIZABETH KOFF
Secretary
NSW Health

POISONS AND THERAPEUTIC GOODS REGULATION 2008

ORDER

Withdrawal of Drug Authority

In accordance with the provisions of clause 175(1) of the *Poisons and Therapeutic Goods Regulation 2008* an Order has been made on **Dr John Bernard SIVEWRIGHT (MED0000970333)**, of Penshurst NSW 2222, prohibiting him until further notice, as a medical practitioner, from supplying or having possession of drugs of addiction as authorised by clause 101 of the Regulation and issuing a prescription for a drug of addiction as authorised by clause 77 of the Regulation.

This Order is to take effect on and from 17 March 2017.

Dated at Sydney, 14 March 2017.

ELIZABETH KOFF
Secretary
NSW Health

RETENTION OF TITLE

His Excellency the Governor has been pleased to approve of the retention of the title “The Honourable” by former Justice Patricia Anne Bergin, who served as a Judge of the Supreme Court of New South Wales from 1 March 1999 and as Chief Judge in Equity from 6 March 2009 until her retirement on 29 January 2017.

TRANSPORT ADMINISTRATION ACT 1988

LAND ACQUISITION (JUST TERMS COMPENSATION) ACT 1991

Notice of Compulsory Acquisition of Land in the Local Government Area of North Sydney

Transport for NSW by its delegate declares, with the approval of His Excellency the Governor, that the land described in Schedule 1 below, excepting the interests in land described in Schedule 2 below, is acquired by compulsory process under the provisions of the *Land Acquisition (Just Terms Compensation) Act 1991* as authorised by clause 11 of Schedule 1 of the *Transport Administration Act 1988* for the purposes of the *Transport Administration Act 1988*.

Tom Gellibrand
Deputy Program Director
Sydney Metro
Transport for NSW

SCHEDULE 1

All that piece of land situated in the Local Government Area of North Sydney, Parish of Willoughby and County of Cumberland, comprising Lot 4 in DP 1096359, being the whole of the land in Certificate of Title 4/1096359, said to be in the possession of Transport for NSW (registered proprietor) and Oznorth Pty Ltd ACN 130 032 638 (leaseholder).

SCHEDULE 2

D109336 Easement for Party Wall affecting the part of Lot 4 in DP1096359 0.045 wide designated (Y) in DP655677.

D109336 Easement for Party Wall appurtenant to Lot 4 in DP 1096359 affecting the land 0.185 wide designated (X) in DP655677.

(Transport for NSW Document Number: SM16/06205 A5873927)

TRANSPORT ADMINISTRATION ACT 1988

LAND ACQUISITION (JUST TERMS COMPENSATION) ACT 1991

Notice of Compulsory Acquisition of Land in the Local Government Area of North Sydney

Transport for NSW by its delegate declares, with the approval of His Excellency the Governor, that the land described in Schedule 1 below, excepting the interests in land described in Schedule 2 below, is acquired by compulsory process under the provisions of the *Land Acquisition (Just Terms Compensation) Act 1991* as authorised by clause 11 of Schedule 1 of the *Transport Administration Act 1988* for the purposes of the *Transport Administration Act 1988*.

Tom Gellibrand
Deputy Program Director
Sydney Metro
Transport for NSW

SCHEDULE 1

All that piece of land situated in the Local Government Area of North Sydney, Parish of Willoughby and County of Cumberland, comprising Lot 3 in DP 655677, being the whole of the land in Certificate of Title 3/655677, said to be in the possession of Transport for NSW (registered proprietor) and Zizz Furniture & Decor Pty Ltd ACN 159 450 487 (leaseholder).

SCHEDULE 2

D109336 Easement for Party Wall affecting the part of Lot 3 in DP655677 0.0185 wide designated (Y) in DP655677.

D109336 Easement for Party Wall appurtenant to Lot 3 in DP655677 affecting the land 0.045 wide designated (X) in DP655677.

(Transport for NSW Document Number: SM16/06205 **A5873926**)

COUNCIL NOTICES

ARMIDALE REGIONAL COUNCIL

ROADS ACT 1993

Naming of Roads

Notice is hereby given that Armidale Regional Council, pursuant to section 162 of the *Roads Act 1993*, has officially named the road(s) as shown hereunder:

Name	Locality
GREAVES CLOSE	-
Description	
In the approved Subdivision of 205 Taylor Street Armidale, being Lot 2 DP 1206479	

DONNA DOUGHAN, DCU Admin, Armidale Regional Council, PO Box 75A, ARMIDALE NSW 2350

GNB Ref: 0049

[9053]

BEGA VALLEY SHIRE COUNCIL

ROADS ACT 1993

Naming of Roads

Notice is hereby given that Bega Valley Shire Council, pursuant to section 162 of the *Roads Act 1993*, has officially named the road(s) as shown hereunder:

Name	Locality
SKYE LANE	Bega
Description	
Skye Lane is a right of carriageway located off Black Range Road in Bega	

Name	Locality
MANUKA LANE	Eden
Description	
Manuka Lane is a right of carriageway located off Tuna Way in Eden	

Name	Locality
CURYO LANE	Bega
Description	
Curyo Lane is a right of carriageway located off Valley Street in Bega	

Name	Locality
ERINNA LANE	Angledale
Description	
Erinna Lane is a right of carriageway located off Hergenahns Lane in Angledale	

Name	Locality
BLUE WREN PLACE	Bermagui
Description	
Blue Wren Place is Council public road located off Hay Street in Bermagui	

Name	Locality
EVERGREEN LANE	Nethercote
Description	
Evergreen Lane is located off Nethercote Road in Nethercote.	

LEANNE BARNES, General Manager, Bega Valley Shire Council, PO Box 492, BEGA NSW 2550

GNB Ref: 0045

[9054]

CENTRAL COAST COUNCIL
 LOCAL GOVERNMENT ACT 1993
 LAND ACQUISITION (JUST TERMS COMPENSATION) ACT 1991
 NOTICE OF COMPULSORY ACQUISITION OF LAND

Central Coast Council declares with the approval of His Excellency the Governor that the lands described in the Schedule below, excluding any mines or deposits of minerals in the lands, are acquired by compulsory process in accordance with the provisions of the *Land Acquisition (Just Terms Compensation) Act 1991* for public health and safety and environmental protection. Dated at Wyong this 20th day of February 2017.

ROB NOBLE, Chief Executive Officer, Central Coast Council, PO Box 20, Wyong NSW 2259

Schedule

Lot 63 DP13019
 Lot 64 DP13019

[9055]

GEORGES RIVER COUNCIL
 LOCAL GOVERNMENT ACT 1993
 LAND ACQUISITION (JUST TERMS COMPENSATION) ACT 1991
 NOTICE OF COMPULSORY ACQUISITION OF LAND

Georges River Council declares with the approval of His Excellency the Governor that the lands described in the schedule below, excluding only those mines or deposits of minerals in the land expressly reserved to the Crown, are acquired by compulsory process in accordance with the *Land Acquisition (Just Terms Compensation) Act 1991* for car park.

Dated at Hurstville 14th this day of March 2017

GAIL CONNOLLY
 General Manager

Schedule

Lot 17 DP4817
 Lot 18 DP4817

[9056]

GREATER HUME SHIRE COUNCIL
 ROADS ACT 1993
 Naming of Roads

Notice is hereby given that Greater Hume Shire Council, pursuant to section 162 of the *Roads Act 1993*, has officially named the road(s) as shown hereunder:

Name	Locality
HEATHCOTE LANE	Culcairn
Description	
Very small section is sealed approx. 30 meter, the rest of the road is unsealed and Runs west from intersections; Railway Parade, Back Henty Rd & Olympic Hwy for a distance of 850 meters.	
Name	Locality
YELLOW BOX LANE	Holbrook
Description	
Running north off Culcairn Holbrook Road for approximately 380 meters. This is the extent of Councils maintenance of this road.	

Name	Locality
THE ELMS LANE	Walla Walla
Description	
Part of existing road renamed and runs from Walla West Rd to Barbers Rd and Voss Rd intersection. Was created after a residence request to rename this section of road to this name as it is an old property name that has been in use for several generations.	

Name	Locality
CASSIA ROAD	Jindera
Description	
Sealed road that runs south off Hueske Rd to Coogera Circuit intersection.	

Name	Locality
COOGERA CIRCUIT	Jindera
Description	
Road is in stage two and will have several more stages before the full length has been constructed. At this stage the road is constructed from Gardenia Place through to just west of Ribery Court intersection.	

Name	Locality
RIBERY COURT	Jindera
Description	
Sealed road that runs off Coogera Circuit and is 250 meters in length.	

Name	Locality
GARDENIA PLACE	Jindera
Description	
Sealed road that runs off Coogera Circuit and is 450 meters in length.	

STEVEN PINNUCK, General Manager, Greater Hume Shire Council, PO Box 99, HOLBROOK NSW 2644
 GNB Ref: 0044 [9057]

INVERELL SHIRE COUNCIL

ROADS ACT 1993

Naming of Roads

Notice is hereby given that Inverell Shire Council, pursuant to section 162 of the *Roads Act 1993*, has officially named the road(s) as shown hereunder:

Name	Locality
TIMMS DRIVE	Gilgai
Description	
Road Reserve running north from Wetzlers Drive to Lot 228 DP 753271	

Name	Locality
WHITE BOX PLACE	Inverell
Description	
New road located within the subdivision of Lot 98 DP 1100511 approved under DA-142/2011.	

Name	Locality
DALEY CLOSE	Inverell
Description	
New road. located within the subdivision of Lot 19 DP 1071126 approved under DA-73/2006.	

Name	Locality
WINDOONA DRIVE	Inverell
Description	
New road located within the subdivision of Lot 19 DP 1071126 approved under DA-73/2006.	

Name	Locality
TALBRAGAR CLOSE	Inverell
Description	
New road located within the subdivision of Lot 19 DP 1071126 approved under DA-73/2006.	

PAUL HENRY, General Manager, Inverell Shire Council, 144 Otho Street, INVERELL NSW 2360
GNB Ref: 0046

[9058]

KEMPSEY SHIRE COUNCIL

ROADS ACT 1993

SECTION 10 – DEDICATION OF LAND AS PUBLIC ROAD

NOTICE is hereby given that the Kempsey Shire Council dedicates the land described in the Schedule below as public road under the provisions of Section 10 of the *Roads Act 1993*.

DAVID RAWLINGS, General Manager, Kempsey Shire Council, 22 Tozer Street, WEST KEMPSEY, NSW 2440

SCHEDULE

Lot 1 Deposited Plan 339540 being land between the eastern end of High Street and Hillary Street, South West Rocks.

Lot 2 Deposited Plan 1224433 being land situated at the intersection of Lukes Lane and Stuarts Point Road, Barraganyatti.

[9059]

LANE COVE, HUNTER’S HILL, CITY OF RYDE AND WILLOUGHBY COUNCILS

COASTAL PROTECTION ACT 1979

Section 55H

Gazettal and Commencement of a Coastal Zone Management Plan

The Councils of Lane Cove, Hunter’s Hill, City of Ryde and Willoughby, with the certification of the Minister for Planning, have prepared and adopted the Lane Cove River Coastal Zone Management Plan in accordance with section 55 of the *Coastal Protection Act 1979*.

The Lane Cove River Coastal Zone Management Plan will help guide the future management of the Lane Cove River estuary. The Plan contains a series of management aims and objectives and associated actions to help protect and enhance the estuary, its foreshores and catchment and promote public access to the waterways.

The Plan will remain in force until such time as it is amended or repealed by a coastal management program that replaces it.

The Plan may be viewed on each member Council’s web site. A hard copy may be viewed at each Council’s main office.

CRAIG WRIGHTSON, General Manager, Lane Cove Municipal Council, PO Box 20, Lane Cove NSW 1595

BARRY SMITH, General Manager, Hunter’s Hill Council, PO Box 21, Hunters Hill NSW 2110

ROY NEWSOME, Acting General Manager, City of Ryde, Locked Bag 2069, North Ryde NSW 1670

DEBRA JUST, General Manager, Willoughby City Council, PO Box 57, Chatswood NSW 2057

[9060]

SUTHERLAND SHIRE COUNCIL

DEDICATION OF PUBLIC RESERVE

Notification is hereby given that the Council of Sutherland Shire pursuant to a resolution passed at its meeting on 20 February 2017 (SER011-17) has resolved to dedicate land described as Lot 102 Deposited Plan 1028645, Lucas Heights, Parish of Holsworthy, County of Cumberland situated at 150 Old Illawarra Road, Barden Ridge to the public as public reserve.

S Phillips, General Manager, Locked Bag 17, Sutherland NSW 1499. Dated 10 March 2017.

[9061]

THE HILLS SHIRE COUNCIL

ROADS ACT 1993

Naming of Roads

Notice is hereby given that The Hills Shire Council, pursuant to section 162 of the *Roads Act 1993*, has officially named the road(s) as shown hereunder:

Name	Locality
HALLETT COURT	Kellyville
Description	
New road recently registered under DP 1211511 requires the road name Type to be changed from "Street" to "Court" as it is now a cul-de-sac & not a through road.	

DAVE WALKER, General Manager, The Hills Shire Council, 3 Columbia Court, BAULKHAM HILLS NSW 2153
GNB Ref: 0047 [9062]

THE HILLS SHIRE COUNCIL

ROADS ACT 1993

Naming of Roads

Notice is hereby given that The Hills Shire Council, pursuant to section 162 of the *Roads Act 1993*, has officially named the road(s) as shown hereunder:

Name	Locality
OUTBACK STREET	Box Hill
Description	
Off The Water Lane, ending at the intersection with Annangrove Road.	

Name	Locality
TRIUMPH WAY	Box Hill
Description	
Off Longmeadow Parkway, ending at the intersection with Annangrove Road.	

Name	Locality
LIMESTONE ROAD	Box Hill
Description	
Off Annangrove Road, ending at the intersection with Hynds Road.	

Name	Locality
DECK WAY	Box Hill
Description	
Off Outback Street	

Name	Locality
LONGMEADOW PARKWAY	Box Hill
Description	
Off Edwards Road, ending at the intersection with Timbercrest Street.	

Name	Locality
SEED STREET	Box Hill
Description	
Off Outback Street	

Name	Locality
BULB WAY	Box Hill
Description	
Off Outback Street	

Name	Locality
DRIFTWOOD STREET	Box Hill
Description	
Off Grandhill Parkway, ending at the intersection with Nelson Road.	

Name	Locality
DRESSAGE STREET	Box Hill
Description	
Off George Street, ending at the intersection with Clydesdale Street.	

Name	Locality
DRAFT STREET	Box Hill
Description	
Off Mt Carmel Drive, ending at the intersection with Shetland Street	

Name	Locality
DORADO STREET	Box Hill
Description	
Off Gemini Street, ending at the intersection with Ceres Way.	

Name	Locality
DONCASTER STREET	Box Hill
Description	
Off Camarero Street, ending at the intersection with Flemington Parkway.	

Name	Locality
DELMAR STREET	Box Hill
Description	
Off Saratoga Street, ending at the intersection with Turffontein Avenue.	

Name	Locality
DAPPLES WAY	Box Hill
Description	
Off Levade Way, ending at the intersection with Newmarket Parkway.	

Name	Locality
CUPERTINO STREET	Box Hill
Description	
Off Terry Road, ending at the intersection with Mt Carmel Drive.	

Name	Locality
CUESTA WAY	Box Hill
Description	
Off Rangeview Street, ending at the intersection with Treehaven Street.	

Name	Locality
CRUX STREET	Box Hill
Description	
Off Corvus Way, ending at the intersection with Constellation Avenue.	

Name	Locality
CROSSIRON STREET	Box Hill
Description	
Off Terry Road, ending at the intersection with Mt Carmel Drive.	

Name	Locality
CROP STREET	Box Hill
Description	
Off Yearling Street, ending at the intersection with Shetland Street.	

Name	Locality
COURSEBROOK STREET	Box Hill
Description	
Off Grandhill Parkway, ending at the intersection with Fiscal Street.	

Name	Locality
COSMOS WAY	Box Hill
Description	
Off Mason Road, ending at the intersection with Hynds Road.	

Name	Locality
CORVUS WAY	Box Hill
Description	
Off George Street, ending at the intersection with Solstice Street.	

Name	Locality
CORONA STREET	Box Hill
Description	
Off George Street, ending at the intersection with Solstice Street.	

Name	Locality
COPENHAGEN STREET	Box Hill
Description	
Off McCall Parkway, ending at the intersection with Maunder Street.	

Name	Locality
CONSTELLATION AVENUE	Box Hill
Description	
Off George Street, ending at the intersection with Capricorn Parkway.	

Name	Locality
CLYDESDALE STREET	Box Hill
Description	
Off Terry Road, ending at the intersection with Brindle Parkway.	

Name	Locality
CINCH STREET	Box Hill
Description	
Off Mustang Avenue, ending at the intersection with Cart Street.	

Name	Locality
CHUKKER STREET	Box Hill
Description	
Off Camarero Street, ending at the intersection with Flemington Parkway.	

Name	Locality
CERES WAY	Box Hill
Description	
Off Equinox Drive, ending at the intersection with Europa Street.	

Name	Locality
CENTAURUS WAY	Box Hill
Description	
Off Mason Road, ending at the intersection with Ceres Way.	

Name	Locality
CELESTIAL STREET	Box Hill
Description	
Off Libra Drive, ending at the intersection with Canopus Parkway.	

Council Notices

Name	Locality
CAULFIELD PARKWAY	Box Hill
Description	
Off Flemington Parkway, (at present) ending at the intersection with Camarero Street (Dec 2016).	

Name	Locality
CART STREET	Box Hill
Description	
Off Mustang Avenue, ending at the intersection with Terry Road.	

Name	Locality
CARBINE STREET	Box Hill
Description	
Off Mustang Avenue, ending at the intersection with Rangy Street	

Name	Locality
CAPRICORN PARKWAY	Box Hill
Description	
Off Mason Road.	

Name	Locality
CANOPUS PARKWAY	Box Hill
Description	
Off Terry Road, ending at the intersection with Equinox Drive.	

Name	Locality
CANOLA STREET	Box Hill
Description	
Off Box Road, ending at the intersection with Grandhill Parkway and Fiscal Street.	

Name	Locality
CAMARERO STREET	Box Hill
Description	
Off George Street, ending at the intersection with Letoken Way.	

Name	Locality
BYERLEY STREET	Box Hill
Description	
Off Terry Road.	

Name	Locality
BROOKHAVEN STREET	Box Hill
Description	
Off Limestone Road, ending at the intersection with Pleasance Street.	

Name	Locality
BROCKLEBANK STREET	Box Hill
Description	
Off Boundary Road, ending at the intersection with Pridham Avenue.	

Name	Locality
BRINDLE PARKWAY	Box Hill
Description	
Off George Street, ending at the intersection with Cart Street.	

Name	Locality
BRAHMAN STREET	Box Hill
Description	
Off Wadham Street, ending at the intersection with Pridham Avenue.	

Council Notices

Name	Locality
BOSAL STREET	Box Hill
Description	
Off Mustang Avenue, ending at the intersection with Cart Street.	

Name	Locality
BOREALIS WAY	Box Hill
Description	
Off Constellation Avenue, ending at the intersection with Gemini Street.	

Name	Locality
BLUEVIEW WAY	Box Hill
Description	
Off Village View, ending at the intersection with Rangeview Street.	

Name	Locality
BLUEGATE STREET	Box Hill
Description	
Off Saratoga Street, ending at the intersection with Mt Carmel Drive.	

Name	Locality
BLOOMFIELD STREET	Box Hill
Description	
Off Greybox Street, ending at the intersection with future Nelson Road.	

Name	Locality
BLAZER STREET	Box Hill
Description	
Off Bluegate Street, ending at the intersection with Turffontein Avenue.	

Name	Locality
BIRIBI STREET	Box Hill
Description	
Off George Street, ending at the intersection with Byerley Street.	

Name	Locality
BILLETS WAY	Box Hill
Description	
Off George Street, ending at the intersection with Rangy Street.	

Name	Locality
BALUSTER STREET	Box Hill
Description	
Off Palazzo View	

Name	Locality
AVIOR STREET	Box Hill
Description	
Off Constellation Avenue, ending at the intersection with Europa Street.	

Name	Locality
AURORA STREET	Box Hill
Description	
Off The Water Lane, ending at the intersection with Cosmos Way.	

Name	Locality
ASTEROID AVENUE	Box Hill
Description	
Off Capricorn Parkway	

Council Notices

Name	Locality
ASPIRE STREET	Box Hill
Description	
Off Crossiron Street, ending at the intersection with Cupertino Street.	

Name	Locality
ARIES WAY	Box Hill
Description	
Off Sagitta Street, ending at the intersection with Ursa Street	

Name	Locality
AQUILA STREET	Box Hill
Description	
Off Mason Road, ending at the intersection with Hynds Road.	

Name	Locality
AQUARIUS WAY	Box Hill
Description	
Off Constellation Avenue, ending at the intersection with Gemini Street.	

Name	Locality
ANTLIA STREET	Box Hill
Description	
Off Constellation Avenue, ending at the intersection with Gemini Street	

Name	Locality
ANDROMEDA PARKWAY	Box Hill
Description	
Off Terry Road	

Name	Locality
ALTAIR STREET	Box Hill
Description	
Off Mason Road, ending at the intersection with Hynds Road	

Name	Locality
AIRD STREET	Box Hill
Description	
Off Hannaford Avenue, ending at intersection with Ruse Street.	

Name	Locality
KEENELAND STREET	Box Hill
Description	
Off Terry Road, ending at the intersection with George Street	

Name	Locality
JUMPER STREET	Box Hill
Description	
Off Mustang Avenue, ending at the intersection with Cart Street.	

Name	Locality
INFINITY CRESCENT	Box Hill
Description	
Off Crossiron Street.	

Name	Locality
INDUS STREET	Box Hill
Description	
Off Porrima Street, ending at the intersection with Milky Crescent.	

Name	Locality
IDA STREET	Box Hill
Description	
Off Hynds Road	

Name	Locality
HYDRA STREET	Box Hill
Description	
Off Aquarius Way, ending at the intersection with Epsilon Street.	

Name	Locality
HYBRID STREET	Box Hill
Description	
Off Terrain Street	

Name	Locality
HURRELL STREET	Box Hill
Description	
Off Greenaway Drive	

Name	Locality
HORDENS WAY	Box Hill
Description	
Off Gardiner Drive	

Name	Locality
HOLLINDALE STREET	Box Hill
Description	
Off George Street	

Name	Locality
HINNY STREET	Box Hill
Description	
Off George Street	

Name	Locality
HEDGEWOOD DRIVE	Box Hill
Description	
Off Terry Road,	

Name	Locality
HANNAFORD AVENUE	Box Hill
Description	
Off Pridham Avenue, ending at the intersection with Brahman Street.	

Name	Locality
GYNSEY WAY	Box Hill
Description	
Off McCall Parkway, ending at the intersection with Copenhagen Street.	

Name	Locality
HADLEYWOOD STREET	Box Hill
Description	
Off Fiscal Street, ending at the intersection with Mangrove Way.	

Name	Locality
GREYBOX STREET	Box Hill
Description	
Off The Water Lane, ending at the intersection with Limestone Road.	

Council Notices

Name	Locality
GREENRIDGE STREET	Box Hill
Description	
Off The Water Lane, ending at the intersection with Limestone Road.	

Name	Locality
GRAZING WAY	Box Hill
Description	
Off Rangeview Street, ending at the intersection with Village View.	

Name	Locality
GRANDHILL PARKWAY	Box Hill
Description	
Off Annangrove Road, ending at the intersection with The Water Lane	

Name	Locality
GLOAMING STREET	Box Hill
Description	
Off Levade Avenue, ending at the intersection with Hedgewood Drive.	

Name	Locality
GIMCRACK STREET	Box Hill
Description	
Off Hedgewood Drive, ending at the intersection with Salinger Street.	

Name	Locality
GILGAI STREET	Box Hill
Description	
Off Levade Avenue, ending at the intersection with Newmarket Parkway.	

Name	Locality
GEMINI STREET	Box Hill
Description	
Off Constellation Avenue, ending at the intersection Centaurus Way.	

Name	Locality
GELT STREET	Box Hill
Description	
Off Pridham Ave	

Name	Locality
GARDINER DRIVE	Box Hill
Description	
Off Terry Road, ending at the intersection with Maunder Street.	

Name	Locality
GARDENGATE STREET	Box Hill
Description	
Off Fiscal Street, ending at the intersection with Mangrove Way.	

Name	Locality
GALILEO STREET	Box Hill
Description	
Off Constellation Avenue, ending at the intersection with Capricorn Parkway.	

Name	Locality
FUTURITY STREET	Box Hill
Description	
Off Mt Carmel Drive, ending at the intersection with Blazer Street.	

Council Notices

Name	Locality
FORNAX STREET	Box Hill
Description	
Off Constellation Avenue, ending at the intersection with Capricorn Parkway.	

Name	Locality
FLOWER STREET	Box Hill
Description	
Off Terrain Street, ending at the intersection with	

Name	Locality
FLEMINGTON PARKWAY	Box Hill
Description	
Off Camarero Street, ending at the intersection with Pimlico Street.	

Name	Locality
FISCAL STREET	Box Hill
Description	
Off Annangrove Road, ending at the intersection with Grandhill Parkway.	

Name	Locality
FIELDSTONE STREET	Box Hill
Description	
Off Terrain Street, ending at the intersection with road currently named Nelson Road (Dec 2016).	

Name	Locality
FELLING STREET	Box Hill
Description	
Off Longerong Avenue, ending at the intersection with Woodgate Parkway.	

Name	Locality
FARMINGTON STREET	Box Hill
Description	
Off Limestone Road, ending at the intersection with Pleasance Street.	

Name	Locality
FACADE STREET	Box Hill
Description	
Off Driftwood Street	

Name	Locality
EQUINOX DRIVE	Box Hill
Description	
Off George Street, ending at the intersection with Libra Drive.	

Name	Locality
EPSILON STREET	Box Hill
Description	
Off Gemini Street, ending at the intersection with Andromeda Parkway	

Name	Locality
ELEMENT LANE	Box Hill
Description	
Off Alan Street	

Name	Locality
EDENBROOK STREET	Box Hill
Description	
Off the Water Lane	

Name	Locality
LUSH LANE	Box Hill
Description	
Off Village View, ending at the intersection with Alan Street.	

Name	Locality
LUMINOUS WAY	Box Hill
Description	
Off Constellation Avenue, ending at the intersection with Europa Street	

Name	Locality
LUDGATE STREET	Box Hill
Description	
Off Copenhagen Street, ending at the intersection with Stocker Way.	

Name	Locality
LOPE STREET	Box Hill
Description	
Off Mustang Avenue, ending at the intersection with Cart Street.	

Name	Locality
LONGERENONG AVENUE	Box Hill
Description	
Off Hereford Street, ending at the intersection with Thorpe Way.	

Name	Locality
LONGCHAMP STREET	Box Hill
Description	
Off Terry Road, ending at the intersection with Keeneland Street	

Name	Locality
LITTORAL WAY	Box Hill
Description	
Off Rangeview Street, ending at the intersection with Treehaven Street.	

Name	Locality
LIMERICK STREET	Box Hill
Description	
Off George Street, ending at the intersection with Chukker Street	

Name	Locality
LIMAX STREET	Box Hill
Description	
Off Equinox Drive, ending at the intersection with Celestial Street.	

Name	Locality
LIBRA DRIVE	Box Hill
Description	
Off Terry Road, ending at the intersection with Centaurus Way.	

Name	Locality
LEVADE AVENUE	Box Hill
Description	
Off Terry Road, ending at the intersection with Mt Carmel Drive.	

Name	Locality
LETOKEN WAY	Box Hill
Description	
Off Manso Crescent, ending at the crossroad intersection with Camarero Street.	

Council Notices

Name	Locality
LEO STREET	Box Hill
Description	
Off Mason Road, ending at the intersection with Europa Parkway.	

Name	Locality
LAKEHAVEN STREET	Box Hill
Description	
Off Fiscal Street, ending at the intersection with Plateau Avenue.	

Name	Locality
KUIPER STREET	Box Hill
Description	
Off Constellation Avenue, ending at the intersection with Capricorn Parkway.	

Name	Locality
KRANJI STREET	Box Hill
Description	
Off Doncaster Street, ending at the crossroad intersection with Mareeba Street.	

Name	Locality
KEWNEY STREET	Box Hill
Description	
Off Turffontein Avenue, ending at the intersection with Bluegate Street.	

Name	Locality
KEMPTON ROAD	Box Hill
Description	
Off George Street	

Name	Locality
MUSTANG AVENUE	Box Hill
Description	
Off George Street, ending at the intersection with Terry Road and Levade Avenue	

Name	Locality
MUSCA STREET	Box Hill
Description	
Off Porrima Street, ending at the intersection with Milky Crescent.	

Name	Locality
MOUNT CARMEL DRIVE	Box Hill
Description	
Off Windsor Road.	

Name	Locality
MORNINGSIDE STREET	Box Hill
Description	
Off The Water Lane, ending at the intersection with Paddock View.	

Name	Locality
MONTECORE STREET	Box Hill
Description	
Off Manso Crescent.	

Name	Locality
MONMOUTH DRIVE	Box Hill
Description	
Off George Street, ending at the intersection with Terry Road.	

Name	Locality
MIRAGE STREET	Box Hill
Description	
Off The Water Lane, ending at the intersection with Rainforest Street.	

Name	Locality
MILKY CRESCENT	Box Hill
Description	
End extents Off Porrima Street.	

Name	Locality
MIDFIELD LANE	Box Hill
Description	
Off Oakbrook Parkway, ending at the intersection with Canola Street.	

Name	Locality
MEZZOMO STREET	Box Hill
Description	
Off Hurrell Street, ending at the intersection with Ludgate Street.	

Name	Locality
MEYDAN STREET	Box Hill
Description	
Off Levade Avenue, ending at the intersection with Newmarket Parkway	

Name	Locality
MEMSIE STREET	Box Hill
Description	
Off Levade Avenue, ending at the intersection with Hedgewood Drive.	

Name	Locality
MCCALL PARKWAY	Box Hill
Description	
Off Terry Road	

Name	Locality
MAUNDER STREET	Box Hill
Description	
Off Copenhagen Street and intersecting beyond Stocker Way.	

Name	Locality
MAREEBA STREET	Box Hill
Description	
Off Manso Crescent, ending at the crossroad intersection with Kranji Street.	

Name	Locality
MARE STREET	Box Hill
Description	
Off Turffontein Avenue, ending at the intersection with Futurity.	

Name	Locality
MANSO CRESCENT	Box Hill
Description	
Off Hereford Street,	

Name	Locality
MANION STREET	Box Hill
Description	
Off Brindle Parkway, ending at the intersection with Carbine Street.	

Name	Locality
MANGROVE WAY	Box Hill
Description	
Off Plateau Avenue, ending at the intersection with Terrain Street	

Name	Locality
MANEGE STREET	Box Hill
Description	
Off Mustang Avenue, ending at the intersection with Brindle Parkway	

Name	Locality
RAINFOREST STREET	Box Hill
Description	
Off Plateau Avenue, ending at the crossroads intersection	

Name	Locality
QUARTER STREET	Box Hill
Description	
Off Mustang Avenue, ending at the intersection with George Street.	

Name	Locality
PROSPER STREET	Box Hill
Description	
Off Mt Carmel Drive, ending at the intersection with Sunway Place.	

Name	Locality
PRIDHAM AVENUE	Box Hill
Description	
Off Boundary Road, ending at the intersection with Longerong Avenue.	

Name	Locality
PORRIMA STREET	Box Hill
Description	
Off Hynds Road, ending at the intersection with Capricorn Parkway.	

Name	Locality
PONY STREET	Box Hill
Description	
Off Turffontein Avenue, ending at the intersection with Futurity Street	

Name	Locality
PLEASANCE STREET	Box Hill
Description	
Off Longmeadow Parkway, ending at the intersection with Limestone Road.	

Name	Locality
PLATEAU AVENUE	Box Hill
Description	
Off The Water Lane, ending at the intersection with Box Road.	

Name	Locality
PINTO STREET	Box Hill
Description	
Off Hedgewood Drive, ending at the intersection with Salinger Street.	

Name	Locality
PICTOR STREET	Box Hill
Description	
Off Hynds Road, ending at the intersection with Rubidea Street.	

Council Notices

Name	Locality
PIAFFE STREET	Box Hill
Description	
Off Mustang Avenue, ending at the intersection with Brindle Parkway.	

Name	Locality
PALAZZO VIEW	Box Hill
Description	
Off Hynds Road	

Name	Locality
OASIS WAY	Box Hill
Description	
Off Grandhill Parkway, ending at the intersection with Scenery Street.	

Name	Locality
OAKLAWN STREET	Box Hill
Description	
Off Turffontein Avenue, ending at the intersection with Bluegate Street.	

Name	Locality
OAKBROOK PARKWAY	Box Hill
Description	
Off Fiscal Street,	

Name	Locality
NOVA STREET	Box Hill
Description	
Off Hynds Road	

Name	Locality
NIX STREET	Box Hill
Description	
Off Terry Road, ending at the intersection with Celestial Street.	

Name	Locality
NIVISON STREET	Box Hill
Description	
Off George Street, ending at the intersection with Monmouth Drive.	

Name	Locality
NEWMARKET PARKWAY	Box Hill
Description	
Off Terry Road, ending at the intersection with Mt Carmel Drive.	

Name	Locality
SKINNER STREET	Box Hill
Description	
Off Hurrell Street, ending at the intersection with McCall Parkway.	

Name	Locality
SKARRATT STREET	Box Hill
Description	
Off Gardiner Drive	

Name	Locality
SINGER STREET	Box Hill
Description	
Extent to be updated – awaiting on Council.	

Council Notices

Name	Locality
SHETLAND STREET	Box Hill
Description	
Off Levade Avenue, ending at the intersection with Hedgewood Drive.	

Name	Locality
SHAND STREET	Box Hill
Description	
Off Hurrell Street	

Name	Locality
SETTLEMENT DRIVE	Box Hill
Description	
Off Terry Road	

Name	Locality
SCULPTOR STREET	Box Hill
Description	
Off Terry Road, ending at the intersection with Virgo Street.	

Name	Locality
SCENERY STREET	Box Hill
Description	
Off The Water Lane, ending at the intersection with Fiscal Street.	

Name	Locality
SARATOGA STREET	Box Hill
Description	
Off George Street, ending at the intersection with Turffontein Avenue.	

Name	Locality
SALINGER STREET	Box Hill
Description	
Off Yearling Street, ending at the intersection with Gloaming Street.	

Name	Locality
SAGITTA STREET	Box Hill
Description	
Off Hynds Road, ending at the intersection with Capricorn Parkway.	

Name	Locality
RUBIDEA STREET	Box Hill
Description	
Off Terry Road, ending at the intersection with Cosmos Way.	

Name	Locality
ROTUNDA WAY	Box Hill
Description	
Off Village View	

Name	Locality
ROSEWORTHY STREET	Box Hill
Description	
Off Brocklebank Street, ending at the intersection with Longerong Avenue.	

Name	Locality
ROSARIO STREET	Box Hill
Description	
Off George Street	

Council Notices

Name	Locality
RIDGEHILL STREET	Box Hill
Description	
Off Driftwood Street, ending at the intersection with Fiscal Street.	

Name	Locality
RAVINE STREET	Box Hill
Description	
Off Driftwood Street, ending at the intersection with Fiscal Street.	

Name	Locality
RANGEVIEW STREET	Box Hill
Description	
Off Village View, ending at the intersection with Alan Street.	

Name	Locality
RANGY STREET	Box Hill
Description	
Off George Street, ending at the intersection with Brindle Parkway.	

Name	Locality
TINLINE STREET	Box Hill
Description	
Off Pridham Avenue, ending at the intersection with Hannaford Avenue.	

Name	Locality
TINARANA STREET	Box Hill
Description	
Off Saratoga Street, ending at the intersection with Sweetenham Avenue.	

Name	Locality
TIMBERCREST STREET	Box Hill
Description	
Off Outback Street, ending at the intersection with Greenridge Street.	

Name	Locality
TIDAL WAY	Box Hill
Description	
Off Box Road, ending at the intersection with Grandhill Parkway.	

Name	Locality
THORPE WAY	Box Hill
Description	
Off Longerenong Ave	

Name	Locality
TERRAIN STREET	Box Hill
Description	
Off The Water Lane, ending at the intersection with Driftwood Street.	

Name	Locality
TAURUS WAY	Box Hill
Description	
Off Ursa Street, need to review as description does not match road plan; no road recorded	

Name	Locality
TACK STREET	Box Hill
Description	
Off Futurity Street, ending at the intersection with Turffontein Avenue	

Council Notices

Name	Locality
SWEETENHAM AVENUE	Box Hill
Description	
Off George Street, ending at the intersection with Bluegate Street.	

Name	Locality
SUNWAY PLACE	Box Hill
Description	
Off Prosper Street.	

Name	Locality
SUNNYHILL PARKWAY	Box Hill
Description	
Off Terry Road, ending at the intersection with Keeneland Street.	

Name	Locality
SUNNYBANK STREET	Box Hill
Description	
Off Village View, ending at the intersection with Alan Street.	

Name	Locality
SUNLINE LANE	Box Hill
Description	
Off Brookline Crescent	

Name	Locality
SUMMER WAY	Box Hill
Description	
Off Pleasance Street	

Name	Locality
STREAMDALE STREET	Box Hill
Description	
Off Limestone Road, ending at the intersection with Pleasance Street.	

Name	Locality
STOCKER WAY	Box Hill
Description	
Off Singer Street, ending at the intersection with Maunder Street.	

Name	Locality
STELLAR STREET	Box Hill
Description	
Off Centaurus Way, ending at the intersection with	

Name	Locality
STEEPLECHASE STREET	Box Hill
Description	
Off George Street, ending at the intersection with Bluegate Street.	

Name	Locality
SPRINGBANK STREET	Box Hill
Description	
Off Saratoga Street, ending at the intersection with Steeplechase Street.	

Name	Locality
SOLSTICE STREET	Box Hill
Description	
Off Terry Road, ending at the intersection with Fornax Street.	

Council Notices

Name	Locality
YEARLING STREET	Box Hill
Description	
Off Levade Avenue, ending at the intersection with Hedgewood Drive.	

Name	Locality
WOODGATE PARKWAY	Box Hill
Description	
Off Wadham Street, ending at the intersection with Brocklebank Street.	

Name	Locality
WHIPPER STREET	Box Hill
Description	
Off Levade Avenue, ending at the intersection with Hedgewood Drive.	

Name	Locality
WESTBURY STREET	Box Hill
Description	
Off George Street, ending at the intersection with Trentham Street.	

Name	Locality
WATERFLOW STREET	Box Hill
Description	
Off Bloomfield Street, ending at the intersection with Limestone Road.	

Name	Locality
WADHAM STREET	Box Hill
Description	
Off Longererong Avenue, ending at the intersection with Hannaford Avenue.	

Name	Locality
VOLANS WAY	Box Hill
Description	
Off Mason Road, ending at the intersection with Tucana Street. Please review, description does not match current revised map supplied by Council.	

Name	Locality
VIRGO STREET	Box Hill
Description	
Off Mason Road, ending at the intersection with Tucana Street. Please review, description does not match revised map.	

Name	Locality
VILLAGE VIEW	Box Hill
Description	
Off Terry Road, ending at the intersection with Rangeview Street.	

Name	Locality
VELA STREET	Box Hill
Description	
Off Hynds Road	

Name	Locality
UTAMA STREET	Box Hill
Description	
Off Cupertino Street, ending at the intersection with Infinity Crescent.	

Name	Locality
URSA STREET	Box Hill
Description	
Off Hynds Road, ending at the intersection with Capricorn Parkway.	

Council Notices

Name	Locality
URBAN WAY	Box Hill
Description	
Off Mt Carmel Drive	

Name	Locality
TURFFONTEIN AVENUE	Box Hill
Description	
Off Mt Carmel Drive, ending at the intersection with Bluegate Street.	

Name	Locality
TUCANA STREET	Box Hill
Description	
Off Sculptor Street, ending at the intersection with Ursa Street.	

Name	Locality
TRENTHAM STREET	Box Hill
Description	
Off Steeplechase Street, ending at the intersection with Sweetenham Avenue.	

Name	Locality
TREELINE STREET	Box Hill
Description	
Off Tidal Way	

Name	Locality
TREEHAVEN STREET	Box Hill
Description	
Off Village View, ending at the intersection with Alan Street.	

Name	Locality
TIPPERARY STREET	Box Hill
Description	
Off Steeplechase Street, ending at the intersection with Sweetenham Avenue.	

Name	Locality
ZETA STREET	Box Hill
Description	
Off Hynds Road, ending at the intersection with Capricorn Parkway	

Name	Locality
ZEBU STREET	Box Hill
Description	
Off Manso Crescent, * end extent not defined, please review.	

Name	Locality
ZANIAH STREET	Box Hill
Description	
Off Hynds Road, ending at the intersection with Aurora Street.	

DAVE WALKER, General Manager, The Hills Shire Council, 3 Columbia Court, BAULKHAM HILLS NSW 2153
GNB Ref: 0048 [9063]

By Authority