

Government Gazette

of the State of

New South Wales

Number 14

Friday, 9 February 2018

The New South Wales Government Gazette is the permanent public record of official notices issued by the New South Wales Government. It also contains local council and other notices and private advertisements.

The Gazette is compiled by the Parliamentary Counsel's Office and published on the NSW legislation website (www.legislation.nsw.gov.au) under the authority of the NSW Government. The website contains a permanent archive of past Gazettes.

To submit a notice for gazettal – see Gazette Information.

GOVERNMENT NOTICES

Mining and Petroleum Notices

NOTICE is given that the following applications have been received:

EXPLORATION LICENCE APPLICATIONS

(T18-1021)

No. 5640, UNITED STONE INDUSTRIES PTY LTD (ACN 605293230), area of 2 units, for Group 2, dated 25 January, 2018. (Orange Mining Division).

(T18-1022)

No. 5641, UNITED STONE INDUSTRIES PTY LTD (ACN 605293230), area of 4 units, for Group 2, dated 29 January, 2018. (Orange Mining Division).

(T18-1023)

No. 5642, FMG RESOURCES PTY LTD, area of 4 units, for Group 1, dated 31 January, 2018. (Orange Mining Division).

The Honourable Don Harwin MLC
Minister for Resources

[n2018-372]

NOTICE is given that the following application has been granted:

EXPLORATION LICENCE APPLICATION

(T16-1508)

No. 5353, now Exploration Licence No. 8687, ULAN COAL MINES LTD (ACN 000 189 248), County of Bligh, Map Sheet (8833), area of 1994 hectares, for Group 9, dated 31 January, 2018, for a term until 31 January, 2024.

The Honourable Don Harwin MLC
Minister for Resources

[n2018-373]

NOTICE is given that the following applications have been withdrawn:

EXPLORATION LICENCE APPLICATION

(T16-1014)

No. 5258, ANDBAC PTY LTD (ACN 160758056), County of Farnell, Map Sheet (7135). Withdrawal took effect on 29 November, 2017.

MINING LEASE APPLICATION

(T01-0162)

Sydney No. 180, CSR LIMITED (ACN 000 001 276), Parish of Castlereagh, County of Cumberland, (9030-4-S). Withdrawal took effect on 1 February, 2018.

The Honourable Don Harwin MLC
Minister for Resources

[n2018-374]

NOTICE is given that the following applications for renewal have been received:

(V18-0435)

Exploration Licence No. 7896, CARPENTARIA RESOURCES LIMITED (ACN 095117981), area of 25 units. Application for renewal received 4 February, 2018.

(V18-0426)

Petroleum Exploration Licence No. 456, HUNTER GAS PTY LTD (ACN 113 972 473) AND SANTOS QNT PTY.LTD. (ACN 083 077 196), area of 69 blocks. Application for renewal received 2 February, 2018.

(T17-1217)

Exploration Licence No. 8325, TARAGO EXPLORATION PTY LTD (ACN 115 529 112), area of 64 units. Application for renewal received 29 November, 2017.

The Honourable Don Harwin MLC
Minister for Resources

[n2018-375]

RENEWAL OF CERTAIN AUTHORITIES

Notice is given that the following authorities have been renewed:

(V17-1101)

Exploration Licence No. 6012, BIG ISLAND MINING PTY LTD (ACN 112 787 470), County of Harden, Map Sheet (8528), area of 4 units, for a further term until 22 October, 2020. Renewal effective on and from 2 February, 2018.

(V17-1097)

Exploration Licence No. 6648, SPECIALITY METALS INTERNATIONAL LIMITED (ACN 115009106), County of Darling, Map Sheet (9036, 9037), area of 9 units, for a further term until 19 October, 2020. Renewal effective on and from 2 February, 2018.

(V17-1117)

Exploration Licence No. 6656, MINCOR COPPER PTY LTD (ACN 120 024 777), County of Kennedy, Map Sheet (8333), area of 10 units, for a further term until 27 October, 2020. Renewal effective on and from 2 February, 2018.

(T17-1214)

Exploration Licence No. 7424, MODELING RESOURCES PTY LTD (ACN 169 211 876), Counties of Ashburnham and Kennedy, Map Sheet (8531, 8532), area of 22 units, for a further term until 30 November, 2020. Renewal effective on and from 2 February, 2018.

(V17-1195)

Exploration Licence No. 8323, ARDEA EXPLORATION PTY LTD (ACN 137 889 279), Counties of Bathurst and Wellington, Map Sheet (8731), area of 60 units, for a further term until 27 November, 2022. Renewal effective on and from 2 February, 2018.

(V17-1156)

Exploration Licence No. 8329, SANDFIRE RESOURCES NL (ACN 105154185), Counties of Bland and Gipps, Map Sheet (8430), area of 26 units, for a further term until 4 December, 2023. Renewal effective on and from 2 February, 2018.

(V17-1214)

Exploration Licence No. 8330, GOLD AND COPPER RESOURCES PTY LIMITED (ACN 124 534 863), County of Bathurst, Map Sheet (8731), area of 3 units, for a further term until 5 December, 2023. Renewal effective on and from 2 February, 2018.

(V17-1215)

Exploration Licence No. 8331, GOLD AND COPPER RESOURCES PTY LIMITED (ACN 124 534 863), Counties of Ashburnham and Wellington, Map Sheet (8631), area of 6 units, for a further term until 5 December, 2023. Renewal effective on and from 2 February, 2018.

(V17-1215)

Exploration Licence No. 8332, GOLD AND COPPER RESOURCES PTY LIMITED (ACN 124 534 863), Counties of Bathurst and Wellington, Map Sheet (8731), area of 17 units, for a further term until 5 December, 2023. Renewal effective on and from 2 February, 2018.

(V17-1209)

Exploration Licence No. 8333, SILVER CITY MINERALS LIMITED (ACN 130 933 309), County of Yancowinna, Map Sheet (7133), area of 5 units, for a further term until 17 December, 2023. Renewal effective on and from 2 February, 2018.

(V17-1212)

Exploration Licence No. 8408, GOLD AND COPPER RESOURCES PTY LIMITED (ACN 124 534 863), Counties of Bathurst and Georgiana, Map Sheet (8730), area of 28 units, for a further term until 2 December, 2023. Renewal effective on and from 2 February, 2018.

(Z11-5908)

Mining Lease No. 1073 (Act 1973), OLIVER TEX WARDEN AND SHIRLEY ANNE WARDEN, Parish of Walcha, County of Parry, Map Sheet (9135-2-N), area of 103.13 hectares, for a further term until 15 October, 2018. Renewal effective on and from 25 January, 2018.

(13-1382)

Mining Lease No. 1246 (Act 1973), OLIVER TEX WARDEN AND SHIRLEY ANNE WARDEN, Parish of Walcha, County of Parry, Map Sheet (9135-2-N), area of 2 hectares, for a further term until 16 October, 2018. Renewal effective on and from 25 January, 2018.

(V17-3139)

Mining Purposes Lease No. 204 (Act 1906), AUSTAR COAL MINE PTY LIMITED (ACN 111 910 822), Parish of Cessnock, County of Northumberland, Map Sheet (9132-2-N, 9132-2-S), area of 1.2 hectares, for a further term until 3 February, 2039. Renewal effective on and from 3 February, 2018.

(V17-3145)

Mining Purposes Lease No. 217 (Act 1906), AUSTAR COAL MINE PTY LIMITED (ACN 111 910 822), area of 6298 square metres, for a further term until 3 February, 2039. Renewal effective on and from 12 April, 2018.

The Honourable Don Harwin MLC
Minister for Resources

[n2018-376]

TRANSFER APPLICATION

(V17/12524)

Exploration Licence No. 5460 (Act 1992), ANGLO COAL (DRAYTON SOUTH) PTY LTD (ACN 081 072 755), ANGLO COAL (DRAYTON) NO. 2 PTY LIMITED (ACN 004 917 177), DAESUNG AUSTRALIA PTY LIMITED (ACN 002 011 967), HYUNDAI AUSTRALIA PTY LTD (ACN 002 008 657), MITSUI DRAYTON INVESTMENT PTY LTD (ACN 082 138 529) and NCE AUSTRALIA PTY LTD (ACN 001 799 444) to ANGLO COAL (DRAYTON SOUTH) PTY LTD (ACN 081 072 755), ANGLO COAL (DRAYTON) NO. 2 PTY LIMITED (ACN 004 917 177), FARAMAX NO 2 PTY LTD (ACN 620 885 127), MITSUI DRAYTON INVESTMENT PTY LTD (ACN 082 138 529), Counties of Durham and Hunter, area of 5580 hectares. Application for transfer received 11 December, 2017.

(V18/432)

Mining Lease No. 6030 (Act 1906) CSR BUILDING PRODUCTS LIMITED (ACN 081 072 755) to HI-QUALITY QUARRY (NSW) PTY LIMITED (ACN 104 362 110), Parish of Castlereagh, County of Cumberland, area of 27.72 hectares. Application for transfer received 2 February, 2018.

(V18/432)

Mining Lease No. 6031 (Act 1906) CSR BUILDING PRODUCTS LIMITED (ACN 081 072 755) to HI-QUALITY QUARRY (NSW) PTY LIMITED (ACN 104 362 110), Parish of Castlereagh, County of Cumberland, area of 23.14 hectares. Application for transfer received 2 February, 2018.

(V18/432)

Mining Lease No. 6032 (Act 1906) CSR BUILDING PRODUCTS LIMITED (ACN 081 072 755) to HI-QUALITY QUARRY (NSW) PTY LIMITED (ACN 104 362 110), Parish of Castlereagh, County of Cumberland, area of 21.07 hectares. Application for transfer received 2 February, 2018.

(V18/432)

Mining Lease No. 1499 (Act 1992), CSR BUILDING PRODUCTS LIMITED (ACN 081 072 755) to HI-QUALITY QUARRY (NSW) PTY LIMITED (ACN 104 362 110), area of 2.22 hectares. Application for transfer received 2 February, 2018.

The Honourable Don Harwin MLC
Minister for Resources

[n2018-377]

Primary Industries Notices

FISHERIES MANAGEMENT ACT 1994

FISHERIES MANAGEMENT (AQUACULTURE) REGULATION 2017

Clause 39 (4) – Notice of Aquaculture Lease Renewal

The Minister has renewed the following class 1 Aquaculture Leases:

OL72/078 within the estuary of the Hastings River, having an area of 0.3591 hectares to Rodney Gene McKay of Port Macquarie, NSW, for a term of 15 years expiring on 1 September 2032.

OL72/257 within the estuary of the Hastings River, having an area of 0.5687 hectares to Rodney Gene McKay of Port Macquarie, NSW, for a term of 15 years expiring on 28 July 2032.

OL57/273 within the estuary of Manning River, having an area of 0.4225 hectares to Peter Mansfield & Trevor Mansfield of Adamstown Heights, NSW, for a term of 15 years expiring on 12 October 2032.

OL72/202 within Port Stephens, having an area of 0.4784 hectares to Oyster Bay (NSW) Pty Ltd of Bobs Farm, NSW, for a term of 15 years expiring on 20 January 2033.

OL57/089 within the estuary of the Shoalhaven River, having an area of 1.0822 hectares to Wayne Simpson of Greenwell Point, NSW, for a term of 15 years expiring on 10 September 2032.

OL57/090 within the estuary of the Shoalhaven River, having an area of 0.3127 hectares to Wayne Simpson of Greenwell Point, NSW, for a term of 15 years expiring on 05 November 2032.

OL88/041 within the estuary of the Clyde River, having an area of 1.4774 hectares to Christopher Mark Ralston of Batemans Bay, NSW, for a term of 15 years expiring on 25 June 2032.

OL82/073 within the estuary of Tuross Lake, having an area of 1.1689 hectares to Christina Kennedy and Trevor Kennedy of Kirribilli, NSW, for a term of 15 years expiring on 20 January 2033

AL13/001 within the estuary of Wallis Lake, having an area of 5.4585 hectares to Glen Robert McLean and Karen Lee Ehlefeldt of Napiac, NSW, for a term of 15 years expiring on 29 November 2032.

OL85/200 within the Wonboyn River, having an area of 0.4777 hectares to Wonboyn Oysters Pty Ltd, NSW, for a term of 15 years expiring on 05 November 2032.

OL85/201 within the Wonboyn River, having an area of 1.1017 hectares to Armitage Holdings (VIC) Pty Ltd, NSW, for a term of 15 years expiring on 05 November 2032.

OL85/211 within the estuary of the Macleay River, having an area of 2.0667 hectares to Adflow Pty Limited of Banora Point, NSW, for a term of 15 years expiring on 30 June 2032.

OL72/072 within the estuary of Merimbula Lake, having an area of 0.6907 hectares to Una Winifred Smith of Millingandi, NSW, for a term of 15 years expiring on 26 September 2032.

OL58/061 within the estuary of the Manning River, having an area of 0.9681 hectares to Neil Kelvin Currie of Taree, NSW, for a term of 15 years expiring on 31 December 2032.

OL87/146 within the estuary of Port Stephens, having an area of 7.7708 hectares to Adrian Salm and Mark Salm of Lemon Tree Passage, NSW, for a term of 15 years expiring on 21 August 2031.

OL59/035 within the estuary of the Pambula River, having an area of 0.7606 hectares to Rodney Grant McIntyre of Lochiel, NSW, for a term of 15 years expiring on 15 February 2033.

OL72/058 within the estuary of the Brunswick River, having an area of 2.3700 hectares to Noel Alexander Baggaley of Stokers Siding, NSW, for a term of 15 years expiring on 31 October 2032.

AL03/011 within the estuary of Wallis Lake, having an area of 1.2864 hectares to MS Verdich & Sons Pty Ltd of Forster, NSW, for a term of 15 years expiring on 29 November 2032.

OL56/233 within the estuary of Wallis Lake, having an area of 0.4091 hectares to Graham James Moore Barclay of Forster, NSW, for a term of 15 years expiring on 14 January 2033.

AL01/025 within the estuary of Wallis Lake, having an area of 2.4811 hectares to Graham James Moore Barclay of Forster, NSW, for a term of 15 years expiring on 18 February 2033.

DAVID MCPHERSON

Group Director Commercial Fisheries & Aquaculture

Fisheries Division
NSW Department of Primary Industries

[n2018-378]

FISHERIES MANAGEMENT ACT 1994
FISHERIES MANAGEMENT (AQUACULTURE) REGULATION 2017

Clause 37 (3) – Notice of Granting of Class 1 Aquaculture Lease

The Minister has granted the following Class 1 Aquaculture Lease:

OL60/032 within the estuary of Port Stephens, having an area of 0.3672 hectares to Alex Watt of Karuah, NSW, for a term of 15 years expiring on 17 November 2032.

OL69/457 within the estuary of Port Stephens, having an area of 0.3495 hectares to Alex Watt of Karuah, NSW, for a term of 15 years expiring on 17 November 2032.

OL87/001 within the estuary of Port Stephens, having an area of 0.1512 hectares to Dean Micheal Johnson of Karuah, NSW, for a term of 15 years expiring on 17 November 2032.

DAVID MCPHERSON
Group Director Commercial Fisheries & Aquaculture
Fisheries Division
NSW Department of Primary Industries

[n2018-379]

FISHERIES MANAGEMENT ACT 1994

Section 8 and Section 11 Notifications – Fishing Closure for Marine Aquaculture Research Lease – Providence Bay

I, GEOFF ALLAN, Deputy Director General Fisheries, with the delegated authority of the Minister for Primary Industries and the Secretary pursuant to sections 227 and 228 of the *Fisheries Management Act 1994* (“the Act”), make these notifications.

1. Notification of Revocation of Fishing Closure

Pursuant to section 11 of the Act, the ‘Section 8 Notification – Fishing Closure for Marine Aquaculture Research Lease – Providence Bay’ dated 25 January 2018 is revoked, as is any notification revived as a result of this notification.

2. Notification of Prohibition of taking of fish

Pursuant to section 8 of the Act, recreational and commercial fishers are prohibited from taking fish from waters bound by the Marine Aquaculture Research Lease as specified in the Schedule below and shown on the lease plan in the Schedule.

3. Commencement and duration

- (a) The revocation of the fishing closure and prohibition of taking fish, as notified above, take effect on the publication.
- (b) This fishing closure is effective until 28 February 2018 unless sooner amended or revoked.

SCHEDULE

Marine Aquaculture Research Lease – Providence Bay

The closure applies to the whole of the waters bounded by a line commencing at the point located at 432 644.2 E/ 6 387 582.2 N, and heading generally south-east to the point located at 433 053.5 E/6 387 171.6 N, then heading generally south-west to the point located at 432 318.3 E/6 386 451.2 N, then heading generally north-west to the point located at 431 912.7 E/6 386 856.1 N, then heading generally north-east to the point of commencement.

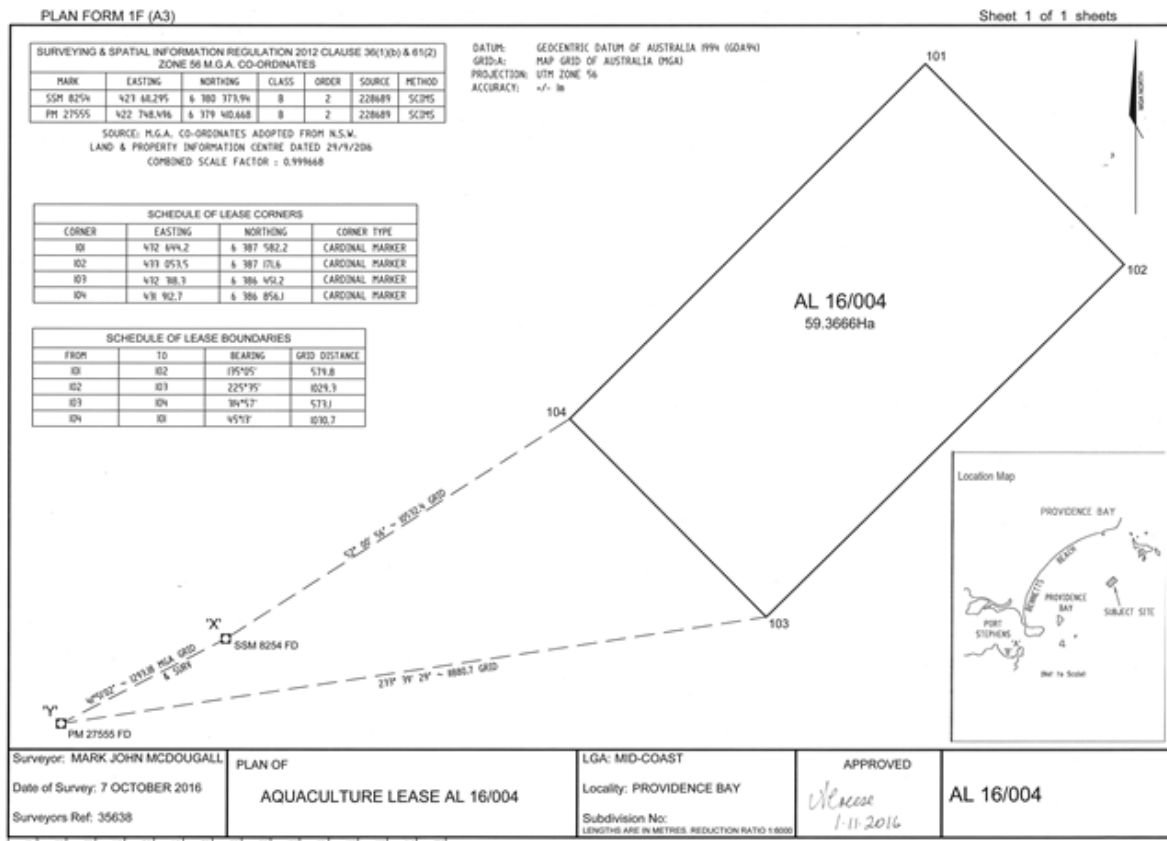

In this schedule, latitude and longitude coordinates are in GDA 94 datum.

Dated this 7th day of February 2018.

DR GEOFF ALLAN
Deputy Director General Fisheries
Department of Primary Industries
(an office within the Department of Industry)

[n2018-380]

FISHERIES MANAGEMENT ACT 1994

Section 8 Notification – Fishing Closure for Marine Aquaculture Research Lease – Providence Bay

I, GEOFF ALLAN, Deputy Director General Fisheries, with the delegated authority of the Minister for Primary Industries and the Secretary pursuant to sections 227 and 228 of the *Fisheries Management Act 1994* (“the Act”), and pursuant to section 8 of the Act, do by this notification prohibit the taking of fish by recreational and commercial fishers from waters bound by the Marine Aquaculture Research Lease as specified in the Schedule below and shown on the lease plan in the Schedule.

Schedule

Marine Aquaculture Research Lease – Providence Bay

The closure applies to the whole of the waters bounded by a line commencing at the point located at 432 644.2 E/ 6 387 582.2 N, and heading generally south-east to the point located at 433 053.5 E/6 387 171.6 N, then heading generally south-west to the point located at 432 318.3 E/6 386 451.2 N, then heading generally north-west to the point located at 431 912.7 E/6 386 856.1 N, then heading generally north-east to the point of commencement.

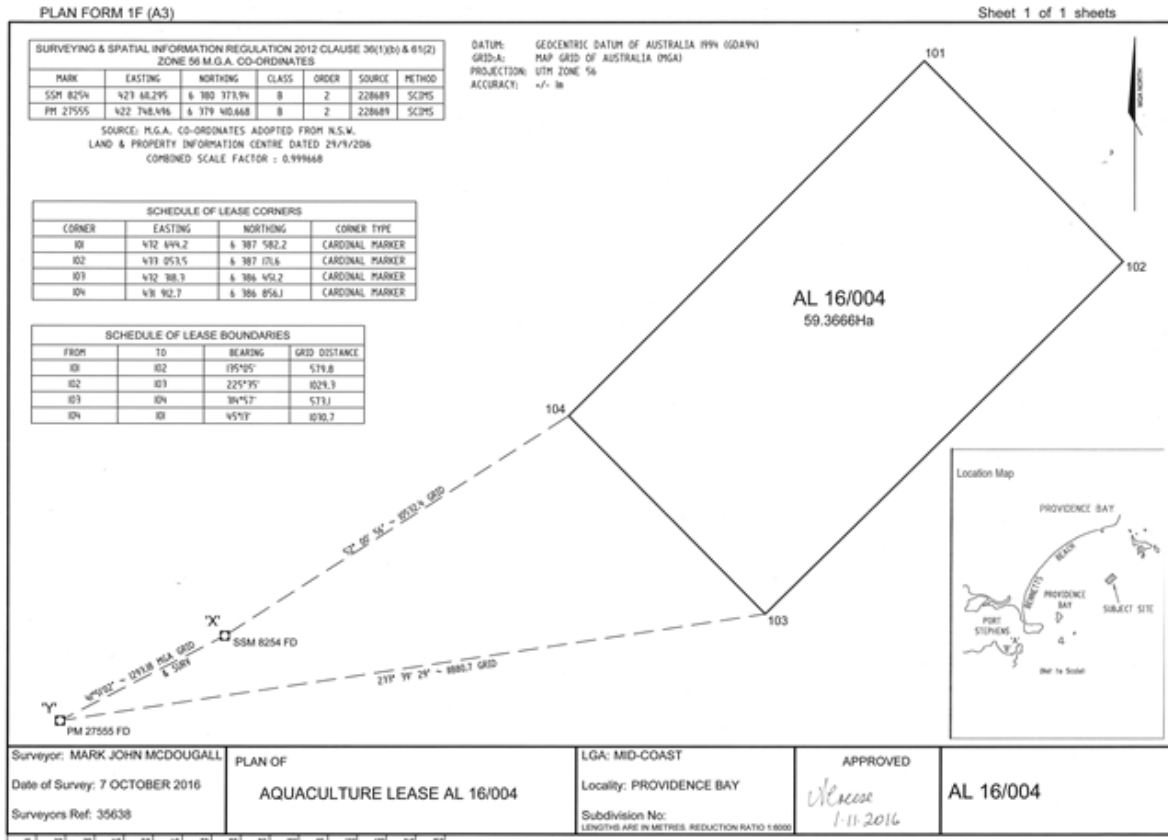

In this schedule, latitude and longitude coordinates are in GDA 94 datum.

This fishing closure notification is effective on the publication of this notification until and including 7 February 2018 unless sooner amended or revoked.

Dated this 25th day of January 2018.

DR GEOFF ALLAN
Deputy Director General Fisheries
Department of Primary Industries
(an office within the Department of Industry)

[n2018-381]

Crown Land Notices

1300 886 235 www.crownland.nsw.gov.au

NOTIFICATION OF CLOSING OF A ROAD

In pursuance of the provisions of the *Roads Act 1993*, the road hereunder described is closed and the lands comprised therein cease to be public road and the rights of passage and access that previously existed in relation to the road is extinguished. Upon closing, title to the land, comprising the former public road, vests in the body specified in the Schedule hereunder.

The Hon Paul Toole, MP
Minister for Lands and Forestry

DESCRIPTION

Parish – Nerang Cowal; County – Gipps

Land District – Forbes; LGA – Lachlan

Road Closed: Lot 1 DP 1235573

File No: 12/01637

SCHEDULE

On closing, the land within Lot 1 DP 1235573 remains vested in the State of New South Wales as Crown land.

[n2018-382]

ROADS ACT 1993

ORDER

Transfer of Crown Roads to Council

IN pursuance of the provisions of Section 151, *Roads Act 1993*, the Crown public roads specified in Schedules 1–6 are transferred to the Roads Authority specified in Schedule 7, hereunder, as from the date of publication of this notice and as from that date, the roads specified in Schedules 1-6 cease to be Crown public roads.

Paul Toole,
Minister for Lands and Water

SCHEDULE 1

Parish – Wiagdon; County – Roxburgh

Land District – Bathurst; Village of Wattle Flat

Local Government Area – Bathurst Regional Council

That part of the Crown Public road known as Twenty Three Mile Lane as denoted by blue shading in the diagram below.



That part of the Crown Public road known as Crawford Lane as denoted by blue shading in the diagram below.

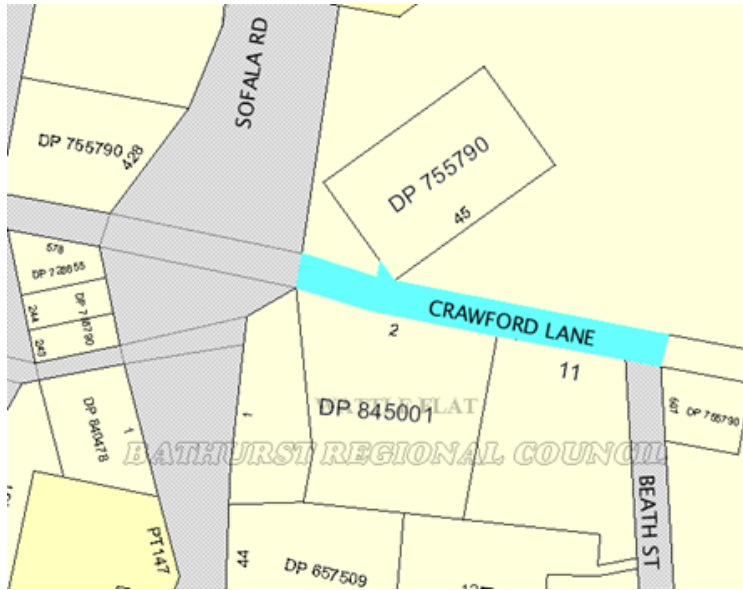

SCHEDULE 5

Parish – Sofala; County – Roxburgh

Land District – Bathurst; Village of Wattle Flat

Local Government Area – Bathurst Regional Council

That part of the Crown Public road known as Reilly Lane as denoted by blue shading in the diagram below.



SCHEDULE 6

Parish – Sofala; County – Roxburgh

Land District – Bathurst; Village of Wattle Flat

Local Government Area – Bathurst Regional Council

DESCRIPTION

*Parish – Clinton; County – Bathurst
Land District – Orange; LGA – Cabonne*

Road Closed: Lot 1 DP 1235653

File No: 10/15014 RS

SCHEDULE

On closing, the land within Lot 1 DP 1235653 remains vested in the State of New South Wales as Crown land.

[n2018-385]

NOTIFICATION OF CLOSING OF A ROAD

In pursuance of the provisions of the *Roads Act 1993*, the road hereunder described is closed and the lands comprised therein cease to be public road and the rights of passage and access that previously existed in relation to the road is extinguished. Upon closing, title to the land, comprising the former public road, vests in the body specified in the Schedule hereunder.

The Hon Paul Toole, MP
Minister for Lands and Forestry

DESCRIPTION

*Parishes – Canonba North, Gilgoen; County – Gregory
Land District – Nyngan; LGA – Bogan*

Road Closed: Lots 1-2 DP 1238412

File No: 17/09505 RS

SCHEDULE

On closing, the land within Lots 1-2 DP 1238412 remains vested in the State of New South Wales as Crown land.

[n2018-386]

ROADS ACT 1993

ORDER

Transfer of a Crown Road to a Council

IN pursuance of the provisions of Section 151, *Roads Act 1993*, the Crown road specified in Column 1 is transferred to the Roads Authority specified in Column 2, hereunder, as from the date of publication of this notice and as from that date, the road specified in Column 1 ceases to be a Crown road.

The Hon Paul Toole, MP
Minister for Lands and Forestry

Column 1	Column 2
<p>Crown public road 200m from the southern boundary of Lot 100 DP 1070724 located within Lot 1 DP 871039 as shown by red colour; Parish Brunswick County Rous at Brunswick Heads.</p> 	<p>Byron Shire Council</p>

Crown lands reference: 18/00507 – W593267

Council's reference: DA2017/337

[n2018-387]

NOTIFICATION OF CLOSING OF A ROAD

In pursuance of the provisions of the *Roads Act 1993*, the road hereunder described is closed and the lands comprised therein cease to be public road and the rights of passage and access that previously existed in relation to the road is extinguished. Upon closing, title to the land, comprising the former public road, vests in the body specified in the Schedule hereunder.

The Hon Paul Toole, MP
Minister for Lands and Forestry

DESCRIPTION

Parish – Bandulla; County – Gowen
Land District – Dunedoo Central; LGA – Warrumbungle

Road Closed: Lot 3 DP 1234583

File No: 17/05761

SCHEDULE

On closing, the land within Lot 3 DP 1234583 remains vested in the State of New South Wales as Crown land.

[n2018-388]

NOTIFICATION OF CLOSING OF A ROAD

In pursuance of the provisions of the *Roads Act 1993*, the road hereunder described is closed and the lands comprised therein cease to be public road and the rights of passage and access that previously existed in relation to the road is extinguished. Upon closing, title to the land, comprising the former public road, vests in the body specified in the Schedule hereunder.

The Hon Paul Toole, MP
Minister for Lands and Forestry

DESCRIPTION

Parish – Tumudgery; County – Townsend
Land District – Deniliquin; LGA – Murray River

Road Closed: Lot 1 DP 1235276

File No: 17/06214

SCHEDULE

On closing, the land within Lot 1 DP 1235276 remains vested in the State of New South Wales as Crown land.

[n2018-389]

NOTIFICATION OF CLOSING OF A ROAD

In pursuance of the provisions of the *Roads Act 1993*, the road hereunder described is closed and the lands comprised therein cease to be public road and the rights of passage and access that previously existed in relation to the road is extinguished. Upon closing, title to the land, comprising the former public road, vests in the body specified in the Schedule hereunder.

The Hon Paul Toole, MP
Minister for Lands and Forestry

DESCRIPTION

Parishes – Moolunmoola, Pialloway; Counties – Parry, Buckland
Land District – Tamworth; LGA – Tamworth Regional

Road Closed: Lots 1-2 DP 1236813

File No: 07/1755

SCHEDULE

On closing, the land within Lots 1-2 DP 1236813 remains vested in the State of New South Wales as Crown land.

[n2018-390]

NOTIFICATION OF CLOSING OF A ROAD

In pursuance of the provisions of the *Roads Act 1993*, the road hereunder described is closed and the lands comprised therein cease to be public road and the rights of passage and access that previously existed in relation to the road is extinguished. Upon closing, title to the land, comprising the former public road, vests in the body specified in the Schedule hereunder.

The Hon Paul Toole, MP
Minister for Lands and Forestry

DESCRIPTION

Parish – Cooridoon; County – Buckland
Land District – Gunnedah; LGA – Gunnedah

Road Closed: Lot 1 DP 1236812

File No: 12/03150

SCHEDULE

On closing, the land within Lot 1 DP 1236812 remains vested in the State of New South Wales as Crown land.

[n2018-391]

NOTIFICATION OF CLOSING OF A ROAD

In pursuance of the provisions of the *Roads Act 1993*, the road hereunder described is closed and the lands comprised therein cease to be public road and the rights of passage and access that previously existed in relation to the road is extinguished. Upon closing, title to the land, comprising the former public road, vests in the body specified in the Schedule hereunder.

The Hon Paul Toole, MP
Minister for Lands and Forestry

DESCRIPTION

Parish – Morangarell; County – Bland
Land District – Grenfell; LGA – Bland

Road Closed: Lot 7 DP 1188075

File No: 10/12107

SCHEDULE

On closing, the land within Lot 7 DP 1188075 remains vested in the State of New South Wales as Crown land.

[n2018-392]

NOTIFICATION OF CLOSING OF A ROAD

In pursuance of the provisions of the *Roads Act 1993*, the road hereunder described is closed and the lands comprised therein cease to be public road and the rights of passage and access that previously existed in relation to the road is extinguished. Upon closing, title to the land, comprising the former public road, vests in the body specified in the Schedule hereunder.

The Hon Paul Toole, MP
Minister for Lands and Forestry

DESCRIPTION

Parish – Colo; County – Camden
Land District – Moss Vale; LGA – Wingecarribee

Road Closed: Lot 4 DP 1234783

File No: 17/04903

SCHEDULE

On closing, the land within Lot 4 DP 1234783 remains vested in the State of New South Wales as Crown land.

[n2018-393]

NOTIFICATION OF CLOSING OF A ROAD

In pursuance of the provisions of the *Roads Act 1993*, the road hereunder described is closed and the lands comprised therein cease to be public road and the rights of passage and access that previously existed in relation to the road is extinguished. Upon closing, title to the land, comprising the former public road, vests in the body specified in the Schedule hereunder.

The Hon Paul Toole, MP
Minister for Lands and Forestry

DESCRIPTION

Parish – Colo; County – Camden

Land District – Moss Vale; LGA – Wingecarribee

Road Closed: Lot 3 DP 1234782

File No: 17/04905

SCHEDULE

On closing, the land within Lot 3 DP 1234782 remains vested in the State of New South Wales as Crown land.

[n2018-394]

NOTIFICATION OF CLOSING OF A ROAD

In pursuance of the provisions of the *Roads Act 1993*, the road hereunder described is closed and the lands comprised therein cease to be public road and the rights of passage and access that previously existed in relation to the road is extinguished. Upon closing, title to the land, comprising the former public road, vests in the body specified in the Schedule hereunder.

The Hon Paul Toole, MP
Minister for Lands and Forestry

DESCRIPTION

Parish – Shadforth; County – Bathurst

Land District – Orange; LGA – Orange

Road Closed: Lot 1 DP 1237290

File No: 17/04826

SCHEDULE

On closing, the land within Lot 1 DP 1237290 remains vested in the State of New South Wales as Crown land.

[n2018-395]

NOTIFICATION OF CLOSING OF A ROAD

In pursuance of the provisions of the *Roads Act 1993*, the road hereunder described is closed and the lands comprised therein cease to be public road and the rights of passage and access that previously existed in relation to the road is extinguished. Upon closing, title to the land, comprising the former public road, vests in the body specified in the Schedule hereunder.

The Hon Paul Toole, MP
Minister for Lands and Forestry

DESCRIPTION

Parish – Castlestead; County – Hume

Land District – Albury; LGA – Greater Hume

Road Closed: Lot 1 DP 1215048

File No: 15/00770

SCHEDULE

On closing, the land within Lot 1 DP 1215048 remains vested in the State of New South Wales as Crown land.

[n2018-396]

NOTIFICATION OF CLOSING OF A ROAD

In pursuance of the provisions of the *Roads Act 1993*, the road hereunder described is closed and the lands comprised therein cease to be public road and the rights of passage and access that previously existed in relation to the road is extinguished. Upon closing, title to the land, comprising the former public road, vests in the body specified in the Schedule hereunder.

The Hon Paul Toole, MP
Minister for Lands and Forestry

DESCRIPTION

Parish – Berwick; County – Rous

Land District – Murwillumbah; LGA – Tweed

Road Closed: Lot 1 DP 1229251

File No: 16/03995

SCHEDULE

On closing, the land within Lot 1 DP 1229251 remains vested in the State of New South Wales as Crown land.

[n2018-397]

ALTERATION OF PURPOSE/CONDITIONS OF A WESTERN LANDS LEASE

It is hereby notified that in pursuance of the provisions of Section 18J *Western Lands Act 1901*, the purpose and conditions of the undermentioned Western Lands Lease have been altered as shown.

The Hon PAUL TOOLE, MP
Minister for Lands and Forestry

Administrative District – Balranald

Shire – Balranald, County – Caira

The purpose of Western Land Leases 15277 & 15278, being the land contained within Folio Identifiers 1/1231855 & 4/1231855 have been altered from “Grazing” to “Conservation” effective from 31 January 2018.

As a consequence of the alteration of purpose/conditions rent will be assessed annually in line with the *Western Lands Act 1901* and Regulations.

The conditions have been altered by the inclusion of the special conditions following:

SPECIAL CONDITIONS ATTACHED TO WESTERN LAND LEASES 15277 & 15278.

1. The lessee must within 12 months from the date of the addition of these conditions to the lease, erect and maintain to the satisfaction of the Commissioner a stock proof fence around the lease.
2. The lessee must ensure that during the term of the leases all domestic stock is excluded from the leases.
3. The lessee must not clear any vegetation or remove any timber, fallen logs or rocks within the lands leased unless written approval has been granted by either the Commissioner or the Minister.
4. The land must only be used for the purpose of Conservation.

File No: WLL4831-1

[n2018-398]

NOTIFICATION OF CLOSING OF A ROAD

In pursuance of the provisions of the *Roads Act 1993*, the road hereunder described is closed and the lands comprised therein cease to be public road and the rights of passage and access that previously existed in relation to the road is extinguished. Upon closing, title to the land, comprising the former public road, vests in the body specified in the Schedule hereunder.

The Hon Paul Toole, MP
Minister for Lands and Forestry

DESCRIPTION

*Parishes – Jamalong, Keadool, Cox; Counties – Baradine, Leichhardt
Land District – Narrabri; LGA – Coonamble*

Road Closed: Lot 3 DP 1234395

File No: 15/08966

SCHEDULE

On closing, the land within Lot 3 DP 1234395 remains vested in the State of New South Wales as Crown land.

[n2018-399]

NOTIFICATION OF CLOSING OF A ROAD

In pursuance of the provisions of the *Roads Act 1993*, the road hereunder described is closed and the lands comprised therein cease to be public road and the rights of passage and access that previously existed in relation to the road is extinguished. Upon closing, title to the land, comprising the former public road, vests in the body specified in the Schedule hereunder.

The Hon Paul Toole, MP
Minister for Lands and Forestry

DESCRIPTION

*Parishes – Bullenbung, Berry Jerry, Tootool; County – Mitchell
Land District – Wagga Wagga; LGA – Wagga Wagga, Lockhart*

Road Closed: Lots 11-13 DP 1226604

File No: 15/03083

SCHEDULE

On closing, the land within Lots 11 DP 1226604 remains vested in the State of New South Wales as Crown land.

On closing, that part of the land within Lot 12 DP1226604 which was formerly Council road, and Lot 13 DP1226604 becomes vested in the State of New South Wales as Crown Land.

[n2018-400]

NOTIFICATION OF CLOSING OF A ROAD

In pursuance of the provisions of the *Roads Act 1993*, the road hereunder described is closed and the lands comprised therein cease to be public road and the rights of passage and access that previously existed in relation to the road is extinguished. Upon closing, title to the land, comprising the former public road, vests in the body specified in the Schedule hereunder.

The Hon Paul Toole, MP
Minister for Lands and Forestry

DESCRIPTION

*Parish – Mongarlowe; County – St Vincent
Land District – Braidwood; LGA – Queanbeyan-Palerang Regional*

Road Closed: Lot 1 DP 1235124

File No: 17/05190

SCHEDULE

On closing, the land within Lot 1 DP 1235124 remains vested in the State of New South Wales as Crown land.

[n2018-401]

NOTIFICATION OF CLOSING OF A ROAD

In pursuance of the provisions of the *Roads Act 1993*, the road hereunder described is closed and the lands comprised therein cease to be public road and the rights of passage and access that previously existed in relation to the road is extinguished. Upon closing, title to the land, comprising the former public road, vests in the body specified in the Schedule hereunder.

The Hon Paul Toole, MP
Minister for Lands and Forestry

DESCRIPTION

Parish – Cunninggar; County – Harden
Land District – Young; LGA – Hilltops

Road Closed: Lot 4 DP 1238225

File No: 17/04694

SCHEDULE

On closing, the land within Lot 4 DP 1238225 remains vested in the State of New South Wales as Crown land.

[n2018-402]

NOTIFICATION OF CLOSING OF A ROAD

In pursuance of the provisions of the *Roads Act 1993*, the road hereunder described is closed and the lands comprised therein cease to be public road and the rights of passage and access that previously existed in relation to the road is extinguished. Upon closing, title to the land, comprising the former public road, vests in the body specified in the Schedule hereunder.

The Hon Paul Toole, MP
Minister for Lands and Forestry

DESCRIPTION

Parish – Eaton; County – Clarence
Land District – Grafton; LGA – Clarence Valley

Road Closed: Lot 1 DP 1238725

File No: 17/10226

SCHEDULE

On closing, the land within Lot 1 DP 1238725 remains vested in the State of New South Wales as Crown land.

[n2018-403]

NOTIFICATION OF CLOSING OF A ROAD

In pursuance of the provisions of the *Roads Act 1993*, the road hereunder described is closed and the lands comprised therein cease to be public road and the rights of passage and access that previously existed in relation to the road is extinguished. Upon closing, title to the land, comprising the former public road, vests in the body specified in the Schedule hereunder.

The Hon Paul Toole, MP
Minister for Lands and Forestry

DESCRIPTION

Parish – Mittagong; County – Camden
Land District – Moss Vale; LGA – Wingecarribee

Road Closed: Lot 3 DP 1235717

File No: 17/07080

SCHEDULE

On closing, the land within Lot 3 DP1235717 becomes vested in the State of New South Wales as Crown Land.

[n2018-404]

NOTIFICATION OF CLOSING OF A ROAD

In pursuance of the provisions of the *Roads Act 1993*, the road hereunder described is closed and the lands comprised therein cease to be public road and the rights of passage and access that previously existed in relation to the road is extinguished. Upon closing, title to the land, comprising the former public road, vests in the body specified in the Schedule hereunder.

The Hon Paul Toole, MP
Minister for Lands and Forestry

DESCRIPTION

*Parishes – Barney Downs, Tenterfield; County – Clive
Land District – Tenterfield; LGA – Tenterfield*

Road Closed: Lot 2 DP 1224654

File No: 15/07248

SCHEDULE

On closing, the land within Lot 2 DP 1224654 remains vested in the State of New South Wales as Crown land.

[n2018-405]

NOTIFICATION OF CLOSING OF A ROAD

In pursuance of the provisions of the *Roads Act 1993*, the road hereunder described is closed and the lands comprised therein cease to be public road and the rights of passage and access that previously existed in relation to the road is extinguished. Upon closing, title to the land, comprising the former public road, vests in the body specified in the Schedule hereunder.

The Hon Paul Toole, MP
Minister for Lands and Forestry

DESCRIPTION

*Parish – Tumbarumba; County – Selwyn
Land District – Tumbarumba; LGA – Snowy Valleys*

Road Closed: Lot 10 DP 1237697

File No: 16/07744

SCHEDULE

On closing, the land within Lot 10 DP 1237697 remains vested in the State of New South Wales as Crown land.

[n2018-406]

NOTIFICATION OF CLOSING OF A ROAD

In pursuance of the provisions of the *Roads Act 1993*, the road hereunder described is closed and the lands comprised therein cease to be public road and the rights of passage and access that previously existed in relation to the road is extinguished. Upon closing, title to the land, comprising the former public road, vests in the body specified in the Schedule hereunder.

The Hon Paul Toole, MP
Minister for Lands and Forestry

DESCRIPTION

*Parish – Woperana; County – Denison
Land District – Deniliquin; LGA – Berrigan*

Road Closed: Lot 1 DP 1235272

File No: 17/00675

SCHEDULE

On closing, the land within Lot 1 DP 1235272 remains vested in the State of New South Wales as Crown land.

[n2018-407]

NOTIFICATION OF CLOSING OF A ROAD

In pursuance of the provisions of the *Roads Act 1993*, the road hereunder described is closed and the lands comprised therein cease to be public road and the rights of passage and access that previously existed in relation to the road is extinguished. Upon closing, title to the land, comprising the former public road, vests in the body specified in the Schedule hereunder.

The Hon Paul Toole, MP
Minister for Lands and Forestry

DESCRIPTION

*Parishes – Momo, Obley; County – Narromine
Land District – Dubbo; LGA – Narromine*

Road Closed: Lots 1-3 DP 1238291

File No: 16/10593

SCHEDULE

On closing, the land within Lots 1-3 DP 1238291 remains vested in the State of New South Wales as Crown land.

[n2018-408]

NOTIFICATION OF CLOSING OF A ROAD

In pursuance of the provisions of the *Roads Act 1993*, the road hereunder described is closed and the lands comprised therein cease to be public road and the rights of passage and access that previously existed in relation to the road is extinguished. Upon closing, title to the land, comprising the former public road, vests in the body specified in the Schedule hereunder.

The Hon Paul Toole, MP
Minister for Lands and Forestry

DESCRIPTION

*Parish – Baxter; County – Monteagle
Land District – Young; LGA – Hilltops*

Road Closed: Lot 2 DP 1235580

File No: 15/00971

SCHEDULE

On closing, the land within Lot 2 DP 1235580 remains vested in the State of New South Wales as Crown land.

[n2018-409]

NOTIFICATION OF CLOSING OF A ROAD

In pursuance of the provisions of the *Roads Act 1993*, the road hereunder described is closed and the lands comprised therein cease to be public road and the rights of passage and access that previously existed in relation to the road is extinguished. Upon closing, title to the land, comprising the former public road, vests in the body specified in the Schedule hereunder.

The Hon Paul Toole, MP
Minister for Lands and Forestry

DESCRIPTION

*Parish – Rockley; County – Georgiana
Land District – Bathurst; LGA – Bathurst Regional*

Road Closed: Lot 1 DP 1235048

File No: 16/09787

SCHEDULE

On closing, the land within Lot 1 DP 1235048 remains vested in the State of New South Wales as Crown land.

[n2018-410]

NOTIFICATION OF CLOSING OF A ROAD

In pursuance of the provisions of the *Roads Act 1993*, the road hereunder described is closed and the lands comprised therein cease to be public road and the rights of passage and access that previously existed in relation to the road is extinguished. Upon closing, title to the land, comprising the former public road, vests in the body specified in the Schedule hereunder.

The Hon Paul Toole, MP
Minister for Lands and Forestry

DESCRIPTION

*Parish – Wollongong; County – Camden
Land District – Kiama; LGA – Wollongong*

Road Closed: Lot 300 DP 1239092

File No: 16/10631

SCHEDULE

On closing, the land within Lot 300 DP 1239092 remains vested in Wollongong City Council as operational land for the purposes of the *Local Government Act 1993*.

Council Reference: Z16/275968

[n2018-411]

NOTIFICATION OF CLOSING OF A ROAD

In pursuance of the provisions of the *Roads Act 1993*, the road hereunder described is closed and the lands comprised therein cease to be public road and the rights of passage and access that previously existed in relation to the road is extinguished. Upon closing, title to the land, comprising the former public road, vests in the body specified in the Schedule hereunder.

The Hon Paul Toole, MP
Minister for Lands and Forestry

DESCRIPTION

*Parish – St Luke; County – Cumberland
Land District – Metropolitan; LGA – Liverpool*

Road Closed: Lot 1 DP 1237490

File No: 16/06849

SCHEDULE

On closing, the land within Lot 1 DP 1237490 remains vested in Liverpool City Council as operational land for the purposes of the *Local Government Act 1993*.

Council Reference: 2011/3291

[n2018-412]

NOTIFICATION OF CLOSING OF A ROAD

In pursuance of the provisions of the *Roads Act 1993*, the road hereunder described is closed and the lands comprised therein cease to be public road and the rights of passage and access that previously existed in relation to the road is extinguished. Upon closing, title to the land, comprising the former public road, vests in the body specified in the Schedule hereunder.

The Hon Paul Toole, MP
Minister for Lands and Forestry

DESCRIPTION

*Parish – Numeralla; County – Beresford
Land District – Cooma; LGA – Snowy Monaro Regional*

Road Closed: Lot 1 DP 1238624

File No: 16/07542

SCHEDULE

On closing, the land within Lot 1 DP 1238624 remains vested in the State of New South Wales as Crown land.

[n2018-413]

NOTIFICATION OF CLOSING OF A ROAD

In pursuance of the provisions of the *Roads Act 1993*, the road hereunder described is closed and the lands comprised therein cease to be public road and the rights of passage and access that previously existed in relation to the road is extinguished. Upon closing, title to the land, comprising the former public road, vests in the body specified in the Schedule hereunder.

The Hon Paul Toole, MP
Minister for Lands and Forestry

DESCRIPTION

Parishes – Emogandry, Wirrigai; County – Ewenmar

Land District – Dubbo; LGA – Narromine

Road Closed: Lots 1-4 DP 1238625

File No: 16/05705

SCHEDULE

On closing, the land within Lots 1-3 DP 1238625 remains vested in the State of New South Wales as Crown land.

On closing, the land within Lot 4 DP 1238625 formerly Council road becomes vested in the State of New South Wales as Crown land.

[n2018-414]

NOTIFICATION OF CLOSING OF A ROAD

In pursuance of the provisions of the *Roads Act 1993*, the road hereunder described is closed and the lands comprised therein cease to be public road and the rights of passage and access that previously existed in relation to the road is extinguished. Upon closing, title to the land, comprising the former public road, vests in the body specified in the Schedule hereunder.

The Hon Paul Toole, MP
Minister for Lands and Forestry

DESCRIPTION

Parish – Braidwood; County – St Vincent

Land District – Braidwood; LGA – Queanbeyan-Palerang Regional

Road Closed: Lot 2 DP 1235758

File No: 16/08890

SCHEDULE

On closing, the land within Lot 2 DP 1235758 remains vested in the State of New South Wales as Crown land.

[n2018-415]

NOTIFICATION OF CLOSING OF A ROAD

In pursuance of the provisions of the *Roads Act 1993*, the road hereunder described is closed and the lands comprised therein cease to be public road and the rights of passage and access that previously existed in relation to the road is extinguished. Upon closing, title to the land, comprising the former public road, vests in the body specified in the Schedule hereunder.

The Hon Paul Toole, MP
Minister for Lands and Forestry

DESCRIPTION

Parish – Chillingham; County – Rous

Land District – Murwillumbah; LGA – Tweed

Road Closed: Lots 1-2 DP 1237656

File No: 16/09062

SCHEDULE

On closing, the land within Lots 1-2 DP 1237656 remains vested in the State of New South Wales as Crown land.

[n2018-416]

NOTIFICATION OF CLOSING OF A ROAD

In pursuance of the provisions of the *Roads Act 1993*, the road hereunder described is closed and the lands comprised therein cease to be public road and the rights of passage and access that previously existed in relation to the road is extinguished. Upon closing, title to the land, comprising the former public road, vests in the body specified in the Schedule hereunder.

The Hon Paul Toole, MP
Minister for Lands and Forestry

DESCRIPTION

Parishes – Carabobala, Mountain Creek; County – Goulburn

Land District – Albury; LGA – Greater Hume

Road Closed: Lots 11-13 DP 1237652

File No: 16/09056

SCHEDULE

On closing, the land within Lots 11-13 DP 1237652 remains vested in the State of New South Wales as Crown land.

[n2018-417]

NOTIFICATION OF CLOSING OF A ROAD

In pursuance of the provisions of the *Roads Act 1993*, the road hereunder described is closed and the lands comprised therein cease to be public road and the rights of passage and access that previously existed in relation to the road is extinguished. Upon closing, title to the land, comprising the former public road, vests in the body specified in the Schedule hereunder.

The Hon Paul Toole, MP
Minister for Lands and Forestry

DESCRIPTION

Parish – Crosby; County – King

Land District – Yass; LGA – Yass Valley

Road Closed: Lot 1 DP 1237433

File No: 17/05602

SCHEDULE

On closing, the land within Lot 1 DP 1237433 remains vested in the State of New South Wales as Crown land.

[n2018-418]

NOTIFICATION OF CLOSING OF A ROAD

In pursuance of the provisions of the *Roads Act 1993*, the road hereunder described is closed and the lands comprised therein cease to be public road and the rights of passage and access that previously existed in relation to the road is extinguished. Upon closing, title to the land, comprising the former public road, vests in the body specified in the Schedule hereunder.

The Hon Paul Toole, MP
Minister for Lands and Forestry

DESCRIPTION

Parishes – Morebringer, Kentucky, Brocklesby; County – Hume

Land District – Corowa; LGA – Greater Hume

Road Closed: Lots 2-3 DP 1226598

File No: 16/01046

SCHEDULE

On closing, the land within Lots 2-3 DP 1226598 remains vested in the State of New South Wales as Crown land.

[n2018-419]

NOTIFICATION OF CLOSING OF A ROAD

In pursuance of the provisions of the *Roads Act 1993*, the road hereunder described is closed and the lands comprised therein cease to be public road and the rights of passage and access that previously existed in relation to the road is extinguished. Upon closing, title to the land, comprising the former public road, vests in the body specified in the Schedule hereunder.

The Hon Paul Toole, MP

Minister for Lands and Forestry

DESCRIPTION

Parish – Eaton; County – Clarence

Land District – Grafton; LGA – Clarence Valley

Road Closed: Lot 1 DP 1223728

File No: 16/01143

SCHEDULE

On closing, the land within Lot 1 DP 1223728 remains vested in the State of New South Wales as Crown land.

[n2018-420]

CROWN LANDS ACT 1989

Erratum

IN the notice appearing in the New South Wales Government Gazette No 12 of the 2 February 2018, Folio 498, under the heading “NOTIFICATION OF CLOSING OF ROAD”, in respect of Road Closed: Lot 1, DP 1233655 at Kildary, L.G.A. – Bland this notice should be deleted and is replaced by notice appearing previously in the New South Wales Government Gazette No 119 of the 27 October, 2017, Folio 6592, under the heading “NOTIFICATION OF CLOSING OF ROAD”, in respect of Road Closed: Lot 1, DP1233655 at Kildary, LGA – Bland.

File No: 14/01427

[n2018-421]

NOTIFICATION OF CLOSING OF A ROAD

In pursuance of the provisions of the *Roads Act 1993*, the road hereunder described is closed and the lands comprised therein cease to be public road and the rights of passage and access that previously existed in relation to the road is extinguished. Upon closing, title to the land, comprising the former public road, vests in the body specified in the Schedule hereunder.

The Hon Paul Toole, MP

Minister for Lands and Forestry

DESCRIPTION

Parish – Cookandoon; County – Oxley

Land District – Nyngan; LGA – Bogan

Road Closed: Lot 8 DP 1233533

File No: 17/00198

SCHEDULE

On closing, the land within Lot 8 DP 1233533 remains vested in the State of New South Wales as Crown land.

[n2018-422]

NOTIFICATION OF CLOSING OF A ROAD

In pursuance of the provisions of the *Roads Act 1993*, the road hereunder described is closed and the lands comprised therein cease to be public road and the rights of passage and access that previously existed in relation to the road is extinguished. Upon closing, title to the land, comprising the former public road, vests in the body specified in the Schedule hereunder.

The Hon Paul Toole, MP
Minister for Lands and Forestry

DESCRIPTION

Parish – Humula; County – Wynyard
Land District – Tumbarumba North; LGA – Wagga Wagga

Road Closed: Lot 1 DP 1228634

File No: 16/07428

SCHEDULE

On closing, the land within Lot 1 DP 1228634 remains vested in the State of New South Wales as Crown land.

[n2018-423]

NOTIFICATION OF CLOSING OF A ROAD

In pursuance of the provisions of the *Roads Act 1993*, the road hereunder described is closed and the lands comprised therein cease to be public road and the rights of passage and access that previously existed in relation to the road is extinguished. Upon closing, title to the land, comprising the former public road, vests in the body specified in the Schedule hereunder.

The Hon Paul Toole, MP
Minister for Lands and Forestry

DESCRIPTION

Parish – Lanitza; County – Clarence
Land District – Grafton; LGA – Clarence Valley

Road Closed: Lot 1 DP 1213223

File No: 15/05768

SCHEDULE

On closing, the land within Lot 1 DP 1213223 remains vested in the State of New South Wales as Crown land.

[n2018-424]

NOTIFICATION OF CLOSING OF A ROAD

In pursuance of the provisions of the *Roads Act 1993*, the road hereunder described is closed and the lands comprised therein cease to be public road and the rights of passage and access that previously existed in relation to the road is extinguished. Upon closing, title to the land, comprising the former public road, vests in the body specified in the Schedule hereunder.

The Hon Paul Toole, MP
Minister for Lands and Forestry

DESCRIPTION

Parish – Blowering; County – Buccleuch
Land District – Tumut; LGA – Snowy Valleys

Road Closed: Lot 1 DP 1198592

File No: 13/12852

SCHEDULE

On closing, the land within Lot 1 DP 1198592 remains vested in the State of New South Wales as Crown land.

[n2018-425]

NOTIFICATION OF CLOSING OF A ROAD

In pursuance of the provisions of the *Roads Act 1993*, the road hereunder described is closed and the lands comprised therein cease to be public road and the rights of passage and access that previously existed in relation to the road is extinguished. Upon closing, title to the land, comprising the former public road, vests in the body specified in the Schedule hereunder.

The Hon Paul Toole, MP
Minister for Lands and Forestry

DESCRIPTION

Parish – Walcha; County – Vernon
Land District – Walcha; LGA – Walcha

Road Closed: Lot 97 DP 1217389

File No: 15/04015

SCHEDULE

On closing, the land within Lot 97 DP 1217389 remains vested in the State of New South Wales as Crown land.

[n2018-426]

NOTIFICATION OF CLOSING OF A ROAD

In pursuance of the provisions of the *Roads Act 1993*, the road hereunder described is closed and the lands comprised therein cease to be public road and the rights of passage and access that previously existed in relation to the road is extinguished. Upon closing, title to the land, comprising the former public road, vests in the body specified in the Schedule hereunder.

The Hon Paul Toole, MP
Minister for Lands and Forestry

DESCRIPTION

Parish – Langtree; County – Nicholson
Land District – Hillston; LGA – Carrathool

Road Closed: Lot 2 DP 1238517

File No: 17/08026

SCHEDULE

On closing, the land within Lot 2 DP 1238517 remains vested in the State of New South Wales as Crown land.

[n2018-427]

NOTIFICATION OF CLOSING OF A ROAD

In pursuance of the provisions of the *Roads Act 1993*, the road hereunder described is closed and the lands comprised therein cease to be public road and the rights of passage and access that previously existed in relation to the road is extinguished. Upon closing, title to the land, comprising the former public road, vests in the body specified in the Schedule hereunder.

The Hon Paul Toole, MP
Minister for Lands and Forestry

DESCRIPTION

Parish – Mitchell; County – Goulburn
Land District – Albury; LGA – Greater Hume

Road Closed: Lot 1 DP 1198388

File No: 14/02502

SCHEDULE

On closing, the land within Lot 1 DP 1198388 remains vested in the State of New South Wales as Crown land.

[n2018-428]

APPOINTMENT OF TRUST BOARD MEMBERS

Pursuant to section 93 of the *Crown Lands Act 1989*, the persons whose names are specified in Column 1 of the Schedule hereunder are appointed, for the terms of office specified in that Column, as members of the trust board for the reserve trust specified opposite thereto in Column 2, which has been established and appointed as trustee of the reserve referred to opposite thereto in Column 3 of the Schedule.

The Hon Paul Toole, MP
Minister for Lands and Forestry

Schedule

Column 1	Column 2	Column 3
Kym Margaret Thomas (new member) Andrew Michael Bruggy (new member) For a term commencing the date of this notice and expiring 23 April 2019.	Sulphide Street Station Railway And Historical Museum Trust – Broken Hill	Reserve No. 89402 Public Purpose: museum Notified: 14 March 1975 File Reference: WL90R0047-2

[n2018-429]

NOTICE OF PURPOSE OTHER THAN THE DECLARED PURPOSE PURSUANT TO SECTION 34A(2)(b) OF THE CROWN LANDS ACT 1989

Pursuant to section 34A(2)(b) of the *Crown Lands Act 1989*, the Crown reserve(s) specified in Column 2 of the Schedule is to be used or occupied under a relevant interest granted for the purpose(s) specified in Column 1 of the Schedule where such use or occupation is other than the declared purpose of the reserve

The Hon Paul Toole, MP
Minister for Lands and Forestry

Schedule

Column 1	Column 2
community purposes	Reserve No. 87665 Public Purpose: girl guides Notified: 13 February 1970 File Reference: 16/05559

Schedule

Column 1	Column 2
pipeline	Reserve No. 751299 Public Purpose: future public requirements Notified: 29 June 2007 File Reference: 16/09579

Schedule

Column 1	Column 2
dam	Reserve No. 84965 Public Purpose: future public requirements Notified: 7 August 1964 File Reference: 17/07199

Schedule

Column 1	Column 2
grazing	Reserve No. 97512 Public Purpose: preservation of native flora and fauna Notified: 2 November 1984 File Reference: 17/06666

Schedule

Column 1	Column 2
sporting event	Reserve No. 2027 Public Purpose: travelling stock Notified: 10 March 1884 File Reference: 17/10667 Reserve No. 2362 Public Purpose: camping Notified: 6 August 1883 File Reference: 17/10667 Reserve No. 5945 Public Purpose: water Notified: 21 April 1888 File Reference: 17/10667 Reserve No. 15877 Public Purpose: travelling stock Notified: 18 June 1892 File Reference: 17/10667 Reserve No. 15882 Public Purpose: travelling stock Notified: 18 June 1889 File Reference: 17/10667 Reserve No. 70962 Public Purpose: village purposes Notified: 3 September 1943 File Reference: 17/10667 Reserve No. 75636 Public Purpose: travelling stock Notified: 27 February 1953 File Reference: 17/10667 Reserve No. 15 Public Purpose: travelling stock Notified: 30 October 1874 File Reference: 17/10667 Reserve No. 88087 Public Purpose: future public requirements Notified: 8 January 1971 File Reference: 17/11646 Reserve No. 755259 Public Purpose: future public requirements Notified: 29 June 2007 File Reference: 17/11646

Schedule

Column 1	Column 2
land management purposes	Reserve No. 6463 Public Purpose: camping, travelling stock Notified: 9 June 1888 File Reference: WL95H0157 Reserve No. 8779 Public Purpose: travelling stock Notified: 23 March 1889 File Reference: WL95H0158 Reserve No. 77324 Public Purpose: access Notified: 7 January 1955 File Reference: WL96H0111 Reserve No. 77745 Public Purpose: camping, travelling stock Notified: 1 July 1955 File Reference: WL96H0111 Reserve No. 89736 Public Purpose: camping, travelling stock Notified: 27 February 1976 File Reference: WL95H0159

[n2018-430]

ORDER – AUTHORISATION OF ADDITIONAL PURPOSE UNDER S121A

Pursuant to section 121A of the *Crown Lands Act 1989*, I authorise by this Order, the purpose specified in Column 1 to be an additional purpose to the declared purpose of the reserves specified opposite thereto in Column 2 of the Schedule.

The Hon Paul Toole, MP
Minister for Lands and Forestry

Schedule

Column 1	Column 2
rural services	Reserve No. 92467 Public Purpose: future public requirements Notified: 30 May 1980 File Reference: 18/00482

[n2018-431]

APPOINTMENT OF TRUST BOARD MEMBERS

Pursuant to section 93 of the *Crown Lands Act 1989*, the persons whose names are specified in Column 1 of the Schedule hereunder are appointed, for the terms of office specified in that Column, as members of the trust board for the reserve trust specified opposite thereto in Column 2, which has been established and appointed as trustee of the reserve referred to opposite thereto in Column 3 of the Schedule.

The Hon Paul Toole, MP
Minister for Lands and Forestry

Schedule

Column 1	Column 2	Column 3
Douglas Bradford Tilley (re-appointment) Kurt Jean Eyding (re-appointment) Grant Michael Pointing(re-appointment) Doug Stratford(re-appointment) Nathan Nassel Waters(re-appointment) Patricia Edith Willard(re-appointment) For a term commencing 15 February 2018 and expiring 14 February 2023.	Robertson Showground Trust	Reserve No. 180002 Public Purpose: showground Notified: 27 June 1986 File Reference: GB91R4

[n2018-432]

NOTIFICATION OF CLOSING OF A ROAD

In pursuance of the provisions of the *Roads Act 1993*, the road hereunder described is closed and the lands comprised therein cease to be public road and the rights of passage and access that previously existed in relation to the road is extinguished. Upon closing, title to the land, comprising the former public road, vests in the body specified in the Schedule hereunder.

The Hon Paul Toole, MP
 Minister for Lands and Forestry

DESCRIPTION

Parish – Gindoono; County – Cunningham
Land District – Condobolin; LGA – Lachlan

Road Closed: Lot 3 DP 1235191

File No: 17/01072

SCHEDULE

On closing, the land within Lot 3 DP 1235191 remains vested in the State of New South Wales as Crown land.

[n2018-433]

NOTIFICATION OF CLOSING OF A ROAD

In pursuance of the provisions of the *Roads Act 1993*, the road hereunder described is closed and the lands comprised therein cease to be public road and the rights of passage and access that previously existed in relation to the road is extinguished. Upon closing, title to the land, comprising the former public road, vests in the body specified in the Schedule hereunder.

The Hon Paul Toole, MP
 Minister for Lands and Forestry

DESCRIPTION

Parish – Cooyal; County – Phillip
Land District – Mudgee; LGA – Mid-Western Regional

Road Closed: Lot 1 DP 1228070

File No: 16/07643

SCHEDULE

On closing, the land within Lot 1 DP 1228070 remains vested in the State of New South Wales as Crown land.

[n2018-434]

REVOCATION OF RESERVATION OF CROWN LAND

Pursuant to section 90 of the *Crown Lands Act 1989*, the reservation of Crown land specified in Column 1 of the Schedules hereunder is revoked to the extent specified opposite thereto in Column 2 of the Schedules.

The Hon Paul Toole, MP
Minister for Lands and Forestry

SCHEDULE

COLUMN 1	COLUMN 2
Land District: Parkes Local Government Area: Parkes Shire Council Locality: Trundle Reserve No. 81149 Public Purpose: future public requirements Notified: 17 October 1958 File Reference: OE81H533	The whole being Whole Lots: Lot 159 DP 752121 Parish: Trundle County: Cunningham

SCHEDULE

COLUMN 1	COLUMN 2
Land District: Parkes Local Government Area: Parkes Shire Council Locality: Trundle Reserve No. 752121 Public Purpose: future public requirements Notified: 29 June 2007 File Reference: OE81H533	The part being Whole Lots: Lot 174 DP 752121 Parish: Trundle County: Cunningham

[n2018-435]

Water Notices

WATER ACT 1912

DEPARTMENT OF INDUSTRY –LANDS AND WATER

GWYDIR FLOOD PLAIN

An application for a Controlled Work Approval under Part 8 of the *Water Act 1912* has been received from R L Estens for a levee on the Gwydir Flood Plain on Lots 30, 31 and 80 in DP751762, County of Carore Parish and Lot 101 DP1096059 Parish of Bagree, County of Courallie.

Objections to the granting of this approval must be registered in writing to DoI – Water, PO Box 205, Deniliquin NSW 2710 within 28 days of this notice (90CW811023). The objection must include your name and address and specify the grounds of objection.

Any queries please call 03 5898 3939, Jane Taylor.

[n2018-436]

WATER MANAGEMENT ACT 2000

DEPARTMENT OF INDUSTRY – LANDS AND WATER

SOUTHERN RECHARGE GROUNDWATER SOURCE

An application for an amended WATER SUPPLY WORK APPROVAL has been received from **WARRUMBUNGLÉ SHIRE COUNCIL** for two new bores for town water supply purposes on Lot 4 DP839637 and Lot 7041 DP 1027284, Parish of Coonabarabran, County of Gowen (Ref: A012146).

Objections to the granting of the approval(s) must be registered in writing to Department of Industry - Water, PO Box 717, DUBBO NSW 2830 within 28 days of this notice. The objection must include your name and address to specify the grounds of objection.

Any queries please call (02) 6841 7469, Catherine Fuller, Water Regulation Officer.

[n2018-437]

WATER MANAGEMENT ACT 2000

DEPARTMENT OF INDUSTRY – LANDS AND WATER

LACHLAN FOLD BELT MDB GROUNDWATER SOURCE

An application under Section 92 of the *Water Management Act 2000* to amend WATER SUPPLY WORK APPROVAL 40CA411901 has been received from **SIBELCO AUSTRALIA LIMITED** to add two new bores for dewatering purposes on Lot 101 DP 1083781 and Lot 102 DP1083781, Parish of Harden, County of Bobbara (Ref: A012171).

Objections to the granting of an approval amendment must be registered in writing to Department of Industry – Water, PO Box 717, DUBBO NSW 2830 within 28 days of this notice. The objection must include your name and address to specify the grounds of objection.

Any queries please call (02) 6841 7555, Catherine Fuller, Water Regulation Officer or email regional.wro@dpi.nsw.gov.au.

[n2018-438]

Other Government Notices

ASSOCIATIONS INCORPORATION ACT 2009

NOTICE UNDER SECTION 509(5) OF THE CORPORATIONS ACT 2001
AS APPLIED BY SECTION 64 OF THE ASSOCIATIONS INCORPORATION ACT 2009

Notice is hereby given that the Incorporated Association mentioned below will be deregistered when three months have passed after 31 January 2018 (being date of receipt of final accounts by Liquidator).

HAWKESBURY COMMUNITY COLLEGE INCORPORATED	Y0510018
---	----------

Dated this 2nd day of February 2018

C Gowland
Delegate of the Secretary & Director Registry Services

[n2018-439]

ASSOCIATIONS INCORPORATION ACT 2009

Cancellation of registration pursuant to section 80

TAKE NOTICE that COUNTRY RUGBY LEAGUE OF NEW SOUTH WALES INCORPORATED (Y0717232) became registered under the *Corporations Act 2001* as COUNTRY RUGBY LEAGUE OF NSW LIMITED (ACN 623 468 959), a company limited by guarantee, on 18 January 2018, and accordingly its registration under the *Associations Incorporation Act 2009* is cancelled as of that date.

Robyne Lunney
Delegate of the Commissioner,
NSW Fair Trading
2 February 2018

[n2018-440]

ASSOCIATIONS INCORPORATION ACT 2009

Cancellation of incorporation pursuant to section 74

TAKE NOTICE that the incorporation of the following associations is cancelled by this notice pursuant to section 74 of the *Associations Incorporation Act 2009*.

ADAPTIVE ATHLETE AUSTRALIA INCORPORATED	INC1700466
AUSTRALIAN CHRISTIAN CARE HUNTER VALLEY INCORPORATED	INC9874143
BANKSTOWN GRANVILLE INDUSTRY EDUCATION PARTNERSHIP INCORPORATED	INC9876899
FRIENDS OF THE REMEMBRANCE DRIVE INCORPORATED	INC1601730
LISMORE COMMUNITY SUSTAINABILITY FORUM INCORPORATED	INC9891113
MURWILLUMBAH COMMUNITY GARDENS INCORPORATED	INC1300023
PROBUS CLUB OF MERIMBULA INC	INC1600632
ROSE BAY CHAMBER OF COMMERCE INCORPORATED	Y2295317
ROTARY CLUB OF MURRURUNDI INCORPORATED	Y1749943

Cancellation is effective as at the date of gazettal.

Dated this 7 February 2018.

Robyne Lunney
Delegate of the Commissioner
NSW Fair Trading

[n2018-441]

ASSOCIATIONS INCORPORATION ACT 2009

Cancellation of Registration pursuant to Section 76

TAKE NOTICE that the registration of the following associations is cancelled by this notice pursuant to section 76 of the *Associations Incorporation Act 2009*.

AFRICAN SUDANESE WOMEN UNION INCORPORATED	INC9889335
ARMIDALE RUGBY LEAGUE FOOTBALL CLUB INCORPORATED	Y2354037
AUSTRALIAN HELLENIC COUNCIL (NSW) INCORPORATED	Y2299207
BELMORE KOREAN PRESBYTERIAN CHURCH INC	INC9894038
BREWARRINA ENTERPRISES ALLIANCE INCORPORATED	INC9886932
CONSERVATORIUM HIGH ASSOCIATION OF OLD STUDENTS INCORPORATED	INC9876931
FRIENDS OF CAMERON PARK SPECIAL SCHOOL INC	Y0484620
HAWKESBURY SOFTBALL ASSOCIATION INC	Y1621147
MANO RIVER SUSTAINABLE DEVELOPMENT ASSOCIATION INCORPORATED	INC9897460
MARULAN FOOTBALL CLUB INCORPORATED	Y1593314
NEW SOUTH WALES POLICE RUGBY LEAGUE FOOTBALL ASSOCIATION INC.	INC9876147
NEWCASTLE SAMOA RUGBY UNION ASSOCIATION INCORPORATED	INC9888695
NOWRA AUSTRALIAN FOOTBALL CLUB INCORPORATED	INC9883638
NSW BRAZILIAN JIU JITSU FEDERATION INCORPORATED	INC9878854
SPANISH SPEAKING CANCER COMMUNITY NETWORK INCORPORATED	INC9890555
TAMWORTH FIELD ARCHERS INCORPORATED	Y2151938

Cancellation is effective as at the date of gazettal.

Dated this 7th day of February 2018.

Christine Gowland
 Delegate of the Commissioner
 NSW Fair Trading

[n2018-442]

CRIMES (ADMINISTRATION OF SENTENCES) ACT 1999

GOVERNOR

I, General The Honourable David Hurley AC DSC (Ret'd), Governor of the State of New South Wales, with the advice of the Executive Council, and pursuant to section 225(1) and 225(3) of the *Crimes (Administration of Sentences) Act 1999*, do, by this Proclamation, declare the area described hereunder and all buildings erected thereon, to be a correctional centre within the meaning of the *Crimes (Administration of Sentences) Act 1999* and I further declare that the correctional centre shall be known as Hunter Correctional Centre, viz:

All that piece or parcel of land situate in the local government area of Cessnock, Parish of Pokolbin and County of Northumberland, being part of lot 2 and 3 Deposited Plan 76202, shown by the shading on Plan Catalogue No 57514 in the Plan Room of the NSW Department of Finance, Services & Innovation, reproduced hereunder and having an area of 8.58 hectares or thereabouts.

This proclamation is to take effect on and from the date of publication in the NSW Government Gazette.

Signed and sealed at Sydney, this 7th day of February 2018.

By His Excellency's Command.

David Elliott MP
 Minister for Corrections

GOD SAVE THE QUEEN!

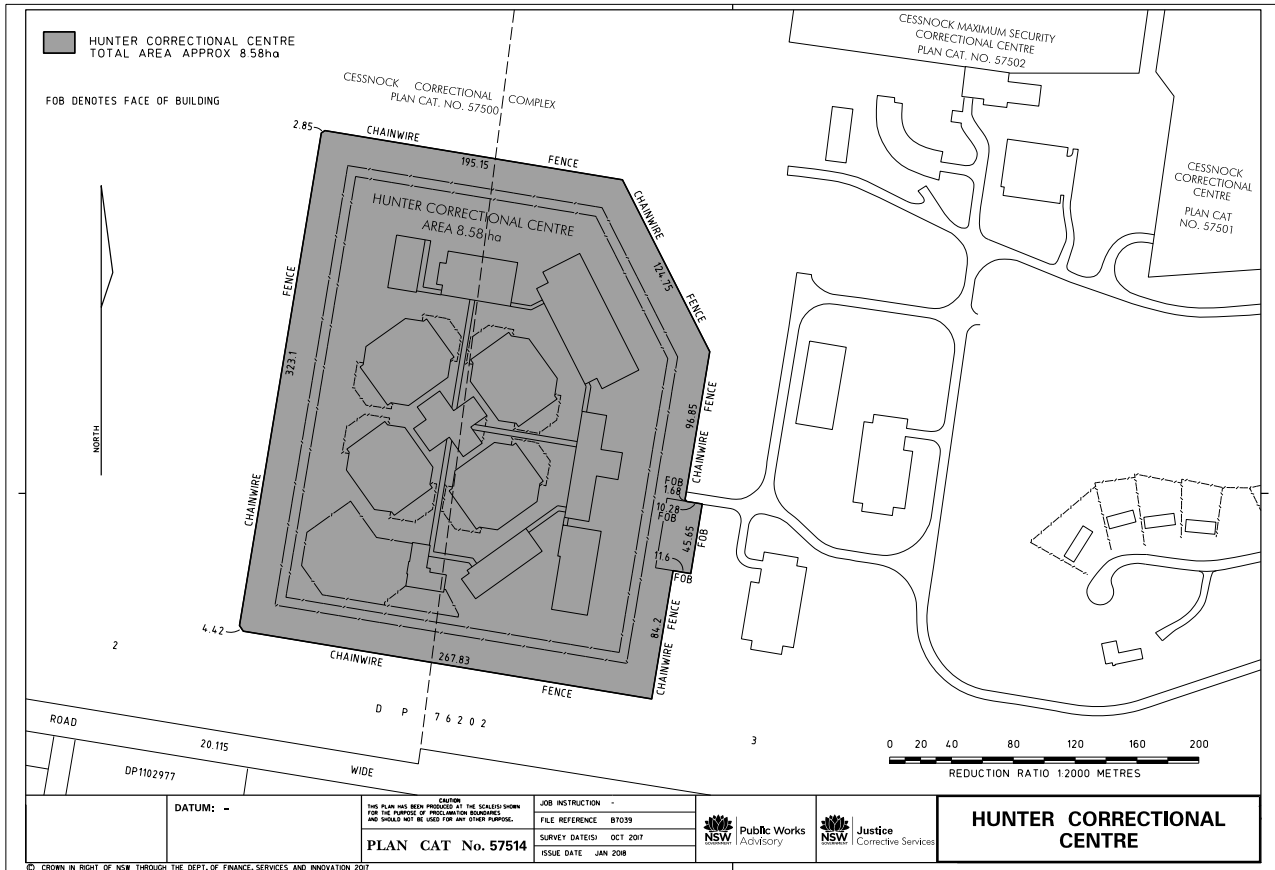

[n2018-443]

DISTRICT COURT ACT 1973

District Court of New South Wales

Direction

PURSUANT to section 32 of the *District Court Act 1973*, I direct that the District Court shall sit in its civil (**Mining**) jurisdiction at the place and time shown as follows:

Sydney	10.00am	12 March 2018 (1 week) In lieu of 19 March 2018 (1 week)
--------	---------	---

Dated this 1st day of February 2018.

Justice D Price AM
Chief Judge

[n2018-444]

EMERGENCY SERVICES LEVY INSURANCE MONITOR ACT 2016

Variation of Guidelines relating to prohibited conduct under section 21 of the *Emergency Services Levy Insurance Monitor Act 2016* (“the Act”).

I, Professor Allan Fels AO, the person appointed as the Emergency Services Levy Insurance Monitor under section 5 of the Act, publish the following variations to the Guidelines on Over-collection of ESL, issued on 6 December 2017, under section 21 of the Act (“Guidelines”):

- On page 21 of the Guidelines, insert in line 2, the symbol and letters “& ACN” immediately after the phrase “name of insurance company”;
- On page 22 of the Guidelines, insert the symbol and letters “& ACN” immediately after the phrase “Name of Company” where it appears on that page of the Guidelines;

3. On page 23 of the Guidelines, insert the symbol and letters “& ACN”:
 - (a) immediately after the phrase “Company Name” in line 2;
 - (b) immediately after the phrase “Company Name” in line 2 of the paragraph immediately below the heading “Conclusion”;
4. On page 23 of the Guidelines:
 - (a) in line 2 of the paragraph immediately below the heading “Conclusion”, substitute the word “ended” for the word “ending”;
 - (b) In line 6 of the second paragraph, substitute the word “December” for the word “July”;
5. On page 24 of the Guidelines, in the first paragraph immediately below the heading “Auditor’s responsibility for the review of the ESL Declaration”:
 - (a) Insert the words “in order to” immediately after the word “review” in line 1 of that paragraph; and
 - (b) Insert the word “not” immediately after the word “does” where it appears in line 3 of that paragraph.

These variations to the Guidelines take effect immediately.

Professor Allan Fels AO
Emergency Services Levy Insurance Monitor

Dated: 7 February 2018

[n2018-445]

GEOGRAPHICAL NAMES ACT 1966

ERRATUM

In the notice referring to the determination of locality boundaries – Shire of Snowy Valley, Folio 6870, 18 September 1992, the names: Braemar, Snowy Plains and Eucumbene Cove were spelt incorrectly. The correct spelling for the names is: Braemar Bay, Snowy Plain and Eucumbene. This notice corrects that error.

Narelle Underwood
Chair
Geographical Names Board
P O Box 143
BATHURST 2795

[n2018-446]

POINT TO POINT TRANSPORT (TAXIS AND HIRE VEHICLES) REGULATION 2017

NOTICE

By the authority vested in me under clause 92(1) of the *Point to Point Transport (Taxis and Hire Vehicles) Regulation 2017*, I hereby exempt the following persons from section 27 of the *Point to Point Transport (Taxis and Hire Vehicles) Act 2016* (the Act):

- 1) The Gunnedah Shire Council (the Council) as established under section 220(1) of the *Local Government Act 1993* is exempted from the requirement to be authorised as a booking service provider under section 27(1) of the Act.
- 2) A provider of a passenger service who obtains bookings from the Council is exempt from the requirement under section 27(3) of the Act to ensure that the Council is authorised to provide that service under the Act.
- 3) Any driver who drives a motor vehicle used to provide a passenger service to the Council is exempt from the requirement under section 27(4) to not take bookings from the Council because the Council is not authorised under the Act.

This exemption will remain in force until the Council is authorised as a booking service provider under the Act or is sooner revoked.

Barbara Wise,
Point to Point Transport Commissioner

6 February 2018

[n2018-447]

POINT TO POINT TRANSPORT (TAXIS AND HIRE VEHICLES) REGULATION 2017

NOTICE

By the authority vested in me under clause 92(1) of the *Point to Point Transport (Taxis and Hire Vehicles) Regulation 2017*, I hereby exempt the following persons from section 27 of the *Point to Point Transport (Taxis and Hire Vehicles) Act 2016* (the Act):

- 1) The Mid-Western Regional Council (the Council) as established under section 220(1) of the *Local Government Act 1993* is exempted from the requirement to be authorised as a booking service provider under section 27(1) of the Act.
- 2) A provider of a passenger service who obtains bookings from the Council is exempt from the requirement under section 27(3) of the Act to ensure that the Council is authorised to provide that service under the Act.
- 3) Any driver who drives a motor vehicle used to provide a passenger service to the Council is exempt from the requirement under section 27(4) to not take bookings from the Council because the Council is not authorised under the Act.

This exemption will remain in force until the Council is authorised as a booking service provider under the Act or is sooner revoked.

Barbara Wise,
Point to Point Transport Commissioner

6 February 2018

[n2018-448]

POINT TO POINT TRANSPORT (TAXIS AND HIRE VEHICLES) REGULATION 2017

NOTICE

By the authority vested in me under clause 92(1) of the *Point to Point Transport (Taxis and Hire Vehicles) Regulation 2017*, I hereby exempt the following persons from section 27 of the *Point to Point Transport (Taxis and Hire Vehicles) Act 2016* (the Act):

- 1) The Snowy Valleys Council (the Council) as established under section 220(1) of the *Local Government Act 1993* is exempted from the requirement to be authorised as a booking service provider under section 27(1) of the Act.
- 2) A provider of a passenger service who obtains bookings from the Council is exempt from the requirement under section 27(3) of the Act to ensure that the Council is authorised to provide that service under the Act.
- 3) Any driver who drives a motor vehicle used to provide a passenger service to the Council is exempt from the requirement under section 27(4) to not take bookings from the Council because the Council is not authorised under the Act.

This exemption will remain in force until the Council is authorised as a booking service provider under the Act or is sooner revoked.

Barbara Wise,
Point to Point Transport Commissioner

6 February 2018

[n2018-449]

POISONS AND THERAPEUTIC GOODS REGULATION 2008

ORDER

Withdrawal of Drug Authority

In accordance with the provisions of clause 175(1) of the *Poisons and Therapeutic Goods Regulation 2008* an Order has been made on **Mr Hung Kim TRAN (PHA0001061446)** of Moorebank NSW 2170 prohibiting him, until further notice, as a pharmacist, from supplying or having possession of, or manufacturing any preparation, admixture or extract of a drug of addiction as authorised by Clauses 101(1) and 102 of the Regulation.

This Order is to take effect on and from 7 February 2018.

Dated at Sydney, 2 February 2018

Elizabeth Koff
Secretary, NSW Health

[n2018-450]

POISONS AND THERAPEUTIC GOODS REGULATION 2008

ORDER

Restoration of Drug Authority

In accordance with the provisions of clause 175(1) of the *Poisons and Therapeutic Goods Regulation 2008* a direction has been issued that the Order that took effect on and from 11 January 2010, on **Dr Paul Stephens (MED0001039886)** of Blackheath, NSW 2785, prohibiting him as a medical practitioner from supplying or having possession of drugs of addiction as authorised by clause 101 of the Regulation, and issuing a prescription for a drug of addiction as authorised by clause 77 of the Regulation, shall cease to operate on and from 9 February 2018.

Dated at Sydney, 5 February 2018

ELIZABETH KOFF
Secretary
NSW Health

[n2018-451]

RESTRICTED PREMISES ACT 1943

Declaration by Supreme Court in relation to premises

On 5 February 2018, the Supreme Court of New South Wales declared that the premises identified by NSW Land Registry Services as Folio 4724-222 and known as 13-15 Chinchin Street, Islington in the State of New South Wales are premises to which Part 2 of the *Restricted Premises Act 1943* (NSW) applies, for the predominant (but not sole) reason that reputed criminals have attended or are likely to attend the premises, and a reputed criminal has, or takes part or assists in, the control or management of the premises

[n2018-452]

TRANSPORT ADMINISTRATION ACT 1988

LAND ACQUISITION (JUST TERMS COMPENSATION) ACT 1991

Notice of Compulsory Acquisition of Interest in Land for the Purposes of the Transport Administration Act 1988

Transport for NSW by its delegate declares, with the approval of His Excellency the Governor, that the easement described in Schedule 1 below is acquired by compulsory process under the provisions of the *Land Acquisition (Just Terms Compensation) Act 1991* as authorised by clause 11 of Schedule 1 of the *Transport Administration Act 1988* for the purposes of the *Transport Administration Act 1988*.

IVAN GLAVINIC
Deputy Program Director - Sydney Metro

SCHEDULE 1

An easement for rock anchors on the terms set out in Schedule 2, and over that part of that piece or parcel of land situated at Sydney, in the Local Government Area of Sydney, Parish of St Lawrence and County of Cumberland being that part of Lot 1 in Deposited Plan 516988 shown marked "X" in Drawing No. NWRLSRT-RPS-SPS-SR-DWG-000027, a copy of which is set out in Schedule 3.

SCHEDULE 2

Terms of easement for rock anchors

1. Easement for rock anchors

1.1 Easement summary

This Easement provides the Authority Benefited with:

- (a) access to the Easement Site for the purpose of installing Rock Anchors; and
- (b) the right to have the Rock Anchors remain on the Easement Site at all times until expiry of the Easement under clause 1.3.

1.2 Terms of the easement

- (a) The Owner of the Lot Burdened grants to the Authority Benefited full, free and unimpeded right for the Authority Benefited to:
 - (i) enter on, pass and repass over the Easement Site at all times with or without Equipment for the Permitted Purpose and do anything reasonably necessary for that purpose including:
 - (A) entering the Easement Site; and
 - (B) taking anything on to the Easement Site; and
 - (ii) have the Rock Anchors remain on the Easement Site until expiry of the Easement under clause 1.3.
- (b) In exercising its rights under this Easement, the Authority Benefited must:
 - (i) make good any damage to the Easement Site, Lot Burdened and Building to the extent caused by the Authority Benefited;
 - (ii) carry out all activities so as to cause as little inconvenience as is reasonably practicable to the Owner of the Lot Burdened or any Occupier;
 - (iii) take all necessary steps to minimise any adverse interference caused by the Authority Benefited to the Owner of the Lot Burdened or any Occupier; and
 - (iv) comply with all relevant laws relating to the exercise of those rights.

1.3 Expiry of the easement

- (a) As soon as practicable after the date on which the Authority Benefited no longer requires the rights under this Easement, the Authority Benefited must:
 - (i) de-stress any stressed Rock Anchors but is not required to remove any Rock Anchors installed on the Easement Site pursuant to this Easement; and

- (ii) notify the Owner of the Lot Burdened in writing.
- (b) This Easement will expire on the earlier to occur of:
 - (i) 30 June 2022; and
 - (ii) the date on which the Authority Benefited gives the Owner of the Lot Burdened notice under paragraph (a)(ii).
- (c) If this Easement has expired under paragraph (b):
 - (i) the Owner of the Lot Burdened and the Authority Benefited must take all reasonable steps to remove this Easement from the title of the Lot Burdened as soon as practicable, including preparing and executing all necessary documents and producing the relevant certificates of title at Land and Property Information NSW; and
 - (ii) the Owner of the Lot Burdened may, at its risk and cost, cut the Rock Anchors at any location within the Easement Site and otherwise deal with any part of the Rock Anchors within the Easement Site as the Owner of the Lot Burdened sees fit.

1.4 **Incorporation of definitions and interpretation clauses**

The provisions of clause 2 apply to this Easement to the extent relevant.

The name of the persons empowered to release, vary or modify this easement:

The Authority Benefited.

2. **General**

2.1 **Exercise of the benefit of the Easement**

The Authority Benefited may, in its discretion, permit any of its Authorised Users to exercise its rights and perform its obligations under this Easement from time to time.

2.2 **Conditions**

Each of the Conditions constitute and are covenants and agreements by and between the Authority Benefited and the Owner of the Lot Burdened for themselves and their respective successors, assigns and transferees with the intention and agreement that the benefit and burden of such covenants and agreements must pass with the benefit and burden of the Easement.

2.3 **Definitions**

Acquisition Notice means the acquisition notice effecting the acquisition of this Easement published in the Government Gazette.

Authorised Users means the agents, employees, contractors (and each of their subcontractors at any level) and consultants of the Authority Benefited and any other person authorised by the Authority Benefited to exercise the rights and perform the obligations of an Authorised User under this Easement.

Authority Benefited means Transport for NSW (ABN 18 804 239 602), a New South Wales Government agency constituted by section 3C of the *Transport Administration Act 1988* (NSW).

Building means the building and other structures (or any part of the building or other structures) on the Lot Burdened from time to time.

Conditions means the conditions contained in this Easement, excluding the section entitled "Easement summary" and including the general provisions set out in this clause 2.

Easement means the easement in this instrument and includes the Conditions in relation to that easement.

Easement Site means the area shown marked "X" in Drawing No. NWRLSRT-RPS-SPS-SR-DWG-000027, a copy of which is set out in Schedule 3 of the Acquisition Notice.

Equipment means all necessary tools, implements, materials, machinery and vehicles.

Existing Building Structures means any improvements located within the Easement Site at the commencement of the Easement.

Government Gazette means the official journal published by the NSW Government containing proclamations and notifications, including land acquisition notices.

Lot Burdened means Lot 1 in Deposited Plan 516988.

Occupier means any person who is legally entitled and authorised to occupy any part of Lot Burdened from time to time.

Owner of the Lot Burdened means every person who is at any time entitled to an estate or interest in the Lot Burdened, including without limitation any freehold or leasehold estate or interest in possession in the Lot Burdened and each part of the Lot Burdened and any Owners Corporation in relation to the Lot Burdened.

Owners Corporation means an owners corporation constituted under the *Strata Schemes Management Act 2015* (NSW) or community association constituted under the *Community Land Development Act 1989* (NSW) and any similar body corporate serving the same functions and purposes as an owners corporation or a community association.

Permitted Purpose means installing Rock Anchors within the Easement Site and all works and activities associated with such installation, including replacement or removal of the Rock Anchors.

Project means the design, construction (including any demolition required to enable construction to proceed or as a necessary part of any construction), operation and maintenance of the Sydney Metro City & Southwest project on land adjoining or in the vicinity of the Lot Burdened.

Rock Anchors means ground anchors, rock anchors, rock bolts, rock pinning, soil nails, rock dowels and other structures or equipment for the purpose of temporarily supporting or temporarily protecting the works on land owned by the Authority Benefited or temporarily underpinning and supporting improvements erected on the Lot Burdened.

SCHEDULE 3

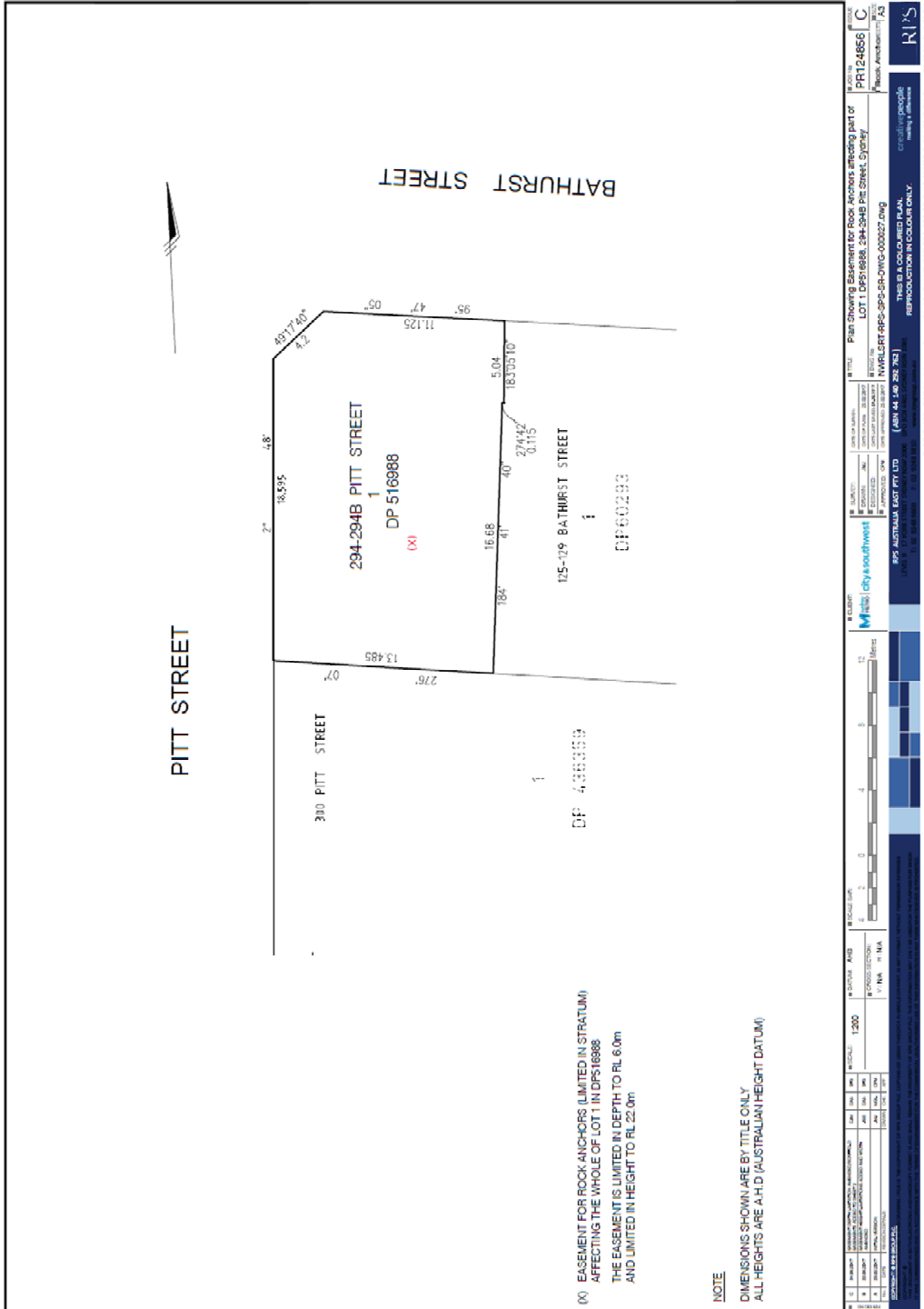

(Transport for NSW Document Number: SM17/0005555)

[n2018-453]

COUNCIL NOTICES

ALBURY CITY COUNCIL

ROADS ACT 1993

Naming of Roads

Notice is hereby given that Albury City Council, pursuant to section 162 of the *Roads Act 1993*, has officially named the road(s) as shown hereunder:

Name	Locality
LEICESTER STREET	Springdale Heights
Description	
Leicester Street will be located within the "Ettamogah Rise" subdivision. The Ettamogah Rise subdivision is located across the suburbs of Springdale Heights and Ettamogah. It is proposed to locate Leicester Street on the western side of this subdivision. Access to Leicester Street will be from either Fenchurch Drive or Whitehall Avenue. Leicester Street will run in an east – west direction.	

FRANK ZAKNICH, GENERAL MANAGER, Albury City Council, PO Box 323, ALBURY NSW 2640

GNB Ref: 0010

[n2018-454]

ALBURY CITY COUNCIL

ROADS ACT 1993

Naming of Roads

Notice is hereby given that Albury City Council, pursuant to section 162 of the *Roads Act 1993*, has officially named the road(s) as shown hereunder:

Name	Locality
BALU COURT	West Albury
Description	
Within proposed subdivision of Lot 1 DP1179008. South Off Padman Drive, about 130m east of Kremur Street. Balu Court heads south for about 40m, then turns west for about 60m to its end.	

FRANK ZAKNICH, GENERAL MANAGER, Albury City Council, PO Box 323, ALBURY NSW 2640

GNB Ref: 0011

[n2018-455]

ALBURY CITY COUNCIL

ROADS ACT 1993

Naming of Roads

Notice is hereby given that Albury City Council, pursuant to section 162 of the *Roads Act 1993*, has officially named the road(s) as shown hereunder:

Name	Locality
PETTS COURT	Thurgoona
Description	
Extends easterly off Kerr Road for about 180m. Commencing about 130m north of Hereford Court.	

FRANK ZAKNICH, GENERAL MANAGER, Albury City Council, PO Box 323, ALBURY NSW 2640

GNB Ref: 0012

[n2018-456]

ALBURY CITY COUNCIL

ROADS ACT 1993

Naming of Roads

Notice is hereby given that Albury City Council, pursuant to section 162 of the *Roads Act 1993*, has officially named the road(s) as shown hereunder:

Name	Locality
OSPREY STREET	Thurgoona
Description	
Osprey Street is located at the northern end of the Subdivision known as Mitchell Park. Osprey Street commences at Ava Avenue, loops around and then concludes at Ava Avenue	

FRANK ZAKNICH, GENERAL MANAGER, Albury City Council, PO Box 323, ALBURY NSW 2640

GNB Ref: 0013

[n2018-457]

ALBURY CITY COUNCIL

ROADS ACT 1993

Naming of Roads

Notice is hereby given that Albury City Council, pursuant to section 162 of the *Roads Act 1993*, has officially named the road(s) as shown hereunder:

Name	Locality
MEENA COURT	Lavington
Description	
Meena Court will be located off Nagle Road in Lavington. Access to Meena Court will be approximately 20 metres North of Wagga Road, access will be directly from Nagle Road.	

FRANK ZAKNICH, GENERAL MANAGER, Albury City Council, PO Box 323, ALBURY NSW 2640

GNB Ref: 0014

[n2018-458]

ALBURY CITY COUNCIL

ROADS ACT 1993

Naming of Roads

Notice is hereby given that Albury City Council, pursuant to section 162 of the *Roads Act 1993*, has officially named the road(s) as shown hereunder:

Name	Locality
GULUMBA STREET	Wirlinga
Description	
Gulumba Street will be located within a subdivision of Lot 251, DP 1206505. This subdivision is located in the suburb of Wirlinga. Access to Gulumba Street will be via Yarrabee Drive. It will run in a Northern direction.	

Name	Locality
WIRRANG STREET	Wirlinga
Description	
Wirrang Street will be located within a subdivision of Lot 251, DP 1206505. This subdivision is located in the suburb of Wirlinga. Access to Wirrang Street will be via Yarrabee Drive. It will run in a Southern direction.	

Name	Locality
YARRABEE DRIVE	Wirlinga
Description	
Yarrabee Drive will be located within a subdivision of Lot 251, DP 1206505. This subdivision is located in the suburb of Wirlinga. Yarrabee Drive will directly access the Subdivision from Kerr Road. It will run in a Eastern direction.	

FRANK ZAKNICH, GENERAL MANAGER, Albury City Council, PO Box 323, ALBURY NSW 2640

GNB Ref: 0018

[n2018-459]

ALBURY CITY COUNCIL

ROADS ACT 1993

Naming of Roads

Notice is hereby given that Albury City Council, pursuant to section 162 of the *Roads Act 1993*, has officially named the road(s) as shown hereunder:

Name	Locality
BLUE WREN CLOSE CLOSE	Thurgoona
Description	
Blue Wren Close will be located within a subdivision of 180 Kerr Road, the subdivision is being named "Kerrford Park Estate". This subdivision is located in the suburb of Thurgoona. Blue Wren Close will be accessed via Kerrford Drive. It will run in a North West direction	

Name	Locality
KERRFORD DRIVE	Thurgoona
Description	
Kerrford Drive will be located within a subdivision of 180 Kerr Road, the subdivision is being named "Kerrford Park Estate". This subdivision is located in the suburb of Thurgoona. Kerrford Drive will be the main access road in this Subdivision. Kerrford Drive will be accessed directly from Kerr Road, It will run in an Eastern direction	

Name	Locality
LORIKEET CLOSE	Thurgoona
Description	
Lorikeet Close will be located within a subdivision of 180 Kerr Road, the subdivision is being named "Kerrford Park Estate". This subdivision is located in the suburb of Thurgoona. Lorikeet Close will be accessed via Kerrford Drive. It will run in a Northern direction	

FRANK ZAKNICH, GENERAL MANAGER, Albury City Council, PO Box 323, ALBURY NSW 2640

GNB Ref: 0019

[n2018-460]

BYRON SHIRE COUNCIL

ROADS ACT 1993

Naming of Roads

Notice is hereby given that Byron Shire Council, pursuant to section 162 of the *Roads Act 1993*, has officially named the road(s) as shown hereunder:

Name	Locality
SHEARWATER LANE	Mullumbimby
Description	
A new road located between Lorikeet Lane and Cockatoo Crescent which is to be dedicated in a plan of subdivision of Lot 105 DP1212439, Tuckeroo Avenue MULLUMBIMBY	

MARK ARNOLD, Acting General Manager, Byron Shire Council, 70-90 Station Street, MULLUMBIMBY NSW 2482

GNB Ref: 0017

[n2018-461]

DUBBO REGIONAL COUNCIL

ERRATUM

In the notice referring to the Naming of Public Roads in the Dubbo Local Government Area, Folio 4217, 21 July 2017, the road name Mangrove Place was assigned with the incorrect road type. The correct road type for this road name is Mangrove Crescent. This notice corrects that error. MICHAEL MCMAHON, General Manager, Dubbo Regional Council, PO Box 81, Dubbo NSW 2830

[n2018-462]

LIVERPOOL CITY COUNCIL

ROADS ACT 1993

Naming of Roads

Notice is hereby given that Liverpool City Council, pursuant to section 162 of the *Roads Act 1993*, has officially named the road(s) as shown hereunder:

Name	Locality
ANDALUSIAN STREET	Austral
Description	
New street running north south from Fifth Avenue to Sixth Avenue as part of the subdivision of Lot 1067 DP2475 and Lot 2 DP1227478. It may be extended through Lot 5 DP1203671 and Lot 1136 DP2475 in the future.	
Name	Locality
SHETLAND WAY	Austral
Description	
An unnamed road created as part of a new residential subdivision of Lot 1067 DP 2475, Lot A DP 416093 and Lot B DP 416093	
Name	Locality
SONIC CLOSE	Middleton Grange
Description	
New road created as part of the subdivision of Lot 332 DP2475. Runs north-south from McGuinness Avenue into a dead end.	
Name	Locality
ESTOC STREET	Austral
Description	
Road constructed as part of the subdivision of Lot 885 DP2475. Road runs east-west and may be extended as part of the future subdivisions of Lots 886-887 DP2475 and Lots 1-2 DP1224481	
Name	Locality
HACKNEY STREET	Austral
Description	
New east-west street created as part of the subdivision of Lot 2 DP1227478 and Lot 1067 DP2475. It will run from the proposed Connemara Street to the proposed Andalusian Street. It may be extended through Lots 1063, 1064, 1065, and 1066 DP2475 in the future.	

Name	Locality
CONNEMARA STREET	Austral
Description	
New north-south street created as part of the subdivision of Lot 2 DP1227478, Lot 1067 DP2475, Lot A DP416093, and Lot 1 DP1227478. It runs from Sixth Avenue to Fifth Avenue.	

Name	Locality
DARTMOOR LANE	Austral
Description	
New street created as part of the subdivision of Lot 1067 DP2475 and Lot 2 DP1227478. Starts and ends at the proposed Connemara Street.	

Name	Locality
PRESTON STREET	Austral
Description	
New road created as part of the subdivision of Lots 1-2 DP619738. Runs east-west from the proposed Clearfield Avenue to the proposed Beaufort Avenue, between the proposed extensions of Sixteenth Avenue and Driftway Street.	

Name	Locality
CLEARFIELD AVENUE	Austral
Description	
Created as part of the subdivision of Lot 1 DP619738 and Lot 3 DP395169. Runs north south from the proposed extension of Seventeenth Avenue to the proposed extension of Sixteenth Avenue. May extend to Lot 363 DP2475 in the future.	

Name	Locality
BEAUFORT AVENUE	Austral
Description	
Created as part of the subdivision of Lot 2 DP619738. Runs north-south from the proposed extension of Seventeenth Avenue to the proposed extension of Sixteenth Avenue. May extend to Lot 362 DP2475 in the future.	

Name	Locality
WALLUP STREET	Austral
Description	
New road created as part of the subdivision of Lots 1-2 DP619738. Runs east-west between the proposed Clearfield Avenue and Beaufort Avenue.	

Name	Locality
ZIPPY WAY	Austral
Description	
New road created as part of the subdivision of Lots 1-2 DP619738. Runs north-south between Gurner Avenue and the proposed extension of Seventeenth Avenue.	

KIERSTEN FISHBURN, Chief Executive Officer, Liverpool City Council, LOCKED BAG 7064, LIVERPOOL BC NSW 1871

NEWCASTLE CITY COUNCIL

Roads Act 1993, Section 16

Dedication of Land as Public Road

NOTICE is hereby given that in accordance with the provisions of section 16 of the *Road Act 1993*, the land held by Council as described in the Schedule below is hereby dedicated as public road.

JEREMY BATH, Chief Executive Officer, Newcastle City Council, PO Box 489, Newcastle, NSW 2300.

SCHEDULE

The land comprising parts of Memorial Drive and Parkway Avenue, in the Parish of Newcastle, County of Northumberland, shown as road on DP 978941, shown highlighted on the attached plan.

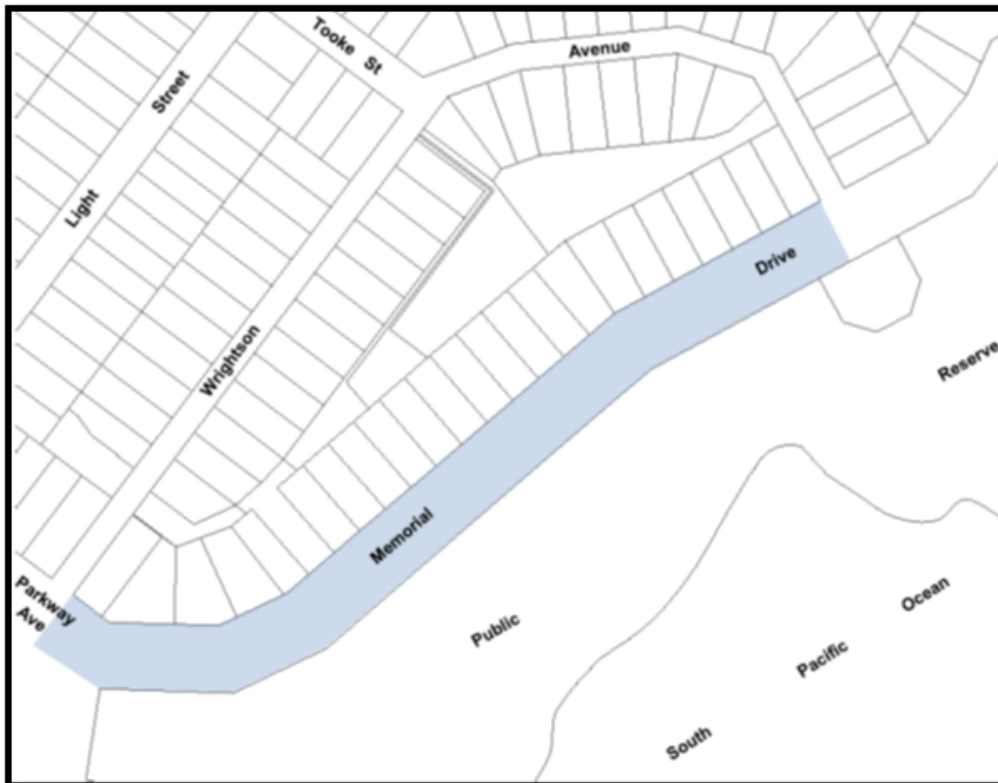

[n2018-464]

NEWCASTLE CITY COUNCIL

Roads Act 1993, Section 16

Dedication of Land as Public Road

NOTICE is hereby given that in accordance with the provisions of section 16 of the *Road Act 1993*, the land held by Council as described in the Schedule below is hereby dedicated as public road.

JEREMY BATH, Chief Executive Officer, Newcastle City Council, PO Box 489, Newcastle, NSW 2300.

SCHEDULE

The land comprising part of the streets in the Parish of Newcastle, County of Northumberland, shown as road on DP 978941, shown highlighted on the attached plan.

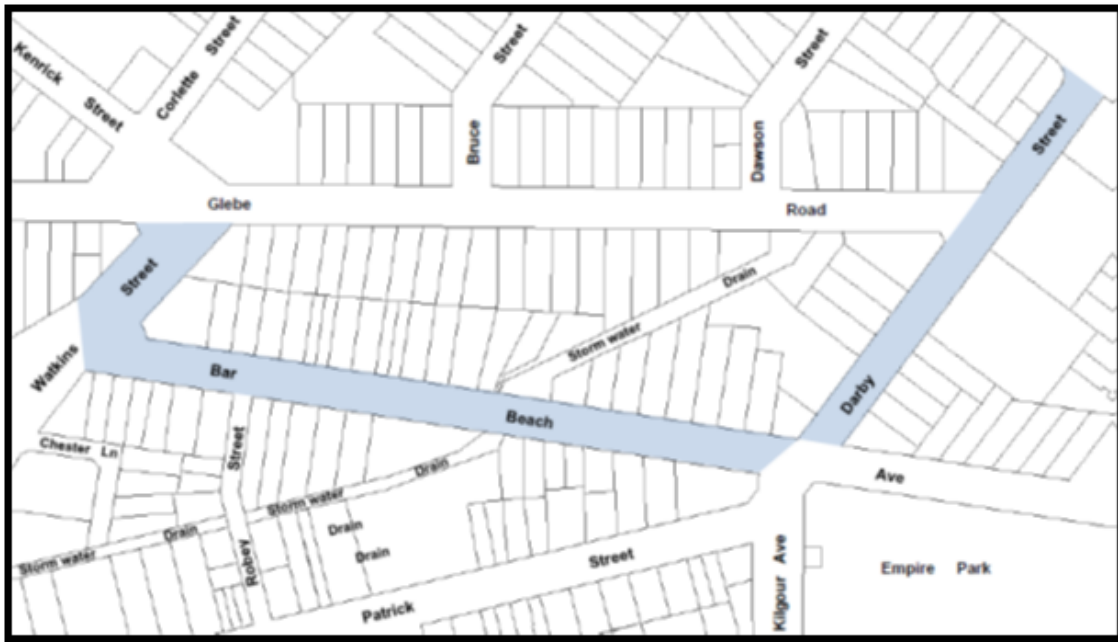

[n2018-465]

NEWCASTLE CITY COUNCIL

Roads Act 1993, Section 16

Dedication of Land as Public Road

NOTICE is hereby given that in accordance with the provisions of section 16 of the *Road Act 1993*, the land held by Council as described in the Schedule below is hereby dedicated as public road.

JEREMY BATH, Chief Executive Officer, Newcastle City Council, PO Box 489, Newcastle, NSW 2300.

SCHEDULE

The land comprising part of Union Street in the Parish of Newcastle, County of Northumberland, shown as road on DP 978941, shown highlighted on the attached plan.



[n2018-466]

NEWCASTLE CITY COUNCIL

Roads Act 1993, Section 16

Dedication of Land as Public Road

NOTICE is hereby given that in accordance with the provisions of section 16 of the *Road Act 1993*, the land held by Council as described in the Schedule below is hereby dedicated as public road.

JEREMY BATH, Chief Executive Officer, Newcastle City Council, PO Box 489, Newcastle, NSW 2300.

SCHEDULE

The land comprising part of the streets, known as Watkins Street and Chester Lane, in the Parish of Newcastle, County of Northumberland, shown as road on DP 111238, shown highlighted on the attached plan.



[n2018-467]

NEWCASTLE CITY COUNCIL

Roads Act 1993, Section 16

Dedication of Land as Public Road

NOTICE is hereby given that in accordance with the provisions of section 16 of the *Road Act 1993*, the land held by Council as described in the Schedule below is hereby dedicated as public road.

JEREMY BATH, Chief Executive Officer, Newcastle City Council, PO Box 489, Newcastle, NSW 2300.

SCHEDULE

The land comprising part of Kemp Street in the Parish of Newcastle, County of Northumberland, shown as road on DP 978941, shown highlighted on the attached plan.



[n2018-468]

NEWCASTLE CITY COUNCIL

Roads Act 1993, Section 16

Dedication of Land as Public Road

NOTICE is hereby given that in accordance with the provisions of section 16 of the *Road Act 1993*, the land held by Council as described in the Schedule below is hereby dedicated as public road.

JEREMY BATH, Chief Executive Officer, Newcastle City Council, PO Box 489, Newcastle, NSW 2300.

SCHEDULE

The land comprising part of Kemp and Union Streets, in the Parish of Newcastle, County of Northumberland, shown as road on DP 978941, shown highlighted on the attached plan.



[n2018-469]

NEWCASTLE CITY COUNCIL

Roads Act 1993, Section 16

Dedication of Land as Public Road

NOTICE is hereby given that in accordance with the provisions of section 16 of the *Road Act 1993*, the land held by Council as described in the Schedule below is hereby dedicated as public road.

JEREMY BATH, Chief Executive Officer, Newcastle City Council, PO Box 489, Newcastle, NSW 2300.

SCHEDULE

The land comprising part of National Park Street, Newcastle, in the Parish of Newcastle, County of Northumberland, shown as road on DP 978941, shown highlighted on the attached plan.



[n2018-470]

NEWCASTLE CITY COUNCIL

Roads Act 1993, Section 16

Dedication of Land as Public Road

NOTICE is hereby given that in accordance with the provisions of section 16 of the *Road Act 1993*, the land held by Council as described in the Schedule below is hereby dedicated as public road.

JEREMY BATH, Chief Executive Officer, Newcastle City Council, PO Box 489, Newcastle, NSW 2300.

SCHEDULE

The land comprising part of Selma Street, Newcastle West, in the Parish of Newcastle, County of Northumberland, shown as road on DP 95305, shown highlighted on the attached plan.



[n2018-471]

NEWCASTLE CITY COUNCIL

Roads Act 1993, Section 16

Dedication of Land as Public Road

NOTICE is hereby given that in accordance with the provisions of section 16 of the *Road Act 1993*, the land held by Council as described in the Schedule below is hereby dedicated as public road.

JEREMY BATH, Chief Executive Officer, Newcastle City Council, PO Box 489, Newcastle, NSW 2300.

SCHEDULE

The land comprising part of Parry Street, Newcastle West, in the Parish of Newcastle, County of Northumberland, shown as road on DP 95382, shown highlighted on the attached plan.



[n2018-472]

PENRITH CITY COUNCIL

Pursuant to Clause 9 of the *Roads Regulation 2008*, notice is hereby given of the naming of the following road/s.

Name	Location
Ottelia Road	Kemps Creek
Aristida Close	Kemps Creek
Imperata Close	Kemps Creek
Chelodina Street	Kemps Creek
Glycine Close	Kemps Creek

For further information please contact The General Manager, Mr Alan Stoneham, Penrith City Council on 02 4732 7777.

[n2018-473]

WAGGA WAGGA CITY COUNCIL

LOCAL GOVERNMENT ACT 1993

LAND ACQUISITION (JUST TERMS COMPENSATION) ACT 1991

NOTICE OF COMPULSORY ACQUISITION OF LAND

Wagga Wagga City Council declares with the approval of Her Honour the Administrator that the land described in the Schedule below, excluding any mines or deposits of minerals in the land, is acquired by compulsory process in accordance with the provisions of the *Land Acquisition (Just Terms Compensation) Act 1991* for the Riverina Intermodal Freight and Logistics Hub Site.

Dated at Wagga Wagga this 29 day of January 2018

Peter Thompson
General Manager

Schedule

Lot 21 DP1230517

[n2018-474]

WOLLONDILLY SHIRE COUNCIL

ROADS ACT 1993

Naming of Roads

Notice is hereby given that Wollondilly Shire Council, pursuant to section 162 of the *Roads Act 1993*, has officially named the road(s) as shown hereunder:

Name	Locality
TIMAIR ROAD	Thirlmere
Description	
A new road coming off Tickle Drive Thirlmere	

LUKE JOHNSON, General Manager, Wollondilly Shire Council, 62-64 Menangle Street, PICTON NSW 2571

GNB Ref: 0016

[n2018-475]

WOOLLAHRA MUNICIPAL COUNCIL

Notification of Dedication as a Public Road

On 24 July 2017, Woollahra Municipal Council resolved to dedicate the land as a public road in accordance with Section 16 of the *Roads Act 1993*.

Descriptions

Part of the residue land comprised in Certificate of Title Volume 1391 Folio 33 at Oswald Lane, Darling Point, Parish of Alexandria and County of Cumberland.

Note: (1) On dedication, title for the land will remain vested in Woollahra Municipal Council as public road.

Dated: 1 February 2018

Gary Leonard JAMES
General Manager
Woollahra Municipal Council

[n2018-476]