



# *Government Gazette*

of the State of

New South Wales

**Number 211–Roads and Transport**

**Friday, 11 September 2020**

---

The New South Wales Government Gazette is the permanent public record of official NSW Government notices. It also contains local council, non-government and other notices.

Each notice in the Government Gazette has a unique reference number that appears in parentheses at the end of the notice and can be used as a reference for that notice (for example, (n2019-14)).

The Gazette is compiled by the Parliamentary Counsel's Office and published on the NSW legislation website ([www.legislation.nsw.gov.au](http://www.legislation.nsw.gov.au)) under the authority of the NSW Government. The website contains a permanent archive of past Gazettes.

To submit a notice for gazettal, see the Gazette page.

**Roads Act 1993, Section 10**

Dedication of Land as Public Road

NOTICE is hereby given that pursuant to Section 10 of the Roads Act 1993, Byron Shire Council hereby dedicates the land described in the Schedule below as public road.

**Schedule**

Parish – Byron; County – Rous

Land District – Bangalow, LGA – Byron Shire

**Location**

Robert Street adjoining Station Street running east to Byron Creek, adjoining Lots 1 to 12 Sec 11 DP 4974.

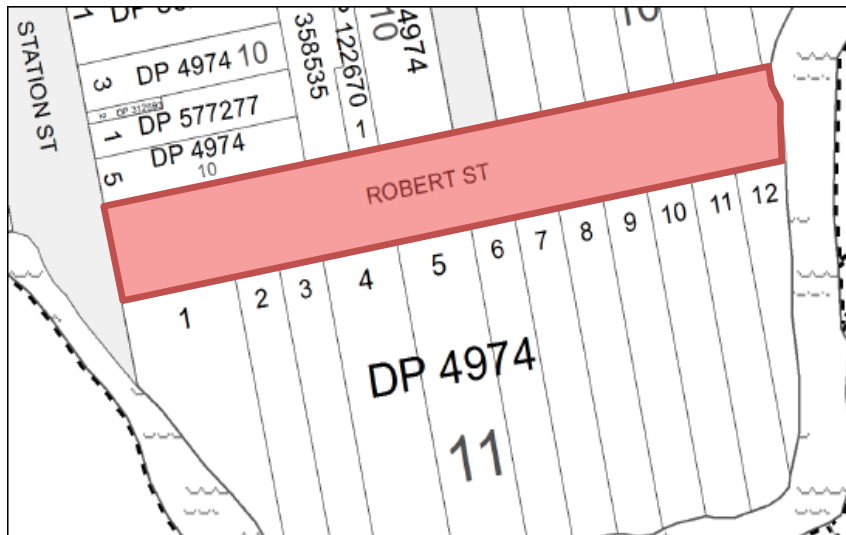

Mark Arnold  
General Manager  
Byron Shire Council  
PO Box 219 Mullumbimby NSW 2482

Liverpool City Council

ROADS ACT 1993

Naming of Roads

*Notice is hereby given that Liverpool City Council, pursuant to section 162 of the Roads Act 1993, has officially named the road(s) as shown hereunder:*

| Name   | Locality  |
|--|-----------|
| Hickman Lane   | LIVERPOOL |
| <b>Description</b>   |           |
| 22-26 Elizabeth Street, Liverpool. As part of the approval, two laneways are proposed to be created. Council has recommended that one of the two laneways be named after Eric Hickman. |           |

David Smith  
Manager Planning & Transport Strategy  
Liverpool City Council  
33 Moore Street  
Liverpool NSW 2170

Wingecarribee Shire Council

ROADS ACT 1993

Naming of Roads

*Notice is hereby given that Wingecarribee Shire Council, pursuant to section 162 of the Roads Act 1993, has officially named the road(s) as shown hereunder:*

| <b>Name</b>   | <b>Locality</b> |
|---|-----------------|
| POPPY Place   | BALACLAVA       |
| <b>Description</b>  |                 |
| 200m running off Cardigan Street terminating in a cul-de-sac. |                 |

Barry W Paull  
Acting General Manager Wingecarribee  
Shire Council Elizabeth Street  
Moss Vale NSW 2577

# ROADS ACT 1993

## Order

### Kempsey Shire Council Area

Declaration as Controlled Access Road, Declaration as Freeway and repeal as Controlled Access Road,  
of parts of the Pacific Highway between South Kempsey and Bellimbopinni

I, the Minister for Regional Transport and Roads, by this order:

1. repeal the parts of the order published in Government Gazette No 108 of 6 July 2001 on page 5309 which declared the main road described in Schedule 2 of that declaration to be controlled access road but only in so far as these parts pertain to the land described in Schedule 1 hereunder; and
2. pursuant to Sections 46, 48, 49, 54 and 67 of the *Roads Act 1993*:
  - a. dedicate as public road the land described in Schedules 2, 3 and 5 under;
  - b. declare to be a main road the said public road described in Schedules 3 and 5 and the public road described in Schedules 4 and 6 under;
  - c. declare to be a controlled access road the said main road described in Schedules 3 and 4 under;
  - d. declare to be a freeway the said main road described in Schedules 1, 5 and 6 under;
  - e. declare that access to the said controlled access road and freeway is restricted; and
  - f. specify in Schedule 7 under, the points along the controlled access road and freeway at which access may be gained to or from other public roads.

The Hon PAUL TOOLE MP  
Minister for Regional Transport and Roads

#### **Schedule 1**

All those pieces or parcels of land situated in the Kempsey Shire Council area, Parish of Beranghi and County of Macquarie, shown as:

Lots 5, 6, 12, 13, 14 and 17 Deposited Plan 1224971; and

Lot 26 Deposited Plan 737376.

The above Lots are shown in TfNSW Plan 0010 235 AC 4018.

#### **Schedule 2**

All those pieces or parcels of land situated in the Kempsey Shire Council area, Parishes of Beranghi, Kempsey and Cooroobongatti and Counties of Macquarie and Dudley, shown as:

Lot 34 Deposited Plan 1224971;

Lots 1, 5, 6 and 7 Deposited Plan 1221131;

Lots 18 and 21 Deposited Plan 1157615;

Lots 108 to 111 inclusive Deposited Plan 1205658;

Lot 61 Deposited Plan 1149843;

Lot 45 Deposited Plan 1160450;

Lots 32, 36 and 37 Deposited Plan 1162338;

Lots 14 to 23 inclusive Deposited Plan 1223282; and

Lot 15 Deposited Plan 1225190.

The above Lots are shown in TfNSW Plan 0010 235 AC 4018.

### **Schedule 3**

All those pieces or parcels of land situated in the Kempsey Shire Council area, Parishes of Beranghi and Cooroobongatti and Counties of Macquarie and Dudley, shown as:

Lots 20, 21, 23, 28, 29 and 30 Deposited Plan 1224971;

Lot 68 Deposited Plan 1165099;

Lots 10 to 14 inclusive Deposited Plan 1225190; and

Lot 60 Deposited Plan 1167380.

The above Lots are shown in TfNSW Plan 0010 235 AC 4018.

### **Schedule 4**

All those pieces or parcels of land situated in the Kempsey Shire Council area, Parish of Beranghi and County of Macquarie, shown as:

Lots 27 and 32 Deposited Plan 1224971.

The above Lots are shown in TfNSW Plan 0010 235 AC 4018.

### **Schedule 5**

All those pieces or parcels of land situated in the Kempsey Shire Council area, Parishes of Beranghi, Kempsey and Cooroobongatti and Counties of Macquarie and Dudley, shown as:

Lots 8, 10, 11, 15, 16, 18 and 19 Deposited Plan 1224971;

Lots 58 and 62 Deposited Plan 1165099;

Lot 81 Deposited Plan 1160308;

Lots 54, 55 and 56 Deposited Plan 1162355;

Lots 2 and 4 Deposited Plan 1221131;

Lot 13 Deposited Plan 1154962;

Lots 24 and 25 Deposited Plan 1157615;

Lot 3 Deposited Plan 1221401;

Lot 8 Deposited Plan 1199851;

Lots 100 to 105 inclusive Deposited Plan 1205658;

Lots 45, 46, 48 to 51 inclusive and 55 Deposited Plan 1149843;

Lot 2 Deposited Plan 1220265;

Lots 11, 24, 25, 27 to 32 inclusive, 34, 35, 38, 39 and 40 Deposited Plan 1160450;

Lot 11 Deposited Plan 1100541;

Lot 2 Deposited Plan 1209284;

Lot 11 Deposited Plan 1193651;  
Lot 803 Deposited Plan 1166237;  
Lots 402 and 403 Deposited Plan 1171540;  
Lots 26 and 29 Deposited Plan 1162338;  
Lot 2 Deposited Plan 1221117;  
Lots 282 and 283 Deposited Plan 1170932;  
Lots 1 to 6 inclusive Deposited Plan 1223282;  
Lots 48 and 49 Deposited Plan 1153400;  
Lots 70, 78 and 80 to 89 inclusive Deposited Plan 1158181;  
Lots 95 to 98 inclusive Deposited Plan 1163545;  
Lot 797 Deposited Plan 1168908;  
Lots 794 and 795 Deposited Plan 1169220;  
Lot 791 Deposited Plan 1165647;  
Lots 102 and 104 Deposited Plan 1162681;  
Lot 11 Deposited Plan 1168482;  
Lots 6, 7 and 8 Deposited Plan 1225190; and  
Lot 58 Deposited Plan 1167380.

The above Lots are shown in TfNSW Plan 0010 235 AC 4018.

#### **Schedule 6**

All those pieces or parcels of land situated in the Kempsey Shire Council area, Parishes of Beranghi, Kempsey and Cooroobongatti and Counties of Macquarie and Dudley, shown as:

Lots 7 and 9 Deposited Plan 1224971;  
Lot 67 Deposited Plan 1165099;  
Lot 3 Deposited Plan 1221131;  
Lot 2 Deposited Plan 1221401;  
Lots 106 and 107 Deposited Plan 1205658;  
Lots 41, 42 and 43 Deposited Plan 1160450;  
Lots 7 to 13 inclusive Deposited Plan 1223282;  
Lot 1 Deposited Plan 1220764;  
Lot 1 Deposited Plan 1220652;  
Lot 1 Deposited Plan 1239417;  
Lot 1 Deposited Plan 1220653;  
Lot 1 Deposited Plan 1220654; and

Lot 9 Deposited Plan 1225190.

The above Lots are shown in TfNSW Plan 0010 235 AC 4018.

### **Schedule 7**

Between the points A and B;

between the points C and D;

between the points E and F;

between the points G and H;

between the points J and K;

between the points L and M;

between the points N and P;

between the points Q and R;

between the points S and T;

between the points U and V;

between the points W and X;

between the points Y and Z;

between the points AA and BB;

between the points CC and DD;

between the points EE and FF; and

between the points GG and HH;

all shown in TfNSW Plan 0010 235 AC 4018.

(TfNSW Papers: SF2019/249130)



## **ROADS ACT 1993**

### Notice of Dedication of Land as Public Road at Milparinka in the Unincorporated Area

Transport for NSW, by its delegate, dedicates the land described in the schedule below as public road under section 10 of the *Roads Act 1993*.

**K DURIE**  
Manager, Compulsory Acquisition & Road Dedication  
Transport for NSW

#### **Schedule**

All those pieces or parcels of land situated in the unincorporated area, Parish of Warratta and County of Tongowoko, shown as Lots 26 and 27 Deposited Plan 1223458.

(TfNSW Papers: SF2020/154384; RO SF2016/047560)