



# *Government Gazette*

of the State of

New South Wales

**Number 106–Local Government**

**Thursday, 2 March 2023**

---

The New South Wales Government Gazette is the permanent public record of official NSW Government notices. It also contains local council, non-government and other notices.

Each notice in the Government Gazette has a unique reference number that appears in parentheses at the end of the notice and can be used as a reference for that notice (for example, (n2019-14)).

The Gazette is compiled by the Parliamentary Counsel's Office and published on the NSW legislation website ([www.legislation.nsw.gov.au](http://www.legislation.nsw.gov.au)) under the authority of the NSW Government. The website contains a permanent archive of past Gazettes.

To submit a notice for gazettal, see the Gazette page.

## JUNEE SHIRE COUNCIL

### ROADS ACT 1993

#### Notification of Closing of a Road (Pathway)

NOTICE is hereby given by Junee Shire Council, in pursuance of section 38D of the *Roads Act 1993*, that part of the road hereunder described is closed and the land comprised therein ceases to be public road. Upon closing, title to the land comprising the former public road will vest in Junee Shire Council as operational land for the purposes of the *Local Government Act 1993*.

#### DESCRIPTION

Parish – South Junee, County – Clarendon

Land District – Junee, LGA – Junee

Road Closed: Lot 42 DP 1291079

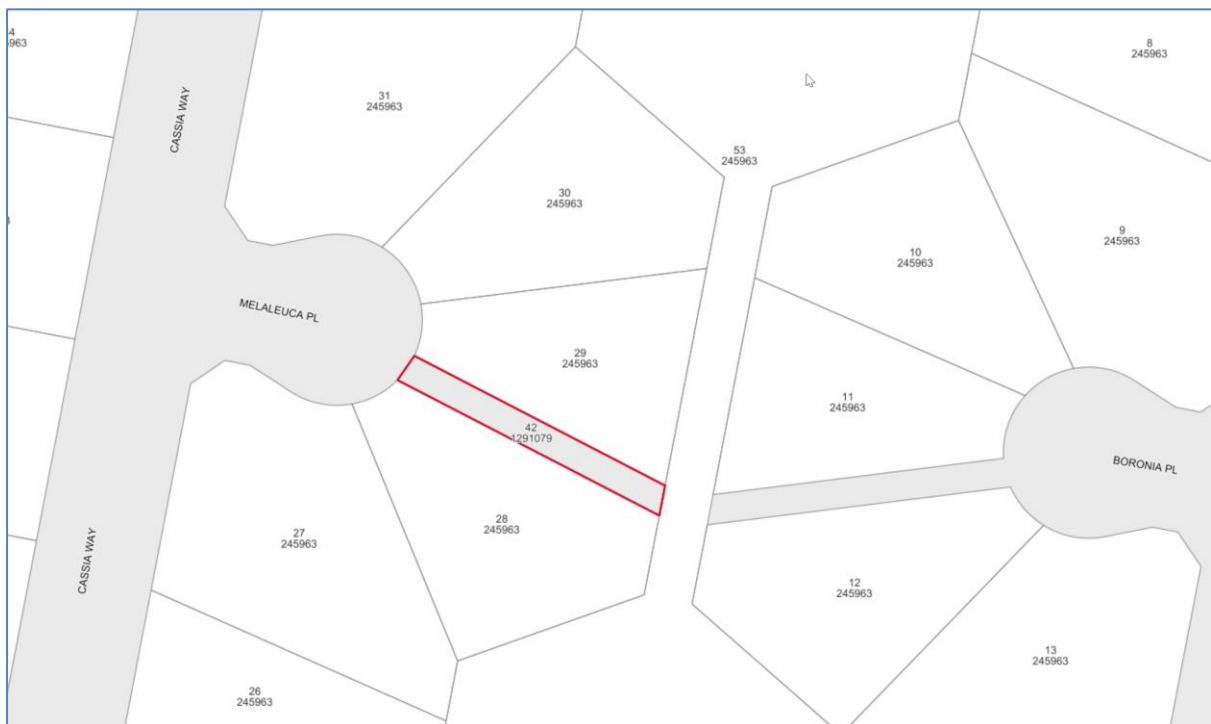

James Davis, General Manager, Junee Shire Council, PO Box 93, Junee NSW 2663

**BLUE MOUNTAINS CITY COUNCIL**

*ROADS ACT 1993*

Naming of Public Road

*Notice is hereby given that Blue Mountains City Council, in pursuance of Section 162 of the Roads Act 1993, has officially named the road as described in the Schedule below.*

General Manager, Blue Mountains City Council, Locked Bag 1005, Katoomba NSW 2780.

---

SCHEDULE

NAME	LOCALITY	DESCRIPTION
Barnet Street	GLENBROOK	Between High Street and the Great Western Highway.

Our Reference: 5031579

23 February 2023

## **Eurobodalla Shire Council**

NSW Coastal Management Act 2016

Commencement of Eurobodalla Open Coast Coastal Management Program

Notice is hereby given, under Section 17(4) of the Coastal Management Act 2016, that upon the publication of this Notice in this Gazette, the Eurobodalla Open Coast Coastal Management Program (CMP) 2022 will commence.

The Eurobodalla Open Coast CMP has been prepared by Eurobodalla Shire Council and certified by the Minister for the Local Government under Section 17(2) of the Coastal Management Act 2016.

The Eurobodalla Open Coast CMP identifies risks, issues, and opportunities for the long-term management of the Eurobodalla coastline from South Durras to Wallaga Lake. It provides a business plan which identifies actions (including infrastructure works), emergency response strategies and land-use planning advice to allow Council to manage this area in a strategic and integrated manner, consistent with the Coastal Management Act 2016 and Coastal Management Manual.

The Eurobodalla Open Coast CMP can be viewed on Eurobodalla Shire Council's website at [www.esc.nsw.gov.au/cmp](http://www.esc.nsw.gov.au/cmp).

For more information call Eurobodalla Shire Council on 4474 1000.

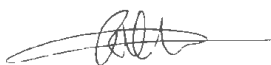

Warwick Winn  
**General Manager**

Blacktown City Council

ROADS ACT 1993

Naming of Roads

*Notice is hereby given that Blacktown City Council, pursuant to section 162 of the Roads Act 1993, has officially named the road(s) as shown hereunder:*

<b>Name</b>	<b>Locality</b>
Greenough Crescent	MARSDEN PARK
<b>Description</b>	
Proposed road starts and ends on proposed Pentecost Crescent, 40m & 220m from Glengarrie Rd.	
<b>Name</b>	<b>Locality</b>
Isdell Street	MARSDEN PARK
<b>Description</b>	
Proposed road runs from proposed Pentecost Crescent to the approximate internal apex of proposed Greenough Crescent.	
<b>Name</b>	<b>Locality</b>
Molineux Street	MARSDEN PARK
<b>Description</b>	
Proposed road runs south-westerly from Glengarrie Rd to meet proposed extension of Bramall Ave.	
<b>Name</b>	<b>Locality</b>
Pentecost Crescent	MARSDEN PARK
<b>Description</b>	
Proposed road starts and ends on the west side of Glengarrie Rd, 200m and 520m from South St.	
<b>Name</b>	<b>Locality</b>
Vasse Way	MARSDEN PARK

<b>Description</b>
Proposed road starts on Glengarrie Rd about 210m from South St and runs westerly to meet proposed Pentecost Crescent.

Kerry Robinson  
Chief Executive Officer  
Blacktown City Council  
PO Box 63  
Blacktown NSW 2148

**NAMBUCCA VALLEY COUNCIL**  
**NOTIFICATION OF CLOSING OF A ROAD**

Roads Act 1993

Notice is hereby given pursuant to Section 38D, Division 3 of Part 4 of the Roads Act 1993, that the road as set out in the Description below is closed. The lands comprised therein cease to be public road and the rights of passage and access that previously existed in relation to the road are extinguished. Upon closing, title to the land, comprising the former public road, will vest in the body specified in the Schedule hereunder.

Chris Thompson  
General Manager  
Nambucca Valley Council  
PO Box 177, MACKSVILLE NSW 2447

---

**DESCRIPTION**

Lot 1 in Deposited Plan 1288566 at Nambucca Heads in the Local Government Area of Nambucca Valley, Parish of Nambucca County of Raleigh and being the land comprised in Folio Identifier 1/1288566.

---

**SCHEDULE**

On closing the land within Lot 1 in Deposited Plan 1288566 will vest in Nambucca Valley Council as operational land for the purpose of the Local Government Act 1993.

Queanbeyan-Palerang Regional Council

ROADS ACT 1993

Naming of Roads

*Notice is hereby given that Queanbeyan-Palerang Regional Council, pursuant to section 162 of the Roads Act 1993, has officially named the road(s) as shown hereunder:*

<b>Name</b>	<b>Locality</b>
Long Flat Lane	MAJORS CREEK
<b>Description</b>	
Unnamed public road off Wallaces Gap Road approximately 2.7km from Hill Street, Majors Creek	
<b>Name</b>	<b>Locality</b>
Kings Creek Lane	BORO
<b>Description</b>	
Unnamed Crown Road off Duckfield Road	
<b>Name</b>	<b>Locality</b>
Rottenbury Crescent	GREENLEIGH
<b>Description</b>	
A new road in the Jumping Creek development area extending NE from the round-a-bout at the Rottenbury Cres/Jumping Creek Rd/Bushland View intersection	
<b>Name</b>	<b>Locality</b>
Shannon Terrace	GREENLEIGH
<b>Description</b>	
A new road in the Jumping Creek development area extending north off Jumping Creek Road, looping around east, to rejoin Jumping Creek Road.	
<b>Name</b>	<b>Locality</b>
Sayersbury Street	GREENLEIGH



<b>Description</b>	
A new road in the Jumping Creek development area extending SSE off Marchiori Crescent.	
<b>Name</b>	<b>Locality</b>
Primrose Avenue	GREENLEIGH
<b>Description</b>	
A new road in the Jumping Creek development area extending SE off Jumping Creek Road to the round-a-bout at the Jumping Creek Road/Marchiori Crescent/Primrose Avenue intersection	
<b>Name</b>	<b>Locality</b>
Petralia Street	GREENLEIGH
<b>Description</b>	
A new road in the Jumping Creek development area extending SE off Rottenbury Crescent to Jumping Creek Road	
<b>Name</b>	<b>Locality</b>
Marchiori Crescent	GREENLEIGH
<b>Description</b>	
A new road in the Jumping Creek development area. It is a loop road extending east and west from the round-a-bout at the Primrose Avenue/Jumping Creek Road intersection	
<b>Name</b>	<b>Locality</b>
Limeburner Way	GREENLEIGH
<b>Description</b>	
A new road within the Jumping Creek development area accessed off Primrose Avenue	
<b>Name</b>	<b>Locality</b>
Kiln Lane	GREENLEIGH
<b>Description</b>	
A new road in the Jumping Creek development area extending SW off Jumping creek Road	

<b>Name</b>	<b>Locality</b>
Jumping Creek Road	GREENLEIGH
<b>Description</b>	
The main entrance road to the Jumping Creek development area extending SE off Ellerton Drive.	
<b>Name</b>	<b>Locality</b>
Bushland View	GREENLEIGH
<b>Description</b>	
A new road in the Jumping Creek development area extending SW from the round-a-bout at the Jumping Creek Road/Rottenbury Crescent/Bushland View intersection	
<b>Name</b>	<b>Locality</b>
Bedrock Street	GREENLEIGH
<b>Description</b>	
A new road in the Jumping Creek development area extending NW off Rottenbury Street	

Rebecca Ryan  
Chief Executive Officer  
Queanbeyan-Palerang Regional Council  
10 Majara Street  
BUNGENDORE NSW 2621

Tweed Shire Council

ROADS ACT 1993

Naming of Roads

*Notice is hereby given that Tweed Shire Council, pursuant to section 162 of the Roads Act 1993, has officially named the road(s) as shown hereunder:*

<b>Name</b>	<b>Locality</b>
Bowen Loop	CUDGEN
<b>Description</b>	
New road within subdivision of Lots 1 and 2 in DP828298 (S93/0076/01). Road starts and ends at Prichard Place.	
<b>Name</b>	<b>Locality</b>
Sugar Mill Road	CUDGEN
<b>Description</b>	
New road within subdivision of Lots 1 and 2 in DP828298 (S93/0076/01). Road starts and ends at Bowen Loop.	

Troy Green  
General Manager  
Tweed Shire Council  
PO Box 816  
Murwillumbah NSW 2484

## Section 16 Roads Act 1993

### Dedication of Land as Public Road

Notice is hereby given pursuant to Section 16 of the *Roads Act 1993*, that the land described in the schedule and shown on the plan below is dedicated as public road.

David Waddell  
Chief Executive officer  
Orange City Council

.....  
SCHEDULE

ALL that piece or parcel of land situated in the Orange City Council area, Parish of Orange and County of Wellington, described as Lot 5 DP 667927 being Identifier 5/667927



Queanbeyan-Palerang Regional Council

ROADS ACT 1993

Naming of Roads

*Notice is hereby given that Queanbeyan-Palerang Regional Council, pursuant to section 162 of the Roads Act 1993, has officially named the road(s) as shown hereunder:*

<b>Name</b>	<b>Locality</b>
Calthorpe Street	GOOGONG
<b>Description</b>	
Between Edward Drive and Glenrock Drive	
<b>Name</b>	<b>Locality</b>
Rucos Street	GOOGONG
<b>Description</b>	
Between Glenrock Drive and Golden Way	
<b>Name</b>	<b>Locality</b>
Perrin Street	GOOGONG
<b>Description</b>	
Between Edward Drive and Rucos Street	

Rebecca Ryan  
Chief Executive Officer  
Queanbeyan-Palerang Regional Council  
10 Majara Street  
BUNGENDORE NSW 2621

Yass Valley Council

ROADS ACT 1993

Naming of Roads

*Notice is hereby given that Yass Valley Council, pursuant to section 162 of the Roads Act 1993, has officially named the road(s) as shown hereunder:*

<b>Name</b>	<b>Locality</b>
Blakelys Close	SUTTON
<b>Description</b>	
Subdivision Plan for Woodbury Ridge Estate being Lot 1 DP 1272209 - 2090 Sutton Road, Sutton. Road 3 Blakelys Close will come off Road 1 Woodbury Drive.	
<b>Name</b>	<b>Locality</b>
Harcourt Close	SUTTON
<b>Description</b>	
Subdivision Plan for Woodbury Ridge Estate being Lot 1 DP 1272209 - 2090 Sutton Road, Sutton. Road 2 Harcourt Close, will come off the Old Federal Highway.	
<b>Name</b>	<b>Locality</b>
Woodbury Drive	SUTTON
<b>Description</b>	
Subdivision Plan for Woodbury Ridge Estate being Lot 1 DP 1272209 - 2090 Sutton Road, Sutton. Road 1 Woodbury Drive will be coming off Guise Street (already established street) in Sutton.	

Chris Berry  
General Manager  
Yass Valley Council  
209 Comur Street  
Yass NSW 2582

**THE HILLS SHIRE COUNCIL**

Roads Act 1993  
Section 10

Notice of Dedication of Land as Public Road

Notice is hereby given by The Hills Shire Council, pursuant to Section 10 of the *Roads Act 1993*, that the land described in the Schedule below is hereby dedicated as public road.

MICHAEL EDGAR  
General Manager,  
The Hills Shire Council  
3 Columbia Court  
Norwest NSW 2153

---

SCHEDULE

*Parish – Nelson; County – Cumberland  
Locality – Box Hill; LGA – The Hills Shire Council*

Lot 21 in DP 1288857 Tablelands Street, Box Hill